

Land Information Memorandum



Property address:

74 Amyes Road

LIM number: H09355357

Page 1

Christchurch City Council

53 Hereford Street, PO Box 73015

Christchurch 8154, New Zealand

Tel 64 3 941 8999

Fax 64 3 941 8984

www.ccc.govt.nz

Application details

Date issued 17 October 2025
Date received 8 October 2025

Property details

Property address 74 Amyes Road, Hornby, Christchurch
Valuation roll number 23433 81200 A
Valuation information Capital Value: \$530,000
Land Value: \$225,000
Improvements Value: \$305,000
Please note: these values are intended for Rating purposes
Legal description Flat 1 DP 62609 on Lot 21 DP 13550 having share in 911 m2
Existing owner Karen Joan Barnes
Kevin Peter Barnes
58 Hudson Street
RIVERLEA
HAMILTON 3216

Council references

Rate account ID 73068433
LIM number H09355357
Property ID 1027129

Document information

This Land Information Memorandum (LIM) has been prepared for the purpose of section 44A of the Local Government Official Information and Meetings Act 1987 (LGOIMA). It is a summary of the information that we hold on the property. Each heading or "clause" in this LIM corresponds to a part of section 44A.

Sections 1 to 10 contain all of the information known to the Christchurch City Council that must be included under section 44A(2) LGOIMA. Any other information concerning the land as the Council considers, at its discretion, to be relevant is included at section 11 of this LIM (section 44A(3) LGOIMA). If there are no comments or information provided in these sections this means that the Council does not hold information on the property that corresponds to that part of section 44A.

The information included in this LIM is based on a search of Council records only and there may be other information relating to the land which is unknown to the Council. Please note that other agencies may also hold information relevant to the property, or administer legislation relevant to the use of the land, for example, the Regional Council (Ecan), Heritage New Zealand Pouhere Taonga, and Land Information New Zealand.

Council records may not show illegal or unauthorised building or works on the property. The applicant is solely responsible for ensuring that the land is suitable for a particular purpose.

A LIM is only valid at the date of issue as information is based only upon information the Council held at the time of that LIM request being made. It is essential that the applicant undertakes their own due diligence to verify the suitability of the property for their intended use.

Property file service

This Land Information Memorandum does not contain all information held on a property file. Customers may request property files by phoning the Council's Customer Call Centre on (03) 941 8999, or visiting any of the Council Service Centres. For further information please visit www.ccc.govt.nz.

To enable the Council to measure the accuracy of this LIM document based on our current records, we would appreciate your response should you find any information contained therein which may be considered to be incorrect or omitted. Please telephone the Customer Call Centre on (03) 941 8999.

Property address:

74 Amyes Road

LIM number: H09355357

Page 3

Christchurch City Council

53 Hereford Street, PO Box 73015
Christchurch 8154, New Zealand
Tel 64 3 941 8999
Fax 64 3 941 8984

www.ccc.govt.nz

A search of records held by the Council has revealed the following information:

1. Special features and characteristics of the land

Section 44A(2)(a) LGOIMA. This is information known to the Council but not apparent from the district scheme under the Town and Country Planning Act 1977 or a district plan under the Resource Management Act 1991. It identifies each (if any) special feature or characteristic of the land concerned, including but not limited to potential erosion, avulsion, falling debris, subsidence, slippage, alluvion, or inundation, or likely presence of hazardous contaminants.

☎ For enquiries, please phone (03) 941 8999 or visit www.ccc.govt.nz.

Natural Hazards

(a) Coastal Hazards

As at the date of this LIM, Council research found no information under this heading.

(b) Earthquakes

- Liquefaction Assessment

Christchurch City Council holds indicative information on liquefaction hazard for Christchurch. Information on liquefaction, including an interactive web tool, can be found on the Council website at ccc.govt.nz/liquefaction. Depending on the liquefaction potential of the area that the property is in, the Council may require site-specific investigations before granting future subdivision or building consent for the property.

(c) Flooding

As at the date of this LIM, Council research found no information under this heading.

(d) Landslides

As at the date of this LIM, Council research found no information under this heading.

(e) Subsidence

- Consultant Report Available

Land Information New Zealand (LINZ) engaged Tonkin and Taylor to provide a Geotechnical Report on Ground Movements that occurred as a result of the Canterbury Earthquake Sequence. The report indicates this property may have been effected by a degree of earthquake induced subsidence. The report obtained by LINZ can be accessed on their website at <https://www.linz.govt.nz> and search Information for Canterbury Surveyors.

(f) Tsunamis

As at the date of this LIM, Council research found no information under this heading.

(g) Volcanic and Geothermal Hazards

As at the date of this LIM, Council research found no information under this heading.

(h) Wind

As at the date of this LIM, Council research found no information under this heading.

(i) Any Other Natural Hazards

As at the date of this LIM, Council research found no information under this heading.

(j) District Plan Natural Hazard Information

Please refer to *Section 8. Land use and conditions* of this report for District Plan related natural hazard information.

(k) Building Notices

Please refer to *Section 5. Consents, certificates, notices, orders, or requisitions affecting the land and buildings* of this report for Building Act notice information.

Property address:

74 Amyes Road

LIM number: H09355357

Christchurch City Council

53 Hereford Street, PO Box 73015
Christchurch 8154, New Zealand
Tel 64 3 941 8999
Fax 64 3 941 8984

Other Special Features or Characteristics of the Land

As at the date of this LIM, Council research found no information under this heading.

Property address:

74 Amyes Road

LIM number: H09355357

Page 5

Christchurch City Council

53 Hereford Street, PO Box 73015

Christchurch 8154, New Zealand

Tel 64 3 941 8999

Fax 64 3 941 8984

www.ccc.govt.nz

2. Private and public stormwater and sewerage drains

Section 44A(2)(b) LGOIMA. This is information about private and public stormwater and sewerage drains as shown in the Council's records.

 For stormwater and sewerage enquiries, please phone (03) 941 8999 or visit www.ccc.govt.nz.

Related Information

- This property is shown to be served by Christchurch City Council Sewer and Stormwater.
- Attached are all drainage plans that Council hold for details of private and public drainage. Not all plans provided are verified by Council, and therefore Council cannot be liable for inaccuracies. Site investigation will be required by owners to determine exact layouts.

3. Drinking Water Supply

Section 44A(2)(ba) and (bb) LGOIMA. This is information notified to the Council about whether the land is supplied with drinking water, whether the supplier is the owner of the land or a networked supplier, any conditions that are applicable, and any information the Council has about the supply.

Please note the council does not guarantee a particular water quality to its customers. If you require information on current water quality at this property please contact the Three Waters & Waste Unit.

☎ For water supply queries, please phone (03) 941 8999 or visit www.ccc.govt.nz.

Water supply

Christchurch City Council is the networked supplier of water to this property. This property is connected to the Christchurch City Council Water Supply. The conditions of supply are set out in the Christchurch City Council Water Supply and Wastewater Bylaw (2022), refer to www.ccc.govt.nz.

4. Rates

Section 44A(2)(c) LGOIMA. This is information on any rates owing in relation to the land.

☎ For rates enquiries, please phone (03) 941 8999 or visit www.ccc.govt.nz.

(a) Annual rates

Annual rates to 30/06/2026: \$3,335.92

	Instalment Amount	Date Due
Instalment 1	\$833.92	31/08/2025
Instalment 2	\$833.92	30/11/2025
Instalment 3	\$833.92	28/02/2026
Instalment 4	\$834.16	31/05/2026

Rates owing as at 17/10/2025: \$566.92

(b) Excess Water Rates

For excess water charge enquiries, please phone (03) 941 8999 or visit www.ccc.govt.nz/contact-us.

(c) Final water meter reading required at settlement?

Property settlements must ensure all water usage and outstanding debts are accurately accounted for.

To advise of a property settlement, please complete the request for settlement information form at www.ccc.govt.nz/services/rates-and-valuations/solicitors-request.

A settlement statement of accounts will be provided on the expected settlement date advised.

Property address:

74 Amyes Road

LIM number: H09355357

5. Consents, certificates, notices, orders, or requisitions affecting the land and buildings

Section 44A(2)(d) LGOIMA. This is information concerning any consent, certificate, notice, order, or requisition, affecting the land or any building on the land, previously issued by the Council. The information in this section may also cover building consent and/or code compliance information issued by building certifiers under the Building Act 1991 and building consent authorities that are not the Council under the Building Act 2004.

You can check the property file to identify whether any consent or certificate was issued by a building certifier under the Building Act 1991.

Section 44A(2)(da) LGOIMA. The information required to be provided to a territorial authority under section 362T(2) of the Building Act 2004. There is currently no information required to be provided by a building contractor to a territorial authority under section 362T(2) of the Building Act 2004. The Building (Residential Consumer Rights and Remedies) Regulations 2014 only prescribed the information that must be given to the clients of a building contractor.

Sections 71 to 74 of the Building Act 2004 require the Building Consent Authority to consider natural hazards when it receives a building consent application for the construction or major alteration of a building on land that is subject to, or likely to be subject to, a natural hazard. A building consent for this property may have been issued subject to a section 72 or 73 notice. This means at the time of building consent the Building Consent Authority was not satisfied that adequate provision would be made to protect the building and land from the natural hazard and was subsequently required to notify the Registrar-General of Land to record the natural hazard on the Record of Title. The Building Act 2004 defines natural hazards as erosion (including coastal erosion, bank erosion, and sheet erosion), falling debris (including soil, rock, snow, and ice), subsidence, inundation (including flooding, overland flow, storm surge, tidal effects, and ponding), and slippage.

If your property contains a notice under s73 of the Building Act 2004, this will be identified on the building consent decision below (decision under s72 of the Building Act 2004) and on the properties' Record of Title. The Record of Title may also record this as a s36 notice under the Building Act 1991, or a s641A notice under the Local Government Act 1974.

☎ For building enquiries, please phone (03) 941 8999, email EPADutyBCO@ccc.govt.nz or visit www.ccc.govt.nz.

(a) Consents

- BCN/1950/328 Applied: 15/12/1950 Status: Completed
74 Amyes Road Hornby
Permit issued 15/12/1950
DWELLING no plans or additional information held on file- Historical Reference PER50101713
- BCN/1951/96 Applied: 20/04/1951 Status: Completed
74 Amyes Road Hornby
Permit issued 20/04/1951
TEMPORARY DWELLING no plans or additional information held on file- Historical Reference PER51010785
- BCN/1969/761 Applied: 19/02/1969 Status: Completed
74 Amyes Road Hornby
Permit granted 21/02/1969
Permit issued 21/02/1969
GARDEN SHED no plans or additional information held on file- Historical Reference PER68011169
- BCN/1973/3148 Applied: 18/05/1973 Status: Completed
74 Amyes Road Hornby
Permit granted 25/05/1973
Permit issued 25/05/1973
CARPORT- Historical Reference PER73015895 - Flat 1
- BCN/1992/1783 Applied: 09/03/1992 Status: Completed
74 Amyes Road Hornby
Permit issued 22/04/1992
DWELLING- Historical Reference PER166210 - Flat 2

Property address:

74 Amyes Road

LIM number: H09355357

Christchurch City Council

53 Hereford Street, PO Box 73015
Christchurch 8154, New Zealand
Tel 64 3 941 8999
Fax 64 3 941 8984

- BCN/1992/2861 Applied: 08/04/1992 Status: Completed
74 Amyes Road Hornby
Permit issued 25/05/1992
GARAGE- Historical Reference PER166368 - Flat 1 and Flat 2

(b) Certificates

Note: Code Compliance Certificates were only issued by the Christchurch City Council since January 1993.

(c) Notices

(d) Orders

(e) Requisitions

Property address:

74 Amyes Road

LIM number: H09355357

Page 10

Christchurch City Council

53 Hereford Street, PO Box 73015
Christchurch 8154, New Zealand
Tel 64 3 941 8999
Fax 64 3 941 8984

www.ccc.govt.nz

6. Certificates issued by a building certifier

Section 44A(2)(e) LGOIMA. This is information notified to the Council concerning any certificate issued by a building certifier pursuant to the Building Act 1991 or the Building Act 2004.

☎ For building enquiries, please phone (03) 941 8999, email EPADutyBCO@ccc.govt.nz or visit www.ccc.govt.nz.

Property address:

74 Amyes Road

LIM number: H09355357

Page 11

Christchurch City Council

53 Hereford Street, PO Box 73015
Christchurch 8154, New Zealand
Tel 64 3 941 8999
Fax 64 3 941 8984

www.ccc.govt.nz

7. Weathertightness

Section 44A(2)(ea) LGOIMA. This is information notified to the Council under section 124 of the Weathertight Homes Resolution Services Act 2006.

 For weathertight homes enquiries, please phone (03) 941 8999 or visit www.ccc.govt.nz.

If there is no information below this means Council is unaware of any formal Weathertight Homes Resolution Services claim lodged against this property.

8. Land use and conditions

Section 44A(2)(f) LGOIMA. This is information relating to the use to which the land may be put and conditions attached to that use. The planning information provided below is not exhaustive and reference to the Christchurch District Plan and any notified proposed changes to that plan is recommended: <https://ccc.govt.nz/the-council/plans-strategies-policies-and-bylaws/plans/christchurch-district-plan/>.

There may be some provisions of the Christchurch City Plan or Banks Peninsula District Plan that affect this property that are still operative.

☎ For planning queries, please phone (03) 941 8999, email DutyPlanner@ccc.govt.nz or visit www.ccc.govt.nz.

- **Regional plan or bylaw**

There may be objectives, policies or rules in a regional plan or a regional bylaw that regulate land use and activities on this site. Please direct enquiries to Canterbury Regional Council (Environment Canterbury).

(a)(i) Christchurch City Plan & Banks Peninsula District Plan

(ii) Christchurch District Plan

- **Christchurch International Airport Protection Sfc.**

Property or part of property within the Christchurch International Airport Protection Surfaces overlay, which is operative.

- **Precinct**

Property or part of property within the Town Centre Intensification Precinct precinct, which has been publicly notified

- **District Plan Zone**

Property or part of property within the High density residential zone, which is operative.

(b) Resource consents

If there are any land use resource consents issued for this property the Council recommends that you check those resource consents on the property file. There may be conditions attached to those resource consents for the property that are still required to be complied with.

- RMA/1992/1433 - Subdivision Consent
Comp. Title SUBDIVISION - Historical Reference RMA11168
Status: Processing complete
Applied 27/10/1992

Property address:

74 Amyes Road

LIM number: H09355357

Page 13

Christchurch City Council

53 Hereford Street, PO Box 73015
Christchurch 8154, New Zealand
Tel 64 3 941 8999
Fax 64 3 941 8984

www.ccc.govt.nz

9. Other land and building classifications

Section 44A(2)(g) LGOIMA. This is information notified to the Council by any statutory organisation having the power to classify land or buildings for any purpose.

 For land and building enquiries, please phone (03) 941 8999 or visit www.ccc.govt.nz.

Please refer to Section 1 for details

Property address:

74 Amyes Road

LIM number: H09355357

Page 14

Christchurch City Council

53 Hereford Street, PO Box 73015
Christchurch 8154, New Zealand
Tel 64 3 941 8999
Fax 64 3 941 8984

www.ccc.govt.nz

10. Network utility information

Section 44A(2)(h) LGOIMA. This is information notified to the Council by any network utility operator pursuant to the Building Act 1991 or the Building Act 2004.

 For network enquiries, please phone (03) 941 8999 or visit www.ccc.govt.nz.

- **None recorded for this property**

11. Other information

Section 44A(3) LGOIMA. This is information concerning the land that the Council has the discretion to include if it considers it to be relevant.

☎ For any enquiries, please phone (03) 941 8999 or visit www.ccc.govt.nz.

(a) Kerbside waste collection

- Your organics are collected Weekly on Thursday. Please leave your organics at the Kerbside by 6:00 a.m.
- Your recycling is collected Fortnightly on the Week 1 collection cycle on a Thursday. Please leave your recycling at the Kerbside by 6:00 a.m. Your nearest recycling depot is the Parkhouse Road EcoDrop.
- Your refuse is collected Fortnightly on the Week 1 collection cycle on a Thursday. Please leave your rubbish at the Kerbside by 6:00 a.m. Your nearest rubbish depot is the Parkhouse Road EcoDrop.

(b) Other

• Floor Levels Information

Council holds a variety of information on requirements for building or property development. This includes:

- required minimum finished floor levels, which need to be set to meet the surface water requirements in clause E1.3.2 of the Building Code (where this applies); and
- the requirements of the Christchurch District Plan (where a property is in the Flood Management Area).

Where this information has been processed for your property, you can view it online at <https://ccc.govt.nz/flooding-and-floor-levels>.

Otherwise, if you are building or developing on this land, you can request a calculation on required finished floor levels for your proposed building by emailing us at floorlevels@ccc.govt.nz.

• Guest Accommodation

Guest accommodation (including whole unit listings on Airbnb; BookaBach; etc.) generally requires a resource consent in this zone when the owner is not residing on the site. For more information, please refer to: <https://ccc.govt.nz/providing-guest-accommodation/>.

• Community Board

Property located in Halswell-Hornby-Riccarton Community Board.

• Tsunami Evacuation Zone

This property is not in a tsunami evacuation zone. It is not necessary to evacuate in a long or strong earthquake or during an official Civil Defence tsunami warning. Residents may wish to offer to open their home to family or friends who need to evacuate from a tsunami zone, and should plan with potential guests to do so in advance. More information can be found at <https://ccc.govt.nz/services/civil-defence/hazards/tsunami-evacuation-zones-and-routes/>

• Electoral Ward

Property located in Hornby Electoral Ward

• Listed Land Use Register

Hazardous activities and industries involve the use, storage or disposal of hazardous substances. These substances can sometimes contaminate the soil. Environment Canterbury identifies land that is used or has been used for hazardous activities and industries. This information is held on a publically available database called the Listed Land Use Register (LLUR). The Christchurch City Council may not hold information that is held on the LLUR. Therefore, it is recommended that you check Environment Canterbury's online database at www.llur.ecan.govt.nz

Property address:

74 Amyes Road

LIM number: H09355357

Page 16

Christchurch City Council

53 Hereford Street, PO Box 73015
Christchurch 8154, New Zealand
Tel 64 3 941 8999
Fax 64 3 941 8984

www.ccc.govt.nz

- **Spatial Query Report**

A copy of the spatial query report is attached at the end of this LIM. The spatial query report lists land use resource consents that have been granted within 100 metres of this property.

Property address:

74 Amyes Road

LIM number: H09355357

Page 17

Christchurch City Council

53 Hereford Street, PO Box 73015

Christchurch 8154, New Zealand

Tel 64 3 941 8999

Fax 64 3 941 8984

www.ccc.govt.nz

• WvInletDrainFieldNot	-- Out of Service	-- Proposed
• WvPump	WwLaternal (non CCC)	SwLaternal (non CCC)
WvAccess	-- In Service	-- In Service
Type	--	--
● Flush Manhole	-- Removed	-- Removed
● Flushing Point	-- Out of Service	-- Out of Service
● Trap	-- Proposed	WvPump
● Inspection Point	• SwFacilityDrainFieldNot	WvValve
● Street Manhole	WwNonNominationType	WwNonnominationType
● Standard Manhole	SwSelflyDischargePoint	● Air Release
● Vacuum Storage	SwAccess	● Backflow Prevention
● Manhole	SwValve	● Butterfly
● ● Street Manhole	Type	● Meter
● WvValve	● Check	● Non Return
▲ WvWell	● Duck Bill	● Pressure Activated
● WvWpSeparator	● Gate	● Sluice
● WwVacPressureBurstingC	● Flap	● Sluice, Normally
● WwVacPressureCheckV	● Check Check	● Closed
● WwVacPressureTankSysT	● Valve	● Valve
● WwOutfall	● Sluice	● WvDrydrain
▲ WvWpRestraint	SwHeadwall	● Walnet
WwFitting	WwConnection	Type
Type	Type	Type
● Change	● U-flet	● File
● End Cap	● SwFlowRestriction	● Restrictor
● Junction	SwGrill	● T-jcty
WwJwy	● Meter	● WwOutlet
Type	● Inlet	● WvWpRestraint
● Eye	● Outlet	● WvFieldNote
● Eye (Vertical)	SwSet	
WwLaternalFitting	Type	WwFitting
Type	Type	Type
● Raised Inspection	● Single Sump	● Bellows
● Point	● Dome Sump	● End Cap
● Lateral Fitting	● Double Sump	● Connector
● WwVacuumBreaker	● Triple Sump	● WvWpProtection
WwVacuumChamber	● Inlet	WvWp
Type	● Gross Debris Trp	NominalDiameter
● Collector	● Split Trap	Diameter is 110mm or smaller
● Interceptor Tank	● SwOutlet	Diameter is greater than 110mm, up to 225mm
● Riser	▲ SwWpRestraint	● 225mm
WwVacuumBreatherPipe	SwSewage	Diameter is greater than 225mm
→ WvWpFlowDirection	● Change	● Other (non-circular pipes)
WvWpBlockageCount	● Bend	● Other (non-circulr pipes) Potable
NumOfBlockages	● Tee	NominalDiameter
● 2 or less Blockages	● End Cap	Diameter is 110mm or smaller
● 3 or more Blockages	● Sweye	Diameter is greater than 110mm, up to 225mm
WvPipe	→ SwWpFlowDirection	Diameter is 110mm or smaller
NominalDiameter	SwLaternalFitting	Diameter is greater than 110mm, up to 225mm
Diameter is 200mm or smaller	Type	Type
Diameter is greater than 200mm, up to 450mm	● Single Sump	● Double Sump
Diameter is greater than 450mm	● Inspection Point	● Manhole
Diameter is greater than 750mm	● Laternal Fitting	● Soak Pit
Other (non-circular pipes)	SwPipe	WwStructure
NominalDiameter	NominalDiameter	WwReservoir
Diameter is 200mm or smaller	Diameter is 450mm or smaller	WwStation
Diameter is greater than 200mm, up to 450mm	Diameter is greater than 450mm, up to 750mm	WvPipe (non CCC)
Diameter is greater than 450mm	Diameter is greater than 750mm	In Service
Other (non-circular pipes)	Other (non-circular pipes)	Unknown
WvLateral	SwLateral	WwPipe (non CCC)
WvWpProtection	SwWpProtection	In Service
SwWpStructure	SwFacility	Abandoned
WwStructure	SwStructure	Out of Service
WwWpungStationCatchme	SwRainStation	Proposed
WvPipe (non CCC)	SwPipe (non CCC)	● BGConnector
In Service	In Service	● BGEndCap
Abandoned	Abandoned	● BGValve
Removed	Out of Service	● BGPipe

Christchurch
City Council

ph: 03 941 8999 web: ccc.govt.nz

Accuracy not guaranteed. Onsite verification required.
Display of data scale dependent.
Client selected legend.
Copyright © 2025 Reproduction prohibited.

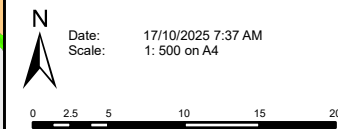

XX1

245

$d1 = \frac{3}{2}$
81

400

REPAIR
30-B-77 IP

74.7L
90

No



Accepted

DPF62609



127875

MVC

74 Amyes Road Land Use Consents

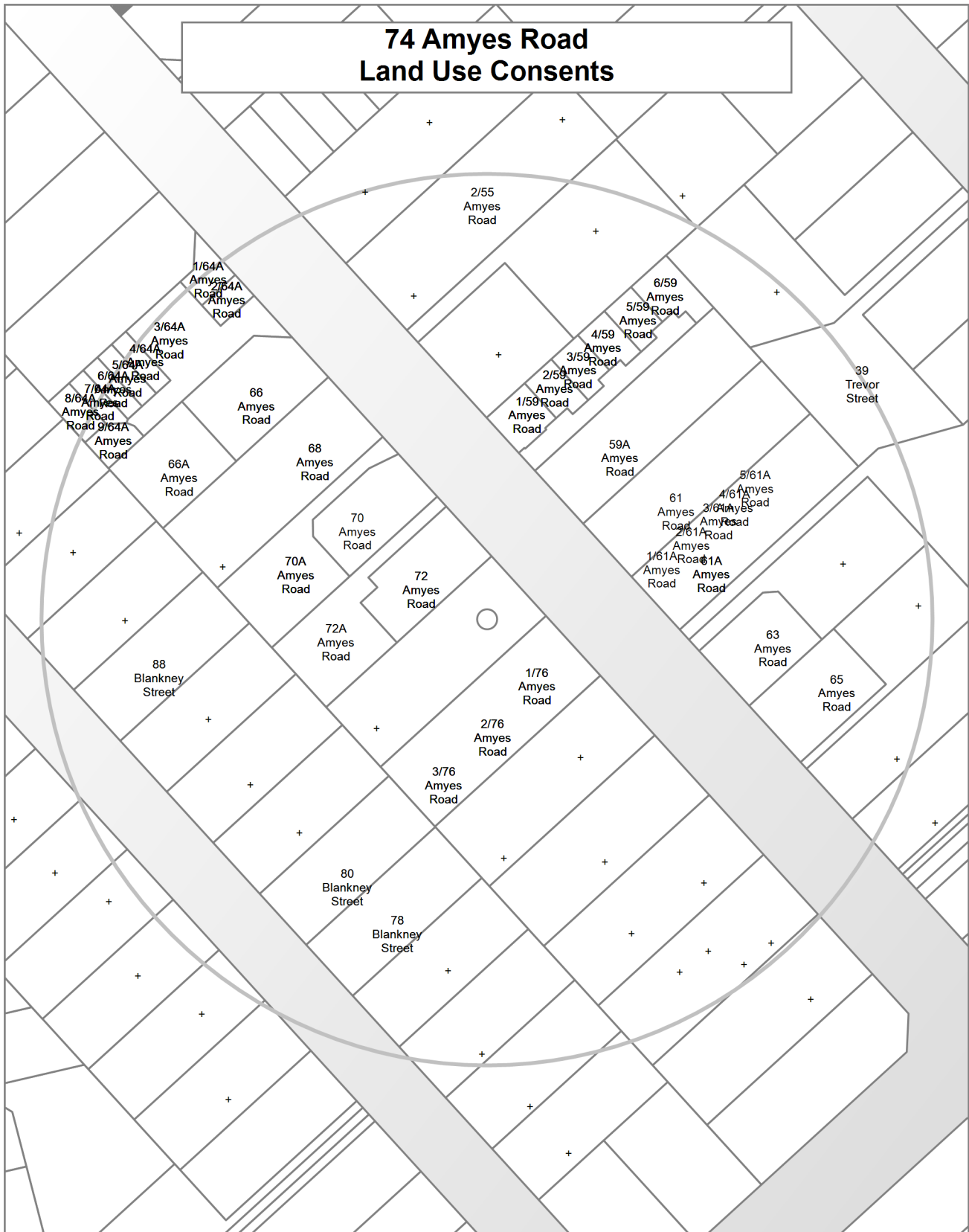

**74 Amyes Road
Subdivision Consents**



Land Use Resource Consents within 100 metres of 74 Amyes Road

Note: This list does not include subdivision Consents and Certificates of Compliance issued under the Resource Management Act.

1/59 Amyes Road

RMA/2022/352

To build six residential units on the site, with associated car parking and landscaping

Processing complete

Applied 11/02/2022

Decision issued 14/06/2022

Granted 13/06/2022

RMA/2022/3862

Subdivision - Fee Simple - Six lots with Land Use

Processing complete

Applied 16/12/2022

s223 Certificate issued 16/11/2023

s224 Certificate issued 16/11/2023

Decision issued 17/02/2023

Granted 16/02/2023

1/61A Amyes Road

RMA/2019/2002

To Construct Five Residential Units with Associated Car Paking and Landscaping

Withdrawn

Applied 30/08/2019

1/64A Amyes Road

RMA/1983/4

Consent to build the upstairs addition in accordance with the plans - Historical Reference RES9200222

Processing complete

Applied 25/03/1983

Decision issued 01/01/1999

Declined 01/01/1999

RMA/2022/921

Construct nine townhouses

Processing complete

Applied 29/03/2022

Conditions changed/cancelled - s127 05/09/2023

Decision issued 09/11/2022

Granted 09/11/2022

RMA/2024/2704

Nine lot fee simple subdivision

Processing complete

Applied 24/09/2024

s223 Certificate issued 15/05/2025

s224 Certificate issued 15/05/2025

Decision issued 12/11/2024

Granted 12/11/2024

1/76 Amyes Road

RMA/2015/1042

Three EHP Units With Attached Garages - Historical Reference RMA92029289

Processing complete

Applied 20/04/2015

Decision issued 01/05/2015

Granted 01/05/2015

RMA/2017/1348

To change three EPH units into multi-unit residential complex

Processing complete

Applied 14/06/2017

Decision issued 04/07/2017

Granted 04/07/2017

2/55 Amyes Road

RMA/2003/2704

Application to construct a conservatory - Historical Reference RMA20015039

Processing complete

Applied 14/10/2003

Decision issued 04/11/2003

Granted 04/11/2003

2/59 Amyes Road

RMA/2022/352

To build six residential units on the site, with associated car parking and landscaping

Processing complete

Applied 11/02/2022

Decision issued 14/06/2022

Granted 13/06/2022

RMA/2022/3862

Subdivision - Fee Simple - Six lots with Land Use

Processing complete

Applied 16/12/2022

s223 Certificate issued 16/11/2023

s224 Certificate issued 16/11/2023

Decision issued 17/02/2023

Granted 16/02/2023

2/61A Amyes Road

RMA/2019/2002

To Construct Five Residential Units with Associated Car Paking and Landscaping

Withdrawn

Applied 30/08/2019

2/64A Amyes Road

RMA/1983/4

Consent to build the upstairs addition in accordance with the plans - Historical Reference RES9200222

Processing complete

Applied 25/03/1983

Decision issued 01/01/1999

Declined 01/01/1999

RMA/2022/921

Construct nine townhouses

Processing complete

Applied 29/03/2022

Conditions changed/cancelled - s127 05/09/2023

Decision issued 09/11/2022

Granted 09/11/2022

RMA/2024/2704

Nine lot fee simple subdivision

Processing complete

Applied 24/09/2024

s223 Certificate issued 15/05/2025

s224 Certificate issued 15/05/2025

Decision issued 12/11/2024

Granted 12/11/2024

2/76 Amyes Road

RMA/2015/1042

Three EHP Units With Attached Garages - Historical Reference RMA92029289

Processing complete

Applied 20/04/2015

Decision issued 01/05/2015

Granted 01/05/2015

RMA/2017/1348

To change three EPH units into multi-unit residential complex

Processing complete

Applied 14/06/2017

Decision issued 04/07/2017

Granted 04/07/2017

3/59 Amyes Road

RMA/2022/352

To build six residential units on the site, with associated car parking and landscaping

Processing complete

Applied 11/02/2022

Decision issued 14/06/2022

Granted 13/06/2022

RMA/2022/3862

Subdivision - Fee Simple - Six lots with Land Use

Processing complete

Applied 16/12/2022

s223 Certificate issued 16/11/2023

s224 Certificate issued 16/11/2023

Decision issued 17/02/2023

Granted 16/02/2023

3/61A Amyes Road

RMA/2019/2002

To Construct Five Residential Units with Associated Car Paking and Landscaping

Withdrawn

Applied 30/08/2019

3/64A Amyes Road

RMA/1983/4

Consent to build the upstairs addition in accordance with the plans - Historical Reference RES9200222

Processing complete

Applied 25/03/1983

Decision issued 01/01/1999

Declined 01/01/1999

RMA/2022/921

Construct nine townhouses

Processing complete

Applied 29/03/2022

Conditions changed/cancelled - s127 05/09/2023

Decision issued 09/11/2022

Granted 09/11/2022

RMA/2024/2704

Nine lot fee simple subdivision

Processing complete

Applied 24/09/2024

s223 Certificate issued 15/05/2025

s224 Certificate issued 15/05/2025

Decision issued 12/11/2024

Granted 12/11/2024

3/76 Amyes Road

RMA/2015/1042

Three EHP Units With Attached Garages - Historical Reference RMA92029289

Processing complete

Applied 20/04/2015

Decision issued 01/05/2015

Granted 01/05/2015

RMA/2017/1348

To change three EPH units into multi-unit residential complex

Processing complete

Applied 14/06/2017

Decision issued 04/07/2017

Granted 04/07/2017

39 Trevor Street

RMA/2013/50

DWELLING EXTENSION - Historical Reference RMA92021625

Processing complete

Applied 17/01/2013

Decision issued 20/03/2013

Granted 20/03/2013

4/59 Amyes Road

RMA/2022/352

To build six residential units on the site, with associated car parking and landscaping

Processing complete

Applied 11/02/2022

Decision issued 14/06/2022

Granted 13/06/2022

RMA/2022/3862

Subdivision - Fee Simple - Six lots with Land Use

Processing complete

Applied 16/12/2022

s223 Certificate issued 16/11/2023

s224 Certificate issued 16/11/2023

Decision issued 17/02/2023

Granted 16/02/2023

4/61A Amyes Road

RMA/2019/2002

To Construct Five Residential Units with Associated Car Paking and Landscaping

Withdrawn

Applied 30/08/2019

4/64A Amyes Road

RMA/1983/4

Consent to build the upstairs addition in accordance with the plans - Historical Reference RES9200222

Processing complete

Applied 25/03/1983

Decision issued 01/01/1999

Declined 01/01/1999

RMA/2022/921

Construct nine townhouses

Processing complete

Applied 29/03/2022

Conditions changed/cancelled - s127 05/09/2023

Decision issued 09/11/2022

Granted 09/11/2022

RMA/2024/2704

Nine lot fee simple subdivision

Processing complete

Applied 24/09/2024

s223 Certificate issued 15/05/2025

s224 Certificate issued 15/05/2025

Decision issued 12/11/2024

Granted 12/11/2024

5/59 Amyes Road

RMA/2022/352

To build six residential units on the site, with associated car parking and landscaping

Processing complete

Applied 11/02/2022

Decision issued 14/06/2022

Granted 13/06/2022

RMA/2022/3862

Subdivision - Fee Simple - Six lots with Land Use

Processing complete

Applied 16/12/2022

s223 Certificate issued 16/11/2023

s224 Certificate issued 16/11/2023

Decision issued 17/02/2023

Granted 16/02/2023

5/61A Amyes Road

RMA/2019/2002

To Construct Five Residential Units with Associated Car Paking and Landscaping

Withdrawn

Applied 30/08/2019

5/64A Amyes Road

RMA/1983/4

Consent to build the upstairs addition in accordance with the plans - Historical Reference RES9200222

Processing complete

Applied 25/03/1983

Decision issued 01/01/1999

Declined 01/01/1999

RMA/2022/921

Construct nine townhouses

Processing complete

Applied 29/03/2022

Conditions changed/cancelled - s127 05/09/2023

Decision issued 09/11/2022

Granted 09/11/2022

RMA/2024/2704

Nine lot fee simple subdivision

Processing complete

Applied 24/09/2024

s223 Certificate issued 15/05/2025

s224 Certificate issued 15/05/2025

Decision issued 12/11/2024

Granted 12/11/2024

59A Amyes Road

RMA/2011/357

FAMILY FLAT AND DOUBLE GARAGE - Historical Reference RMA92017883

Processing complete

Applied 11/04/2011

Decision issued 04/08/2011

Granted 04/08/2011

6/59 Amyes Road

RMA/2022/352

To build six residential units on the site, with associated car parking and landscaping

Processing complete

Applied 11/02/2022

Decision issued 14/06/2022

Granted 13/06/2022

RMA/2022/3862

Subdivision - Fee Simple - Six lots with Land Use

Processing complete

Applied 16/12/2022

s223 Certificate issued 16/11/2023

s224 Certificate issued 16/11/2023

Decision issued 17/02/2023

Granted 16/02/2023

6/64A Amyes Road

RMA/1983/4

Consent to build the upstairs addition in accordance with the plans - Historical Reference RES9200222

Processing complete

Applied 25/03/1983

Decision issued 01/01/1999

Declined 01/01/1999

RMA/2022/921

Construct nine townhouses

Processing complete

Applied 29/03/2022

Conditions changed/cancelled - s127 05/09/2023

Decision issued 09/11/2022

Granted 09/11/2022

RMA/2024/2704

Nine lot fee simple subdivision

Processing complete

Applied 24/09/2024

s223 Certificate issued 15/05/2025

s224 Certificate issued 15/05/2025

Decision issued 12/11/2024

Granted 12/11/2024

61 Amyes Road

RMA/2025/3141

Multi-unit residential complex (7 units)Residential Pathway A

Processing

Applied 12/09/2025

61A Amyes Road

RMA/2019/2002

To Construct Five Residential Units with Associated Car Paking and Landscaping

Withdrawn

Applied 30/08/2019

RMA/2020/776

To construct two units with associated landscaping, car parking and earthworks.

Processing complete

Applied 15/04/2020

Decision issued 18/08/2020

Granted 18/08/2020

RMA/2025/1933

Construct SIX (6) residential units and associated earthworksResidential Pathway A

On hold - waiting for response from applicant

Applied 23/06/2025

63 Amyes Road

RMA/1996/1267

Application for site coverage of Flat 1 to exceed 35% (37.15% proposed), reduced rear boundary of 1m (1.8m required) and site area not meetin - Historical Reference RES961476

Processing complete

Applied 13/06/1996

Decision issued 10/07/1996

Granted 10/07/1996

65 Amyes Road

RMA/1996/1220

Application to erect a garage in the front yard at 2m from the front boundary in terms of the Proposed District Plan. - Historical Reference RES961423

Processing complete

Applied 07/06/1996

Decision issued 12/08/1996

Granted 12/08/1996

66 Amyes Road

RMA/1997/1862

A two Lot subdivisions which does not comply with site area or access width under the Paparua Transitional Plan. - Historical Reference RES972096

Processing complete

Applied 05/08/1997

Decision issued 23/10/1997

Granted 23/10/1997

RMA/1997/1992

Application to locate a garage within the front 4.5m setback from the road boundary in terms of the Proposed District Plan - Flat 1 - Historical Reference RES972264

Withdrawn

Applied 19/08/1997

RMA/1998/442

Application to erect a garage within the front 4.5m road boundary setback under Proposed Plan. Garage intrudes 5.5m setback from row and 90percentile car is unable to access the garage in one movement both under both plans. - Historical Reference RES980405

Processing complete

Applied 17/02/1998

Decision issued 27/02/1998

Granted 27/02/1998

66A Amyes Road

RMA/1997/1862

A two Lot subdivisions which does not comply with site area or access width under the Paparua Transitional Plan. - Historical Reference RES972096

Processing complete

Applied 05/08/1997

Decision issued 23/10/1997

Granted 23/10/1997

68 Amyes Road

RMA/1990/9

Erect double garage - Historical Reference RES9200223

Processing complete

Applied 23/05/1990

Decision issued 22/08/1990

Granted 22/08/1990

RMA/1990/987

Two vehicle crossings on a site with a frontage less than 20m - Historical Reference RES94001381

Processing complete

Applied 23/05/1990

Decision issued 30/05/1990

Granted 30/05/1990

7/64A Amyes Road

RMA/1983/4

Consent to build the upstairs addition in accordance with the plans - Historical Reference RES9200222

Processing complete

Applied 25/03/1983

Decision issued 01/01/1999

Declined 01/01/1999

RMA/2022/921

Construct nine townhouses

Processing complete

Applied 29/03/2022

Conditions changed/cancelled - s127 05/09/2023

Decision issued 09/11/2022

Granted 09/11/2022

RMA/2024/2704

Nine lot fee simple subdivision

Processing complete

Applied 24/09/2024

s223 Certificate issued 15/05/2025

s224 Certificate issued 15/05/2025

Decision issued 12/11/2024

Granted 12/11/2024

70 Amyes Road

RMA/2017/14

Wastewater Capacity Certificate

Processing complete

Applied 10/01/2017

Certificate issued 12/01/2017

70A Amyes Road

RMA/2017/14

Wastewater Capacity Certificate

Processing complete

Applied 10/01/2017

Certificate issued 12/01/2017

RMA/2017/171

Fee simple subdivision - 2 LotsLT 513560

Processing complete

Applied 31/01/2017

s223 Certificate issued 11/10/2018

s224 Certificate issued 11/10/2018

Decision issued 11/08/2017

Granted 10/08/2017

72 Amyes Road

RMA/2006/2082

Application to erect a garage for the existing dwelling and new dwelling for the proposed rear site - Historical Reference RMA92006161

Processing complete

Applied 04/09/2006

Decision issued 17/05/2007

Granted 17/05/2007

RMA/2008/923

Application for a two unit development with a reduced setback of the existing dwelling from the access way (not addressed in RMA 92006161) - Historical Reference RMA92011739

Processing complete

Applied 07/05/2008

Decision issued 28/05/2008

Granted 28/05/2008

72A Amyes Road

RMA/2006/2082

Application to erect a garage for the existing dwelling and new dwelling for the proposed rear site - Historical Reference RMA92006161

Processing complete

Applied 04/09/2006

Decision issued 17/05/2007

Granted 17/05/2007

78 Blankney Street

RMA/1997/372

Application for a garage to exceed the 9m maximum length for an accessory building within 1.8m of the boundary in terms of both the Transitional and Proposed District plans. - Historical Reference RES970317

Processing complete

Applied 07/02/1997

Decision issued 07/03/1997

Granted 07/03/1997

8/64A Amyes Road

RMA/1983/4

Consent to build the upstairs addition in accordance with the plans - Historical Reference RES9200222

Processing complete

Applied 25/03/1983

Decision issued 01/01/1999

Declined 01/01/1999

RMA/2022/921

Construct nine townhouses

Processing complete

Applied 29/03/2022

Conditions changed/cancelled - s127 05/09/2023

Decision issued 09/11/2022

Granted 09/11/2022

RMA/2024/2704

Nine lot fee simple subdivision

Processing complete

Applied 24/09/2024

s223 Certificate issued 15/05/2025

s224 Certificate issued 15/05/2025

Decision issued 12/11/2024

Granted 12/11/2024

80 Blankney Street

RMA/1990/59

Consent to erect an oversized garage - Historical Reference RES9200731

Processing complete

Applied 18/12/1990

Decision issued 07/01/1991

Granted 07/01/1991

88 Blankney Street

RMA/1989/43

Consent to site a carport 1.7m from the house - Historical Reference RES9200732

Processing complete

Applied 23/01/1989

Decision issued 01/01/1990

Granted 01/01/1990

9/64A Amyes Road

RMA/1983/4

Consent to build the upstairs addition in accordance with the plans - Historical Reference RES9200222

Processing complete

Applied 25/03/1983

Decision issued 01/01/1999

Declined 01/01/1999

RMA/2022/921

Construct nine townhouses

Processing complete

Applied 29/03/2022

Conditions changed/cancelled - s127 05/09/2023

Decision issued 09/11/2022

Granted 09/11/2022

RMA/2024/2704

Nine lot fee simple subdivision

Processing complete

Applied 24/09/2024

Granted 12/11/2024

s223 Certificate issued 15/05/2025

s224 Certificate issued 15/05/2025

Decision issued 12/11/2024

Data Quality Statement

Land Use Consents

All resource consents are shown for sites that have been labelled with an address. For sites that have been labelled with a cross (+) no resource consents have been found. Sites that have no label have not been checked for resource consents. This will be particularly noticeable on the margins of the search radius. If there are such sites and you would like them included in the check, please ask for the LIM spatial query to be rerun accordingly. This will be done free of charge although there may be a short delay. Resource consents which are on land occupied by roads, railways or rivers are not, and currently cannot be displayed, either on the map or in the list. Resource consents that relate to land that has since been subdivided, will be shown in the list, but not on the map. They will be under the address of the land as it was at the time the resource consent was applied for. Resource consents that are listed as Non-notified and are current, may in fact be notified resource consents that have not yet been through the notification process. If in doubt. Please phone (03)941 8999.

The term “resource consents” in this context means land use consents. Subdivision consents and certificates of compliance are excluded.

Subdivision Consents

All subdivision consents are shown for the sites that have been labelled with consent details. For Sites that have been labelled with a cross (+) no records have been found. Sites that have no label have not been checked for subdivision consents. This will be particularly noticeable on the margins of the search radius. If there are such sites and you would like them included in the check, please ask for the LIM spatial query to be rerun accordingly. This will be done free of charge although there may be a short delay.

The term “subdivision consents” in this context means a resource consent application to subdivide land. Non subdivision land use resource consents and certificates of compliance are excluded.

This report will only record those subdivision applications which have not been completed i.e once a subdivision has been given effect to and the new lots/properties have been established the application which created those lots will not be shown

All subdivision consent information is contained on the map and no separate list is supplied