

Land Information Memorandum



Property address:
37 Sugden Street

LIM number: H09355366

Page 1

Christchurch City Council
53 Hereford Street, PO Box 73015
Christchurch 8154, New Zealand
Tel 64 3 941 8999
Fax 64 3 941 8984

www.ccc.govt.nz

Application details

Date issued 17 October 2025
Date received 8 October 2025

Property details

Property address 37 Sugden Street, Spreydon, Christchurch
Valuation roll number 22640 05701
Valuation information Capital Value: \$560,000
Land Value: \$350,000
Improvements Value: \$210,000
Please note: these values are intended for Rating purposes
Legal description Lot 1 DP 329836
Existing owner KB Associates Limited
58 Hudson Street
RIVERLEA
HAMILTON 3216

Council references

Rate account ID 73111094
LIM number H09355366
Property ID 1136595

Document information

This Land Information Memorandum (LIM) has been prepared for the purpose of section 44A of the Local Government Official Information and Meetings Act 1987 (LGOIMA). It is a summary of the information that we hold on the property. Each heading or "clause" in this LIM corresponds to a part of section 44A.

Sections 1 to 10 contain all of the information known to the Christchurch City Council that must be included under section 44A(2) LGOIMA. Any other information concerning the land as the Council considers, at its discretion, to be relevant is included at section 11 of this LIM (section 44A(3) LGOIMA). If there are no comments or information provided in these sections this means that the Council does not hold information on the property that corresponds to that part of section 44A.

The information included in this LIM is based on a search of Council records only and there may be other information relating to the land which is unknown to the Council. Please note that other agencies may also hold information relevant to the property, or administer legislation relevant to the use of the land, for example, the Regional Council (Ecan), Heritage New Zealand Pouhere Taonga, and Land Information New Zealand.

Council records may not show illegal or unauthorised building or works on the property. The applicant is solely responsible for ensuring that the land is suitable for a particular purpose.

A LIM is only valid at the date of issue as information is based only upon information the Council held at the time of that LIM request being made. It is essential that the applicant undertakes their own due diligence to verify the suitability of the property for their intended use.

Property file service

This Land Information Memorandum does not contain all information held on a property file. Customers may request property files by phoning the Council's Customer Call Centre on (03) 941 8999, or visiting any of the Council Service Centres. For further information please visit www.ccc.govt.nz.

To enable the Council to measure the accuracy of this LIM document based on our current records, we would appreciate your response should you find any information contained therein which may be considered to be incorrect or omitted. Please telephone the Customer Call Centre on (03) 941 8999.

Property address:

37 Sugden Street

LIM number: H09355366

Page 3

Christchurch City Council

53 Hereford Street, PO Box 73015
Christchurch 8154, New Zealand
Tel 64 3 941 8999
Fax 64 3 941 8984

www.ccc.govt.nz

A search of records held by the Council has revealed the following information:

1. Special features and characteristics of the land

Section 44A(2)(a) LGOIMA. This is information known to the Council but not apparent from the district scheme under the Town and Country Planning Act 1977 or a district plan under the Resource Management Act 1991. It identifies each (if any) special feature or characteristic of the land concerned, including but not limited to potential erosion, avulsion, falling debris, subsidence, slippage, alluvion, or inundation, or likely presence of hazardous contaminants.

☎ For enquiries, please phone (03) 941 8999 or visit www.ccc.govt.nz.

Natural Hazards

(a) Coastal Hazards

As at the date of this LIM, Council research found no information under this heading.

(b) Earthquakes

- Liquefaction Assessment

Christchurch City Council holds indicative information on liquefaction hazard for Christchurch. Information on liquefaction, including an interactive web tool, can be found on the Council website at ccc.govt.nz/liquefaction. Depending on the liquefaction potential of the area that the property is in, the Council may require site-specific investigations before granting future subdivision or building consent for the property.

(c) Flooding

As at the date of this LIM, Council research found no information under this heading.

(d) Landslides

As at the date of this LIM, Council research found no information under this heading.

(e) Subsidence

- Consultant Report Available

Land Information New Zealand (LINZ) engaged Tonkin and Taylor to provide a Geotechnical Report on Ground Movements that occurred as a result of the Canterbury Earthquake Sequence. The report indicates this property may have been effected by a degree of earthquake induced subsidence. The report obtained by LINZ can be accessed on their website at <https://www.linz.govt.nz> and search Information for Canterbury Surveyors.

(f) Tsunamis

As at the date of this LIM, Council research found no information under this heading.

(g) Volcanic and Geothermal Hazards

As at the date of this LIM, Council research found no information under this heading.

(h) Wind

As at the date of this LIM, Council research found no information under this heading.

(i) Any Other Natural Hazards

As at the date of this LIM, Council research found no information under this heading.

(j) District Plan Natural Hazard Information

Please refer to *Section 8. Land use and conditions* of this report for District Plan related natural hazard information.

(k) Building Notices

Please refer to *Section 5. Consents, certificates, notices, orders, or requisitions affecting the land and buildings* of this report for Building Act notice information.

Other Special Features or Characteristics of the Land

As at the date of this LIM, Council research found no information under this heading.

Property address:

37 Sugden Street

LIM number: H09355366

Page 5

Christchurch City Council

53 Hereford Street, PO Box 73015
Christchurch 8154, New Zealand
Tel 64 3 941 8999
Fax 64 3 941 8984

www.ccc.govt.nz

2. Private and public stormwater and sewerage drains

Section 44A(2)(b) LGOIMA. This is information about private and public stormwater and sewerage drains as shown in the Council's records.

 For stormwater and sewerage enquiries, please phone (03) 941 8999 or visit www.ccc.govt.nz.

Related Information

- This property is shown to be served by Christchurch City Council Sewer.
- The council plan shows no public stormwater lateral to this site.
- Attached are all drainage plans that Council hold for details of private and public drainage. Not all plans provided are verified by Council, and therefore Council cannot be liable for inaccuracies. Site investigation will be required by owners to determine exact layouts.

3. Drinking Water Supply

Section 44A(2)(ba) and (bb) LGOIMA. This is information notified to the Council about whether the land is supplied with drinking water, whether the supplier is the owner of the land or a networked supplier, any conditions that are applicable, and any information the Council has about the supply.

Please note the council does not guarantee a particular water quality to its customers. If you require information on current water quality at this property please contact the Three Waters & Waste Unit.

☎ For water supply queries, please phone (03) 941 8999 or visit www.ccc.govt.nz.

Water supply

Christchurch City Council is the networked supplier of water to this property. This property is connected to the Christchurch City Council Water Supply. The conditions of supply are set out in the Christchurch City Council Water Supply and Wastewater Bylaw (2022), refer to www.ccc.govt.nz.

4. Rates

Section 44A(2)(c) LGOIMA. This is information on any rates owing in relation to the land.

☎ For rates enquiries, please phone (03) 941 8999 or visit www.ccc.govt.nz.

(a) Annual rates

Annual rates to 30/06/2026: \$3,499.14

	Instalment Amount	Date Due
Instalment 1	\$874.72	15/08/2025
Instalment 2	\$874.72	15/11/2025
Instalment 3	\$874.72	15/02/2026
Instalment 4	\$874.98	15/05/2026

Rates owing as at 17/10/2025: \$594.75

(b) Excess Water Rates

For excess water charge enquiries, please phone (03) 941 8999 or visit www.ccc.govt.nz/contact-us.

(c) Final water meter reading required at settlement?

Property settlements must ensure all water usage and outstanding debts are accurately accounted for.

To advise of a property settlement, please complete the request for settlement information form at www.ccc.govt.nz/services/rates-and-valuations/solicitors-request.

A settlement statement of accounts will be provided on the expected settlement date advised.

5. Consents, certificates, notices, orders, or requisitions affecting the land and buildings

Section 44A(2)(d) LGOIMA. This is information concerning any consent, certificate, notice, order, or requisition, affecting the land or any building on the land, previously issued by the Council. The information in this section may also cover building consent and/or code compliance information issued by building certifiers under the Building Act 1991 and building consent authorities that are not the Council under the Building Act 2004.

You can check the property file to identify whether any consent or certificate was issued by a building certifier under the Building Act 1991.

Section 44A(2)(da) LGOIMA. The information required to be provided to a territorial authority under section 362T(2) of the Building Act 2004. There is currently no information required to be provided by a building contractor to a territorial authority under section 362T(2) of the Building Act 2004. The Building (Residential Consumer Rights and Remedies) Regulations 2014 only prescribed the information that must be given to the clients of a building contractor.

Sections 71 to 74 of the Building Act 2004 require the Building Consent Authority to consider natural hazards when it receives a building consent application for the construction or major alteration of a building on land that is subject to, or likely to be subject to, a natural hazard. A building consent for this property may have been issued subject to a section 72 or 73 notice. This means at the time of building consent the Building Consent Authority was not satisfied that adequate provision would be made to protect the building and land from the natural hazard and was subsequently required to notify the Registrar-General of Land to record the natural hazard on the Record of Title. The Building Act 2004 defines natural hazards as erosion (including coastal erosion, bank erosion, and sheet erosion), falling debris (including soil, rock, snow, and ice), subsidence, inundation (including flooding, overland flow, storm surge, tidal effects, and ponding), and slippage.

If your property contains a notice under s73 of the Building Act 2004, this will be identified on the building consent decision below (decision under s72 of the Building Act 2004) and on the properties' Record of Title. The Record of Title may also record this as a s36 notice under the Building Act 1991, or a s641A notice under the Local Government Act 1974.

☎ For building enquiries, please phone (03) 941 8999, email EPADutyBCO@ccc.govt.nz or visit www.ccc.govt.nz.

(a) Consents

- BCN/1968/5151 Applied: 21/10/1968 Status: Completed
37 Sugden Street Spreydon
Permit granted 22/10/1968
Permit issued 04/11/1968
STUCCO DWELLING- Historical Reference PER68900974
- BCN/1988/4300 Applied: 21/06/1988 Status: Completed
37 Sugden Street Spreydon
Permit granted 05/07/1988
Permit issued 05/07/1988
WOODSMAN INBUILT LOGFIRE - WETBACK- Historical Reference PER88901120
- BCN/1988/4701 Applied: 06/07/1988 Status: Completed
37 Sugden Street Spreydon
Permit granted 06/07/1988
Permit issued 06/07/1988
PLUMBING WATER SUPPLY TO WETBACK HEATER- Historical Reference PER88000075
- BCN/2003/9414 Applied: 11/11/2003 Status: Completed
37 Sugden Street Spreydon
Accepted for processing 11/11/2003
Building consent granted 25/11/2003
Building consent issued 25/11/2003
PIM Granted 25/11/2003
PIM Issued 25/11/2003

Property address:

37 Sugden Street

LIM number: H09355366

Page 9

Christchurch City Council

53 Hereford Street, PO Box 73015
Christchurch 8154, New Zealand
Tel 64 3 941 8999
Fax 64 3 941 8984

www.ccc.govt.nz

Code Compliance Certificate Granted 05/03/2004

Code Compliance Certificate Issued 05/03/2004

DRAINAGE- Historical Reference ABA10040514

- BCN/2005/4708 Applied: 20/06/2005 Status: Completed
37 Sugden Street Spreydon
Accepted for processing 20/06/2005
PIM Granted 11/07/2005
PIM Issued 11/07/2005
Building consent granted 22/07/2005
Building consent issued 22/07/2005
Code Compliance Certificate Granted 24/07/2007
Code Compliance Certificate Issued 24/07/2007
RELOCATED GARAGE - UNLINED- Historical Reference ABA10056368
- BCN/2010/7142 Applied: 18/08/2010 Status: Lapsed
37 Sugden Street Spreydon
Accepted for processing 18/08/2010
Building consent granted 30/08/2010
Building consent issued 30/08/2010
PIM Granted 30/08/2010
PIM Issued 30/08/2010
Building consent lapsed 18/12/2012
METRO ECO SMART INBUILT WETBACK WOODBURNER CAC 102426- Historical Reference ABA10106343
- BCN/2011/6221 Applied: 27/04/2011 Status: Cancelled
37 Sugden Street Spreydon

Application for exemption from Building Consent for Log Burner / CLM/2011/065025
- Historical Reference BAE35003345

(b) Certificates

Note: Code Compliance Certificates were only issued by the Christchurch City Council since January 1993.

(c) Notices

(d) Orders

(e) Requisitions

Related Information

- Council holds no record of building permit/consent for dwelling at this address. No information is held by Council relating to the materials, construction or year the dwelling was built.

Property address:

37 Sugden Street

LIM number: H09355366

6. Certificates issued by a building certifier

Section 44A(2)(e) LGOIMA. This is information notified to the Council concerning any certificate issued by a building certifier pursuant to the Building Act 1991 or the Building Act 2004.

☎ For building enquiries, please phone (03) 941 8999, email EPADutyBCO@ccc.govt.nz or visit www.ccc.govt.nz.

Property address:

37 Sugden Street

LIM number: H09355366

Page 11

Christchurch City Council

53 Hereford Street, PO Box 73015
Christchurch 8154, New Zealand
Tel 64 3 941 8999
Fax 64 3 941 8984

www.ccc.govt.nz

7. Weathertightness

Section 44A(2)(ea) LGOIMA. This is information notified to the Council under section 124 of the Weathertight Homes Resolution Services Act 2006.

 For weathertight homes enquiries, please phone (03) 941 8999 or visit www.ccc.govt.nz.

If there is no information below this means Council is unaware of any formal Weathertight Homes Resolution Services claim lodged against this property.

Property address:

37 Sugden Street

LIM number: H09355366

Page 12

Christchurch City Council

53 Hereford Street, PO Box 73015
Christchurch 8154, New Zealand
Tel 64 3 941 8999
Fax 64 3 941 8984

www.ccc.govt.nz

8. Land use and conditions

Section 44A(2)(f) LGOIMA. This is information relating to the use to which the land may be put and conditions attached to that use. The planning information provided below is not exhaustive and reference to the Christchurch District Plan and any notified proposed changes to that plan is recommended: <https://ccc.govt.nz/the-council/plans-strategies-policies-and-bylaws/plans/christchurch-district-plan/>.

There may be some provisions of the Christchurch City Plan or Banks Peninsula District Plan that affect this property that are still operative.

☎ For planning queries, please phone (03) 941 8999, email DutyPlanner@ccc.govt.nz or visit www.ccc.govt.nz.

- **Regional plan or bylaw**

There may be objectives, policies or rules in a regional plan or a regional bylaw that regulate land use and activities on this site. Please direct enquiries to Canterbury Regional Council (Environment Canterbury).

(a)(i) Christchurch City Plan & Banks Peninsula District Plan

(ii) Christchurch District Plan

- **Christchurch International Airport Protection Sfc.**

Property or part of property within the Christchurch International Airport Protection Surfaces overlay, which is operative.

- **Liquefaction Management Area (LMA)**

Property or part of property within the Liquefaction Management Area (LMA) Overlay, which is operative.

- **District Plan Zone**

Property or part of property within the Medium density residential zone, which is operative.

(b) Resource consents

If there are any land use resource consents issued for this property the Council recommends that you check those resource consents on the property file. There may be conditions attached to those resource consents for the property that are still required to be complied with.

- **RMA/2003/2829 - Subdivision Consent**

FEE SIMPLE SUBDIVISION - 2 LOTS 223 received 22/12/03 Issued 23/12/03 224 requested 30/3/04 Issued 31/3/04 DP 329836 - Historical Reference RMA20015166

Status: Processing complete

Applied 23/10/2003

Granted 26/11/2003

Decision issued 26/11/2003

- **RMA/2005/1383 - Land Use Consent**

37 Sugden Street Spreydon

Application to erect a double garage within the front yard - Historical Reference RMA20020241

Status: Processing complete

Applied 20/06/2005

Granted 29/09/2005

Property address:

37 Sugden Street

LIM number: H09355366

Page 13

Christchurch City Council

53 Hereford Street, PO Box 73015

Christchurch 8154, New Zealand

Tel 64 3 941 8999

Fax 64 3 941 8984

www.ccc.govt.nz

Land Information Memorandum

Decision issued 29/09/2005

Property address:
37 Sugden Street

LIM number: H09355366

Page 14

Christchurch City Council
53 Hereford Street, PO Box 73015
Christchurch 8154, New Zealand
Tel 64 3 941 8999
Fax 64 3 941 8984

www.ccc.govt.nz

9. Other land and building classifications

Section 44A(2)(g) LGOIMA. This is information notified to the Council by any statutory organisation having the power to classify land or buildings for any purpose.

 For land and building enquiries, please phone (03) 941 8999 or visit www.ccc.govt.nz.

Please refer to Section 1 for details

10. Network utility information

Section 44A(2)(h) LGOIMA. This is information notified to the Council by any network utility operator pursuant to the Building Act 1991 or the Building Act 2004.

 For network enquiries, please phone (03) 941 8999 or visit www.ccc.govt.nz.

- **None recorded for this property**

11. Other information

Section 44A(3) LGOIMA. This is information concerning the land that the Council has the discretion to include if it considers it to be relevant.

☎ For any enquiries, please phone (03) 941 8999 or visit www.ccc.govt.nz.

(a) Kerbside waste collection

- Your organics are collected Weekly on Tuesday. Please leave your organics at the Kerbside by 6:00 a.m.
- Your recycling is collected Fortnightly on the Week 1 collection cycle on a Tuesday. Please leave your recycling at the Kerbside by 6:00 a.m. Your nearest recycling depot is the Parkhouse Road EcoDrop.
- Your refuse is collected Fortnightly on the Week 1 collection cycle on a Tuesday. Please leave your rubbish at the Kerbside by 6:00 a.m. Your nearest rubbish depot is the Parkhouse Road EcoDrop.

(b) Other

• Floor Levels Information

Council holds a variety of information on requirements for building or property development. This includes:

- required minimum finished floor levels, which need to be set to meet the surface water requirements in clause E1.3.2 of the Building Code (where this applies); and
- the requirements of the Christchurch District Plan (where a property is in the Flood Management Area).

Where this information has been processed for your property, you can view it online at <https://ccc.govt.nz/flooding-and-floor-levels>.

Otherwise, if you are building or developing on this land, you can request a calculation on required finished floor levels for your proposed building by emailing us at floorlevels@ccc.govt.nz.

• Guest Accommodation

Guest accommodation (including whole unit listings on Airbnb; BookaBach; etc.) generally requires a resource consent in this zone when the owner is not residing on the site. For more information, please refer to: <https://ccc.govt.nz/providing-guest-accommodation/>.

• Community Board

Property located in Spreydon-Cashmere-Heathcote Community Board.

• Tsunami Evacuation Zone

This property is not in a tsunami evacuation zone. It is not necessary to evacuate in a long or strong earthquake or during an official Civil Defence tsunami warning. Residents may wish to offer to open their home to family or friends who need to evacuate from a tsunami zone, and should plan with potential guests to do so in advance. More information can be found at <https://ccc.govt.nz/services/civil-defence/hazards/tsunami-evacuation-zones-and-routes/>

• Electoral Ward

Property located in Spreydon Electoral Ward

• Listed Land Use Register

Hazardous activities and industries involve the use, storage or disposal of hazardous substances. These substances can sometimes contaminate the soil. Environment Canterbury identifies land that is used or has been used for hazardous activities and industries. This information is held on a publically available database called the Listed Land Use Register (LLUR). The Christchurch City Council may not hold information that is held on the LLUR. Therefore, it is recommended that you check Environment Canterbury's online database at www.llur.ecan.govt.nz

Property address:

37 Sugden Street

LIM number: H09355366

Page 17

Christchurch City Council

53 Hereford Street, PO Box 73015
Christchurch 8154, New Zealand
Tel 64 3 941 8999
Fax 64 3 941 8984

www.ccc.govt.nz

- **Spatial Query Report**

A copy of the spatial query report is attached at the end of this LIM. The spatial query report lists land use resource consents that have been granted within 100 metres of this property.

Property address:

37 Sugden Street

LIM number: H09355366

Page 18

Christchurch City Council

53 Hereford Street, PO Box 73015
Christchurch 8154, New Zealand
Tel 64 3 941 8999
Fax 64 3 941 8984

www.ccc.govt.nz

37 Sugden Street



Christchurch
City Council

ph: 03 941 8999 web: ccc.govt.nz

Accuracy not guaranteed. Onsite verification required.
Display of data scale dependant.
Client selected legend.

Copyright © 2025 Reproduction prohibited.

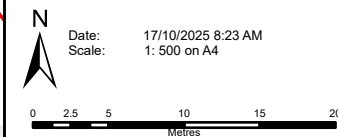

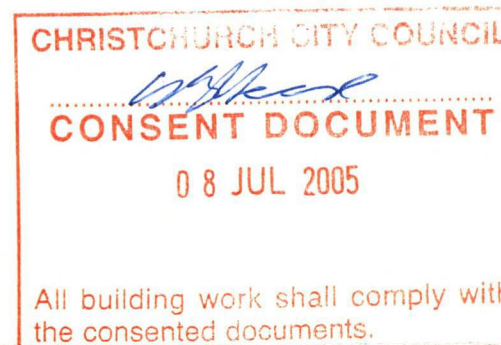

FILE COPY

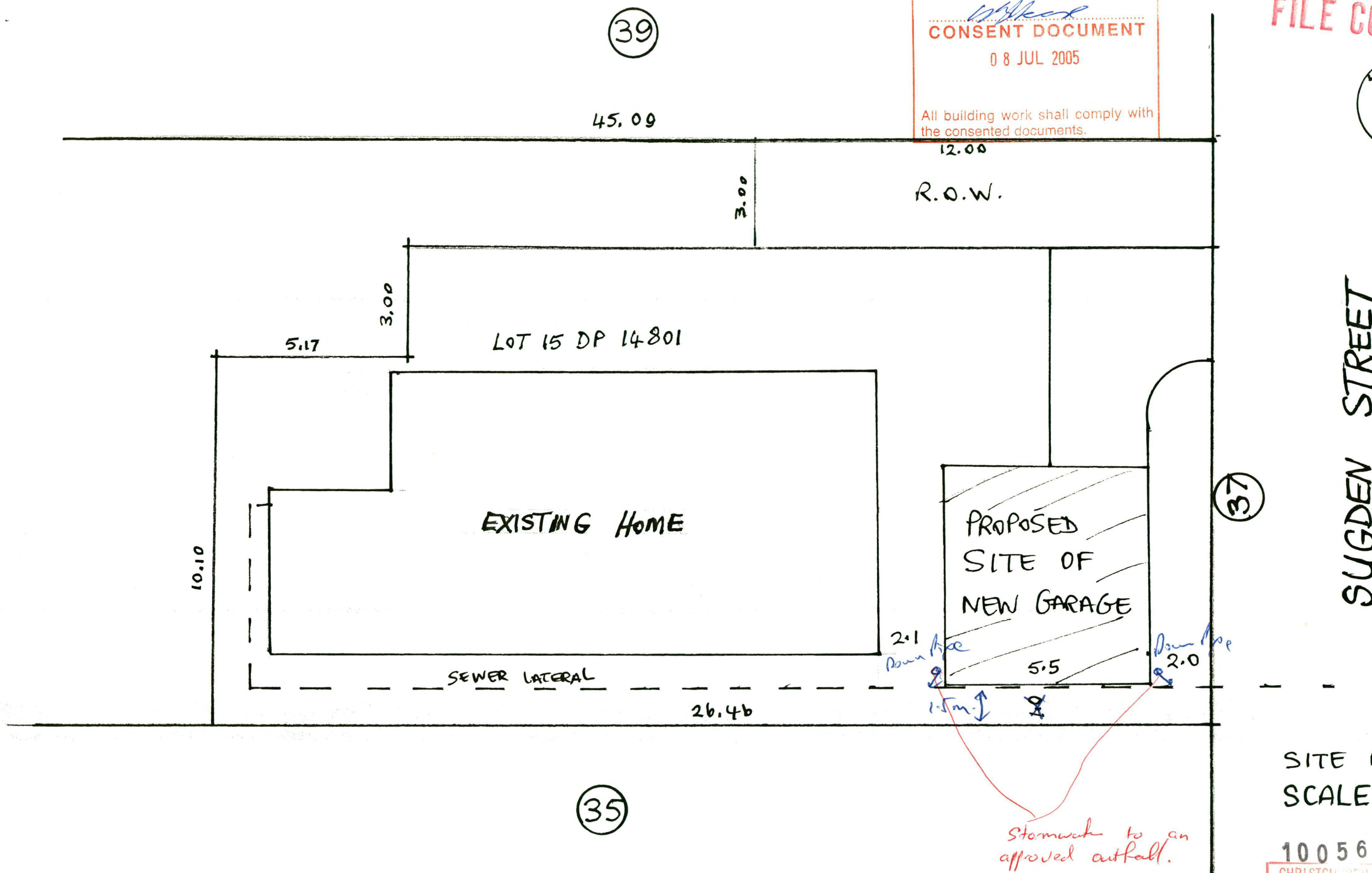

SITE PLAN - PROPOSED ERECTION OF RELOCATED
SECOND HAND 'VERSATILE' BRAND GARAGE
MR. J. SPAIN 37 SUGDEN ST. TEL. 0274337117

SITE PLAN
SCALE 1:100

10056368

CHRISTCHURCH CITY COUNCIL
P.I.M. APPLICATION

Rec'd 2 JUL 2005

Civic Offices

PROJECT No.

37 Sugden Street Land Use Consents

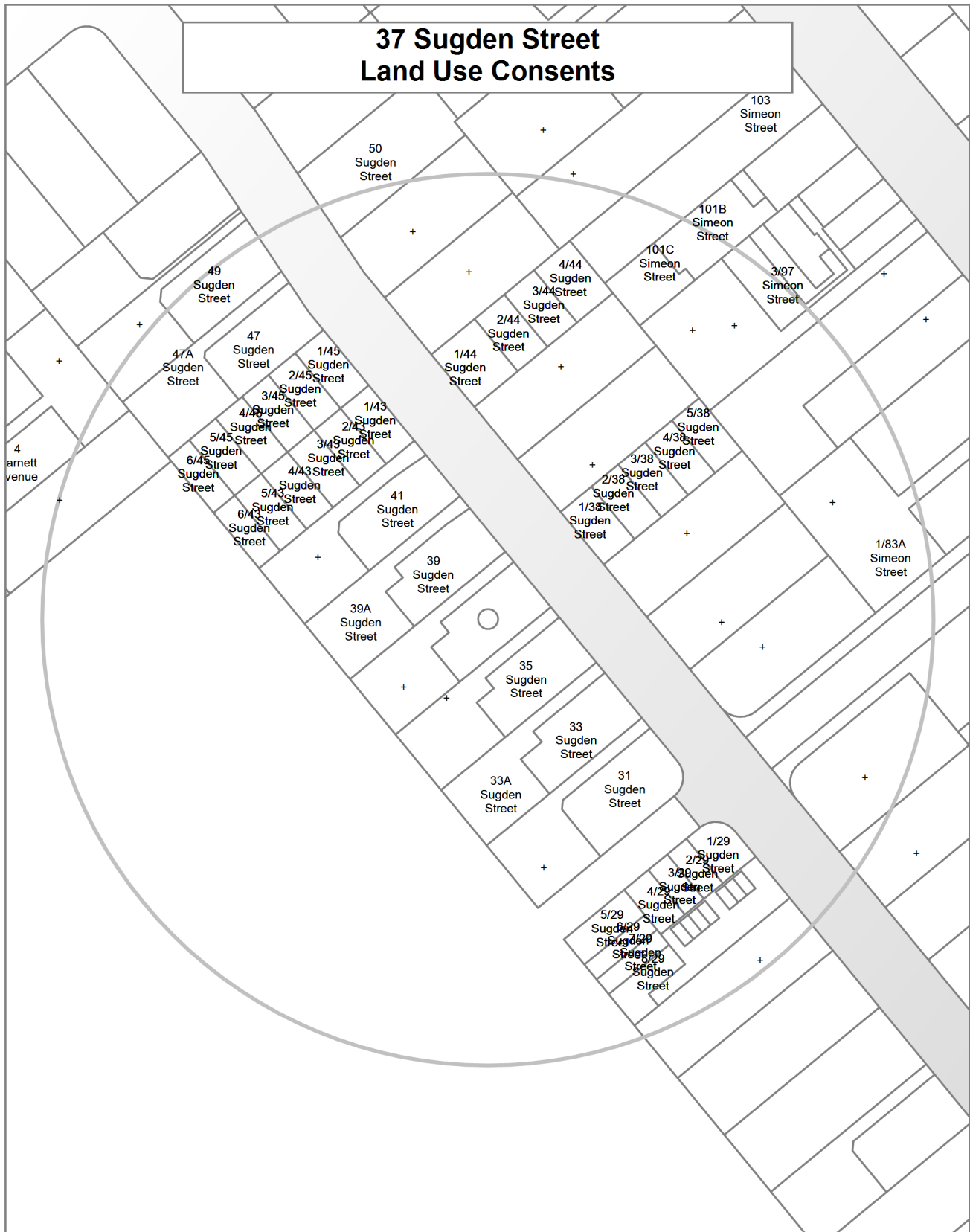

**37 Sugden Street
Subdivision Consents**



Land Use Resource Consents within 100 metres of 37 Sugden Street

Note: This list does not include subdivision Consents and Certificates of Compliance issued under the Resource Management Act.

1/29 Sugden Street

RMA/2022/492

To construct a multi-unit residential complex of eight two storey residential dwellings

Processing complete

Applied 23/02/2022

Decision issued 25/05/2022

Granted 25/05/2022

RMA/2023/93

Subdivision - Fee Simple - Eight lots with amalgamation of Lot 9 (access) and carparks

Processing complete

Applied 19/01/2023

s223 Certificate issued 25/08/2023

s224 Certificate issued 25/08/2023

Decision issued 02/03/2023

Granted 02/03/2023

1/38 Sugden Street

RMA/2021/3034

Construct five residential dwellings

Processing complete

Applied 14/09/2021

Decision issued 26/01/2022

Granted 26/01/2022

RMA/2022/3020

Fee Simple Subdivision - Five Lots and associated land use

Processing complete

Applied 23/09/2022

s223 Certificate issued 09/03/2023

s224 Certificate issued 03/05/2023

Decision issued 15/11/2022

Granted 15/11/2022

1/43 Sugden Street

RMA/2023/3348

Multi-unit residential development - 6 units

Processing complete

Applied 21/12/2023

Decision issued 14/08/2024

Granted 14/08/2024

Within scope amendment accepted 12/03/2025

Within scope amendment decision issued 12/03/2025

RMA/2025/35

Subdivision - Fee Simple - Twelve lots and associated land use

Processing complete

Applied 09/01/2025

s223 Certificate issued 30/04/2025

s224 Certificate issued 15/05/2025

Decision issued 19/03/2025

Granted 19/03/2025

1/44 Sugden Street

RMA/2024/2619

Subdivision - Fee Simple - Four (4) Lots with Land Use

Processing complete

Applied 13/09/2024

s223 Certificate issued 14/03/2025

s224 Certificate issued 14/03/2025

Decision issued 10/10/2024

Granted 09/10/2024

RMA/2024/319

Construct four residential units

Processing complete

Applied 14/02/2024

Amended decision issued - s133A 22/03/2024

Decision issued 20/03/2024

Granted 20/03/2024

1/45 Sugden Street

RMA/2023/3347

Construct SIX Residential Units with attached garages and carpark

Processing complete

Applied 10/01/2024

Conditions changed/cancelled - s127 18/03/2025

Decision issued 15/08/2024

Granted 14/08/2024

RMA/2025/35

Subdivision - Fee Simple - Twelve lots and associated land use

Processing complete

Applied 09/01/2025

s223 Certificate issued 30/04/2025

s224 Certificate issued 15/05/2025

Decision issued 19/03/2025

Granted 19/03/2025

1/83A Simeon Street

RMA/1999/1492

Application to erect a Dwelling and garage, with a side yard of 5ft instead of 10ft. - Historical Reference RES954959

Processing complete

Applied 01/01/1999

Decision issued 01/01/1900

Granted 01/01/1900

101B Simeon Street

RMA/2023/101

To construct three social housing units

Processing complete

Applied 20/01/2023

Decision issued 09/02/2023

Granted 09/02/2023

RMA/2024/476

Subdivision - Fee simple - Three lots and associated land use

Processing complete

Applied 27/02/2024

s223 Certificate issued 18/08/2024

s224 Certificate issued 18/08/2024

Decision issued 02/04/2024

Granted 02/04/2024

101C Simeon Street

RMA/2023/101

To construct three social housing units

Processing complete

Applied 20/01/2023

Decision issued 09/02/2023

Granted 09/02/2023

RMA/2024/476

Subdivision - Fee simple - Three lots and associated land use

Processing complete

Applied 27/02/2024

s223 Certificate issued 18/08/2024

s224 Certificate issued 18/08/2024

Decision issued 02/04/2024

Granted 02/04/2024

103 Simeon Street

RMA/1991/1170

Consent to exceed 65m² of accessory building and to exceed 9m of continuous wall at the side boundary - Historical Reference RES9221612

Processing complete

Applied 23/07/1991

Decision issued 06/08/1991

Granted 06/08/1991

2/29 Sugden Street

RMA/2022/492

To construct a multi-unit residential complex of eight two storey residential dwellings

Processing complete

Applied 23/02/2022

Decision issued 25/05/2022

Granted 25/05/2022

RMA/2023/93

Subdivision - Fee Simple - Eight lots with amalgamation of Lot 9 (access) and carpark

Processing complete

Applied 19/01/2023

s223 Certificate issued 25/08/2023

s224 Certificate issued 25/08/2023

Decision issued 02/03/2023

Granted 02/03/2023

2/38 Sugden Street

RMA/2021/3034

Construct five residential dwellings

Processing complete

Applied 14/09/2021

Decision issued 26/01/2022

Granted 26/01/2022

RMA/2022/3020

Fee Simple Subdivision - Five Lots and associated land use

Processing complete

Applied 23/09/2022

s223 Certificate issued 09/03/2023

s224 Certificate issued 03/05/2023

Decision issued 15/11/2022

Granted 15/11/2022

2/43 Sugden Street

RMA/2023/3348

Multi-unit residential development - 6 units

Processing complete

Applied 21/12/2023

Decision issued 14/08/2024

Granted 14/08/2024

Within scope amendment accepted 12/03/2025

Within scope amendment decision issued 12/03/2025

RMA/2025/35

Subdivision - Fee Simple - Twelve lots and associated land use

Processing complete

Applied 09/01/2025

s223 Certificate issued 30/04/2025

s224 Certificate issued 15/05/2025

Decision issued 19/03/2025

Granted 19/03/2025

2/44 Sugden Street

RMA/2024/2619

Subdivision - Fee Simple - Four (4) Lots with Land Use

Processing complete

Applied 13/09/2024

s223 Certificate issued 14/03/2025

s224 Certificate issued 14/03/2025

Decision issued 10/10/2024

Granted 09/10/2024

RMA/2024/319

Construct four residential units

Processing complete

Applied 14/02/2024

Amended decision issued - s133A 22/03/2024

Decision issued 20/03/2024

Granted 20/03/2024

2/45 Sugden Street

RMA/2023/3347

Construct SIX Residential Units with attached garages and carpark

Processing complete

Applied 10/01/2024

Conditions changed/cancelled - s127 18/03/2025

Decision issued 15/08/2024

Granted 14/08/2024

RMA/2025/35

Subdivision - Fee Simple - Twelve lots and associated land use

Processing complete

Applied 09/01/2025

s223 Certificate issued 30/04/2025

s224 Certificate issued 15/05/2025

Decision issued 19/03/2025

Granted 19/03/2025

270 Barrington Street

RMA/1971/12

To erect a sign to advertise that library - Historical Reference RES9201257

Processing complete

Applied 11/01/1971

Decision issued 22/02/1971

Granted 22/02/1971

RMA/1978/18

Extension and upgrading of Club house - Historical Reference RES9201264

Processing complete

Applied 09/06/1978

Decision issued 22/11/1978

Granted 22/11/1978

RMA/1980/45

Consent to replace the existing pavilion containing the existing tennis courts - Historical Reference RES9201275

Processing complete

Applied 18/03/1980

Decision issued 16/06/1980

Granted 16/06/1980

RMA/1988/55

Construct and relocation of new croquet clubrooms - Historical Reference RES9201283

Processing complete

Applied 14/01/1988

Decision issued 07/04/1988

Granted 07/04/1988

RMA/1989/61

A dispensation relating to recession plane and set back requirements for the proposed Barrington park toilets - Historical Reference RES9201254

Processing complete

Applied 08/06/1989

Decision issued 22/06/1989

Granted 22/06/1989

RMA/1992/426

Consent to extend liquor licensing hours of the Barrington bowling Club on a site in the rec 3 zone - vary conditions of a previous planning consent - Historical Reference RES9214996

Processing complete

Applied 11/12/1992

Decision issued 29/04/1993

Granted 29/04/1993

RMA/2002/703

Application to erect three lighting towers that exceed the 8 metre height maximum - Historical Reference RMA20009684

Processing complete

Applied 26/03/2002

Decision issued 26/06/2002

Granted 15/05/2002

RMA/2007/2425

Application for replacement of a storage garage and toilet block - Historical Reference RMA92009750

Processing complete

Applied 04/09/2007

Decision issued 23/11/2007

Granted 19/11/2007

3/29 Sugden Street

RMA/2022/492

To construct a multi-unit residential complex of eight two storey residential dwellings

Processing complete

Applied 23/02/2022

Decision issued 25/05/2022

Granted 25/05/2022

RMA/2023/93

Subdivision - Fee Simple - Eight lots with amalgamation of Lot 9 (access) and carparks

Processing complete

Applied 19/01/2023

s223 Certificate issued 25/08/2023

s224 Certificate issued 25/08/2023

Decision issued 02/03/2023

Granted 02/03/2023

3/38 Sugden Street

RMA/2021/3034

Construct five residential dwellings

Processing complete

Applied 14/09/2021

Decision issued 26/01/2022

Granted 26/01/2022

RMA/2022/3020

Fee Simple Subdivision - Five Lots and associated land use

Processing complete

Applied 23/09/2022

s223 Certificate issued 09/03/2023

s224 Certificate issued 03/05/2023

Decision issued 15/11/2022

Granted 15/11/2022

3/43 Sugden Street

RMA/2023/3348

Multi-unit residential development - 6 units

Processing complete

Applied 21/12/2023

Decision issued 14/08/2024

Granted 14/08/2024

Within scope amendment accepted 12/03/2025

Within scope amendment decision issued 12/03/2025

RMA/2025/35

Subdivision - Fee Simple - Twelve lots and associated land use

Processing complete

Applied 09/01/2025

s223 Certificate issued 30/04/2025

s224 Certificate issued 15/05/2025

Decision issued 19/03/2025

Granted 19/03/2025

3/44 Sugden Street

RMA/2024/2619

Subdivision - Fee Simple - Four (4) Lots with Land Use

Processing complete

Applied 13/09/2024

s223 Certificate issued 14/03/2025

s224 Certificate issued 14/03/2025

Decision issued 10/10/2024

Granted 09/10/2024

RMA/2024/319

Construct four residential units

Processing complete

Applied 14/02/2024

Amended decision issued - s133A 22/03/2024

Decision issued 20/03/2024

Granted 20/03/2024

3/45 Sugden Street

RMA/2023/3347

Construct SIX Residential Units with attached garages and carpark

Processing complete

Applied 10/01/2024

Conditions changed/cancelled - s127 18/03/2025

Decision issued 15/08/2024

Granted 14/08/2024

RMA/2025/35

Subdivision - Fee Simple - Twelve lots and associated land use

Processing complete

Applied 09/01/2025

s223 Certificate issued 30/04/2025

s224 Certificate issued 15/05/2025

Decision issued 19/03/2025

Granted 19/03/2025

3/97 Simeon Street

RMA/2020/3089

To construct a six unit residential complex

Processing complete

Applied 23/12/2020

Decision issued 16/03/2021

Granted 16/03/2021

RMA/2021/3416

Fee simple subdivision - 6 Lots

Processing complete

Applied 11/10/2021

s223 Certificate issued 27/04/2022

s224 Certificate issued 27/04/2022

Decision issued 02/11/2021

Granted 29/10/2021

31 Sugden Street

RMA/2005/2087

Residential dwelling with attached garage - Historical Reference RMA20020965

Processing complete

Applied 09/09/2005

Decision issued 15/09/2005

Granted 15/09/2005

33 Sugden Street

RMA/2004/1063

Application to locate a garage within the front boundary setback - Historical Reference RMA20016657

Withdrawn

Applied 22/04/2004

RMA/2004/1865

New garage in the front yard. - Historical Reference RMA20017492

Processing complete

Applied 20/07/2004

Decision issued 02/08/2004

Granted 02/08/2004

33A Sugden Street

RMA/2004/2569

Application to erect a dwelling with an attached garage - Historical Reference RMA20018216

Processing complete

Applied 06/10/2004

Decision issued 13/10/2004

Granted 13/10/2004

35 Sugden Street

RMA/2001/981

Application to construct a dwelling site that will result in the existing dwelling on front site having reduced ODLS and setbacks - Historical Reference RMA20004853

Processing complete

Applied 23/04/2001

Decision issued 07/05/2001

Granted 04/05/2001

39 Sugden Street

RMA/2004/1835

Application to erect a double garage in the front yard - Historical Reference RMA20017457

Processing complete

Applied 15/07/2004

Decision issued 06/09/2004

Granted 03/09/2004

39A Sugden Street

RMA/2004/2816

Application to erect a dwelling with an attached garage - Historical Reference RMA20018469

Processing complete

Applied 02/11/2004

Decision issued 16/11/2004

Granted 16/11/2004

4 Garnett Avenue

RMA/1999/2954

Transitional Plan: Reduced setbacks to house(Lot 1), Reduced width and area Lot 1 (353m2 and 11.79m), reduced ROW width (3.0m) - Historical Reference RES991807

Processing complete

Applied 18/06/1999

Decision issued 29/06/1999

Granted 29/06/1999

4/29 Sugden Street

RMA/2022/492

To construct a multi-unit residential complex of eight two storey residential dwellings

Processing complete

Applied 23/02/2022

Decision issued 25/05/2022

Granted 25/05/2022

RMA/2023/93

Subdivision - Fee Simple - Eight lots with amalgamation of Lot 9 (access) and carparks

Processing complete

Applied 19/01/2023

s223 Certificate issued 25/08/2023

s224 Certificate issued 25/08/2023

Decision issued 02/03/2023

Granted 02/03/2023

4/38 Sugden Street

RMA/2021/3034

Construct five residential dwellings

Processing complete

Applied 14/09/2021

Decision issued 26/01/2022

Granted 26/01/2022

RMA/2022/3020

Fee Simple Subdivision - Five Lots and associated land use

Processing complete

Applied 23/09/2022

s223 Certificate issued 09/03/2023

s224 Certificate issued 03/05/2023

Decision issued 15/11/2022

Granted 15/11/2022

4/43 Sugden Street

RMA/2023/3348

Multi-unit residential development - 6 units

Processing complete

Applied 21/12/2023

Decision issued 14/08/2024

Granted 14/08/2024

Within scope amendment accepted 12/03/2025

Within scope amendment decision issued 12/03/2025

RMA/2025/35

Subdivision - Fee Simple - Twelve lots and associated land use

Processing complete

Applied 09/01/2025

s223 Certificate issued 30/04/2025

s224 Certificate issued 15/05/2025

Decision issued 19/03/2025

Granted 19/03/2025

4/44 Sugden Street

RMA/2024/2619

Subdivision - Fee Simple - Four (4) Lots with Land Use

Processing complete

Applied 13/09/2024

s223 Certificate issued 14/03/2025

s224 Certificate issued 14/03/2025

Decision issued 10/10/2024

Granted 09/10/2024

RMA/2024/319

Construct four residential units

Processing complete

Applied 14/02/2024

Amended decision issued - s133A 22/03/2024

Decision issued 20/03/2024

Granted 20/03/2024

4/45 Sugden Street

RMA/2023/3347

Construct SIX Residential Units with attached garages and carparks

Processing complete

Applied 10/01/2024

Conditions changed/cancelled - s127 18/03/2025

Decision issued 15/08/2024

Granted 14/08/2024

RMA/2025/35

Subdivision - Fee Simple - Twelve lots and associated land use

Processing complete

Applied 09/01/2025

s223 Certificate issued 30/04/2025

s224 Certificate issued 15/05/2025

Decision issued 19/03/2025

Granted 19/03/2025

41 Sugden Street

RMA/1998/789

Application to locate a garage 2m from the road boundary. Required to be setback 4.5m to be permitted within the Proposed Plan. - Historical Reference RES980825

Processing complete

Applied 30/03/1998

Decision issued 06/05/1998

Granted 06/05/1998

47 Sugden Street

RMA/2000/1053

Application to locate a garage within the front setback from the road boundary - Historical Reference RMA20001742

Processing complete

Applied 14/04/2000

Decision issued 08/05/2000

Granted 03/05/2000

47A Sugden Street

RMA/2000/1460

Dwelling with attached double garage. - Historical Reference RMA20002173

Processing complete

Applied 09/06/2000

Decision issued 20/06/2000

Granted 16/06/2000

49 Sugden Street

RMA/2002/3143

LAND USE - RECESSION PLANES SET BACKS DENSITY 20012107 - Historical Reference RMA20012197

Processing complete

Applied 06/12/2002

Decision issued 06/12/2002

Granted 06/12/2002

RMA/2003/182

Application to relocate a garage in the front yard and a hobby room in the back yard. - Historical Reference
RMA20012429

Processing complete

Applied 10/01/2003

Decision issued 04/02/2003

Granted 03/02/2003

5/29 Sugden Street

RMA/2022/492

To construct a multi-unit residential complex of eight two storey residential dwellings

Processing complete

Applied 23/02/2022

Decision issued 25/05/2022

Granted 25/05/2022

RMA/2023/93

Subdivision - Fee Simple - Eight lots with amalgamation of Lot 9 (access) and carpark

Processing complete

Applied 19/01/2023

s223 Certificate issued 25/08/2023

s224 Certificate issued 25/08/2023

Decision issued 02/03/2023

Granted 02/03/2023

5/38 Sugden Street

RMA/2021/3034

Construct five residential dwellings

Processing complete

Applied 14/09/2021

Decision issued 26/01/2022

Granted 26/01/2022

RMA/2022/3020

Fee Simple Subdivision - Five Lots and associated land use

Processing complete

Applied 23/09/2022

s223 Certificate issued 09/03/2023

s224 Certificate issued 03/05/2023

Decision issued 15/11/2022

Granted 15/11/2022

5/43 Sugden Street

RMA/2023/3348

Multi-unit residential development - 6 units

Processing complete

Applied 21/12/2023

Decision issued 14/08/2024

Granted 14/08/2024

Within scope amendment accepted 12/03/2025

Within scope amendment decision issued 12/03/2025

RMA/2025/35

Subdivision - Fee Simple - Twelve lots and associated land use

Processing complete

Applied 09/01/2025

s223 Certificate issued 30/04/2025

s224 Certificate issued 15/05/2025

Decision issued 19/03/2025

Granted 19/03/2025

5/45 Sugden Street

RMA/2023/3347

Construct SIX Residential Units with attached garages and carparks

Processing complete

Applied 10/01/2024

Conditions changed/cancelled - s127 18/03/2025

Decision issued 15/08/2024

Granted 14/08/2024

RMA/2025/35

Subdivision - Fee Simple - Twelve lots and associated land use

Processing complete

Applied 09/01/2025

s223 Certificate issued 30/04/2025

s224 Certificate issued 15/05/2025

Decision issued 19/03/2025

Granted 19/03/2025

50 Sugden Street

RMA/2015/1402

Dwelling alterations and additions and repositioning of - Historical Reference RMA92029664

Processing complete

Applied 26/05/2015

Decision issued 31/07/2015

Granted 31/07/2015

6/29 Sugden Street

RMA/2022/492

To construct a multi-unit residential complex of eight two storey residential dwellings

Processing complete

Applied 23/02/2022

Decision issued 25/05/2022

Granted 25/05/2022

RMA/2023/93

Subdivision - Fee Simple - Eight lots with amalgamation of Lot 9 (access) and carpark

Processing complete

Applied 19/01/2023

s223 Certificate issued 25/08/2023

s224 Certificate issued 25/08/2023

Decision issued 02/03/2023

Granted 02/03/2023

6/43 Sugden Street

RMA/2025/35

Subdivision - Fee Simple - Twelve lots and associated land use

Processing complete

Applied 09/01/2025

s224 Certificate issued 15/05/2025

Decision issued 19/03/2025

Granted 19/03/2025

s223 Certificate issued 30/04/2025

6/45 Sugden Street

RMA/2023/3347

Construct SIX Residential Units with attached garages and carpark

Processing complete

Applied 10/01/2024

Conditions changed/cancelled - s127 18/03/2025

Decision issued 15/08/2024

Granted 14/08/2024

RMA/2025/35

Subdivision - Fee Simple - Twelve lots and associated land use

Processing complete

Applied 09/01/2025

s223 Certificate issued 30/04/2025

s224 Certificate issued 15/05/2025

Decision issued 19/03/2025

Granted 19/03/2025

7/29 Sugden Street

RMA/2022/492

To construct a multi-unit residential complex of eight two storey residential dwellings

Processing complete

Applied 23/02/2022

Decision issued 25/05/2022

Granted 25/05/2022

RMA/2023/93

Subdivision - Fee Simple - Eight lots with amalgamation of Lot 9 (access) and carpark

Processing complete

Applied 19/01/2023

s223 Certificate issued 25/08/2023

s224 Certificate issued 25/08/2023

Decision issued 02/03/2023

Granted 02/03/2023

77 Simeon Street

RMA/1972/312

Consent to build a fire Station - Historical Reference RMA98

Processing complete

Applied 15/07/1972

Decision issued 09/03/1973

Granted 09/03/1973

RMA/2003/1131

Application for a gym addition which intrudes the setback - Historical Reference RMA20013414

Processing complete

Applied 29/04/2003

Decision issued 02/05/2003

Outline plan accepted 02/05/2003

RMA/2015/3316

Rebuild Addington Fire Station - Historical Reference RMA92031715

Processing complete

Applied 30/11/2015

Decision issued 20/01/2016

Granted 20/01/2016

8/29 Sugden Street

RMA/2022/492

To construct a multi-unit residential complex of eight two storey residential dwellings

Processing complete

Applied 23/02/2022

Decision issued 25/05/2022

Granted 25/05/2022

RMA/2023/93

Subdivision - Fee Simple - Eight lots with amalgamation of Lot 9 (access) and carparks

Processing complete

Applied 19/01/2023

s223 Certificate issued 25/08/2023

s224 Certificate issued 25/08/2023

Decision issued 02/03/2023

Granted 02/03/2023

Data Quality Statement

Land Use Consents

All resource consents are shown for sites that have been labelled with an address. For sites that have been labelled with a cross (+) no resource consents have been found. Sites that have no label have not been checked for resource consents. This will be particularly noticeable on the margins of the search radius. If there are such sites and you would like them included in the check, please ask for the LIM spatial query to be rerun accordingly. This will be done free of charge although there may be a short delay. Resource consents which are on land occupied by roads, railways or rivers are not, and currently cannot be displayed, either on the map or in the list. Resource consents that relate to land that has since been subdivided, will be shown in the list, but not on the map. They will be under the address of the land as it was at the time the resource consent was applied for. Resource consents that are listed as Non-notified and are current, may in fact be notified resource consents that have not yet been through the notification process. If in doubt. Please phone (03)941 8999.

The term “resource consents” in this context means land use consents. Subdivision consents and certificates of compliance are excluded.

Subdivision Consents

All subdivision consents are shown for the sites that have been labelled with consent details. For Sites that have been labelled with a cross (+) no records have been found. Sites that have no label have not been checked for subdivision consents. This will be particularly noticeable on the margins of the search radius. If there are such sites and you would like them included in the check, please ask for the LIM spatial query to be rerun accordingly. This will be done free of charge although there may be a short delay.

The term “subdivision consents” in this context means a resource consent application to subdivide land. Non subdivision land use resource consents and certificates of compliance are excluded.

This report will only record those subdivision applications which have not been completed i.e once a subdivision has been given effect to and the new lots/properties have been established the application which created those lots will not be shown

All subdivision consent information is contained on the map and no separate list is supplied