

# EARTHQUAKE RECOVERY (EQR) DOCUMENTATION

The documents within the Earthquake Recovery Documentation section, encompass all works completed under the Canterbury Home Repair Programme (CHRP). These contain assessments, contractor quotes, work orders and sign offs.

# EQR Property Overview Report

**Company** Fletcher EQR (division of FCC) as agent for EQC

**Printed Date:** 25-04-2018

EQC Property ID	Property Address	Vulnerable?	Property F Status	Property Finalisation Indicator		
<b>2010042482</b>	<b>74 AMYES ROAD, HORNBY</b>		<b>F3 - Complete &amp; Finalised</b>	<b>Some Finalisation has taken place</b>		
Main Contractor:	CLOSED OUT-Sinclair Builders 2010 Limited ***** (S022)		Property F2'd By:	System Generated Finalisation	F2 Completed Date:	09-02-2015
Cont Managing Hub:	Ensors	Not Vulnerable	Property F3'd By:	System Generated Finalisation	F3 Completed Date:	09-02-2015

## Adjustments

			Original Budget			Budget Variation			Gross Claimed	Gross Certified
EQC Claim Number + Address	Project	Status	Unmapped Adjmt Lines	Total OB	Allocated	Unallocated	Total BV	Allocated	Unallocated	
CLM/2010/042482 74/UNIT 1 AMYES ROAD	No Adjustments for this Claim			0.00	0.00	0.00	0.00	0.00	0.00	0.00
CLM/2011/204158 74 AMYES ROAD	E004	F3	0	20,069.61	20,069.61	0.00	7,496.99	7,496.99	0.00	27,481.60
<b>Property Total</b>			<b>0</b>	<b>20,069.61</b>	<b>20,069.61</b>	<b>0.00</b>	<b>7,496.99</b>	<b>7,496.99</b>	<b>0.00</b>	<b>27,481.60</b>

## Assignments

EQC Claim Number + Address	CC + Hub Status	Assignment	Subcontractor Hub Comments	Workflow Status	Contractor Quote	Adjustment Line Count	Gross Claimed	Gross Certified
CLM/2010/042482 74/UNIT 1 AMYES ROAD		Substantive Works - Primary	CLOSED OUT-Sinclair Builders 2010 Limited ***** (S022)	COMPLETIONS	25,422.88	0	0.00	0.00
		Transmitted To Hub -> Awaiting Claim File Review	See 2011/204158 claim for 74 Amyes (Same property)					
CLM/2011/204158 74 AMYES ROAD		Emergency Works - Primary	CLOSED OUT-Corbel Construction Limited ***** (S150)	COMPLETIONS	0.00	1	2,058.72	2,058.72
		Allocated To Hub -> Awaiting Claim File Review	1) Take down balance of chimney to ground level (upper section already removed) - dangerous. 2) Replace one badly cracked concrete roof tile - weather tightness.					
CLM/2011/204158 74 AMYES ROAD		Substantive Works - Primary	CLOSED OUT-Sinclair Builders 2010 Limited ***** (S022)	COMPLETIONS	25,422.88	11	25,422.88	25,422.88
		Transmitted To Hub -> Claim File Review Complete	Not Eligible for heating. No working fires					
<b>Property Total</b>					<b>50,845.76</b>	<b>12</b>	<b>27,481.60</b>	<b>27,481.60</b>

No Works Orders on this Property

# EQR Property Overview Report

Company Fletcher EQR (division of FCC) as agent for EQC

Printed Date: 25-04-2018

EQC Property ID	Property Address	Vulnerable?	Property F Status	Property Finalisation Indicator		
<b>2010042482</b>	<b>74 AMYES ROAD, HORNBY</b>		<b>F3 - Complete &amp; Finalised</b>	<b>Some Finalisation has taken place</b>		
Main Contractor:	CLOSED OUT-Sinclair Builders 2010 Limited ***** (S022)		Property F2'd By:	System Generated Finalisation	F2 Completed Date:	09-02-2015
Cont Managing Hub:	Ensors	Not Vulnerable	Property F3'd By:	System Generated Finalisation	F3 Completed Date:	09-02-2015

## Claims / Certs / Payables

### S150 CLOSED OUT-Corbel Construction Limited \*\*\*\*\*

EQC Claim Num	Line Type	Approval Type	Claim No	Claimed By	Remaining	Claim Date	This Claim	
CLM/2011/204158	E3Emg BV	Emergency Under 50k(Delegated)	6	EQR\NookE	\$0.00	21-Aug-2011	\$2,058.72	
EQC Claim Num	Line Type	Approval Type	Cert No	Certified By	Remaining	Certified Date	This Cert	Cert Line Notes
CLM/2011/204158	E3Emg BV	Emergency Under 50k(Delegated)	6	EQR\NookE	\$0.00	21-Aug-2011	\$2,058.72	

<b>S150</b>	<b>CLOSED OUT-Corbel Construction Limited ***** Total</b>	<b>Claims</b>	<b>\$2,058.72</b>	<b>Certs</b>	<b>\$2,058.72</b>	<b>Payables</b>	<b>\$0.00</b>
-------------	---	---------------	-------------------	--------------	-------------------	-----------------	---------------

### CONS Consultants

EQC Claim Num	Line Type	Approval Type	Transaction Type	Internal Ref	CAS Batch	CAS Date	Line Value	Invoice No
CLM/2011/204158			Creditors Invoices	EQ1201065TU-04	2346	01-Feb-2012	\$85.00	11205

<b>CONS</b>	<b>Consultants Total</b>	<b>Claims</b>	<b>\$0.00</b>	<b>Certs</b>	<b>\$0.00</b>	<b>Payables</b>	<b>\$85.00</b>
-------------	--------------------------	---------------	---------------	--------------	---------------	-----------------	----------------

### S022 CLOSED OUT-Sinclair Builders 2010 Limited \*\*\*\*\*

EQC Claim Num	Line Type	Approval Type	Claim No	Claimed By	Remaining	Claim Date	This Claim	
CLM/2011/204158	Subst OB	Substantive Works	57	EQR\NookE	\$0.00	24-Feb-2012	\$17,925.89	
CLM/2011/204158	Subst OB	Substantive Works	57	EQR\NookE	\$0.00	24-Feb-2012	\$7,496.99	
CLM/2011/204158	Subst OB	Substantive Works	75	EQR\NookE	\$0.00	19-Jul-2012	-\$5,353.27	
CLM/2011/204158	Subst BV	Scope Addition	75	EQR\NookE	\$0.00	19-Jul-2012	\$5,353.27	
EQC Claim Num	Line Type	Approval Type	Cert No	Certified By	Remaining	Certified Date	This Cert	Cert Line Notes
CLM/2011/204158	Subst OB	Substantive Works	49	EQR\AndreR	\$0.00	23-Feb-2012	\$17,925.89	
CLM/2011/204158	Subst OB	Substantive Works	49	EQR\AndreR	\$0.00	23-Feb-2012	\$7,496.99	
CLM/2011/204158	Subst OB	Substantive Works	65	EQR\NookE	\$0.00	19-Jul-2012	-\$5,353.27	
CLM/2011/204158	Subst BV	Scope Addition	65	EQR\NookE	\$0.00	19-Jul-2012	\$5,353.27	

<b>S022</b>	<b>CLOSED OUT-Sinclair Builders 2010 Limited ***** Total</b>	<b>Claims</b>	<b>\$25,422.88</b>	<b>Certs</b>	<b>\$25,422.88</b>	<b>Payables</b>	<b>\$0.00</b>
-------------	--	---------------	--------------------	--------------	--------------------	-----------------	---------------

<b>Property Total</b>	<b>Claims</b>	<b>\$27,481.60</b>	<b>Certs</b>	<b>\$27,481.60</b>	<b>Payables</b>	<b>\$85.00</b>
-----------------------	---------------	--------------------	--------------	--------------------	-----------------	----------------

No Open Complaints / Remedial Issues on this Property

# EQR Property Overview Report

**Company** Fletcher EQR (division of FCC) as agent for EQC

**Printed Date:** 25-04-2018

EQC Property ID	Property Address	Vulnerable?	Property F Status	Property Finalisation Indicator		
<b>2010042482</b>	<b>74 AMYES ROAD, HORNBY</b>		<b>F3 - Complete &amp; Finalised</b>	<b>Some Finalisation has taken place</b>		
Main Contractor:	CLOSED OUT-Sinclair Builders 2010 Limited ***** (S022)		Property F2'd By:	System Generated Finalisation	F2 Completed Date:	09-02-2015
Cont Managing Hub:	Ensors	Not Vulnerable	Property F3'd By:	System Generated Finalisation	F3 Completed Date:	09-02-2015

## Finalisation Documents

EQC Claim Number	Document Type	Hub Zone	File Last Modified Date
CLM/2011/204158	Construction Completion Inspection		22/01/2015
CLM/2010/042482	Defects Liability Certificate	Addington Hub	19/06/2014
CLM/2011/204158	Defects Liability Certificate	Addington Hub	28/05/2014

**Property Total** **Finalisation Documents Present:** 3

No Technical Services Referrals on this Property

## Asbestos Test Information

EQC Claim Number	Claim Address	Asbestos Test Required?	Asbestos Test Result
CLM/2010/042482	74/UNIT 1 AMYES ROAD	<NOT SPECIFIED>	<NOT SPECIFIED>
CLM/2011/204158	74 AMYES ROAD	<NOT SPECIFIED>	<NOT SPECIFIED>

**Property Total** **Number of Claims:** 2

## Contractors

Contractor	Accreditation Status	Accreditation Number	Classification	Type of Work on the Property
S022 CLOSED OUT-Sinclair Builders 2010 Limited *****	Accredited	EQRC0463	Main Contractor	Substantive Works
S150 CLOSED OUT-Corbel Construction Limited *****	Rationalised	EQRC0121	Main Contractor	Emergency Works

**Property Total** **Number of Contractors:** 2





APPROVED

## Statement of Claim Checklist / Repair Strategy

Date: ..... 12/1/11 .....

Author: ..... Gary PHILLIPS .....

CLM/2010/042482

K BARNES  
1/74 AMYES ROAD  
HORNBY  
CHRISTCHURCH 8042  
H: [REDACTED]  
W: [REDACTED]  
M: [REDACTED]

LA: ..... Gary PHILLIPS .....

Estimator: ..... Don CHARTERIS .....

Room	Earthquake Damage	Walls	Ceiling	Floor	Repair Strategy
	Y/N	✓	✓	✓	
<del>Lounge</del>					
<del>NONE</del> Dining Room	N/A				
<del>LOUNGE</del> Kitchen	NO				4.3m x 6.5m
<del>NONE</del> Family Room					
Bedroom 1	NO				4.6m x 3.9m
<del>NONE</del> Ensuite	N/A				
Bedroom 2	NO				2.9m x 3.3m
Bedroom 3	Y	✓	✓		Strip paper & fix ceiling, repaper (patterned paper). Roll out cracks to walls, fill and repaint 3.6m x 3.3m.

B

SOC / Repair Strategy – Page 2

K BARNES  
1/74 AMYES ROAD  
HORNBY  
CHRISTCHURCH 8042  
H: [REDACTED]  
W: [REDACTED]  
M: [REDACTED]

W<sup>e</sup>  
APPROVED

Room	Earthquake Damage	Walls	Ceiling	Floor	Repair Strategy
	Y/N	✓	✓	✓	
NONE Bedroom 4	N/A				
Bathroom	ND				1.8m x 2.4m
Toilet 1	ND				1.8m x 0.9m
NONE Toilet 2	N/A				
NONE Office / Study	N/A				
NONE Rumpus	N/A				
Entry / Hall(s)	ND				4.55m x 1.35m
NONE Stairwell	N/A				
Laundry	ND				2m x 1.8m
INTERNA Garage NONE	N/A				
Rear hall Other	ND				1.05m x 1.8m

.....  
Initials)

SOC / Repair Strategy - Page 3

K BARNES  
1/74 AMYES ROAD  
HORNBY  
CHRISTCHURCH 8042

H:  
W:  
M:



Item		Event Damage	
		Y / N	
Roof		Y	Rake cracks, gap fill, paint soffit, supply new soffit lining .4m x 2.4m install and fix. Replace roof tile
EXTERNAL WALLS	North	Y	Rake out cracks, gap fill and paint window trims/joinery. Rake cracks at entry area (board and batten), gap fill, paint
	South	Y	Rake out cracks, gap fill and paint window trims/joinery.
	East	Y	Rake out cracks, gap fill and paint window trims/joinery.
	West	Y	Rake out cracks, gap fill and repaint window trims/joinery.
Decks		N	
CHIMNEY X	RENDER. Bas. SOFFIT	Y	Remove bricks to fracture point, supply mortar and rebuild. 4x.5x.5
	Ceiling Cavity	ND	
	Above Roof	Y	Supply scaffold, bricks and mortar, rebuild .6m x .6m x 1.5m.
	Fireplace	ND	

JS  
Initials)

SOC / Repair Strategy – Page 4

K BARNES  
 1/74 AMYES ROAD  
 HORNBY  
 CHRISTCHURCH 8042  
 H: [REDACTED]  
 W: [REDACTED]  
 M: [REDACTED]

Item	Event Damage	
	Y / N	
Foundations	ND	
Piling	ND	
Services	ND	
Other Dwelling Items	ND	
Outbuildings	ND	
Land & Retaining Walls (Discuss with Supervisor)	ND	

**Supplementary Notes:**

I confirm the rooms and areas listed above have been inspected by an EQC representative.

Damage caused by the event has been noted and to my knowledge there are no other areas of damage resulting from the event.

Signature of Claimant: 36ms Dated: 12/1/11

.....  
 (Initials)

**NOTE: THIS FORM IS TO BE COMPLETED IN THE CLAIMANT'S PRESENCE.**





EARTHQUAKE COMMISSION

## File Note

CLM/2010/042482

Date:

12/1/11

Author:

Gary Phillips

K BARNES

1/74 AMYES ROAD

HORNBY

CHRISTCHURCH 8042

H:

W:

M:

## Topic

<input checked="" type="checkbox"/> General	EECA.		
<input checked="" type="checkbox"/> Building Claim	<input type="checkbox"/> Pay Claimant \$0-\$10,000	<input type="checkbox"/> PMO \$10-\$100,000	<input type="checkbox"/> Pay over cap \$100,000 +
<input checked="" type="checkbox"/> CSU Letter	<input checked="" type="checkbox"/> Contents	<input type="checkbox"/> Building	<input checked="" type="checkbox"/> Land
<input type="checkbox"/> Decline Claim			

Subject:

FIRST INSPECTION

Related To:

None (Claim Level)

Confidential:

☐

Yes

☒

No

Notes: ATTENDANCE

1145

TIME/DATE

12/1/11

CLAIMANT PRESENT?

YES.

INSURANCE DETAILS.

Westpac (Lumley Group)

MORTGAGEE.

Westpac, Rangiuru Beach, CHCH.

ALTERNATIVE PHONE

EMAIL

LAND DAMAGE?

NO

RESERVE

-

CONTENTS?

NO

RESERVE

-

DWELLING?

YES.

RESERVE

\$7,800

NEXT ACTION:

Building scoped for EECA managed repair.

## DAMAGE DESCRIPTION

LAND: (one sentence, indicating type and location)

No lead damage

CONTENTS: (brief outline, type &amp; classification, as per contents schedule)



DWELLING: (one or two sentences at most, describing the damage. Note if major/minor structural or major/minor cosmetic.)

Minimal internal damage involving cracks to walls and ceiling in one room. Minor external damage involving cracks to 4 walls and chimney damage.

WAS A FULL INSPECTION DONE? (On roof, in roof space &amp; under sub floor) IF NOT, REASONS.

Yes, roof, roof space and sub floor.

## OFFICE USE ONLY - LOSS ADJUSTER TO COMPLETE

Date 12 Jan 11Claim Number 2010/ 042 482Loss Adjuster: Gary PHILLIPSCosting Estimate

\$ ND

Lounge/Kitchen

\$

Dining Room

\$

\$ NA

Family Room

\$ ND

Bed 1

\$

Ensuite

\$

Bed 2

\$ 1730

Bed 3

\$

Bed 4

\$

Bathroom

\$

Toilet 1

\$

Toilet 2

\$

Office/Study

\$

Rumpus

\$

Entry/Hall(s)

\$

Stairwell

\$

Laundry

\$

Outbuildings/Garage

APPROVED <sup>62</sup>

## OFFICE USE ONLY - LOSS ADJUSTER TO COMPLETE

Date: 12 JanClaim Number: 2010/ 042482Loss Adjuster: Gary PHILLIPS

\$ 1170

Roof/Soffit

\$ 1400

Exterior.

\$ 3500

chimney

\$

\$

\$

\$

\$

\$

Sub Totals:

\$ 1170

\$ 3130

\$ 3500

Total Estimate: \$ 7800



APPROVED

Date: 12 Jan 11

Claim Number: 2010/ 042482

Estimators Name: Dan Charteris

Dwelling Inspection Checklist: Show measurements indicate damage

<p>Lounge / Kitchen</p>	<p>NA</p>	<p>NA</p>
<p>Family Room</p>	<p>Bed 1</p>	<p>Ensuite</p>
<p>Bed 3</p>	<p>Bed 2</p>	<p>Bed 4</p>
<p>Bathroom</p>	<p>Toilet 1</p>	<p>Toilet 2</p>
<p>Rear Hall</p>	<p>Rumpus</p>	<p>Entry/Hall(s)</p>

90penny 3950  
 Initials) 35

Date: 12 Jan 11

Claim Number: 2010/042482

Estimators Name: Dan Charteris



Stairwell

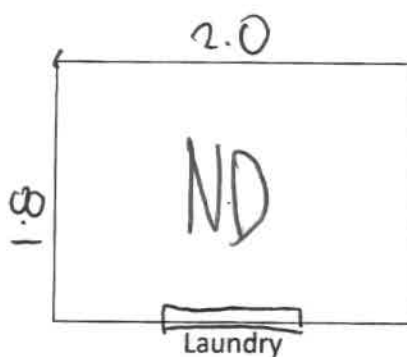

Laundry

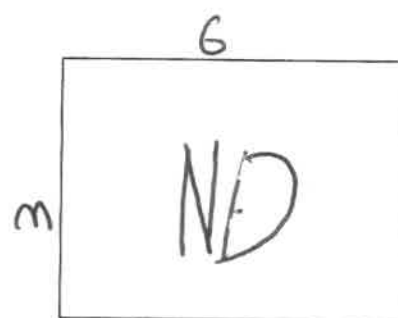

Outbuildings/Garage

Soffit/skooka junction  
cracking 38 cm x  
Soffit 400mm wide.  
Broken soffit 24 x 400  
N/W corner Supply new  
Fit & paint Supply new roof tile

Roof/soffit.



Foundation

Window trim separation  
on 6 windows  
Cladless junction  
separation @ Entry  
area. Supply new Facing  
board. Rake gap fill  
board & battens Entry 6m

Exterior

Chimney has been removed  
to roof line.  
Chimney out of plumb remove  
to base & rebuild.

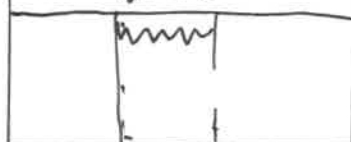

chimney

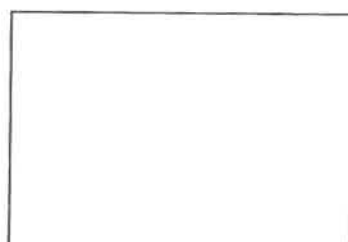
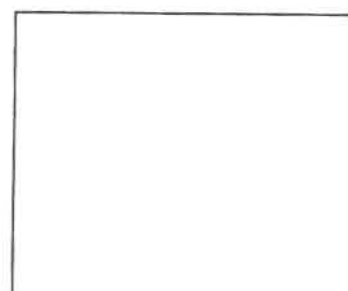
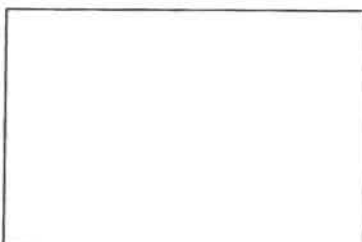
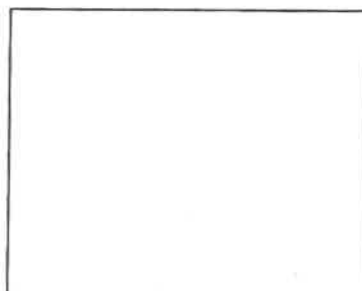
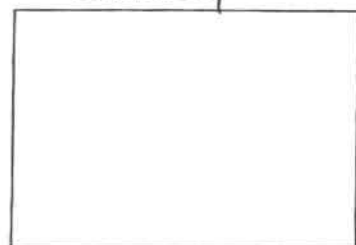

## Legend

—	Crack to ceiling (show length)
M	Crack to wall (show length)
X	External damage
O	Foundation damage
+	Floor damage





APPROVED

## Statement of Claim Checklist / Repair Strategy

Date: 11/6/11

Author: Darryl Nix

CLM/2011/065044

K BARNES

74 AMYES ROAD

HORNBY

CHRISTCHURCH 8042

E:

W:

M:

LA: Darryl Nix

Estimator: Peter Tucker

Room	Earthquake Damage	Walls	Ceiling	Floor	Repair Strategy
	Y/N	✓	✓	✓	
2.4 Lounge 4.2 x 6.5	Y	Y	N	N CARPET	Walls: Take out GIB CRACKS 6.0m - STOP - PAINT.
Dining Room					AS in Lounge
Kitchen					AS in Lounge.
Family Room	N/A				
2.4 Bedroom 1 4.5 x 4.0	Y	Y	N	N CARPET	Walls: Take out GIB CRACKS 8.0m - STOP - PAINT. Windows: PAINT frame. 2.5 Lm (CRACKED PAINT)
Ensuite	N/A				
2.4 Bedroom 2 3.3 x 2.9	Y	Y	N	N CARPET	Walls: Take out GIB CRACKS 1.0m - STOP - PAINT. PAINT Windows frame 2.5 Lm. (CRACKED PAINT ONLY)
2.4 Bedroom 3 3.7 x 3.3	Y	Y	N	N CARPET	Walls: Take out GIB CRACKS 3.0m - STOP - PAINT.



SOC / Repair Strategy – Page 2

D. Nix 11/6/11

ADDITIONAL

Affix label here

K. Barnes 2011/065044

Room	Earthquake Damage	Walls	Ceiling	Floor	Repair Strategy
	Y/N	✓	✓	✓	
Bedroom 4	N/A				
2-4 Bathroom 2.4 x 1.8	Y	Y	N	N/A	Walls:- make out G.B Cracks 2 m Stop-PAINT.
2-4 Toilet 1 - 9 x 1.8	N	✓		Particle.	✓
Toilet 2	N/A				
Office / Study	N/A				
2-4 Passage Rumpus 5.5 x 1.8	Y	Y	N	N/A	Walls:- make out G.B Cracks 6.0 m. Stop-PAINT.
2.0 Entry / Hall(s) 1.8 x 1.0	N	✓			✓
Stairwell	N/A				
2-4 Laundry 1.8 x 1.9	N	✓		Particle.	✓
2-4 Garage 6.0 x 3.9	N	✓		Slab	✓
Other	N/A				✓

.....  
(Initials)

Affix label here

SOC / Repair Strategy – Page 3

D. Nix 11/6/11

K. BARNES 2011/06/04/11  
APPROVED

Item		Event Damage Y / N	Repair Strategy
Roof		N	
EXTERNAL WALLS	North	Y	Re Mortar 1x Brick by Kitchen Window - 1m. White Paint
	South	Y	Grind out Mortar Cracks 2.0m - Re Mortar - White Points.
	East	Y	Grind out Mortar Cracks - 5m - Re Mortar - White Points. Re Mortar Sill Bricks 3.0m - White Points. Replace Brick Mould - 2 m.
	West	Y	Re Mortar Sill Blocks under Laundry + Toilet Windows 3.0m. - White Points. Sand and Paint Window Frames Bedrooms 2, 3 + Laundry
Decks		N/A	
CHIMNEY	Base	N	
	Ceiling Cavity	N	
	Above Roof	Y	Reinstall Chimney Above Roof Level 1.5 x .6 x .6. Brick.
	Fireplace	N	

APPROVED  
Affix label here

SOC / Repair Strategy – Page 4

D. Dix 11/6/11

K BARNES 2011/065044

Item	Event Damage	Repair Strategy
	Y / N	
Foundations	N	/
Piling	N	/
Services	N	/
Other Dwelling Items	N	/
Outbuildings	N	/
Land & Retaining Walls <i>(Discuss with Supervisor)</i>	N	/

**Supplementary Notes:**

I confirm the rooms and areas listed above have been inspected by an EQC representative.

Damage caused by the event has been noted and to my knowledge there are no other areas of damage resulting from the event.

Claimant left the address before completion.

**Signature of Claimant:** ..... **Dated:** .....

\*\*\*\*\*  
(Initials)

**NOTE: THIS FORM IS TO BE COMPLETED IN THE CLAIMANT'S PRESENCE.**



## File Note

CLM/2011/065044

Date: 11/6/11

Author: Drangl dx

K BARNES  
74 AMYES ROAD  
HORNBY  
CHRISTCHURCH 8042

E:  
W:  
M:

CHECKED

## Topic

<input checked="" type="checkbox"/> General			
<input checked="" type="checkbox"/> Building Claim	<input type="checkbox"/> Pay Claimant \$0-\$10,000	<input checked="" type="checkbox"/> PMO \$10-\$100,000	<input type="checkbox"/> Pay over cap \$100,000 +
<input type="checkbox"/> CSU Letter	<input type="checkbox"/> Contents	<input type="checkbox"/> Building	<input type="checkbox"/> Land
<input type="checkbox"/> Decline Claim			

Subject:

FIRST INSPECTION

Related To:

None (Claim Level)

Confidential:

☐

Yes

☒

No

Notes: ATTENDANCE

TIME/DATE

CLAIMANT PRESENT?

INSURANCE DETAILS. Lumley via Westpac.

MORTGAGEE. Westpac.

ALTERNATIVE PHONE NO.

EMAIL

LAND DAMAGE? No

RESERVE

CONTENTS?

No

RESERVE

DWELLING?

yes

RESERVE

+ \$

NEXT ACTION:



## DAMAGE DESCRIPTION

LAND: (one sentence, indicating type and location)

No

CONTENTS: (brief outline, type &amp; classification, as per contents schedule)

No.

DWELLING: (one or two sentences at most, describing the damage. Note if major/minor structural or major/minor cosmetic.)

1950's Brick Bungalow Dwelling Suffering 50% Damage in September repaired 50% February. Claimant mentioned that this rental property had been inspected after the September Quake by EOC but having just evicted some crack tenants. And wanting to put family in the house, they had re-decorated before inspection. Took place. Inspection team at the time could only go with what claimant told them. Damage seen on current inspection was all fresh in the interior. Since February.

WAS A FULL INSPECTION DONE? (On roof, in roof space &amp; under sub floor) IF NOT, REASONS.

Yes. Claimant was concerned about water leaking into house above lounge window. We could find no logical reason for this apart from a possible dislodged roof tile. Tile re-set, but doubtful that this was cause of problem.

House Habitable.



APPROVED

## Scope of Works

Completed By: Peter TuckerDate: 11/6/11Page 1 of 11CLM 2011 / 065044

Claimant Name:

K Barnes

## Element Details:

Land	Building	<input checked="" type="checkbox"/> Bridges/culverts	Retaining walls	Other
Lounge	Dining	Kitchen	Family Room	Bedroom
Office/Study	Rumpus	Hallway	Stairwell	Toilet
Laundry	Bathroom	Ensuite	Chimney	Foundations
Piling	Services	Kitchen Ovens	Hot Water Cylinders	Header Tanks
Glazing/windows	Fireplace/woodburner	Floor	External Walls	Roof
Outbuildings	Other			

DESCRIPTION: N/DREPAIR STRATEGY: NA

## LINE ITEMS:

DESCRIPTION:	Units	Length	Breadth	Depth	Qty	Rate	Cost
<u>CONSENT-DESIGN</u>							<u>NA</u>
- PERMIT	<u>EA</u>						<u>"</u>
- ARCHITECTURAL							<u>"</u>
- ENGINEER	<u>EA</u>						<u>"</u>
<u>PRELIMINARY &amp; GENERAL</u>							<u>NA</u>
- SITE ESTABLISHMENT	<u>EA</u>						<u>"</u>
- SCAFFOLD	<u>M<sup>2</sup></u>						<u>"</u>
- SCAFFOLDING WEEKLY HIRE	<u>M<sup>2</sup></u>						<u>"</u>
- SCAFFOLDING WEEKLY CHECK	<u>EA</u>						<u>"</u>
<u>DEMOLITION &amp; FILL</u>							<u>NA</u>
* PARTIAL							<u>"</u>
* WALLS - FULL							<u>"</u>
- PARTIAL							<u>"</u>
- FULL BRICK							<u>"</u>
* ROOF - FULL							<u>"</u>
- PARTIAL							<u>"</u>
* FLOOR - FULL							<u>"</u>
- PARTIAL							<u>"</u>

Subtotal

+ P&amp;G, Margin &amp; GST Figure

TOTAL

\* Unit Categories to be used as follows:

Each, Sheet, Kilogram, Linear metre, Square metre, Cubic metre,  
Per Hour, Per Day, Per Week. Cubic metre calculations must include  
length, breadth and depth figures. Square metre calculations must  
include length and breadth figures.







# Scope of Works

Completed By:

**Peter Tucker**

Date:

CLM

2011 / 065044

Claimant Name:

16 BARNES.

Page 3 of 11

## Element Details:

Land	Building	<input checked="" type="checkbox"/> Bridges/culverts	Retaining walls	Other
Lounge	Dining	Kitchen	Family Room	Bedroom
Office/Study	Rumpus	Hallway	Stairwell	Toilet
Laundry	Bathroom	Ensuite	Chimney	Foundations
Piling	Services	Kitchen Ovens	Hot Water Cylinders	Header tanks
Glazing/windows	Fireplace/woodburner	Floor	External Walls	<input checked="" type="checkbox"/> Roof <input checked="" type="checkbox"/>
Outbuildings	Other			

DESCRIPTION:

Soft cracking / MORTAR CRACKING

REPAIR STRATEGY:

Fill &amp; Paint / RE MORTAR

## LINE ITEMS:

DESCRIPTION:	Units	Length	Breadth	Depth	Qty	Rate	Cost
EXTERNAL WALLS - Soft Fill & Paint	HR				8	45	360
(Step cracking) - Cladding Brick	HR				8	50	400
- Degrading Paint Mat	EA				1	80	80
Materials	EA				1	30	30
- Boulder (Brickmold)	HR				2	45	90
Roof - Cladding							ND
- Framing							"
- Gutter							"
- Downpipes							"
- Weatherproof Coverings							"
- Eave Cladding							"
INSULATION - Roof							ND
- Walls							"
- Floor							"
INTERNAL WALLS - FRAMING ONLY							ND

Subtotal 960

+ P&amp;G, Margin &amp; GST Figure

TOTAL

\* Unit Categories to be used as follows:

Each, Sheet, Kilogram, Linear metre, Square metre, Cubic metre, Per Hour, Per Day, Per Week. Cubic metre calculations must include length, breadth and depth figures. Square metre calculations must include length and breadth figures.



# Scope of Works

Completed By:

**Peter Tucker**

Date:

Page 4 of 11

CLM

2011 /

065044

Claimant Name:

K Barnes

## Element Details:

Land	Building	<input checked="" type="checkbox"/> Bridges/culverts	Retaining walls	Other
Lounge	<input checked="" type="checkbox"/> Dining	<input checked="" type="checkbox"/> Kitchen	<input checked="" type="checkbox"/> Family Room	<input checked="" type="checkbox"/> Bedroom
Office/Study	Kumpus	Hallway	Stairwell	Toilet
Laundry	Bathroom	Ensuite	Chimney	Foundations
Piling	Services	Kitchen Ovens	Hot Water Cylinders	Header Tanks
Clazing/windows	Fireplace/woodburner	Floor	External Walls	Roof
Outbuildings	Other			

DESCRIPTION:

Gib Cracking

REPAIR STRATEGY:

Gibstop &amp; Paint

## LINE ITEMS:

DESCRIPTION:	Units	Length	Breadth	Depth	Qty	Rate	Cost
Lounge - WALLS Gibstopper	HR				4	45	180
- DECORATING WALLS Painter	m <sup>2</sup>	21.4	2.4		51.36	24	1232.64
- CEILING							
Gib Materials					1	20	20
Dining - WALLS (AS ABOVE)							
- DECORATING WALLS							
- CEILING							
Kitchen - WALLS (AS ABOVE)							
- DECORATING WALLS							
- CEILING							
Family Room - WALLS							N/A
- DECORATING WALLS							
- CEILING							

\* Unit Categories to be used as follows:

Each, Sheet, Kilogram, Linear metre, Square metre, Cubic metre,  
Per Hour, Per Day, Per Week. Cubic metre calculations must include  
length, breadth and depth figures. Square metre calculations must  
include length and breadth figures.

Subtotal

1432.64

+ P&amp;G, Margin &amp; CST Figure

TOTAL



# Scope of Works

Completed By:

Date:

**Peter Tucker**Page 5 of 11

CLM

2011 / 065044

Claimant Name:

H. Barnes

## Element Details:

Land	Building	<input checked="" type="checkbox"/> Bridges/culverts	Retaining walls	Other
Lounge	Dining	Kitchen	Family Room	Bedroom
Office/Study	Rumpus	Hallway	Stairwell	Toilet
Laundry	Bathroom	Ensuite	<input checked="" type="checkbox"/> Chimney	Foundations
Piling	Services	Kitchen Ovens	Hot Water Cylinders	Header Tanks
Clazing/windows	Fireplace/woodburner	Floor	External Walls	Roof
Outbuildings	Other			

### DESCRIPTION:

INTERIOR - EARTHQUAKE DAMAGE.

### REPAIR STRATEGY:

REDECORATE - REPAIR INTERIOR.

### LINE ITEMS:

DESCRIPTION:	Units	Length	Breadth	Depth	Qty	Rate	Cost
BR1 - WALLS	HR				2	45	90
- GIBSTOPPER							
- DECORATING WALLS	M <sup>2</sup>	17.0	2.4		40.8	24	979.20
- WINDOW	HR				4	45	180
- PAINTER							
- PAINT	EA				1	30	30
ENSUITE - WALLS							NA
- DECORATING WALLS							4
- CEILING							4
BR2 - WALLS	HR				2	45	90.00
- GIBSTOPPER							
- DECORATING WALLS	M <sup>2</sup>	12.4	2.4		29.76	24	714.24
- PAINTER							ND
- CEILING							
- WINDOW	HR				2	45	90.00
- PAINTER							
- PAINT	EA				1	30	30.00

Subtotal

+ P&amp;C, Margin &amp; GST Figure 2253.44

TOTAL

\* Unit Categories to be used as follows:

Each, Sheet, Kilogram, Linear metre, Square metre, Cubic metre, Per Hour, Per Day, Per Week. Cubic metre calculations must include length, breadth and depth figures. Square metre calculations must include length and breadth figures.





# Scope of Works

Completed By: Peter Tucker

Date: 11/6/11

Page 6 of 11

CLM 2011 / 065044

Claimant Name: K BARNES

## Element Details:

Land	Building	<input checked="" type="checkbox"/> Bridges/culverts	Retaining walls	Other
Lounge	Dining	Kitchen	Family Room	Bedroom <u>3</u>
Office/Study	Rumpus	Hallway	Stairwell	Toilet
Laundry	Bathroom	<input checked="" type="checkbox"/> Ensuite	Chimney	Foundations
Piling	Services	Kitchen Ovens	Hot Water Cylinders	Header Tanks
Glazing/windows	Fireplace/woodburner	Floor	External Walls	Roof
Outbuildings	Other			

### DESCRIPTION:

### REPAIR STRATEGY:

### LINE ITEMS:

DESCRIPTION:	Units	Length	Breadth	Depth	Qty	Rate	Cost
BR3 - walls <u>Gibstopper</u>	HR				2	45	90.00
-Decorating walls <u>Painter</u>	m <sup>2</sup>	14	2.4		33.6	24	806.40
-Ceiling							-
<u>Materials</u>	EA				1	20	20.00
BR4 - walls							NA
-Decorating walls							1
-Ceiling							1
Bathroom <u>Gibstopper</u>	HR				2	45	90
<u>Painter</u>	m <sup>2</sup>	8.4	2.4		20.16	24	483.84
<u>Materials</u>	EA				1	10	10

\* Unit Categories to be used as follows:

Each, Sheet, Kilogram, Linear metre, Square metre, Cubic metre, Per Hour, Per Day, Per Week. Cubic metre calculations must include length, breadth and depth figures. Square metre calculations must include length and breadth figures.

Subtotal 1500.24

+ P&G, Margin & GST Figure

TOTAL







# Scope of Works

Completed By:

CLM 2011 / 065044

Date:

Peter Tucker

Claimant Name:

K BARNES.

Page 8 of 11

## Element Details:

Land	Building	<input checked="" type="checkbox"/> Bridges/culverts	Retaining walls	Other
Lounge	Dining	Kitchen	Family Room	Bedroom
Office/Study	<del>Ramp</del> <i>Passage</i>	<input checked="" type="checkbox"/> Hallway	<input checked="" type="checkbox"/> Stairwell	<input checked="" type="checkbox"/> Toilet
Laundry	Bathroom	Ensuite	Chimney	Foundations
Piling	Services	Kitchen Ovens	Hot Water Cylinders	Header Tanks
Glazing/windows	Hireplace/woodburner	Floor	External Walls	Roof
Outbuildings	Other			

### DESCRIPTION:

### REPAIR STRATEGY:

### LINE ITEMS:

DESCRIPTION:	Units	Length	Breadth	Depth	Qty	Rate	Cost
<i>Passage</i> - walls <i>Gibstopper</i>	HE				2	45	90.00
- Decorating walls <i>Paint</i>	m <sup>2</sup>	14.6	2.4		35.44	24	840.96
- Ceiling							-
<i>Gib material</i>	EA				1	20	20.00
<i>Entry</i> - walls							NA
<i>Hall</i> - Decorating walls							"
- Ceiling							"
<i>Stairwell</i> - walls							NA
- Decorating walls							"
- Ceiling							"

\* Unit: Categories to be used as follows:

Each, Sheet, Kilogram, Linear metre, Square metre, Cubic metre, Per Hour, Per Day, Per Week. Cubic metre calculations must include length, breadth and depth figures. Square metre calculations must include length and breadth figures.

Subtotal

950.96

+ P&amp;G, Margin &amp; GST Figure

TOTAL





# Scope of Works

Completed By: **Peter Tucker**

Date: **4/6/2011**

Page **10** of **11**

CLM **2011 / 065044**

Claimant Name:

**Baines**

## Element Details:

Land	Building	<input checked="" type="checkbox"/>	Bridges/culverts	Retaining walls	Other
Lounge	Dining		Kitchen	Family Room	Bedroom
Office/Study	Rumpus		Hallway	Stairwell	Toilet
Laundry	Bathroom		Ensuite	Chimney	Foundations
Piling	Services		Kitchen Overs	Hot Water Cylinders	Header Janks
Glazing/windows	Fireplace/woodburner		Floor	External Walls	Roof
Outbuildings	Other		<b>Windows</b>		

### DESCRIPTION:

**Paint cracking on window frames.**

### REPAIR STRATEGY:

**RE Paint Frames**

### LINE ITEMS:

DESCRIPTION:	Units	Length	Breadth	Depth	Qty	Rate	Cost
Windows & Doors (EXTERNAL) <b>Paint Windows</b>	HA				8	45	360
<b>PAINT</b>	EA				1	80	80
Doors (INTERNAL)							ND
SERVICES							ND
OUT BUILDING - GARAGE							ND
CHIMNEY Repair Roof OP. \$3210 less Skip Bnl \$330	EA						2880
SUNDERES							NA
EXTERNAL WORKS							NA
HAZARDOUS MATERIALS							

Subtotal **3320.00**

+ P&C, Margin & GST Figure

TOTAL

\* Unit Categories to be used as follows:

Each, Sheet, Kilogram, Linear metre, Square metre, Cubic metre,  
Per Hour, Per Day, Per Week. Cubic metre calculations must include  
length, breadth and depth figures. Square metre calculations must  
include length and breadth figures.





# Scope of Works

Completed By: **Peter Tucker**

CLM 2011 / 065044

Claimant Name:

*K. BARNES.*

Date:

Page 11 of 11

## Element Details:

Land	Building	<input checked="" type="checkbox"/> Bridges/culverts	Retaining walls	Other
Lounge	Dining	Kitchen	Family Room	Bedroom
Office/Study	Rumpus	Hallway	Stairwell	Toilet
Laundry	Bathroom	Ensuite	Chimney	Foundations
Piling	Services	Kitchen Ovens	Hot Water Cylinders	Header Tanks
Clazing/windows	Fireplace/woodburner	Floor	External Walls	Roof
Outbuildings	Other			

DESCRIPTION:

*Summary*

REPAIR STRATEGY:

## LINE ITEMS:

DESCRIPTION:

Units Length Breadth Depth Qty Rate Cost

*PAGE 1 Subtotal*

*1 2 11*

*1 3 11*

*1 4 11*

*1 5 11*

*1 6 11*

*1 7 11*

*1 8 11*

*✓ 9 ✓*

*✓ 10 ✓*

960.00

1432.64

2253.44

1500.24

950.96

3320.00

Subtotal 10457.28

P&G, Margin & CST Figure 3814.80

TOTAL 14272.08

\* Unit Categories to be used as follows:

Each, Sheet, Kilogram, Linear metre, Square metre, Cubic metre, Per Hour, Per Day, Per Week. Cubic metre calculations must include length, breadth and depth figures. Square metre calculations must include length and breadth figures.









APPROVED

Date:	Claim Number: 2010/	Estimator Name:
11.6-2011	204 / 065044g	Peter Tucker

## Dwelling Inspection Checklist: Show measurements indicate damage

<p>NA</p> <p>Stairwell</p>	<p>1-8</p> <p>ND</p> <p>19</p> <p>Laundry</p>	<p>6</p> <p>ND</p> <p>Outbuilding/Garage</p>	3.9
<p>N</p> <p>LOOSE BRICK BY KITCHEN WINDOW</p>	<p>S</p> <p>MORTAR CRACKING 2m</p>	<p>E</p> <p>BRICK</p> <ul style="list-style-type: none"> <li>- STEP CRACKING - 5</li> <li>- MORTAR FALLEN OUT UNDER BRI WINDOW 3m</li> <li>- BRICK MOULD FALLEN OFF 2 LONG</li> </ul>	
<p>W</p> <p>MORTAR FALLEN OUT UNDER KITCHEN &amp; WC WINDOW 3m</p> <p>WINDOW FRAME PAINT CRACKING BR 1.3 &amp; LAUNDRY</p>	<p>ROOF</p> <p>NO</p>	<p>FOUNDATION / FLOOR</p> <p>ND</p>	
<p>Chimney</p> <p>16 x 16</p> <p>1.5</p> <p>3.2</p>			

Legend

	Crack to ceiling (show length)
	Crack to wall (show length)
	External damage
	Foundation damage



Date:

Claim Number: 2010/

Estimator Name:

11 - 6 - 2011

204 / 065 Oldy

Peter Tucker

# Dwelling Inspection Checklist: Show measurements indicate damage

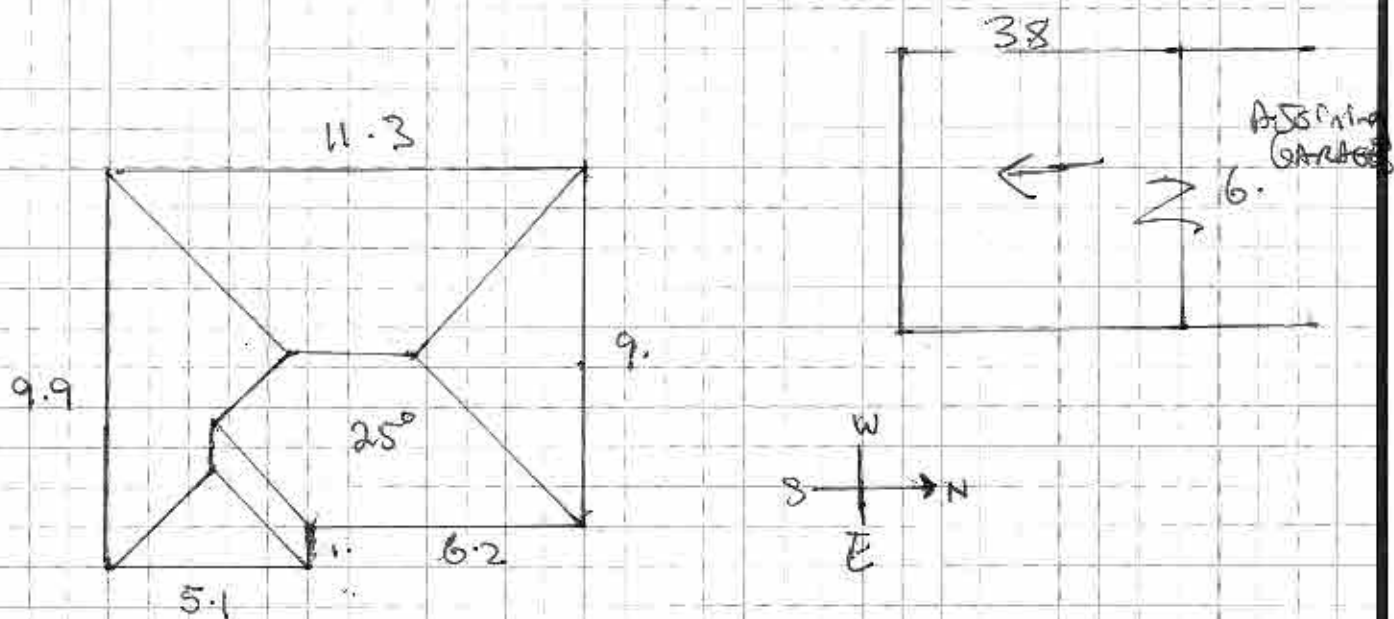

Area m2:	130
Stud Heights:	24
Wall Finish:	<input type="checkbox"/> Wallpaper <input type="checkbox"/> Plastered <input checked="" type="checkbox"/> Paint Finish
Other:	
Services:	Specify Damage: <b>ND</b>
Chimneys:	Construction Type: <b>BRICK</b> Height: <b>4-7</b> Damage Description: <input checked="" type="checkbox"/> Above Roof <input type="checkbox"/> Below Roof         Total Repair: <b>ABOVE ROOF</b>
Foundations Damage:	Timber <input checked="" type="checkbox"/> Concrete Ring <input type="checkbox"/> Concrete Slab         Other (Specify): <b>NO</b> Minor <input type="checkbox"/> Moderate <input type="checkbox"/> Severe <input checked="" type="checkbox"/> NO         House Moved off Foundations? <b>NO</b> Concrete Slab Cracked? Crack Width: <b>NA</b> Crack Length: <b>NA</b>
Roof:	<input checked="" type="checkbox"/> Framed <input type="checkbox"/> Trussed         Pitch: <b>250</b> Type: <input type="checkbox"/> Clay Tiles <input checked="" type="checkbox"/> Concrete Tiles <input type="checkbox"/> Rolled Metal         Other: <b>NO</b> Damage: <b>NO</b>
Cladding Type:	<input type="checkbox"/> Weatherboard <input checked="" type="checkbox"/> Brick Veneer <input type="checkbox"/> Hardi Plank         Other: <b>NO</b>





# Scope of Works



## Document explanatory note:

This document provides a summary of the earthquake damage identified by the EQC assessment team. Land, building and room by room damage is listed along with an indication of how this damage is to be repaired. A glossary of terms describing the type of damage that may be listed on your Scope of Works is provided at the end of this document.

**Customer:** KAREN BARNES

## Assessment of Property at 74 AMYES ROAD, HORNBY, CHRISTCHURCH 8042 on 13/07/2011

### Site

Element	Damage	Repair
Land (Exposed - Soil - 455.00 m2)		
Land (Exposed - Soil - 140.00 m2)		

### Services

Element	Damage	Repair
Sewerage (Town Connection - PVC Pipe - 35.00 l/m)	No Earthquake Damage	
Water Supply (Town Connection - Plastic - 30.00 l/m)	No Earthquake Damage	

## Main Building

### Exterior

#### Elevation (North 11.4x2.4 step cracking, loose and cracked bricks)

Element	Damage	Repair
Wall Cladding (Brick Veneer - Brick - 27.36 m2)	Cracking	Grind out and repoint mortar 4.00 l/m
	Structural damage	Remove, dispose and replace bricks 0.02 m2
	Structural damage	Relay and re-bed loose bricks 0.10 m2
Wall framing (Timber Frame - Timber - 27.36 m2)	No Earthquake Damage	

#### Elevation (South 11.4x2.4 step cracks)

Element	Damage	Repair
Wall Cladding (Brick Veneer - Brick - 27.36 m2)	Cracking	Grind out and repoint mortar 2.00 l/m
Wall framing (Timber Frame - Timber - 27.36 m2)	No Earthquake Damage	

#### Elevation (East 10.0x2.4 step cracking)

Element	Damage	Repair
Wall Cladding (Brick Veneer - Brick - 24.00 m2)	Cracking	Grind out and repoint mortar 2.00 l/m
Wall framing (Timber Frame - Timber - 24.00 m2)	No Earthquake Damage	

#### Elevation (West 10.0x2.4 step cracks)

Element	Damage	Repair
Wall Cladding (Brick Veneer - Brick - 24.00 m2)	Cracking	Grind out and repoint mortar 5.00 l/m

Wall framing (Timber Frame - Timber - No Earthquake Damage  
24.00 m2)

#### Foundations (Concrete ring 42.8m/ concrete piles)

Element	Damage	Repair
No Damage		

#### Roof (35\* concrete tile 121.7m2. Displaced tiles & 1 broken, cracked soffits)

Element	Damage	Repair	
Roof Covering (Pitched - Concrete tile - 121.70 m2)	Impact damage	Realign roof tiles	4.00 m2
Roof framing (Framed - Timber - 121.70 m2)	No Earthquake Damage		
Soffit (Cement Sheet - Cement sheet 4.5mm - 14.98 m2)	Cracked soffit lining	Gap fill	1.50 l/m
	Cracked soffit lining	Paint cracked soffit	14.97 m2

#### Chimney (Exterior) (.500x.500 brick chimney collapsed to .500 above roof line)

Element	Damage	Repair	
One story chimney (Single Pot - Brick - 1.00 item)	Collapsed chimney	EXT - Brick - Ceiling - 1 POT	1.00 item

#### Interior

##### Ground Floor - Toilet

Room Size: 1.80 x 0.90 = 1.62 (length(m) x width(m) = Area Size(m2))

Stud Height: 2.50 m

Element	Damage	Repair
No Damage		

##### Ground Floor - Laundry (Wall cracks.)

Room Size: 2.00 x 1.80 = 3.60 (length(m) x width(m) = Area Size(m2))

Stud Height: 2.50 m

Element	Damage	Repair	
Ceiling (Other - Paint - 3.60 m2)	No Earthquake Damage		
Floor (T&G - Bare floor boards - 3.60 m2)	No Earthquake Damage		
Wall covering (Hardboard - Paint - 19.00 m2)	Cosmetic damage	Paint wall	4.50 m2
Wash tub (Single - Stainless Steel - 1.00 item)	No Earthquake Damage		
Window (Timber medium - Pane single glazed - 2.00 No of)	No Earthquake Damage		

##### Ground Floor - Entry (By back door/laundry. Ceiling cracks.)

Room Size: 1.10 x 1.90 = 2.09 (length(m) x width(m) = Area Size(m2))

Stud Height: 2.20 m

Element	Damage	Repair	
Ceiling (Other - Paint - 2.09 m2)	Cosmetic Damage	Paint Ceiling	2.09 m2
Door (External) (SG Single - Timber - 1.00 item)	No Earthquake Damage		
Floor (Chipboard - Carpet - 2.09 m2)	No Earthquake Damage		
Wall covering (Hardboard - Paint - 13.20 m2)	No Earthquake Damage		

##### Ground Floor - Bathroom (Ceiling and wall cracks.)

Room Size: 2.40 x 1.80 = 4.32 (length(m) x width(m) = Area Size(m2))

Stud Height: 2.40 m

Element	Damage	Repair	
Bath (Acrylic - Standard specification - 1.00 item)	No Earthquake Damage		
Bathroom Sink (Basin - Standard specification - 1.00 item)	No Earthquake Damage		
Ceiling (Gib - Paint - 4.32 m2)	Cosmetic Damage	Rake out, plaster and paint	4.32 m2
Door (Internal) (Single Hollow Core - Timber - 1.00 No of)	No Earthquake Damage		
Floor (Chipboard - Vinyl - 4.32 m2)	No Earthquake Damage		
Mirror (Fixed) (Standard Spec - Mirror - .45 m2)	No Earthquake Damage		
Shower (Cubical shower unit - Glass - .68 m2)	No Earthquake Damage		
Wall covering (Gib - Paint - 20.16 m2)	Cosmetic damage	Rake out, plaster and paint	20.16 m2
Window (Aluminium Awning - Pane single glazed - 1.00 No of)	No Earthquake Damage		

#### Ground Floor - Kitchen (Includes dining. Wall cracks, ceiling paint cracks.)

Room Size: 4.30 x 2.80 = 12.04 (length(m) x width(m) = Area Size(m2))

Stud Height: 2.40 m

Element	Damage	Repair	
Ceiling (Pinex Tiles - Paint - 12.04 m2)	Cosmetic Damage	Paint Ceiling	12.04 m2
Door (Internal) (Glass panel door - Timber - 1.00 No of)	No Earthquake Damage		
Floor (T&G - T+G polished timber - 12.04 m2)	No Earthquake Damage		
Kitchen joinery (Medium Spec - MDF - 1.00 item)	No Earthquake Damage		
Range ( Free standing oven ) (Electric - Standard Electric - 1.00 item)	No Earthquake Damage		
Range Hood (Over Head - Standard spec - 1.00 item)	No Earthquake Damage		
Wall covering (Solid plaster - Paint - 34.08 m2)	Cosmetic damage	Rake out, plaster and paint	23.76 m2
Window (Timber medium - Pane single glazed - 1.00 No of)	No Earthquake Damage		
Work top (Kitchen work top - Laminate - 5.50 l/m)	No Earthquake Damage		

#### Ground Floor - Lounge (Wall cracks.)

Room Size: 4.10 x 3.70 = 15.17 (length(m) x width(m) = Area Size(m2))

Stud Height: 2.40 m

Element	Damage	Repair	
Ceiling (Other - Paint - 15.17 m2)	No Earthquake Damage		
Door (Internal) (Single Hollow Core - Timber - 1.00 No of)	No Earthquake Damage		
Floor (T&G - Carpet - 15.17 m2)	No Earthquake Damage		
Wall covering (Solid plaster - Paint - 37.44 m2)	Cosmetic damage	Gap fill cracks	3.00 l/m
	Cosmetic damage	Rake out, plaster and paint	37.44 m2
Window (Timber medium - Pane single glazed - 2.00 No of)	No Earthquake Damage		

#### Ground Floor - Bedroom (Bedroom 3, centre south. Wall cracks.)

Room Size: 3.40 x 2.80 = 9.52 (length(m) x width(m) = Area Size(m2))

Stud Height: 2.40 m

Element	Damage	Repair	
Ceiling (Other - Paint - 9.52 m2)	No Earthquake Damage		
Door (Internal) (Single Hollow Core - Timber - 1.00 No of)	No Earthquake Damage		
Floor (T&G - Carpet - 9.52 m2)	No Earthquake Damage		
Wall covering (Solid plaster - Paint - 29.76 m2)	Cosmetic damage	Rake out and stop	2.60 l/m
	Cosmetic damage	Remove, supply and replace Lining paper	13.44 m2
	Cosmetic damage	Paint wall	29.76 m2
Window (Timber medium - Pane single glazed - 1.00 No of)	No Earthquake Damage		

#### Ground Floor - Bedroom (Bedroom 2, Nicholas room. Wall and ceiling cracks.)

Room Size: 3.30 x 3.60 = 11.88 (length(m) x width(m) = Area Size(m2))

Stud Height: 2.40 m

Element	Damage	Repair	
Ceiling (Other - Paint - 11.88 m2)	Cosmetic Damage	Refix ceiling	
	Cosmetic Damage	Remove, supply, replace wall paper and paint	11.88 m2
Door (Internal) (Single Hollow Core - Timber - 1.00 No of)	No Earthquake Damage		
Floor (T&G - Carpet - 11.88 m2)	No Earthquake Damage		
Wall covering (Solid plaster - Paint - 33.12 m2)	Cosmetic damage	Remove, supply, replace lining paper and paint	33.12 m2
Window (Timber medium - Pane single glazed - 2.00 No of)	No Earthquake Damage		

#### Ground Floor - Bedroom (Main bedroom, Simons room. Wall and ceiling cracks.)

Room Size: 4.00 x 4.60 = 18.40 (length(m) x width(m) = Area Size(m2))

Stud Height: 2.40 m

Element	Damage	Repair	
Ceiling (Other - Paint - 18.40 m2)	Cosmetic Damage	Refix trims	4.00 l/m
	Cosmetic Damage	Paint Ceiling	18.40 m2
Door (Internal) (Single Hollow Core - Timber - 1.00 No of)	No Earthquake Damage		
Floor (T&G - Carpet - 18.40 m2)	No Earthquake Damage		
Wall covering (Solid plaster - Paint - 41.28 m2)	Cosmetic damage	Remove, supply and replace Lining paper	9.60 m2
	Cosmetic damage	Remove, rake out, plaster, supply and replace wallpaper	31.68 m2
	Cosmetic damage	Paint wall	41.28 m2
Window (Timber medium - Pane single glazed - 1.00 No of)	No Earthquake Damage		

#### Ground Floor - Hallway (Includes main entry. Wall cracks.)

Room Size: 5.90 x 1.70 = 10.03 (length(m) x width(m) = Area Size(m2))

Stud Height: 2.40 m

Element	Damage	Repair	
Ceiling (Other - Paint - 10.03 m2)	No Earthquake Damage		
Door (External) (DG French - Timber - 1.00 item)	No Earthquake Damage		
Floor (T&G - T+G polished timber - 10.03 m2)	No Earthquake Damage		
Wall covering (Solid plaster - Paint - 36.48 m2)	Cosmetic damage	Remove, supply, replace lining paper and paint	36.48 m2
	Cosmetic damage	Rake out and stop	2.40 l/m



## Garage

### Exterior

#### Elevation (North 6.0x 2.1)

Element	Damage	Repair
---------	--------	--------

No Damage

#### Elevation (South internal gibbed wall adjoining neighbouring garage)

Element	Damage	Repair
---------	--------	--------

No Damage

#### Elevation (East 3.9x 2.1)

Element	Damage	Repair
---------	--------	--------

No Damage

#### Elevation (West 3.9x2.1)

Element	Damage	Repair
---------	--------	--------

No Damage

#### Foundations (Concrete slab 23.4m2)

Element	Damage	Repair
---------	--------	--------

No Damage

#### Roof (15\* rolled metal 23.4m2)

Element	Damage	Repair
---------	--------	--------

No Damage

### Interior

#### Ground Floor - Room (Other) (Garage interior.)

Room Size: 5.90 x 3.80 = 22.42 (length(m) x width(m) = Area Size(m2))

Stud Height: 2.20 m

Element	Damage	Repair
---------	--------	--------

No Damage

#### Scope of Works - Glossary of Terms

<b>Cosmetic Damage</b>	Cosmetic damage is used to record repairs to an element that can be done in situ e.g. minor cracking to plasterboard. For example a repair strategy may state "rake, stop and paint" and this is carried out without needing to remove or replace the damaged element. Where the plasterboard for example needs to be removed and replaced, this will be recorded as 'structural damage'.
<b>Impact Damage</b>	Impact damage is where an element or part of a building sustains earthquake damage and then breaks away or collapses causing damage to another part of the building. An example is a chimney that has collapsed and caused damage to roof tiles.
<b>Structural Damage</b>	The term structural damage is used where a repair requires an element to be removed and replaced e.g. major cracking to plasterboard or external cladding that has been dislodged. This term does not relate to the structural integrity of the building as a whole, but to the individual element only.

#### Additional Information

<b>Building Terms</b>	The Department of Building and Housing website has a comprehensive list of common building terms: <a href="http://www.dbh.govt.nz/building-az-wxyz">http://www.dbh.govt.nz/building-az-wxyz</a>
-----------------------	---

# EQC Full Assessment Report

**Claim Number:** CLM/2011/204158  
**Claimant:** KAREN BARNES  
**Property Address:** 74 AMYES ROAD  
 HORNBY  
 CHRISTCHURCH 8042

**Assessment Date:** 13/07/2011 16:42  
**Assessor:** White, Gordon  
**Estimator:** Kallahar, Steve  
**Property Occupied By:** Owner Occupied

## Claimant Setup

Type	Name	Home Number	Mobile Number	Work Number	Email Address
Owner	KAREN, BARNES				

## Insurance & Mortgage Details

### Insurance Details - From Claim Centre

Insurer	Policy Type	Policy Number	Insurance Sighted	Insurance Valid
Westpac (Lumley Group)	Dwelling		Yes	

### Insurance Details - Added in COMET

Insurer	Policy Type	Policy Number	Insurance Sighted	Insurance Valid
---------	-------------	---------------	-------------------	-----------------

### Insurance Details - Comments

### Mortgage Details - From Claim Centre

Bank
------

### Mortgage Details - Added in COMET

Bank
WESTPAC NEW ZEALAND LIMITED

### Mortgage Details - Comments

## Opt Out

For repairs costing between \$10,000 and \$100,000 the claimant wishes to manage their own repairs? No

## Hazards

**Hazards:** Nil. Dwelling habitable and waterproof. Area zoned green. Damage approximately 25% Sept 2010, 25%Feb 2011, 50% June 20, 2011.

**Property Sticker:** No Sticker

## Building Configurations

Leaky Home Syndrome? No

Building Name	Number of floors	Building Finish	Age of house	Footprint	Area (m2)
Main Building	1	Standard	1935 - 1960	Rectangular	91.59
Garage	1	Standard	Post 1980	Rectangular	22.91

## Full Assessment

### Site

Element	Type	Material	Damages	Measure	Rate	Cost
Land	Exposed	Soil	No Earthquake Damage			
			No Earthquake Damage			

**General Comments:**

### Services

Element	Type	Material	Damages	Measure	Rate	Cost
Sewerage	Town Connection	PVC Pipe	No Earthquake Damage			
Water Supply	Town Connection	Plastic	No Earthquake Damage			

**General Comments:**

### Main Building

#### Exterior

#### Elevation (North 11.4x2.4 step cracking, loose and cracked bricks)

**Damage:** Earthquake damage

**Require Scaffolding?** No

Element	Type	Material	Damages	Measure	Rate	Cost
Wall Cladding	Brick Veneer	Brick	Cracking			
			Grind out and repoint mortar	4.00 l/m	35.00	140.00
			Structural damage			
			Remove, dispose and replace bricks	0.02 m2	154.00	3.08
			Structural damage			
			Relay and re-bed loose bricks	0.10 m2	85.00	8.50
Wall framing	Timber Frame	Timber	No Earthquake Damage			

**General Comments:** Brick veneer, timber windows. 1.8x1.2 entry porch with timber decking and 1.6x1.0 attached concrete steps. Step cracking, loose top bricks, 1 cracked brick.

#### Elevation (South 11.4x2.4 step cracks)

**Damage:** Earthquake damage

**Require Scaffolding?** No

Element	Type	Material	Damages	Measure	Rate	Cost
Wall Cladding	Brick Veneer	Brick	Cracking			
			Grind out and repoint mortar	2.00 l/m	35.00	70.00
Wall framing	Timber Frame	Timber	No Earthquake Damage			

**General Comments:** brick veneer, timber joinery. 1.4x1.2 attached concrete entry porch, steel frame clad with clearlight walls and iron roof. Step cracking to bricks.

#### Elevation (East 10.0x2.4 step cracking)

**Damage:** Earthquake damage

**Require Scaffolding?** No

Element	Type	Material	Damages	Measure	Rate	Cost
Wall Cladding	Brick Veneer	Brick	Cracking			
			Grind out and repoint mortar	2.00 l/m	35.00	70.00
Wall framing	Timber Frame	Timber	No Earthquake Damage			

**General Comments:** brick veneer, timber joinery. Vertical separation crack to brick chimney/ elevation wall

#### Elevation (West 10.0x2.4 step cracks)

**Damage:** Earthquake damage

**Require Scaffolding?** No

Element	Type	Material	Damages	Measure	Rate	Cost
Wall Cladding	Brick Veneer	Brick	Cracking			
			Grind out and repoint mortar	5.00 l/m	35.00	175.00
Wall framing	Timber Frame	Timber	No Earthquake Damage			

**General Comments:** brick veneer, timber joinery. Step cracking.

**Foundations (Concrete ring 42.8m/ concrete piles)****Damage:** No damage**Require Scaffolding?** No**General Comments:** .400 splatercoat plastered concrete ring 42.8m, approx 57 concrete piles**Roof (35\* concrete tile 121.7m2. Displaced tiles & 1 broken, cracked soffits)****Damage:** Earthquake damage**Require Scaffolding?** No

Element	Type	Material	Damages	Measure	Rate	Cost
Roof Covering	Pitched	Concrete tile	Impact damage			
			Realign roof tiles	4.00 m2	15.00	60.00
Roof framing	Framed	Timber	No Earthquake Damage			
Soffit	Cement Sheet	Cement sheet 4.5mm	Cracked soffit lining			
			Gap fill	1.50 l/m	10.00	15.00
			Cracked soffit lining			
			Paint cracked soffit	14.97 m2	28.00	419.16

**General Comments:** .350 painted cement sheet soffit, 45.6m pvc spouting, 3 pvc downpipes, 35\* concrete tiles on timber framed roof. Soffits have cracking and paint separation at wall junction. Allow to gap fill cracks and paint all soffit Displaced tiles= approx 2 m2 on south side and approx 2m2 on north side with one broken tile on north side also.

**Chimney (Exterior) (.500x.500 brick chimney collapsed to .500 above roof line)****Damage:** Earthquake damage**Require Scaffolding?** No

Element	Type	Material	Damages	Measure	Rate	Cost
One story chimney	Single Pot	Brick	Collapsed chimney			
			EXT - Brick - Ceiling - 1 POT	1.00 item	3,210.00	3,210.00

**General Comments:** .500x.500 brick chimney has collapsed to .500 above roof line and needs to be removed to roof line and allow to rebuild to approx 2.5m above roof line. Chimney is not live in dwelling and external 1.3x.200X2.4 high soffit to base section has only a minor vertical separation crack on one side and has been allowed for in east elevation cladding repair.

**Ground Floor - Toilet****Damage:** No damage**Require Scaffolding?** No**General Comments:** Painted walls and ceiling, unpainted hardboard overlay floor. One door, one window.**Ground Floor - Laundry (Wall cracks.)****Damage:** Earthquake damage**Require Scaffolding?** No

Element	Type	Material	Damages	Measure	Rate	Cost
Ceiling	Other	Paint	No Earthquake Damage			
Floor	T&G	Bare floor boards	No Earthquake Damage			
Wall covering	Hardboard	Paint	Cosmetic damage			
			Paint wall	4.50 m2	24.00	108.00
Wash tub	Single	Stainless Steel	No Earthquake Damage			
Window	Timber medium	Pane single glazed	No Earthquake Damage			

**General Comments:** Painted walls and ceiling, unpainted hardboard overlay floor. Two windows, open to rear entry.

**Ground Floor - Entry (By back door/laundry. Ceiling cracks.)****Damage:** Earthquake damage**Require Scaffolding?** No

Element	Type	Material	Damages	Measure	Rate	Cost
Ceiling	Other	Paint	Cosmetic Damage			
			Paint Ceiling	2.09 m2	24.00	50.16
Door (External)	SG Single	Timber	No Earthquake Damage			
Floor	Chipboard	Carpet	No Earthquake Damage			
Wall covering	Hardboard	Paint	No Earthquake Damage			

**General Comments:** Painted walls and ceiling, unpainted hardboard overlay floor. One external door, no windows.

**Ground Floor - Bathroom (Ceiling and wall cracks.)**



**Damage:** Earthquake damage**Require Scaffolding?** No

Element	Type	Material	Damages	Measure	Rate	Cost
Bath	Acrylic	Standard specification	No Earthquake Damage			
Bathroom Sink	Basin	Standard specification	No Earthquake Damage			
Ceiling	Gib	Paint	Cosmetic Damage			
			Rake out, plaster and paint	4.32 m2	34.00	146.88
Door (Internal)	Single Hollow Core	Timber	No Earthquake Damage			
Floor	Chipboard	Vinyl	No Earthquake Damage			
Mirror (Fixed)	Standard Spec	Mirror	No Earthquake Damage			
Shower	Cubical shower unit	Glass	No Earthquake Damage			
Wall covering	Gib	Paint	Cosmetic damage			
			Rake out, plaster and paint	20.16 m2	34.00	685.44
Window	Aluminium Awning	Pane single glazed	No Earthquake Damage			

**General Comments:** Painted walls and ceiling, vinyl floor. One door, one window.**Ground Floor - Kitchen (Includes dining. Wall cracks, ceiling paint cracks.)****Damage:** Earthquake damage**Require Scaffolding?** No

Element	Type	Material	Damages	Measure	Rate	Cost
Ceiling	Pinex Tiles	Paint	Cosmetic Damage			
			Paint Ceiling	12.04 m2	24.00	288.96
Door (Internal)	Glass panel door	Timber	No Earthquake Damage			
Floor	T&G	T+G polished timber	No Earthquake Damage			
Kitchen joinery	Medium Spec	MDF	No Earthquake Damage			
Range ( Free standing oven )	Electric	Standard Electric	No Earthquake Damage			
Range Hood	Over Head	Standard spec	No Earthquake Damage			
Wall covering	Solid plaster	Paint	Cosmetic damage			
			Rake out, plaster and paint	23.76 m2	34.00	807.84
Window	Timber medium	Pane single glazed	No Earthquake Damage			
Work top	Kitchen work top	Laminate	No Earthquake Damage			

**General Comments:** Painted ceilings and walls, polished t&g floor. One door, one window, open to lounge.**Ground Floor - Lounge (Wall cracks.)****Damage:** Earthquake damage**Require Scaffolding?** No

Element	Type	Material	Damages	Measure	Rate	Cost
Ceiling	Other	Paint	No Earthquake Damage			
Door (Internal)	Single Hollow Core	Timber	No Earthquake Damage			
Floor	T&G	Carpet	No Earthquake Damage			
Wall covering	Solid plaster	Paint	Cosmetic damage			
			Gap fill cracks	3.00 l/m	12.00	36.00
			Cosmetic damage			
			Rake out, plaster and paint	37.44 m2	34.00	1,272.96
Window	Timber medium	Pane single glazed	No Earthquake Damage			

**General Comments:** Painted walls and ceiling, carpet floor. Two windows, one door, open to kitchen.**Ground Floor - Bedroom (Bedroom 3, centre south. Wall cracks.)****Damage:** Earthquake damage**Require Scaffolding?** No

Element	Type	Material	Damages	Measure	Rate	Cost
Ceiling	Other	Paint	No Earthquake Damage			
Door (Internal)	Single Hollow Core	Timber	No Earthquake Damage			
Floor	T&G	Carpet	No Earthquake Damage			

Wall covering	Solid plaster	Paint	Cosmetic damage			
			Rake out and stop	2.60 l/m	10.00	26.00
			Cosmetic damage			
			Remove, supply and replace Lining paper	13.44 m2	30.00	403.20
			Cosmetic damage			
			Paint wall	29.76 m2	24.00	714.24

Window Timber medium Pane single glazed No Earthquake Damage

**General Comments:** Painted lining paper walls, painted wallpaper ceiling, carpet floor. One door, one window.

**Ground Floor - Bedroom (Bedroom 2, Nicholas room. Wall and ceiling cracks.)**

**Damage:** Earthquake damage

**Require Scaffolding?** No

Element	Type	Material	Damages	Measure	Rate	Cost
Ceiling	Other	Paint	Cosmetic Damage			
			Refix ceiling	250.00 \$	0.00	250.00
			Cosmetic Damage			
			Remove, supply, replace wall paper and paint	11.88 m2	67.00	795.96
Door (Internal)	Single Hollow Core	Timber	No Earthquake Damage			
Floor	T&G	Carpet	No Earthquake Damage			
Wall covering	Solid plaster	Paint	Cosmetic damage			
			Remove, supply, replace lining paper and paint	33.12 m2	55.00	1,821.60

Window Timber medium Pane single glazed No Earthquake Damage

**General Comments:** Painted lining paper walls, painted wallpaper ceiling, carpet floor. One door, two windows.

**Ground Floor - Bedroom (Main bedroom, Simons room. Wall and ceiling cracks.)**

**Damage:** Earthquake damage

**Require Scaffolding?** No

Element	Type	Material	Damages	Measure	Rate	Cost
Ceiling	Other	Paint	Cosmetic Damage			
			Refix trims	4.00 l/m	9.00	36.00
			Cosmetic Damage			
			Paint Ceiling	18.40 m2	24.00	441.60
Door (Internal)	Single Hollow Core	Timber	No Earthquake Damage			
Floor	T&G	Carpet	No Earthquake Damage			
Wall covering	Solid plaster	Paint	Cosmetic damage			
			Remove, supply and replace Lining paper	9.60 m2	30.00	288.00
			Cosmetic damage			
			Remove, rake out, plaster, supply and replace wallpaper	31.68 m2	43.00	1,362.24
			Cosmetic damage			
			Paint wall	41.28 m2	24.00	990.72

Window Timber medium Pane single glazed No Earthquake Damage

**General Comments:** Paint one wall, painted wallpaper three walls, stipple ceiling, carpet floor. One door, one window.

**Ground Floor - Hallway (Includes main entry. Wall cracks.)**

**Damage:** Earthquake damage

**Require Scaffolding?** No

Element	Type	Material	Damages	Measure	Rate	Cost
Ceiling	Other	Paint	No Earthquake Damage			
Door (External)	DG French	Timber	No Earthquake Damage			
Floor	T&G	T+G polished timber	No Earthquake Damage			
Wall covering	Solid plaster	Paint	Cosmetic damage			
			Remove, supply, replace lining paper and paint	36.48 m2	55.00	2,006.40

Wall covering	Solid plaster	Paint	Cosmetic damage			
			Rake out and stop	2.40 l/m	10.00	24.00

**General Comments:** Paint on lining paper walls, paint on wallpaper ceiling, varnished t&g floor. One external door.

## Garage

### Exterior

#### Elevation (North 6.0x 2.1)

**Damage:** No damage

**Require Scaffolding?** No

**General Comments:** metal weatherboard clad versatile garage.

#### Elevation (South internal gibbed wall adjoining neighbouring garage)

**Damage:** No damage

**Require Scaffolding?** No

**General Comments:**

#### Elevation (East 3.9x 2.1)

**Damage:** No damage

**Require Scaffolding?** No

**General Comments:** metal weatherboard clad versatile garage.

#### Elevation (West 3.9x2.1)

**Damage:** No damage

**Require Scaffolding?** No

**General Comments:** metal weatherboard clad versatile garage.

#### Foundations (Concrete slab 23.4m2)

**Damage:** No damage

**Require Scaffolding?** No

**General Comments:**

#### Roof (15\* rolled metal 23.4m2)

**Damage:** No damage

**Require Scaffolding?** No

**General Comments:** 7.8m metal spouting, 2 metal downpipes, 23.4m2 rolled metal on timber trussed roof.

#### Ground Floor - Room (Other) (Garage interior.)

**Damage:** No damage

**Require Scaffolding?** No

**General Comments:**

## Fees

### Fees

Name	Duration	Estimate
Small Job Fee	1.00	180.00

### Overheads

Name	Estimate
Preliminary and general	1,338.16
Margin	1,824.51
GST	3,010.44

## Scope Of Works Estimate

### Property

Description	Estimate
Site	0.00
Services	0.00
	0.00

### Main Building

Name	Description	Estimate
Exterior	Chimney (Exterior) (.500x.500 brick chimney collapsed to .500 above roof line)	3,210.00
	Roof (35* concrete tile 121.7m2. Displaced tiles & 1 broken, cracked soffits)	494.16
	Foundations (Concrete ring 42.8m/ concrete piles)	0.00
	Elevation (East 10.0x2.4 step cracking)	70.00
	Elevation (North 11.4x2.4 step cracking, loose and cracked bricks)	151.58
	Elevation (South 11.4x2.4 step cracks)	70.00
	Elevation (West 10.0x2.4 step cracks)	175.00
		4,170.74

Floor	Description	Estimate
Ground Floor	Bathroom (Ceiling and wall cracks.)	832.32
	Bedroom (Bedroom 2, Nicholas room. Wall and ceiling cracks.)	2,867.56
	Bedroom (Bedroom 3, centre south. Wall cracks.)	1,143.44
	Bedroom (Main bedroom, Simons room. Wall and ceiling cracks.)	3,118.56
	Entry (By back door/laundry. Ceiling cracks.)	50.16
	Hallway (Includes main entry. Wall cracks.)	2,030.40
	Kitchen (Includes dining. Wall cracks, ceiling paint cracks.)	1,096.80
	Laundry (Wall cracks.)	108.00
	Lounge (Wall cracks.)	1,308.96
	Toilet	0.00
		12,556.20

12,556.20

### Garage

Name	Description	Estimate
Exterior	Roof (15* rolled metal 23.4m2)	0.00
	Foundations (Concrete slab 23.4m2)	0.00
	Elevation (East 3.9x 2.1)	0.00
	Elevation (North 6.0x 2.1)	0.00
	Elevation (South internal gibbed wall adjoining neighbouring garage)	0.00
	Elevation (West 3.9x2.1)	0.00
		0.00

Floor	Description	Estimate
Ground Floor	Room (Other) (Garage interior.)	0.00
		0.00

0.00

### Fees

Description	Estimate
Small Job Fee	180.00
	180.00

### Overheads

Description	Estimate
Preliminary and general	1,338.16



Margin	1,824.51
GST	3,010.44
	6,173.11
<b>Total Estimate</b>	23,080.05

## Inspection Sign Off

Description	Answer	comments
<b>Land Damage</b>		
Is there land damage?	No	
<b>Contents Damage</b>		
Has the contents schedule been left with claimant?	No	
Have the contents been sighted?	No	
<b>Was a full inspection done?</b>		
In roof space	Yes	
On roof?	Yes	
Under sub floor?	Yes	
<b>Decline Claim</b>		
Recommend Declining Claim	No	
<b>Next Action:</b>		

Claimant to send to EQC account for replacement toilet, damaged June 20 event.

## Previous Claim Numbers (recorded manually in field)

- 2010/042482
- 2011/065044

## File Notes

<b>Date Created:</b>	08/08/2011 21:46
<b>Created :</b>	Administrator, Alchemy
<b>Subject:</b>	COMET sent to EQR on 08/08/2011
<b>Note:</b>	COMET sent to EQR on 08/08/2011
<b>Next Action:</b>	
<b>Date Created:</b>	22/10/2012 06:49
<b>Created :</b>	Administrator, Alchemy
<b>Subject:</b>	Assessment Address Changed
<b>Note:</b>	From:1/74 AMYES ROAD, HORNBY, CHRISTCHURCH To:74 AMYES ROAD, HORNBY, CHRISTCHURCH
<b>Next Action:</b>	

## Urgent Works Items

<b>Date Created:</b>	13/07/2011 16:09
<b>Created :</b>	White, Gordon
<b>Situation Of Loss:</b>	1/74 Amyes Rd, Hornby
<b>Urgency:</b>	Category 2 - 3-5 days
<b>Scope Of Works:</b>	1/74 Amyes Rd, Hornby
<b>Date Created:</b>	13/07/2011 16:15
<b>Created :</b>	White, Gordon
<b>Situation Of Loss:</b>	1/74 Amyes Rd, Hornby
<b>Urgency:</b>	Category 2 - 3-5 days
<b>Scope Of Works:</b>	1/74 Amyes Rd, Hornby

Sin.

in ECM 05 74 Amyes.

## EQC Claim Assessment

<b>Address</b>	1/74 AMYES ROAD, HORNBY, CHRISTCHURCH, 8042	<b>EQC Claim Number</b>	CLM/2011/204158
<b>Hazards</b>	Nil. Dwelling habitable and waterproof. Area zoned green. Damage approximately 25% Sept 2010, 25% Feb 2011, 50% June 20, 2011.		
<b>EQC Assessor (L,F)</b>	White, Gordon		
<b>Inspection Date</b>	13-Jul-2011	<b>Placard</b>	No Sticker
<b>EQC Estimator (L,F)</b>	Kallahar, Steve		

## Claimants

Name	Home Phone	Work Phone	Mobile Phone	Email Address
BARNES KAREN				

## Property - Overheads and Fees

**cluded Items** Contractor's margin, Covering incidental costs., Goods and services tax, Small Job Fee

## Property Detail - Services

Element	Description / Damage / Repair Strategy	Measure
<b>Water Supply</b>	Town Connection, Plastic	30 m
<b>Sewerage</b>	Town Connection, PVC Pipe	35 m

## Property Detail - Site

Element	Description / Damage / Repair Strategy	Measure
<b>Land</b>	Exposed, Soil	455 m2
<b>Land</b>	Exposed, Soil	140 m2

<b>MAIN BUILDING</b>	<b>Age</b> 1935 - 1960	<b>Area</b> 91.6m2	<b>Footprint</b> Rectangular
----------------------	------------------------	--------------------	------------------------------

## Structure

Element	Description / Damage / Repair Strategy	Measure
<b>Elevation (West 10.0x2.4 step cracks)</b>		
Wall cladding	Brick veneer, Brick (24.00 m2)	
	Cracking	
	Grind out and repoint mortar	5 m
Wall framing	Timber Frame, Timber (24.00 m2)	

**Comments:** brick veneer, timber joinery. Step cracking.

Element	Description / Damage / Repair Strategy	Measure
<b>Elevation (North 11.4x2.4 step cracking, loose and cracked bricks)</b>		
Wall cladding	Brick veneer, Brick (27.36 m2)	
	Cracking	
	Grind out and repoint mortar	4 m
	Structural damage	
	Relay and re-bed loose bricks	0.1 m2
	Remove, dispose and replace bricks	0.02 m2
Wall framing	Timber Frame, Timber (27.36 m2)	

**Comments:** Brick veneer, timber windows. 1.8x1.2 entry porch with timber decking and 1.6x1.0 attached concrete steps.

□  
Step cracking, loose top bricks, 1 cracked brick.

Element	Description / Damage / Repair Strategy	Measure
---------	--	---------



EQC Claim Number CLM/2011/204158

**Elevation (South 11.4x2.4 step cracks)**

Wall cladding Brick veneer, Brick (27.36 m2)

Cracking

Grind out and repoint mortar

2 m

Wall framing Timber Frame, Timber (27.36 m2)

**Comments:** brick veneer, timber joinery. 1.4x1.2 attached concrete entry porch, steel frame clad with clearlight walls and iron roof. Step cracking to bricks.

Element	Description / Damage / Repair Strategy	Measure
---------	--	---------

**Elevation (East 10.0x2.4 step cracking)**

Wall cladding Brick veneer, Brick (24.00 m2)

Cracking

Grind out and repoint mortar

2 m

Wall framing Timber Frame, Timber (24.00 m2)

**Comments:** brick veneer, timber joinery. Vertical separation crack to brick chimney/ elevation wall

Element	Description / Damage / Repair Strategy	Measure
---------	--	---------

**Foundations (Concrete ring 42.8m/ concrete piles)**

**Comments:** .400 splatcoat plastered concrete ring 42.8m, approx 57 concrete piles

Element	Description / Damage / Repair Strategy	Measure
---------	--	---------

**Roof (35\* concrete tile 121.7m2. Displaced tiles & 1 broken, cracked soffits)**

Soffit Cement Sheet, Cement sheet 4.5mm (14.98 m2)

Cracked soffit lining

Gap fill

1.5 m

Paint cracked soffit

14.97 m2

Roof framing Framed, Timber (121.70 m2)

Roof Covering Pitched, Concrete tile (121.70 m2)

Impact damage

Realign roof tiles

4 m2

**Comments:** .350 painted cement sheet soffit, 45.6m pvc spouting, 3 pvc downpipes, 35\* concrete tiles on timber framed roof. □ Soffits have cracking and paint separation at wall junction. Allow to gap fill cracks and paint all soffit  
Displaced tiles= approx 2 m2 on south side and approx 2m2 on north side with one broken tile on north side also.

Element	Description / Damage / Repair Strategy	Measure
---------	--	---------

**Chimney (Exterior) (.500x.500 brick chimney collapsed to .500 above roof line)**

One story chimney Single Pot, Brick (1.00 Item)

Collapsed chimney

EXT - Brick - Ceiling - 1 POT

1 Item

**Comments:** .500x.500 brick chimney has collapsed to .500 above roof line and needs to be removed to roof line and allow to rebuild to approx 2.5m above roof line. Chimney is not live in dwelling and external 1.3x.200x2.4 high soffit to base section has only a minor vertical separation crack on one side and has been allowed for in east elevation cladding repair.

**Ground Floor**

Room / Element	Description / Damage / Repair Strategy	Measure
----------------	--	---------

**Bathroom Ceiling and wall cracks. (L=1.8m W=2.4m H=2.4m)**

Bath Acrylic, Standard specification (1.00 Item)

Window Aluminium Awning, Pane single glazed (1.00 No of)



EQC Claim Number CLM/2011/204158

Bathroom sink	Basin, Standard specification (1.00 Item)	
Floor	Chipboard, Vinyl (4.32 m2)	
Shower	Cubical shower unit, Glass (0.68 m2)	
Wall covering	Gib, Paint (20.16 m2)	
	Cosmetic damage	
	Rake out, plaster and paint	20.16 m2
Ceiling	Gib, Paint (4.32 m2)	
	Cosmetic Damage	
	Rake out, plaster and paint	4.32 m2
Door (Internal)	Single Hollow Core, Timber (1.00 No of)	
Mirror (Fixed)	Standard Spec, Mirror (0.45 m2)	

**Room - Comments:** Painted walls and ceiling, vinyl floor. One door, one window.**Room - Additional Notes:****Bedroom Bedroom 2, Nicholas room. Wall and ceiling cracks. (L=3.6m W=3.3m H=2.4m)**

Ceiling	Other, Paint (11.88 m2)	
	Cosmetic Damage	
	Refix ceiling	250 Sum
	Remove, supply, replace wall paper and paint	11.88 m2
Door (Internal)	Single Hollow Core, Timber (1.00 No of)	
Wall covering	Solid plaster, Paint (33.12 m2)	
	Cosmetic damage	
	Remove, supply, replace lining paper and paint	33.12 m2
Floor	T&G, Carpet (11.88 m2)	
Window	Timber medium, Pane single glazed (2.00 No of)	

**Room - Comments:** Painted lining paper walls, painted wallpaper ceiling, carpet floor. One door, two windows.**Room - Additional Notes:****Bedroom Bedroom 3, centre south. Wall cracks. (L=2.8m W=3.4m H=2.4m)**

Ceiling	Other, Paint (9.52 m2)	
Door (Internal)	Single Hollow Core, Timber (1.00 No of)	
Wall covering	Solid plaster, Paint (29.76 m2)	
	Cosmetic damage	
	Paint wall	29.76 m2
	Rake out and stop	2.6 m
	Remove, supply and replace Lining paper	13.44 m2
Floor	T&G, Carpet (9.52 m2)	
Window	Timber medium, Pane single glazed (1.00 No of)	

**Room - Comments:** Painted lining paper walls, painted wallpaper ceiling, carpet floor. One door, one window.**Room - Additional Notes:****Bedroom Main bedroom, Simons room. Wall and ceiling cracks. (L=4.6m W=4.0m H=2.4m)**

Ceiling	Other, Paint (18.40 m2)	
---------	-------------------------	--



EQC Claim Number CLM/2011/204158

	Cosmetic Damage	
	Paint Ceiling	18.4 m2
	Refix trims	4 m
Door (Internal)	Single Hollow Core, Timber (1.00 No of)	
Wall covering	Solid plaster, Paint (41.28 m2)	
	Cosmetic damage	
	Paint wall	41.28 m2
	Remove, rake out, plaster, supply and replace wallpaper	31.68 m2
	Remove, supply and replace Lining paper	9.6 m2
Floor	T&G, Carpet (18.40 m2)	
Window	Timber medium, Pane single glazed (1.00 No of)	
<b>Room - Comments:</b> Paint one wall, painted wallpaper three walls, stipple ceiling, carpet floor. One door, one window.		
<b>Room - Additional Notes:</b>		
<b>Entry By back door/laundry. Ceiling cracks. (L=1.9m W=1.1m H=2.2m)</b>		
Floor	Chipboard, Carpet (2.09 m2)	
Wall covering	Hardboard, Paint (13.20 m2)	
Ceiling	Other, Paint (2.09 m2)	
	Cosmetic Damage	
	Paint Ceiling	2.09 m2
Door (External)	SG Single, Timber (1.00 Item)	
<b>Room - Comments:</b> Painted walls and ceiling, unpainted hardboard overlay floor. One external door, no windows.		
<b>Room - Additional Notes:</b>		
<b>Hallway Includes main entry. Wall cracks. (L=1.7m W=5.9m H=2.4m)</b>		
Door (External)	DG French, Timber (1.00 Item)	
Ceiling	Other, Paint (10.03 m2)	
Wall covering	Solid plaster, Paint (36.48 m2)	
	Cosmetic damage	
	Rake out and stop	2.4 m
	Remove, supply, replace lining paper and paint	36.48 m2
Floor	T&G, T+G polished timber (10.03 m2)	
<b>Room - Comments:</b> Paint on lining paper walls, paint on wallpaper ceiling, varnished t&g floor. One external door.		
<b>Room - Additional Notes:</b>		
<b>Kitchen Includes dining. Wall cracks, ceiling paint cracks. (L=2.8m W=4.3m H=2.4m)</b>		
Range ( Free standing oven )	Electric, Standard Electric (1.00 Item)	
Door (Internal)	Glass panel door, Timber (1.00 No of)	
Work top	Kitchen work top, Laminate (5.50 m)	
Kitchen joinery	Medium Spec, MDF (1.00 Item)	
Range Hood	Over Head, Standard spec (1.00 Item)	



EQC Claim Number CLM/2011/204158

Ceiling	Pinex Tiles, Paint (12.04 m2)	
	Cosmetic Damage	
	Paint Ceiling	12.04 m2
Wall covering	Solid plaster, Paint (34.08 m2)	
	Cosmetic damage	
	Rake out, plaster and paint	23.76 m2
Floor	T&G, T+G polished timber (12.04 m2)	
Window	Timber medium, Pane single glazed (1.00 No of)	
<b>Room - Comments:</b> Painted ceilings and walls, polished t&g floor. One door, one window, open to lounge.		

**Room - Additional Notes:****Laundry Wall cracks. (L=1.8m W=2.0m H=2.5m)**

Wall covering	Hardboard, Paint (19.00 m2)	
	Cosmetic damage	
	Paint wall	4.5 m2
Ceiling	Other, Paint (3.60 m2)	
Wash tub	Single, Stainless Steel (1.00 Item)	
Floor	T&G, Bare floor boards (3.60 m2)	
Window	Timber medium, Pane single glazed (2.00 No of)	
<b>Room - Comments:</b> Painted walls and ceiling, unpainted hardboard overlay floor. Two windows, open to rear entry.		

**Room - Additional Notes:****Lounge Wall cracks. (L=3.7m W=4.1m H=2.4m)**

Ceiling	Other, Paint (15.17 m2)	
Door (Internal)	Single Hollow Core, Timber (1.00 No of)	
Wall covering	Solid plaster, Paint (37.44 m2)	
	Cosmetic damage	
	Gap fill cracks	3 m
	Rake out, plaster and paint	37.44 m2
Floor	T&G, Carpet (15.17 m2)	
Window	Timber medium, Pane single glazed (2.00 No of)	
<b>Room - Comments:</b> Painted walls and ceiling, carpet floor. Two windows, one door, open to kitchen.		

**Room - Additional Notes:****Toilet (L=0.9m W=1.8m H=2.5m)****Room - Comments:** Painted walls and ceiling, unpainted hardboard overlay floor. One door, one window.**Room - Additional Notes:**

GARAGE	Age Post 1980	Area 22.9m2	Footprint Rectangular
<b>Structure</b>			
Element	Description / Damage / Repair Strategy		Measure



EQC Claim Number CLM/2011/204158

**Elevation (East 3.9x 2.1)****Comments:** metal weatherboard clad versatile garage.

Element	Description / Damage / Repair Strategy	Measure
---------	--	---------

**Elevation (West 3.9x2.1)****Comments:** metal weatherboard clad versatile garage.

Element	Description / Damage / Repair Strategy	Measure
---------	--	---------

**Elevation (North 6.0x 2.1)****Comments:** metal weatherboard clad versatile garage.

Element	Description / Damage / Repair Strategy	Measure
---------	--	---------

**Elevation (South internal gibbed wall adjoining neighbouring garage)**

Element	Description / Damage / Repair Strategy	Measure
---------	--	---------

**Foundations (Concrete slab 23.4m2)**

Element	Description / Damage / Repair Strategy	Measure
---------	--	---------

**Roof (15\* rolled metal 23.4m2)****Comments:** 7.8m metal spouting, 2 metal downpipes, 23.4m2 rolled metal on timber trussed roof.**Ground Floor**

Room / Element	Description / Damage / Repair Strategy	Measure
----------------	--	---------

**Room (Other) Garage interior. (L=3.8m W=5.9m H=2.2m)****Room - Additional Notes:****End Of Assessment**



A

**SCOPE CHANGE RECORD (2 PAGES)**

Claim Number	CLM/2011/204158	Contractor	SINCLAIR BUILDERS
Name	Karen Barnes	Supervisor	JOHNATHAN FRANCIS
Address	1174 Amies Rd	Date	WED 28/9/11 9.30
Phone 1		Prop Owner email	
Phone 2			

**HOME OWNER INFORMATION**

Item	Description	Y/N	Comments	ECM
Office- General	Has the EQC been through for a 2011 assesment?	X		
	Has any emergency work been carried out?	X		
	Is the property occupied by the owner or a tenant?	0		
	Significant damage from 22 February earthquake?			
	Does the home have a special status from the council?	N		
	Potential delays to the start date?	N		
	Are there any outstanding heating issues?			
Supervisor - Winter Heating Programme Criteria	Does the home have a damaged chimney?			
	Is the chimney a primary heating source?			
	Is there a risk that the chimney could collapse at any time?			
	What is the age range of the adult occupants? (10 yr ranges)			
	Are any occupants younger than 5 years?			
	Are there any medical issues that may impact on the need for heating?			
	Building repair required (for primary heat source)			
	Appliance category - circle one.		Heat pump, solid fuel burner, repair required.	
Supervisor - General	OK to use owner facilities – toilet and power?	X		
	Non standard hours of work? (Std. 7.30am to 5pm)	Y		
	OK to use driveway for unloading only?	X		
	Any undertile heating?	N		
	Special considerations for pets etc?	N		
	Consultants required? Architect, Engineer, Specifier	N		
	Necessary for the owner/tenant to move out while the work is carried out? Time? Notice required? Space on property for temporary accommodation?	N		
	Prop Owner wants Master Build guarantee? ( If Yes – discuss cost. If No - Discuss waiver form)	N		
	Site specific safety plan required?	X		NA
	Discuss grouting, colour, masonry match	Y		NA
	Discuss protection of surface finishes	Y		NA
	Discuss relocation of furniture if required	Y		NA
	Discuss daily and final cleaning practices & standards	Y		NA

**NOTES**

\* Owner Talked to EQC bout  
 paint on window & Leak in window  
 and was told to Just tell flecters  
 about she was not happy  
 With Guys who Came Round.

**OFFICE USE**

Uploaded to Aconex		Copy to Supervisor	
Transmitted to Contractor			
Entered into ECM/Cleanheat			
ECM data entry by			



**SCOPE CHANGE RECORD (2 PAGES)**

Claim No:	Address:				Supervisor:	Date:
Room	Photo No. #	Walls ✓	Ceiling ✓	Floor ✓	Repair Strategy	
Lounge	Y	✓			Paint 2 x Window Reveal cracking in corner	
Dining Room						
Kitchen					Paint 1 x Window Reveal cracking in corner	
Family Room						
Bedroom 1 4.6 x 4.0	Y	✓			Chimney backs onto wall ReGib 1 x Wall 4 x 2.4 Major Damage Fibrous Plaster. Repaint 1 x Window frame / Reveal	
Bedroom 2 3.6 x 3.3	N		✓		Ceiling has let go Must be ReGibbed As Damage is unrepairable	
Bedroom 3 4.6 x 4.0					Repaint 1 x Window frame / Reveal	
Bedroom 4						
Bathroom						
Toilet 1 2 x 1	Y	✓	✓		Etc. Cracking to Trim hardboard Crack fill & Paint	
Toilet 2						
Office/Study Hallway 1.7 x 5.9	Y		✓		Cracking To Wall Ceiling Junction Strip Wallpaper Sq stop Sand Repaper & Paint	
Stairwell Back door 2 x 1	Y	✓	✓		Remove Painted Hardies and Scotia Retire <del>Scotia</del> Ceiling <sup>Reshape</sup> Paint walls & & ceiling	
Laundry						



## SCOPE CHANGE RECORD (2 PAGES)

Claim No:		Address:				Supervisor:	Date:
Room		Photo No. #	Walls ✓	Ceiling ✓	Floor ✓	Repair Strategy	
Garage Roof						Not Gap fill & Paint Soft + Replace.	
Roof						Water coming in Above lounge window Builder to Allow 1 hr for investigate leak.	
External Walls	North		✓			Rebuild 2.5 sqs Not Just a Paint job	
	South					Paint all Soft + 0.5m x 10.4m x 2 Paint all window 0.5m x 11.4m x 2 x 9 of Rebuild chimney bricks 3 sqs	
	East						
	West						
Chimney							
Foundations							
Piling							
Outbuildings							
Hallway							
Ensuite							

Schedule **E4****Defects Liability Certificate**Contract: Sinclair BuildersClaim Number: 2011/204158Location: 74 Amyes Rd.**End of Defects Liability period**

The Principal is required to issue a Defects Liability Certificate. The NBC SW Standard Conditions rule 13.1 states that:

The Principal must certify to the Contractor when in relation to the Contract Works or a Separate Section of them:

- (a) the Defects Liability Period has ended; and
- (b) the Contractor has completed all minor omissions and corrected all minor defects referred to in rule 12.1; and
- (c) the Contractor has completed agreed deferred work.

**This Certificate**

This is to certify that in accordance with rule 13.1, the above named Contract Works the Defects Liability Period has ended, all deferred work has been completed and all defects have been corrected

The issuing of this certificate does not affect the Contractor's liability to fulfil any obligation in the Contract which remains unperformed or not properly performed.

The Principal has used all reasonable care and skill in the preparation of this Certificate

The certificate cannot be relied on for any other purpose.

Signed by/date:

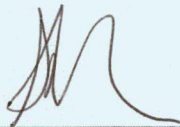
31.7.13

(Date signed)



## PROJECT SIGN OFF FORM



Contractor

Sinclair Builders

Home Owner

Karen Barnes

Claim Number

2011/204158

Street Address

1/74 Amyes Rd

## Description of Works

Earthquake repair as per Scope  
and any changes

<b>Completion Certificate</b>  This is to advise that the earthquake repair work performed under this contract has been reviewed and that it has been agreed that it has been satisfactorily completed as per EQC Scope and EQR Variations.	Supervisor Sign  	Builders Sign  	Owner Sign (Optional)	Date  16/2/2012
The Homeowner/Occupant acknowledges that they will notify the Supervisor prior to the expiration of 3 months from the date of this certificate of any defects arising with the repair work which require remedying and allow the contractor to perform such repairs.	Supervisor Sign  	Builders Sign  	Owner Sign (Optional)	Date  16/2/2012

Schedule **E1(a) Contractor's Producer Statement for Construction PS3**

Contract: ~ Karen Barnes

Location: ~ 1174 Amyes Rd

**Issued by**

Contractor: ~ Sinclair Builders

LBP Licence No ~ BP101784

**Preamble**

The Contractor is required to complete this Producer Statement for Construction PS3 within 5 days of the completion of the Contract Works and issue it to the Hub Supervisor.

This Producer Statement will be relied upon to confirm that the Building Works has, to the best of the Contractor's knowledge, been performed in compliance with the NZ Building Code.

**Statement** I Chris Sinclair (name of LPB) undertook or supervised the following building work and confirm that I am satisfied on reasonable grounds that the work performed is in compliance with the NZ Building Code and, where a building consent is applicable, in compliance with the Building Consent.

**Description of the work covered by this statement:**Claim Number: 2011/204158

Carried out Earthquake repairs as  
per E.Q.C Scope of works.

Signed by/date:

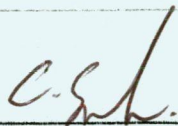

(Date signed)



# CASH SETTLED CLAIM(S)

The following information contains documents relating to claim(s) that were cash settled for the property.

If you require sign off or repair completion documents, they may be obtainable from the contractors who completed the substantive repairs at the property.



Barnes

## Trade-tech Property Solutions

PO Box 19648, Christchurch 8241

Phone: Paul 027 2449 818 or David 027 4350 404

Email: trade.tech@xtra.co.nz

359 Lincoln Road

PO Box 9008

Tower Junction

Christchurch 8149

Ph: +64-3-335-0410

Fax: +64-3-335-0411

Email: info@tepm.co.nz

www.tepm.co.nz

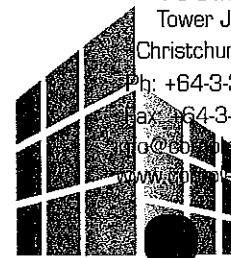

**Trade-tech**  
Property Solutions  
**complete**  
PROPERTY MANAGEMENT

## Invoice to:

TotalFix Property Maintenance

PO Box 9008

Tower Junction

Christchurch 8149

## TAX INVOICE

DATE

GST NO

2031

15-Sep-10

76 624 151

Reference : 014818

Description	Qty	Price	Total
ACCOUNT TO, KEVIN AND KAREN BARNES			
RE, 74 AMYES ROAD			
To re construct cupboard front after plumber repaired hot water cylinder.			
The work order states the cylinder stand has some damage and needs to be repaired. However the plumber must have done this when refitting cylinder. I put a couple of extra fixings in but that is all it needed.			
Note; Most of the kitchen cupboard doors are off. They will need new hinges etc on most of them. You may need an inspection of these.			
Paul			
Materials	1	\$6.00	\$6.00
Labour	1	\$40.00	\$40.00
Travel	1	\$13.00	\$13.00

Sub Total \$59.00

Plus GST \$7.38

**Total Amount Payable \$66.38**

Our Goal is to be Christchurch's most trusted Maintenance Company.

Inviced To CPM	
Entered By	16/9/10
Entered MYOB	17/9/10.
Entered By	no



ADEN  
ELECTRICAL  
CANTERBURY

Barnes

16/9/10

359 Lincoln Road  
PO Box 9008  
Tower Junction  
Whittington Holdings Ltd T/A  
Aden Electrical Canterbury  
26 Byron Street, Christchurch 8149  
Sydenham, Christchurch  
PO Box 7663, Christchurch  
Sydenham, Christchurch  
New Zealand  
Ph: +64-3-335-0410  
+64-3-335-0411  
info@completepm.co.nz  
www.completepm.co.nz  
Ph (64) 3 365 7041  
Fax (64) 3 365 7042  
canterbury@aden.co.nz

## TAX INVOICE 101567

**complete**  
PROPERTY MANAGEMENT

Complete Property Management Ltd  
PO Box 9008  
Tower Junction  
Christchurch 8149  
New Zealand

GST Reg : 103-525-117  
Invoice Date : 14/09/2010  
Job No : C321423  
Client No : C13231  
Order No : 14821

This is a Payment Claim under the Construction Contracts Act 2002.

### COMPLETE - 74 AMYES RD

Payment Due: 7 days from receipt of invoice

Attention:  
Kevin And Karen Barnes  
C/- [REDACTED]

Job Address: 74 Amyes Road

Job Description: Connect HWC which has been replaced after the quake

As per Attached 60.00

Issued To CPM	
Entered By	16/9/10
Entered By	17/9/10
Entered By	
Entered By	

SUBTOTAL : \$60.00  
GST : \$7.50  
INVOICE TOTAL : \$67.50

All work is carried out in accordance with our terms and conditions and the Construction Contracts Act 2002.  
Any queries on this invoice or related work must be addressed to this office within 7 days.

#### Bank Account Details

Name: Whittington Holdings Ltd T/A Aden Electrical Canterbury  
Number: 02 0820 0132922 00

# ***STAR HOLDS ltd***

www.starholds.co.nz

To

K Barnes

74 Amyes RD

Christchurch

EQC

po box 311 Wellington

Claim 2010/042482

Dr. to

Peter and Linda Taw

57 Robert Coup Rd

Kaiapoi

Tax Invoice

GST no. 96 742 932

Phone/Fax. 03 327 4847 Cell 0274 389 398 E. Mail: peter.taw@extra.co.nz

DATE	DESCRIPTION	Labour	Materials	CREDIT
22-Dec-2010	fix door in lounge fix garage door rivets	4.5	12	
		4.5		

Please make cheques payable to Star Holds

labour	\$247.50
Materials	\$12.00
Balance	\$259.50
Less credits	\$0.00

Nett Balance	\$259.50
GST	\$38.93

Balance to pay	\$298.43
----------------	----------



