

Land Information Memorandum



Property address:
29 Neville Street

LIM number: H09333381

Page 1

Christchurch City Council
53 Hereford Street, PO Box 73015
Christchurch 8154, New Zealand
Tel 64 3 941 8999
Fax 64 3 941 8984

www.ccc.govt.nz

Application details

Date issued 19 September 2025
Date received 16 September 2025

Property details

Property address 29 Neville Street, Spreydon, Christchurch
Valuation roll number 22621 19200 B
Valuation information Capital Value: \$550,000
Land Value: \$160,000
Improvements Value: \$390,000
Please note: these values are intended for Rating purposes
Legal description Flat 2 DP 66429 on Lot 2 DP 13847 having share in 914 m2
Existing owner James Frederick Bartlett
Rachel Bartlett
29 Neville Street
Christchurch 8024

Council references

Rate account ID 73017577
LIM number H09333381
Property ID 1064040

Document information

This Land Information Memorandum (LIM) has been prepared for the purpose of section 44A of the Local Government Official Information and Meetings Act 1987 (LGOIMA). It is a summary of the information that we hold on the property. Each heading or "clause" in this LIM corresponds to a part of section 44A.

Sections 1 to 10 contain all of the information known to the Christchurch City Council that must be included under section 44A(2) LGOIMA. Any other information concerning the land as the Council considers, at its discretion, to be relevant is included at section 11 of this LIM (section 44A(3) LGOIMA). If there are no comments or information provided in these sections this means that the Council does not hold information on the property that corresponds to that part of section 44A.

The information included in this LIM is based on a search of Council records only and there may be other information relating to the land which is unknown to the Council. Please note that other agencies may also hold information relevant to the property, or administer legislation relevant to the use of the land, for example, the Regional Council (Ecan), Heritage New Zealand Pouhere Taonga, and Land Information New Zealand.

Council records may not show illegal or unauthorised building or works on the property. The applicant is solely responsible for ensuring that the land is suitable for a particular purpose.

A LIM is only valid at the date of issue as information is based only upon information the Council held at the time of that LIM request being made. It is essential that the applicant undertakes their own due diligence to verify the suitability of the property for their intended use.

Property file service

This Land Information Memorandum does not contain all information held on a property file. Customers may request property files by phoning the Council's Customer Call Centre on (03) 941 8999, or visiting any of the Council Service Centres. For further information please visit www.ccc.govt.nz.

To enable the Council to measure the accuracy of this LIM document based on our current records, we would appreciate your response should you find any information contained therein which may be considered to be incorrect or omitted. Please telephone the Customer Call Centre on (03) 941 8999.

Property address:

29 Neville Street

LIM number: H09333381

Page 3

Christchurch City Council

53 Hereford Street, PO Box 73015
Christchurch 8154, New Zealand
Tel 64 3 941 8999
Fax 64 3 941 8984

www.ccc.govt.nz

A search of records held by the Council has revealed the following information:

1. Special features and characteristics of the land

Section 44A(2)(a) LGOIMA. This is information known to the Council but not apparent from the district scheme under the Town and Country Planning Act 1977 or a district plan under the Resource Management Act 1991. It identifies each (if any) special feature or characteristic of the land concerned, including but not limited to potential erosion, avulsion, falling debris, subsidence, slippage, alluvion, or inundation, or likely presence of hazardous contaminants.

☎ For enquiries, please phone (03) 941 8999 or visit www.ccc.govt.nz.

Natural Hazards

(a) Coastal Hazards

As at the date of this LIM, Council research found no information under this heading.

(b) Earthquakes

- Consultant Report Available

The Tonkin & Taylor Darfield Earthquake 4 September 2010 Geotechnical Land Damage Assessment & Reinstatement Stage 1 Report indicates areas of observed surface manifestations of liquefaction resulting from the earthquake. This property is within one of the identified areas. The report can be viewed at www.eqc.govt.nz/our-publications/darfield-earthquake-geotechnical-land-damage-assessment-reinstatement-stage-1/

- Liquefaction Assessment

Christchurch City Council holds indicative information on liquefaction hazard for Christchurch. Information on liquefaction, including an interactive web tool, can be found on the Council website at ccc.govt.nz/liquefaction. Depending on the liquefaction potential of the area that the property is in, the Council may require site-specific investigations before granting future subdivision or building consent for the property.

(c) Flooding

- Flood Assessment

Council is currently updating the flood map database. For information relating to flooding at this address please email floorlevels@ccc.govt.nz.

(d) Landslides

As at the date of this LIM, Council research found no information under this heading.

(e) Subsidence

- Consultant Report Available

Land Information New Zealand (LINZ) engaged Tonkin and Taylor to provide a Geotechnical Report on Ground Movements that occurred as a result of the Canterbury Earthquake Sequence. The report indicates this property may have been effected by a degree of earthquake induced subsidence. The report obtained by LINZ can be accessed on their website at <https://www.linz.govt.nz> and search Information for Canterbury Surveyors.

(f) Tsunamis

As at the date of this LIM, Council research found no information under this heading.

(g) Volcanic and Geothermal Hazards

As at the date of this LIM, Council research found no information under this heading.

(h) Wind

As at the date of this LIM, Council research found no information under this heading.

(i) Any Other Natural Hazards

As at the date of this LIM, Council research found no information under this heading.

Property address:

29 Neville Street

LIM number: H09333381

Page 4

Christchurch City Council

53 Hereford Street, PO Box 73015
Christchurch 8154, New Zealand
Tel 64 3 941 8999
Fax 64 3 941 8984

www.ccc.govt.nz

(j) District Plan Natural Hazard Information

Please refer to *Section 8. Land use and conditions* of this report for District Plan related natural hazard information.

(k) Building Notices

Please refer to *Section 5. Consents, certificates, notices, orders, or requisitions affecting the land and buildings* of this report for Building Act notice information.

Other Special Features or Characteristics of the Land

As at the date of this LIM, Council research found no information under this heading.

2. Private and public stormwater and sewerage drains

Section 44A(2)(b) LGOIMA. This is information about private and public stormwater and sewerage drains as shown in the Council's records.

 For stormwater and sewerage enquiries, please phone (03) 941 8999 or visit www.ccc.govt.nz.

Related Information

- Attached are all drainage plans that Council hold for details of private and public drainage. Not all plans provided are verified by Council, and therefore Council cannot be liable for inaccuracies. Site investigation will be required by owners to determine exact layouts.
- This property is shown to be served by Christchurch City Council Sewer.
- The council plan shows no public stormwater lateral to this site.

Property address:

29 Neville Street

LIM number: H09333381

Page 6

Christchurch City Council

53 Hereford Street, PO Box 73015
Christchurch 8154, New Zealand
Tel 64 3 941 8999
Fax 64 3 941 8984

www.ccc.govt.nz

3. Drinking Water Supply

Section 44A(2)(ba) and (bb) LGOIMA. This is information notified to the Council about whether the land is supplied with drinking water, whether the supplier is the owner of the land or a networked supplier, any conditions that are applicable, and any information the Council has about the supply.

Please note the council does not guarantee a particular water quality to its customers. If you require information on current water quality at this property please contact the Three Waters & Waste Unit.

☎ For water supply queries, please phone (03) 941 8999 or visit www.ccc.govt.nz.

Water supply

Christchurch City Council is the networked supplier of water to this property. This property is connected to the Christchurch City Council Water Supply. The conditions of supply are set out in the Christchurch City Council Water Supply and Wastewater Bylaw (2022), refer to www.ccc.govt.nz.

Property address:

29 Neville Street

LIM number: H09333381

Page 7

Christchurch City Council

53 Hereford Street, PO Box 73015
Christchurch 8154, New Zealand
Tel 64 3 941 8999
Fax 64 3 941 8984

www.ccc.govt.nz

4. Rates

Section 44A(2)(c) LGOIMA. This is information on any rates owing in relation to the land.

☎ For rates enquiries, please phone (03) 941 8999 or visit www.ccc.govt.nz.

(a) Annual rates

Annual rates to 30/06/2026: \$3,444.72

	Instalment Amount	Date Due
Instalment 1	\$861.12	15/08/2025
Instalment 2	\$861.12	15/11/2025
Instalment 3	\$861.12	15/02/2026
Instalment 4	\$861.36	15/05/2026

Rates owing as at 19/09/2025: \$0.00

(b) Excess Water Rates

For excess water charge enquiries, please phone (03) 941 8999 or visit www.ccc.govt.nz/contact-us.

(c) Final water meter reading required at settlement?

Property settlements must ensure all water usage and outstanding debts are accurately accounted for.

To advise of a property settlement, please complete the request for settlement information form at www.ccc.govt.nz/services/rates-and-valuations/solicitors-request.

A settlement statement of accounts will be provided on the expected settlement date advised.

Property address:

29 Neville Street

LIM number: H09333381

Page 8

Christchurch City Council

53 Hereford Street, PO Box 73015
Christchurch 8154, New Zealand
Tel 64 3 941 8999
Fax 64 3 941 8984

www.ccc.govt.nz

5. Consents, certificates, notices, orders, or requisitions affecting the land and buildings

Section 44A(2)(d) LGOIMA. This is information concerning any consent, certificate, notice, order, or requisition, affecting the land or any building on the land, previously issued by the Council. The information in this section may also cover building consent and/or code compliance information issued by building certifiers under the Building Act 1991 and building consent authorities that are not the Council under the Building Act 2004.

You can check the property file to identify whether any consent or certificate was issued by a building certifier under the Building Act 1991.

Section 44A(2)(da) LGOIMA. The information required to be provided to a territorial authority under section 362T(2) of the Building Act 2004. There is currently no information required to be provided by a building contractor to a territorial authority under section 362T(2) of the Building Act 2004. The Building (Residential Consumer Rights and Remedies) Regulations 2014 only prescribed the information that must be given to the clients of a building contractor.

Sections 71 to 74 of the Building Act 2004 require the Building Consent Authority to consider natural hazards when it receives a building consent application for the construction or major alteration of a building on land that is subject to, or likely to be subject to, a natural hazard. A building consent for this property may have been issued subject to a section 72 or 73 notice. This means at the time of building consent the Building Consent Authority was not satisfied that adequate provision would be made to protect the building and land from the natural hazard and was subsequently required to notify the Registrar-General of Land to record the natural hazard on the Record of Title. The Building Act 2004 defines natural hazards as erosion (including coastal erosion, bank erosion, and sheet erosion), falling debris (including soil, rock, snow, and ice), subsidence, inundation (including flooding, overland flow, storm surge, tidal effects, and ponding), and slippage.

If your property contains a notice under s73 of the Building Act 2004, this will be identified on the building consent decision below (decision under s72 of the Building Act 2004) and on the properties' Record of Title. The Record of Title may also record this as a s36 notice under the Building Act 1991, or a s641A notice under the Local Government Act 1974.

 For building enquiries, please phone (03) 941 8999, email EPADutyBCO@ccc.govt.nz or visit www.ccc.govt.nz.

(a) Consents

- BCN/1987/3442 Applied: 08/06/1987 Status: Completed
27 Neville Street Spreydon
Permit granted 01/07/1987
Permit issued 01/07/1987
ADDITION TO DWELLING - ACTIVITY ROOM - FLAT 1- Historical Reference PER87000833
- BCN/1993/10244 Applied: 02/12/1993 Status: Completed
29 Neville Street Spreydon
Accepted for processing 02/12/1993
Building consent granted 24/12/1993
Building consent issued 24/12/1993
Code Compliance Certificate Granted 17/03/1994
Code Compliance Certificate Issued 17/03/1994
DWELLING - FLAT 2- Historical Reference CON93013040
- BCN/1994/703 Applied: 09/02/1994 Status: Completed
29 Neville Street Spreydon
Accepted for processing 09/02/1994
Building consent granted 24/02/1994
Building consent issued 24/02/1994
Code Compliance Certificate Granted 18/03/1994
Code Compliance Certificate Issued 18/03/1994
CARPORT - FLAT 2- Historical Reference CON94000826

Property address:

29 Neville Street

LIM number: H09333381

Christchurch City Council

53 Hereford Street, PO Box 73015
Christchurch 8154, New Zealand
Tel 64 3 941 8999
Fax 64 3 941 8984

- BCN/2008/4461 Applied: 03/07/2008 Status: Completed
27 Neville Street Spreydon
Accepted for processing 03/07/2008
Building consent granted 03/07/2008
Building consent issued 03/07/2008
PIM Granted 03/07/2008
PIM Issued 03/07/2008
Code Compliance Certificate Granted 16/06/2010
Code Compliance Certificate Issued 16/06/2010
PARKWOOD INSERT INBUILT PELLET FIRE CLEAN AIR CERT 083310- Historical Reference ABA10087281
- BCN/2011/1731 Applied: 18/05/2011 Status: Code Compliance Certificate refused S93
27 Neville Street Spreydon
Accepted for processing 18/05/2011
PIM Granted 27/05/2011
PIM Issued 27/05/2011
Building consent granted 22/06/2011
Building consent issued 30/06/2011
Council refused to issue a Code Compliance Certificate, s93 Building Act 2004 24/06/2013
FLAT 1 - GARAGE- Historical Reference ABA10110253

(b) Certificates

Note: Code Compliance Certificates were only issued by the Christchurch City Council since January 1993.

(c) Notices

- Placards issued under the Civil Defence Emergency Management Act 2002 as a result of the 4 September 2010 and 22 February 2011 earthquakes have now expired (by 12 July 2011 if not before). Some civil defence placards were replaced with dangerous building notices issued under section 124 Building Act 2004, and where this has happened the section 124 notice is separately recorded. Many other buildings, although not issued with a section 124 notice, may require structural work or other repairs before they can be occupied again. It is the building owners responsibility to make sure the building is safe for any occupier or visitor. Detailed structural engineering assessments may still be required to be carried out.
- CDB75068347 04/03/2011 29 Neville Street
Building Evaluation : Building Inspected Under Civil Defence Emergency , Green Placard Issued (a deemed Building Act notice)

(d) Orders

(e) Requisitions

Property address:

29 Neville Street

LIM number: H09333381

Page 10

Christchurch City Council

53 Hereford Street, PO Box 73015
Christchurch 8154, New Zealand
Tel 64 3 941 8999
Fax 64 3 941 8984

www.ccc.govt.nz

6. Certificates issued by a building certifier

Section 44A(2)(e) LGOIMA. This is information notified to the Council concerning any certificate issued by a building certifier pursuant to the Building Act 1991 or the Building Act 2004.

 For building enquiries, please phone (03) 941 8999, email EPADutyBCO@ccc.govt.nz or visit www.ccc.govt.nz.

Property address:

29 Neville Street

LIM number: H09333381

Page 11

Christchurch City Council

53 Hereford Street, PO Box 73015
Christchurch 8154, New Zealand
Tel 64 3 941 8999
Fax 64 3 941 8984

www.ccc.govt.nz

7. Weathertightness

Section 44A(2)(ea) LGOIMA. This is information notified to the Council under section 124 of the Weathertight Homes Resolution Services Act 2006.

 For weathertight homes enquiries, please phone (03) 941 8999 or visit www.ccc.govt.nz.

If there is no information below this means Council is unaware of any formal Weathertight Homes Resolution Services claim lodged against this property.

Property address:

29 Neville Street

LIM number: H09333381

Page 12

Christchurch City Council

53 Hereford Street, PO Box 73015
Christchurch 8154, New Zealand
Tel 64 3 941 8999
Fax 64 3 941 8984

www.ccc.govt.nz

8. Land use and conditions

Section 44A(2)(f) LGOIMA. This is information relating to the use to which the land may be put and conditions attached to that use. The planning information provided below is not exhaustive and reference to the Christchurch District Plan and any notified proposed changes to that plan is recommended: <https://ccc.govt.nz/the-council/plans-strategies-policies-and-bylaws/plans/christchurch-district-plan/>.

There maybe some provisions of the Christchurch City Plan or Banks Peninsula District Plan that affect this property that are still operative.

☎ For planning queries, please phone (03) 941 8999, email DutyPlanner@ccc.govt.nz or visit www.ccc.govt.nz.

- **Regional plan or bylaw**

There may be objectives, policies or rules in a regional plan or a regional bylaw that regulate land use and activities on this site. Please direct enquiries to Canterbury Regional Council (Environment Canterbury).

(a)(i) Christchurch City Plan & Banks Peninsula District Plan

(ii) Christchurch District Plan

- **Liquefaction Management Area (LMA)**

Property or part of property within the Liquefaction Management Area (LMA) Overlay, which is operative.

- **District Plan Zone**

Property or part of property within the Residential Suburban Zone, which is operative.

(b) Resource consents

If there are any land use resource consents issued for this property the Council recommends that you check those resource consents on the property file. There may be conditions attached to those resource consents for the property that are still required to be complied with.

- RMA/1994/2142 - Subdivision Consent
29 Neville Street Spreydon
Comp. Title SUBDIVISION - Historical Reference RMA12563
Status: Processing complete
Applied 16/02/1994

Property address:

29 Neville Street

LIM number: H09333381

Page 13

Christchurch City Council

53 Hereford Street, PO Box 73015
Christchurch 8154, New Zealand
Tel 64 3 941 8999
Fax 64 3 941 8984

www.ccc.govt.nz

9. Other land and building classifications

Section 44A(2)(g) LGOIMA. This is information notified to the Council by any statutory organisation having the power to classify land or buildings for any purpose.

 For land and building enquiries, please phone (03) 941 8999 or visit www.ccc.govt.nz.

Please refer to Section 1 for details

Property address:

29 Neville Street

LIM number: H09333381

Page 14

Christchurch City Council

53 Hereford Street, PO Box 73015
Christchurch 8154, New Zealand
Tel 64 3 941 8999
Fax 64 3 941 8984

www.ccc.govt.nz

10. Network utility information

Section 44A(2)(h) LGOIMA. This is information notified to the Council by any network utility operator pursuant to the Building Act 1991 or the Building Act 2004.

☎ For network enquiries, please phone (03) 941 8999 or visit www.ccc.govt.nz.

- **None recorded for this property**

Property address:

29 Neville Street

LIM number: H09333381

Page 15

Christchurch City Council

53 Hereford Street, PO Box 73015
Christchurch 8154, New Zealand
Tel 64 3 941 8999
Fax 64 3 941 8984

www.ccc.govt.nz

11. Other information

Section 44A(3) LGOIMA. This is information concerning the land that the Council has the discretion to include if it considers it to be relevant.

☎ For any enquiries, please phone (03) 941 8999 or visit www.ccc.govt.nz.

(a) Kerbside waste collection

- Your organics are collected Weekly on Tuesday. Please leave your organics at the Kerbside by 6:00 a.m.
- Your recycling is collected Fortnightly on the Week 2 collection cycle on a Tuesday. Please leave your recycling at the Kerbside by 6:00 a.m. Your nearest recycling depot is the Parkhouse Road EcoDrop.
- Your refuse is collected Fortnightly on the Week 2 collection cycle on a Tuesday. Please leave your rubbish at the Kerbside by 6:00 a.m. Your nearest rubbish depot is the Parkhouse Road EcoDrop.

(b) Other

• Floor Levels Information

Council holds a variety of information on requirements for building or property development. This includes:

- required minimum finished floor levels, which need to be set to meet the surface water requirements in clause E1.3.2 of the Building Code (where this applies); and
- the requirements of the Christchurch District Plan (where a property is in the Flood Management Area).

Where this information has been processed for your property, you can view it online at <https://ccc.govt.nz/flooding-and-floor-levels>.

Otherwise, if you are building or developing on this land, you can request a calculation on required finished floor levels for your proposed building by emailing us at floorlevels@ccc.govt.nz.

• Guest Accommodation

Guest accommodation (including whole unit listings on Airbnb; BookaBach; etc.) generally requires a resource consent in this zone when the owner is not residing on the site. For more information, please refer to: <https://ccc.govt.nz/providing-guest-accommodation/>.

• Community Board

Property located in Spreydon-Cashmere-Heathcote Community Board.

• Tsunami Evacuation Zone

This property is not in a tsunami evacuation zone. It is not necessary to evacuate in a long or strong earthquake or during an official Civil Defence tsunami warning. Residents may wish to offer to open their home to family or friends who need to evacuate from a tsunami zone, and should plan with potential guests to do so in advance. More information can be found at <https://ccc.govt.nz/services/civil-defence/hazards/tsunami-evacuation-zones-and-routes/>

• Electoral Ward

Property located in Spreydon Electoral Ward

• Listed Land Use Register

Hazardous activities and industries involve the use, storage or disposal of hazardous substances. These substances can sometimes contaminate the soil. Environment Canterbury identifies land that is used or has been used for hazardous activities and industries. This information is held on a publically available database called the Listed Land Use Register (LLUR). The Christchurch City Council may not hold information that is held on the LLUR. Therefore, it is recommended that you check Environment Canterbury's online database at www.llur.ecan.govt.nz

Property address:

29 Neville Street

LIM number: H09333381

Page 16

Christchurch City Council

53 Hereford Street, PO Box 73015
Christchurch 8154, New Zealand
Tel 64 3 941 8999
Fax 64 3 941 8984

www.ccc.govt.nz

- **Spatial Query Report**

A copy of the spatial query report is attached at the end of this LIM. The spatial query report lists land use resource consents that have been granted within 100 metres of this property.

Property address:

29 Neville Street

LIM number: H09333381

Page 17

Christchurch City Council

53 Hereford Street, PO Box 73015

Christchurch 8154, New Zealand

Tel 64 3 941 8999

Fax 64 3 941 8984

www.ccc.govt.nz

- Buildings
- StreetAddress
- WwAccess
- Flush Manhole
- Standard Manhole
- Vented Manhole
- WwLocalPressureCon
- WwLocalPressurePu
- WwLocalPressureTan
- WwPipeFlowDirection
- WwPipe
- NominalDiameter
- WwLateral
- WwLateral (non CCC)
- SwInlet
- Single Sump
- SwOutlet
- SwPipeFlowDirection
- SwLateralFitting
- Inspection Point
- SwPipe
- NominalDiameter
- SwLateral
- SwLateral (non CCC)
- WsConnection
- WsFitting
- End Cap
- Connector
- Connector
- Connector
- Connector
- WsHydrant
- WsConnection
- Meter
- WsFitting
- End Cap
- Connector
- Connector
- Connector
- WsHydrant
- WsConnection
- Meter
- WsFitting
- End Cap
- RatingUnit
- SwLateral
- SwLateral (non CCC)
- In Service
- WsValve
- Gate
- Sluice
- WsHydrant
- WsConnection
- Meter
- WsFitting
- End Cap
- Connector
- Connector
- Connector
- WsHydrant
- WsConnection
- Meter
- WsFitting
- End Cap
- RatingUnit

Christchurch City Council 

ph: 03 941 8999 web: ccc.govt.nz

Accuracy not guaranteed. Onsite verification required.
Display of data scale dependant.
Client selected legend.
Copyright © 2025 Reproduction prohibited.

 Date: 19/09/2025 10:01 AM
Scale: 1: 923 on A4

 0 0.0045 0.009 0.018 0.027 0.036 km

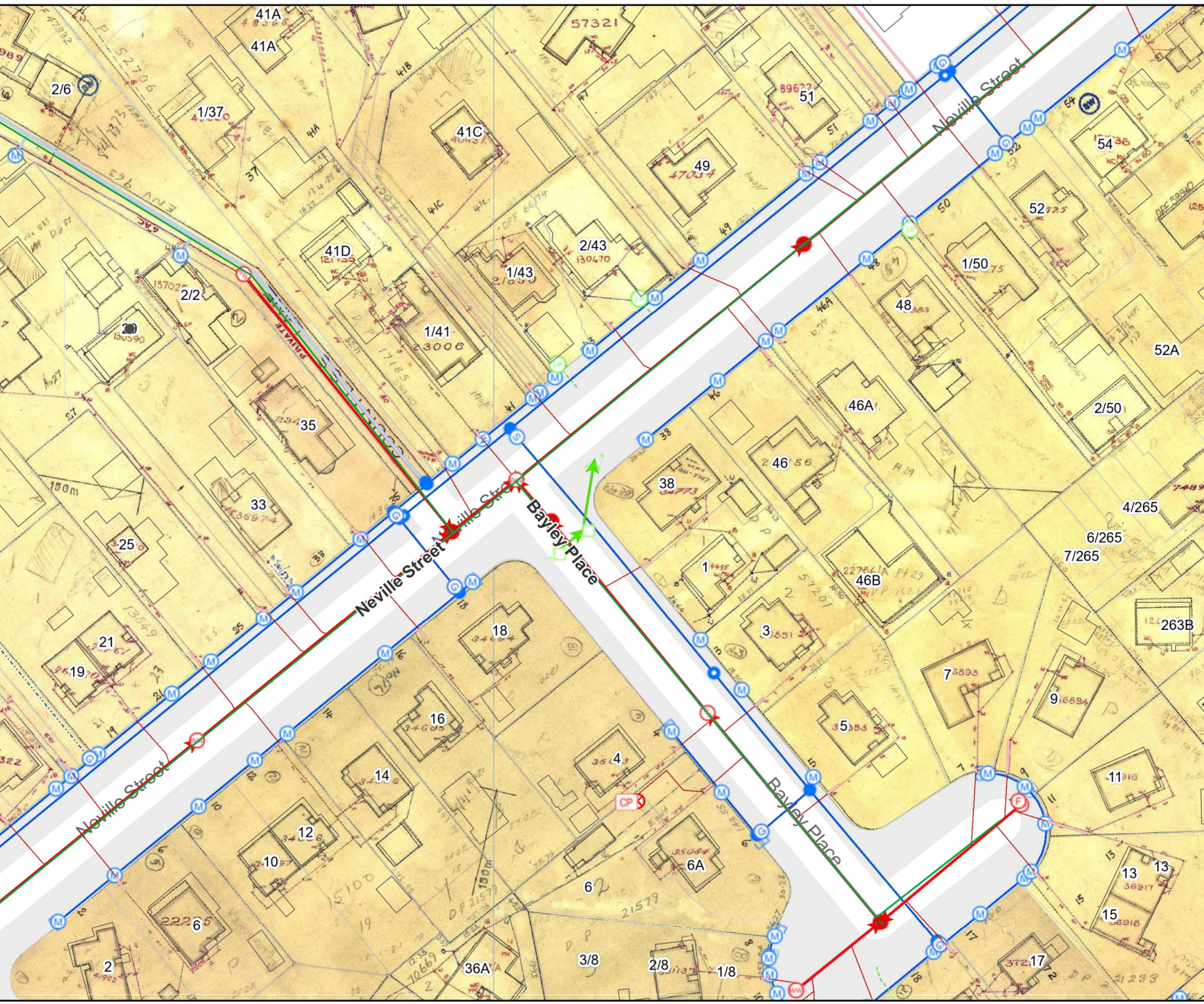

29 Neville Street Land Use Consents

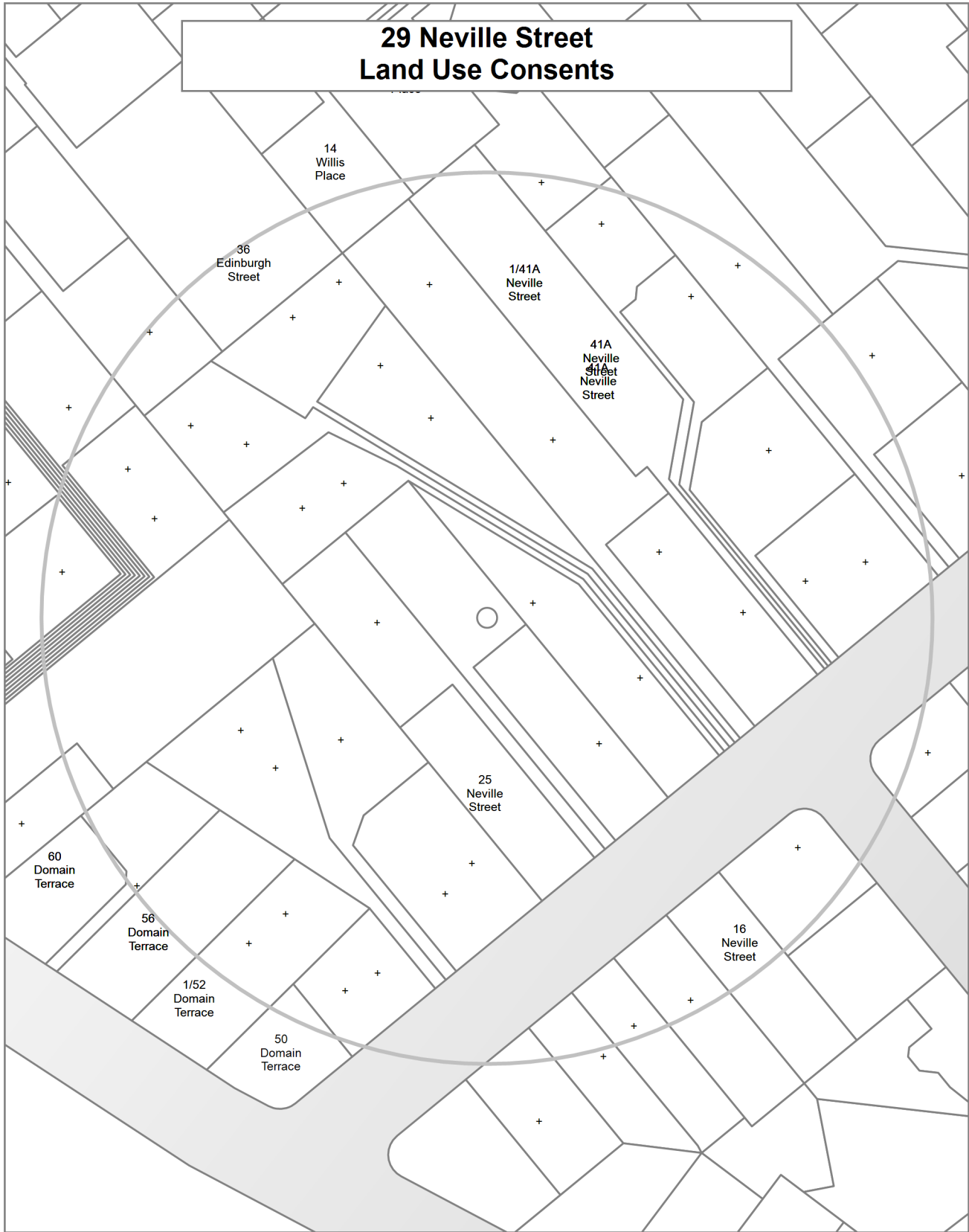

**29 Neville Street
Subdivision Consents**

Fee simple
Lots:2
Approved

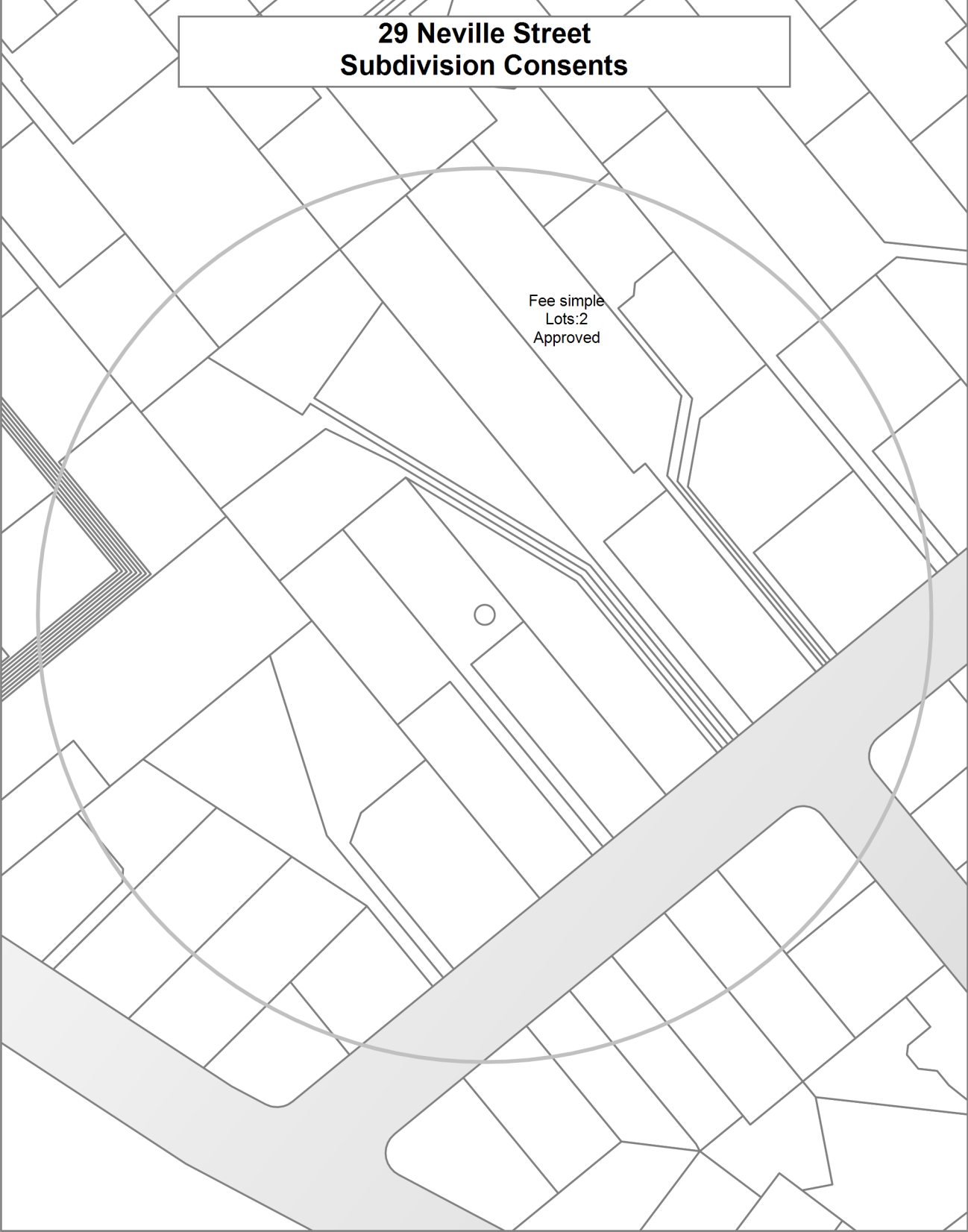

Land Use Resource Consents within 100 metres of 29 Neville Street

Note: This list does not include subdivision Consents and Certificates of Compliance issued under the Resource Management Act.

1/41A Neville Street

RMA/2020/1031

Wastewater Capacity Certificate

Processing complete

Applied 21/05/2020

Certificate issued 26/05/2020

Certificate issued 08/06/2020

RMA/2020/1275

Fee simple subdivision - Two lots

Consent issued

Applied 22/06/2020

Decision issued 02/11/2020

Granted 02/11/2020

RMA/2025/3050

Construction of eight OPH units

Processing

Applied 10/09/2025

1/52 Domain Terrace

RMA/1988/212

Consent to construct 3 single storey apartment units on a site 19.7m wide only (0.3m short of the minimum req'd distance) - Historical Reference RES9205551

Processing complete

Applied 01/02/1988

Decision issued 11/05/1988

Granted 11/05/1988

14 Willis Place

RMA/1997/4188

Reduction in net site area under the Transitional Plan. - Historical Reference RMA556

Processing complete

Applied 01/10/1997

Decision issued 20/10/1997

Granted 20/10/1997

16 Neville Street

RMA/1994/212

Consent to a garage extension to 12m in total length within the side yard - Historical Reference RES9221979

Processing complete

Applied 25/03/1994

Decision issued 06/04/1994

Granted 06/04/1994

16 Willis Place

RMA/2004/802

Application for the erection of an accessory building which contains a double garage and a workshop - Historical Reference RMA20016389

Processing complete

Applied 19/03/2004

Decision issued 25/03/2004

Granted 25/03/2004

25 Neville Street

RMA/2024/180

Alter existing garage to minor residential unit

Processing complete

Applied 30/01/2024

Decision issued 21/02/2024

Granted 21/02/2024

36 Edinburgh Street

RMA/2014/3327

Dwelling with Attached Garage - Recession Plane - Historical Reference RMA92028036

Processing complete

Applied 12/12/2014

Decision issued 23/06/2015

Granted 23/06/2015

41A Neville Street

RMA/2020/1031

Wastewater Capacity Certificate

Processing complete

Applied 21/05/2020

Certificate issued 26/05/2020

Certificate issued 08/06/2020

Certificate issued 26/05/2020

Certificate issued 08/06/2020

RMA/2020/1275

Fee simple subdivision - Two lots

Consent issued

Applied 22/06/2020

Decision issued 02/11/2020

Granted 02/11/2020

Decision issued 02/11/2020

Granted 02/11/2020

RMA/2025/3050

Construction of eight OPH units

Processing

Applied 10/09/2025

50 Domain Terrace

RMA/2021/391

Discharge of encumbrance

Processing complete

Applied 29/05/2014

Encumbrance discharged 26/02/2021

56 Domain Terrace

RMA/1997/2090

Dwelling extension where the two living area windows within the addition are to be located 2.050m from the NW internal boundary. Required to be setback 3m under Proposed Plan. the proposed Terrace is to be 1.7m from the NW internal boundary. - Historical Reference RES972391

Processing complete

Applied 28/08/1997

Decision issued 18/09/1997

Granted 18/09/1997

RMA/2001/2949

Application for additions to an exi will bring total length of wall over 9 metres and recession plane intrusion - Historical Reference RMA20008880

Processing complete

Applied 30/11/2001

Decision issued 12/12/2001

Granted 12/12/2001

60 Domain Terrace

RMA/1996/2107

Transitional Plan application to reduce net site area to 432m² for Lot 2. Reduction of ROW width to 3.0m. Reduction in setback for dwelling on Lot 1 to 1.5m. Proposed Plan reduction in setback for a living window for dwelling on Lot 1 to 1.5m - Historical Reference RES962458

Processing complete

Applied 19/09/1996

Decision issued 24/09/1996

Granted 24/09/1996

RMA/1997/1426

Application for a garage which intrudes through the recession plane by 300mm in relations to the east side boundary of the site under the Transitional Plan. - Historical Reference RES971585

Processing complete

Applied 16/06/1997

Decision issued 30/06/1997

Granted 30/06/1997

64 Domain Terrace

RMA/1986/272

Consent to waive compliance with the 2.3m boundary heigh and recession plane intrusion for a replacement garage and exceed 85m total accessory floor space - Historical Reference RES9205554

Processing complete

Applied 12/03/1986

Decision issued 10/04/1986

Granted 10/04/1986

Data Quality Statement

Land Use Consents

All resource consents are shown for sites that have been labelled with an address. For sites that have been labelled with a cross (+) no resource consents have been found. Sites that have no label have not been checked for resource consents. This will be particularly noticeable on the margins of the search radius. If there are such sites and you would like them included in the check, please ask for the LIM spatial query to be rerun accordingly. This will be done free of charge although there may be a short delay. Resource consents which are on land occupied by roads, railways or rivers are not, and currently cannot be displayed, either on the map or in the list. Resource consents that relate to land that has since been subdivided, will be shown in the list, but not on the map. They will be under the address of the land as it was at the time the resource consent was applied for. Resource consents that are listed as Non-notified and are current, may in fact be notified resource consents that have not yet been through the notification process. If in doubt. Please phone (03)941 8999.

The term "resource consents" in this context means land use consents. Subdivision consents and certificates of compliance are excluded.

Subdivision Consents

All subdivision consents are shown for the sites that have been labelled with consent details. For Sites that have been labelled with a cross (+) no records have been found. Sites that have no label have not been checked for subdivision consents. This will be particularly noticeable on the margins of the search radius. If there are such sites and you would like them included in the check, please ask for the LIM spatial query to be rerun accordingly. This will be done free of charge although there may be a short delay.

The term "subdivision consents" in this context means a resource consent application to subdivide land. Non subdivision land use resource consents and certificates of compliance are excluded.

This report will only record those subdivision applications which have not been completed i.e once a subdivision has been given effect to and the new lots/properties have been established the application which created those lots will not be shown

All subdivision consent information is contained on the map and no separate list is supplied