

Statement of Passing Over:

This information has been supplied by the vendor or the vendor's agents and Smith + Bishop (powered by ownly Ltd licensed REAA 208) is merely passing over this information as supplied to us. We cannot guarantee its accuracy as we have not checked, audited, or reviewed the information and all intending purchasers are advised to conduct their own due diligence investigation into this information. Where you have been supplied with a Council Property File or a LIM Report, please note there may be matters relating to pre-1992 consents or permits in this file which may need further investigation in order to determine their relevance. To the maximum extent permitted by law we do not accept any responsibility to any party for the accuracy or use of the information herein.

DISCLAIMER: Council has made the information available under Section 10 to 18 (inclusive) of the Local Government Official Information and Meetings Act 1987 ONLY. Council does not warrant its accuracy and disclaims all liability whatsoever for any error, inaccuracy or incompleteness of the Information. No person should rely on any information without seeking appropriate independent and professional advice.

SOUTH TARANAKI DISTRICT COUNCIL



RECEIVED

- 4 AUG 1992

SOUTH TARANAKI
DISTRICT COUNCIL

APPLICATION FOR: (tick the applicable box)

- ☐ PROJECT INFORMATION MEMORANDUM ONLY
- ☐ BUILDING CONSENT ONLY (IN ACCORDANCE WITH INFORMATION MEMORANDUM No. 122/92)
- ☐ BOTH A PROJECT INFORMATION MEMORANDUM AND A BUILDING CONSENT

OWNER	
Name: <u>Rex Cole.</u>	
Address: <u>RD2</u> <u>Patea.</u>	
Phone Home <u>24036</u> Bus _____	
LEGAL DESCRIPTION	
Valuation No. <u>1236021760</u>	
Plot No. _____ DP _____	
Section <u>463-64</u> Block <u>111 CARLY</u>	
Survey District <u>Patea District.</u>	
NAME, ADDRESS AND PHONE NUMBERS REGISTRATION NUMBER REQUIRED	
Designer(s): _____	
Builder(s): <u>Mike Cole.</u> <u>RD2 Patea.</u>	
Registered Drainlayer: _____ Reg. No. _____	
Registered Plumber: _____ Reg. No. _____	
Registered Gasfitter: _____ Reg. No. _____	
Registered Electrician: _____ Reg. No. _____	
Building Certifier(s): _____	
Other(s): _____	

SITE ADDRESS	
Street No. _____ Dairy No. _____	
Street Name <u>Kakaramea Road.</u>	
Town <u>Kakaramea.</u>	

DESCRIPTION OF PROPOSED WORK	
<u>Haybarn.</u>	
FLOOR AREA <u>73.5</u> m ²	

ESTIMATED VALUE OF WORK (Includes materials, labour and GST)	
\$ <u>3000</u>	

Type of Building Work <input checked="" type="checkbox"/> New Building <input type="checkbox"/> Alterations <input type="checkbox"/> Demolition	Intended Life Infinite (not less than 50 years) <input checked="" type="checkbox"/> Specified _____ years
---	--

Being Stage <u>1</u> of an intended <u>1</u> stages

Signed by or for and on behalf of the applicant	
Name <u>M M Cole.</u>	
Position <u>Builder.</u> Date <u>10-8-92</u>	

OFFICE USE ONLY

CHARGES AND FEES

Project Information Memorandum	\$	<u>50.00</u>
Building Consent	\$	
Code Compliance Certificate	\$	
Inspections	\$	<u>40.00</u>
Structural Check	\$	
Electricity	\$	
Gas	\$	
Lifts	\$	
Photocopying	\$	
Others	\$	
Sub Total	\$	
G.S.T.	\$	
Total	\$	<u>90.00</u>

Receipt No. 15140 Date 4-8-92

Receipt No. _____ Date _____

Receipt No. _____ Date _____

Planning
Com Engineer
Street Engineer
Services Engineer
Structural Engineer
Building
Drainage
Plumbing
Electrician
Gas
Health
Dangerous Goods
Network Utility Operator
Others

CIRCULATION

P.I.M.	Bldg. Consent
	<input checked="" type="checkbox"/>
	<input checked="" type="checkbox"/>

APPLICATION NO: 2920054

OWNER COLE

122/92
38355

BUILDING CONSENT CHECK SHEET OFFICE USE ONLY

BUILDING

NOT APPROVED _____ DATE _____

Stamp No 1

APPROVED *[Signature]* _____ DATE *8/4/92* _____

STRUCTURAL ENGINEER

NOT APPROVED _____ DATE _____

APPROVED _____ DATE _____

Plumbing & Drainage

NOT APPROVED _____ DATE _____

APPROVED _____ DATE _____

Electrical

Not Approved _____ Approved _____

Date _____ Date _____

GAS

Not Approved _____ Approved _____

Date _____ Date _____

FIRE

Not Approved _____ Approved _____

Date _____ Date _____

CHARGE OUT

OFFICE USE ONLY

[illegible]

NATURE OF PERMIT (TICK BOX)

- ☒ **NEW BUILDING**
- exclude domestic garages and domestic outbuildings
- ☐ **FOUNDATIONS ONLY**
- ☐ **ALTERED, REPAIRED, EXTENDED, CONVERTED, RESITED**
- include installation of heating appliances
- ☐ **NEW CONSTRUCTION OTHER THAN BUILDINGS**
- include demolitions
- ☐ **DOMESTIC GARAGES AND DOMESTIC OUTBUILDINGS**

To be completed for both Building Consent and Project Information Memorandum
The Project involves the following matters (Cross each applicable box, if any, and attach relevant information in duplicate)

Location of buildings in relation to Legal Boundaries	<input type="checkbox"/>
External dimensions of new, relocated or altered building(s)	<input type="checkbox"/>
New Provisions to be made for vehicular access, including parking	<input type="checkbox"/>
Provisions to be made in building over or adjacent to any road or public place	<input type="checkbox"/>
Provisions to be made for disposing of stormwater and wastewater	<input type="checkbox"/>
Precautions to be taken where building work is to take place over any existing drains or sewers or in close proximity to wells or watermains	<input type="checkbox"/>

New connections to public utilities	<input type="checkbox"/>
Provisions to be made in any demolition work for the protection of the Public, suppression of dust, disposal of debris, disconnection from public utilities & suppression of noise	<input type="checkbox"/>
Any Cultural heritage significance of the building or building site, including whether it is a marae	<input type="checkbox"/>
Other details _____	

TO BE COMPLETED FOR BUILDING CONSENT ONLY

All information necessary to verify that the building work, if properly completed in accordance with those plans and specifications, will comply with the provisions of the building Act 1991 and the New Zealand Building Code, Including:-

<input type="checkbox"/>	Building certificates
<input type="checkbox"/>	References to determinations
<input type="checkbox"/>	References to accreditation certificates
<input type="checkbox"/>	Reference to Approved Documents
<input type="checkbox"/>	Producer Statements

Proposed procedures (if any) for inspection during construction

<input type="checkbox"/>	Inspection by building certifier(s)
<input type="checkbox"/>	Inspection by South Taranaki District Council

DOCUMENTS SUBMITTED WITH THIS APPLICATION IN DUPLICATE AND TO SCALE
(Please tick box)

Site and/or Drainage Plans	<input checked="" type="checkbox"/>
Floor Plans	<input checked="" type="checkbox"/>
Cross-sections and details	<input checked="" type="checkbox"/>
All Elevations	<input checked="" type="checkbox"/>
Wall Bracing Calculations	<input checked="" type="checkbox"/>
Specifications	<input type="checkbox"/>
Structural Calculations	<input checked="" type="checkbox"/>
Other	<input type="checkbox"/>

PLEASE INDICATE THE MATERIALS TO BE USED

Floor (tick boxes)

1	<input type="checkbox"/> Timber
2	<input checked="" type="checkbox"/> Concrete
3	<input type="checkbox"/> Wood Products
4	<input type="checkbox"/> Other

Framing (tick boxes)

1	<input checked="" type="checkbox"/> Timber
2	<input type="checkbox"/> Concrete
3	<input type="checkbox"/> Steel
4	<input type="checkbox"/> Aluminium
5	<input type="checkbox"/> Other

Roof (tick boxes)

1	<input checked="" type="checkbox"/> Steel Sheeting
2	<input type="checkbox"/> Steel Tiles
3	<input type="checkbox"/> Concrete Tiles
4	<input type="checkbox"/> Shingles
5	<input type="checkbox"/> Aluminium
6	<input type="checkbox"/> Other

Internal Linings (tick boxes)

1	<input type="checkbox"/> Plaster board
2	<input type="checkbox"/> Fibrous plaster
3	<input type="checkbox"/> Wood Products
4	<input type="checkbox"/> Other

External Cladding (tick boxes)

1	<input type="checkbox"/> Brick
2	<input type="checkbox"/> Concrete
3	<input type="checkbox"/> Concrete Block
4	<input type="checkbox"/> Cement Board
5	<input type="checkbox"/> Plaster
6	<input type="checkbox"/> Timber
7	<input checked="" type="checkbox"/> Steel
8	<input type="checkbox"/> Aluminium
9	<input type="checkbox"/> Other

For Office Use Only
PROJECT INFORMATION MEMORANDUM

PLANNING		FEE: _____
NOT APPROVED _____ DATE _____ APPROVED <u>85/104</u> DATE <u>4/5/22</u>		

HEALTH	
NOT APPROVED _____ DATE _____ APPROVED _____ DATE _____	

DANGEROUS GOODS	
NOT APPROVED _____ DATE _____ APPROVED _____ DATE _____	

STREETWORKS ENGINEER	VEHICLE CROSSING Fee \$ _____
NOT APPROVED _____ DATE _____ APPROVED _____ DATE _____	

NETWORK UTILITY OPERATORS

SERVICES ENGINEER	SEWER CONNECTION FEE \$ _____ WATER CONNECTION FEE \$ _____
NOT APPROVED _____ DATE _____ APPROVED _____ DATE _____	

GAS	FEE \$ _____
NOT APPROVED _____ DATE _____ APPROVED _____ DATE _____	

ELECTRICAL	FEE \$ _____
NOT APPROVED _____ DATE _____ APPROVED _____ DATE _____	

APPROVING OFFICER	
NOT APPROVED _____ DATE _____ APPROVED _____ DATE _____	

SOUTH TARANAKI DISTRICT COUNCIL

PRIVATE BAG 902 HAWERA TELEPHONE (06) 278-8010 FACSIMILE (06) 278-8757

SERVICE CENTRES:

P.O. Box 142 ELTHAM 06-764 8143
P.O. Box 15 MANAIA 06-274 8189
P.O. Box 19 OPUNAKE 06-761 8729
P.O. Box 28 PATEA 06-273 8084
87 Weraroa Rd. WAVERLEY 06-346 5096
AGENCY
57 Victoria St. KAPONGA 06-764 6681

CODE COMPLIANCE CERTIFICATE Section 43(3), Building Act 1991

Applicant

MR REX COLE
R D 2
PATEA

Consent Details

Consent/PIM No.: 920054
Date issued: 9/09/98
Valn No: 1236021700



Project Descrn:

NEW CONSTRUCTION
BEING STAGE 1 OF AN INTENDED 1 STAGE
HAYBARN

Intended Life:

SPECIFIED AS 50 YEARS YEARS

Intended Uses:

Project Location:

435 634 KAKARAMEA RD, KAKARAMEA

Legal Description:

SECS 463 & 64 PATEA DIST BLK III CARLYLE
SD

Estimated Value:

\$ 3,000

This is a final code compliance certificate issued in respect of
all the building work under the above building consent.

FILE NOTE:

This Consent originally
affected a property other
than that related to this
file, through Subdivision
this Consent now relates
to this property.

SIGNED FOR AND ON BEHALF OF THE COUNCIL:

Building Control Section

Date:

[Signature]
10/9/98

BUILDING PERMIT
(Office Copy)

AUTHORITY

Stats. No. **K** 31355
No.

South Taranaki District Council

Receipt No. *75740*

Date Permit Issued *5 / 8 / 92*

OWNER

Name *REN COLE*

Mailing Address *RD2*

Patea

BUILDER

Name *MIKE COLE*

Mailing Address *RD2*

Patea



CONS

PROPERTY ON WHICH BUILDING IS TO BE ERECTED/DEMOLISHED

SITE

Street No. _____

Street Name *KINDAMENO RD.*

Town/District *PATEA*

Ward _____

LEGAL DESCRIPTION

Valuation Roll No. *1236021700*

Lot *463-64* D.P. _____

Section _____ Block *III*

Survey District *Patea District*

DESCRIPTION OF PROPOSED WORK AND MAIN PURPOSE OF USE

May BATH

FLOOR AREA

DWELLING UNITS

Whole
Sq. Metres *74*

Number
Erected _____

ESTIMATED
VALUES
\$

Building } *3000.00*
Plumbing }
Drainage }
G.S.T. }
TOTAL

NATURE OF PERMIT (TICK BOX)

- ☒ NEW BUILDING
- exclude domestic garages and domestic outbuildings
- ☐ FOUNDATIONS ONLY
- ☐ ALTERED, REPAIRED, EXTENDED, CONVERTED, RESITED
- include installation of heating appliances
- ☐ NEW CONSTRUCTION
OTHER THAN BUILDINGS - include demolitions
- ☐ DOMESTIC GARAGES
AND DOMESTIC OUTBUILDINGS

FEES APPLICABLE

Building Permit	\$ <i>50.00</i>	Water Connection	\$ _____
Street Damage Deposit	\$ _____	<i>Inspections</i>	\$ <i>40.00</i>
Building Research Levy	\$ _____		\$ _____
Plumbing	\$ _____		\$ _____
Drainage	\$ _____		\$ _____
Sewer Connection	\$ _____		\$ _____
Vehicle Crossing Levy	\$ _____	G.S.T.	\$ _____
M.S. Plumbing	\$ _____	TOTAL:	\$ _____

Receipt No. *75740*

Date of Payment *4 / 8 / 92*

Authorised Officer *JH Hall*

Special Conditions: (In addition to those noted on reverse):

1244022800

B.C.O. to be notified when shed is completed.

NOTICE TO APPLICANT

PERMISSION IS HEREBY GRANTED YOU to carry out the works as proposed in accordance with the drawings and other documents submitted, and with any conditions defined; such work to be subject to inspection at any time during progress and to be carried out in strict conformity with the requirements of the Council By-Laws.

IMPORTANT - YOU ARE FULLY RESPONSIBLE for any damage done to any works such as telephone cables, power cables, water mains, gas mains, sewers, pipes, footpaths, roads or other services.

Inspector: M _____ File No. _____

Receipt No. 75740

Date Permit Issued 5 / 8 / 92

OWNER

Name Mr. CUE

Mailing Address RD 2
PATCA

BUILDER

Name Mr. CUE

Mailing Address RD 2
PATCA

PROPERTY ON WHICH BUILDING IS TO BE ERECTED/DEMOLISHED

SITE

Street No. _____

Street Name KINDAMEN RD

Town/District PATCA

Ward _____

LEGAL DESCRIPTION

Valuation Roll No. 1236021700

Lot 113-66 D.P. _____

Section _____ Block III

Survey District Patca District

DESCRIPTION OF PROPOSED WORK AND MAIN PURPOSE OF USE

11/4 BATH

FLOOR AREA Whole Sq. Metres 74

DWELLING UNITS Number Erected _____

ESTIMATED VALUES \$	Building	}	<u>3000.00</u>	
	Plumbing			
	Drainage			
	G.S.T.			
	TOTAL			

NATURE OF PERMIT (TICK BOX)

☒ NEW BUILDING
— exclude domestic garages and domestic outbuildings

☐ FOUNDATIONS ONLY

☐ ALTERED, REPAIRED, EXTENDED, CONVERTED, RESITED
— include installation of heating appliances

☐ NEW CONSTRUCTION
OTHER THAN BUILDINGS — include demolitions

☐ DOMESTIC GARAGES
AND DOMESTIC OUTBUILDINGS

FEES APPLICABLE

Building Permit	\$ <u>50.00</u>	Water Connection	\$ _____	Receipt No. <u>75740</u>
Street Damage Deposit	\$ _____	INSPECTION	\$ <u>40.00</u>	
Building Research Levy	\$ _____		\$ _____	Date of Payment <u>4 / 8 / 92</u>
Plumbing	\$ _____		\$ _____	
Drainage	\$ _____		\$ _____	Authorised Officer <u>J. Hall</u>
Sewer Connection	\$ _____		\$ _____	
Vehicle Crossing Levy	\$ _____	G.S.T.	\$ _____	
M.S. Plumbing	\$ _____	TOTAL:	\$ _____	

Special Conditions: _____

B.C.O. to be notified when shed is completed.

Date Inspected	REMARKS (e.g. stage reached with work)
<u>7/10/92</u>	<u>Job Completed</u>

Date Inspected

[illegible]

COMPLETED (Signature) _____ Date ____/____/____

RECEIVED

- 4 AUG 1992

SOUTH TARANAKI
DISTRICT COUNCIL

SITE PLAN

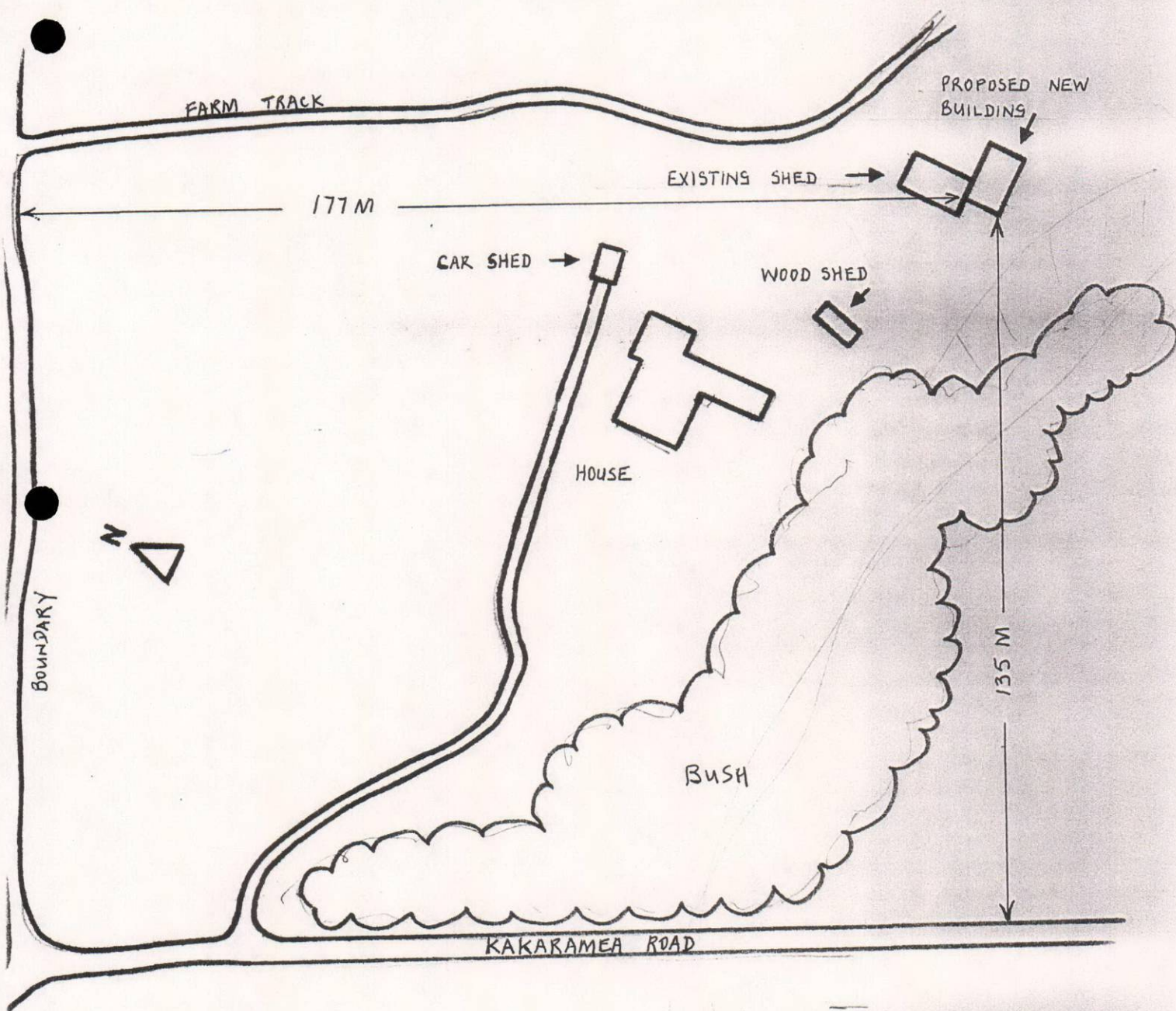

0 10 20 30 40 50
APPROX SCALE M



EXISTING, SHED

PLAN

SCALE 20:1

N

7.0 m

10.5 m

↑
A
see x section.

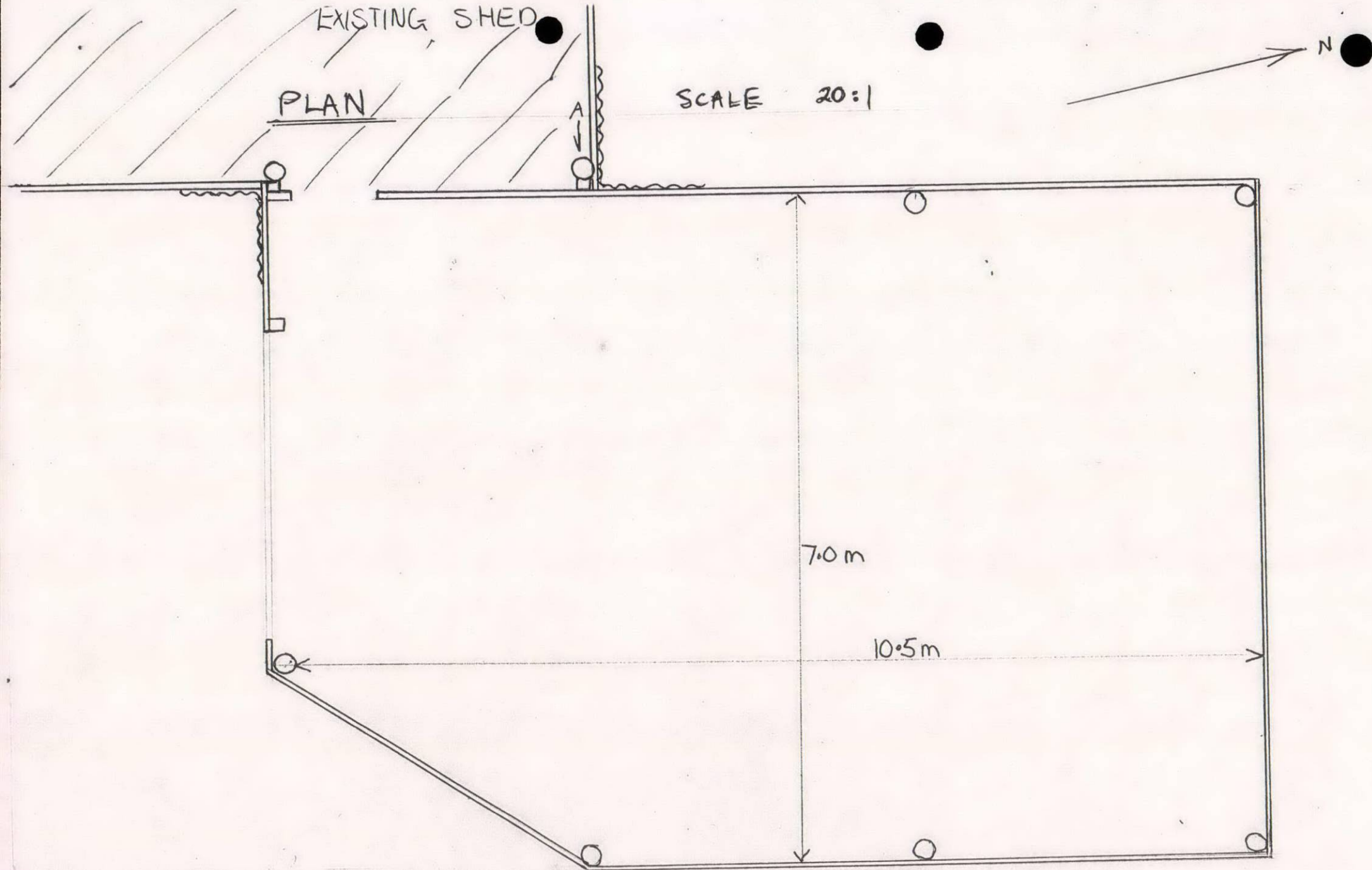

POLE TOP DETAIL.

Scale 100mm : 1m.

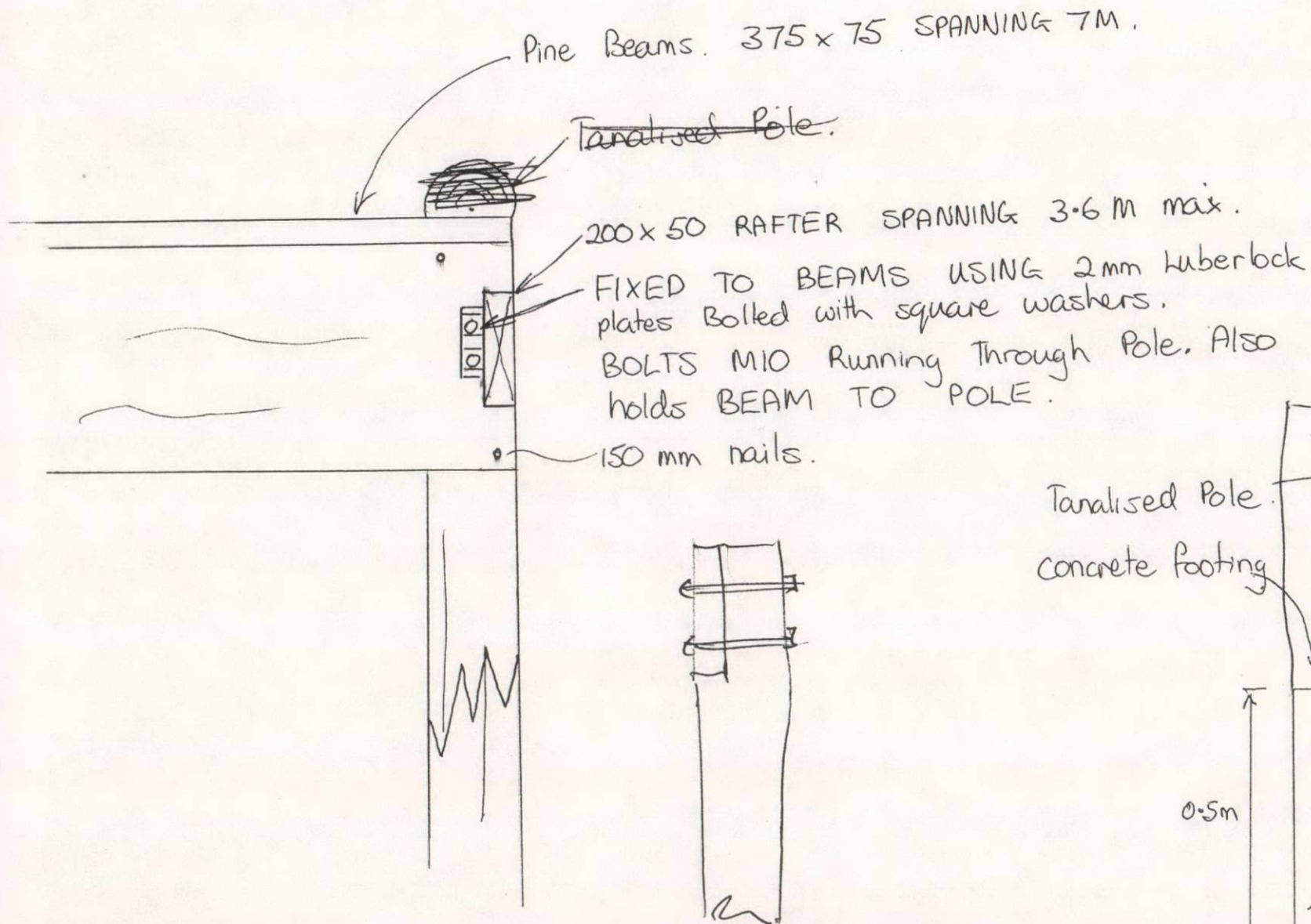

POLE BOTTOM DETAIL.

Scale. 100mm : 1m

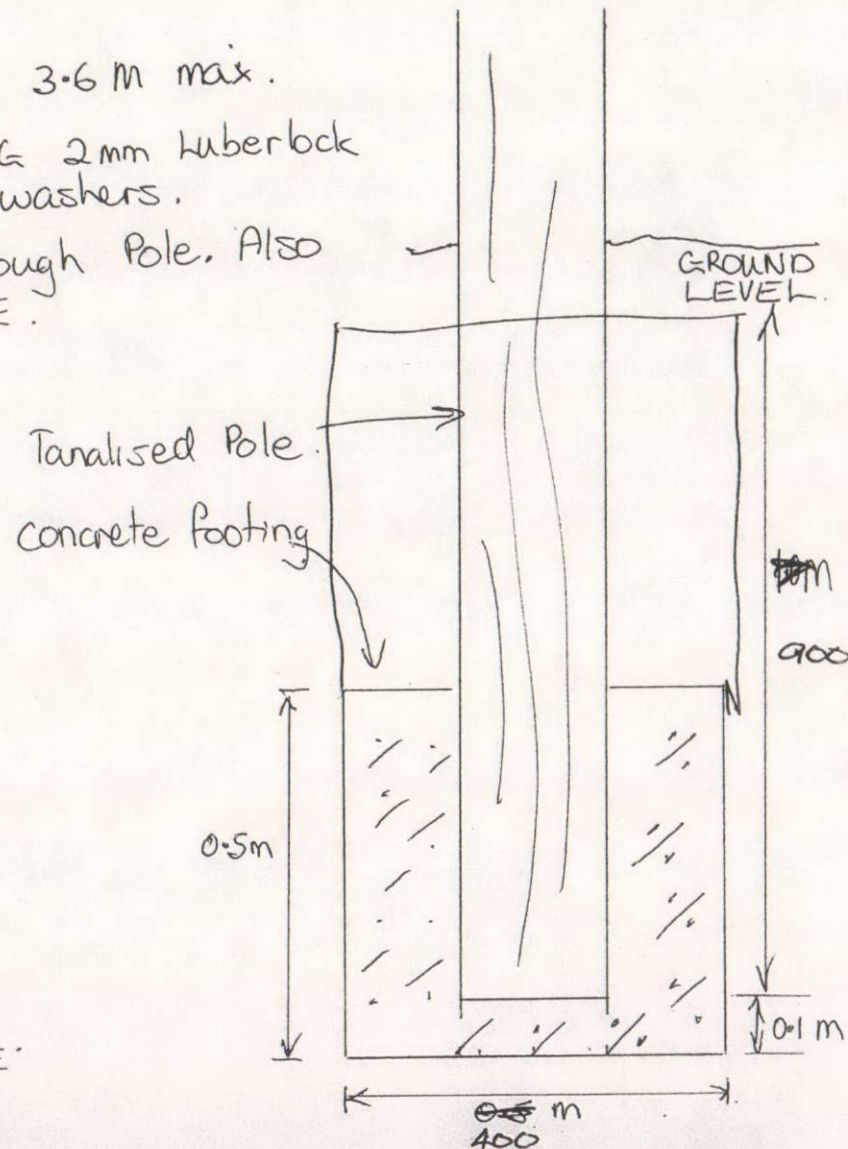

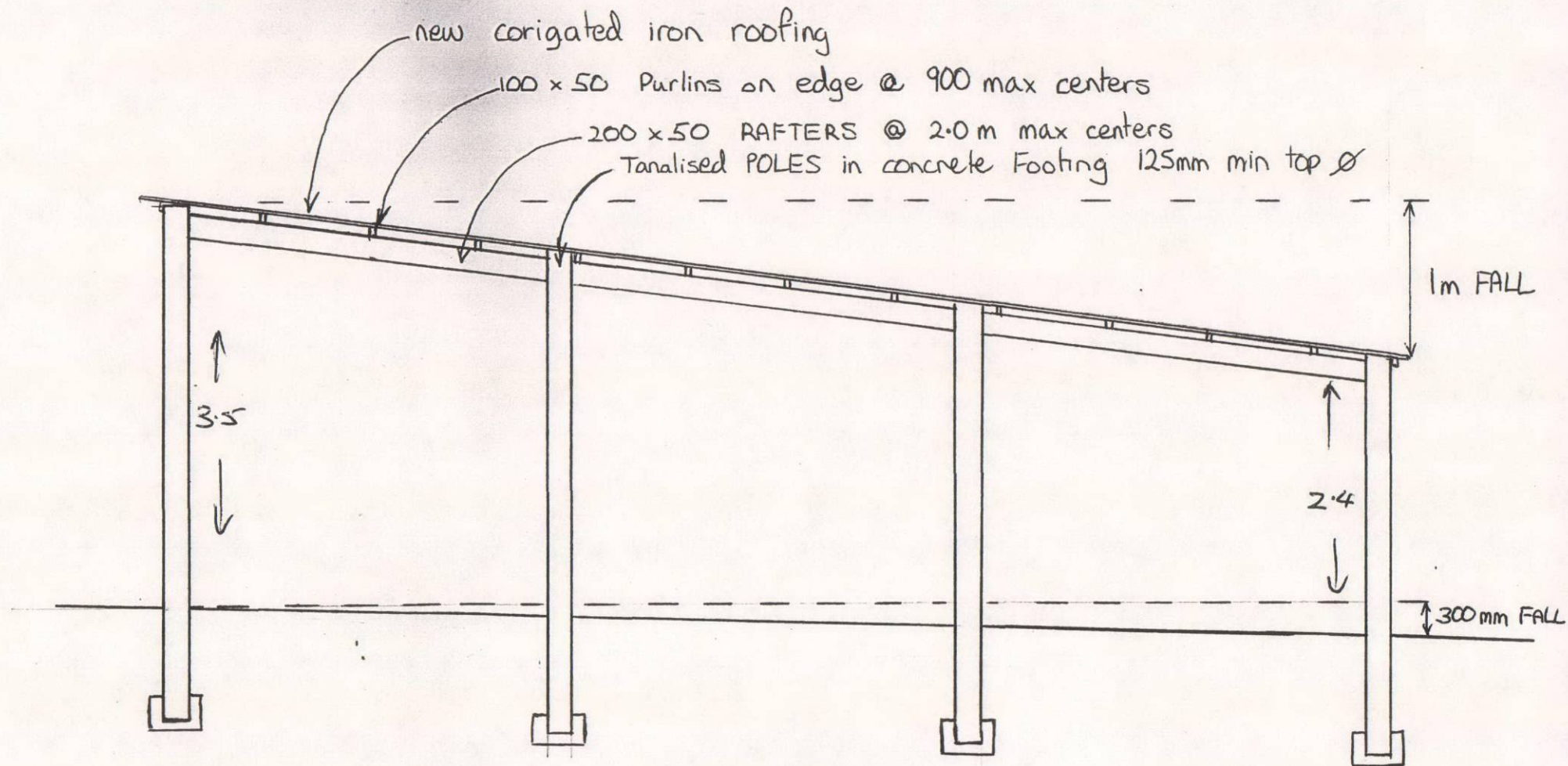

EAST ELEVATION

Scale 20:1

375x75 BEAM STRAPPED & BOLTED
TO 100x100 POST

Pole in existing shed

100x100 POST BLOCKED
AND THROUGH BOLTED
TO EXISTING POLE
IN THREE PLACES.
M10 BOLTS.

200x50.

150x50 BETWEEN PO.
TO CARRY IRON SIDE

X Section at AA

Scale 20 mm : 1 m

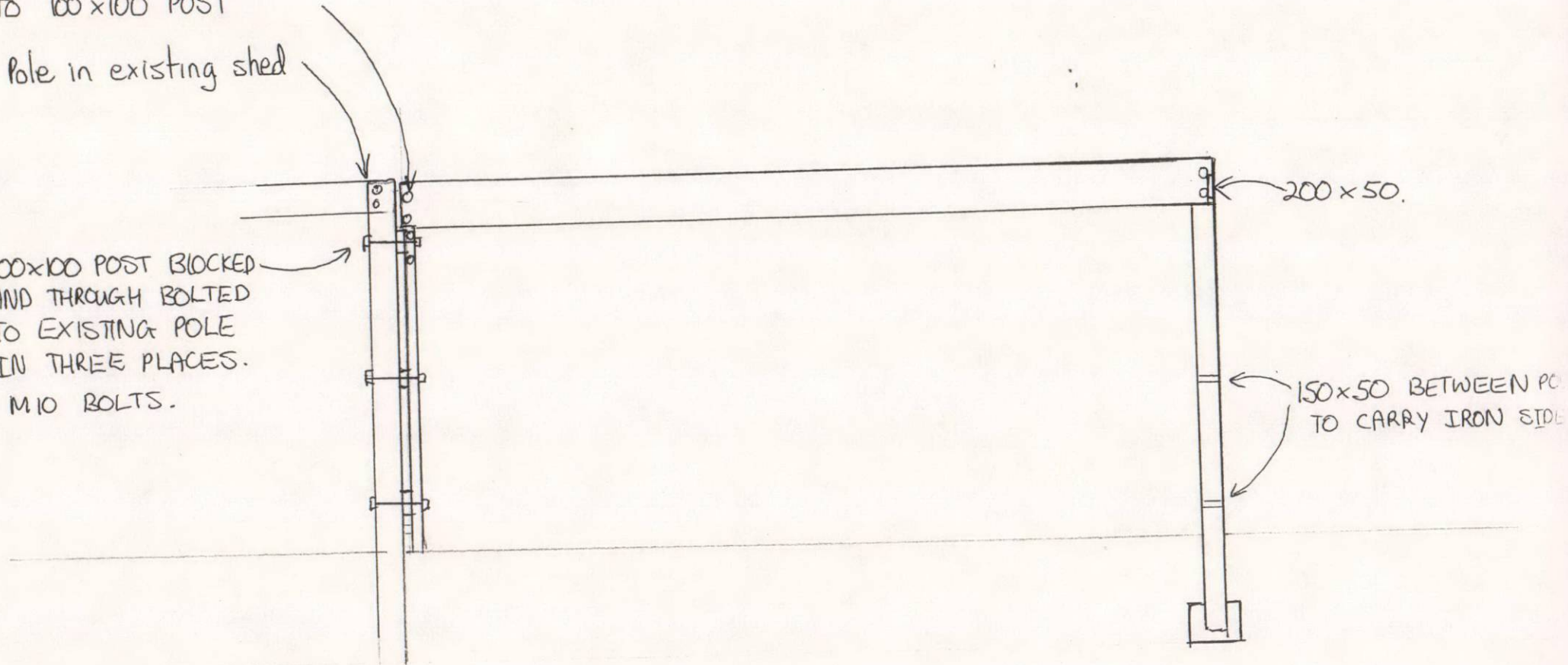

12360-217-00



20 July 2011



Alison Gibson
South Taranaki District Council TA Certification Division
Private Bag
Hawera 0000

Survey Ref: 08262.nzt

(464) P/N-10916 ✓ L/D-14996
(463) ✓ L/N-14997

Territorial Authority Ref: RMS080063

Deposit of DP 411106 Taranaki Land District

Cadastral Survey Dataset DP 411106 of Lots 1 and 2 being a Subdivision of Sections 463 and 464 Patea District Land Registration District of Taranaki lodged by Ian Michael Dickey was deposited on 08/07/2011.

The following new Computer Register(s) have been issued:

Kaukaramea Rd.

Computer Register: 441516

435 Area: 2.6357 hectares

Legal Description: Lot 1 Deposited Plan 411106

(217/01)

L/D

24932.

1002894

Computer Register: 441517

634 Area: 47.9500 hectares

Legal Description: Lot 2 Deposited Plan 411106

(217/00)

24933

1002895

Hirsthouse Rd.

Area Manager

Association) ✓

Scanned & Attached. ✓

New Prop File 217/01 ✓

Christchurch Processing Centre
112 Tuam St
Private Bag 4721
Christchurch Mail Centre
Christchurch 8140
New Zealand
Tel 0800 ONLINE (665463)
Fax 64-3-366 6422
Internet <http://www.linz.govt.nz>

RMS080063
Your Ref 08262

Ian Dickey
BTW Company Ltd
PO Box 551
New Plymouth 4340

Dear Ian

Survey Plan – Rox Cole, 435 Kakaramea Road, Kakaramea

The final survey plan has been approved electronically pursuant to Sections 223 and 224 of the Resource Management Act 1991.

Attached is an invoice for the approvals.

If you wish to discuss anything further with me, please do not hesitate to contact me.

Yours sincerely

Christine Bromell
Planning Administration Officer/PA

christine.bromell@stdc.govt.nz

Tax Invoice/Statement: 9486

GST Reg. No: 52-769-477

Invoice Date: 30 May 2011

R M Cole
Kakarama Road
RD 2
Patea 4598

Address: Private Bag 902
Hawera
Phone: 06 278 0555
Free Phone: 0800 111 323
Facsimile: 06 278 8757
Email: contact@stdc.govt.nz
Website: www.stdc.co.nz

FILE COPY

Application Number: RMS080063
Description: 2 Lot Rural Subdivision
Owner: R M Cole
Location Address: 435 Kakarama Road Kakarama

Charge Description	Charge	GST	Amount
Plan Approval Processing (Engineering)	\$49.78	\$7.47	\$57.25
Site Visit Engineering	\$136.96	\$20.54	\$157.50
Subdivision 223 Certificate Fee	\$99.57	\$14.93	\$114.50
Subdivision 224 Certificate Fee	\$99.57	\$14.93	\$114.50
Total	\$385.88	\$57.87	\$443.75

Remittance Advice**Please post to:**

South Taranaki District Council
Private Bag 902
Hawera 4640

If you wish to pay online details are as follows - 030647-0220100-03
Please quote the Application Number as the reference

Application Number: RMS080063
Applicant: R M Cole
Amount Due: \$443.75

Client Ref



TA Approvals

Territorial Authority	South Taranaki District Council TA Certification Division	TA Reference	RMS080063
Survey Number	LT 411106	Survey Purpose	LT Subdivision
Surveyor Reference	08262.nzt	Land District	Taranaki
Surveyor	Ian Michael Dickey		
Surveyor Firm	BTW Company (New Plymouth)		
Dataset Description	Lots 1 and 2 being a Subdivision of Sections 463 and 464 Patea District		

TA Certificates

I hereby certify that plan 411106 was approved by the South Taranaki District Council pursuant to section 223 of the Resource Management Act 1991 on the 30 May 2011. ✓

Pursuant to Section 224(c) Resource Management Act 1991 I hereby certify that all the conditions of the subdivision consent have been complied with to the satisfaction of the South Taranaki District Council
Dated this 30 day of May 2011 ✓

Signature

Signed by Christine Maree Bromell, Authorised Officer, on 30/05/2011 01:02 PM

Receipt Information

Transaction Receipt Number	5531376
Signing Certificate (Distinguished Name)	Bromell, Christine Maree
Signing Certificate (Serial Number)	1019733972
Signature Date	30/05/2011

*** End of Report ***