

Arrow International / AMI - Out of Scope Project - Site Assessment Sheet

Claim No: 03373994

Address: 114 Wales St.

Insured: Annee Thurston

Policy Type: Replacement

Project Manager: PRM

Excess: \$200

Contractor:

Date: 13-03-13

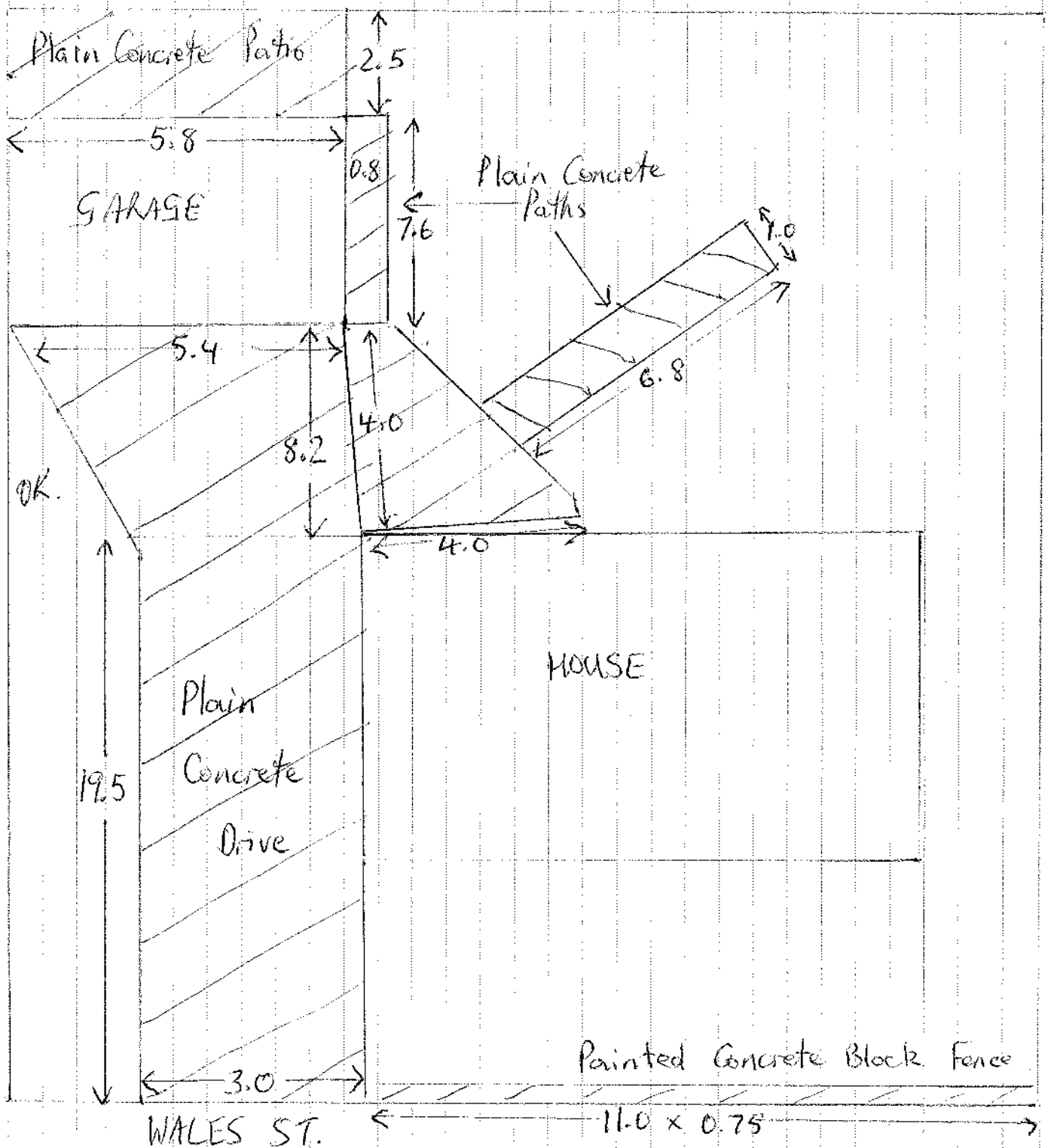

- * Replace plain concrete drive - $19.5 \times 3.0 = 58.5$
- * Demo, rebuild + paint concrete block fence - $11.0 \times 0.75 = 8.25m^2$
- * Replace plain concrete paths + patio - $5.8 \times 2.5 = 14.5$
- * $\frac{3.0 + 5.4}{2} \times 8.2 = 34.44$
- * $2.0 \times 4.0 = 8.0$
- * $6.8 \times 1.0 = 6.8$
- * TOTAL = $92.84m^2$
- * TOTAL = $35.38m^2$

Vicki Tranter

From: Richie Flitcroft [Richie.Flitcroft@nks.co.nz]
Sent: Thursday, 8 June 2017 3:33 p.m.
To: Vicki Tranter
Subject: FW: Thurston to Miller- 114 Wales Street, Christchurch.
Attachments: Quote QU0194.pdf

Hi Vicki - see below from Robert Thurston and attached quote.

I look forward to hearing from you with respect to confirmation of the contract.

Richie Flitcroft LL.B. BCA
Partner
NICHOLSONS Lawyers & Notary Public
PO Box 68, DX NP90008
NEW PLYMOUTH
NEW ZEALAND
p: + 64 6 757 5609 f: + 64 6 758 8569
e: richie.flitcroft@nks.co.nz

The information and any files and attachments transmitted in this communication are confidential and may also be legally privileged, intended only for the specific addressee.

If you are not the addressee, you are hereby notified that any use, copying or dissemination of this communication is strictly prohibited. Please notify us immediately if you are not the addressee by advising us that you have deleted this communication along with any files and attachments.

Thank you.

From: Rob Thurston [mailto:Rob@beattiegroupp.co.nz]
Sent: Thursday, 8 June 2017 3:23 p.m.
To: Richie Flitcroft
Subject: RE: Thurston to Miller- 114 Wales Street, Christchurch.

They have been engaged and will be have done by 30th.
All new drive in concrete.

Cheers
Rob Thurston
0293794840

Beattie  **air**



QUOTE

Robbie - 114 Wales Street, Halswell

Date
19 May 2017

Quote Number
QU-0194

GST Number
111-599-300

Bond Earth Works Ltd
P O Box 9418
Tower Junction
Christchurch 8149
NEW ZEALAND
Phone: 0272592500
admin@bondearthworks.co.
nz

Description	Quantity	Unit Price	Amount NZD
Excavate Driveway Concrete by Machine, New Subbase and Supply and Install new 20MPA Plain Concrete	143.60	110.00	15,796.00
If Required Excavate Footpaths Concrete by Hand, New Subbase and Supply and Install new 20MPA Plain Concrete	15.00	130.00	1,950.00
Subtotal			17,746.00
TOTAL GST 15%			2,661.90
TOTAL NZD			20,407.90

Terms

Bond Earth Works has priced on what it can see and what has been discussed with the client. Any further work needed where extra funds and materials will be required will be discussed with the client before job commencement.

EXPECTED RISKS

Bond Earthworks have made no provisions in the prices quoted for:

- a)Excavation or removal and replacement or backfilling of any unsuitable foundation/ subgrade material.
- b)Repair and/or reinstatement of any buried services not drawn to Bond Earthworks attention prior to making this quotation.

Bond Earth Works requires a 50% deposit before job commencement and final payment paid within 7 days of job completion. Deposit to be paid to BNZ 02-0820-0208851-00.

Scope Of Works



Client Name Mr & Mrs Robert & Aimee Thurston
Address 114 WALES STREET
HALSWELL
CHRISTCHURCH 8025

Customer Excess (inc GST)

\$200.00

Project Manager MacDonald, Paul
Assessment Date 13/03/2013
Issue Date 14/03/2013

Reference Numbers

Primary Claim Number	D3373994	Property Reference Number	D3373994
Primary Policy Number	3797168D02	McLarens Claim Number	D3373994

Contact Details

Contact Name Aimee Thurston
Contact Number (03) 3221571
Contact Email

Insurance Events

Damage Allocation	Damage Allocation	Excess
4 September 10	100%	\$200.00
Total Excess		\$200.00

Comments

This property was inspected on 13.03.13
AMI/Southern Response records show that there is one claim for the Out of EQC scope items.
The policy holder has informed me that the damage occurred in September 2010
It is my assessment that one excess applies in this case.
There is evidence of earthquake related damage to the drive, paths, and patio. See the attached sketch and schedule for details of repairs.
There is no evidence of pre-existing damage.
The property was very overgrown and it was very difficult to establish the sizes of paths and whether there was any earthquake damage.

Cash Settlement

Instructions

The works listed below represent repairs that are considered suitable for a cash settlement request. Generally repairs will be undertaken unless the repair is shared with a third party. Any cash settlement request is subject to Southern Response's approval.

Site - Front

Concrete Drive (Plain - Concrete)

Southern Response

Replace plain concrete drive

Cracked Concrete Surface	Measure	Quantity	Rate (\$)	Cost (\$)
Demo, Supply and lay 20MPA plain concrete 100mm thick - Inc demo, top up base and relay surface	m2	92.84	95.00	8,819.80
Sub Total (excl GST)				8,819.80

Site - Front

Wall (0.75 - Concrete Block)

Southern Response

Demo and rebuild at \$340/m2

Paint both sides at \$30/m2

Structural Cracking	Measure	Quantity	Rate (\$)	Cost (\$)
Demo and rebuild 8.25 x \$340/m2	item	1.00	2,805.00	2,805.00
Paint 16.5m2 @ \$30/m2	item	1.00	495.00	495.00
Sub Total (excl GST)				3,300.00

Site - Rear

Concrete Path (Plain - Concrete)

Southern Response

Rear paths and patio

Cracked Concrete Surface	Measure	Quantity	Rate (\$)	Cost (\$)
Demo, Supply and lay 20MPA plain concrete 100mm thick - Inc demo, top up base and relay surface	m2	35.38	95.00	3,361.10
Sub Total (excl GST)				3,361.10

Cash Settlement Schedule Summary

	Total (\$) (excl GST)	GST (\$)	Total (\$) (incl GST)
Total	15,480.90	2,322.14	17,803.04
Other Parties Share	0.00	0.00	0.00
Excess	-173.91	-26.09	-200.00
Southern Response Liability	15,306.99	2,296.05	17,603.04

Other Parties Share	0.00	0.00	0.00
----------------------------	-------------	-------------	-------------

Excess	173.91	26.09	200.00
---------------	---------------	--------------	---------------

Southern Response Liability	15,306.99	2,296.05	17,603.04
------------------------------------	------------------	-----------------	------------------

Disclaimer

The other parties share represents the proportion of the cost that should be paid by a third party. Generally used for shared fences and driveways.

Excess - The excess is payable by the home owner to the Southern Response if a Cash Settlement makes up all or part of the claim settlement process and is payable prior to the start of works or payment of funds. Please make payment on request.

Southern Response Liability - The figure represents the proportion of cost payable by Southern Response to the contractor.

Summary

Cash Settlement	Total (excl GST)	GST	Total (incl GST)
Other Parties Share	0.00	0.00	0.00
Southern Response Liability	15,306.99	2,296.05	17,603.04
Excess	173.91	26.09	200.00
Total Cash Settlement	15,480.90	2,322.14	17,803.04

Other Parties Share	0.00	0.00	0.00
----------------------------	-------------	-------------	-------------

Excess	173.91	26.09	200.00
---------------	---------------	--------------	---------------

Southern Response Liability	15,306.99	2,296.05	17,603.04
------------------------------------	------------------	-----------------	------------------

Grand Total	15,480.90	2,322.14	17,803.04
--------------------	------------------	-----------------	------------------



EARTHQUAKE COMMISSION

Statement of Claim Checklist / Repair Strategy

Date: 14 / 5 / 2011

Author: Doug TARRAH

2011
Claim No: 2010 / 126919

Claimant: Robert THURSTON

Situation of Loss: 114 Wales St
HARSWELL

LA: Doug TARRAH

Estimator: Mark CROFT

Room	Earthquake Damage	Walls	Ceiling	Floor	Repair Strategy
	Y/N	✓	✓	✓	
4.6 x 3.1 Lounge 2.4	Y	0.8 LM Y	4.6 LM Y	N Carpet	walls - strip lining paper, stop, hang, paint ceiling - scrape off, rake out, restipple, paint
2.5 x 2.3 Dining Room 2.4	Y	0.4 LM Y	Y	Y tile	walls - strip lining paper, stop, hang, paint (x1 wall) ceiling - scrape off, rake out, restipple, paint (open plan with lounge)
3.8 x 2.5 Kitchen 2.4	Y	0.8 LM Y	0.5 LM Y	N cork tile	walls - rake out, stop, paint ceiling - rake out, stop, paint window sill - fill in, paint
2.0 x 2.6 Scm Family Room	Y	N	N	N cork tile	Window sill - fill in, paint
4.1 x 3.2 Bedroom 1 2.4	Y	2.8 LM Y	4.0 LM Y	N Carpet	walls - strip lining paper, stop, hang, paint ceiling - scrape off, rake out, restipple, paint
Ensuite	NA				
5.0 x 4.2 Bedroom 2 2.4	Y	2.5 LM Y	4.0 LM Y	N Carpet	walls - strip lining paper, stop, hang, paint ceiling - scrape off, rake out, restipple, paint
3.7 x 3.2 Bedroom 3 2.4	Y	0.9 LM Y	3.5 LM Y	N Carpet	walls - rake out, stop, paint ceiling - scrape off, rake out, re-stipple, paint

Dong TAURUA
14/5/2011

Affix label here

2011/126919

Room	Earthquake Damage	Walls	Ceiling	Floor	Repair Strategy
	Y/N	✓	✓	✓	
3.5 x 2.6 Bedroom 4 2.4		0.4 LM	2.0 LM	N Carpet	Wall - strip lining paper, stop, hang, paint Ceiling - scrape off, rake out, fill, restipple, paint
2.5 x 1.6 Bathroom 2.4		0.4 LM		N Carpet	Wall - rake out, stop, paint
1.5 x 0.8 Toilet 1 2.4	ND				
1.8 x 1.8 Toilet 2 Bath 2	Y	Y	N Carpet	Y Carpet	Walls - reglue glazed shower lining x 1 Floor - Repair x 1m ² of particle board floor (in cupboard)
3.2 x 2.4 Office / Study 2.4	Y	N	3.0 LM Y Carpet	N Carpet	ceiling - scrape off, rake out, fill, restipple, paint
4.1 x 2.4 Sunroom Rumpus	Y	N	N		Window sill - fill in paint
5.8 x 3.3 Entry / Hall(s) 2.4	Y	0.8 LM Y	2.0 LM Y Carpet		Walls - strip lining paper stop hang, paint ceiling - scrape off, rake out, fill, restipple, paint
3.4 x 0.9 Hall 2 Stairwell 1.7 x 2.4	Y	0.8 LM Y	2.4 LM Y Carpet	N Carpet	Walls - strip wall paper, rake out stop, hang wallpaper Ceiling - scrape off, rake out, fill, restipple, paint See supplementary notes re stairwell
1.7 x 1.8 Laundry	Y	Y	Y Carpet	N Carpet	Remove wall ceiling linings and replace Paint walls + ceiling.
8.8 x 5.7 Garage	Y	Y	2.0 LM Y	8.0 LM Y	Walls - rake out, stop, paint (rear room x 2.8 x ceiling - rake out, stop, paint) 5.7 x 2.4 Floor - grind out, epoxy x 3m External - grind + epoxy block cracks + paint face x 8.8 x 2.4
1.7 x 2.3 Bedroom Other 5	ND	N	N Carpet	N Carpet	

.....
(Initials)

Samy TALAUA
14/5/2011

Affix label here
2011 / 126919

Item		Event Damage	Repair Strategy
		Y / N	
Roof		Y	Reset 10 m ² of concrete roof tiles over lounge
EXTERNAL WALLS	North	Y	GRIND out crack and point - 1.5m crack (minor) - Paint 2m ²
	South	N	
	East	Y	grind out crack and point - 1.0m crack (minor) - Paint 1m ²
	West	Y	grind out crack and point - 1.5m crack (minor) - Paint 2m ²
Decks		Y	Repair timber hand rail around deck. (minor fixings and timber)
CHIMNEY	Base	NA	
	Ceiling Cavity	NA	
	Above Roof	NA	
	Fireplace	NA	

Ang TALLIA
14/5/2011

Affix label here
2011 / 126919

Item	Event Damage	Repair Strategy
	Y / N	
Foundations	N	
Piling	N	
Services	N	
Other Dwelling Items	NA	
Outbuildings	NA	
Land & Retaining Walls (Discuss with Supervisor)	N	

Supplementary Notes: IRON STAIRWELL HAS BROKEN AND INSTRUCTION GIVEN TO REPLACE BY RAPID ASSESSMENT TEAM. OWNER IS FORWARDING RECEIPTS.

I confirm the rooms and areas listed above have been inspected by an EQC representative.

Damage caused by the event has been noted and to my knowledge there are no other areas of damage resulting from the event.

Signature of Claimant: Althia Dated: 14/05/11

.....
(Initials)

NOTE: THIS FORM IS TO BE COMPLETED IN THE CLAIMANT'S PRESENCE.

Southern Response Earthquake Services Limited

PO Box 97 365

Manukau City

Manukau 2140

Phone 0800 501 525

Web www.southernresponse.co.nz



Settlement and Discharge Agreement

For Claim Number: D3373994

AMI Policy Number: 3797168D02

Damaged Property Situated: 114 Wales Street, Halswell,
Christchurch

Date of offer: 30 May 2013

Claim Number: D3373994VXJ

AS
PUT



The items listed below (Insured Property) were damaged in one or more earthquakes prior to the date of this document. Southern Response has agreed to accept an insurance claim in respect of the Insured Property. The policyholder has agreed to a full and final settlement of the Claim on the following terms:

Insured Property: Drive, wall and path

	Amount (including GST)
Total	\$17,803.04
Less Policy Excess	\$200.00
Settlement Amount	\$17,603.04
Amount (if any) to be paid to party noted on policy	N/A
Balance to be paid to policyholder	\$17,603.04

The policyholder accepts the payment under this agreement in full and final settlement and discharge of all claims under the Policy for damage (known and unknown) to the Insured Property and in respect of any complaint, claim or right of action, the policyholder has or may have against Southern Response, which arises directly or indirectly out of any earthquake that has occurred before the date of this Agreement. Southern Response will have no responsibility for, and will not be involved in, the repair or reinstatement of the Insured Property.

The policyholder acknowledges that Southern Response Earthquake Services Limited has encouraged the policyholder to seek legal advice as to the effect and implications of this Settlement and Discharge agreement.

Once Southern Response Earthquake Services Limited has received this signed Settlement and Discharge agreement it will release the Settlement Amount.

Set
Pit

Southern Response Earthquake Services Limited

PO Box 97 365

Manukau City

Manukau 2140

Phone 0800 501 525

Web www.southernresponse.co.nz

S O U T H E R N
R E S P O N S E
Urupare ki te Tonga



Signed by Mr Robert William Thurston

Date

X RT Thurston.

12/June/13.

Signed by Mrs Aimee Carissa Thurston

Date

X AThurston.

12/6/13.