

GRIFFIOEN.

RECORD OF TITLE

Statement of Passing Over: This information has been supplied by the vendor or the vendor's agents. GRIFFIOEN. (Powered by Ownly Limited, Licensed REAA 2008) is merely passing over this information as supplied to us.

We cannot guarantee its accuracy as we have not checked, audited, or reviewed the information and all intending purchasers are advised to seek your own advice as to the information contained in this document.

To the maximum extent permitted by law we do not accept any responsibility to any party for the accuracy or use of the information herein.



**RECORD OF TITLE
UNDER LAND TRANSFER ACT 2017
FREEHOLD**

**Guaranteed Search Copy issued under Section 60 of the Land
Transfer Act 2017**



R.W. Muir
Registrar-General
of Land

Identifier **CB4C/575**
Land Registration District **Canterbury**
Date Issued 20 April 1965

Prior References
CB713/33

Estate Fee Simple
Area 627 square metres more or less
Legal Description Lot 19 Deposited Plan 15039
Registered Owners
David Leslie Mervyn Bos-Terry and Marrieke Hillegonda Bos

Interests

Subject to Part IV A Conservation Act 1987
Subject to Section 11 Crown Minerals Act 1991
Pipelines for the passage of sewage and stormwater pass through or serve the within land as specified in Certificate 463572
- 5.8.1957 at 2.00 pm
Fencing Covenant in Transfer A290103.1 - 4.4.1997 at 9.12 am
12449720.3 Mortgage to TSB Bank Limited - 13.5.2022 at 11:57 am

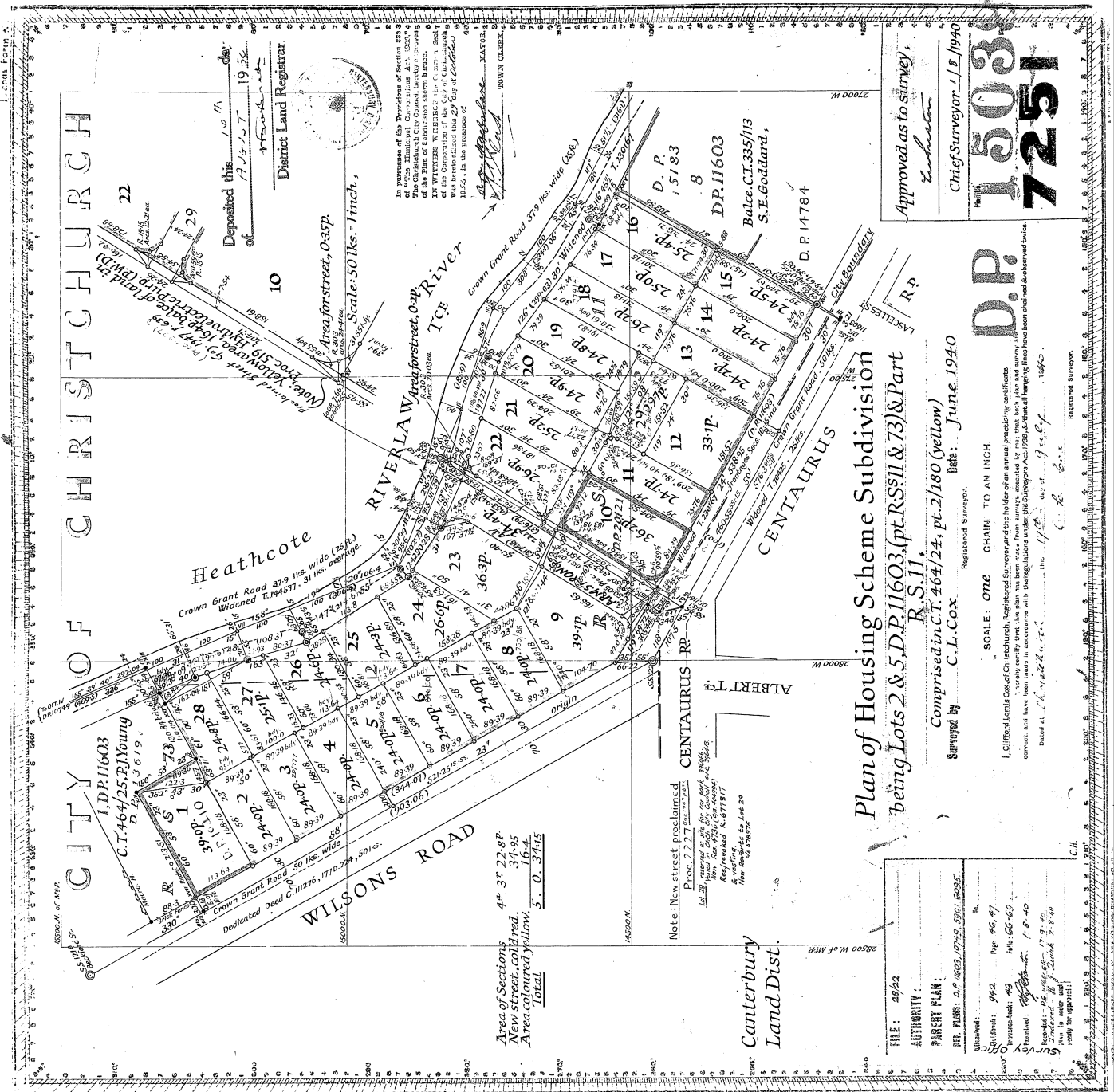

Approved by the Registrar-General
of Land as No. 2359

463572

HCEC

IN L 1896

5p

PIPE LINE CERTIFICATE

Under Section 16 of the Finance Act (No. 21) 1958, 26 of the Housing Act 1955

THE STATE ADVANCES CORPORATION OF NEW ZEALAND acting under Section 16 of the Housing Act, 1955

(extracts from which are for convenience of reference printed on the back hereof) HEREBY

CERTIFIES that a pipe line for the passage of (1) A Sewage B Stormwater passes over or through and serves, the several parcels of land specified in the Schedule hereto as more particularly appears in the diagram (2) endorsed on plan hereto annexed showing the several parcels of land served by the pipe line and the land over or through which the pipe line has been constructed.

It is hereby certified that it is not practicable to show the true course of the pipelines herein but that their positions have been indicated as nearly as possible on the annexed plan and that the pipeline on Reserve 4736 was constructed thereon while the land belonged to the Crown

CERT 463572 Certificate

Cpy - 01/01, Pgs - 005, 16/08/13, 10:54



DocId: 21038879

SCHEDULE

Registered proprietor of fee simple.	Dominant Tenement(s): official description of the parcels of land served by the pipe line.	Registered Agreement or Licence to Occupy affecting any dominant tenement, and names of purchasers or licensees.	Servient Tenement(s): official description of the parcels of land over or through which the pipe line passes.	Registered Agreement or Licence to Occupy affecting any servient tenement, official description and names of purchasers or licensees.
Her Majesty the Queen for the purposes of the Housing Act 1955	A SEWER			
	Lot 1 DP 15106		Lot 2 DP 15106	Licence 635/42 S.G. & N.L. Tonkin (now H.S. Green)
	Lot 3 DP 15106		Lot 4 DP 15106	
	Lot 7 DP 15106		Lot 8 DP 15106	
	Lot 8 DP 15106		Lot 9 DP 15106	
	Lot 13 DP 15106		Lot 14 DP 15106	
	Lot 14 DP 15106		Lot 13 DP 15106	
	Lot 19 DP 15106		Lot 18 DP 15106	
✓ C/T 459/32	Lot 2 DP 14984		Lot 1 DP 14984	
	Lot 1 DP 18633		Lot 2 DP 18633	
✓ C/T 458/164	Lot 2 DP 10749		Lot 3 DP 10749	Agt 540/4 J.W. Smith
	Lot 4 DP 10749		Lot 5 DP 10749	
✓ C/T 478/53-56	Lot 1 DP 15115		Lot 2 DP 15115	
✓ C/T 720/69	Lot 1 DP 15048		Lot 2 DP 15048	
✓ C/T 510/258	Lot 5 DP 15075		Lot 4 DP 15075	
	Lot 9 DP 15075		Lot 8 DP 15075	
	Lot 10 DP 15075		Lot 11 DP 15075	
	Lot 12 DP 15075		Lot 11 DP 15075	
	Lot 14 DP 15075		Lot 15 DP 15075	
	Lot 16 DP 15075		Lot 17 DP 15075	
	Lot 17 DP 15075		Lot 18 DP 15075	
	Lot 20 DP 15075		Lot 19 DP 15075	
✓ C/T 712/33	Lot 1 DP 19410		Lot 2 DP 19410	
	Lot 2 DP 15039		Lot 3 DP 15039	

[Over

A SEWAGEDIAGRAM

C/T 742/33

Lot 5 DP 15039

Lot 6 DP 15039

Lot 8 DP 15039

Lot 9 DP 15039

Lot 10 DP 15039

Lot 29 DP 15039 (R4736)

Lot 11 DP 15039

Lot 29 DP 15039 (R4736)

Lot 16 DP 15039 (Agt 540/78
(J. & P.A. May)Lots 17, 14 & 13
DP 15039

Lot 17 DP 15039

Lots 14, 13 DP 15039

Lot 14 DP 15039

Lot 13 DP 15039

Lot 18 DP 15039

Lots 19 & 29
DP 15039 (R4736)

Lot 19 DP 15039

Lot 29 DP 15039 (R4736)

Lot 21 DP 15039

Lots 20 & 29
DP 15039 (R4736)

Lot 20 DP 15039

Lot 29 DP 15039 (R4736)

Lot 25 DP 15039

Lot 24 DP 15039

Lot 27 DP 15039 (Agt 630/16
(A.A. & M.T. Terry)

Lot 26 DP 15039

B STORMWATER

Bel. C/T 477/242

Lot 1 DP 15106

Lot 2 DP 15106 } Licence 635/42
} S.G. & N.L. Tonkin
} (now H.S. Green)

Lot 5 DP 15106

Lot 6 DP 15106

Lot 8 DP 15106

Lot 7 DP 15106

Lot 8 DP 15106

Lot 9 DP 15106

Lot 9 DP 15106

Lot 10 DP 15106

Lot 12 DP 15106

Lot 11 DP 15106

Lot 13 DP 15106

Lot 12 DP 15106

Lot 13 DP 15106

Lot 14 DP 15106

Lot 15 DP 15106

Lot 14 DP 15106

Lot 16 DP 15106

Lot 15 DP 15106

Lot 18 DP 15106

Lot 19 DP 15106

C/T 459/32

Lot 3 DP 14984

Lot 2 DP 14984

Lot 1 DP 18633

Lot 3 DP 14984

Lot 1 DP 18633

Lot 2 DP 18633

Lot 6 DP 14984

Lot 2 DP 18633

C/T 458/164

Lot 3 DP 10749 (Agt 540/4
(J.W. Smith)

Lot 2 DP 10749

Lot 4 DP 10749

Lots 3 & 2 DP 10749
(Agt 540/4 J.W. Smith)

Lot 4 DP 10749

Lot 5 DP 10749

C/T 478/53-56

Lot 2 DP 15115

Lot 3 DP 15115

✓ Lot 2 DP 15115

Lot 1 DP 15115

C/T 503/111

Lot 1 DP 15105

Lot 2 DP 15105

Lot 3 DP 15105

Lot 2 DP 15105

C/T 720/69

Lot 1 DP 15048

Lot 2 DP 15048

B STORMWATER

C/T 540/258

Lot 2 DP 15075

Lot 3 DP 15075

Lot 4 DP 15075

Lot 5 DP 15075

Lot 6 DP 15075

Lot 7 DP 15075

Lot 8 DP 15075

Lot 10 DP 15075

Lot 11 DP 15075

Lot 12 DP 15075

Lot 13 DP 15075) Licence 613/34
A. E. & B. Alexander
(now J. T. & C. M. McGee)

Lot 14 DP 15075

Lot 15 DP 15075

Lot 20 DP 15075

Lot 19 DP 15075

Lot 18 DP 15075

Lot 17 DP 15075

Lot 21 DP 15075

Lot 22 DP 15075

C/T 712/33

Lot 3 DP 15039

Lot 3 DP 15039

Lot 5 DP 15039

Lot 7 DP 15039

Lot 6 DP 15039

Lot 7 DP 15039

Lot 8 DP 15039

Lot 10 DP 15039

Lot 11 DP 15039

Lot 13 DP 15039

Lot 13 DP 15039

Lot 14 DP 15039

Lot 19 DP 15039

Lot 21 DP 15039

Lot 27 DP 15039) Agt 630/16
A. A. & M. T. Terry

Lot 1 DP 15075

Lot 2 DP 15075

Lot 3 DP 15075

Lot 4 DP 15075

Lot 5 DP 15075

Lot 8 DP 15075

Lot 9 DP 15075

Lot 11 DP 15075

Lot 12 DP 15075

Lots 13, 14, 15 & 16) Licence 613/34
DP 15075 A. E. & B. Alexander
(now J. T. & C. M. McGee)

Lots 14, 15 & 16
DP 15075

Lots 15 & 16
DP 15075

Lot 16 DP 15075

Lots 19, 18, 17 & 16
DP 15075

Lots 18, 17 & 16
DP 15075

Lots 17 & 16
DP 15075

Lot 16 DP 15075

Lot 22 DP 15075

Lot 21 DP 15075

Lot 2 DP 15039

Lot 4 DP 15039

Lot 6 DP 15039

Lot 6 DP 15039

Lot 7 DP 15039

Lot 8 DP 15039

Lot 9 DP 15039

Lot 11 DP 15039

Lot 12 DP 15039

Lot 12 DP 15039

Lots 14 & 15
DP 15039

Lot 15 DP 15039

Lot 18 DP 15039

Lot 20 DP 15039

Lot 26 DP 15039

DATED at CHRISTCHURCH

this 31st day of

1957

SIGNED on behalf of the State Advances Corporation of New Zealand by authority of the Board of Management under the common seal of the Corporation with the written consent of the Minister of Finance and pursuant to section 9 of the Finance Act 1948 by

Norman Henry Marks

an officer of the Corporation in the presence of:—

As witness

Solicitor

Particulars

For and on behalf of the State Advances Corporation of New Zealand.

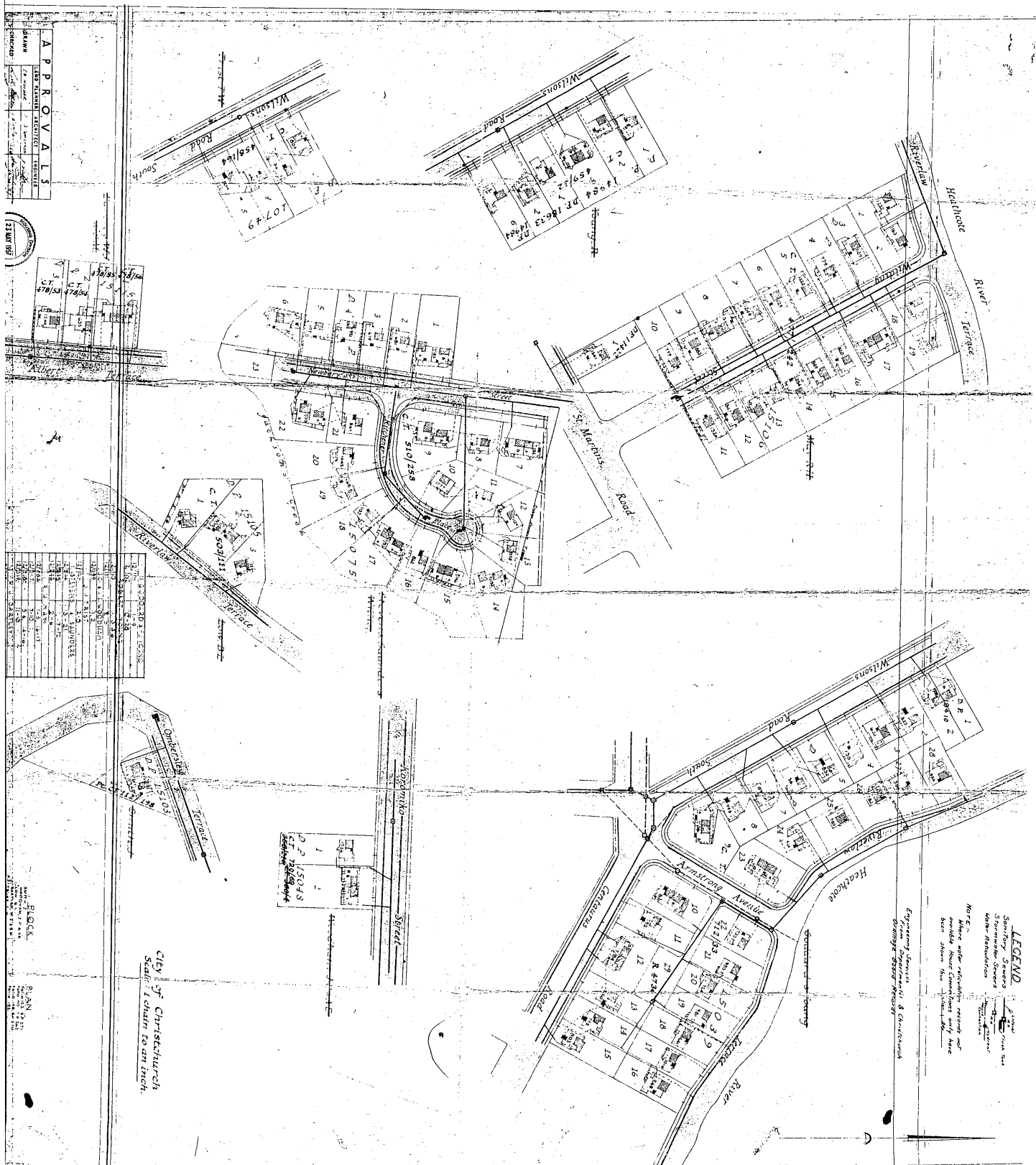

46357

PIPE LINE CERTIFICATE

given by the State Advances Corporation
of New Zealand

Particulars entered in the Register Book

Vol. *as per Schedule below* Folio *301*

the *5* day of *August* 1951

at *12* o'clock



Phonat
District Land Registrar
Assistant

of the *Century*

Delchuk

Volume

Folio

<i>444</i>	<i>32</i>	<i>40/1412 19A/132,23</i>
<i>459</i>	<i>32</i>	
<i>458</i>	<i>164</i>	
<i>478</i>	<i>53</i>	
<i>478</i>	<i>54</i>	
<i>478</i>	<i>55</i>	
<i>478</i>	<i>56</i>	
<i>120</i>	<i>69</i>	
<i>510</i>	<i>258</i>	<i>4C/717 ASP 15A/187</i>
<i>112</i>	<i>33</i>	
<i>503</i>	<i>111</i>	<i>REP 14A/1242</i>

Agd.S.P. 940 *78*
630 *16*
540 *4*

Sec. 100. *635* *42*
613 *34*

*A468843.5 Merging by Unity of Service
into within storm water easement as so
for that it is one part lot 3 marked
A-B-C, D-B on DA 81905 Chantry, PLG 1
3DP 15115 CT 5A/1932) appropriate to
that part of lot 3 DP 81905 formerly
contained in lot 2 DP 15115 CT 31A/1498*

LAND & DEEDS	<i>4.8.2000 at</i>
Nature	<i>pipe line easement</i>
From	<i>State Advances for RGL</i>
	<i>- 5 AUG 1957</i>
Time	<i>2 pm</i>
Fee &	<i>1</i>
Abstract No.	<i>1732</i>

State Advances Corporation of
New Zealand

Correct for the purposes of the
Land Transfer Act

Signature for the State Advances Corporation of New Zealand.

26
Section 4 of the Housing Act 1955 is as follows:—

(4) While any pipe line certificate remains registered in accordance with section 4 of this Act against the titles to the land to which the certificate relates, unless the certificate otherwise provides, the following provisions shall apply:—

- The owner for the time being of every parcel of land specified in the certificate as being served or intended to be served by the pipe line shall have a right to the free and uninterrupted use of the pipe line; and a right, for himself and his servants and agents, after giving reasonable notice, to enter upon any land shown in the certificate as land over or through which the pipe line passes and (so far as is reasonably necessary for the purpose) on other land to which the certificate relates for the purpose of relaying or effecting necessary repairs to the pipe line, subject to the restoration as nearly as is reasonably possible of the surface of the land to its former condition:
- The owner for the time being of any land specified in the certificate as being land over or through which the pipe line passes shall afford to the persons specified in paragraph (a) of this subsection the full and free exercise of the rights specified in that paragraph in respect of that land;
- The owner for the time being of each parcel of land specified in the certificate as being served or intended to be served by the pipe line may require and enforce reasonable contribution from all or any other such owners in respect of the cost of executing, providing, and doing all necessary relaying of or repairs to the pipe line and all things required in respect of the pipe line by any local authority having statutory powers in respect thereof:

Provided that, where relaying or repairs are rendered necessary by the act or default of any one or more of the owners, he or they shall bear the whole cost thereof.

Enl 01896
cto 059



A 290103.1 T

CERTIFICATE OF NON-REVOCATION OF POWER OF ATTORNEY

I, John Parker Gall of Christchurch in New Zealand, of Housing New Zealand Limited
HEREBY CERTIFY:

1. THAT by Deed dated the 30th day of August 1996 copies of which are deposited
in the Land Registry Office at:

Blenheim (Marlborough Registry) and there numbered	186983
Christchurch (Canterbury Registry) and there numbered	A256933
Dunedin (Otago Registry) and there numbered	915676
Hokitika (Westland Registry) and there numbered	105705
Invercargill (Southland Registry) and there numbered	244174
Nelson (Nelson Registry) and there numbered	361411

Housing New Zealand Limited, a duly incorporated company appointed me its
Attorney on the terms and subject to the conditions set out in the said Deed and the
attached document is executed by me under the powers thereby conferred.

2. THAT at the date hereof I am the Commercial Administrator of Housing New
Zealand Limited, South Region.
3. THAT at the date hereof I have not received any notice or information of the
revocation of that appointment by the winding up or dissolution of Housing New
Zealand Limited or otherwise.

Signed at Christchurch this 6th day of March 1997.



TRANSFER
Land Transfer Act 1952

If there is not enough space in any of the panels below, the two page form incorporating the Annexure Schedule should be used: no other format will be received.

Land Registration District

Canterbury

Certificate of Title No. **All or Part?** **Area and legal description - *Insert only when part or Stratum, CT***

4C

575

All

Transferor Surnames must be underlined

HOUSING NEW ZEALAND LIMITED at Wellington

Transferee Surnames must be underlined

JILLIAN MARIE STONEHOUSE of Christchurch, Company Officer

Estate or Interest or Easement to be created: *Insert e.g. Fee simple; Leasehold in Lease No ...; Right of way etc*

Fee Simple and the transferee shall be bound by a fencing covenant as defined in Section 2 of the Fencing Act 1978 in favour of the transferor

Consideration

\$134,000.00

Operative Clause

The TRANSFEROR for the above consideration (receipt of which is acknowledged) TRANSFERS to the TRANSFEE all the transferor's estate and interest in the land in the above Certificate(s) of Title and if an easement is described above such is granted or created

Dated this 6th day of March 19 97

Attestation

Signed for and on behalf of
Housing New Zealand Limited by
its attorney JOHN PARKER GALL

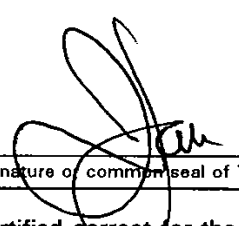
Signature of common seal of Transferor

Signed in my presence by the Transferor
Signature of Witness

Witness to complete in **BLOCK** letters
(unless typewritten or legibly stamped)

Witness name

Occupation Christopher James Kilbride

Solicitor

Address Christchurch

Certified correct for the purposes of the Land Transfer Act 1952

Certified that Part IIA of the Land Settlement Promotion and Land Acquisition Act 1952 does not apply.
Certified that no conveyance duty is payable by virtue of Section 24(1) of the Stamp and Cheque Duties Act 1971.
(DELETE INAPPLICABLE CERTIFICATE)

Solicitor for the Transferee

TRANSFER

Land Transfer Act 1952

Parry Field & Co
PO Box 1725
Christchurch
(CJ ROYDS)

This page is for Land Registry Office Use Only.

9.12 4 Apr 97 A290103/1
PARTICULARS ENTERED IN REGISTER
LAND REGISTRY - CANTERBURY
ENTRETIEN ET REGISTRATION
ASST. LAND REGISTRAR
CANTERBURY N.Z.

