



Property Title

Statement Of Passing Over

This building inspection has been supplied by the vendor in good faith. H&G (Powered by Ownly Limited, Licensed REAA 2008) is merely passing over this information as supplied to us.

We cannot guarantee its accuracy as we have not checked, audited, or reviewed the information and all intending purchasers are advised to seek your own advice as to the information contained in this document.

Please note this Council property file is provided for informational purposes only. There may be matters relating to pre-1992 consents or permits which may need further investigation in order to determine their relevance.

To the maximum extent permitted by law we do not accept any responsibility to any party for the accuracy or use of the information herein.



**RECORD OF TITLE
UNDER LAND TRANSFER ACT 2017
CROSS LEASE**



**Guaranteed Search Copy issued under Section 60 of the Land
Transfer Act 2017**

R.W. Muir
Registrar-General
of Land

Identifier **WN15D/361**
Land Registration District **Wellington**
Date Issued 10 February 1976

Prior References
WNB1/482

Estate Fee Simple - 1/2 share
Area 971 square metres more or less
Legal Description Lot 4 Deposited Plan 21868

Registered Owners
Katrina Louise Van Dooren

| | | | |
|--------------------------|--|-------------------|------------------------------------|
| Estate | Leasehold | Instrument | L 089817.4 |
| | | Term | 999 years commencing on 30.10.1975 |
| Legal Description | Flat 2 Deposited Plan 44387 and Garage 2 Deposited Plan 44387 | | |

Registered Owners
Katrina Louise Van Dooren

Interests

- 089817.3 Lease of Flat 1 Garage 1 DP 44387 Term 999 years commencing on 30.10.1975 CT WN15D/360 issued - 10.2.1976 at 9.37 am (Affects Fee Simple)
- 089817.4 Lease of Flat 2 Garage 2 DP 44387 Term 999 years commencing on 30.10.1975 Composite CT WN15D/361 issued - 10.2.1976 at 9.37 am (Affects Fee Simple)
- Appurtenant hereto is a right of way created by Easement Instrument 6427087.2 - 19.5.2005 at 9:00 am (affects fee simple)
- 6456600.1 Variation of Lease 089817.3 affecting the fee simple estate - 14.6.2005 at 9:00 am
- 6456600.2 Variation of Lease 089817.4 - 14.6.2005 at 9:00 am
- 10617979.3 Mortgage to ANZ Bank New Zealand Limited - 1.12.2016 at 3:30 pm

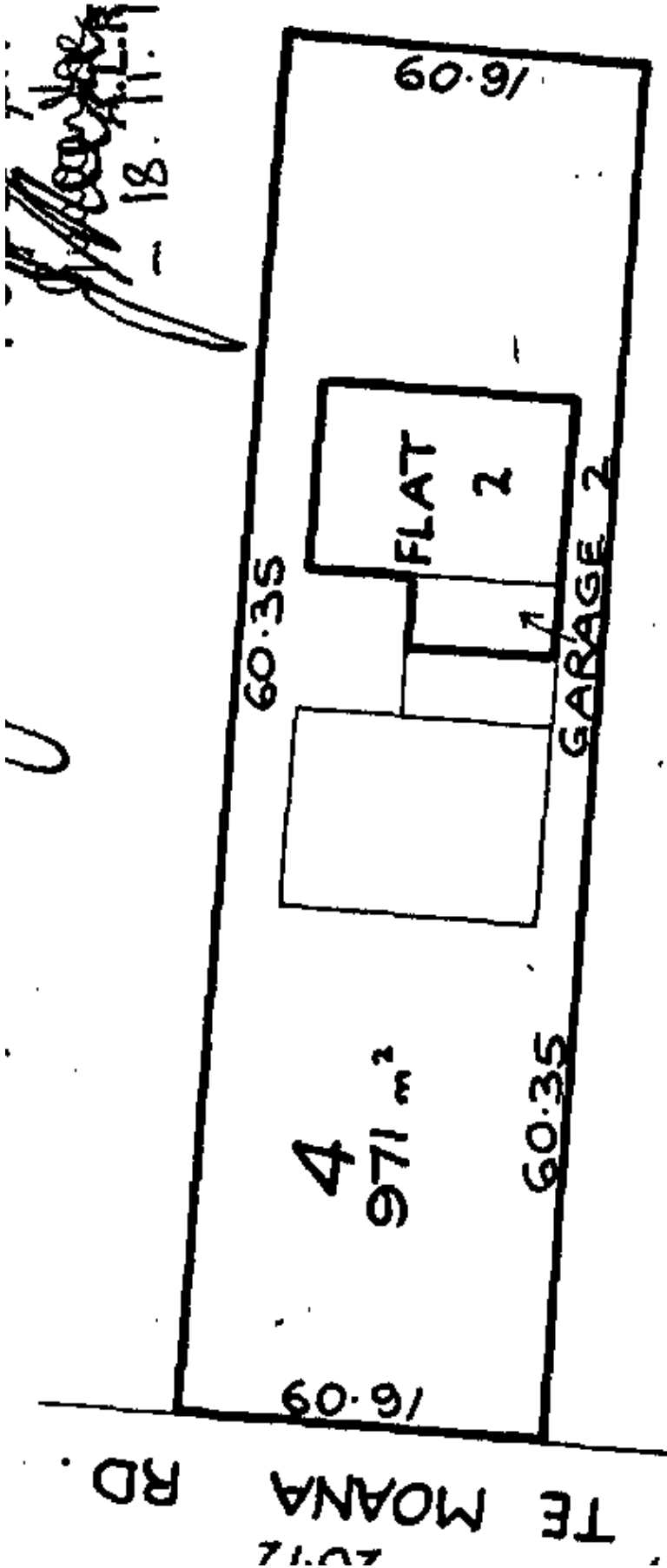

Measurements see Matrix