

F5000012462801

 <p>CHRISTCHURCH THE GARDEN CITY <i>The city that shines</i></p>	<p>CHRISTCHURCH CITY COUNCIL BUILDING ACT 1991 [S.43(3)] CODE COMPLIANCE CERTIFICATE</p>	<p>FORM: BA10</p>
		<p>PROJECT NO. 94004465</p>

<p>PROJECT</p> <p>New or relocated building <input type="checkbox"/> N</p> <p>Alteration <input checked="" type="checkbox"/> X</p> <p>Intended use(s): PLUMBING</p>		<p>PROJECT LOCATION</p> <p>Street address: 1 GILMORE PL WAIMAIRI</p> <p>Legal Description: Valuation Roll: 2190812600 LOT 2 DP 26914</p>	
<p>Intended life: Indefinite but not less than 50 years <input checked="" type="checkbox"/> X</p> <p>Specified as _____ years</p> <p>Demolition <input type="checkbox"/></p>		<p>COUNCIL CHARGES</p> <p>The Council's outstanding charges payable on the uplifting of the code compliance certificate, in accordance with the attached details are:</p> <p>\$0.00</p> <p>Receipt No:</p>	

COPY

- This is*
- A final code compliance certificate issued in respect of all the building work under the above building consent.
 - An interim code compliance certificate in respect of part only, as specified in the attached particulars, of the building work under the above building consent.
 - This certificate is issued subject to the conditions specified in the attached page(s) headed "Conditions of Code Compliance Certificate No. 94004465 " (being this certificate).

Signed for and on behalf of the Council:

Name: *M. Wells*

Position: Date: 3 October 1997



CHRISTCHURCH CITY COUNCIL BUILDING ACT 1991

FORM: BA3

APPLICATION FOR BUILDING CONSENT

PROJECT NO.

94004465

Has a Project Information Memorandum been issued by the Council for this Project? YES NO
 If YES, add the Project Information Memorandum number to the box above marked PROJECT NO.

<p>OWNER (OR PURCHASER OR LESSEE)</p> <p>Name: <u>Miss M. Fahay</u></p> <p>Mailing Address: <u>No. 1. Gilmore Place</u> <u>Burnside</u></p> <p>Phone: _____ Fax: _____</p>	<p>PROJECT LOCATION</p> <p>Street Address: <u>No. 1. Gilmore Place</u> <u>Burnside</u></p> <p>Lot: <u>2</u> DP: <u>26914</u></p> <p>Other: _____</p>																														
<p>APPLICANT (If not owner, purchaser or lessee)</p> <p>Name: <u>A.M. GISSON</u></p> <p>Company: <u>MW GISSON LTD</u></p> <p>Mailing Address: <u>827a Main North Road</u> <u>CHCH</u></p> <p>Phone: <u>083 8731</u> Fax: _____</p>	<p>PROJECT</p> <p>Description of Work: <u>New WC</u> <u>to existing Terminal Unit</u> <u>Remove Unit + make small stack to New WC</u></p> <p>Intended Use: _____</p>																														
<p>BUILDING CONSENT FEES</p> <p>The charges incurred by the Council in processing this application are payable whether or not the project proceeds.</p> <p>Note: Fees for some minor works (e.g. spaceheaters, drainage only works, detached accessory buildings with a value less than \$5,000) are required at the time of application.</p>	<p><u>PLUMBING ONLY</u> <u>Add 1 EXTRA W.C.</u></p> <p>Will the building undergo a change of use? <input type="checkbox"/> Yes <input checked="" type="checkbox"/> No</p>																														
<p>Estimated Value (inclusive of GST) \$ <u>500-00</u></p>	<p>Intended Life if less than 50 years _____ years.</p> <p>Being Stage <u>1</u> of an intended <u>1</u> Stages.</p>																														
<p>Building Consent to be picked up from:</p> <p><input type="checkbox"/> _____ Service Centre</p> <p><input checked="" type="checkbox"/> If prepaid post to Owner/Applicant (delete one)</p>	<p>FLOOR AREA</p> <p>Ground Flr: Existing _____m² Proposed _____m²</p> <p>Other Flrs: Existing _____m² Proposed _____m²</p> <p>Accessory Building Area: <u>NO CHANGE</u></p> <p>Existing _____m² Proposed _____m²</p> <p>Total Area of all Buildings: (over foundation)</p> <p>Existing _____m² Proposed _____m²</p>																														
<p>Signature: <u>[Signature]</u></p> <p>Position: (if lessee) _____</p> <p>Date: _____</p>	<p style="text-align: center; color: red; font-weight: bold;">CHRISTCHURCH CITY COUNCIL P.I.M. APPLICATION</p> <p style="text-align: center; color: red; font-weight: bold;">Rec'd 24 MAY 1994</p>																														
Fendalton FOR COUNCIL USE ONLY																															
<p>Date Received: <u>24/5/94</u></p> <p>Prepaid Fee: \$ <u>82.50</u></p> <p>Receipt No: <u>635490</u></p> <p>Receiving Officer: <u>[Signature]</u></p> <p>Primary Classification: * _____</p>	<table border="1" style="width: 100%; border-collapse: collapse;"> <thead> <tr> <th>Code</th> <th>New</th> <th>Add</th> <th>Alter</th> <th>Demo</th> <th>Relo.</th> </tr> </thead> <tbody> <tr> <td style="text-align: center;">*</td> <td style="text-align: center;">80.4</td> <td></td> <td style="text-align: center;">✓</td> <td></td> <td></td> </tr> <tr> <td> </td> <td> </td> <td> </td> <td> </td> <td> </td> <td> </td> </tr> <tr> <td> </td> <td> </td> <td> </td> <td> </td> <td> </td> <td> </td> </tr> <tr> <td> </td> <td> </td> <td> </td> <td> </td> <td> </td> <td> </td> </tr> </tbody> </table>	Code	New	Add	Alter	Demo	Relo.	*	80.4		✓																				
Code	New	Add	Alter	Demo	Relo.																										
*	80.4		✓																												
<p>DRAINAGE INFORMATION: Not Required <input checked="" type="checkbox"/> Block Plan Only <input type="checkbox"/> Full PIM <input type="checkbox"/></p> <p>Date Requested: _____ / _____ / _____</p>																															

The information contained in this application may be made available to other Units of the Council.

PROJECT DETAILS

A. Identify which of the following are involved:

			NAME	ADDRESS	PHONE NO.
Designer	<input checked="" type="checkbox"/> No	<input type="checkbox"/> Yes
Engineer	<input checked="" type="checkbox"/> No	<input type="checkbox"/> Yes
Builder	<input checked="" type="checkbox"/> No	<input type="checkbox"/> Yes
Drainlayer	<input checked="" type="checkbox"/> No	<input type="checkbox"/> Yes
Plumber	<input type="checkbox"/> No	<input checked="" type="checkbox"/> Yes	TOMY GIBSON	MAN NORTH RD	025 333 545
Building Certifier	<input type="checkbox"/> No	<input checked="" type="checkbox"/> Yes	C-CC

B. Identify Construction Arrangements:

Is the builder responsible for the completion of the project in accordance with the Building Consent drawings and specifications? Yes No

C. Inspection Arrangements:

Does the project involve specialist consultant design? (eg, Structural, Civil or Mechanical Engineers) Yes No

If YES provide details of inspection procedure on Form BA 20

D. Producer Statements:

Are producer statements to be submitted in support of the application? eg, for Design or Construction Inspection Yes No

If YES provide details on Form BA 20

E. Mechanical Systems:

Does the project include mechanical systems, fire protection system or emergency warning systems for which a Compliance Schedule is required? Yes No

If YES identify these features on Form BA 21

NOTES: This application must be accompanied by three (3) copies of drawings and two (2) copies of specifications.

Guidelines showing acceptable standards of plans and specifications are available at any Service Centre or Civic Offices.

P.I.M. APPLICATION CHECK SHEET

PROJECT NO

Project: Plumbing

Location: 1. Gilmore Place

94004465

Checked	Comment (see over)	Officer	Date	Time Input
<input checked="" type="checkbox"/> Hazard Register	<input type="checkbox"/> Yes <input checked="" type="checkbox"/> No	<i>[Signature]</i>	<u>27-5-18</u>	<u>10</u>
<input checked="" type="checkbox"/> Property File	<input type="checkbox"/> Yes <input checked="" type="checkbox"/> No			
<input type="checkbox"/> Site Inspection	<input type="checkbox"/> Yes <input type="checkbox"/> No			
<input type="checkbox"/> Designations	<input type="checkbox"/> Yes <input type="checkbox"/> No			
<input type="checkbox"/> Planning	<input type="checkbox"/> Yes <input type="checkbox"/> No			
<input type="checkbox"/> Zoning	<u>Res G</u>			
<input type="checkbox"/> Site Area/Shape Factor	<u>1</u>			
<input type="checkbox"/> Site Coverage/Density				
<input type="checkbox"/> Plot Ratio/Bonuses				
<input type="checkbox"/> Floor space				
<input type="checkbox"/> Site suitability				
<input type="checkbox"/> Setbacks				
<input type="checkbox"/> Recession plane/height				
<input type="checkbox"/> Separation/on site privacy				
<input type="checkbox"/> Outdoor living/service areas				
<input type="checkbox"/> Design and appearance				
<input type="checkbox"/> Landscaping				
<input type="checkbox"/> Tree Register	<u>None</u>			
<input type="checkbox"/> Heritage Buildings	<u>None</u>			
RESERVE CONTRIBUTION/LEVY				
<input type="checkbox"/> Traffic	<input type="checkbox"/> Yes <input type="checkbox"/> No			
<input type="checkbox"/> Car parking/garageable spaces				
<input type="checkbox"/> Vehicle crossings				
<input type="checkbox"/> Access & manocuvring areas				
<input type="checkbox"/> Loading areas				
<input type="checkbox"/> Other				
<input type="checkbox"/> Subdivisions	<input type="checkbox"/> Yes <input type="checkbox"/> No			
<input type="checkbox"/> Environmental Health Officer	<input type="checkbox"/> Yes <input type="checkbox"/> No			
<input type="checkbox"/> Drainage & Waste Unit	<input type="checkbox"/> Yes <input checked="" type="checkbox"/> No			
Request faxed <input checked="" type="checkbox"/>				
<input type="checkbox"/> Other (Specify)	<input type="checkbox"/> Yes <input type="checkbox"/> No			
<u>None</u>				

COMPLETE DETAILS ON REAR OF THIS SHEET AS APPROPRIATE

FILE COPY

CHRISTCHURCH CITY COUNCIL
P.I.M. APPLICATION
Rec'd 24 MAY 1994
Fendalton Service Centre
PROJECT No.....

CHRISTCHURCH CITY COUNCIL
31 MAY 1994
[Signature]
CONSENT DOCUMENT

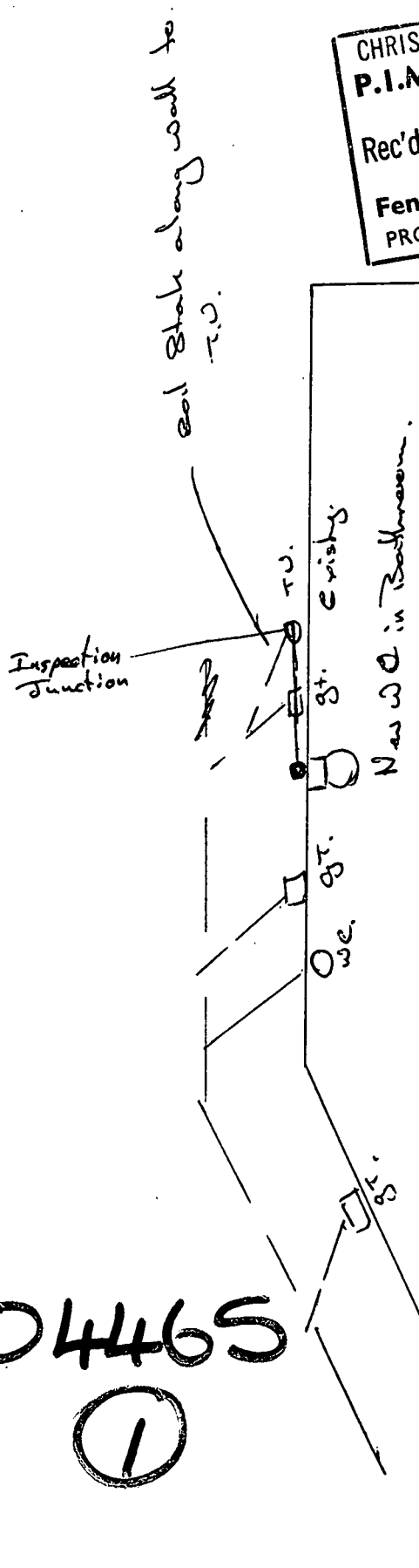

All building work shall comply with the New Zealand Building Code notwithstanding any inconsistencies which may occur in the drawings and specifications.

94004465
①

No 1 Rilmore Place.



CHRISTCHURCH CITY COUNCIL
BUILDING ACT 1991
PROJECT INFORMATION
MEMORANDUM

FORM:BA2A

PROJECT NO: 94004465

ADDRESS: 1 Gilmore Place

NO INFORMATION RELATED TO THIS PROJECT, OTHER THAN THAT IDENTIFIED BELOW, HAS BEEN FOUND.

- Drainage Information Attached.
- Vehicle Crossing Application Form Attached.
- Water Information Sheet Attached.
- Cross-Lease Titles - the lease agreement may require you to obtain the consents of the other owners to this project.
- Resource Consent Attached.

N.I P.I.M.

PIM Fee: \$ 22.50

PAID.
635490.

SIGNED FOR AND ON BEHALF OF THE COUNCIL

LEO O'LOUGHLIN
Building Information Officer

Date: 27-5-94.

POSITION

This Project Information Memorandum is confirmation that the proposed work may be undertaken subject to the requirements of the attached Building Consent.

CHRISTCHURCH CITY COUNCIL
P.I.M. APPLICATION
 Rec'd 24 MAY 1994
 Fendalton Service Centre
 PROJECT No.....

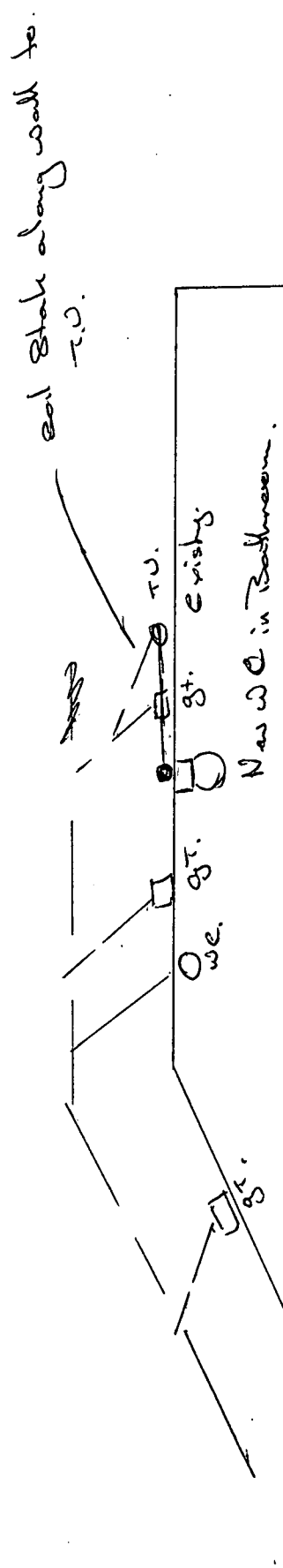

No 1 Rilmore Place.



CHRISTCHURCH CITY COUNCIL

1 June 1994

A M GIBSON
827A MAIN NORTH ROAD
CHRISTCHURCH

Dear Sir/Madam

APPLICATION FOR BUILDING CONSENT
PROJECT NO. 94004465

Your application for a Building Consent for the proposed PLUMBING at 1 GILMORE PLC WAIMAIRI refers.

The building consent application for the above works has been granted and the Consent together with the "Conditions of Building Consent" are attached.

Payment has been received for the following fees associated with the building consent:

To PIM:	Basic Fee	\$ 12.50
To Building Consent:	Issue	\$ 40.00
To Inspections:	Final Inspection	\$ 30.00
TOTAL		\$ 82.50

Please quote the above Project No. in all communication with the Council.

Signed

for
PUBLIC HEALTH AND SAFETY MANAGER



CHRISTCHURCH CITY COUNCIL SITE INSPECTION REPORT

PROJECT NO.

Site Address: 1 GILMORE PLACE

Description of Consent: PLUMBING

90004465

COMMENTS:

PROJECT COMPLIANT

PROJECT COMPLETE

SIGNED: [Signature]

DATE: 21.10.97

(M. H. GIBSON)

Delete that which is not applicable.

INSTRUCTION TO OWNER/OWNERS AGENT:	Inspection Type
All work inspected is in accordance with the Building Consent.	M8
Some work is not satisfactory as detailed above and rectification is required.	
A formal notice to rectify will be issued.	
SIGNED: <u>[Signature]</u>	DATE: <u>21.10.97</u>

THIS IS NOT A COMPLIANCE CERTIFICATE