

GRIFFIOEN.

EQC CLAIM DOCUMENTATION

Statement of Passing Over: This documentation has been supplied to us by the Earthquake Commission under the Official Information Act. GRIFFIOEN. (Powered by Ownly Limited, Licensed REAA 2008) is merely passing over this information as supplied to us.

We cannot guarantee its accuracy as we have not checked, audited, or reviewed the information and all intending purchasers are advised to seek your own advice as to the information contained in this document.

To the maximum extent permitted by law we do not accept any responsibility to any party for the accuracy or use of the information herein.

CASH SETTLED CLAIM(S)

The following information contains documents relating to claim(s) that were cash settled for the property.

If you require sign off or repair completion documents, they may be obtainable from the contractors who completed the substantive repairs at the property.

Scope of Works



Customer: J PALMADA

Document explanatory note:

This document provides a summary of the earthquake damage identified by the EQC assessment team. Land, building and room by room damage is listed along with an indication of how this damage is to be repaired. A glossary of terms describing the type of damage that may be listed on your Scope of Works is provided at the end of this document.

Assessment of Property at 9 GORE STREET, HALSWELL, CHRISTCHURCH 8025 on 28/09/2011

Site

Element	Damage	Repair
Land (Under dwelling - Soil - 140.00 m2)		
Land (Exposed - Soil - 490.00 m2)		

Services

Element	Damage	Repair
Sewerage (Town Connection - Clay pipes - 6.00 l/m)	No Earthquake Damage	
Water Supply (Town Connection - Steel - 12.00 l/m)	No Earthquake Damage	

Main Building

Exterior

Elevation (East)

Element	Damage	Repair
Wall Cladding (Block Veneer - Compressed concrete - 37.50 m2)	Cracking	Grind out and repoint mortar 6.00 l/m
	Cracking to paint	Paint wall 37.50 m2
	Structural damage	Remove, dispose and replace concrete block veneer 0.48 m2
Wall framing (Timber Frame - Timber - 36.00 m2)	No Earthquake Damage	

Elevation (South)

Element	Damage	Repair
Wall Cladding (Block Veneer - Compressed concrete - 33.00 m2)	Cracking	Grind out and repoint mortar 3.00 l/m
	Cracking	Paint wall 33.00 m2
Wall framing (Timber Frame - Timber - 31.68 m2)	No Earthquake Damage	

Elevation (West facing street)

Element	Damage	Repair
Wall Cladding (Block Veneer - Compressed concrete - 11.50 m2)	Cracking	Grind out and repoint mortar 3.00 l/m
	Cracking	Paint wall 11.50 m2
Wall framing (Timber Frame - Timber - 11.04 m2)	No Earthquake Damage	

Elevation (North)

Element	Damage	Repair	
Patio (Concrete - Concrete - 19.50 m2)	No Earthquake Damage		
Wall Cladding (Block Veneer - Compressed concrete - 16.75 m2)	Cracking	Grind out and repoint mortar	1.50 l/m
	Cracking	Paint wall	16.75 m2
Wall Cladding (Weatherboard - Iron - 37.50 m2)	No Earthquake Damage		
Wall framing (Timber Frame - Timber - 52.08 m2)	No Earthquake Damage		

Foundations

Element	Damage	Repair	
Piles (Ordinary - Concrete - 1.00 item)	Floor has moved less than 100mm	Replace Pile less than 6 under house	5.00 No of
Ring foundation (Load bearing - Concrete - 42.00 l/m)	Cracks to ring foundation	Grind out and epoxy fill cracks	1.50 l/m
	Cracks to ring foundation	Splash coat repair	8.00 m2
	Cracks to ring foundation	Paint foundation	8.00 m2

Roof

Element	Damage	Repair	
No Damage			

Interior

Ground Floor - Kitchen

Room Size: 3.00 x 6.00 = 18.00 (length(m) x width(m) = Area Size(m2))

Stud Height: 2.40 m

Element	Damage	Repair	
Ceiling (Gib - Paint - 18.00 m2)	No Earthquake Damage		
Door (Internal) (Cavity Slider - MDF - 1.00 No of)			
Floor (T&G - Carpet - 18.00 m2)	No Earthquake Damage		
Kitchen joinery (Medium Spec - MDF - 1.00 item)	No Earthquake Damage		
Range (Free standing oven) (Electric - Standard Electric - 1.00 item)	No Earthquake Damage		
Range Hood (Over Head - Standard spec - 1.00 item)	No Earthquake Damage		
Wall covering (Gib - Paint - 43.20 m2)	Cosmetic damage	Rake out, plaster and paint	43.20 m2
Window (Timber medium - Pane single glazed - 1.00 No of)	No Earthquake Damage		
Work top (Kitchen work top - Stainless - 4.00 l/m)	No Earthquake Damage		

Ground Floor - Lounge

Room Size: 4.90 x 3.90 = 19.11 (length(m) x width(m) = Area Size(m2))

Stud Height: 2.40 m

Element	Damage	Repair	
Ceiling (Gib - Stipple - 19.11 m2)	Cosmetic Damage	Scrape off, rake out, fill, restipple	19.11 m2
	Cosmetic Damage	Paint Ceiling	19.11 m2
Door (Internal) (Single Hollow Core - Timber - 1.00 No of)	No Earthquake Damage		
Floor (T&G - Carpet - 19.11 m2)	No Earthquake Damage		
Wall covering (Gib - Paint - 42.24 m2)	Cosmetic damage	Rake out, plaster and paint	42.24 m2
	Structural damage	Remove, dispose, replace Gib, stop and undercoat (Excluding Trim)	11.76 m2
Window (Timber medium - Pane single glazed - 1.00 No of)	No Earthquake Damage		

Ground Floor - Rumpus

Room Size: 3.50 x 3.90 = 13.65 (length(m) x width(m) = Area Size(m2))

Stud Height: 2.40 m

Element	Damage	Repair	
Ceiling (Gib - Paint - 13.65 m2)	No Earthquake Damage		
Door (Internal) (Glass panel door - Timber - 1.00 No of)	Cosmetic damage	Ease door	1.00 No of
Floor (T&G - Carpet - 13.65 m2)	No Earthquake Damage		
Heating (Electric - Heat pump - 1.00 item)	No Earthquake Damage		
Wall covering (Gib - Paint - 35.52 m2)	Cosmetic damage	Rake out, plaster and paint	35.52 m2
Window (Timber medium - Pane single glazed - 1.00 No of)	No Earthquake Damage		

Ground Floor - Hallway

Room Size: 0.90 x 10.00 = 9.00 (length(m) x width(m) = Area Size(m2))

Stud Height: 2.40 m

Element	Damage	Repair	
Ceiling (Gib - Paint - 9.00 m2)	Cosmetic Damage	Rake out, plaster and paint	9.00 m2
Door (External) (Single glass door - Timber - 1.00 item)	Cosmetic damage	Ease door	1.00 No of
Door (Internal) (Single Hollow Core - Timber - 1.00 No of)	Cosmetic damage	Ease door	1.00 No of
Floor (T&G - Carpet - 9.00 m2)	No Earthquake Damage		
Wall covering (Gib - Paint - 52.32 m2)	Cosmetic damage	Rake out, plaster and paint	52.32 m2
Window (Timber medium - Pane single glazed - 1.00 No of)	No Earthquake Damage		

Ground Floor - Bathroom

Room Size: 1.70 x 1.90 = 3.23 (length(m) x width(m) = Area Size(m2))

Stud Height: 2.40 m

Element	Damage	Repair	
No Damage			

Ground Floor - Laundry

Room Size: 2.00 x 1.40 = 2.80 (length(m) x width(m) = Area Size(m2))

Stud Height: 2.40 m

Element	Damage	Repair	
No Damage			

Ground Floor - Toilet

Room Size: 8.00 x 1.40 = 11.20 (length(m) x width(m) = Area Size(m2))

Stud Height: 2.40 m

Element	Damage	Repair	
No Damage			

Ground Floor - Bedroom (Bedroom 3, first bedroom on left down hallway)

Room Size: 2.80 x 3.10 = 8.68 (length(m) x width(m) = Area Size(m2))

Stud Height: 2.40 m

Element	Damage	Repair	
Ceiling (Gib - Paint - 8.68 m2)	Cosmetic Damage	Rake out, plaster and paint	8.68 m2

Door (Internal) (Single Hollow Core - MDF - No Earthquake Damage 1.00 No of)			
Floor (T&G - Carpet - 8.68 m2)	No Earthquake Damage		
Wall covering (Gib - Paint - 28.32 m2)	Cosmetic damage	Rake out, plaster and paint	28.32 m2
Window (Timber medium - Pane single glazed - 1.00 No of)	No Earthquake Damage		

Ground Floor - Bedroom (Bedroom 2, second bedroom on left down hallway)

Room Size: 3.00 x 3.00 = 9.00 (length(m) x width(m) = Area Size(m2))

Stud Height: 2.40 m

Element	Damage	Repair	
Ceiling (Gib - Paint - 9.00 m2)	No Earthquake Damage		
Door (Internal) (Single Hollow Core - MDF - No Earthquake Damage 1.00 No of)	No Earthquake Damage		
Floor (T&G - Carpet - 9.00 m2)	No Earthquake Damage		
Wall covering (Gib - Paint - 28.80 m2)	Cosmetic damage	Rake out, plaster and paint	28.80 m2
Window (Timber medium - Pane single glazed - 1.00 No of)	No Earthquake Damage		

Ground Floor - Bedroom (Main bedroom, at end of hallway)

Room Size: 4.00 x 3.30 = 13.20 (length(m) x width(m) = Area Size(m2))

Stud Height: 2.40 m

Element	Damage	Repair	
Ceiling (Gib - Paint - 13.20 m2)	No Earthquake Damage		
Door (Internal) (Single Hollow Core - MDF - No Earthquake Damage 1.00 No of)	No Earthquake Damage		
Floor (T&G - Carpet - 13.20 m2)	No Earthquake Damage		
Wall covering (Gib - Paint - 35.04 m2)	Cosmetic damage	Rake out, plaster and paint	35.04 m2
Window (Timber medium - Pane single glazed - 1.00 No of)	No Earthquake Damage		

Garage

Exterior

Foundations

Element	Damage	Repair
No Damage		

Elevation (east)

Element	Damage	Repair
No Damage		

Elevation (West)

Element	Damage	Repair
No Damage		

Elevation (South)

Element	Damage	Repair
No Damage		

Elevation (North)

Element	Damage	Repair
No Damage		

Roof

Element	Damage	Repair
---------	--------	--------

No Damage

Interior**Ground Floor - Room (Other)**

Room Size: 6.00 x 6.00 = 36.00 (length(m) x width(m) = Area Size(m²))

Stud Height: 2.40 m

Element	Damage	Repair
---------	--------	--------

No Damage

Scope of Works - Glossary of Terms

Cosmetic Damage	Cosmetic damage is used to record repairs to an element that can be done in situ e.g. minor cracking to plasterboard. For example a repair strategy may state "rake, stop and paint" and this is carried out without needing to remove or replace the damaged element. Where the plasterboard for example needs to be removed and replaced, this will be recorded as 'structural damage'.
Impact Damage	Impact damage is where an element or part of a building sustains earthquake damage and then breaks away or collapses causing damage to another part of the building. An example is a chimney that has collapsed and caused damage to roof tiles.
Structural Damage	The term structural damage is used where a repair requires an element to be removed and replaced e.g. major cracking to plasterboard or external cladding that has been dislodged. This term does not relate to the structural integrity of the building as a whole, but to the individual element only.

Additional Information

Building Terms	The Department of Building and Housing website has a comprehensive list of common building terms: http://www.dbh.govt.nz/building-az-wxyz
-----------------------	--

EQC Full Assessment Report

Claim Number:	CLM/2011/209019	Assessment Date:	28/09/2011 14:45
Claimant:	J PALMADA	Assessor:	Miller, Paul
Property Address:	9 GORE STREET HALSWELL CHRISTCHURCH 8025	Estimator:	Lawler, Tony
		Property Occupied By:	Owner Occupied

Claimant Setup

Type	Name	Home Number	Mobile Number	Work Number	Email Address
Owner	J, PALMADA				

Insurance & Mortgage Details

Insurance Details - From Claim Centre

Insurer	Policy Type	Policy Number	Insurance Sighted	Insurance Valid
IAG - State/Norwich Group	Dwelling		Yes	

Insurance Details - Added in COMET

Insurer	Policy Type	Policy Number	Insurance Sighted	Insurance Valid
---------	-------------	---------------	-------------------	-----------------

Insurance Details - Comments

Unable to view insurance details as owner is in Australia and we have no contact details for him, contact was made with tenant as a result of a cold call.

Mortgage Details - From Claim Centre

Bank

Mortgage Details - Added in COMET

Bank

WESTPAC NEW ZEALAND LIMITED

Mortgage Details - Comments

Opt Out

For repairs costing between \$10,000 and \$100,000 the claimant wishes to manage their own repairs? No

Hazards

Hazards: Nil hazards

Property Sticker: No Sticker

Building Configurations

Leaky Home Syndrome? No

Building Name	Number of floors	Building Finish	Age of house	Footprint	Area (m2)
Main Building	1	Standard	1961 - 1980	Rectangular	111.48
Garage	1	Standard	1961 - 1980	Rectangular	36.60

Full Assessment

Site

Element	Type	Material	Damages	Measure	Rate	Cost
Land	Under dwelling	Soil	No Earthquake Damage			
Land	Exposed	Soil	No Earthquake Damage			

General Comments:

Services

Element	Type	Material	Damages	Measure	Rate	Cost
Sewerage	Town Connection	Clay pipes	No Earthquake Damage			
Water Supply	Town Connection	Steel	No Earthquake Damage			

General Comments:

Main Building

Exterior

Elevation (East)

Damage: Earthquake damage

Require Scaffolding? No

Element	Type	Material	Damages	Measure	Rate	Cost
Wall Cladding	Block Veneer	Compressed concrete	Cracking			
			Grind out and repoint mortar	6.00 l/m	50.00	300.00
			Cracking to paint			
			Paint wall	37.50 m2	29.00	1,087.50
Structural damage			Remove, dispose and replace concrete block veneer	0.48 m2	180.00	86.40
Wall framing	Timber Frame	Timber	No Earthquake Damage			

General Comments:

Elevation (South)

Damage: Earthquake damage

Require Scaffolding? No

Element	Type	Material	Damages	Measure	Rate	Cost
Wall Cladding	Block Veneer	Compressed concrete	Cracking			
			Grind out and repoint mortar	3.00 l/m	50.00	150.00
			Cracking			
Paint wall			Paint wall	33.00 m2	29.00	957.00
Wall framing	Timber Frame	Timber	No Earthquake Damage			

General Comments:

Elevation (West facing street)

Damage: Earthquake damage

Require Scaffolding? No

Element	Type	Material	Damages	Measure	Rate	Cost
Wall Cladding	Block Veneer	Compressed concrete	Cracking			
			Grind out and repoint mortar	3.00 l/m	50.00	150.00
			Cracking			
Paint wall			Paint wall	11.50 m2	29.00	333.50
Wall framing	Timber Frame	Timber	No Earthquake Damage			

General Comments:

Elevation (North)

Damage: Earthquake damage

Require Scaffolding? No

Element	Type	Material	Damages	Measure	Rate	Cost
Patio	Concrete	Concrete	No Earthquake Damage			

Wall Cladding	Block Veneer	Compressed concrete	Cracking			
			Grind out and repoint mortar	1.50 l/m	50.00	75.00
			Cracking			
			Paint wall	16.75 m2	29.00	485.75
Wall Cladding	Weatherboard	Iron	No Earthquake Damage			
Wall framing	Timber Frame	Timber	No Earthquake Damage			

General Comments: Patio has historical cracking

Foundations

Damage: Earthquake damage

Require Scaffolding? No

Element	Type	Material	Damages	Measure	Rate	Cost
Piles	Ordinary	Concrete	Floor has moved less than 100mm			
			Replace Pile less than 6 under house	5.00 No of	195.00	975.00
Ring foundation	Load bearing	Concrete	Cracks to ring foundation			
			Grind out and epoxy fill cracks	1.50 l/m	30.00	45.00
			Cracks to ring foundation			
			Splash coat repair	8.00 m2	35.00	280.00
			Cracks to ring foundation			
			Paint foundation	8.00 m2	39.00	312.00

General Comments:

Roof

Damage: No damage

Require Scaffolding? No

General Comments: Rolled metal

Ground Floor - Kitchen

Damage: Earthquake damage

Require Scaffolding? No

Element	Type	Material	Damages	Measure	Rate	Cost
Ceiling	Gib	Paint	No Earthquake Damage			
Door (Internal)	Cavity Slider	MDF				
Floor	T&G	Carpet	No Earthquake Damage			
Kitchen joinery	Medium Spec	MDF	No Earthquake Damage			
Range (Free standing oven)	Electric	Standard Electric	No Earthquake Damage			
Range Hood	Over Head	Standard spec	No Earthquake Damage			
Wall covering	Gib	Paint	Cosmetic damage			
			Rake out, plaster and paint	43.20 m2	27.00	1,166.40
Window	Timber medium	Pane single glazed	No Earthquake Damage			
Work top	Kitchen work top	Stainless	No Earthquake Damage			

General Comments:

Ground Floor - Lounge

Damage: Earthquake damage

Require Scaffolding? No

Element	Type	Material	Damages	Measure	Rate	Cost
Ceiling	Gib	Stipple	Cosmetic Damage			
			Scrape off, rake out, fill, restipple	19.11 m2	50.00	955.50
			Cosmetic Damage			
			Paint Ceiling	19.11 m2	24.00	458.64
Door (Internal)	Single Hollow Core	Timber	No Earthquake Damage			
Floor	T&G	Carpet	No Earthquake Damage			
Wall covering	Gib	Paint	Cosmetic damage			

Wall covering	Gib	Paint	Rake out, plaster and paint	42.24 m2	27.00	1,140.48
			Structural damage			
			Remove, dispose, replace Gib, stop and undercoat (Excluding Trim)	11.76 m2	99.00	1,164.24
Window	Timber medium	Pane single glazed	No Earthquake Damage			

General Comments:**Ground Floor - Rumpus****Damage:** Earthquake damage**Require Scaffolding?** No

Element	Type	Material	Damages	Measure	Rate	Cost
Ceiling	Gib	Paint	No Earthquake Damage			
Door (Internal)	Glass panel door	Timber	Cosmetic damage			
			Ease door	1.00 No of	90.00	90.00
Floor	T&G	Carpet	No Earthquake Damage			
Heating	Electric	Heat pump	No Earthquake Damage			
Wall covering	Gib	Paint	Cosmetic damage			
			Rake out, plaster and paint	35.52 m2	27.00	959.04
Window	Timber medium	Pane single glazed	No Earthquake Damage			

General Comments:**Ground Floor - Hallway****Damage:** Earthquake damage**Require Scaffolding?** No

Element	Type	Material	Damages	Measure	Rate	Cost
Ceiling	Gib	Paint	Cosmetic Damage			
			Rake out, plaster and paint	9.00 m2	27.00	243.00
Door (External)	Single glass door	Timber	Cosmetic damage			
			Ease door	1.00 No of	90.00	90.00
Door (Internal)	Single Hollow Core	Timber	Cosmetic damage			
			Ease door	1.00 No of	90.00	90.00
Floor	T&G	Carpet	No Earthquake Damage			
Wall covering	Gib	Paint	Cosmetic damage			
			Rake out, plaster and paint	52.32 m2	27.00	1,412.64
Window	Timber medium	Pane single glazed	No Earthquake Damage			

General Comments:**Ground Floor - Bathroom****Damage:** No damage**Require Scaffolding?** No**General Comments:** Painted gib walls and ceiling, vinyl covered T and G floor, no earthquake damage**Ground Floor - Laundry****Damage:** No damage**Require Scaffolding?** No**General Comments:** Laminate wall linings, painted gib ceiling, vinyl covered T and G flooring.**Ground Floor - Toilet****Damage:** No damage**Require Scaffolding?** No**General Comments:** Painted gib walls and ceiling, vinyl covered T and G flooring, no earthquake damage.**Ground Floor - Bedroom (Bedroom 3, first bedroom on left down hallway)****Damage:** Earthquake damage**Require Scaffolding?** No

Element	Type	Material	Damages	Measure	Rate	Cost
Ceiling	Gib	Paint	Cosmetic Damage			
			Rake out, plaster and paint	8.68 m2	27.00	234.36
Door (Internal)	Single Hollow Core	MDF	No Earthquake Damage			

Floor	T&G	Carpet	No Earthquake Damage			
Wall covering	Gib	Paint	Cosmetic damage			
			Rake out, plaster and paint	28.32 m2	27.00	764.64
Window	Timber medium	Pane single glazed	No Earthquake Damage			

General Comments:

Ground Floor - Bedroom (Bedroom 2, second bedroom on left down hallway)

Damage: Earthquake damage

Require Scaffolding? No

Element	Type	Material	Damages	Measure	Rate	Cost
Ceiling	Gib	Paint	No Earthquake Damage			
Door (Internal)	Single Hollow Core	MDF	No Earthquake Damage			
Floor	T&G	Carpet	No Earthquake Damage			
Wall covering	Gib	Paint	Cosmetic damage			
			Rake out, plaster and paint	28.80 m2	27.00	777.60
Window	Timber medium	Pane single glazed	No Earthquake Damage			

General Comments:

Ground Floor - Bedroom (Main bedroom, at end of hallway)

Damage: Earthquake damage

Require Scaffolding? No

Element	Type	Material	Damages	Measure	Rate	Cost
Ceiling	Gib	Paint	No Earthquake Damage			
Door (Internal)	Single Hollow Core	MDF	No Earthquake Damage			
Floor	T&G	Carpet	No Earthquake Damage			
Wall covering	Gib	Paint	Cosmetic damage			
			Rake out, plaster and paint	35.04 m2	27.00	946.08
Window	Timber medium	Pane single glazed	No Earthquake Damage			

General Comments:

Garage

Exterior

Foundations

Damage: No damage

Require Scaffolding? No

General Comments: Concrete floor full of packing boxes viewing difficult 6. X 6

Elevation (east)

Damage: No damage

Require Scaffolding? No

General Comments: Metal cladding 6. X 2.1

Elevation (West)

Damage: No damage

Require Scaffolding? No

General Comments: metal cladding 6 x 2.1

Elevation (South)

Damage: No damage

Require Scaffolding? No

General Comments: metal cladding 6 x 2.1

Elevation (North)

Damage: No damage

Require Scaffolding? No

General Comments: metal tiltadoor. Metal cladding 6. X. 2.1

Roof

Damage: No damage

Require Scaffolding? No

General Comments: Metal trim deck

Ground Floor - Room (Other)

Damage: No damage

Require Scaffolding? No

General Comments:

Fees

Fees

Name	Duration	Estimate
Contents movement fee	1.00	592.33
Small Job Fee	1.00	180.00

Overheads

Name	Estimate
Preliminary and general	1,258.38
Margin	1,776.05
GST	2,930.48

Scope Of Works Estimate

Property

Description	Estimate
Site	0.00
Services	0.00
	0.00

Main Building

Name	Description	Estimate
Exterior	Foundations	1,612.00
	Roof	0.00
	Elevation (East)	1,473.90
	Elevation (North)	560.75
	Elevation (South)	1,107.00
	Elevation (West facing street)	483.50
		5,237.15

Floor	Description	Estimate
Ground Floor	Bathroom	0.00
	Bedroom (Bedroom 2, second bedroom on left down hallway)	777.60
	Bedroom (Bedroom 3, first bedroom on left down hallway)	999.00
	Bedroom (Main bedroom, at end of hallway)	946.08
	Hallway	1,835.64
	Kitchen	1,166.40
	Laundry	0.00
	Lounge	3,718.86
	Rumpus	1,049.04
	Toilet	0.00
		10,492.62

10,492.62

Garage

Name	Description	Estimate
Exterior	Foundations	0.00
	Roof	0.00
	Elevation (east)	0.00
	Elevation (North)	0.00
	Elevation (South)	0.00
	Elevation (West)	0.00
		0.00

Floor	Description	Estimate
Ground Floor	Room (Other)	0.00
		0.00

0.00

Fees

Description	Estimate
Contents movement fee	592.33
Small Job Fee	180.00
	772.33

Overheads

Description	Estimate
Preliminary and general	1,258.38

Margin	1,776.05
GST	2,930.48
<hr/>	
	5,964.91
<hr/>	
Total Estimate	22,467.01

Inspection Sign Off

Description	Answer	comments
Contents Damage		
Has the contents schedule been left with claimant?	No	
Have the contents been sighted?	No	
Land Damage		
Is there land damage?	No	
Landslip damage has been assessed on paper	No	
Was a full inspection done?		
In roof space	Yes	
On roof?	Yes	
Under sub floor?	Yes	
Decline Claim		
Recommend Declining Claim	No	

Next Action:

Insured is residing in Australia and we have not been supplied with a contact phone number for him. We ascertained from the current tenant that they had only recently moved into the premises and as such were unable to provide a break up of damage caused by each individual event.

Previous Claim Numbers (recorded manually in field)

- Unable to advise as unable to contact owner

File Notes

Date Created: 28/09/2011 11:52

Created : Miller, Paul

Subject: Property description

Note: Low set concrete block dwelling with rolled iron roof and T and G floor, approximately 45 years old.

Damage consists of minor cosmetic cracking to walls and ceilings throughout the premises as well as some easing of doors.

Cosmetic cracking to exterior block work as well as some releveling to piles

Next Action:

Date Created: 28/09/2011 12:04

Created : Miller, Paul

Subject: Details pertaining to insured property

Note: This owner of this property lives in Australia, and we have not been given a phone contact number for him. As a result of a cold call at the address on 27/9/2011, we ascertained that the property is rented and the tenant gave us permission to return on 28/9:2011 at 11.00 am to conduct a full assessment .

Next Action:

Urgent Works Items



Statement of Claim Checklist / Scope of Works

Date: 15/12/10
 Author: Ian Blake

CLM/2010/101998
 J Palmada
 9 GORE STREET
 HALSWELL
 CHRISTCHURCH
 H: [REDACTED]
 W:
 M:
 Estimator: Allan Coulton

LA: Ian Blake

Room	Earthquake Damage	Walls	Ceiling	Floor	Repair Strategy
	Y/N	✓	✓	✓	
Lounge	Y	✓			RAKE OUT CRACKS GIB STOP+TAPE + RE PAINT WALLS, AND CEILING. EASE WINDOWS IN LOUNGE
Dining Room	Y	✓			RAKE OUT CRACKS, GIB STOP + TAPE + REPAINT WALLS - Cracks under windows + doors.
Kitchen		✓			
Family Room					
Bedroom 1	Y			✓	BEDROOM FLOOR OUT OF LEVEL 10mm/m 40 WEST. WINDOWS JAMMING - EASE WINDOWS SEE PILING FOR REPAIR STRATEGY
Ensuite					
Bedroom 2	Y			✓	FLOOR OUT 15mm/m 40 WEST. SEE PILING/FOUNDATION FOR REPAIR STRAT.
Bedroom 3	Y			✓	① FLOOR OUT 15mm/m 40 WEST SEE PILING/FOUNDATIONS FOR REPAIR STRAT. ② GIB STOP TAPE + REPAINT WALLS CRACKS @ SCOTIA - FILL + REPAINT CEILING.

Room	Earthquake Damage Y/N	Walls	Ceiling	Floor	Repair Strategy
		✓	✓	✓	
Bedroom 4	N/A	✓			RAKE OUT, GIB STOP + TAPE CRACKS UNDER WINDOWS, RE PAINT WALLS
Bathroom	N/A				
Toilet 1	Y			✓	FLOOR OUT 10mm/m TO WEST. SEE PILING / FOUNDATIONS.
Toilet 2	N/A				
Office / Study	N/A				
Rumpus					
Entry / Hall(s)	Y	✓	✓		RAKE OUT CRACKS, GIB STOP + TAPE REPAINT WALLS AND CEILING.
Stairwell					
BATH / Laundry	Y			✓	FLOOR OUT 10mm/m SEE PILING / FOUND FOR REPAIR.
Other					

Item		Event Damage	Repair Strategy
		Y / N	
Roof		N	
EXTERNAL WALLS	North	N	
	South	N	
	East	N	
	West	N	
Decks			
CHIMNEY	Base	N	
	Ceiling Cavity	N	
	Above Roof	N	
	Fireplace	N	

Item	Event Damage	Repair Strategy
	Y / N	
Foundations	Y	CONCRETE RING FOUNDATION SUNK SOUTH/NORTH/NORTH SIDES. RAISE HOUSE REPILE HOUSE, REPLACE RING FOUNDATION. R/R
Piling	Y	EXTERNAL BRICK WORK.
Services	N	
Other Dwelling Items	N	
Outbuildings	N	
Land & Retaining Walls <i>(Discuss with Supervisor)</i>	Y	SUBSIDANCE OF LAND LEADING TO HOUSE FOUNDATION SUBSIDING.

Supplementary Notes:

I confirm the rooms and areas listed above have been inspected by an EQC representative.

Damage caused by the event has been noted and to my knowledge there are no other areas of damage resulting from the event.

Signature of Claimant: *M. Hooper* Dated: *15-12-10*

NOTE: THIS FORM IS TO BE COMPLETED IN THE CLAIMANT'S PRESENCE.

.....
Initials)



Scope of Works

Completed by:	N.Jones	CLM	2010 / 101998 (Fully Costed SOW)
Date:	06 May 2013.	Claimant Name:	
		J . Palmada	
		9 Gore Street	
		Christchurch.	

Element details:

Land	Building	Bridges/culverts	Retaining walls	Other
Lounge	Dining	Kitchen	Family room	Bedroom
Office/Study	Rumpus	Hallway	Stairwell	Toilet
Laundry	Bathroom	Ensuite	Chimney	Foundations
Piling	Services	Kitchen ovens	Hot water cylinders	Header tanks
Glazing/windows	Fireplace/woodburner	Floors	External walls	Roof
Outbuildings	Other			

Description: Substantial Damage to Dwelling

Repair strategy: Cost to Repair Exceeds Maximum EQC Entitlement

Line items:

Description:	Units	Length	Breadth	Depth	Qty	Rate	Cost
Consents & Consultants Fees							
Demolition fee	Each				1.00	\$ 373.00	\$ 373.00
Building Consent - Dwelling major	Each				1.00	\$ 4,347.00	\$ 4,347.00
Structural Engineer	Each					\$ 3,555.00	\$ -
Architectural Design fee	m ²				0.00	\$ 106.56	\$ -
Architectural Design fee minor works	Each					\$ 6,000.00	\$ -
Preliminary & General							
Site Set Up/Establishment	Each				1.00	\$ 4,000.00	\$ 4,000.00
Scaffolding - Erect and Dismantle	Each				0.00	\$ 1,835.00	\$ -
Scaffolding - Weekly Hire	Wks				0.00	\$ 200.00	\$ -
Scaffolding checks (weekly)	Wks				0.00	\$ 80.00	\$ -
Reconnect Services	Each				1.00	\$ 5,000.00	\$ 5,000.00
RE-INSTATE DRAINAGE	Each				1.00	5000.00	\$ 5,000.00
Mobile Scaffolding	Each				1.00	150.00	\$ 150.00
					0.00		\$ -
					0.00		\$ -
						Subtotal	\$ 18,870.00
						+ P&G, Margin & GST Figure	
						Total	

* Unit categories to be used as follows:
Each, Sheet, Kilogram, Linear metre, Square metre, Cubic metre, Per hour, Per day, Per week. Cubic metre calculations must include length, breadth and depth figures. Square metre calculations must include length and breadth figures.

EQC 039 - Revised 07-09



Scope of Works

Completed by:	N.Jones	CLM	2010 / 101998 (Fully Costed SOW)
Date:	06 May 2013.	Claimant Name:	
		J . Palmada	
		9 Gore Street	
		Christchurch.	

Element details:

Land	Building	Bridges/culverts	Retaining walls	Other
Lounge	Dining	Kitchen	Family room	Bedroom
Office/Study	Rumpus	Hallway	Stairwell	Toilet
Laundry	Bathroom	Ensuite	Chimney	Foundations
Piling	Services	Kitchen ovens	Hot water cylinders	Header tanks
Glazing/windows	Fireplace/woodburner	Floors	External walls	Roof
Outbuildings	Other			

Description: Substantial Damage to Dwelling

Repair strategy: Cost to Repair Exceeds Maximum EQC Entitlement

Line items:

Description:	Units	Length	Breadth	Depth	Qty	Rate	Cost
Demolition							
Demolish Light Weight Cladding	m ²	37.50	1.00		37.50	\$ 5.00	\$ 187.50
Demolition of Heavy Roof/Light Wall/Light Floor	m ²				0.00	100.00	\$ -
Concrete Slab	m ²				0.00	75.75	\$ -
Ring Foundation	Lm	52.40			52.40	90.00	\$ 4,716.00
Piles	Each				62.00	\$ 15.00	\$ 930.00
Remove Brick Veneer and Dispose - 10 Series Block	m ²	98.70	1.00		98.70	\$ 48.00	\$ 4,737.60
WEATHER PROOF WRAP	m ²	136.20	1.00		136.20	\$ 7.20	\$ 980.64
Cut away internal wall linings for a lift on slab	m ²				0.00	\$ 3.50	\$ -
((gfa x 0.53) + (perimeter x 0.6))					0.00		\$ -
Remove concrete roof tiles	m ²				0.00	\$ 25.00	\$ -
Patio	m ²				0.00	\$ 75.75	\$ -
Deck	m ²				0.00	\$ 40.00	\$ -
LIFTING & REMOVAL							
Lift & Reinststate Dwelling	Each				1.00	\$ 17,000.00	\$ 17,000.00
Lift & Reinststate Garage	Each					\$ 4,000.00	\$ -
ACROW PROP HIRE (1 MONTH)	Each					\$ 60.72	\$ -
						Subtotal	\$ 28,551.74
						+ P&G, Margin & GST Figure	
						Total	

* Unit categories to be used as follows:
Each, Sheet, Kilogram, Linear metre, Square metre, Cubic metre, Per hour, Per day, Per week. Cubic metre calculations must include length, breadth and depth figures. Square metre calculations must include length and breadth figures.

EQC 039 - Revised 07-09



Scope of Works

Completed by:	N.Jones	CLM	2010 / 101998 (Fully Costed SOW)
Date:	06 May 2013.	Claimant Name:	
		J . Palmada	
		9 Gore Street	
		Christchurch.	

Element details:

Land	Building	Bridges/culverts	Retaining walls	Other
Lounge	Dining	Kitchen	Family room	Bedroom
Office/Study	Rumpus	Hallway	Stairwell	Toilet
Laundry	Bathroom	Ensuite	Chimney	Foundations
Piling	Services	Kitchen ovens	Hot water cylinders	Header tanks
Glazing/windows	Fireplace/woodburner	Floors	External walls	Roof
Outbuildings	Other			

Description: Substantial Damage to Dwelling

Repair strategy: Cost to Repair Exceeds Maximum EQC Entitlement

Line items:

Description:	Units	Length	Breadth	Depth	Qty	Rate	Cost
LIQUIFACTION							\$ -
Remove from under dwelling	Each					\$ 8,000.00	\$ -
					0.00		\$ -
ASBESTOS							\$ -
Strip & remove from site	m ²				0.00	\$ 75.00	\$ -
Test	Each					\$ 200.00	\$ -
					0.00		\$ -
FOUNDATIONS							\$ -
Foundation Walls - Concrete	Lm	52.40			52.40	\$ 240.00	\$ 12,576.00
Concrete slab	m ²				0.00	\$ 130.00	\$ -
Hardfill	m ²				0.00	\$ 34.00	\$ -
Concrete Slab Footings	Lm				0.00	\$ 136.00	\$ -
					0.00		\$ -
REPAIRS TO CONCRETE SLAB							\$ -
Slab repair - cracks 10 - 25 mm wide	Lm				0.00	\$ 190.00	\$ -
Self levelling compound 10-20 mm thick	m ²				0.00	\$ 85.00	\$ -
Epoxy repair to cracks - cracks up to 10 mm wide	Lm				0.00	\$ 42.00	\$ -
Asphalt concrete (AC) - repairs up to 30 mm thick	Lm				0.00	\$ 37.00	\$ -
						Subtotal	\$ 12,576.00
						+ P&G, Margin & GST Figure	
						Total	

* Unit categories to be used as follows:
Each, Sheet, Kilogram, Linear metre, Square metre, Cubic metre, Per hour, Per day, Per week. Cubic metre calculations must include length, breadth and depth figures. Square metre calculations must include length and breadth figures.

EQC 039 - Revised 07-09



Scope of Works

Completed by:	N.Jones	CLM	2010 / 101998 (Fully Costed SOW)
Date:	06 May 2013.	Claimant Name:	
		J . Palmada	
		9 Gore Street	
		Christchurch.	

Element details:

Land	Building	Bridges/culverts	Retaining walls	Other
Lounge	Dining	Kitchen	Family room	Bedroom
Office/Study	Rumpus	Hallway	Stairwell	Toilet
Laundry	Bathroom	Ensuite	Chimney	Foundations
Piling	Services	Kitchen ovens	Hot water cylinders	Header tanks
Glazing/windows	Fireplace/woodburner	Floors	External walls	Roof
Outbuildings	Other			

Description: Substantial Damage to Dwelling

Repair strategy: Cost to Repair Exceeds Maximum EQC Entitlement

Line items:

Description:	Units	Length	Breadth	Depth	Qty	Rate	Cost
PILING							
125 x 125 H5 tanapiles	Each				62.00	\$ 185.00	\$ 11,470.00
Piles allow for separate small job	Each						\$ -
Subfloor access through timber floor	Each					\$ 250.00	\$ -
Subfloor access through ring foundation	Each						\$ -
125 x 125 H5 tanapiles to deck at 1.500 m ctrs	Each					\$ 80.00	\$ -
Pack and Relevel Piles	Each					\$ 100.00	\$ -
Jack Piling to Concrete Ring Foundation at 1.350 mm ctrs	Each					\$ 200.00	\$ -
MID FLOOR CONCRETE FLOORS							
75mm Hebel sound floor	m ²				0.00	\$ 200.00	\$ -
					0.00		\$ -
					0.00		\$ -
TIMBER FLOORS							
Timber Subfloor Framing with Sheet Flooring	m ²				0.00	\$ 135.00	
Timber Subfloor Framing with T&G	m ²				0.00	\$ 275.00	\$ -
					0.00		\$ -
TIMBER DECKS							
125 x 125 H5 tanapiles to deck at 1.500 m ctrs	Each				0.00	\$ 80.00	
Timber Deck Framing with Radiata Grip Tread	m ²				0.00	\$ 200.00	\$ -
						Subtotal	\$ 11,470.00
						+ P&G, Margin & GST Figure	
						Total	

* Unit categories to be used as follows:
Each, Sheet, Kilogram, Linear metre, Square metre, Cubic metre, Per hour, Per day, Per week. Cubic metre calculations must include length, breadth and depth figures. Square metre calculations must include length and breadth figures.

EQC 039 - Revised 07-09



Scope of Works

Completed by:	N.Jones	CLM	2010 / 101998 (Fully Costed SOW)
Date:	06 May 2013.	Claimant Name:	
		J . Palmada	
		9 Gore Street	
		Christchurch.	

Element details:

Land	Building	Bridges/culverts	Retaining walls	Other
Lounge	Dining	Kitchen	Family room	Bedroom
Office/Study	Rumpus	Hallway	Stairwell	Toilet
Laundry	Bathroom	Ensuite	Chimney	Foundations
Piling	Services	Kitchen ovens	Hot water cylinders	Header tanks
Glazing/windows	Fireplace/woodburner	Floors	External walls	Roof
Outbuildings	Other			

Description: Substantial Damage to Dwelling

Repair strategy: Cost to Repair Exceeds Maximum EQC Entitlement

Line items:

Description:	Units	Length	Breadth	Depth	Qty	Rate	Cost
NETTING AND UNDERLAY PAPER							
Roofing Underlay	m ²				0.00	\$ 3.00	\$ -
					0.00		\$ -
FASCIA AND SPOUTING							
Klass Fascia and Spouting	Lm				0.00	\$ 45.00	\$ -
PVC Downpipes - 80mm - Supply and Install	Lm				0.00	\$ 68.00	\$ -
					0.00		\$ -
EXTERIOR CLADDING							
Brick/Block							
Standard Brick Veneer	m ²	98.70	1.00		98.70	\$ 104.00	\$ 10,264.80
Concrete block 15 / 20 series supply / Lay / fill	m ²				0.00	\$ 180.00	\$ -
					0.00		\$ -
Hebel Panels							
75mm thick sound floor	m ²				0.00	\$ -	\$ -
					0.00		\$ -
Stone/Rock Veneers							
Summerhill Stone	m ²				0.00	\$ 130.00	\$ -
					0.00		\$ -
						Subtotal	\$ 10,264.80
						+ P&G, Margin & GST Figure	
						Total	

* Unit categories to be used as follows:
Each, Sheet, Kilogram, Linear metre, Square metre, Cubic metre, Per hour, Per day, Per week. Cubic metre calculations must include length, breadth and depth figures. Square metre calculations must include length and breadth figures.

EQC 039 - Revised 07-09



Scope of Works

Completed by:	N.Jones	CLM	2010 / 101998 (Fully Costed SOW)
Date:	06 May 2013.	Claimant Name:	
		J . Palmada	
		9 Gore Street	
		Christchurch.	

Element details:

Land	Building	Bridges/culverts	Retaining walls	Other
Lounge	Dining	Kitchen	Family room	Bedroom
Office/Study	Rumpus	Hallway	Stairwell	Toilet
Laundry	Bathroom	Ensuite	Chimney	Foundations
Piling	Services	Kitchen ovens	Hot water cylinders	Header tanks
Glazing/windows	Fireplace/woodburner	Floors	External walls	Roof
Outbuildings	Other			

Description: Substantial Damage to Dwelling

Repair strategy: Cost to Repair Exceeds Maximum EQC Entitlement

Line items:

Description:	Units	Length	Breadth	Depth	Qty	Rate	Cost
Solid Plaster	m ²				0.00	\$ 85.00	\$ -
Splash coat to Foundations	m ²				0.00	\$ 55.00	\$ -
Cracks - grind out & epoxy fill (STUCCO)	Lm				0.00	\$ 55.00	\$ -
					0.00		\$ -
Monolithic cladding - Polyclad, Insulclad systems, including painting	m ²				0.00	\$ 155.00	\$ -
Monolithic cladding repairs - includes crack repairs and painting.	m ²				0.00	\$ 65.00	\$ -
Repairs includes scaffold					0.00		\$ -
					0.00		\$ -
Weatherboard/Sheet Exterior Claddings							
Hardiplank	m ²	37.50	1.00		37.50	\$ 114.00	\$ 4,275.00
Natural Finish (Cedar)	m ²				0.00	\$ 187.00	\$ -
Hardiflex - direct fixed	m ²				0.00	\$ 43.00	\$ -
Scribers - remove, replace. Includes labour and materials.	Lm				0.00	\$ 23.00	\$ -
					0.00		\$ -
Brickolite - allow to replace with a textured finish							
Walls less than 20m ²	m ²				0.00	\$ 200.00	\$ -
Walls greater than 20m ²	m ²				0.00	\$ 175.00	\$ -
					0.00		\$ -
						Subtotal	\$ 4,275.00
* Unit categories to be used as follows: Each, Sheet, Kilogram, Linear metre, Square metre, Cubic metre, Per hour, Per day, Per week. Cubic metre calculations must include length, breadth and depth figures. Square metre calculations must include length and breadth figures.						+ P&G, Margin & GST Figure	
						Total	

EQC 039 - Revised 07-09



Scope of Works

Completed by:	N.Jones	CLM	2010 / 101998 (Fully Costed SOW)
Date:	06 May 2013.	Claimant Name:	
		J . Palmada	
		9 Gore Street	
		Christchurch.	

Element details:

Land	Building	Bridges/culverts	Retaining walls	Other
Lounge	Dining	Kitchen	Family room	Bedroom
Office/Study	Rumpus	Hallway	Stairwell	Toilet
Laundry	Bathroom	Ensuite	Chimney	Foundations
Piling	Services	Kitchen ovens	Hot water cylinders	Header tanks
Glazing/windows	Fireplace/woodburner	Floors	External walls	Roof
Outbuildings	Other			

Description: Substantial Damage to Dwelling

Repair strategy: Cost to Repair Exceeds Maximum EQC Entitlement

Line items:

Description:	Units	Length	Breadth	Depth	Qty	Rate	Cost
LOUNGE ceiling							
Rake stop paint	m ²	4.80	3.80		18.24	\$ 27.00	\$ 492.48
Paint	m ²				0.00	\$ 25.00	\$ -
Walls							
Rake stop paint	m ²	17.20	2.40		41.28	\$ 27.00	\$ 1,114.56
Ease Window	Each				1.00	\$ 100.00	\$ 100.00
Floor							
Uplift / Supply / Lay tiles	m ²				0.00	\$ 170.00	\$ -
Supply & Lay tiles	m ²				0.00	\$ 130.00	\$ -
Dining Room Kitchen Combined Ceiling							
Rake stop paint	m ²	5.90	2.80		16.52	\$ 27.00	\$ 446.04
Stipple coat	m ²				0.00	\$ 50.00	\$ -
Walls							
Rake stop paint	m ²	17.40	2.40		41.76	\$ 27.00	\$ 1,127.52
Re gib	m ²				0.00	\$ 50.00	\$ -
Floor							
Uplift relay carpet	m ²				0.00	\$ 12.00	\$ -
Uplift relay carpet	m ²				0.00	\$ 12.00	\$ -
						Subtotal	\$ 3,280.60
* Unit categories to be used as follows: Each, Sheet, Kilogram, Linear metre, Square metre, Cubic metre, Per hour, Per day, Per week. Cubic metre calculations must include length, breadth and depth figures. Square metre calculations must include length and breadth figures.						+ P&G, Margin & GST Figure	
						Total	

EQC 039 - Revised 07-09



Scope of Works

Completed by:	N.Jones	CLM	2010 / 101998 (Fully Costed SOW)
Date:	06 May 2013.	Claimant Name:	
		J . Palmada	
		9 Gore Street	
		Christchurch.	

Element details:

Land	Building	Bridges/culverts	Retaining walls	Other
Lounge	Dining	Kitchen	Family room	Bedroom
Office/Study	Rumpus	Hallway	Stairwell	Toilet
Laundry	Bathroom	Ensuite	Chimney	Foundations
Piling	Services	Kitchen ovens	Hot water cylinders	Header tanks
Glazing/windows	Fireplace/woodburner	Floors	External walls	Roof
Outbuildings	Other			

Description: Substantial Damage to Dwelling

Repair strategy: Cost to Repair Exceeds Maximum EQC Entitlement

Line items:

Description:	Units	Length	Breadth	Depth	Qty	Rate	Cost
BEDROOM ceiling							
Rake stop paint	m ²	4.00	3.10		12.40	\$ 27.00	\$ 334.80
Paint	m ²				0.00	\$ 25.00	\$ -
Walls							
Rake stop paint	m ²	14.20	2.40		34.08	\$ 27.00	\$ 920.16
Ease Window	Each				1.00	\$ 100.00	\$ 100.00
Floor							
Cork tiles	m ²				0.00	\$ 215.00	\$ -
Uplift relay carpet	m ²				0.00	\$ 12.00	\$ -
BEDROOM ceiling							
Rake stop paint	m ²	3.00	2.90		8.70	\$ 27.00	\$ 234.90
Rake stop paint	m ²				0.00	\$ 27.00	\$ -
Walls							
Rake stop paint	m ²	11.80	2.40		28.32	\$ 27.00	\$ 764.64
Re gib	m ²				0.00	\$ 50.00	\$ -
Floor							
Uplift relay carpet	m ²				0.00	\$ 12.00	\$ -
Uplift relay carpet	m ²				0.00	\$ 12.00	\$ -
						Subtotal	\$ 2,354.50
						+ P&G, Margin & GST Figure	
						Total	

* Unit categories to be used as follows:
Each, Sheet, Kilogram, Linear metre, Square metre, Cubic metre, Per hour, Per day, Per week. Cubic metre calculations must include length, breadth and depth figures. Square metre calculations must include length and breadth figures.

EQC 039 - Revised 07-09



Scope of Works

Completed by:	N.Jones	CLM	2010 / 101998 (Fully Costed SOW)
Date:	06 May 2013.	Claimant Name:	
		J . Palmada	
		9 Gore Street	
		Christchurch.	

Element details:

Land	Building	Bridges/culverts	Retaining walls	Other
Lounge	Dining	Kitchen	Family room	Bedroom
Office/Study	Rumpus	Hallway	Stairwell	Toilet
Laundry	Bathroom	Ensuite	Chimney	Foundations
Piling	Services	Kitchen ovens	Hot water cylinders	Header tanks
Glazing/windows	Fireplace/woodburner	Floors	External walls	Roof
Outbuildings	Other			

Description: Substantial Damage to Dwelling

Repair strategy: Cost to Repair Exceeds Maximum EQC Entitlement

Line items:

Description:	Units	Length	Breadth	Depth	Qty	Rate	Cost
BEDROOM ceiling							
Rake stop paint	m ²	2.90	2.70		7.83	\$ 27.00	\$ 211.41
Stipple coat	m ²				0.00	\$ 50.00	\$ -
Walls							
Rake stop paint	m ²	11.20	2.40		26.88	\$ 27.00	\$ 725.76
Re gib	m ²				0.00	\$ 50.00	\$ -
Floor							
Uplift relay carpet	m ²				0.00	\$ 12.00	\$ -
Uplift relay carpet	m ²				0.00	\$ 12.00	\$ -
Bedroom Ceiling							
Rake stop paint	m ²	4.10	3.20		13.12	\$ 27.00	\$ 354.24
Stipple coat	m ²				0.00	\$ 50.00	\$ -
Walls							
Rake stop paint	m ²	14.60	2.40		35.04	\$ 27.00	\$ 946.08
Re gib	m ²				0.00	\$ 50.00	\$ -
Floor							
Cork tiles	m ²				0.00	\$ 215.00	\$ -
Uplift / Supply / Lay tiles	m ²				0.00	\$ 170.00	\$ -
						Subtotal	\$ 2,237.49
						+ P&G, Margin & GST Figure	
						Total	

* Unit categories to be used as follows:
Each, Sheet, Kilogram, Linear metre, Square metre, Cubic metre, Per hour,
Per day, Per week. Cubic metre calculations must include length, breadth
and depth figures. Square metre calculations must include length and
breadth figures.

EQC 039 - Revised 07-09



Scope of Works

Completed by:	N.Jones	CLM	2010 / 101998 (Fully Costed SOW)
Date:	06 May 2013.	Claimant Name:	
		J . Palmada	
		9 Gore Street	
		Christchurch.	

Element details:

Land	Building	Bridges/culverts	Retaining walls	Other
Lounge	Dining	Kitchen	Family room	Bedroom
Office/Study	Rumpus	Hallway	Stairwell	Toilet
Laundry	Bathroom	Ensuite	Chimney	Foundations
Piling	Services	Kitchen ovens	Hot water cylinders	Header tanks
Glazing/windows	Fireplace/woodburner	Floors	External walls	Roof
Outbuildings	Other			

Description: Substantial Damage to Dwelling

Repair strategy: Cost to Repair Exceeds Maximum EQC Entitlement

Line items:

Description:	Units	Length	Breadth	Depth	Qty	Rate	Cost
Bathroom Ceiling							
Rake stop paint	m ²	1.80	1.40		2.52	\$ 27.00	\$ 68.04
Stipple coat	m ²				0.00	\$ 50.00	\$ -
Walls							
Rake stop paint	m ²	6.40	2.40		15.36	\$ 27.00	\$ 414.72
Re gib	m ²				0.00	\$ 50.00	\$ -
Floor							
Uplift relay carpet	m ²				0.00	\$ 12.00	\$ -
Uplift relay carpet	m ²				0.00	\$ 12.00	\$ -
TOILET ceiling							\$ -
Rake stop paint	m ²	1.40	1.00		1.40	\$ 27.00	\$ 37.80
Rake stop paint	m ²				0.00	\$ 27.00	\$ -
Walls							
Rake stop paint	m ²	4.80	2.40		11.52	\$ 27.00	\$ 311.04
Re gib	m ²				0.00	\$ 50.00	\$ -
Floor							
Uplift relay carpet	m ²				0.00	\$ 12.00	\$ -
Uplift relay carpet	m ²				0.00	\$ 12.00	\$ -
						Subtotal	\$ 831.60
* Unit categories to be used as follows: Each, Sheet, Kilogram, Linear metre, Square metre, Cubic metre, Per hour, Per day, Per week. Cubic metre calculations must include length, breadth and depth figures. Square metre calculations must include length and breadth figures.						+ P&G, Margin & GST Figure	
						Total	

EQC 039 - Revised 07-09



Scope of Works

Completed by:	N.Jones	CLM	2010 / 101998 (Fully Costed SOW)
Date:	06 May 2013.	Claimant Name:	
		J . Palmada	
		9 Gore Street	
		Christchurch.	

Element details:

Land	Building	Bridges/culverts	Retaining walls	Other
Lounge	Dining	Kitchen	Family room	Bedroom
Office/Study	Rumpus	Hallway	Stairwell	Toilet
Laundry	Bathroom	Ensuite	Chimney	Foundations
Piling	Services	Kitchen ovens	Hot water cylinders	Header tanks
Glazing/windows	Fireplace/woodburner	Floors	External walls	Roof
Outbuildings	Other			

Description: Substantial Damage to Dwelling

Repair strategy: Cost to Repair Exceeds Maximum EQC Entitlement

Line items:

Description:	Units	Length	Breadth	Depth	Qty	Rate	Cost
Entry Hall Ceiling							
Rake stop paint	m ²	7.50	2.20		16.50	\$ 27.00	\$ 445.50
Stipple coat	m ²				0.00	\$ 50.00	\$ -
Walls							
Rake stop paint	m ²	19.40	2.40		46.56	\$ 27.00	\$ 1,257.12
Strip lathe & plaster fit new gib	m ²				0.00	\$ 115.00	\$ -
Floor							
Sand polyurethane	m ²				0.00	\$ 32.00	\$ -
Uplift / Supply / Lay tiles	m ²				0.00	\$ 170.00	\$ -
Lounge Ceiling							
Remove lathe & plaster with same	m ²				0.00	\$ 250.00	\$ -
Stipple coat	m ²				0.00	\$ 50.00	\$ -
Walls							
Strip lathe & plaster fit new gib	m ²				0.00	\$ 115.00	\$ -
Re gib	m ²				0.00	\$ 50.00	\$ -
Floor							
Uplift relay carpet	m ²				0.00	\$ 12.00	\$ -
Uplift relay carpet	m ²				0.00	\$ 12.00	\$ -
						Subtotal	\$ 1,702.62
						+ P&G, Margin & GST Figure	
						Total	

* Unit categories to be used as follows:
Each, Sheet, Kilogram, Linear metre, Square metre, Cubic metre, Per hour,
Per day, Per week. Cubic metre calculations must include length, breadth
and depth figures. Square metre calculations must include length and
breadth figures.

EQC 039 - Revised 07-09



Scope of Works

Completed by: N.Jones	CLM	2010 / 101998 (Fully Costed SOW)
Date: 06 May 2013.	Claimant Name:	
	J . Palmada	
	9 Gore Street	
	Christchurch.	

Element details:

Land	Building	Bridges/culverts	Retaining walls	Other
Lounge	Dining	Kitchen	Family room	Bedroom
Office/Study	Rumpus	Hallway	Stairwell	Toilet
Laundry	Bathroom	Ensuite	Chimney	Foundations
Piling	Services	Kitchen ovens	Hot water cylinders	Header tanks
Glazing/windows	Fireplace/woodburner	Floors	External walls	Roof
Outbuildings	Other			

Description: Substantial Damage to Dwelling

Repair strategy: Cost to Repair Exceeds Maximum EQC Entitlement

Line items:

Description:	Units	Length	Breadth	Depth	Qty	Rate	Cost
Garage Doors & Windows							
2.400mm wide single garage door	Each					\$ 2,226.00	\$ -
					0.00		\$ -
					0.00		\$ -
Outbuilding							
Studio	m ²				0.00		\$ -
					0.00		\$ -
					0.00		\$ -
Sundries							
Conservatory not including floor	m ²					\$ 670.00	\$ -
Pergola	m ²					\$ 69.00	\$ -
Patio	m ²					\$ 130.00	\$ -
							\$ -
CHIMNEY'S							
INTERNAL - BRICK - CEILING - 1 POT	Each					\$ 3,725.00	\$ -
INTERNAL - BRICK - BASE - 1 POT	Each					\$ 7,250.00	\$ -
EXTERNAL - BRICK - CEILING - 1 POT	Each					\$ 3,210.00	\$ -
EXTERNAL - BRICK - BASE - 1 POT	Each				1.00	\$ 8,983.00	\$ 8,983.00
						Subtotal	\$ 8,983.00
						+ P&G, Margin & GST Figure	
						Total	

* Unit categories to be used as follows:
Each, Sheet, Kilogram, Linear metre, Square metre, Cubic metre, Per hour, Per day, Per week. Cubic metre calculations must include length, breadth and depth figures. Square metre calculations must include length and breadth figures.

EQC 039 - Revised 07-09

W.K.

9 Gere

Date: 15-12-2010

Claim No: 2010/101998

Estimator's Name: Alan Coeletter

stud 2.4

Dwelling Inspection Checklist: Show measurements, indicate damage

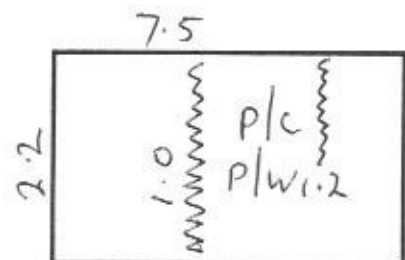
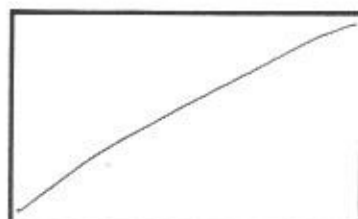
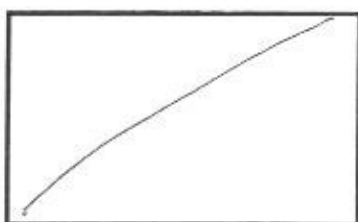
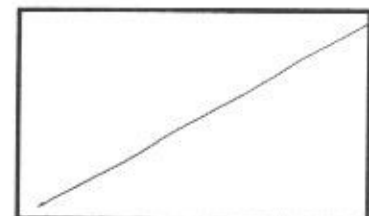
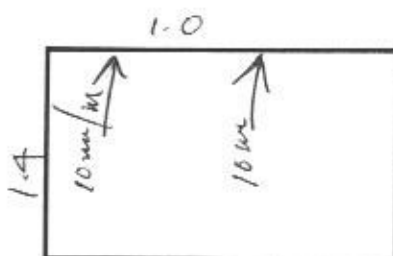
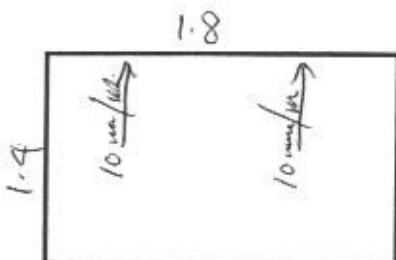
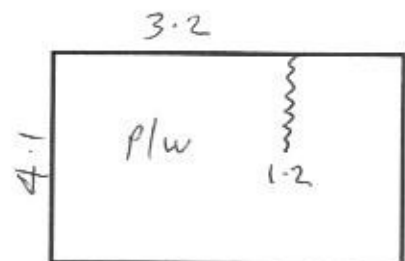
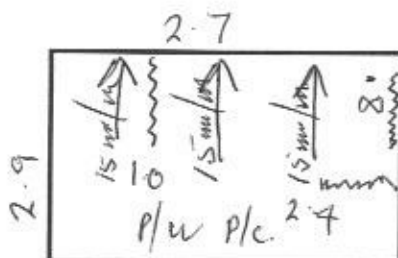
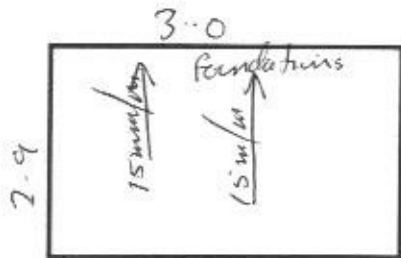
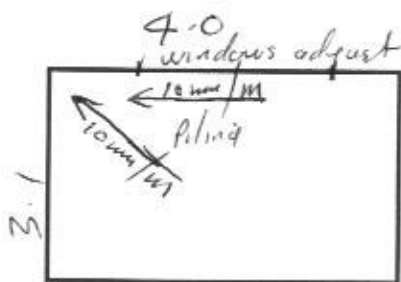
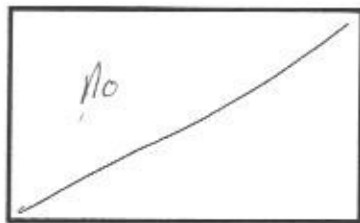
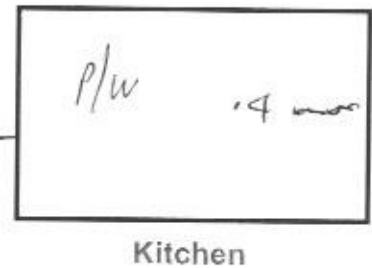
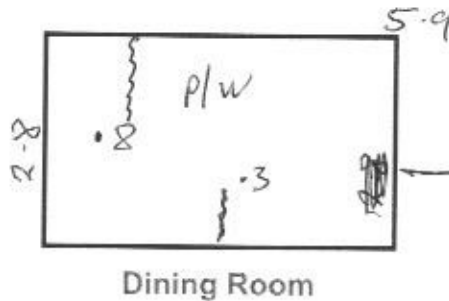
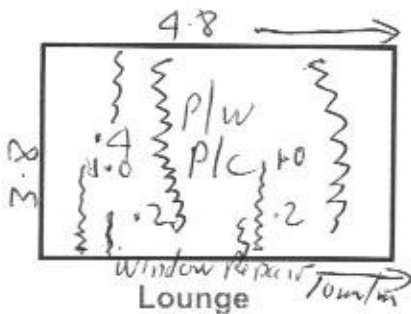

Date: 15-12-2010

Claim No: 2010/ 101998

Estimator's Name: Alan Coulter

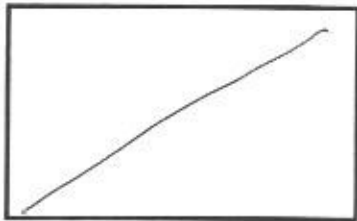

Stairwell

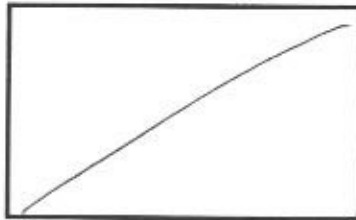

Laundry

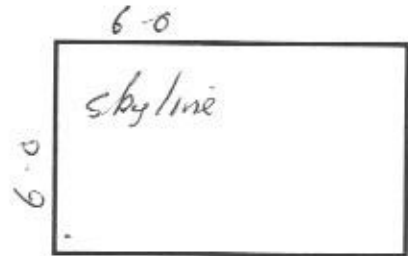

Outbuldings/Garage

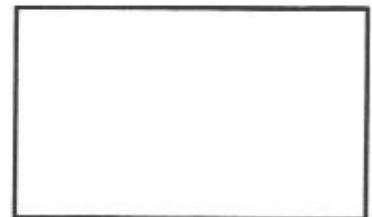
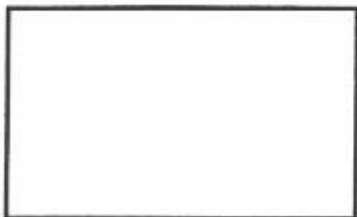

Legend

<u>w/w</u>	Wall Cracks
<u>c/c</u>	ceiling Cracks
<u>P/c</u>	Paint Ceiling
<u>P/w</u>	Paint Walls
<u>15mm/m</u>	floor slope 15mm/metre.

9 gone

Date: 15-12-2010

Claim Number: 2010/ 101998

Estimator's Name: Alan Corlten

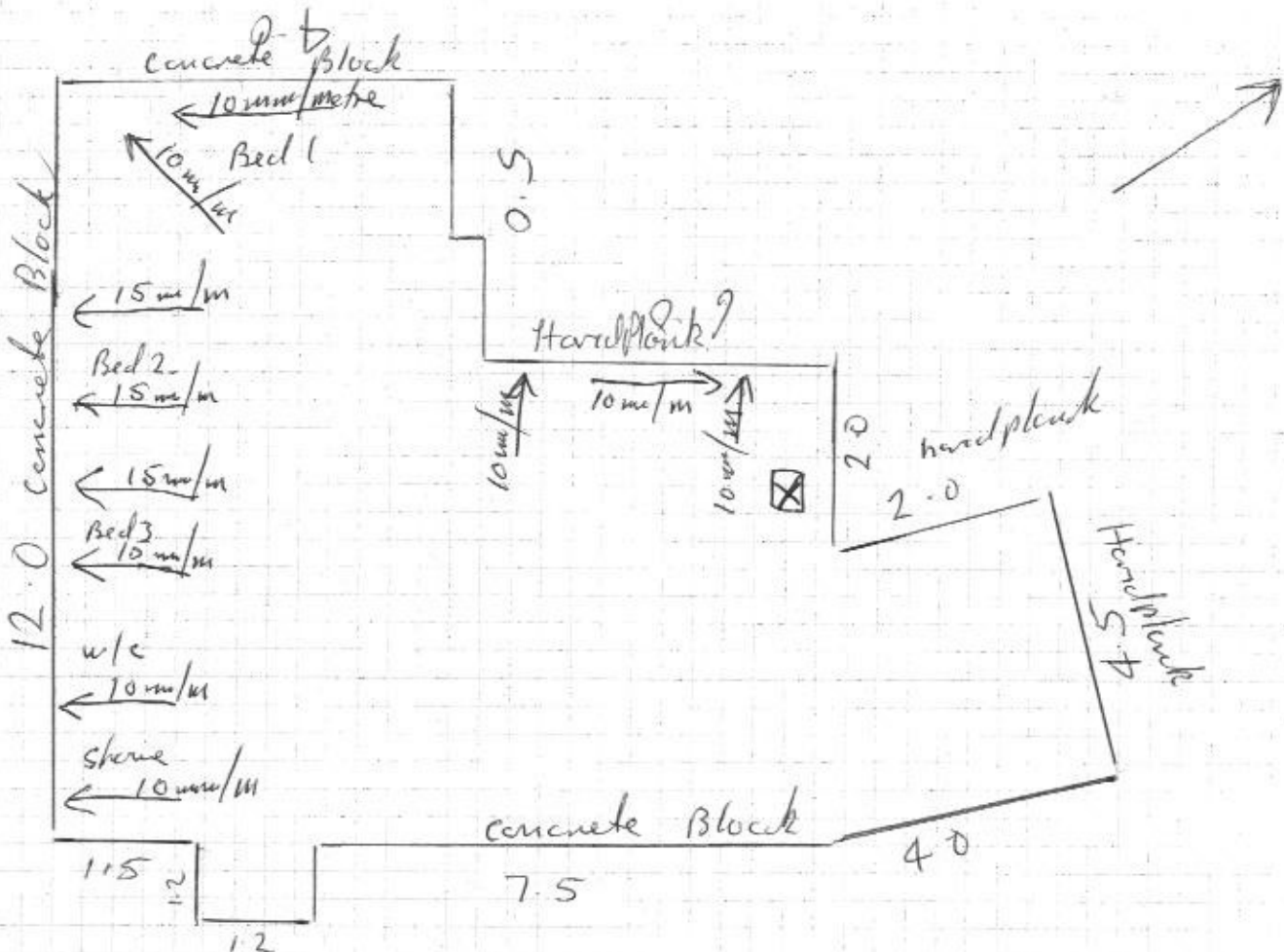

Area m ² :	125			
Stud Heights:	2.4			
Wall Finish:	Wallpaper	Plastered	Paint finish	
Other:				
Services:	Specify damage:			
Chimneys:	Construction type: Block			
	Height:			
	Damage description:	Above Roof	Below Roof	Total Repair
Foundations Damage:	Timber	Concrete Ring	Concrete Slab	Other (specify):
	Minor	Moderate	Severe	
	House moved off foundations?:			
	Concrete slab cracked?	Crack width	Crack length	
Roof:	Framed	Trussed		
	Type:	Clay Tiles	Concrete tiles	Metal tiles
			Rolled Metal	Other (specify):
	Damage:			
Cladding Type:	Weatherboard	Brick Veneer	Hardi Plank	Other

Additional Information

Block

LAND DOCUMENTS

The following information contains documents relating to the land assessments that were either cash settled or declined:

The attached land document(s) help NHC Toka Tū Ake identify information that may be relevant to its assessment of your residential land claims. They are not intended to form a complete technical report on land damage to your land. The land information, including valuations, repair costs and estimates, do not necessarily reflect the final land settlement received



1959032 2010 CHCH EQ - LAND ENGINEERING REPORT

EQC Claim Number	2010/101998	Significant Risk to Safety	YES NO
Claimants Address	9 GORE ST. HAWSWAY	Engineer's Name :	SMORRIS C LOYE
Claimant Name :	J PALMADA	Engineers E-mail:	smorris@goldel.com
		Date:	16/02/2011 Team no: 8
LM	BLACK	RED	ORANGE GREEN BLUE

LAND DAMAGE CATEGORY

GENERAL

Type of Damage	Earthquake	Landslip	Storm/Flood	other
EQC Priority of claims	1 - Home/Land seriously damaged and uninhabitable		2 - Home/Land seriously damaged but habitable	
	3 - Moderate damage to Home/Land & Habitable		4 - All other damage	
Is this natural Disaster Damage?	YES	NO		
Is there an Imminent Risk of Loss?	YES	NO		

INSPECTION DATA & DISCUSSION WITH CLAIMANT(S)

Discussion with Claimant/Occupier?	YES	NO
What happened? Claimant's story	NOT HOME. NO PHONE NUMBER.	

SITE DESCRIPTION (Refer Site Plan and Cross Section)

General:	CRAacking ON EXTERNAL WALLS, THROUGH TO RING BEAM. CRACKING OF STEPS. MOVEMENT OF WALLS - WINDOWS. SPARSE CRACKING ON W/E SIDES. SETTLEMENT PROBABLE AROUND THE SOUTH. NO SAND OBSERVED.
----------	--

LAND - (DAMAGED ACCESS, LAND, & DESTROYED LAND, & RETAINING WALLS, BRIDGES, CULVERTS)

Type of damage to land :	None				
	Liquefaction:	Sand Boils	Ground Rupture	surface slump	rotational slip
		Lateral Spreading	tension cracks (landslip)	toe-bulge	other,
		Permanent Settlement	- HOUSE.		
Retaining wall damaged?	None	No. of walls damaged		other	
Type of damage to retaining wall(s) :	N/A cracks	rotated/leaning	slid	bulging	Settlement
Location of retaining wall(s) :	N/A within 8m of building	within 60m & needed to protect of land within 8m of accessway/building			other,
Land beneath Main access way damaged?	No-N/A	within 30m of building	other,		
Areas of land Damage	Entire Site	Portion of Site	None		

Detailed Areas	Total Site Area: 588	AREA (m2)	(only complete table if a portion of site damaged)	
within 8 m of Dwelling	Evacuated	544	BLACK	Severe Lateral Spreading
	Evacuated - Imminent Risk		RED	Significant Lateral spreading &/or severe settlement of dwelling
	Inundated			
	Inundated - Imminent Risk			
on or supporting accessway	Evacuated	20	ORANGE	Evidence of Liquefaction (sand on surface)
	Evacuated - Imminent Risk		GREEN	Cracks in Ground no Sand
	Inundated		BLUE	No Land Damage
	Inundated - Imminent Risk			
	Non EQC Area:	24		

544 x \$30 = 16,320

Blind 11/4/11

I SCANNED SCANNED

LAND REMEDIAL OPTION & COST (Refer Site Plan and Cross Section)					
Land Remedial option	Drainage	Retaining Wall	Pallisade Wall	Soil Nail/Rock Bolt	Earthworks
	Debris Wall/Catch Fence	Other	Combination of Above		
Estimated Land Remedial Cost	\$0	<\$10k	\$10k - \$50k	\$50k - \$100k	\$100k - \$250k
	\$250k - \$500k	\$500k - \$1M	> \$1M	To Be Determined	



DWELLING DESCRIPTION (Refer Site Plan and Cross Section)	
General :	
(not generally req'd)	

BUILDING DAMAGE - GENERAL					
Has the building been Damaged?	YES	NO			
Is the Dwelling at Imminent Risk?	YES	NO			
Estimated Remedial Value?	\$0	<\$10k	\$10k - \$25k	\$25k - \$50k	\$50k - \$75k
	\$75k - \$100k	>\$100k			
Have any Appurtenant structures been damaged?		YES	NO		
Are any appurtenant structures at Imminent Risk?		YES	NO	(Does not include Patios/Paving)	
Have any services within 60 m of dwelling been damaged?		YES	NO		
Are any services within 60 m of dwelling at Imminent Risk?		YES	NO		

DAMAGED DWELLING, APPURTENANT STRUCTURES, & SERVICES (Refer Site Plan and Cross Section)					
Dwelling : features damaged :	None	external walls	internal walls	ceiling	door/window frames
	window glass	steps	foundation/slab	roof	chimney
	other				
Type of damage to Dwelling:	cracks (walls)	cracks (ceiling)	cracks (window glass)	cracks (chimney)	floor sloping
	racking/sagging	walls etc out of vertical	crack in slab	crack in footing	other
Appurtenant structure(s) damaged :	None	garage/shed	carport	deck	tanks
What services have been damaged?	water	sewer	drainage	gas	electrical
	telephone	service structures	Don't Know	other	None

GENERAL :	

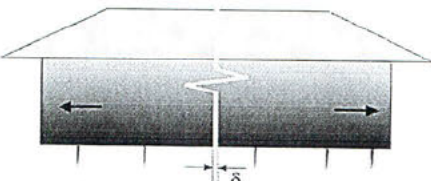
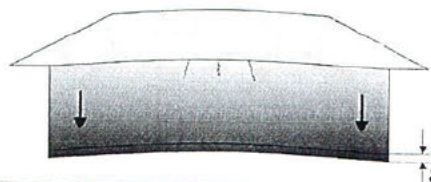
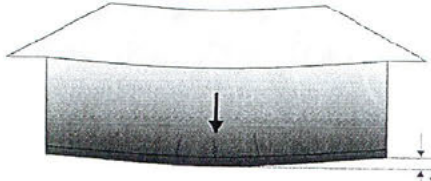
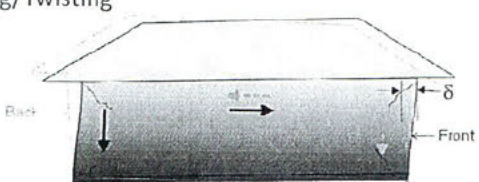
Floors and Foundations	Roof Cladding	Wall Cladding
Timber floor on piles	✓ Light: Iron roof	Light: weatherboard/plywood/stucco etc
✓ Timber on internal piles with perimeter concrete footing	✓ Heavy: concrete tiles/clay tiles/slate etc	✓ Heavy: brick veneer/stone/solid plaster
Concrete slab on grade		

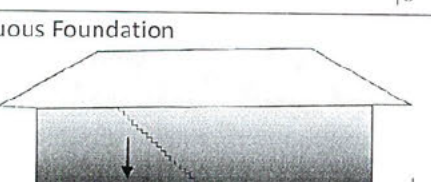
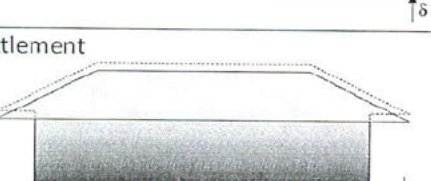
Type of Damage	Severity		
	Minor	Moderate	Major
Stretching 	0 to 5mm	5 to 30mm	>30mm
Hogging 	0 to 20mm	20 to 50mm	>50mm
Dishing 	0 to 20mm	20 to 50mm	>50mm
Racking/Twisting 	0 to 10mm	✓ 10 to 30mm	>30mm
Tilting 	✓ 0 to 20mm	20 to 50mm	>50mm
Discontinuous Foundation 	0 to 10mm	10 to 20mm	>20mm
Global Settlement 	0 to 50mm	50 to 100mm	>100mm

2010/101998

EQC Canterbury Earthquake Land Damage Assessment

9 Gore Street, Halswell



⊗ = NON EQC AREA

⊕ = ACCESS AREA



JASON PALMADA
9 GORE STREET
HALSWELL
CHRISTCHURCH
H: & W:
M:

Geoff Dalgleish
17-05-013

Land Area
588 m²
Whole Site
Within EQC
Cover

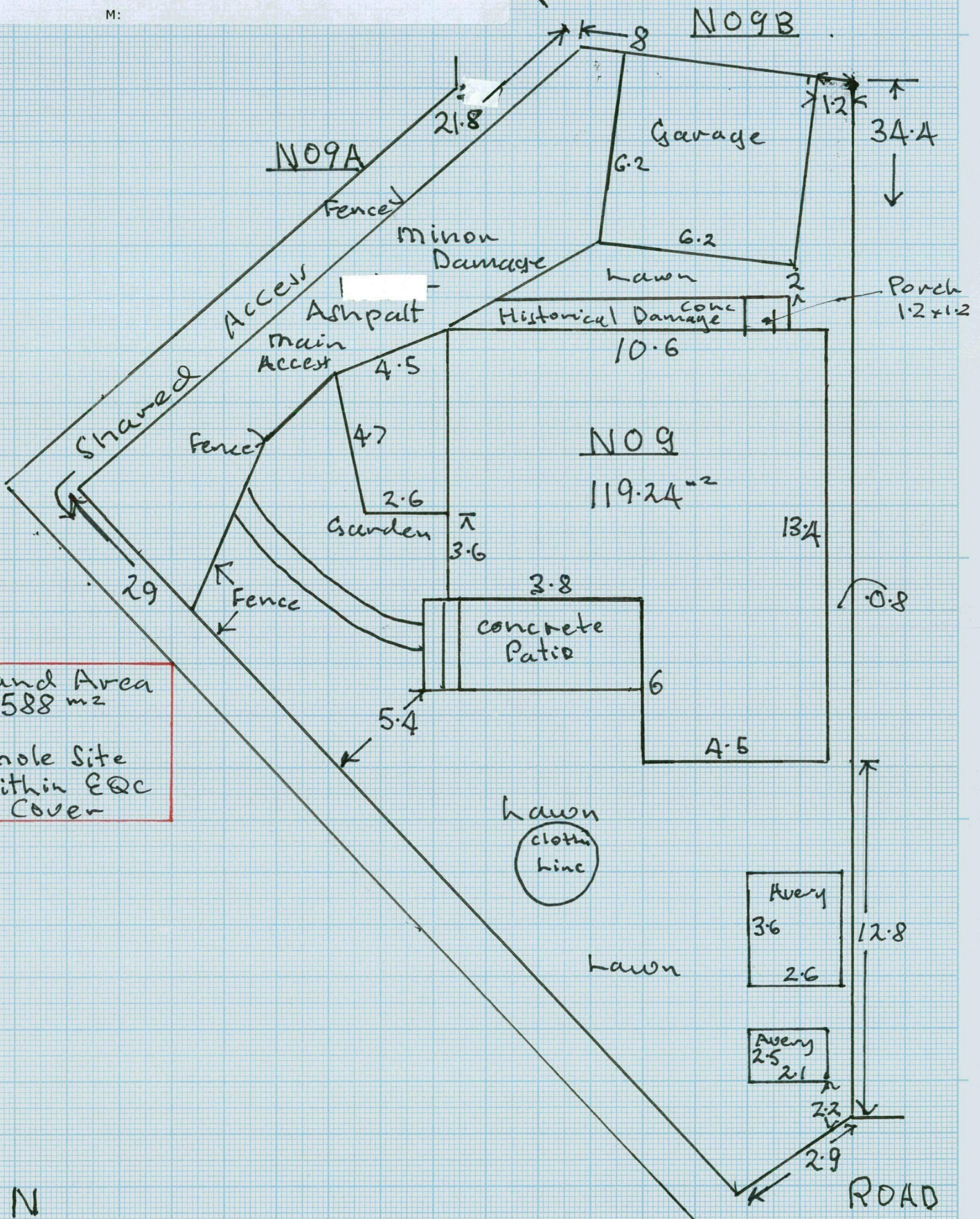

CHECKED

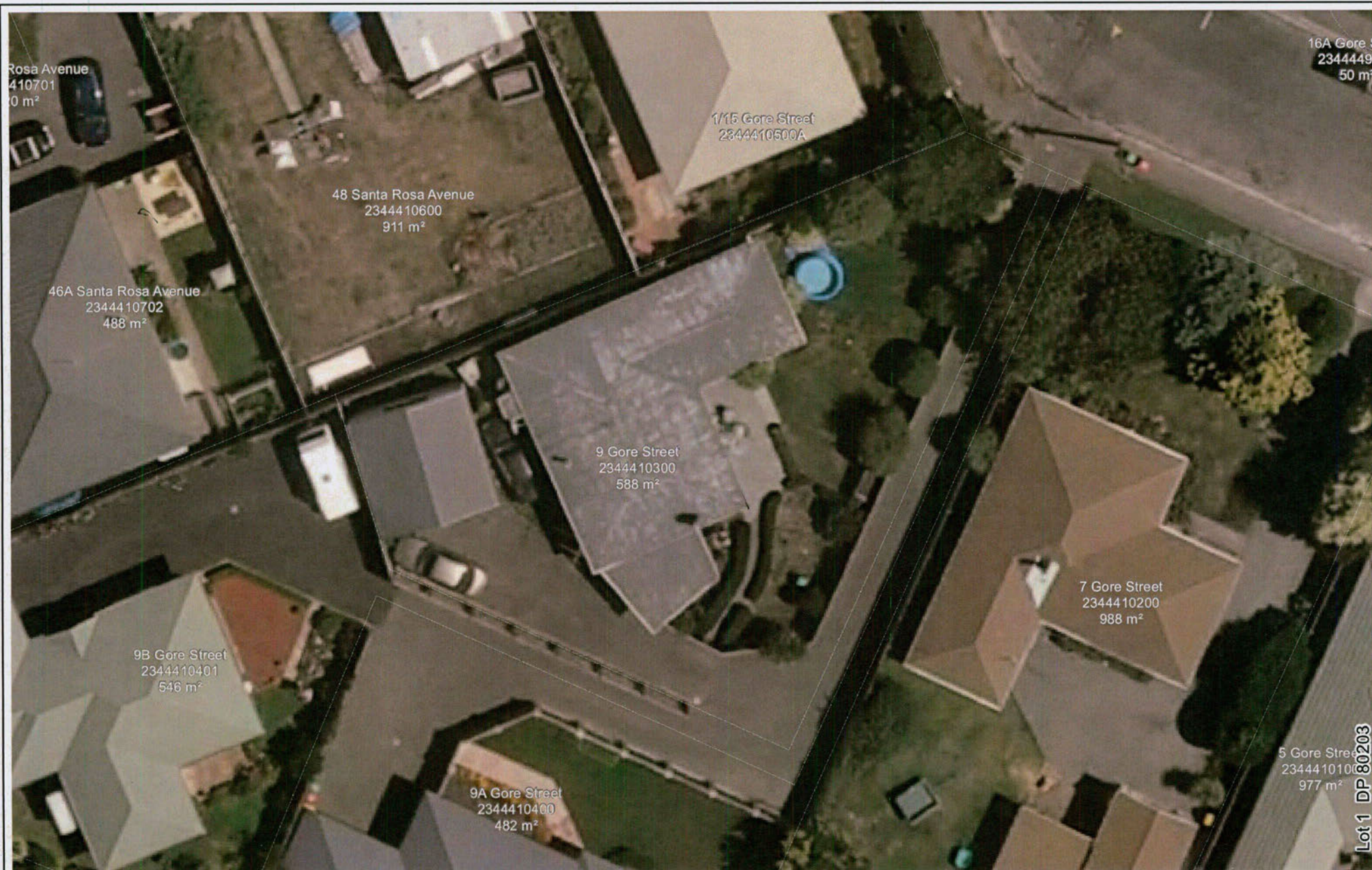

Path: L:\52000\Working\Material\GIS\MapDoc_Field_AKLC\CHC-C049_Oaklands.mxd Date: 18/02/2011 Time: 2:02:25 p.m.

Notes:



Drawn by:

Date:



22 FEB 2011 - EARTHQUAKE
 OAKLANDS, CHRISTCHURCH
 (C049-055862) - 9 Gore Street

EQC Claim No: 201 _ /

Lot 1 DP 80203

inspection Summary



Completed by: Leo Down

Date: 17/05/13 Page: 1 of 1
dd/mm/yy

CLM / 2010 / 101998
 JASON PALMADA
 9 GORE STREET
 HALSWELL
 CHRISTCHURCH
 H: & W:
 M:

Time arrived at site: 09:30 Time left site: 10:10 Was an inspection carried out? Yes No

Customer present: Yes No Customer Name: TENANT (STACEY) APPROVAL FROM JASON PALMADA

Access denied Loose dogs Other If other, please provide reason

If No inspection carried out, why not?

Where an inspection has been conducted:

	Yes	No	Notes
- Any land damage under the main access way or other hard surfaces?	<input type="checkbox"/>	<input checked="" type="checkbox"/>	
- Were any bridges or culverts damaged within EQC Cover?	<input type="checkbox"/>	<input checked="" type="checkbox"/>	
- Were any retaining walls damaged within EQC Cover?	<input type="checkbox"/>	<input checked="" type="checkbox"/>	
- Is an engineer required?	<input type="checkbox"/>	<input checked="" type="checkbox"/>	
- Is a valuation required?	<input type="checkbox"/>	<input checked="" type="checkbox"/>	
- Is a resource consent required for any remediation work? (proximity to protected trees and waterways)	<input type="checkbox"/>	<input checked="" type="checkbox"/>	
- Has anything in this pack been escalated?	<input type="checkbox"/>	<input checked="" type="checkbox"/>	
- Customer has advised of invoices for emergency work?	<input type="checkbox"/>	<input checked="" type="checkbox"/>	
- Customer advised of next action?	<input checked="" type="checkbox"/>	<input type="checkbox"/>	<u>Monitor Jason - confirm no land damage</u> <u>LETTER WILL FOLLOW FROM EQC</u>
- Was any silt found under the dwelling?	<input type="checkbox"/>	<input checked="" type="checkbox"/>	

- If there was nil damage, why was that? Building removed Building repairs have fixed No visible damage

- If a potential or actual 8/9 property, was the dwelling present? Building removed Building present

Land Damage to Area A? If Yes, add details

Yes No

Land Damage to Area B? If Yes, add details

Yes No

Land Damage to Area C? If Yes, add details

Yes No

Total m² of Damaged Land: NIL m² Notional Land Damage Value @\$300/m² (Incl GST): \$ —

Next action REFER SWANBY ACCESS ANALYSIS + RE-COSTING

CHECKED

