

# GRIFFIOEN.

## LAND INFORMATION MEMORANDUM

Statement of Passing Over: This building inspection has been supplied by the vendor in good faith. GRIFFIOEN. (Powered by Ownly Limited, Licensed REAA 2008) is merely passing over this information as supplied to us.

We cannot guarantee its accuracy as we have not checked, audited, or reviewed the information and all intending purchasers are advised to seek your own advice as to the information contained in this document.

Please note this LIM report is provided for informational purposes only. There may be matters relating to pre-1992 consents or permits which may need further investigation in order to determine their relevance.

To the maximum extent permitted by law we do not accept any responsibility to any party for the accuracy or use of the information herein.

# Land Information Memorandum



Property address:

9 Gore Street

LIM number: H09543484

Page 1

**Christchurch City Council**

53 Hereford Street, PO Box 73015

Christchurch 8154, New Zealand

Tel 64 3 941 8999

Fax 64 3 941 8984

[www.ccc.govt.nz](http://www.ccc.govt.nz)

## Application details

**Date issued** 26 March 2026  
**Date received** 17 March 2026

## Property details

**Property address** 9 Gore Street, Oaklands, Christchurch  
**Valuation roll number** 23444 10300  
**Valuation information** Capital Value: \$690,000  
Land Value: \$350,000  
Improvements Value: \$340,000  
*Please note: these values are intended for Rating purposes*  
**Legal description** Lot 1 DP 80203  
**Existing owner** Adrian Philip Taylor  
Lucy Erin Taylor  
9 Gore Street  
Christchurch 8025

## Council references

**Rate account ID** 73059363  
**LIM number** H09543484  
**Property ID** 1024087

Property address:

9 Gore Street

LIM number: H09543484

Page 2

**Christchurch City Council**  
53 Hereford Street, PO Box 73015  
Christchurch 8154, New Zealand  
Tel 64 3 941 8999  
Fax 64 3 941 8984

[www.ccc.govt.nz](http://www.ccc.govt.nz)

## Document information

This Land Information Memorandum (LIM) has been prepared for the purpose of section 44A of the Local Government Official Information and Meetings Act 1987 (LGOIMA). It is a summary of the information that we hold on the property. Each heading or "clause" in this LIM corresponds to a part of section 44A.

Sections 1 to 10 contain all of the information known to the Christchurch City Council that must be included under section 44A(2) LGOIMA. Any other information concerning the land as the Council considers, at its discretion, to be relevant is included at section 11 of this LIM (section 44A(3) LGOIMA). If there are no comments or information provided in these sections this means that the Council does not hold information on the property that corresponds to that part of section 44A.

The information included in this LIM is based on a search of Council records only and there may be other information relating to the land which is unknown to the Council. Please note that other agencies may also hold information relevant to the property, or administer legislation relevant to the use of the land, for example, the Regional Council (Ecan), Heritage New Zealand Pouhere Taonga, and Land Information New Zealand.

Council records may not show illegal or unauthorised building or works on the property. The applicant is solely responsible for ensuring that the land is suitable for a particular purpose.

A LIM is only valid at the date of issue as information is based only upon information the Council held at the time of that LIM request being made. It is essential that the applicant undertakes their own due diligence to verify the suitability of the property for their intended use.

**To enable the Council to measure the accuracy of this LIM document based on our current records, we would appreciate your response should you find any information contained therein which may be considered to be incorrect or omitted. Please telephone the Customer Call Centre on (03) 941 8999.**

Property address:

9 Gore Street

LIM number: H09543484

Page 3

**Christchurch City Council**

53 Hereford Street, PO Box 73015  
Christchurch 8154, New Zealand  
Tel 64 3 941 8999  
Fax 64 3 941 8984

[www.ccc.govt.nz](http://www.ccc.govt.nz)

A search of records held by the Council has revealed the following information:

## 1. Special features and characteristics of the land

*Section 44(A)(2)(aa) LGOIMA. This is information known to the Council but is not apparent from a district plan under the Resource Management Act 1991. It identifies each (if any) special feature or characteristic of the land concerned, including but not limited to the likely presence of hazardous contaminants.*

 For enquiries, please phone (03) 941 8999 or visit [www.ccc.govt.nz](http://www.ccc.govt.nz).

### Natural Hazards

*Section 44A(2)(a) LGOIMA. This is information known to the Council about natural hazards that is required by section 44B LGOIMA.*

Council's information has primarily been obtained from external specialists with the technical expertise to carry out research, investigation or analysis. Under the Local Government (Natural Hazard Information in Land Information Memoranda) Regulations 2025, the Council isn't required to:

- prepare a risk assessment of the land concerned.
- undertake any further analysis relating to the land.
- conduct additional searches or inquiries about the existence of natural hazard information.

It is the LIM recipient's responsibility to seek qualified advice about any identified natural hazard and/or the suitability of the land for its intended purpose.

*This section may also include natural hazard information provided by Environment Canterbury. Christchurch City Council is required to include such information in LIMs where Environment Canterbury considers it meets the criteria under section 44C of LGOIMA.*

*The following statement has been provided by Environment Canterbury:*

This Land Information Memorandum includes natural hazard information deemed by Environment Canterbury to be the most up to date, useful, and relevant, and is provided in accordance with the Local Government (Natural Hazard Information in Land Information Memoranda) Regulations 2025. All due care has been taken to ensure current information required to be provided under the regulations is presented below.

Environment Canterbury may hold superseded or less reliable natural hazards information relating to the land that has not been included in this Land Information Memorandum. Please contact Environment Canterbury if you would like to enquire about this information.

#### (a) Coastal Hazards

- Regional Hazard Information: Shoreline Modelling

Future shoreline modelling has not been completed for this area, however given the distance of the property from the coast, it will not be susceptible to coastal erosion for at least the next 100 years.

Property address:

9 Gore Street

LIM number: H09543484

Page 4

**Christchurch City Council**

53 Hereford Street, PO Box 73015  
Christchurch 8154, New Zealand  
Tel 64 3 941 8999  
Fax 64 3 941 8984

[www.ccc.govt.nz](http://www.ccc.govt.nz)

## (b) Earthquakes

- Consultant Report Available

The Tonkin & Taylor Darfield earthquake 4 September 2010 geotechnical land damage assessment and reinstatement stage 1 report indicates areas of observed surface manifestations of liquefaction resulting from the earthquake. This property is within one of the identified areas. The report can be viewed online at <https://www.eqc.govt.nz/our-publications/darfield-earthquake-geotechnical-land-damage-assessment-reinstatement-stage-1>

Title of report: Tonkin & Taylor Darfield earthquake 4 September 2010 geotechnical land damage assessment and reinstatement stage 1.

Purpose of report: Identify the nature and cause of land damage associated with residential property following the 7.1 earthquake which occurred near Darfield on 4 September 2010.

Scope of report: Christchurch

Where or how to access the report: <https://www.naturalhazards.govt.nz/assets/Publications-Resources/Tonkin--Taylor-Darfield-EQ-4-Sept-10-report-Stage-1-report-v2.pdf>

Date of report: October 2010

Name of person/entity that commissioned report: Earthquake Commission

The name of person/entity that prepared the report: Tonkin & Taylor Ltd

- Liquefaction Assessment

Christchurch City Council holds indicative information about liquefaction hazards for Christchurch. Information, including an interactive web tool, can be found on the Council's website at [ccc.govt.nz/liquefaction](http://ccc.govt.nz/liquefaction)

Depending on the potential liquefaction hazard of an area that a property is in, the Council may require site-specific investigations before granting future subdivision or building consent for a property.

Title of report: Christchurch liquefaction vulnerability study

Purpose of report: To provide a district-wide liquefaction vulnerability assessment and to provide expected land performance for a range of potential future earthquake and groundwater scenarios. For use in land use planning, subdivision and building consenting

Scope of report: Christchurch urban area from the Waimakariri River mouth to Godley Head, and inland to the Selwyn District boundary

Where or how to access the report: <https://ccc.govt.nz/assets/Documents/Environment/Land/CCC-Liquefaction-ReportBody.pdf>

Date of report: July 2020

Name of person/entity that commissioned report: Christchurch City Council

Name of person/entity that prepared the report: Tonkin & Taylor Ltd

Title of Report: Geotechnical information on horizontal land movement due to the Canterbury earthquake sequence

Purpose of report: Background geotechnical information about shallow ground movements as a result of the earthquake sequence

Scope of Report: Christchurch City flat area, excluding Port Hills and Banks Peninsula

Where or how to access the report: <https://www.linz.govt.nz/resources/research/geotechnical-information-horizontal-land-movement-due-canterbury-earthquake-sequence>

Date of report: March 2015

Name of person/entity that commissioned report: Land Information New Zealand

The name of person/entity that prepared the report: Tonkin & Taylor Ltd

Property address:

9 Gore Street

LIM number: H09543484

Page 5

**Christchurch City Council**

53 Hereford Street, PO Box 73015

Christchurch 8154, New Zealand

Tel 64 3 941 8999

Fax 64 3 941 8984

[www.ccc.govt.nz](http://www.ccc.govt.nz)

- Regional Liquefaction Information

Areas where there was evidence of liquefaction were mapped following the 2010/11 Canterbury earthquakes by Tonkin & Taylor for the Earthquake Commission (urban areas) and by a group of researchers for Environment Canterbury (rural, commercial and industrial areas). These are available in the Christchurch Liquefaction Viewer at <https://apps.canterburymaps.govt.nz/ChristchurchLiquefactionViewer/>.

Technical report information:

Title: Review of liquefaction hazard information in eastern Canterbury, including Christchurch City and parts of Selwyn, Waimakariri and Hurunui Districts.

Date: December 2012.

Author: H Brackley (compiler).

Commissioned by: Environment Canterbury.

Purpose of report: To collate liquefaction occurrence during the 2010/11 Canterbury earthquakes, and to determine liquefaction vulnerability. For use in land use planning, subdivision and building consenting.

Study area: Coastal Canterbury from the Waipara River mouth to the Rakaia River mouth, including Banks Peninsula, and inland to Rangiora, Aylesbury, Selwyn and Southbridge.

Accessible at: <https://www.ecan.govt.nz/document/download?uri=1702192>.

- Regional Hazard Information: Earthquake fault deformation

There are no known earthquake faults at the ground surface in Christchurch. However, it is possible there are some faults in Christchurch that are yet to be identified because they are not visible at the ground surface.

More information on fault deformation is available on Environment Canterbury's fault deformation map at

<https://mapviewer.canterburymaps.govt.nz/?webmap=b5f859bd18ee4912828cb092bef6c449>.

### (c) Flooding

- Regional Hazard Information: Selwyn Modelling

The property, or part of the property, is within an area where detailed floodplain modelling has been carried out by Selwyn District Council and overlaps the Christchurch District Boundary. Model results are available on Environment Canterbury's flood model results webapp at

<https://apps.canterburymaps.govt.nz/FloodModelResults/>.

Title: Selwyn District Flood Model - Hydraulic Model Build Report

Date: August 2025

Author: Tonkin & Taylor Ltd

Commissioned by: Selwyn District Council

Purpose of report: To quantify the extent and severity of flooding in the Selwyn District. For use in land use planning.

Study area: Selwyn District plains

Accessible at: [https://www.selwyn.govt.nz/services/civil-defence-And-emergency-management/documents/2025.08.28.SDCFloodModel\\_ModelBuildReport.vA\\_Final.pdf](https://www.selwyn.govt.nz/services/civil-defence-And-emergency-management/documents/2025.08.28.SDCFloodModel_ModelBuildReport.vA_Final.pdf)

- Regional Hazard Information: Flood Photographs

Photographs showing the property during or following past flood events may be available. Flood photographs are available on Environment Canterbury's flood imagery register at <https://apps.canterburymaps.govt.nz/FIR>.

- Regional Hazard Information: Site Specific Flood Assessment

A site specific flood hazard assessment may have been completed for the property by Environment Canterbury. The information contained in this assessment may now be outdated. Please contact Environment Canterbury if you would like to request a copy.

- Regional Hazard Information: Flood Assessment Request

You can request a new site-specific flood hazard assessment for the property from Environment Canterbury at: <https://www.ecan.govt.nz/do-it-online/property-information/flood-hazard-assessments>.

### (d) Landslides

As at the date of this LIM, Council research found no information under this heading.

Property address:

9 Gore Street

LIM number: H09543484

Page 6

Christchurch City Council

53 Hereford Street, PO Box 73015

Christchurch 8154, New Zealand

Tel 64 3 941 8999

Fax 64 3 941 8984

[www.ccc.govt.nz](http://www.ccc.govt.nz)

## (e) Subsidence

- Consultant Report Available

Land Information New Zealand (LINZ) engaged Tonkin and Taylor to provide a Geotechnical Report on Ground Movements that occurred as a result of the Canterbury Earthquake Sequence. The report indicates this property may have been effected by a degree of earthquake induced subsidence. The report obtained by LINZ can be accessed on their website at <https://www.linz.govt.nz> and search Information for Canterbury Surveyors.

## (f) Tsunamis

As at the date of this LIM, Council research found no information under this heading.

## (g) Volcanic and Geothermal Hazards

As at the date of this LIM, Council research found no information under this heading.

## (h) Wind

As at the date of this LIM, Council research found no information under this heading.

## (i) Any Other Natural Hazards

As at the date of this LIM, Council research found no information under this heading.

## (j) District Plan Natural Hazard Information

Please refer to *Section 8. Land use and conditions* of this report for District Plan related natural hazard information.

## (k) Building Notices

Please refer to *Section 5. Consents, certificates, notices, orders, or requisitions affecting the land and buildings* of this report for Building Act notice information.

## Other Special Features or Characteristics of the Land

As at the date of this LIM, Council research found no information under this heading.

## Related Information

- This property was previously served by a septic tank prior to connection to the Council network, it is unknown if the tank remains on site. Please see attached site plan for approximate location.

## 2. Private and public stormwater and sewerage drains

Section 44A(2)(b) LGOIMA. This is information about private and public stormwater and sewerage drains as shown in the Council's records.

 For stormwater and sewerage enquiries, please phone (03) 941 8999 or visit [www.ccc.govt.nz](http://www.ccc.govt.nz).

### Related Information

- This property is shown to be served by Christchurch City Council sewer and stormwater.
- Attached are all drainage plans that Council hold for details of private and public drainage. Not all plans provided are verified by Council, and therefore Council cannot be liable for inaccuracies. Site investigation will be required by owners to determine exact layouts.

Property address:

9 Gore Street

LIM number: H09543484

Page 8

**Christchurch City Council**

53 Hereford Street, PO Box 73015  
Christchurch 8154, New Zealand  
Tel 64 3 941 8999  
Fax 64 3 941 8984

[www.ccc.govt.nz](http://www.ccc.govt.nz)

## 3. Drinking Water Supply

*Section 44A(2)(ba) and (bb) LGOIMA. This is information notified to the Council about whether the land is supplied with drinking water, whether the supplier is the owner of the land or a networked supplier, any conditions that are applicable, and any information the Council has about the supply.*

Please note the council does not guarantee a particular water quality to its customers. If you require information on current water quality at this property please contact the Three Waters & Waste Unit.

 For water supply queries, please phone (03) 941 8999 or visit [www.ccc.govt.nz](http://www.ccc.govt.nz).

### Water supply

Christchurch City Council is the networked supplier of water to this property. This property is connected to the Christchurch City Council Water Supply. The conditions of supply are set out in the Christchurch City Council Water Supply and Wastewater Bylaw (2022), refer to [www.ccc.govt.nz](http://www.ccc.govt.nz).

Property address:

9 Gore Street

LIM number: H09543484

Page 9

**Christchurch City Council**

53 Hereford Street, PO Box 73015

Christchurch 8154, New Zealand

Tel 64 3 941 8999

Fax 64 3 941 8984

[www.ccc.govt.nz](http://www.ccc.govt.nz)

## 4. Rates

Section 44A(2)(c) LGOIMA. This is information on any rates owing in relation to the land.

☎ For rates enquiries, please phone (03) 941 8999 or visit [www.ccc.govt.nz](http://www.ccc.govt.nz).

### (a) Annual rates

Annual rates to 30/06/2026: \$4,206.38

	Instalment Amount	Date Due
Instalment 1	\$1,051.55	31/08/2025
Instalment 2	\$1,051.55	30/11/2025
Instalment 3	\$1,051.55	28/02/2026
Instalment 4	\$1,051.73	31/05/2026

Rates owing as at 26/03/2026: \$2,313.44

### (b) Excess Water Rates

For excess water charge enquiries, please phone (03) 941 8999 or visit [www.ccc.govt.nz/contact-us](http://www.ccc.govt.nz/contact-us).

### (c) Final water meter reading required at settlement?

Property settlements must ensure all water usage and outstanding debts are accurately accounted for.

To advise of a property settlement, please complete the request for settlement information form at [www.ccc.govt.nz/services/rates-and-valuations/solicitors-request](http://www.ccc.govt.nz/services/rates-and-valuations/solicitors-request).

A settlement statement of accounts will be provided on the expected settlement date advised.

Property address:

9 Gore Street

LIM number: H09543484

Page 10

**Christchurch City Council**  
53 Hereford Street, PO Box 73015  
Christchurch 8154, New Zealand  
Tel 64 3 941 8999  
Fax 64 3 941 8984

[www.ccc.govt.nz](http://www.ccc.govt.nz)

## 5. Consents, certificates, notices, orders, or requisitions affecting the land and buildings

*Section 44A(2)(d) LGOIMA. This is information concerning any consent, certificate, notice, order, or requisition, affecting the land or any building on the land, previously issued by the Council. The information in this section may also cover building consent and/or code compliance information issued by building certifiers under the Building Act 1991 and building consent authorities that are not the Council under the Building Act 2004.*

You can check the property file to identify whether any consent or certificate was issued by a building certifier under the Building Act 1991.

*Section 44A(2)(da) LGOIMA. The information required to be provided to a territorial authority under section 362T(2) of the Building Act 2004. There is currently no information required to be provided by a building contractor to a territorial authority under section 362T(2) of the Building Act 2004. The Building (Residential Consumer Rights and Remedies) Regulations 2014 only prescribed the information that must be given to the clients of a building contractor.*

*Sections 71 to 74 of the Building Act 2004 require the Building Consent Authority to consider natural hazards when it receives a building consent application for the construction or major alteration of a building on land that is subject to, or likely to be subject to, a natural hazard. A building consent for this property may have been issued subject to a section 72 or 73 notice. This means at the time of building consent the Building Consent Authority was not satisfied that adequate provision would be made to protect the building and land from the natural hazard and was subsequently required to notify the Registrar-General of Land to record the natural hazard on the Record of Title. The Building Act 2004 defines natural hazards as erosion (including coastal erosion, bank erosion, and sheet erosion), falling debris (including soil, rock, snow, and ice), subsidence, inundation (including flooding, overland flow, storm surge, tidal effects, and ponding), and slippage.*

*If your property contains a notice under s73 of the Building Act 2004, this will be identified on the building consent decision below (decision under s72 of the Building Act 2004) and on the properties' Record of Title. The Record of Title may also record this as a s36 notice under the Building Act 1991, or a s641A notice under the Local Government Act 1974.*

 For building enquiries, please phone (03) 941 8999, email [EPADutyBCO@ccc.govt.nz](mailto:EPADutyBCO@ccc.govt.nz) or visit [www.ccc.govt.nz](http://www.ccc.govt.nz).

### (a) Consents

- BCN/1966/6729 Applied: 23/11/1966 Status: Completed  
9 Gore Street Oaklands  
Permit granted 23/11/1966  
Permit issued 23/11/1966  
SHED- Historical Reference PER66079052
- BCN/1966/6937 Applied: 06/12/1966 Status: Completed  
9 Gore Street Oaklands  
Permit granted 06/12/1966  
Permit issued 06/12/1966  
GLASSHOUSE- Historical Reference PER66079057 No information/plans held on property file
- BCN/1970/2121 Applied: 27/04/1970 Status: Completed  
9 Gore Street Oaklands  
Permit granted 06/05/1970  
Permit issued 06/05/1970  
GLASSHOUSE- Historical Reference PER70112459 No information/plans held on property file
- BCN/1973/399 Applied: 25/01/1973 Status: Completed  
9 Gore Street Oaklands  
Permit granted 02/02/1973  
Permit issued 02/02/1973  
GLASSHOUSE- Historical Reference PER72115448

Property address:

9 Gore Street

LIM number: H09543484

Page 11

**Christchurch City Council**

53 Hereford Street, PO Box 73015  
Christchurch 8154, New Zealand  
Tel 64 3 941 8999  
Fax 64 3 941 8984

[www.ccc.govt.nz](http://www.ccc.govt.nz)

- BCN/1978/832 Applied: 01/03/1978 Status: Completed  
9 Gore Street Oaklands  
Permit granted 13/03/1978  
Permit issued 13/03/1978  
ADDITION TO DWELLING - SUNPORCH- Historical Reference PER78122523
- BCN/1998/8157 Applied: 11/11/1998 Status: Completed  
9B Gore Street Oaklands  
Accepted for processing 11/11/1998  
Building consent granted 09/12/1998  
Building consent issued 14/12/1998  
Code Compliance Certificate Granted 09/04/1999  
Code Compliance Certificate Issued 09/04/1999  
DWELLING WITH ATTACHED GARAGE (9B GORE) & DETACHED GARAGE (9 GORE)- Historical Reference CON98009022

## (b) Certificates

Note: Code Compliance Certificates were only issued by the Christchurch City Council since January 1993.

## (c) Notices

## (d) Orders

## (e) Requisitions

Property address:

9 Gore Street

LIM number: H09543484

Page 12

**Christchurch City Council**  
53 Hereford Street, PO Box 73015  
Christchurch 8154, New Zealand  
Tel 64 3 941 8999  
Fax 64 3 941 8984

[www.ccc.govt.nz](http://www.ccc.govt.nz)

## 6. Certificates issued by a building certifier

Section 44A(2)(e) LGOIMA. This is information notified to the Council concerning any certificate issued by a building certifier pursuant to the Building Act 1991 or the Building Act 2004.

☎ For building enquiries, please phone (03) 941 8999, email [EPADutyBCO@ccc.govt.nz](mailto:EPADutyBCO@ccc.govt.nz) or visit [www.ccc.govt.nz](http://www.ccc.govt.nz).

Property address:

9 Gore Street

LIM number: H09543484

Page 13

**Christchurch City Council**

53 Hereford Street, PO Box 73015  
Christchurch 8154, New Zealand  
Tel 64 3 941 8999  
Fax 64 3 941 8984

[www.ccc.govt.nz](http://www.ccc.govt.nz)

## 7. Weathertightness

*Section 44A(2)(ea) LGOIMA. This is information notified to the Council under section 124 of the Weathertight Homes Resolution Services Act 2006.*

 For weathertight homes enquiries, please phone (03) 941 8999 or visit [www.ccc.govt.nz](http://www.ccc.govt.nz).

*If there is no information below this means Council is unaware of any formal Weathertight Homes Resolution Services claim lodged against this property.*

Property address:

9 Gore Street

LIM number: H09543484

Page 14

**Christchurch City Council**

53 Hereford Street, PO Box 73015  
Christchurch 8154, New Zealand  
Tel 64 3 941 8999  
Fax 64 3 941 8984

[www.ccc.govt.nz](http://www.ccc.govt.nz)

## 8. Land use and conditions

Section 44A(2)(f) LGOIMA. This is information relating to the use to which the land may be put and conditions attached to that use. The planning information provided below is not exhaustive and reference to the Christchurch District Plan and any notified proposed changes to that plan is recommended: <https://ccc.govt.nz/the-council/plans-strategies-policies-and-bylaws/plans/christchurch-district-plan/>.

There may be some provisions of the Christchurch City Plan or Banks Peninsula District Plan that affect this property that are still operative.

☎ For planning queries, please phone (03) 941 8999, email [DutyPlanner@ccc.govt.nz](mailto:DutyPlanner@ccc.govt.nz) or visit [www.ccc.govt.nz](http://www.ccc.govt.nz).

- **Regional plan or bylaw**

There may be objectives, policies or rules in a regional plan or a regional bylaw that regulate land use and activities on this site. Please direct enquiries to Canterbury Regional Council (Environment Canterbury).

### (a)(i) Christchurch City Plan & Banks Peninsula District Plan

#### (ii) Christchurch District Plan

- **Liquefaction Management Area (LMA)**

Property or part of property within the Liquefaction Management Area (LMA) Overlay, which is operative.

- **District Plan Zone**

Property or part of property within the Residential Suburban Zone, which is operative.

### (b) Resource consents

If there are any land use resource consents issued for this property the Council recommends that you check those resource consents on the property file. There may be conditions attached to those resource consents for the property that are still required to be complied with.

- RMA/1998/3380 - Subdivision Consent

Fee Simple SUBDIVISION 223 received 26/1/00 Certified 29/1/99 224 requested 8/11/00 Issued 9/11/00 DP 80203 - Historical Reference RMA13357

Status: Processing complete

Applied 23/12/1998

Granted 25/01/1999

Decision issued 25/01/1999

Property address:

9 Gore Street

LIM number: H09543484

Page 15

**Christchurch City Council**

53 Hereford Street, PO Box 73015

Christchurch 8154, New Zealand

Tel 64 3 941 8999

Fax 64 3 941 8984

[www.ccc.govt.nz](http://www.ccc.govt.nz)

## 9. Other land and building classifications

Section 44A(2)(g) LGOIMA. This is information notified to the Council by any statutory organisation having the power to classify land or buildings for any purpose.

 For land and building enquiries, please phone (03) 941 8999 or visit [www.ccc.govt.nz](http://www.ccc.govt.nz).

Please refer to Section 1 for details

Property address:

9 Gore Street

LIM number: H09543484

Page 16

**Christchurch City Council**

53 Hereford Street, PO Box 73015  
Christchurch 8154, New Zealand  
Tel 64 3 941 8999  
Fax 64 3 941 8984

[www.ccc.govt.nz](http://www.ccc.govt.nz)

## 10. Network utility information

Section 44A(2)(h) LGOIMA. This is information notified to the Council by any network utility operator pursuant to the Building Act 1991 or the Building Act 2004.

 For network enquiries, please phone (03) 941 8999 or visit [www.ccc.govt.nz](http://www.ccc.govt.nz).

- **None recorded for this property**

Property address:

9 Gore Street

LIM number: H09543484

Page 17

**Christchurch City Council**

53 Hereford Street, PO Box 73015

Christchurch 8154, New Zealand

Tel 64 3 941 8999

Fax 64 3 941 8984

[www.ccc.govt.nz](http://www.ccc.govt.nz)

## 11. Other information

Section 44A(3) LGOIMA. This is information concerning the land that the Council has the discretion to include if it considers it to be relevant.

☎ For any enquiries, please phone (03) 941 8999 or visit [www.ccc.govt.nz](http://www.ccc.govt.nz).

### (a) Kerbside waste collection

- Your organics are collected Weekly on Thursday. Please leave your organics at the Kerbside by 6:00 a.m.
- Your recycling is collected Fortnightly on the Week 1 collection cycle on a Thursday. Please leave your recycling at the Kerbside by 6:00 a.m. Your nearest recycling depot is the Parkhouse Road EcoDrop.
- Your refuse is collected Fortnightly on the Week 1 collection cycle on a Thursday. Please leave your rubbish at the Kerbside by 6:00 a.m. Your nearest rubbish depot is the Parkhouse Road EcoDrop.

### (b) Other

#### • Floor Levels Information

Council holds a variety of information on requirements for building or property development. This includes:

- required minimum finished floor levels, which need to be set to meet the surface water requirements in clause E1.3.2 of the Building Code (where this applies); and
- the requirements of the Christchurch District Plan (where a property is in the Flood Management Area).

Where this information has been processed for your property, you can view it online at <https://ccc.govt.nz/flooding-and-floor-levels>.

Otherwise, if you are building or developing on this land, you can request a calculation on required finished floor levels for your proposed building by emailing us at [floorlevels@ccc.govt.nz](mailto:floorlevels@ccc.govt.nz).

#### • Guest Accommodation

Guest accommodation (including whole unit listings on Airbnb; BookaBach; etc.) generally requires a resource consent in this zone when the owner is not residing on the site. For more information, please refer to: <https://ccc.govt.nz/providing-guest-accommodation/>.

#### • Community Board

Property located in Halswell-Hornby-Riccarton Community Board.

#### • Tsunami Evacuation Zone

This property is not in a tsunami evacuation zone. It is not necessary to evacuate in a long or strong earthquake or during an official Civil Defence tsunami warning. Residents may wish to offer to open their home to family or friends who need to evacuate from a tsunami zone, and should plan with potential guests to do so in advance. More information can be found at <https://ccc.govt.nz/services/civil-defence/hazards/tsunami-evacuation-zones-and-routes/>

#### • Electoral Ward

Property located in Halswell Electoral Ward

#### • Listed Land Use Register

Hazardous activities and industries involve the use, storage or disposal of hazardous substances. These substances can sometimes contaminate the soil. Environment Canterbury identifies land that is used or has been used for hazardous activities and industries. This information is held on a publicly available database called the Listed Land Use Register (LLUR). The Christchurch City Council may not hold information that is held on the LLUR. Therefore, it is recommended that you check Environment Canterbury's online database at [www.llur.ecan.govt.nz](http://www.llur.ecan.govt.nz)

Property address:

9 Gore Street

LIM number: H09543484

Page 18

**Christchurch City Council**

53 Hereford Street, PO Box 73015

Christchurch 8154, New Zealand

Tel 64 3 941 8999

Fax 64 3 941 8984

[www.ccc.govt.nz](http://www.ccc.govt.nz)

- **Spatial Query Report**

A copy of the spatial query report is attached at the end of this LIM. The spatial query report lists land use resource consents that have been granted within 100 metres of this property.

## **Related Information**

- The Council has received a third party report relating to unverified building work on this property. It has been placed on the property file as a public record of work ONLY. The Council does not accept any liability for the contents, or representations, made within the report. The report is not included in the Land Information Memorandum (LIM) because the Council cannot verify the information in the report.

Property address:

9 Gore Street

LIM number: H09543484

Page 19

**Christchurch City Council**

53 Hereford Street, PO Box 73015

Christchurch 8154, New Zealand

Tel 64 3 941 8999

Fax 64 3 941 8984

[www.ccc.govt.nz](http://www.ccc.govt.nz)

# Halswell County Council

## DRAINAGE BLOCK PLAN

REFERENCES—B.T. means Buchan Trap  
 F.A.I. means Fresh Air Inlet  
 I.C. means Inspecting Chamber  
 I.P. means Inspecting Pipe  
 G.T. Means Gully Trap  
 M.V. means Main Vent  
 T.V. means Terminal Vent

SCALE: 8 FT. TO AN INCH

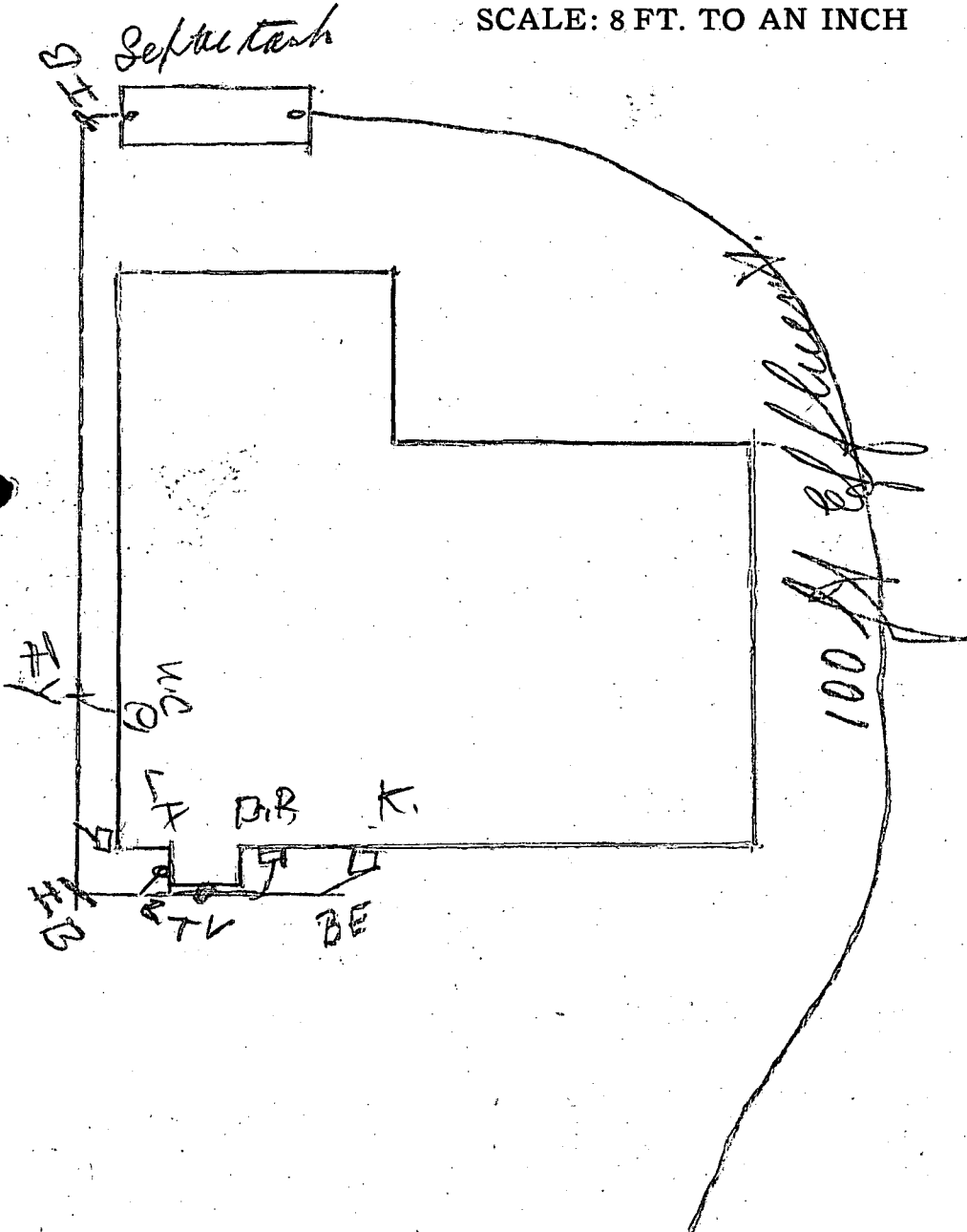

OWNER .....

PERMIT No. ....

RIDING .....

STREET and No. ....

VALUATION No. ....

DRAINLAYER .....

ADDRESS .....

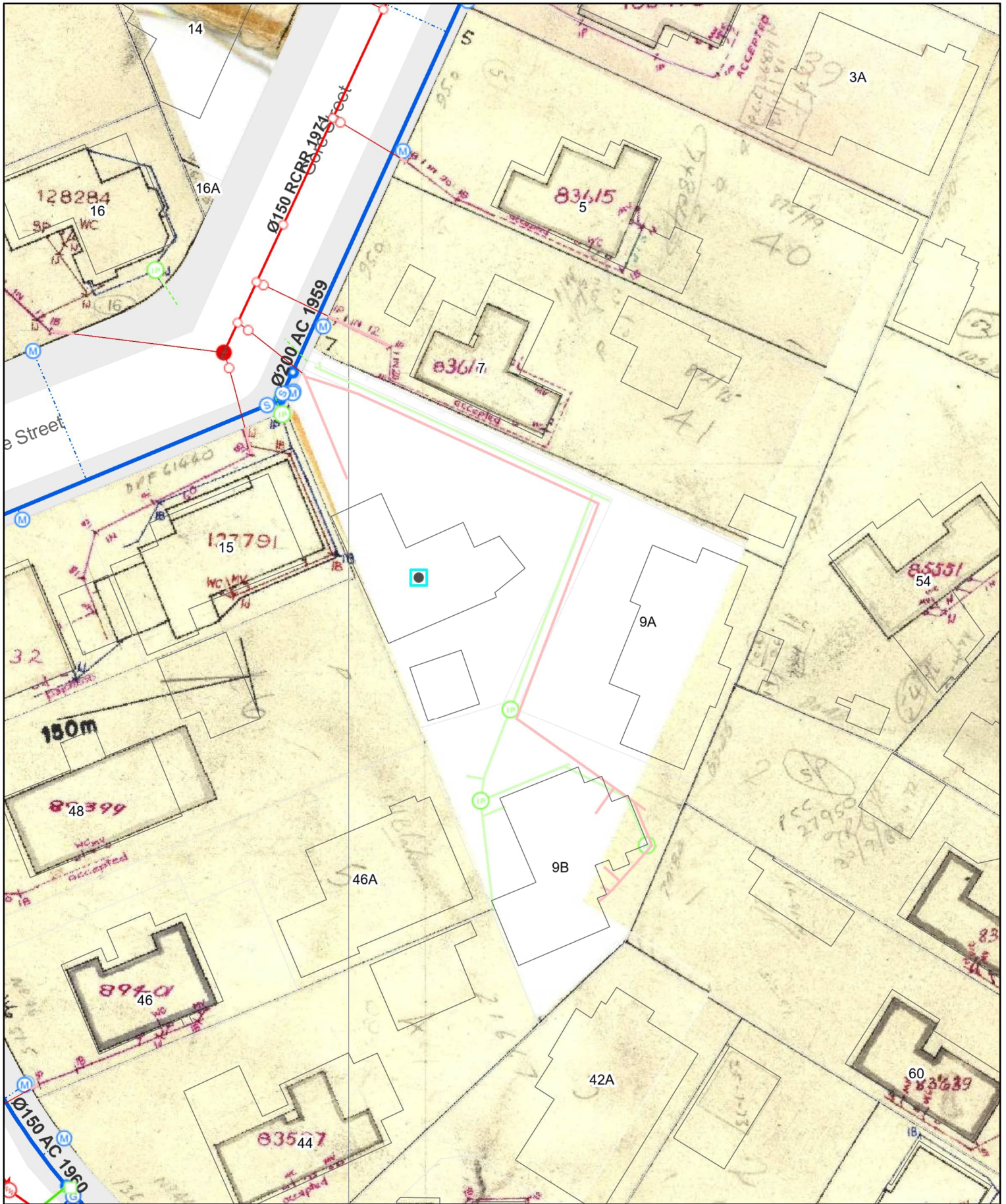

# Christchurch City Council



ph: 03 941 8999 web: ccc.govt.nz

Accuracy not guaranteed. Onsite verification required.  
Display of data scale dependant.  
Client selected legend.

Copyright © 2026 Reproduction prohibited.

N  
Date: 26/03/2026 7:31 AM  
Scale: 1: 500 on A4

0 0.0025 0.005 0.01 0.015 0.02

## ArcGIS Web Map

- |   |   |  |   |  |
|---|---|--|---|--|
| <ul style="list-style-type: none"> <li><span style="display: inline-block; width: 10px; height: 10px; border: 1px solid black; margin-right: 5px;"></span> Buildings</li> <li><span style="display: inline-block; width: 10px; height: 10px; border: 1px solid black; margin-right: 5px;"></span> StreetAddress</li> <li><b>WwAccess</b></li> <li><span style="display: inline-block; width: 10px; height: 10px; border: 1px solid black; border-radius: 50%; margin-right: 5px;"></span> Standard Manhole</li> <li><span style="display: inline-block; width: 10px; height: 10px; border: 1px solid black; border-radius: 50%; margin-right: 5px;"></span> Vented Manhole</li> <li><b>WwEye</b></li> <li><span style="display: inline-block; width: 10px; height: 10px; border: 1px solid black; border-radius: 50%; margin-right: 5px;"></span> Eye</li> <li><span style="display: inline-block; width: 10px; height: 10px; border: 1px solid black; border-radius: 50%; margin-right: 5px;"></span> Eye</li> <li><span style="display: inline-block; width: 10px; height: 10px; border: 1px solid black; border-radius: 50%; margin-right: 5px;"></span> Lateral Fitting</li> <li><span style="display: inline-block; width: 10px; height: 10px; border: 1px solid black; border-radius: 50%; margin-right: 5px;"></span> Lateral Fitting</li> </ul> | <ul style="list-style-type: none"> <li><span style="display: inline-block; width: 10px; height: 10px; border: 1px solid black; margin-right: 5px;"></span> WwPipeFlowDirection</li> <li><b>WwPipe</b></li> <li>NominalDiameter</li> <li><span style="display: inline-block; width: 10px; height: 10px; border: 1px solid black; margin-right: 5px;"></span> Diameter is 200mm or smaller</li> <li><span style="display: inline-block; width: 10px; height: 10px; border: 1px solid black; margin-right: 5px;"></span> WwLateral</li> <li>WwLateral (non CCC)</li> <li><span style="display: inline-block; width: 10px; height: 10px; border: 1px solid black; margin-right: 5px;"></span> In Service</li> <li><b>SwInlet</b></li> <li><span style="display: inline-block; width: 10px; height: 10px; border: 1px solid black; margin-right: 5px;"></span> Single Sump</li> <li><span style="display: inline-block; width: 10px; height: 10px; border: 1px solid black; margin-right: 5px;"></span> SwPipeFlowDirection</li> </ul> | <ul style="list-style-type: none"> <li><b>SwLateralFitting</b></li> <li><span style="display: inline-block; width: 10px; height: 10px; border: 1px solid black; border-radius: 50%; margin-right: 5px;"></span> Inspection Point</li> <li><b>SwPipe</b></li> <li>NominalDiameter</li> <li><span style="display: inline-block; width: 10px; height: 10px; border: 1px solid black; margin-right: 5px;"></span> Diameter is 450mm or smaller</li> <li><span style="display: inline-block; width: 10px; height: 10px; border: 1px solid black; margin-right: 5px;"></span> SwLateral</li> <li>SwLateral (non CCC)</li> <li><span style="display: inline-block; width: 10px; height: 10px; border: 1px solid black; margin-right: 5px;"></span> In Service</li> <li><span style="display: inline-block; width: 10px; height: 10px; border: 1px solid black; margin-right: 5px;"></span> SwLateral (non CCC)</li> <li><span style="display: inline-block; width: 10px; height: 10px; border: 1px solid black; margin-right: 5px;"></span> In Service</li> </ul> | <ul style="list-style-type: none"> <li><b>WsValve</b></li> <li><span style="display: inline-block; width: 10px; height: 10px; border: 1px solid black; border-radius: 50%; margin-right: 5px;"></span> Gate</li> <li><span style="display: inline-block; width: 10px; height: 10px; border: 1px solid black; border-radius: 50%; margin-right: 5px;"></span> Sluice</li> <li><span style="display: inline-block; width: 10px; height: 10px; border: 1px solid black; border-radius: 50%; margin-right: 5px;"></span> WsHydrant</li> <li><b>WsConnection</b></li> <li><span style="display: inline-block; width: 10px; height: 10px; border: 1px solid black; border-radius: 50%; margin-right: 5px;"></span> Meter</li> <li><b>WsFitting</b></li> <li><span style="display: inline-block; width: 10px; height: 10px; border: 1px solid black; border-radius: 50%; margin-right: 5px;"></span> Connector</li> <li><span style="display: inline-block; width: 10px; height: 10px; border: 1px solid black; border-radius: 50%; margin-right: 5px;"></span> Connector</li> </ul> | <ul style="list-style-type: none"> <li><b>WsPipe</b></li> <li>NominalDiameter</li> <li><span style="display: inline-block; width: 10px; height: 10px; border: 1px solid black; margin-right: 5px;"></span> Diameter is 110mm or smaller</li> <li><span style="display: inline-block; width: 10px; height: 10px; border: 1px solid black; margin-right: 5px;"></span> Diameter is greater than 110mm, up to 225mm</li> <li><span style="display: inline-block; width: 10px; height: 10px; border: 1px solid black; margin-right: 5px;"></span> WsLateral</li> <li>WsConnection (not In Service)</li> <li><span style="display: inline-block; width: 10px; height: 10px; border: 1px solid black; border-radius: 50%; margin-right: 5px;"></span> Meter</li> <li><span style="display: inline-block; width: 10px; height: 10px; border: 1px solid black; border-radius: 50%; margin-right: 5px;"></span> RatingUnit</li> </ul> |
|---|---|--|---|--|



# 9 Gore Street Land Use Consents



**9 Gore Street  
Subdivision Consents**



## Land Use Resource Consents within 100 metres of 9 Gore Street

Note: This list does not include subdivision Consents and Certificates of Compliance issued under the Resource Management Act.

---

### 15 Gore Street

RMA/1991/1193

Consent granted to build an oversized accessory building at 50 Santa Rosa Avenue on the grounds that the section is to contain 2 dwelling units and 2 large garages associated with each unit is required. - Historical Reference RES94001465

Processing complete

Applied 22/02/1991

Granted 05/03/1991

Decision issued 05/03/1991

Decision issued 05/03/1991

Granted 05/03/1991

### 16 Gore Street

RMA/1992/1178

Consent granted to reduce the setback from the front and rear boundaries. - Historical Reference RES94001424

Processing complete

Applied 24/03/1992

Decision issued 30/03/1992

Granted 30/03/1992

### 3 Gore Street

RMA/2008/363

Application to create two new lots (Proposed Lots 1 & 2) and to erect a new garage on proposed lot 1 - Historical Reference RMA92011157

Processing complete

Applied 25/02/2008

Decision issued 01/05/2008

Granted 29/04/2008

### **3A Gore Street**

RMA/2008/363

Application to create two new lots (Proposed Lots 1 & 2) and to erect a new garage on proposed lot 1 - Historical Reference RMA92011157

Processing complete

Applied 25/02/2008

Decision issued 01/05/2008

Granted 29/04/2008

### **41 Santa Rosa Avenue**

RMA/1980/716

Consent granted to intrude the recession plane with proposed second storey addition to 41 Santa Rosa Avenue. - Historical Reference RES94001464

Processing complete

Applied 10/11/1980

Decision issued 15/11/1980

Granted 15/11/1980

### **42A Santa Rosa Avenue**

RMA/2007/97

Application for the construction of a new garage and workshop - Historical Reference RMA92007304

Processing complete

Applied 19/01/2007

Decision issued 19/02/2007

Granted 19/02/2007

### **46 Fern Drive**

RMA/2007/811

Application to construct a sun-shade and patio - Historical Reference RMA92008052

Processing complete

Applied 11/04/2007

Decision issued 09/05/2007

Granted 08/05/2007

### **46A Santa Rosa Avenue**

RMA/2002/1308

Application to erect a second dwelling and an additional garage on the property - Historical Reference RMA20010312

Processing complete

Applied 06/06/2002

Decision issued 27/06/2002

Granted 26/06/2002

### **49A Nottingham Avenue**

RMA/2021/3880

Fee simple subdivision in two lots

Processing complete

Applied 22/11/2021

s223 Certificate issued 24/05/2022

s224 Certificate issued 24/05/2022

Decision issued 16/12/2021

Granted 16/12/2021

### **51 Santa Rosa Avenue**

RMA/2026/427

To establish a social housing complex comprising three units

Processing complete

Applied 19/02/2026

Decision issued 06/03/2026

Granted 06/03/2026

### **55 Nottingham Avenue**

RMA/1975/248

Consent to use premises as second hand dealers shop - Historical Reference RES9215185

Processing complete

Applied 02/09/1975

Decision issued 02/09/1975

Granted 02/09/1975

RMA/1993/925

Consent to erect 4 dwellings in the commercial 1 zone - Historical Reference RES9220770

Processing complete

Applied 27/10/1993

Decision issued 06/12/1993

Granted 06/12/1993

### **56 Santa Rosa Avenue**

RMA/2002/1215

Application to extend the existing dwelling on the property - Historical Reference RMA20010212

Processing complete

Applied 27/05/2002

Decision issued 14/06/2002

Granted 14/06/2002

### **57 Santa Rosa Avenue**

RMA/2009/1968

Conservatory addition - Historical Reference RMA92015457

Processing complete

Applied 24/12/2009

Decision issued 08/01/2010

Granted 07/01/2010

### **60 Santa Rosa Avenue**

RMA/2005/2935

Application to erect a garage in front of the existing dwelling with a reduced setback from the Right of Way - Historical Reference RMA20021847

Processing complete

Applied 22/12/2005

Decision issued 12/01/2006

Granted 12/01/2006

RMA/2005/2936

Application to erect a dwelling with an attached garage on the proposed rear site - Historical Reference RMA20021848

Processing complete

Applied 22/12/2005

Decision issued 13/01/2006

Granted 12/01/2006

RMA/2013/126

Dwelling with attached garage - Historical Reference RMA92021707

Processing complete

Applied 30/01/2013

Decision issued 20/02/2013

Granted 20/02/2013

RMA/2013/2506

Fee Simple Subdivision - 2 Lots Sec223 issued 30/10/14 LT 478159 Sec224 issued 2/10/15 - Historical Reference RMA92024229

Processing complete

Applied 22/11/2013

Decision issued 13/12/2013

Granted 13/12/2013

## **60A Santa Rosa Avenue**

RMA/2005/2935

Application to erect a garage in front of the existing dwelling with a reduced setback from the Right of Way - Historical Reference RMA20021847

Processing complete

Applied 22/12/2005

Decision issued 12/01/2006

Granted 12/01/2006

RMA/2005/2936

Application to erect a dwelling with an attached garage on the proposed rear site - Historical Reference RMA20021848

Processing complete

Applied 22/12/2005

Decision issued 13/01/2006

Granted 12/01/2006

RMA/2013/126

Dwelling with attached garage - Historical Reference RMA92021707

Processing complete

Applied 30/01/2013

Decision issued 20/02/2013

Granted 20/02/2013

RMA/2013/2506

Fee Simple Subdivision - 2 Lots Sec223 issued 30/10/14 LT 478159 Sec224 issued 2/10/15 - Historical Reference RMA92024229

Processing complete

Applied 22/11/2013

Decision issued 13/12/2013

Granted 13/12/2013

## **62 Fern Drive**

RMA/1994/1344

Increase of site coverage with second unit. - Historical Reference RES94102649

Withdrawn

Applied 21/11/1994

## **9A Gore Street**

RMA/1998/3019

A two Lot subdivision which does not meet the access width requirement under the Paparua Transitional Plan. - Historical Reference RES983458

Processing complete

Applied 23/12/1998

Decision issued 12/01/1999

Granted 12/01/1999

RMA/2013/1330

DWELLING WITH ATTACHED GARAGE - Historical Reference RMA92022988

Processing complete

Applied 12/07/2013

Decision issued 13/08/2013

Granted 12/08/2013

## **Data Quality Statement**

### **Land Use Consents**

All resource consents are shown for sites that have been labelled with an address. For sites that have been labelled with a cross (+) no resource consents have been found. Sites that have no label have not been checked for resource consents. This will be particularly noticeable on the margins of the search radius. If there are such sites and you would like them included in the check, please ask for the LIM spatial query to be rerun accordingly. This will be done free of charge although there may be a short delay. Resource consents which are on land occupied by roads, railways or rivers are not, and currently cannot be displayed, either on the map or in the list. Resource consents that relate to land that has since been subdivided, will be shown in the list, but not on the map. They will be under the address of the land as it was at the time the resource consent was applied for. Resource consents that are listed as Non-notified and are current, may in fact be notified resource consents that have not yet been through the notification process. If in doubt. Please phone (03)941 8999.

The term "resource consents" in this context means land use consents. Subdivision consents and certificates of compliance are excluded.

### **Subdivision Consents**

All subdivision consents are shown for the sites that have been labelled with consent details. For Sites that have been labelled with a cross (+) no records have been found. Sites that have no label have not been checked for subdivision consents. This will be particularly noticeable on the margins of the search radius. If there are such sites and you would like them included in the check, please ask for the LIM spatial query to be rerun accordingly. This will be done free of charge although there may be a short delay.

The term "subdivision consents" in this context means a resource consent application to subdivide land. Non subdivision land use resource consents and certificates of compliance are excluded.

This report will only record those subdivision applications which have not been completed i.e once a subdivision has been given effect to and the new lots/properties have been established the application which created those lots will not be shown

All subdivision consent information is contained on the map and no separate list is supplied