



**RECORD OF TITLE
UNDER LAND TRANSFER ACT 2017
FREEHOLD**

**Guaranteed Search Copy issued under Section 60 of the Land
Transfer Act 2017**



R. W. Muir
Registrar-General
of Land

Identifier **NL10D/1231**

Land Registration District **Nelson**

Date Issued 06 May 1994

Prior References

NL10D/1185 NL7B/1137

Estate Fee Simple

Area 705 square metres more or less

Legal Description Lot 8 Deposited Plan 16715

Registered Owners

John Ellis Robert McIntyre

Interests

The part herein formerly in CT NL10D/1185 is subject to Part IV A Conservation Act 1987

The part herein formerly in CT NL10D/1185 is subject to Section 11 Crown Minerals Act 1991

337787.5 Easement Certificate specifying the following easements - 6.5.1994 at 10.30 am

Type	Servient Tenement	Easement Area	Dominant Tenement	Statutory Restriction
Rights of way, rights to drain sewage & water, convey water & rights to transmit electricity & telephonic communications	Lot 8 Deposited Plan 16715 - herein	A DP 16715	Lot 6 Deposited Plan 16715	
Rights of way, rights to drain sewage & water, convey water & rights to transmit electricity & telephonic communications	Lot 8 Deposited Plan 16715 - herein	A DP 16715	Lot 7 Deposited Plan 16715	

Rights of way,
rights to drain
sewage & water,
convey water &
rights to transmit
electricity &
telephonic

Lot 7 Deposited Plan
16715

B DP 16715

Lot 8 Deposited Plan
16715 - herein

communications

Rights of way,
rights to drain
sewage & water,
convey water &
rights to transmit
electricity &
telephonic
communications

Lot 6 Deposited Plan
16715

C DP 16715

Lot 8 Deposited Plan
16715 - herein

The easements specified in Easement Certificate 337787.5 when created are subject to Section 243 (a) Resource Management Act 1991

337787.6 Transfer creating the following easements - 6.5.1994 at 10.30 am

Type	Servient Tenement	Easement Area	Dominant Tenement	Statutory Restriction
Transmit electricity	Lot 8 Deposited Plan 16715 - herein	A DP 16715	Lot 5 Deposited Plan 16542 - CT NL10D/415	

Land Covenant in Transfer 340493.1 - 29.7.1994 at 10.25 am

Fencing Covenant in Transfer 340493.1 - 29.7.1994 at 10.25 am

Fencing Covenant in Transfer 350413.1 - 1.8.1995 at 11.50 am

11537708.3 Mortgage to Bank of New Zealand - 6.9.2019 at 1:09 pm

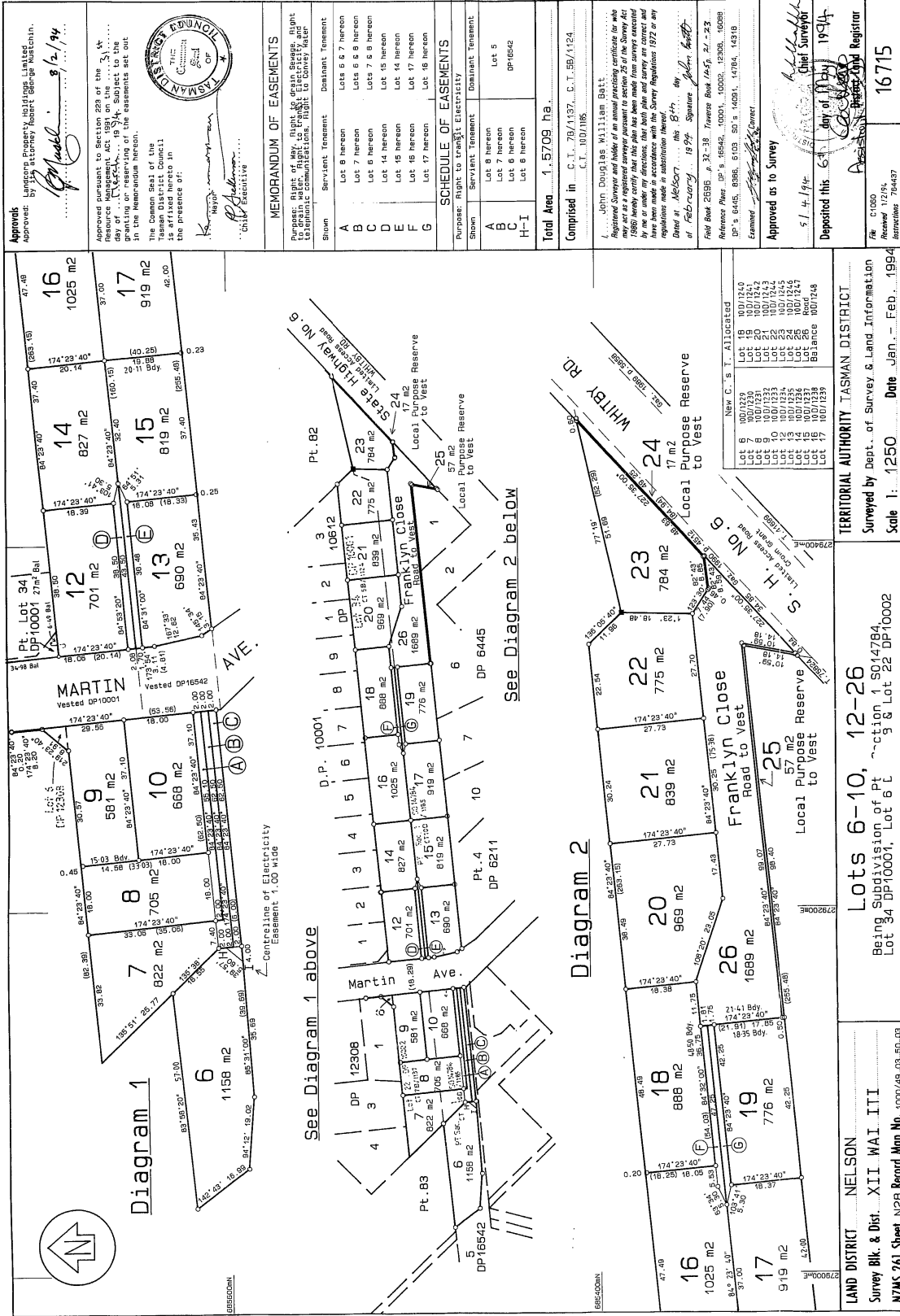

Approve: Landcorp Property Holdings Limited
 Approved by Attorney Robert George Hutchinson, 8/2/94

Approved pursuant to Section 223 of the Resource Management Act 1976, subject to the granting or reserving of the easements set out in the Memorandum hereon.

The Common Seal of the Tasman District Council is hereunto set in the presence of:

Christine M. H. ...
 Mayor

Christine M. H. ...
 Councillor

MEMORANDUM OF EASEMENTS

Purpose: Right of Way, Right to drain, Easement, Right to transmit communications, Right to convey water

Shown	Servient Tenement	Dominant Tenement
A	Lot 9 hereon	Lots 6 & 7 hereon
B	Lot 7 hereon	Lots 6 & 9 hereon
C	Lot 6 hereon	Lots 7 & 9 hereon
D	Lot 14 hereon	Lot 15 hereon
E	Lot 15 hereon	Lot 14 hereon
F	Lot 16 hereon	Lot 17 hereon
G	Lot 17 hereon	Lot 16 hereon

SCHEDULE OF EASEMENTS

Purpose: Right to transmit Electricity

Shown	Servient Tenement	Dominant Tenement
A	Lot 8 hereon	Lot 5
B	Lot 7 hereon	DP 6542
C	Lot 6 hereon	DP 6542
H-I	Lot 6 hereon	DP 6542

Total Area 1,5709 ha.

Comprised in C.T. 78/1437, C.T. 59/1134, C.T. 100/1186

John Douglas William Bell
 Registered Surveyor and holder of an annual practicing certificate for who may act as a registered surveyor pursuant to section 25 of the Survey Act 1976, in accordance with the provisions of section 25 of the Survey Act 1976, by me or under my directions, that both plan and survey are correct and have been made in accordance with the Survey Regulations 1972 or any regulations made in substitution thereof.

Dated at Nelson on 19th day of February 1994

Field Book 2696, p. 32-38, Transverse Book 1447, p. 2-23
 Reference Plans DP 9, 85442, 10001, 10002, 12350, 16088
 DP 9, 6445, 6396, 6103, 80 9, 14091, 14784, 14318

Approved as to Survey

5/4/94

Deposited this 5th day of February 1994

Registrar

File C100
 Received 17294
 Memorandum 704487

16715

New C. S. T. Allocated

Lot 6	100/1230
Lot 7	100/1231
Lot 8	100/1232
Lot 9	100/1233
Lot 10	100/1234
Lot 11	100/1235
Lot 12	100/1236
Lot 13	100/1237
Lot 14	100/1238
Lot 15	100/1239
Lot 16	100/1240
Lot 17	100/1241
Lot 18	100/1242
Lot 19	100/1243
Lot 20	100/1244
Lot 21	100/1245
Lot 22	100/1246
Lot 23	100/1247
Lot 24	100/1248
Lot 25	100/1249
Lot 26	100/1250
Balance	800/126

TERRITORIAL AUTHORITY TASMAN DISTRICT

Surveyed by Dept. of Survey & Land Information

Scale 1: 1250 Date Jan - Feb, 1994

Lots 6-10, 12-26

Being Subdivision of Pt Section 1 5014784,
 Lot 34 DP10001, Lot 6 L

LAND DISTRICT NELSON

Survey Bk. & Dist. XII WAI III

NZMS 261 Sheet N28 Record Map No. 1000/49.03.50.09

W.A. ROBERTSON, DIRECTOR GENERAL, DEPARTMENT OF SURVEY AND LAND INFORMATION, NEW ZEALAND

MICROFILM RECORDS (WAIKATO) LTD, HAMILTON

8/6/94 3

8/6/94 3