

SIGNING PAGE

VENDOR	PURCHASER
<p>Signed by</p> <p>Egon James Kuster <hr/> Vendor</p> <p>Rebecca Anne Kuster <hr/> Vendor</p>	<p>Signed by</p> <p><hr/> Purchaser</p> <p><hr/> Purchaser</p>
VENDOR (COMPANY)	PURCHASER (COMPANY)
<p>Signed by in accordance with s127(1) of the Corporations Act 2001 by the authorised person(s) whose signature(s) appear(s) below:</p> <p><hr/> Signature of authorised person <hr/> Signature of authorised person</p> <p><hr/> Name of authorised person <hr/> Name of authorised person</p> <p><hr/> Office held <hr/> Office held</p>	<p>Signed by in accordance with s127(1) of the Corporations Act 2001 by the authorised person(s) whose signature(s) appear(s) below:</p> <p><hr/> Signature of authorised person <hr/> Signature of authorised person</p> <p><hr/> Name of authorised person <hr/> Name of authorised person</p> <p><hr/> Office held <hr/> Office held</p>

Choices

Vendor agrees to accept a **deposit-bond** NO yes

Nominated *Electronic Lodgment Network (ELN)* (clause 4)

Manual transaction (clause 30)

NO yes

(if yes, vendor must provide further details, including any applicable exemption, in the space below):

Tax information (the parties promise this is correct as far as each party is aware)

Land tax is adjustable

NO yes

GST: Taxable supply

NO yes in full yes to an extent

Margin scheme will be used in making the taxable supply

NO yes

This sale is not a taxable supply because (one or more of the following may apply) the sale is:

- not made in the course or furtherance of an enterprise that the vendor carries on (section 9-5(b))
- by a vendor who is neither registered nor required to be registered for GST (section 9-5(d))
- GST-free because the sale is the supply of a going concern under section 38-325
- GST-free because the sale is subdivided farm land or farm land supplied for farming under Subdivision 38-O
- input taxed because the sale is of eligible residential premises (sections 40-65, 40-75(2) and 195-1)

Purchaser must make an **GSTRW payment**

NO yes (if yes, vendor must provide details)

(GST residential withholding payment)

If the details below are not fully completed at the contract date, the vendor must provide all these details in a separate notice at least 7 days before the date for completion.

GSTRW payment (GST residential withholding payment) – details

Frequently the supplier will be the vendor. However, sometimes further information will be required as to which entity is liable for GST, for example, if the supplier is a partnership, a trust, part of a GST group or a participant in a GST joint venture.

Supplier's name:

Supplier's ABN:

Supplier's GST branch number (if applicable):

Supplier's business address:

Supplier's representative:

Supplier's contact phone number:

Supplier's proportion of **GSTRW payment**:

If more than one supplier, provide the above details for each supplier.

Amount purchaser must pay – price multiplied by the **GSTRW rate** (residential withholding rate): \$

Amount must be paid: AT COMPLETION at another time (specify):

Is any of the consideration not expressed as an amount in money? NO yes

If "yes", the GST inclusive market value of the non-monetary consideration: \$

Other details (including those required by regulation or the ATO forms):

List of Documents

General	Strata or community title (clause 23 of the contract)
<input checked="" type="checkbox"/> 1 property certificate for the land <input type="checkbox"/> 2 plan of the land <input type="checkbox"/> 3 unregistered plan of the land <input type="checkbox"/> 4 plan of land to be subdivided <input type="checkbox"/> 5 document that is to be lodged with a relevant plan <input type="checkbox"/> 6 section 10.7(2) planning certificate under Environmental Planning and Assessment Act 1979 <input type="checkbox"/> 7 additional information included in that certificate under section 10.7(5) <input type="checkbox"/> 8 sewerage infrastructure location diagram (service location print) <input type="checkbox"/> 9 sewer lines location diagram (sewer service diagram) <input type="checkbox"/> 10 document that created or may have created an easement, profit à prendre, restriction on use or positive covenant disclosed in this contract <input type="checkbox"/> 11 <i>planning agreement</i> <input type="checkbox"/> 12 section 88G certificate (positive covenant) <input type="checkbox"/> 13 survey report <input type="checkbox"/> 14 building information certificate or building certificate given under <i>legislation</i> <input type="checkbox"/> 15 occupation certificate <input type="checkbox"/> 16 lease (with every relevant memorandum or variation) <input type="checkbox"/> 17 other document relevant to tenancies <input type="checkbox"/> 18 licence benefiting the land <input type="checkbox"/> 19 old system document <input type="checkbox"/> 20 Crown purchase statement of account <input type="checkbox"/> 21 building management statement <input type="checkbox"/> 22 form of requisitions <input type="checkbox"/> 23 <i>clearance certificate</i> <input type="checkbox"/> 24 land tax certificate	<input type="checkbox"/> 33 property certificate for strata common property <input type="checkbox"/> 34 plan creating strata common property <input type="checkbox"/> 35 strata by-laws <input type="checkbox"/> 36 strata development contract <input type="checkbox"/> 37 strata management statement <input type="checkbox"/> 38 strata renewal proposal <input type="checkbox"/> 39 strata renewal plan <input type="checkbox"/> 40 leasehold strata - lease of lot and common property <input type="checkbox"/> 41 property certificate for neighbourhood property <input type="checkbox"/> 42 plan creating neighbourhood property <input type="checkbox"/> 43 neighbourhood development contract <input type="checkbox"/> 44 neighbourhood management statement <input type="checkbox"/> 45 property certificate for precinct property <input type="checkbox"/> 46 plan creating precinct property <input type="checkbox"/> 47 precinct development contract <input type="checkbox"/> 48 precinct management statement <input type="checkbox"/> 49 property certificate for community property <input type="checkbox"/> 50 plan creating community property <input type="checkbox"/> 51 community development contract <input type="checkbox"/> 52 community management statement <input type="checkbox"/> 53 document disclosing a change of by-laws <input type="checkbox"/> 54 document disclosing a change in a development contract or management statement <input type="checkbox"/> 55 document disclosing a change in boundaries <input type="checkbox"/> 56 information certificate (strata) <input type="checkbox"/> 57 information certificate (association) <input type="checkbox"/> 58 document relevant to an exclusive supply network <input type="checkbox"/> 59 disclosure statement - off the plan contract <input type="checkbox"/> 60 other document relevant to the off the plan contract Other <input type="checkbox"/> 61
Home Building Act 1989 <input type="checkbox"/> 25 insurance certificate <input type="checkbox"/> 26 brochure or warning <input type="checkbox"/> 27 evidence of alternative indemnity cover Swimming Pools Act 1992 <input type="checkbox"/> 28 certificate of compliance <input type="checkbox"/> 29 evidence of registration <input type="checkbox"/> 30 relevant occupation certificate <input type="checkbox"/> 31 certificate of non-compliance <input type="checkbox"/> 32 detailed reasons of non-compliance	

HOLDER OF STRATA OR COMMUNITY SCHEME RECORDS – Name, address, email address and telephone number

IMPORTANT NOTICE TO VENDORS AND PURCHASERS

Before signing this contract you should ensure that you understand your rights and obligations, some of which are not written in this contract but are implied by law.

WARNING—SMOKE ALARMS

The owners of certain types of buildings and strata lots must have smoke alarms, or in certain cases heat alarms, installed in the building or lot in accordance with regulations under the *Environmental Planning and Assessment Act 1979*. It is an offence not to comply. It is also an offence to remove or interfere with a smoke alarm or heat alarm. Penalties apply.

WARNING—LOOSE-FILL ASBESTOS INSULATION

Before purchasing land that includes residential premises, within the meaning of the *Home Building Act 1989*, Part 8, Division 1A, built before 1985, a purchaser is strongly advised to consider the possibility that the premises may contain loose-fill asbestos insulation, within the meaning of the *Home Building Act 1989*, Part 8, Division 1A. In particular, a purchaser should—

- (a) search the Register required to be maintained under the *Home Building Act 1989*, Part 8, Division 1A, and
- (b) ask the relevant local council whether it holds records showing that the residential premises contain loose-fill asbestos insulation.

For further information about loose-fill asbestos insulation, including areas in which residential premises have been identified as containing loose-fill asbestos insulation, contact NSW Fair Trading.

Cooling off period (purchaser's rights)

- 1 This is the statement required by the *Conveyancing Act 1919*, section 66X. This statement applies to a contract for the sale of residential property.
- 2 **EXCEPT** in the circumstances listed in paragraph 3, the purchaser may rescind the contract before 5pm on—
 - (a) for an off the plan contract—the tenth business day after the day on which the contract was made, or
 - (b) in any other case—the fifth business day after the day on which the contract was made.
- 3 There is **NO COOLING OFF PERIOD**—
 - (a) if, at or before the time the contract is made, the purchaser gives to the vendor, or the vendor's solicitor or agent, a certificate that complies with the Act, section 66W, or
 - (b) if the property is sold by public auction, or
 - (c) if the contract is made on the same day as the property was offered for sale by public auction but passed in, or
 - (d) if the contract is made in consequence of the exercise of an option, other than an option that is void under the Act, section 66ZG.
- 4 A purchaser exercising the right to cool off by rescinding the contract forfeits 0.25% of the purchase price of the property to the vendor.
- 5 The vendor is entitled to recover the forfeited amount from an amount paid by the purchaser as a deposit under the contract. The purchaser is entitled to a refund of any balance.

DISPUTES

If you get into a dispute with the other party, the Law Society and Real Estate Institute encourage you to use informal procedures to resolve the dispute such as negotiation, independent expert appraisal, the Law Society Conveyancing Dispute Resolution Scheme or mediation (for example mediation under the Law Society Mediation Program).

AUCTIONS

Regulations made under the Property and Stock Agents Act 2002 prescribe a number of conditions applying to sales by auction.

WARNINGS

1. Various Acts of Parliament and other matters can affect the rights of the parties to this contract. Some important matters are actions, claims, decisions, licences, notices, orders, proposals or rights of way involving:

<p>Australian Taxation Office County Council Department of Education Department of Planning, Housing and Infrastructure Department of Primary Industries and Regional Development Electricity, gas and telecommunications Homes NSW</p>	<p>Local Council Local Land Services NSW Fair Trading NSW Public Works Owner of adjoining land Privacy Subsidence Advisory NSW Transport agencies Water, sewerage or drainage authority</p>
---	---

If you think that any of these matters affects the property, tell your solicitor.
2. A lease may be affected by the Agricultural Tenancies Act 1990, the Residential Tenancies Act 2010 or the Retail Leases Act 1994.
3. If any purchase money is owing to the Crown, it will become payable before obtaining consent, or if no consent is needed, when the transfer is registered.
4. If a consent to transfer is required under legislation, see clause 27 as to the obligations of the parties.
5. The vendor should continue the vendor's insurance until completion. If the vendor wants to give the purchaser possession before completion, the vendor should first ask the insurer to confirm this will not affect the insurance.
6. Most purchasers will have to pay transfer duty (and, sometimes, if the purchaser is not an Australian citizen, surcharge purchaser duty) on this contract. If a payment is not made on time, interest and penalties may be incurred. More information is available from Revenue NSW.
7. If the purchaser agrees to the release of deposit, the purchaser's right to recover the deposit may stand behind the rights of others (for example the vendor's mortgagee).
8. The purchaser should arrange insurance as appropriate.
9. Some transactions involving personal property may be affected by the Personal Property Securities Act 2009.
10. A purchaser should be satisfied that finance will be available at the time of completing the purchase.
11. The purchaser may have to comply with a foreign resident capital gains withholding payment obligation (even if the vendor is not a foreign resident). If so, this will affect the amount available to the vendor on completion.
12. Purchasers of some residential properties may have to withhold part of the purchase price to be credited towards the GST liability of the vendor. If so, this will also affect the amount available to the vendor. More information is available from the Australian Taxation Office.
13. From 1 July 2026, estate agents, solicitors, licensed conveyancers and other professions who provide a designated service will have regulatory obligations under the Anti-Money Laundering and Counter-Terrorism Financing (AML/CTF) regime. These new obligations include customer due diligence and reporting to AUSTRAC. More details are available from AUSTRAC.

The vendor sells and the purchaser buys the *property* for the price under these provisions instead of Schedule 3 Conveyancing Act 1919, subject to any *legislation* that cannot be excluded.

1 Definitions (a term in italics is a defined term)

1.1	In this contract, these terms (in any form) mean –
<i>adjustment date</i>	the earlier of the giving of possession to the purchaser or completion;
<i>adjustment figures</i>	details of the adjustments to be made to the price under clause 14;
<i>authorised Subscriber</i>	a <i>Subscriber</i> (not being a <i>party's solicitor</i>) named in a notice served by a <i>party</i> as being authorised for the purposes of clause 20.6.8;
<i>bank</i>	the Reserve Bank of Australia or an authorised deposit-taking institution which is a bank, a building society or a credit union;
<i>business day</i>	any day except a bank or public holiday throughout NSW or a Saturday or Sunday;
<i>cheque</i>	a cheque that is not postdated or stale;
<i>clearance certificate</i>	a certificate within the meaning of s14-220 of Schedule 1 to the <i>TA Act</i> , that covers one or more days falling within the period from and including the contract date to completion;
<i>completion time</i>	the time of day at which completion is to occur;
<i>deposit-bond</i>	a deposit bond or guarantee with each of the following approved by the vendor – <ul style="list-style-type: none"> ● the issuer; ● the expiry date (if any); and ● the amount;
<i>depositholder</i>	vendor's agent (or if no vendor's agent is named in this contract, the vendor's <i>solicitor</i> , or if no vendor's <i>solicitor</i> is named in this contract, the buyer's agent);
<i>discharging mortgagee</i>	any discharging mortgagee, chargee, covenant chargee or caveator whose provision of a <i>Digitally Signed</i> discharge of mortgage, discharge of charge or withdrawal of caveat is required in order for unencumbered title to the <i>property</i> to be transferred to the purchaser;
<i>document of title</i>	document relevant to the title or the passing of title;
<i>ECNL</i>	the Electronic Conveyancing National Law (NSW);
<i>electronic document</i>	a dealing as defined in the Real Property Act 1900 which may be created and <i>Digitally Signed</i> in an <i>Electronic Workspace</i> ;
<i>electronic transaction</i>	a <i>Conveyancing Transaction</i> to be conducted for the <i>parties</i> by their legal representatives as <i>Subscribers</i> using an <i>ELN</i> and in accordance with the <i>ECNL</i> and the <i>participation rules</i> ;
<i>electronic transfer</i>	a transfer of land under the Real Property Act 1900 for the <i>property</i> to be prepared and <i>Digitally Signed</i> in the <i>Electronic Workspace</i> established for the purposes of the <i>parties' Conveyancing Transaction</i> ;
<i>FRCGW percentage</i>	the percentage mentioned in s14-200(3)(a) of Schedule 1 to the <i>TA Act</i> (15% as at 1 January 2025);
<i>FRCGW remittance</i>	a remittance which the purchaser must make under s14-200 of Schedule 1 to the <i>TA Act</i> , being the lesser of the <i>FRCGW percentage</i> of the price (inclusive of GST, if any) and the amount specified in a <i>variation served by a party</i> ;
<i>GST Act</i>	A New Tax System (Goods and Services Tax) Act 1999;
<i>GST rate</i>	the rate mentioned in s4 of A New Tax System (Goods and Services Tax Imposition - General) Act 1999 (10% as at 1 July 2000);
<i>GSTRW payment</i>	a payment which the purchaser must make under s14-250 of Schedule 1 to the <i>TA Act</i> (the price multiplied by the <i>GSTRW rate</i>);
<i>GSTRW rate</i>	the rate determined under ss14-250(6), (8) or (9) of Schedule 1 to the <i>TA Act</i> (as at 1 July 2018, usually 7% of the price if the margin scheme applies, 1/11 th if not);
<i>incoming mortgagee</i>	any mortgagee who is to provide finance to the purchaser on the security of the <i>property</i> and to enable the purchaser to pay the whole or part of the price;
<i>legislation</i>	an Act or a by-law, ordinance, regulation or rule made under an Act;
<i>manual transaction</i>	a <i>Conveyancing Transaction</i> in which a dealing forming part of the <i>Lodgment Case</i> at or following completion cannot be <i>Digitally Signed</i> ;
<i>normally</i>	subject to any other provision of this contract;
<i>participation rules</i>	the participation rules as determined by the <i>ECNL</i> ;
<i>party</i>	each of the vendor and the purchaser;
<i>property</i>	the land, the improvements, all fixtures and the inclusions, but not the exclusions;
<i>planning agreement</i>	a valid voluntary agreement within the meaning of s7.4 of the Environmental Planning and Assessment Act 1979 entered into in relation to the <i>property</i> ;
<i>populate</i>	to complete data fields in the <i>Electronic Workspace</i> ;

<i>requisition</i>	an objection, question or requisition (but the term does not include a claim);
<i>rescind</i>	rescind this contract from the beginning;
<i>serve</i>	serve in writing on the other <i>party</i> ;
<i>settlement cheque</i>	an unendorsed <i>cheque</i> made payable to the person to be paid and – <ul style="list-style-type: none"> • issued by a <i>bank</i> and drawn on itself; or • if authorised in writing by the vendor or the vendor's <i>solicitor</i>, some other <i>cheque</i>;
<i>solicitor</i>	in relation to a <i>party</i> , the <i>party's</i> solicitor or licensed conveyancer named in this contract or in a notice <i>served</i> by the <i>party</i> ;
<i>TA Act</i>	Taxation Administration Act 1953;
<i>terminate</i>	terminate this contract for breach;
<i>title data</i>	the details of the title to the <i>property</i> made available to the <i>Electronic Workspace</i> by the <i>Land Registry</i> ;
<i>variation</i>	a variation made under s14-235 of Schedule 1 to the <i>TA Act</i> ;
<i>within</i>	in relation to a period, at any time before or during the period; and
<i>work order</i>	a valid direction, notice or order that requires work to be done or money to be spent on or in relation to the <i>property</i> or any adjoining footpath or road (but the term does not include a notice under s22E of the Swimming Pools Act 1992 or clause 20 of the Swimming Pools Regulation 2018).

1.2 Words and phrases used in this contract (italicised and in Title Case, such as *Conveyancing Transaction*, *Digitally Sign*, *Electronic Workspace*, *ELN*, *ELNO*, *Land Registry*, *Lodgment Case* and *Subscriber*) have the meanings given in the *participation rules*.

2 Deposit and other payments before completion

2.1 The purchaser must pay the deposit to the *depositholder* as stakeholder.

2.2 *Normally*, the purchaser must pay the deposit on the making of this contract, and this time is essential.

2.3 If this contract requires the purchaser to pay any of the deposit by a later time, that time is also essential.

2.4 The purchaser can pay any of the deposit by –

2.4.1 giving cash (up to \$2,000) to the *depositholder*;

2.4.2 unconditionally giving a *cheque* to the *depositholder* or to the vendor, vendor's agent or vendor's *solicitor* for sending to the *depositholder*; or

2.4.3 electronic funds transfer to the *depositholder's* nominated account and, if requested by the vendor or the *depositholder*, providing evidence of that transfer.

2.5 The vendor can *terminate* if –

2.5.1 any of the deposit is not paid on time;

2.5.2 a *cheque* for any of the deposit is not honoured on presentation; or

2.5.3 a payment under clause 2.4.3 is not received in the *depositholder's* nominated account by 5.00 pm on the third *business day* after the time for payment.

This right to *terminate* is lost as soon as the deposit is paid in full.

2.6 If the vendor accepts a *deposit-bond* for the deposit, clauses 2.1 to 2.5 do not apply.

2.7 If the vendor accepts a *deposit-bond* for part of the deposit, clauses 2.1 to 2.5 apply only to the balance.

2.8 If any of the deposit or of the balance of the price is paid before completion to the vendor or as the vendor directs, it is a charge on the land in favour of the purchaser until *termination* by the vendor or completion, subject to any existing right.

2.9 If each *party* tells the *depositholder* that the deposit is to be invested, the *depositholder* is to invest the deposit (at the risk of the *party* who becomes entitled to it) with a *bank*, in an interest-bearing account in NSW, payable at call, with interest to be reinvested, and pay the interest to the *parties* equally, after deduction of all proper government taxes and financial institution charges and other charges.

3 Deposit-bond

3.1 This clause applies only if the vendor accepts a *deposit-bond* for the deposit (or part of it).

3.2 The purchaser must provide the *deposit-bond* to the vendor's *solicitor* (or if no solicitor the *depositholder*) at or before the making of this contract and this time is essential.

3.3 If the *deposit-bond* has an expiry date and completion does not occur by the date which is 14 days before the expiry date, the purchaser must *serve* a replacement *deposit-bond* at least 7 days before the expiry date. The time for service is essential.

3.4 The vendor must approve a replacement *deposit-bond* if –

3.4.1 it is from the same issuer and for the same amount as the earlier *deposit-bond*; and

3.4.2 it has an expiry date at least three months after its date of issue.

3.5 A breach of clauses 3.2 or 3.3 entitles the vendor to *terminate*. The right to *terminate* is lost as soon as –

3.5.1 the purchaser *serves* a replacement *deposit-bond*; or

3.5.2 the deposit is paid in full under clause 2.

3.6 Clauses 3.3 and 3.4 can operate more than once.

- 3.7 If the purchaser *serves* a replacement *deposit-bond*, the vendor must *serve* the earlier *deposit-bond*.
- 3.8 The amount of any *deposit-bond* does not form part of the price for the purposes of clause 16.5.
- 3.9 The vendor must give the purchaser any original *deposit-bond* –
- 3.9.1 on completion; or
- 3.9.2 if this contract is *rescinded*.
- 3.10 If this contract is *terminated* by the vendor –
- 3.10.1 *normally*, the vendor can immediately demand payment from the issuer of the *deposit-bond*; or
- 3.10.2 if the purchaser *serves* prior to *termination* a notice disputing the vendor's right to *terminate*, the vendor must forward any original *deposit-bond* (or its proceeds if called up) to the *depositholder* as stakeholder.
- 3.11 If this contract is *terminated* by the purchaser –
- 3.11.1 *normally*, the vendor must give the purchaser any original *deposit-bond*; or
- 3.11.2 if the vendor *serves* prior to *termination* a notice disputing the purchaser's right to *terminate*, the vendor must forward any original *deposit-bond* (or its proceeds if called up) to the *depositholder* as stakeholder.
- 4 Electronic transaction**
- 4.1 This *Conveyancing Transaction* is to be conducted as an *electronic transaction* unless –
- 4.1.1 the contract says this transaction is a *manual transaction*, giving the reason, or
- 4.1.2 a *party serves* a notice stating why the transaction is a *manual transaction*, in which case the *parties* do not have to complete earlier than 14 days after *service* of the notice, and clause 21.3 does not apply to this provision,
- and in both cases clause 30 applies.
- 4.2 If, because of clause 4.1.2, this *Conveyancing Transaction* is to be conducted as a *manual transaction* –
- 4.2.1 each *party* must –
- bear equally any disbursements or fees; and
 - otherwise bear that *party's* own costs;
- incurred because this *Conveyancing Transaction* was to be conducted as an *electronic transaction*; and
- 4.2.2 if a *party* has paid all of a disbursement or fee which, by reason of this clause, is to be borne equally by the *parties*, that amount must be adjusted under clause 14.
- 4.3 The *parties* must conduct the *electronic transaction* –
- 4.3.1 in accordance with the *participation rules* and the *ECNL*; and
- 4.3.2 using the nominated *ELN*, unless the *parties* otherwise agree. This clause 4.3.2 does not prevent a *party* using an *ELN* which can interoperate with the nominated *ELN*.
- 4.4 A *party* must pay the fees and charges payable by that *party* to the *ELNO* and the *Land Registry*.
- 4.5 *Normally*, the vendor must *within 7 days* of the contract date create and *populate* an *Electronic Workspace* with *title data* and the date for completion, and invite the purchaser to the *Electronic Workspace*.
- 4.6 If the vendor has not created an *Electronic Workspace* in accordance with clause 4.5, the purchaser may create and *populate* an *Electronic Workspace* and, if it does so, the purchaser must invite the vendor to the *Electronic Workspace*.
- 4.7 The *parties* must, as applicable to their role in the *Conveyancing Transaction* and the steps taken under clauses 4.5 or 4.6 –
- 4.7.1 promptly join the *Electronic Workspace* after receipt of an invitation;
- 4.7.2 create and *populate* an *electronic transfer*;
- 4.7.3 invite any *discharging mortgagee* or *incoming mortgagee* to join the *Electronic Workspace*; and
- 4.7.4 *populate* the *Electronic Workspace* with a nominated *completion time*.
- 4.8 If the transferee in the *electronic transfer* is not the purchaser, the purchaser must give the vendor a direction signed by the purchaser personally for that transfer.
- 4.9 The vendor can require the purchaser to include a covenant or easement in the *electronic transfer* only if this contract contains the wording of the proposed covenant or easement, and a description of the land burdened and benefited.
- 4.10 If the purchaser must make a *GSTRW payment* or an *FRCGW remittance*, the purchaser must *populate* the *Electronic Workspace* with the payment details for the *GSTRW payment* or *FRCGW remittance* payable to the Deputy Commissioner of Taxation at least 2 *business days* before the date for completion.
- 4.11 Before completion, the *parties* must ensure that –
- 4.11.1 all *electronic documents* which a *party* must *Digitally Sign* to complete the *electronic transaction* are *populated* and *Digitally Signed*;
- 4.11.2 all certifications required by the *ECNL* are properly given; and
- 4.11.3 they do everything else in the *Electronic Workspace* which that *party* must do to enable the *electronic transaction* to proceed to completion.
- 4.12 If the computer systems of any of the *Land Registry*, the *ELNO*, Revenue NSW or the Reserve Bank of Australia are inoperative for any reason at the *completion time* agreed by the *parties*, a failure to complete this contract for that reason is not a default under this contract on the part of either *party*.

- 4.13 If the computer systems of the *Land Registry* are inoperative for any reason at the *completion time* agreed by the *parties*, and the *parties* choose that financial settlement is to occur despite this, then on financial settlement occurring –
- 4.13.1 all *electronic documents Digitally Signed* by the vendor and any discharge of mortgage, withdrawal of caveat or other *electronic document* forming part of the *Lodgment Case* for the *electronic transaction* are taken to have been unconditionally and irrevocably delivered to the purchaser or the purchaser's mortgagee at the time of financial settlement together with the right to deal with the land; and
- 4.13.2 the vendor is taken to have no legal or equitable interest in the *property*.
- 4.14 If the *parties* do not agree about the delivery before completion of one or more documents or things that cannot be delivered through the *Electronic Workspace*, the *party* required to deliver the documents or things –
- 4.14.1 holds them on completion in escrow for the benefit of; and
- 4.14.2 must immediately after completion deliver the documents or things to, or as directed by; the *party* entitled to them.

5 Requisitions

- 5.1 If a form of *requisitions* is attached to this contract, the purchaser is taken to have made those *requisitions*.
- 5.2 If the purchaser is or becomes entitled to make any other *requisition*, the purchaser can make it only by *servicing* it –
- 5.2.1 if it arises out of this contract or it is a general question about the *property* or title - *within 21 days* after the contract date;
- 5.2.2 if it arises out of anything *served* by the vendor - *within 21 days* after the later of the contract date and that *service*; and
- 5.2.3 in any other case - *within a reasonable time*.

6 Error or misdescription

- 6.1 *Normally*, the purchaser can (but only before completion) claim compensation for an error or misdescription in this contract (as to the *property*, the title or anything else and whether substantial or not).
- 6.2 This clause applies even if the purchaser did not take notice of or rely on anything in this contract containing or giving rise to the error or misdescription.
- 6.3 However, this clause does not apply to the extent the purchaser knows the true position.

7 Claims by purchaser

- Normally*, the purchaser can make a claim (including a claim under clause 6) before completion only by *servicing* it with a statement of the amount claimed, and if the purchaser makes one or more claims before completion –
- 7.1 the vendor can *rescind* if in the case of claims that are not claims for delay –
- 7.1.1 the total amount claimed exceeds 5% of the price;
- 7.1.2 the vendor *serves* notice of intention to *rescind*; and
- 7.1.3 the purchaser does not *serve* notice waiving the claims *within 14 days* after that *service*; and
- 7.2 if the vendor does not *rescind*, the *parties* must complete and if this contract is completed –
- 7.2.1 the lesser of the total amount claimed and 10% of the price must be paid out of the price to and held by the *depositholder* until the claims are finalised or lapse;
- 7.2.2 the amount held is to be invested in accordance with clause 2.9;
- 7.2.3 the claims must be finalised by an arbitrator appointed by the *parties* or, if an appointment is not made *within 1 month* of completion, by an arbitrator appointed by the President of the Law Society at the request of a *party* (in the latter case the *parties* are bound by the terms of the Conveyancing Arbitration Rules approved by the Law Society as at the date of the appointment);
- 7.2.4 the purchaser is not entitled, in respect of the claims, to more than the total amount claimed and the costs of the purchaser;
- 7.2.5 net interest on the amount held must be paid to the *parties* in the same proportion as the amount held is paid; and
- 7.2.6 if the *parties* do not appoint an arbitrator and neither *party* requests the President to appoint an arbitrator *within 3 months* after completion, the claims lapse and the amount belongs to the vendor.

8 Vendor's rights and obligations

- 8.1 The vendor can *rescind* if –
- 8.1.1 the vendor is, on reasonable grounds, unable or unwilling to comply with a *requisition*;
- 8.1.2 the vendor *serves* a notice of intention to *rescind* that specifies the *requisition* and those grounds; and
- 8.1.3 the purchaser does not *serve* a notice waiving the *requisition within 14 days* after that *service*.

- 8.2 If the vendor does not comply with this contract (or a notice under or relating to it) in an essential respect, the purchaser can *terminate* by *servicing* a notice. After the *termination* –
- 8.2.1 the purchaser can recover the deposit and any other money paid by the purchaser under this contract;
- 8.2.2 the purchaser can sue the vendor to recover damages for breach of contract; and
- 8.2.3 if the purchaser has been in possession a *party* can claim for a reasonable adjustment.
- 9 Purchaser's default**
- If the purchaser does not comply with this contract (or a notice under or relating to it) in an essential respect, the vendor can *terminate* by *servicing* a notice. After the *termination* the vendor can –
- 9.1 keep or recover the deposit (to a maximum of 10% of the price);
- 9.2 hold any other money paid by the purchaser under this contract as security for anything recoverable under this clause –
- 9.2.1 for 12 months after the *termination*; or
- 9.2.2 if the vendor commences proceedings under this clause *within* 12 months, until those proceedings are concluded; and
- 9.3 sue the purchaser either –
- 9.3.1 where the vendor has resold the *property* under a contract made *within* 12 months after the *termination*, to recover –
- the deficiency on resale (with credit for any of the deposit kept or recovered and after allowance for any capital gains tax or goods and services tax payable on anything recovered under this clause); and
 - the reasonable costs and expenses arising out of the purchaser's non-compliance with this contract or the notice and of resale and any attempted resale; or
- 9.3.2 to recover damages for breach of contract.
- 10 Restrictions on rights of purchaser**
- 10.1 The purchaser cannot make a claim or *requisition* or *rescind* or *terminate* in respect of –
- 10.1.1 the ownership or location of any fence as defined in the Dividing Fences Act 1991;
- 10.1.2 a service for the *property* being a joint service or passing through another property, or any service for another property passing through the *property* ('service' includes air, communication, drainage, electricity, garbage, gas, oil, radio, sewerage, telephone, television or water service);
- 10.1.3 a wall being or not being a party wall in any sense of that term or the *property* being affected by an easement for support or not having the benefit of an easement for support;
- 10.1.4 any change in the *property* due to fair wear and tear before completion;
- 10.1.5 a promise, representation or statement about this contract, the *property* or the title, not set out or referred to in this contract;
- 10.1.6 a condition, exception, reservation or restriction in a Crown grant;
- 10.1.7 the existence of any authority or licence to explore or prospect for gas, minerals or petroleum;
- 10.1.8 any easement or restriction on use the substance of either of which is disclosed in this contract or any non-compliance with the easement or restriction on use; or
- 10.1.9 anything the substance of which is disclosed in this contract (except a caveat, charge, mortgage, priority notice or writ).
- 10.2 The purchaser cannot *rescind* or *terminate* only because of a defect in title to or quality of the inclusions.
- 10.3 *Normally*, the purchaser cannot make a claim or *requisition* or *rescind* or *terminate* or require the vendor to change the nature of the title disclosed in this contract (for example, to remove a caution evidencing qualified title, or to lodge a plan of survey as regards limited title).
- 11 Compliance with work orders**
- 11.1 *Normally*, the vendor must by completion comply with a *work order* made on or before the contract date and if this contract is completed the purchaser must comply with any other *work order*.
- 11.2 If the purchaser complies with a *work order*, and this contract is *rescinded* or *terminated*, the vendor must pay the expense of compliance to the purchaser.
- 12 Certificates and inspections**
- The vendor must do whatever is reasonably necessary to enable the purchaser, subject to the rights of any tenant –
- 12.1 to have the *property* inspected to obtain any certificate or report reasonably required;
- 12.2 to apply (if necessary in the name of the vendor) for –
- 12.2.1 any certificate that can be given in respect of the *property* under *legislation*; or
- 12.2.2 a copy of any approval, certificate, consent, direction, notice or order in respect of the *property* given under *legislation*, even if given after the contract date; and
- 12.3 to make 1 inspection of the *property* in the 3 days before a time appointed for completion.

13 Goods and services tax (GST)

- 13.1 Terms used in this clause which are not defined elsewhere in this contract and have a defined meaning in the *GST Act* have the same meaning in this clause.
- 13.2 *Normally*, if a *party* must pay the price or any other amount to the other *party* under this contract, GST is not to be added to the price or amount.
- 13.3 If under this contract a *party* must make an adjustment or payment for an expense of another party or pay an expense payable by or to a third party (for example, under clauses 14 or 20.7), the *party* must adjust or pay on completion any GST added to or included in the expense, but –
- 13.3.1 the amount of the expense must be reduced to the extent the party receiving the adjustment or payment (or the representative member of a GST group of which that party is a member) is entitled to an input tax credit for the expense; and
- 13.3.2 if the adjustment or payment under this contract is consideration for a taxable supply, an amount for GST must be added at the *GST rate*.
- 13.4 If this contract says this sale is the supply of a going concern –
- 13.4.1 the *parties* agree the supply of the *property* is a supply of a going concern;
- 13.4.2 the vendor must, between the contract date and completion, carry on the enterprise conducted on the land in a proper and business-like way;
- 13.4.3 if the purchaser is not registered by the date for completion, the *parties* must complete and the purchaser must pay on completion, in addition to the price, an amount being the price multiplied by the *GST rate* ("the retention sum"). The retention sum is to be held by the *depositholder* and dealt with as follows –
- if *within* 3 months of completion the purchaser *serves* a letter from the Australian Taxation Office stating the purchaser is registered with a date of effect of registration on or before completion, the *depositholder* is to pay the retention sum to the purchaser; but
 - if the purchaser does not *serve* that letter *within* 3 months of completion, the *depositholder* is to pay the retention sum to the vendor; and
- 13.4.4 if the vendor, despite clause 13.4.1, *serves* a letter from the Australian Taxation Office stating the vendor has to pay GST on the supply, the purchaser must pay to the vendor on demand the amount of GST assessed.
- 13.5 *Normally*, the vendor promises the margin scheme will not apply to the supply of the *property*.
- 13.6 If this contract says the margin scheme is to apply in making the taxable supply, the *parties* agree that the margin scheme is to apply to the sale of the *property*.
- 13.7 If this contract says the sale is not a taxable supply –
- 13.7.1 the purchaser promises that the *property* will not be used and represents that the purchaser does not intend the *property* (or any part of the *property*) to be used in a way that could make the sale a taxable supply to any extent; and
- 13.7.2 the purchaser must pay the vendor on completion in addition to the price an amount calculated by multiplying the price by the *GST rate* if this sale is a taxable supply to any extent because of –
- a breach of clause 13.7.1; or
 - something else known to the purchaser but not the vendor.
- 13.8 If this contract says this sale is a taxable supply in full and does not say the margin scheme applies to the *property*, the vendor must pay the purchaser on completion an amount of one-eleventh of the price if –
- 13.8.1 this sale is not a taxable supply in full; or
- 13.8.2 the margin scheme applies to the *property* (or any part of the *property*).
- 13.9 If this contract says this sale is a taxable supply to an extent –
- 13.9.1 clause 13.7.1 does not apply to any part of the *property* which is identified as being a taxable supply; and
- 13.9.2 the payments mentioned in clauses 13.7 and 13.8 are to be recalculated by multiplying the relevant payment by the proportion of the price which represents the value of that part of the *property* to which the clause applies (the proportion to be expressed as a number between 0 and 1). Any evidence of value must be obtained at the expense of the vendor.
- 13.10 *Normally*, on completion the vendor must give the recipient of the supply a tax invoice for any taxable supply by the vendor by or under this contract.
- 13.11 The vendor does not have to give the purchaser a tax invoice if the margin scheme applies to a taxable supply.
- 13.12 If the vendor is liable for GST on rents or profits due to issuing an invoice or receiving consideration before completion, any adjustment of those amounts must exclude an amount equal to the vendor's GST liability.
- 13.13 If the vendor *serves* details of a *GSTRW payment* which the purchaser must make, the purchaser does not have to complete earlier than 5 *business days* after that *service* and clause 21.3 does not apply to this provision.
- 13.14 If the purchaser must make a *GSTRW payment* the purchaser must, at least 2 *business days* before the date for completion, *serve* evidence of submission of a *GSTRW payment* notification form to the Australian Taxation Office by the purchaser or, if a direction under either clause 4.8 or clause 30.4 has been given, by the transferee named in the transfer the subject of that direction.

14 Adjustments

- 14.1 *Normally*, the vendor is entitled to the rents and profits and will be liable for all rates, water, sewerage and drainage service and usage charges, land tax, levies and all other periodic outgoings up to and including the *adjustment date* after which the purchaser will be entitled and liable.
- 14.2 The *parties* must make any necessary adjustment on completion, and –
- 14.2.1 the purchaser must provide the vendor with *adjustment figures* at least 2 *business days* before the date for completion; and
- 14.2.2 the vendor must confirm the *adjustment figures* at least 1 *business day* before the date for completion.
- 14.3 If an amount that is adjustable under this contract has been reduced under *legislation*, the *parties* must on completion adjust the reduced amount.
- 14.4 The *parties* must not adjust surcharge land tax (as defined in the Land Tax Act 1956) but must adjust any other land tax for the year current at the *adjustment date* –
- 14.4.1 only if land tax has been paid or is payable for the year (whether by the vendor or by a predecessor in title) and this contract says that land tax is adjustable;
- 14.4.2 by adjusting the amount that would have been payable if at the start of the year –
- the person who owned the land owned no other land;
 - the land was not subject to a special trust or owned by a non-concessional company; and
 - if the land (or part of it) had no separate taxable value, by calculating its separate taxable value on a proportional area basis.
- 14.5 The *parties* must not adjust any first home buyer choice property tax.
- 14.6 If any other amount that is adjustable under this contract relates partly to the land and partly to other land, the *parties* must adjust it on a proportional area basis.
- 14.7 If on completion the last bill for a water, sewerage or drainage usage charge is for a period ending before the *adjustment date*, the vendor is liable for an amount calculated by dividing the bill by the number of days in the period then multiplying by the number of unbilled days up to and including the *adjustment date*.
- 14.8 The vendor is liable for any amount recoverable for work started on or before the contract date on the *property* or any adjoining footpath or road.

15 Date for completion

The *parties* must complete by the date for completion and, if they do not, a *party* can serve a notice to complete if that *party* is otherwise entitled to do so.

16 Completion

• Vendor

- 16.1 *Normally*, on completion the vendor must cause the legal title to the *property* (being the estate disclosed in this contract) to pass to the purchaser free of any charge, mortgage or other interest, subject to any necessary registration.
- 16.2 The legal title to the *property* does not pass before completion.
- 16.3 If the vendor gives the purchaser a document (other than the transfer) that needs to be lodged for registration, the vendor must pay the lodgment fee to the purchaser.
- 16.4 If a *party* serves a land tax certificate showing a charge on any of the land, by completion the vendor must do all things and pay all money required so that the charge is no longer effective against the land.

• Purchaser

- 16.5 On completion the purchaser must pay to the vendor –
- 16.5.1 the price less any –
- deposit paid;
 - *FRCGW remittance* payable;
 - *GSTRW payment*; and
 - amount payable by the vendor to the purchaser under this contract; and
- 16.5.2 any other amount payable by the purchaser under this contract.
- 16.6 If any of the deposit is not covered by a *deposit-bond*, at least 1 *business day* before the date for completion the purchaser must give the vendor an order signed by the purchaser authorising the *depositholder* to account to the vendor for the deposit, to be held by the vendor in escrow until completion.
- 16.7 On completion the deposit belongs to the vendor.

17 Possession

- 17.1 *Normally*, the vendor must give the purchaser vacant possession of the *property* on completion.
- 17.2 The vendor does not have to give vacant possession if –
- 17.2.1 this contract says that the sale is subject to existing tenancies; and
- 17.2.2 the contract discloses the provisions of the tenancy (for example, by attaching a copy of the lease and any relevant memorandum or variation).
- 17.3 *Normally*, the purchaser can claim compensation (before or after completion) or *rescind* if any of the land is affected by a protected tenancy (a tenancy affected by Schedule 2, Part 7 of the Residential Tenancies Act 2010).

18 Possession before completion

- 18.1 This clause applies only if the vendor gives the purchaser possession of the *property* before completion.
- 18.2 The purchaser must not before completion –
- 18.2.1 let or part with possession of any of the *property*;
 - 18.2.2 make any change or structural alteration or addition to the *property*; or
 - 18.2.3 contravene any agreement between the *parties* or any direction, document, *legislation*, notice or order affecting the *property*.
- 18.3 The purchaser must until completion –
- 18.3.1 keep the *property* in good condition and repair having regard to its condition at the giving of possession; and
 - 18.3.2 allow the vendor or the vendor's authorised representative to enter and inspect it at all reasonable times.
- 18.4 The risk as to damage to the *property* passes to the purchaser immediately after the purchaser enters into possession.
- 18.5 If the purchaser does not comply with this clause, then without affecting any other right of the vendor –
- 18.5.1 the vendor can before completion, without notice, remedy the non-compliance; and
 - 18.5.2 if the vendor pays the expense of doing this, the purchaser must pay it to the vendor with interest at the rate prescribed under s101 Civil Procedure Act 2005.
- 18.6 If this contract is *rescinded* or *terminated* the purchaser must immediately vacate the *property*.
- 18.7 If the *parties* or their *solicitors* on their behalf do not agree in writing to a fee or rent, none is payable.

19 Rescission of contract

- 19.1 If this contract expressly gives a *party* a right to *rescind*, the *party* can exercise the right –
- 19.1.1 only by *servicing* a notice before completion; and
 - 19.1.2 in spite of any making of a claim or *requisition*, any attempt to satisfy a claim or *requisition*, any arbitration, litigation, mediation or negotiation or any giving or taking of possession.
- 19.2 *Normally*, if a *party* exercises a right to *rescind* expressly given by this contract or any *legislation* –
- 19.2.1 the deposit and any other money paid by the purchaser under this contract must be refunded;
 - 19.2.2 a *party* can claim for a reasonable adjustment if the purchaser has been in possession;
 - 19.2.3 a *party* can claim for damages, costs or expenses arising out of a breach of this contract; and
 - 19.2.4 a *party* will not otherwise be liable to pay the other *party* any damages, costs or expenses.

20 Miscellaneous

- 20.1 The *parties* acknowledge that anything stated in this contract to be attached was attached to this contract by the vendor before the purchaser signed it and is part of this contract.
- 20.2 Anything attached to this contract is part of this contract.
- 20.3 An area, bearing or dimension in this contract is only approximate.
- 20.4 If a *party* consists of 2 or more persons, this contract benefits and binds them separately and together.
- 20.5 A *party's solicitor* can receive any amount payable to the *party* under this contract or direct in writing that it is to be paid to another person.
- 20.6 A document under or relating to this contract is –
- 20.6.1 signed by a *party* if it is signed by the *party* or the *party's solicitor* (apart from a direction under clause 4.8 or clause 30.4);
 - 20.6.2 *served* if it is *served* by the *party* or the *party's solicitor*;
 - 20.6.3 *served* if it is *served* on the *party's solicitor*, even if the *party* has died or any of them has died;
 - 20.6.4 *served* if it is *served* in any manner provided in s170 of the Conveyancing Act 1919;
 - 20.6.5 *served* if it is sent by email or fax to the *party's solicitor*, unless in either case it is not received;
 - 20.6.6 *served* on a person if it (or a copy of it) comes into the possession of the person;
 - 20.6.7 *served* at the earliest time it is *served*, if it is *served* more than once; and
 - 20.6.8 *served* if it is provided to or by the *party's solicitor* or an *authorised Subscriber* by means of an *Electronic Workspace* created under clause 4. However, this does not apply to a notice making an obligation essential, or a notice of *rescission* or *termination*.
- 20.7 An obligation to pay an expense of another *party* of doing something is an obligation to pay –
- 20.7.1 if the *party* does the thing personally - the reasonable cost of getting someone else to do it; or
 - 20.7.2 if the *party* pays someone else to do the thing - the amount paid, to the extent it is reasonable.
- 20.8 Rights under clauses 4, 11, 13, 14, 17, 24, 30 and 31 continue after completion, whether or not other rights continue.
- 20.9 The vendor does not promise, represent or state that the purchaser has any cooling off rights.
- 20.10 The vendor does not promise, represent or state that any attached survey report is accurate or current.
- 20.11 A reference to any *legislation* (including any percentage or rate specified in *legislation*) is also a reference to any corresponding later *legislation*.
- 20.12 Each *party* must do whatever is necessary after completion to carry out the *party's* obligations under this contract.
- 20.13 Neither taking possession nor *servicing* a transfer of itself implies acceptance of the *property* or the title.

- 20.14 The details and information provided in this contract (for example, on pages 1 - 4) are, to the extent of each *party's* knowledge, true, and are part of this contract.
- 20.15 Where this contract provides for choices, a choice in BLOCK CAPITALS applies unless a different choice is marked.
- 20.16 Each *party* consents to –
- 20.16.1 any *party* signing this contract electronically; and
- 20.16.2 the making of this contract by the exchange of counterparts delivered by email, or by such other electronic means as may be agreed by the *parties*.
- 20.17 Each *party* agrees that electronic signing by a *party* identifies that *party* and indicates that *party's* intention to be bound by this contract.

21 Time limits in these provisions

- 21.1 If the time for something to be done or to happen is not stated in these provisions, it is a reasonable time.
- 21.2 If there are conflicting times for something to be done or to happen, the latest of those times applies.
- 21.3 The time for one thing to be done or to happen does not extend the time for another thing to be done or to happen.
- 21.4 If the time for something to be done or to happen is the 29th, 30th or 31st day of a month, and the day does not exist, the time is instead the last day of the month.
- 21.5 If the time for something to be done or to happen is a day that is not a *business day*, the time is extended to the next *business day*, except in the case of clauses 2 and 3.2.
- 21.6 *Normally*, the time by which something must be done is fixed but not essential.

22 Foreign Acquisitions and Takeovers Act 1975

- 22.1 The purchaser promises that the Commonwealth Treasurer cannot prohibit and has not prohibited the transfer under the Foreign Acquisitions and Takeovers Act 1975.
- 22.2 This promise is essential and a breach of it entitles the vendor to *terminate*.

23 Strata or community title

• Definitions and modifications

- 23.1 This clause applies only if the land (or part of it) is a lot in a strata, neighbourhood, precinct or community scheme (or on completion is to be a lot in a scheme of that kind).
- 23.2 In this contract –
- 23.2.1 'change', in relation to a scheme, means –
- a registered or registrable change from by-laws set out in this contract;
 - a change from a development contract or management statement set out in this contract; or
 - a change in the boundaries of common property;
- 23.2.2 'common property' includes association property for the scheme or any higher scheme;
- 23.2.3 'contribution' includes an amount payable under a by-law;
- 23.2.4 'information certificate' includes a certificate under s184 Strata Schemes Management Act 2015 and s174 Community Land Management Act 2021;
- 23.2.5 'interest notice' includes a strata interest notice under s22 Strata Schemes Management Act 2015 and an association interest notice under s20 Community Land Management Act 2021;
- 23.2.6 'normal expenses', in relation to an owners corporation for a scheme, means normal operating expenses usually payable from the administrative fund of an owners corporation for a scheme of the same kind;
- 23.2.7 'owners corporation' means the owners corporation or the association for the scheme or any higher scheme;
- 23.2.8 'the *property*' includes any interest in common property for the scheme associated with the lot; and
- 23.2.9 'special expenses', in relation to an owners corporation, means its actual, contingent or expected expenses, except to the extent they are –
- normal expenses;
 - due to fair wear and tear;
 - disclosed in this contract; or
 - covered by moneys held in the capital works fund.
- 23.3 Clauses 11, 14.8 and 18.4 do not apply to an obligation of the owners corporation, or to property insurable by it.
- 23.4 Clauses 14.4.2 and 14.6 apply but on a unit entitlement basis instead of an area basis.
- ### • Adjustments and liability for expenses
- 23.5 The *parties* must adjust under clause 14.1 –
- 23.5.1 a regular periodic contribution;
- 23.5.2 a contribution which is not a regular periodic contribution but is disclosed in this contract; and
- 23.5.3 on a unit entitlement basis, any amount paid by the vendor for a normal expense of the owners corporation to the extent the owners corporation has not paid the amount to the vendor.

- 23.6 If a contribution is not a regular periodic contribution and is not disclosed in this contract –
- 23.6.1 the vendor is liable for it if it was determined on or before the contract date, even if it is payable by instalments; and
- 23.6.2 the purchaser is liable for all contributions determined after the contract date.
- 23.7 The vendor must pay or allow to the purchaser on completion the amount of any unpaid contributions for which the vendor is liable under clause 23.6.1.
- 23.8 *Normally*, the purchaser cannot make a claim or *requisition* or *rescind* or *terminate* in respect of –
- 23.8.1 an existing or future actual, contingent or expected expense of the owners corporation;
- 23.8.2 a proportional unit entitlement of the lot or a relevant lot or former lot, apart from a claim under clause 6; or
- 23.8.3 a past or future change in the scheme or a higher scheme.
- 23.9 However, the purchaser can *rescind* if –
- 23.9.1 the special expenses of the owners corporation at the later of the contract date and the creation of the owners corporation when calculated on a unit entitlement basis (and, if more than one lot or a higher scheme is involved, added together), less any contribution paid by the vendor, are more than 1% of the price;
- 23.9.2 in the case of the lot or a relevant lot or former lot in a higher scheme, a proportional unit entitlement for the lot is disclosed in this contract but the lot has a different proportional unit entitlement at the contract date or at any time before completion;
- 23.9.3 a change before the contract date or before completion in the scheme or a higher scheme materially prejudices the purchaser and is not disclosed in this contract; or
- 23.9.4 a resolution is passed by the owners corporation before the contract date or before completion to give to the owners in the scheme for their consideration a strata renewal plan that has not lapsed at the contract date and there is not attached to this contract a strata renewal proposal or the strata renewal plan.
- **Notices, certificates and inspections**
- 23.10 Before completion, the purchaser must *serve* a copy of an interest notice addressed to the owners corporation and signed by the purchaser.
- 23.11 After completion, the purchaser must insert the date of completion in the interest notice and send it to the owners corporation.
- 23.12 The vendor can complete and send the interest notice as agent for the purchaser.
- 23.13 The vendor must *serve* at least 7 days before the date for completion, an information certificate for the lot, the scheme or any higher scheme which relates to a period in which the date for completion falls.
- 23.14 The purchaser does not have to complete earlier than 7 days after *service* of the information certificate and clause 21.3 does not apply to this provision. On completion the purchaser must pay the vendor the prescribed fee for the information certificate.
- 23.15 The vendor authorises the purchaser to apply for the purchaser's own information certificate.
- 23.16 The vendor authorises the purchaser to apply for and make an inspection of any record or other document in the custody or control of the owners corporation or relating to the scheme or any higher scheme.
- **Meetings of the owners corporation**
- 23.17 If a general meeting of the owners corporation is convened before completion –
- 23.17.1 if the vendor receives notice of it, the vendor must immediately notify the purchaser of it; and
- 23.17.2 after the expiry of any cooling off period, the purchaser can require the vendor to appoint the purchaser (or the purchaser's nominee) to exercise any voting rights of the vendor in respect of the lot at the meeting.

24 Tenancies

- 24.1 If a tenant has not made a payment for a period preceding or current at the *adjustment date* –
- 24.1.1 for the purposes of clause 14.2, the amount is to be treated as if it were paid; and
- 24.1.2 the purchaser assigns the debt to the vendor on completion and will if required give a further assignment at the vendor's expense.
- 24.2 If a tenant has paid in advance of the *adjustment date* any periodic payment in addition to rent, it must be adjusted as if it were rent for the period to which it relates.
- 24.3 If the *property* is to be subject to a tenancy on completion or is subject to a tenancy on completion –
- 24.3.1 the vendor authorises the purchaser to have any accounting records relating to the tenancy inspected and audited and to have any other document relating to the tenancy inspected;
- 24.3.2 the vendor must *serve* any information about the tenancy reasonably requested by the purchaser before or after completion; and
- 24.3.3 *normally*, the purchaser can claim compensation (before or after completion) if –
- a disclosure statement required by the Retail Leases Act 1994 was not given when required;
 - such a statement contained information that was materially false or misleading;
 - a provision of the lease is not enforceable because of a non-disclosure in such a statement; or
 - the lease was entered into in contravention of the Retail Leases Act 1994.

- 24.4 If the *property* is subject to a tenancy on completion –
- 24.4.1 the vendor must allow or transfer –
- any remaining bond money or any other security against the tenant's default (to the extent the security is transferable);
 - any money in a fund established under the lease for a purpose and compensation for any money in the fund or interest earned by the fund that has been applied for any other purpose; and
 - any money paid by the tenant for a purpose that has not been applied for that purpose and compensation for any of the money that has been applied for any other purpose;
- 24.4.2 if the security is not transferable, each *party* must do whatever is reasonably necessary to cause a replacement security to issue for the benefit of the purchaser and the vendor must hold the original security on trust for the benefit of the purchaser until the replacement security issues;
- 24.4.3 the vendor must give to the purchaser –
- at least 2 *business days* before the date for completion, a proper notice of the transfer (an attornment notice) addressed to the tenant, to be held by the purchaser in escrow until completion;
 - any certificate given under the Retail Leases Act 1994 in relation to the tenancy;
 - a copy of any disclosure statement given under the Retail Leases Act 1994;
 - a copy of any document served on the tenant under the lease and written details of its service, if the document concerns the rights of the landlord or the tenant after completion; and
 - any document served by the tenant under the lease and written details of its service, if the document concerns the rights of the landlord or the tenant after completion;
- 24.4.4 the vendor must comply with any obligation to the tenant under the lease, to the extent it is to be complied with by completion; and
- 24.4.5 the purchaser must comply with any obligation to the tenant under the lease, to the extent that the obligation is disclosed in this contract and is to be complied with after completion.

25 Qualified title, limited title and old system title

- 25.1 This clause applies only if the land (or part of it) –
- 25.1.1 is under qualified, limited or old system title; or
- 25.1.2 on completion is to be under one of those titles.
- 25.2 The vendor must *serve* a proper abstract of title *within 7 days* after the contract date.
- 25.3 If an abstract of title or part of an abstract of title is attached to this contract or has been lent by the vendor to the purchaser before the contract date, the abstract or part is *served* on the contract date.
- 25.4 An abstract of title can be or include a list of documents, events and facts arranged (apart from a will or codicil) in date order, if the list in respect of each document –
- 25.4.1 shows its date, general nature, names of parties and any registration number; and
- 25.4.2 has attached a legible photocopy of it or of an official or registration copy of it.
- 25.5 An abstract of title –
- 25.5.1 must start with a good root of title (if the good root of title must be at least 30 years old, this means 30 years old at the contract date);
- 25.5.2 in the case of a leasehold interest, must include an abstract of the lease and any higher lease;
- 25.5.3 *normally*, need not include a Crown grant; and
- 25.5.4 need not include anything evidenced by the Register kept under the Real Property Act 1900.
- 25.6 In the case of land under old system title –
- 25.6.1 in this contract 'transfer' means conveyance;
- 25.6.2 the purchaser does not have to *serve* the transfer until after the vendor has *served* a proper abstract of title; and
- 25.6.3 each vendor must give proper covenants for title as regards that vendor's interest.
- 25.7 In the case of land under limited title but not under qualified title –
- 25.7.1 *normally*, the abstract of title need not include any document which does not show the location, area or dimensions of the land (for example, by including a metes and bounds description or a plan of the land);
- 25.7.2 clause 25.7.1 does not apply to a document which is the good root of title; and
- 25.7.3 the vendor does not have to provide an abstract if this contract contains a delimitation plan (whether in registrable form or not).
- 25.8 On completion the vendor must give the purchaser any *document of title* that relates only to the *property*.
- 25.9 If on completion the vendor has possession or control of a *document of title* that relates also to other property, the vendor must produce it as and where necessary.
- 25.10 The vendor must give a proper covenant to produce where relevant.
- 25.11 The vendor does not have to produce or covenant to produce a document that is not in the possession of the vendor or a mortgagee.
- 25.12 If the vendor is unable to produce an original document in the chain of title, the purchaser will accept a photocopy from the *Land Registry* of the registration copy of that document.

26 Crown purchase money

- 26.1 This clause applies only if purchase money is payable to the Crown, whether or not due for payment.
 26.2 The vendor is liable for the money, except to the extent this contract says the purchaser is liable for it.
 26.3 To the extent the vendor is liable for it, the vendor is liable for any interest until completion.
 26.4 To the extent the purchaser is liable for it, the *parties* must adjust any interest under clause 14.

27 Consent to transfer

- 27.1 This clause applies only if the land (or part of it) cannot be transferred without consent under *legislation* or a *planning agreement*.
 27.2 The purchaser must properly complete and then *serve* the purchaser's part of an application for consent to transfer of the land (or part of it) *within 7 days* after the contract date.
 27.3 The vendor must apply for consent *within 7 days* after *service* of the purchaser's part.
 27.4 If consent is refused, either *party* can *rescind*.
 27.5 If consent is given subject to one or more conditions that will substantially disadvantage a *party*, then that *party* can *rescind within 7 days* after receipt by or *service* upon the *party* of written notice of the conditions.
 27.6 If consent is not given or refused –
 27.6.1 *within 42 days* after the purchaser *serves* the purchaser's part of the application, the purchaser can *rescind*; or
 27.6.2 *within 30 days* after the application is made, either *party* can *rescind*.
 27.7 Each period in clause 27.6 becomes 90 days if the land (or part of it) is –
 27.7.1 under a *planning agreement*; or
 27.7.2 in the Western Division.
 27.8 If the land (or part of it) is described as a lot in an unregistered plan, each time in clause 27.6 becomes the later of the time and 35 days after creation of a separate folio for the lot.
 27.9 The date for completion becomes the later of the date for completion and 14 days after *service* of the notice granting consent to transfer.

28 Unregistered plan

- 28.1 This clause applies only if some of the land is described as a lot in an unregistered plan.
 28.2 The vendor must do whatever is reasonably necessary to have the plan registered *within 6 months* after the contract date, with or without any minor alteration to the plan or any document to be lodged with the plan validly required or made under *legislation*.
 28.3 If the plan is not registered *within* that time and in that manner –
 28.3.1 the purchaser can *rescind*; and
 28.3.2 the vendor can *rescind*, but only if the vendor has complied with clause 28.2 and with any *legislation* governing the rescission.
 28.4 Either *party* can *serve* notice of the registration of the plan and every relevant lot and plan number.
 28.5 The date for completion becomes the later of the date for completion and 21 days after *service* of the notice.
 28.6 Clauses 28.2 and 28.3 apply to another plan that is to be registered before the plan is registered.

29 Conditional contract

- 29.1 This clause applies only if a provision says this contract or completion is conditional on an event, but does not apply to an event to which clause 28 applies.
 29.2 If the time for the event to happen is not stated, the time is 42 days after the contract date.
 29.3 If this contract says the provision is for the benefit of a *party*, then it benefits only that *party*.
 29.4 If anything is necessary to make the event happen, each *party* must do whatever is reasonably necessary to cause the event to happen.
 29.5 A *party* can *rescind* under this clause only if the *party* has substantially complied with clause 29.4.
 29.6 If the event involves an approval and the approval is given subject to a condition that will substantially disadvantage a *party* who has the benefit of the provision, the *party* can *rescind within 7 days* after either *party* *serves* notice of the condition.
 29.7 If the *parties* can lawfully complete without the event happening –
 29.7.1 if the event does not happen *within* the time for it to happen, a *party* who has the benefit of the provision can *rescind within 7 days* after the end of that time;
 29.7.2 if the event involves an approval and an application for the approval is refused, a *party* who has the benefit of the provision can *rescind within 7 days* after either *party* *serves* notice of the refusal; and
 29.7.3 the date for completion becomes the later of the date for completion and 21 days after the earliest of –
 • either *party* *serving* notice of the event happening;
 • every *party* who has the benefit of the provision *serving* notice waiving the provision; or
 • the end of the time for the event to happen.

- 29.8 If the *parties* cannot lawfully complete without the event happening –
- 29.8.1 if the event does not happen *within* the time for it to happen, either *party* can *rescind*;
- 29.8.2 if the event involves an approval and an application for the approval is refused, either *party* can *rescind*;
- 29.8.3 the date for completion becomes the later of the date for completion and 21 days after either *party* serves notice of the event happening.
- 29.9 A *party* cannot *rescind* under clauses 29.7 or 29.8 after the event happens.

30 Manual transaction

- 30.1 This clause applies if this transaction is to be conducted as a *manual transaction*.
- **Transfer**
- 30.2 *Normally*, the purchaser must *serve* the transfer at least 7 days before the date for completion.
- 30.3 If any information needed for the transfer is not disclosed in this contract, the vendor must *serve* it.
- 30.4 If the purchaser *serves* a transfer and the transferee is not the purchaser, the purchaser must give the vendor a direction signed by the purchaser personally for that transfer.
- 30.5 The vendor can require the purchaser to include a covenant or easement in the transfer only if this contract contains the wording of the proposed covenant or easement, and a description of the land burdened and benefited.
- **Place for completion**
- 30.6 *Normally*, the *parties* must complete at the completion address, which is –
- 30.6.1 if a special completion address is stated in this contract - that address; or
- 30.6.2 if none is stated, but a first mortgagee is disclosed in this contract and the mortgagee would usually discharge the mortgage at a particular place - that place; or
- 30.6.3 in any other case - the vendor's *solicitor's* address stated in this contract.
- 30.7 The vendor by reasonable notice can require completion at another place, if it is in NSW, but the vendor must pay the purchaser's additional expenses, including any agency or mortgagee fee.
- 30.8 If the purchaser requests completion at a place that is not the completion address, and the vendor agrees, the purchaser must pay the vendor's additional expenses, including any agency or mortgagee fee.
- **Payments on completion**
- 30.9 On completion the purchaser must pay to the vendor the amounts referred to in clauses 16.5.1 and 16.5.2, by cash (up to \$2,000) or *settlement cheque*.
- 30.10 *Normally*, the vendor can direct the purchaser to produce a *settlement cheque* on completion to pay an amount adjustable under this contract and if so –
- 30.10.1 the amount is to be treated as if it were paid; and
- 30.10.2 the *cheque* must be forwarded to the payee immediately after completion (by the purchaser if the *cheque* relates only to the *property* or by the vendor in any other case).
- 30.11 If the vendor requires more than 5 *settlement cheques*, the vendor must pay \$10 for each extra *cheque*.
- 30.12 If the purchaser must make a *GSTRW payment* the purchaser must –
- 30.12.1 produce on completion a *settlement cheque* for the *GSTRW payment* payable to the Deputy Commissioner of Taxation;
- 30.12.2 forward the *settlement cheque* to the payee immediately after completion; and
- 30.12.3 *serve* evidence of receipt of payment of the *GSTRW payment* and a copy of the settlement date confirmation form submitted to the Australian Taxation Office.
- 30.13 If the purchaser must pay an *FRCGW remittance*, the purchaser must –
- 30.13.1 produce on completion a *settlement cheque* for the *FRCGW remittance* payable to the Deputy Commissioner of Taxation;
- 30.13.2 forward the *settlement cheque* to the payee immediately after completion; and
- 30.13.3 *serve* evidence of receipt of payment of the *FRCGW remittance*.

31 Foreign Resident Capital Gains Withholding

- 31.1 This clause applies only if –
- 31.1.1 the sale is not an excluded transaction within the meaning of s14-215 of Schedule 1 to the *TA Act*; and
- 31.1.2 a *clearance certificate* in respect of every vendor is not attached to this contract.
- 31.2 If the vendor *serves* any *clearance certificate* or *variation*, the purchaser does not have to complete earlier than 5 *business days* after that *service* and clause 21.3 does not apply to this provision.
- 31.3 The purchaser must at least 2 *business days* before the date for completion, *serve* evidence of submission of a purchaser payment notification to the Australian Taxation Office by the purchaser or, if a direction under either clause 4.8 or clause 30.4 has been given, by the transferee named in the transfer the subject of that direction.
- 31.4 The vendor cannot refuse to complete if the purchaser complies with clause 31.3 and, as applicable, clauses 4.10 or 30.13.
- 31.5 If the vendor *serves* in respect of every vendor either a *clearance certificate* or a *variation* to 0.00 percent, clauses 31.3 and 31.4 do not apply.

32 Residential off the plan contract

- 32.1 This clause applies if this contract is an off the plan contract within the meaning of Division 10 of Part 4 of the Conveyancing Act 1919 (the Division).
- 32.2 No provision of this contract has the effect of excluding, modifying or restricting the operation of the Division.
- 32.3 If the purchaser makes a claim for compensation under the terms prescribed by sections 4 to 6 of Schedule 3 to the Conveyancing (Sale of Land) Regulation 2022 –
- 32.3.1 the purchaser cannot make a claim under this contract about the same subject matter, including a claim under clauses 6 or 7; and
 - 32.3.2 the claim for compensation is not a claim under this contract.

54A TRANSFIELD AVE EDGEWORTH NSW 2205

ADDITIONAL CONDITIONS

Vendor: Egon James Kuster and Rebecca Anne Kuster

Purchaser:

Property: 54A Transfield Avenue, Edgeworth 2285

32. Intentionally deleted

33. Amendments to the standard contract conditions

- 33.2 Clause 7.1.1 is deleted.
- 33.3 Clause 8.1.1 is amended by deleting the words "on reasonable grounds".
- 33.4 Clause 14 is hereby varied by the addition of the following sentence after the word "liable":
 - 14.1.1 The amounts and figures for water consumption furnished by the relevant water rating authority, even if estimated or provisional, shall be conclusive for the purpose of such adjustment.
- 33.5 Clause 14.4.2 is deleted.
- 33.6 Clause 18 is hereby varied by the addition of the following clause:
 - 18.8 The Purchaser cannot make a claim or requisition or delay completion of this Contract after entering into possession of the property.
- 33.7 Clause 25.1.1 is amended by deleting the word "limited".
- 33.8 Clause 25.7 is deleted.

34. Warranty as to Agent

The Purchaser hereby indemnifies and agrees that at all times for the maximum period permitted by law to indemnify and keep indemnified the Vendor from and against any claim, commission, charge, expense, action, suit, proceedings, cost or demand of whatsoever nature by any real estate agent or employee of such real estate agent (other than the Vendor's agent named herein) who establishes that the Purchaser was introduced to the Vendor or to the property by any other agent or employee of him.

35. Deposit of less than 10%

The Vendor and the Purchaser agree that if:

- (a) The Purchaser defaults in the observance or performance of any obligation hereunder which is or the performance of which has become essential; and
- (b) The Purchaser has paid a deposit of less than ten per centum (10%) of the purchase price; and
- (c) the Vendor has terminated this Contract,

then the Vendor shall be entitled to recover from the Purchaser an amount equal to ten per centum (10%) of the purchase price less the deposit paid as liquidated damages and it is agreed that this right shall be in addition to and shall not limit any other remedies available to the Vendor herein contained or implied notwithstanding any rule of Law or equity to the contrary. This clause shall not merge upon termination of this Contract.

36. Deposit payable by instalments

If a cooling off period applies to this contract, the purchaser may pay the deposit holder in 2 instalments as follows:

- (a) On or before the date of this contract 0.25% of the agreed purchase price; and

- (b) In the event of the purchaser proceeding with the purchase on or before 5.00 pm on the fifth business day after the date of this contract a further 9.75% of the agreed purchase price.

37. Subject to finance

- (a) ~~With the written consent of the vendor or their representative, it is a condition of this contract that the purchaser shall obtain approval in writing of finance for the purchase of the property in accordance with this clause and The Schedule.~~
- (b) ~~The purchaser shall promptly, at the purchaser's expense:~~
- ~~i. apply for finance in accordance with The Schedule;~~
 - ~~ii. make and pursue the finance application, pay all fees, supply all particulars, certificates and valuations, and do all other things as may reasonably be required for the purpose of the application;~~
 - ~~iii. inform the vendor regarding the progress of the finance application whenever reasonably requested to do so by or on behalf of the vendor;~~
 - ~~iv. notify the vendor in writing after receipt of written approval or refusal from the Lender.~~
- (c) ~~This clause is for the benefit of the purchaser who may, prior to rescission of this agreement, waive the benefit thereof.~~
- (d) ~~If without default on the part of the purchaser the finance approval in writing has not been obtained within the time limited in The Schedule, either party shall be entitled by notice served upon the other to rescind this agreement, provided that if the purchaser has obtained the finance approval in writing prior to service of such notice of rescission by either party, neither party shall thereafter be entitled to rescind this agreement for want of such approval.~~
- (e) ~~Upon rescission pursuant to this Clause the provisions of Clause 19 shall apply.~~
- ~~i. In the event of a rescission under the terms of this clause, the purchaser shall forfeit to the vendor the sum equivalent to 0.25% of the purchase price being an estimate of the vendor's costs associated with the preparation of the contract and other expenses associated.~~
 - ~~ii. In order for the purchaser to rescind this Contract pursuant provision (d) above, the notice of rescission must be received by the Vendor's solicitor no later than 5.00pm on the last day the purchaser has to obtain finance approval as determined by item 3 in the Schedule below.~~

THE SCHEDULE

- ~~1. Lender:~~
- ~~2. Amount of Loan:~~
- ~~3. Number of (calendar) days after making this agreement for obtaining written approval of finance: ten (10) calendar days~~

38. Release of deposit

~~The purchasers agree and acknowledge that by their execution of this contract they irrevocably authorise the vendor's agent to release to the vendors such part of the deposit moneys as they shall require for the purpose of settlement, a deposit and/or stamp duty on any piece of real estate that the vendors negotiate to purchase between the date hereof and the date of settlement hereof.~~

39. Warranty by Purchaser

The Purchaser warrants to the vendor:

- (a) The purchaser is not an undischarged bankrupt and has not committed any act of bankruptcy;

- (b) The Purchaser does not require the approval or consent of the Foreign Investment Review Board to purchase the property;
- (c) The Purchaser is over the age of 18 years.

The Purchaser acknowledges that the Vendor relies on this warranty in entering into this Contract and the Purchaser will indemnify and keep indemnified the Vendor against any loss, expense, fine, damage, penalty and/or liability arising out of or as a consequence of a breach of this warranty by the Purchaser. This indemnity will not merge on completion.

40. Mine Subsidence Board

The Purchaser may rescind this Contract if the owner of the improvements on the land is not entitled, as at the date of this Contract, to claim compensation from the Mine Subsidence Board in respect of any damage to the land and/or improvements arising from mine subsidence and written communication from the Mine Subsidence Board to that effect shall be conclusive for the purposes of this condition.

41. Purchaser acknowledgements

The Purchaser acknowledges that they are purchasing the property:

- (a) In its present condition and state of repair;
- (b) Subject to all defects latent and patent;
- (c) Subject to any infestations or dilapidation;
- (d) Subject to all existing water, sewerage, drainage and plumbing services and connection in respect of the property;
- (e) Subject to any non-compliance, that is disclosed herein, with the Local Government Act or any Ordinance under that Act in respect of any building on the land;
- (f) With the items specified as "inclusions" on the front page of this Contract that are not new;
- (g) Without any representation or warranty from or on behalf of the Vendor as to the state of repair or condition of any inclusions, the Vendor will not be responsible for any mechanical breakdown in respect of any such items;
- (h) Subject to the state of repair and condition of any inclusions as at the date of exchange subject to a reasonable wear and tear between the date hereof and the date on which the Purchaser is entitled to take possession of the property; and
- (i) Subject to title of the inclusions being passed on completion of this Contract and the Vendor shall not be required to give formal delivery in respect thereof.

The Purchaser agrees not to seek, terminate, rescind or make any objection or requisition or claim for compensation arising out of any of the matters covered by this clause.

42. Representations and warranties negated

Subject to the provisions of Section 52A of the Conveyancing Act, 1919, the Purchaser warrants that, unless otherwise stated in this Contract, the Purchaser has not entered into this Contract in reliance on any statement, representation, promise or warranty made by the Vendor or on behalf of the Vendor including without limitation, any statement, representation, promise or warranty in respect of the nature or fitness or suitability for any purpose of the property or any financial return or income to be derived from the Property and the terms and conditions set out in this Contract contain the entire agreement in relation to the property as concluded between the parties.

The Purchaser further acknowledges that the Purchaser has not been induced to enter into this Contract by any representation, whether verbal or otherwise made by or on behalf of the Vendor which is not set out in the Contract.

43. Covenants

Notwithstanding anything in this Contract to the contrary, the Purchaser agrees not to raise any requisition or objection or make any claim for compensation or rescind or terminate this Contract in breach of any covenant relating to the property. The Purchaser is satisfied as to the terms of the covenants and has inspected the property as is satisfied as to the compliance or non-compliance with such covenants and accepts any such non-compliance. Covenant in this clause excludes any restrictive covenant.

44. Claims by the Purchaser

Notwithstanding the provisions of Clauses 5, 6 and 7 hereof the parties expressly agree that any claim (whether for compensation or not) shall be deemed to be an objection or requisition for the purpose of Clause 7 and 8 hereto entitling the Vendor to rescind this Contract.

45. Late completion

In the event that completion of this Contract shall not take place within the time allowed for completion in Clause 15 hereof, other than due to any act or omission on the part of the Vendor, the Purchaser hereby acknowledges and agrees that the Vendor is entitled to recover from the Purchaser as liquidated damages on completion of this Contract:

- (a) Interest on the balance of the purchase price payable hereunder at the rate of ten per centum (10%) per annum for the period between the expiration of the time allowed for completion pursuant to Clause 15 hereof and the actual date of completion, with such interest being calculated on a daily basis and added to the balance payable on completion;
- (b) The sum of Three Hundred and Thirty Dollars (\$330.00) to cover legal costs and other expenses incurred as a consequence of the delay as a genuine pre-estimate of those additional expenses allowed by the Purchaser as an additional adjustment on completion;
- (c) The Parties agree that payment of such sums is made on account of damages and that the Vendor shall not be required to complete this Contract unless the said sums are paid on completion;
- (d) The Vendor's rights pursuant to this clause do not limit any other rights the Vendor may have against the Purchaser as a result of the Purchaser's failure to complete this Contract in accordance with the provisions of this Contract.

46. Notice to complete

- (a) It is expressly agreed between the parties hereto that in circumstances justifying the issue of a Notice to Complete fourteen (14) days shall be deemed to be reasonable and sufficient notice for that purpose;
- (b) Further, in the circumstances justifying the issue of a Notice to Complete by the Vendor, then the Purchaser shall be liable for the sum of three hundred & thirty dollars (\$330.00) as the agreed reasonable legal expenses incurred by the Vendor as a result of having to issue such Notice to Complete.
- (c) The Purchaser's obligation to pay the sum referred to in clause 42(b) hereof is an essential term of this contract and shall in no way affect, abrogate, limit or inhibit the Vendor's right to take action for recovery of damages that may be suffered by the Vendor as a result of the Purchaser's breach of Contract.
- (d) The party serving the Notice to Complete may:
 - i. At any time, withdraw the Notice to Complete by further notice to the party in default; and
 - ii. At its option, issue a further Notice to Complete.

47. Swimming pool

If a swimming pool forms part of the property:

- (a) The Vendor does not warrant that the swimming pool complies with the requirements imposed by the Swimming Pools Act 1992 (in this clause "the Act") and the regulations prescribed under the Act;
- (b) After completion the Purchaser must comply with the requirements of the Act; and
- (c) The Purchaser cannot make claim, objection or requisition or rescind or terminate in respect of the swimming pool and any non-compliance with the Act and Regulations prescribed under the Act.

48. Survey

Where a Surveyor's Report (or copy thereof) is annexed to the Contract:

- (a) The Vendor does not warrant the accuracy of completeness of the Report; and
- (b) The purchaser will take title subject to and will not make any objection, requisition or claim for compensation or claim any right to rescind or terminate in respect of the matters disclosed or referred to in such Report.

49. Qualified and limited title

- (a) If applicable, the property the subject of this Contract for Sale shall be deemed to be held by the Vendor pursuant to the provisions of the Real Property Act, 1900 and the Purchaser shall not be entitled to make any requisition, claim for compensation or objection with regard to the said Qualified Certificate of Title and the Vendor shall not be called upon to, nor shall the Vendor be obliged to, provide any Old System Title Abstracts of Title or Chronological Index of Title or Old System Title Search Papers and the Vendor shall be entitled to treat the subject property as not being Qualified Title pursuant to part IVA of the Real Property Act, 1900 and the Purchaser shall accept the title to the subject property as being wholly pursuant to the provisions of the Real Property Act, 1900.
- (b) If applicable, notwithstanding any other provision in this Contract for Sale the Vendor shall be under no obligation to provide to the Purchaser any Abstract of Title or Old System Documents in relation to the notation of Limited Title on the subject property.

50. Sewer Diagram

- (a) The Vendor and the Purchaser acknowledges that in the event the property is connected to a sewer main service provided by the Hunter Water Corporation then the attached sewer main diagram is the only diagram available from the Hunter Water Corporation in the ordinary course of administration.
- (b) The Purchaser shall not be entitled to make any objection, requisition or claim for compensation or rescind or terminate this Contract in respect of the matter disclosed.

51. Death/mental incapacity

If at any time prior to completion the Vendor or Purchaser (or any of them) dies or becomes mentally ill or, being a company is wound up or go into liquidation, then either party may at any time thereafter rescind this Contract by notice in writing served on the other party.

52. Guarantee and indemnity if the Purchaser is a Company

- (a) If the Purchaser of the property is a Company, the Offices or persons who sign this contract on behalf of the Company or who attest the seal of the Company on this Contract:
 - i. Jointly and separately guarantee all obligations of the Purchaser under this Contract including the payment of the purchase price; and

- ii. Jointly and separately indemnify the Vendor in respect of any default of the Purchaser under this Contract.
- (b) This guarantee and indemnity is given by each guarantor as principal and not discharged or released by any release or variation of this Contract between the Vendor and the Purchaser.

53. ~~Tenancy~~

~~If a tenant is in occupation of the property and if page one (1) of this Contract provides for the Vendor to give Vacant Possession of the property on completion of this contract, then the following provisions shall apply:~~

- ~~(a) Completion of this contract is conditional upon the Vendor obtaining Vacant Possession of the property from the tenant. The Vendor will forthwith serve a notice on the tenant and will pursue that notice and the obtaining of Vacant Possession.~~
- ~~(b) Neither party will be entitled to service Notice to Complete on the other party until Vacant Possession by the tenant is available to the Vendor.~~

54. Intentionally deleted

55. Intentionally deleted

56. Requisitions

- (a) The Purchaser agrees that the only form of general Requisitions in Title the Purchaser may make pursuant to clause 5.1 shall be in the form of Requisitions on Title annexed hereto.
- (b) The Purchaser acknowledges that these Requisitions on Title are deemed to have been served on the date of this contract.
- (c) The Purchaser is not entitled to make any requisitions (other than those annexed hereto) unless such requisition arises out of something served by the Vendor after the date of this Contract.

57. Conflict

If there is a conflict or inconsistency between these Additional Conditions and the printed clauses of this Contract, these Additional Conditions shall prevail to the extent of such conflict or inconsistency.

RESIDENTIAL PROPERTY REQUISITIONS ON TITLE

Re: Kuster Proposed Sale

Property: 54A Transfield Avenue, Edgeworth NSW 2285

Dated: 7 April 2026

Possession & Tenancies

1. Vacant possession of the property must be given on completion unless the Contract provides otherwise.
2. Is anyone in adverse possession of the property or any part of it?
3. (a) What are the nature and provisions of any tenancy or occupancy?
(b) If they are in writing, all relevant documentation should be produced, found in order and handed over on completion with notices of attornment.
(c) Please specify any existing breaches.
(d) All rent should be paid up to or beyond the date of completion.
(e) Please provide details of any bond together with the Rental Bond Board's reference number.
(f) If any bond money is held by the Rental Bond Board, the appropriate transfer documentation duly signed should be handed over on completion.
4. Is the property affected by a protected tenancy? (A tenancy affected by Parts 2, 3, 4 or 5 of the *Landlord and Tenant (Amendment) Act 1948*.)
5. If the tenancy is subject to the *Residential Tenancies Act 1987*:
(a) has either the vendor or any predecessor or the tenant applied to the Residential Tenancies Tribunal for an order?
(b) have any orders been made by the Residential Tenancies Tribunal? If so, please provide details.

Title

6. Subject to the Contract, on completion the vendor should be registered as proprietor in fee simple of the property free from all encumbrances.
7. On or before completion, any mortgage or caveat must be discharged or withdrawn (as the case may be) or an executed discharge or withdrawal handed over on completion.
8. When and where may the title documents be inspected?
9. Are the inclusions or fixtures subject to any charge or hiring agreement? If so, details must be given and any indebtedness discharged prior to completion or title transferred unencumbered to the vendor prior to completion.

Adjustments

10. All outgoing referred to in clause 14.1 of the Contract must be paid up to and including the date of completion.
11. Is the vendor liable to pay land tax or is the property otherwise charged or liable to be charged with land tax? If so:
(a) to what year has a return been made?
(b) what is the land value for land tax purposes for the current year?

Survey & Building

12. Subject to the Contract, survey should be satisfactory and show that the whole of the property is available and that there are no encroachments by or upon the property and that all improvements comply with local government/planning legislation.
13. Is the vendor in possession of a survey report? If so, please produce a copy for inspection prior to completion. The original should be handed over on completion.
14. (a) Have the provisions of the *Local Government Act*, the *Environmental Planning and Assessment Act* and their regulations been complied with?
(b) Is there any matter that could justify the making of an upgrading or demolition order in respect of any building or structure?
(c) Has the vendor a Building Certificate which relates to all current buildings or structures? If so, it should be handed over on completion. Please provide a copy in advance.

- (d) In respect of any residential building work carried out in the last 7 years:
 - (i) please identify the building work carried out;
 - (ii) when was the building work completed?
 - (iii) please state the builder's name and licence number;
 - (iv) please provide details of insurance under the *Home Building Act 1989*.
- 15. Has the vendor (or any predecessor) entered into any agreement with or granted any indemnity to the Council or any other authority concerning any development on the property?
- 16. If a swimming pool is included in the property:
 - (a) when did construction of the swimming pool commence?
 - (b) is the swimming pool surrounded by a barrier which complies with the requirements of the *Swimming Pools Act 1992*?
 - (c) if the swimming pool has been approved under the *Local Government Act 1993*, please provide details.
 - (d) are there any outstanding notices or orders?
- 17.
 - (a) To whom do the boundary fences belong?
 - (b) Are there any party walls?
 - (c) If the answer to (b) is yes, specify what rights exist in relation to each party wall and produce any agreement. The benefit of any such agreement should be assigned to the purchaser on completion.
 - (d) Is the vendor aware of any dispute regarding boundary or dividing fences or party walls?
 - (e) Has the vendor received any notice, claim or proceedings under the *Dividing Fences Act 1991* or the *Encroachment of Buildings Act 1922*?

Affectations

- 18. Is the vendor aware of any rights, licences, easements, covenants or restrictions as to use other than those disclosed in the Contract?
- 19. Is the vendor aware of:
 - (a) any road, drain, sewer or storm water channel which intersects or runs through the land?
 - (b) any dedication to or use by the public of any right of way or other easement over any part of the land?
 - (c) any latent defects in the property?
- 20. Has the vendor any notice or knowledge that the property is affected by the following:
 - (a) any resumption or acquisition or proposed resumption or acquisition?
 - (b) any notice requiring work to be done or money to be spent on the property or any footpath or road adjoining? If so, such notice must be complied with prior to completion.
 - (c) any work done or intended to be done on the property or the adjacent street which may create a charge on the property or the cost of which might be or become recoverable from the purchaser?
 - (d) any sum due to any local or public authority? If so, it must be paid prior to completion.
 - (e) any realignment or proposed realignment of any road adjoining the property?
 - (f) any contamination?
- 21.
 - (a) Does the property have the benefit of water, sewerage, drainage, electricity gas and telephone services?
 - (b) If so, do any of the connections for such services pass through any adjoining land?
 - (c) Do any service connections for any other property pass through the property?
- 22. Has any claim been made by any person to close, obstruct or limit access to or from the property or to an easement over any part of the property?

Capacity

- 23. If the Contract discloses that the vendor is a trustee, evidence should be produced to establish the trustee's power of sale.

Requisitions & Transfer

- 24. If the transfer or any other document to be handed over on completion is executed pursuant to a power of attorney, then at least 7 days prior to completion a copy of the registered power of attorney should be produced and found in order.
- 25. Searches, surveys, enquiries and inspection of title deeds must prove satisfactory.
- 26. The purchaser reserves the right to make further requisitions prior to completion.
- 27. Unless we are advised by you to the contrary prior to completion, it will be assumed that your replies to these requisitions remain unchanged as at completion date.

NEW SOUTH WALES LAND REGISTRY SERVICES - TITLE SEARCH

FOLIO: 2/1225469

SEARCH DATE	TIME	EDITION NO	DATE
7/4/2026	3:28 PM	4	24/2/2020

LAND

LOT 2 IN DEPOSITED PLAN 1225469
 AT EDGEWORTH
 LOCAL GOVERNMENT AREA LAKE MACQUARIE
 PARISH OF TERALBA COUNTY OF NORTHUMBERLAND
 TITLE DIAGRAM DP1225469

FIRST SCHEDULE

EGON JAMES KUSTER
 REBECCA ANNE KUSTER
 AS JOINT TENANTS

SECOND SCHEDULE (10 NOTIFICATIONS)

- 1 RESERVATIONS AND CONDITIONS IN THE CROWN GRANT(S)
- 2 DP1209574 RESTRICTION(S) ON THE USE OF LAND REFERRED TO AND NUMBERED (6) IN THE S.88B INSTRUMENT
- 3 DP1209574 POSITIVE COVENANT
- 4 DP1225469 EASEMENT FOR SUPPORT VARIABLE WIDTH REFERRED TO AND NUMBERED (1) IN THE S.88B INSTRUMENT AFFECTING THE SITE DESIGNATED (E) IN THE TITLE DIAGRAM
- 5 DP1225469 EASEMENT FOR SUPPORT VARIABLE WIDTH REFERRED TO AND NUMBERED (1) IN THE S.88B INSTRUMENT APPURTENANT TO THE LAND ABOVE DESCRIBED
- 6 DP1225469 RIGHT OF CARRIAGEWAY VARIABLE WIDTH AFFECTING THE PART(S) SHOWN SO BURDENED IN THE TITLE DIAGRAM
- 7 DP1225469 RIGHT OF CARRIAGEWAY VARIABLE WIDTH APPURTENANT TO THE LAND ABOVE DESCRIBED
- 8 DP1225469 EASEMENT FOR SUPPORT VARIABLE WIDTH REFERRED TO AND NUMBERED (3) IN THE S.88B INSTRUMENT AFFECTING THE SITE DESIGNATED (S) IN THE TITLE DIAGRAM
- 9 DP1225469 EASEMENT FOR SUPPORT VARIABLE WIDTH REFERRED TO AND NUMBERED (3) IN THE S.88B INSTRUMENT APPURTENANT TO THE LAND ABOVE DESCRIBED
- 10 AP921211 MORTGAGE TO BENDIGO AND ADELAIDE BANK LIMITED

NOTATIONS

UNREGISTERED DEALINGS: NIL

*** END OF SEARCH ***

32968...

PRINTED ON 7/4/2026

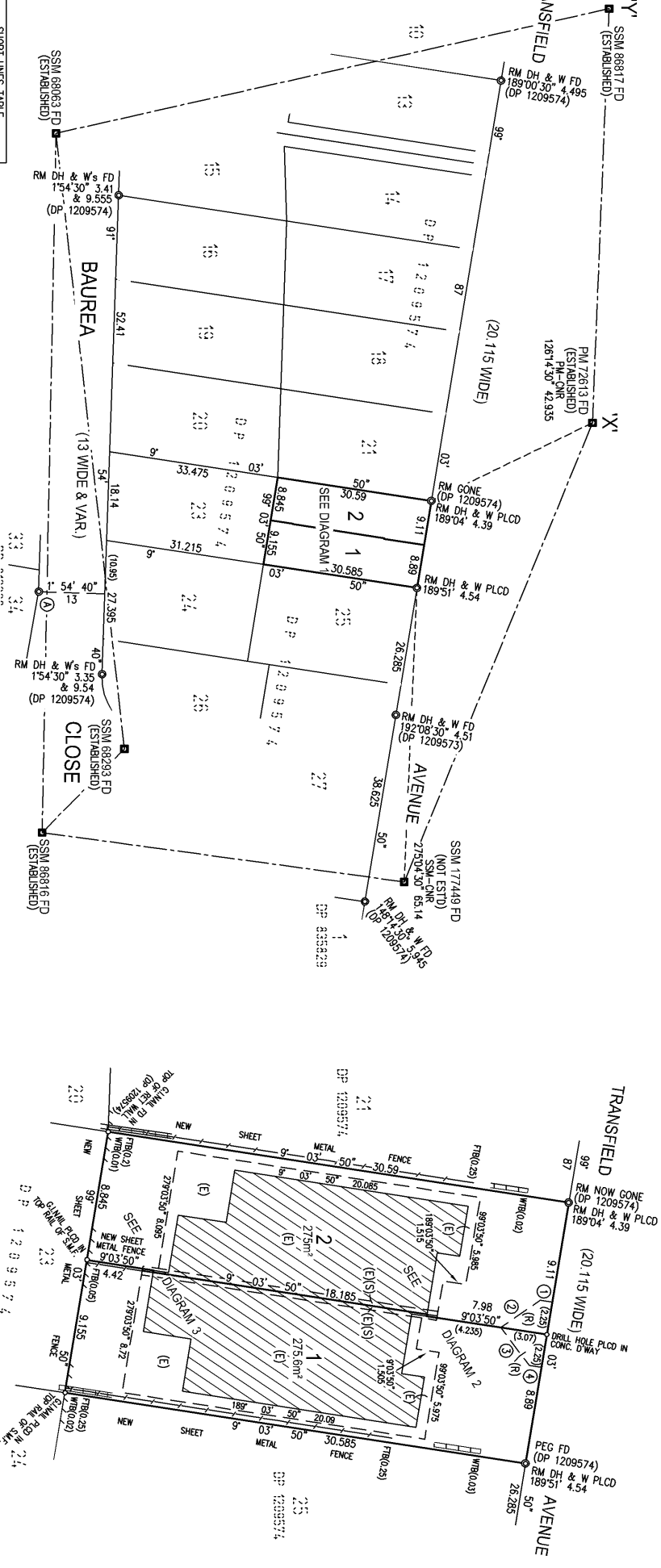

SHORT LINES TABLE

LINE	BEARING	DISTANCE
1	9°03'50"	0.82
2	324°03'50"	3.18
3	234°03'50"	3.18
4	189°03'50"	0.82

FTB - FENCE TO BOUNDARY
 WTB - WALL TO BOUNDARY
 --- DENOTES NEW TIMBER RETAINING WALL

(E) EASEMENT FOR SUPPORT VARIABLE WIDTH
 (R) RIGHT OF CARRIAGEWAY VARIABLE WIDTH
 (S) EASEMENT FOR SUPPORT VARIABLE WIDTH

SCHEDULE OF REFERENCE MARKS

MARK	BEARING	DISTANCE	FROM
(A)	181°54'40"	3.4 & 9.6	RM DH & Ws FD (DP 812338)

SURVEYING & SPATIAL INFORMATION REGULATION 2012: CLAUSE 35A(1)(b) & 61(2)

MARK	M.G.A. CO-ORDINATES	CLASS	ORDER	METHOD	ORIGIN
PM 72613	57 663 583	B	2	SGMS	SGMS
SM 86063	57 545 639	B	2	SGMS	SGMS
SM 86293	57 749 219	B	2	SGMS	SGMS
SM 86816	57 766 394	B	2	SGMS	SGMS
SM 86817	57 748 328	B	2	SGMS	SGMS
SM 177449	57 781 243	B	2	TRAVERSE	TRAVERSE

COMBINED SEA LEVEL & SCALE FACTOR = 0.999792
 SOURCE: M.G.A. ZONE 56 CO-ORDINATES ADOPTED FROM S.C.I.M.S. AS AT 18TH AUGUST 2016

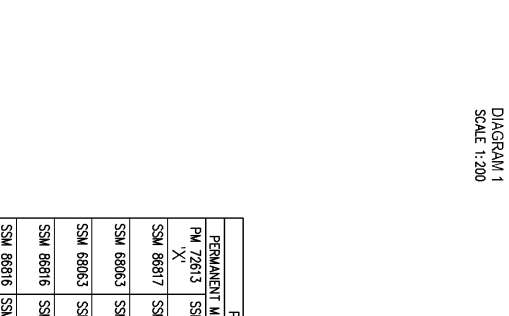
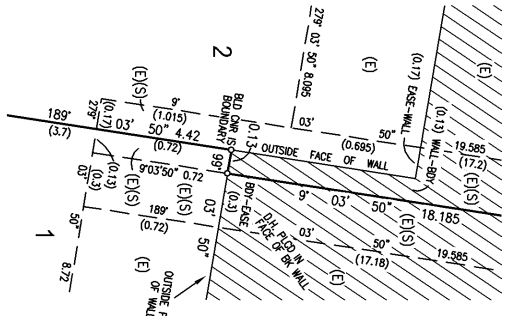
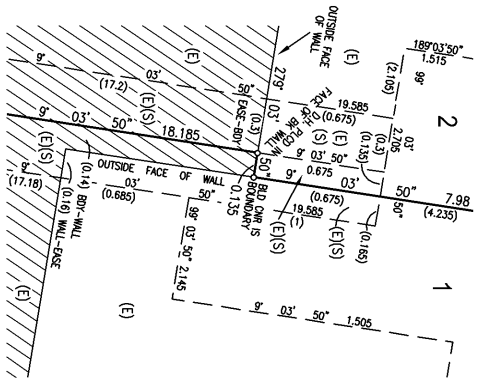

PM & SSM TRAVERSE TABLE

PERMANENT MARKS	BEARING	DISTANCE
PM 72613	215.572 SVY	215.572 SVY
SM 86817	215.577 MGA GND	215.577 MGA GND
SM 86063	139°03'31"	147.009 SVY
SM 86816	139°03'12"	147.021 MGA GND
SM 86293	86°27'52"	203.746 SVY
SM 86063	86°22'02"	203.745 MGA GND
SM 86816	92°41'11"	221.025 SVY
SM 86293	92°41'12"	221.024 MGA GND
SM 86816	133°21'35"	23.545 MGA GND
SM 177449	127°19'50"	69.607 SVY
SM 72613	286°09'28"	122.108 SVY

Surveyor: TROY DANIEL SUMNER
 Date of Survey: 09/09/2016
 Surveyor's Ref: 16135

PLAN OF SUBDIVISION OF LOT 22 DP 1209574

LGA: LAKE MACQUARIE
 Locality: EDGEWORTH
 Subdivision No: SC/10/12016
 Lengths are in metres. Reduction Ratio: 1:800

Registered:
 17.03.2017

DP1225469

PLAN FORM 6 (2013)

WARNING: Creasing or folding will lead to rejection

ePlan

DEPOSITED PLAN ADMINISTRATION SHEET

Sheet 1 of 3 sheet(s)

<p>Registered:  17.03.2017 Title System: TORRENS Purpose: SUBDIVISION</p>	<p>Office Use Only</p> <p style="text-align: center; font-size: 2em;">DP1225469</p> <p>Office Use Only</p>
<p>PLAN OF SUBDIVISION OF LOT 22 DP 1209574.</p>	<p>LGA: LAKE MACQUARIE Locality: EDGEWORTH Parish: TERALBA County: NORTHUMBERLAND</p>
<p>Crown Lands NSW/Western Lands Office Approval</p> <p>I, (Authorised Officer) in approving this plan certify that all necessary approvals in regard to the allocation of the land shown herein have been given.</p> <p>Signature: Date: File Number: Office:</p>	<p style="text-align: center;">Survey Certificate</p> <p>I, Troy Daniel Sumner – PULVER COOPER & BLACKLEY PTY LTD of 98 LAWES STREET, EAST MAITLAND.</p> <p>a surveyor registered under the <i>Surveying and Spatial Information Act 2002</i>, certify that:</p> <p><i>*(a) The land shown in the plan was surveyed in accordance with the Surveying and Spatial Information Regulation 2012, is accurate and the survey was completed on 09/09/2016.</i></p> <p><i>*(b) The part of the land shown in the plan (*being/*excluding ^) was surveyed in accordance with the Surveying and Spatial Information Regulation 2012, is accurate and the survey was completed on, the part not surveyed was compiled in accordance with that Regulation.</i></p> <p><i>*(c) The land shown in this plan was compiled in accordance with the Surveying and Spatial Information Regulation 2012.</i></p> <p>Signature:  Dated: 8/11/2016</p> <p>Surveyor ID: 8754 Datum Line: 'X' – 'Y' Type: *Urban/*Rural The terrain is *Level-Undulating / *Steep Mountainous.</p> <p><i>*Strike through if inapplicable. ^Specify the land actually surveyed or specify any land shown in the plan that is not the subject of the survey.</i></p>
<p style="text-align: center;">Subdivision Certificate</p> <p>I, <u>Greg Field</u></p> <p>*Authorised Person/*General Manager/*Accredited Certifier, certify that the provisions of s.109J of the <i>Environmental Planning and Assessment Act 1979</i> have been satisfied in relation to the proposed subdivision, new road or reserve set out herein.</p> <p>Signature:  Accreditation number: Consent Authority: LAKE MACQUARIE CITY COUNCIL Date of endorsement: 12 December 2016 Subdivision Certificate number: SC /101 /2016 File number: DA/1749/2015</p> <p><i>*Strike through if inapplicable.</i></p>	<p>Statements of intention to dedicate public roads, public reserves and drainage reserves.</p> <p>Plans used in the preparation of survey/compilation.</p> <p>DP 1209574</p> <p style="text-align: center;">if space is insufficient continue on PLAN FORM 6A</p>
<p>Signatures, Seals and Section 88B Statements should appear on PLAN FORM 6A</p>	<p>Surveyor's Reference: 16/135</p>

PLAN FORM 6A (2012)

WARNING: Creasing or folding will lead to rejection

ePlan

DEPOSITED PLAN ADMINISTRATION SHEET

Sheet 2 of 3 sheet(s)

<p style="text-align: right;">Office Use Only</p> <p>Registered:  17.03.2017</p>	<p style="text-align: right;">Office Use Only</p> <h1 style="text-align: center;">DP1225469</h1>
<p>PLAN OF SUBDIVISION OF LOT 22 DP 1209574.</p>	<p>This sheet is for the provision of the following information as required:</p> <ul style="list-style-type: none"> • A schedule of lots and addresses - See 60(c) <i>SSI Regulation 2012</i> • Statements of intention to create and release affecting interests in accordance with section 88B <i>Conveyancing Act 1919</i> • Signatures and seals- see 195D <i>Conveyancing Act 1919</i> • Any information which cannot fit in the appropriate panel of sheet 1 of the administration sheets.
<p>Subdivision Certificate number: <u>SC/101/2016</u></p> <p>Date of Endorsement: <u>12 December 2016</u></p>	

LOT	STREET NUMBER	STREET NAME	STREET TYPE	LOCALITY
1	54B	TRANSFIELD	AVENUE	EDGEWORTH
2	54A	TRANSFIELD	AVENUE	EDGEWORTH

Pursuant to Section 88B of the Conveyancing Act 1919, as amended It is intended to create:

1. Easement for support variable width (E)
2. Right of carriageway variable width (R)
3. Easement for support ~~0.3 wide~~ (S) **VARIABLE WIDTH**
3

SIGNED in my presence by
EGON JAMES KUSTER
who is personally know to me

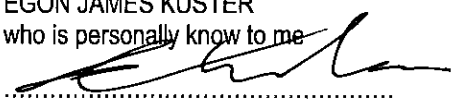

Signature of Witness

ALBERT KUSTER

Name of Witness

19 LAFFERS ROAD

BLAIR SA 5052

Address of Witness

Executed by the registered
proprietor of Lot 22 DP 1209574



EGON JAMES KUSTER

SIGNED in my presence by
REBECCA ANNE KUSTER
who is personally know to me

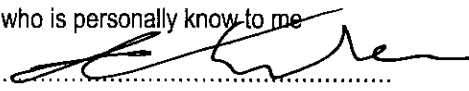

Signature of Witness

ALBERT KUSTER

Name of Witness

19 LAFFERS ROAD

BLAIR SA 5052

Address of Witness

Executed by the registered
proprietor of Lot 22 DP 1209574

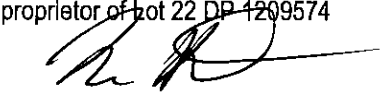

REBECCA ANNE KUSTER

If space is insufficient use additional annexure sheet

Surveyor's Reference: 16/135

PLAN FORM 6A (2012)

WARNING: Creasing or folding will lead to rejection

ePlan

DEPOSITED PLAN ADMINISTRATION SHEET

Sheet 3 of 3 sheet(s)

Office Use Only
 Registered:  17.03.2017

Office Use Only
DP1225469

**PLAN OF SUBDIVISION OF LOT 22
 DP 1209574.**

This sheet is for the provision of the following information as required:

- A schedule of lots and addresses - See 60(c) *SSI Regulation 2012*
- Statements of intention to create and release affecting interests in accordance with section 88B *Conveyancing Act 1919*
- Signatures and seals- see 195D *Conveyancing Act 1919*
- Any information which cannot fit in the appropriate panel of sheet 1 of the administration sheets.

Subdivision Certificate number: *SC/101/2016*
 Date of Endorsement: *12 December 2016*

Execution by PERPETUAL LIMITED (ACN 000 431 827):

Signed in my presence for and on behalf of Perpetual Limited (A.C.N. 000 431 827) by its attorneys
Justin Arigho Manager and **Robert D'Cunha** Manager
 who are personally known to me and each of whom declares that he/she has been appointed by the Board of Directors of that company as an attorney of the company for the purposes of the Power of Attorney dated *10/12/12* (Registration No. *4642/773*) and that he/she has no notice of the revocation of his/ her powers.

 Signature of Witness

 Signature of Attorney

Mortgage Operations Officer
 Level 18 Angel Place
 123 Pitt Street Sydney
 NSW 2000 (02) 9229 9000

Roseleen Maano
 Full name of Witness

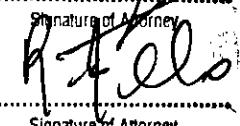
 Signature of Attorney

If space is insufficient use additional annexure sheet

Surveyor's Reference: 16/135

INSTRUMENT SETTING OUT TERMS OF EASEMENTS OR PROFITS À PRENDRE INTENDED TO BE CREATED OR RELEASED AND OF RESTRICTIONS ON THE USE OF LAND OR POSITIVE COVENANTS INTENDED TO BE CREATED PURSUANT TO SECTION 88B CONVEYANCING ACT 1919.

(Sheet 1 of 4 Sheets)

Plan: **DP1225469**

Plan of Subdivision of Lot 22 DP 1209574
covered by Council Subdivision Certificate
No:SC/101/2016 dated: 12 December 2016

Full name and address of the
owner of the land:

Egon James Kuster and
Rebecca Anne Kuster
3 Livingstone Street
Thebarton SA 5031

Full name and address of the
mortgagee of the land:

PERPETUAL LIMITED
ACN 000 431 827
Sydney NSW 2000

Part 1 (Creation)

Number of item shown in the intention panel on the plan	Identity of easement, profit à prendre, restriction or positive covenant to be created and referred to in the plan.	Burdened lot(s) or parcel(s)	Benefited lot(s), road(s), bodies or Prescribed Authorities
1	Easement for support variable width (E)	1 2	2 1
2	Right of carriageway variable width (R)	1 2	2 1
3	Easement for support 0.3 wide (S) VARIABLE WIDTH <i>5</i>	1 2	2 1

Part 2 (Terms)

1. TERMS OF EASEMENT FOR SUPPORT NUMBERED 1 IN THE PLAN

No structure on either lot shall be altered or demolished so as to adversely affect the dwelling on the adjoining created lot, in the subdivision, with respect to the level of fire protection, weather proofing, ventilation, noise or structural integrity or other matters as required by the Building Code of Australia.

Plan: DP1225469

Plan of Subdivision of Lot 22 DP 1209574
covered by Council Subdivision Certificate
No: SC/101/2016 dated: 12 December 2016

2. TERMS OF EASEMENT FOR SUPPORT NUMBERED 3 IN THE PLAN.

Full and free right for every person who is at any time entitled to an estate or interest in possession in the land herein indicated as the dominant tenement or any part thereof with which the right shall be capable of enjoyment to use the wall of the building already erected or to be erected on the servient tenement in such a manner that the building already erected or to be erected on the dominant tenement shall have proper and adequate support but only for such time as both buildings exist, and if it is subsequently necessary to demolish either building then the registered proprietor for the time being of the dominant tenement agrees that if the building already erected or to be erected on the servient tenement ever is demolished or falls into such a condition that proper and adequate support cannot be maintained then they will erect or cause to be erected at their own expense sufficient independent means of support lying entirely within the dominant tenement provided that such independent means of support are not attached in any manner whatsoever to any part of any building which is or may be erected from time to time on the servient tenement, and the registered proprietor for the time being of the dominant tenement further agrees that it will be their responsibility to ensure that such independent means of support satisfy all requirements of any statutory authority which may or may not be deemed from time to time to have the requisite jurisdiction, and the registered proprietor for the time being of the dominant tenement further agrees that they will not do or suffer to be done any act which will, or is likely to damage, impair or deface in any manner whatsoever the wall of the building erected on the servient tenement and that in the event of such an act occurring he will restore that wall at their own expense in a proper workmanlike manner as nearly as practicable to its original condition.

NAME OF PERSON OR AUTHORITY EMPOWERED TO RELEASE, VARY OR MODIFY EASEMENT FOR SUPPORT NUMBERED 1 AND 3, AND RIGHT OF CARRIAGEWAY NUMBERED 2 IN THE PLAN.

The owners of the lot burdened and benefited but only with the consent of Lake Macquarie City Council.



Plan: **DP1225469**

Plan of Subdivision of Lot 22 DP 1209574
covered by Council Subdivision Certificate
No:SC/101/2016 dated: 12 December 2016

LAKE MACQUARIE CITY COUNCIL)
by its authorised delegate pursuant to)
s.377 Local Government Act 1993)

G. Field

Signature of delegate

GREG FIELD

Name of delegate (BLOCK LETTERS)

I certify that I am eligible witness and that the
delegate signed in my presence

David William Fawcett

Signature of Witness

DAVID WILLIAM FAWCETT

Name of Witness (BLOCK LETTERS)

32 COAK ST

WARRIERS PT

Address of Witness

Execution by PERPETUAL LIMITED (ACN 000 431 827):

Mortgage Operations Officer
Level 18 Angel Place
123 Pitt Street Sydney
NSW 2000 (02) 9229 9000

Signed in my presence for and on behalf of Perpetual Limited (A C N 000 431 827) by its attorneys
Justin Arigho Manager and **Robert D'Cunha** Manager
..... and **Robert D'Cunha**.....
who are personally known to me and each of whom declares that he/she has been appointed by the
Board of Directors of that company as an attorney of the company for the purposes of the Power of
Attorney dated 10/12/12 (Registration No. 4642/773) and that he/she has
no notice of the revocation of his/ her powers.

Roseleen Maano
.....
Signature of Witness

Roseleen Maano
.....
Full name of Witness

Robert D'Cunha
.....
Signature of Attorney

Justin Arigho
.....
Signature of Attorney

John D.

Plan: **DP1225469**

Plan of Subdivision of Lot 22 DP 1209574
covered by Council Subdivision Certificate
No:SC/101/2016 dated: 12 December 2016

SIGNED in my presence by
EGON JAMES KUSTER
who is personally know to me

.....

Signature of Witness

ALBERT KUSTER

Name of Witness

19 LAFFERS ROAD

BELAIR SA 5052

Address of Witness

Executed by the registered
proprietor of Lot 22 DP 1209574

.....

EGON JAMES KUSTER

SIGNED in my presence by
REBECCA ANNE KUSTER
who is personally know to me

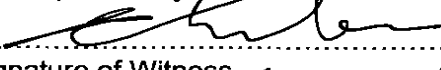
.....

Signature of Witness

ALBERT KUSTER

Name of Witness

19 LAFFERS ROAD

BELAIR SA 5052

Address of Witness

Executed by the registered
proprietor of Lot 22 DP 1209574

.....

REBECCA ANNE KUSTER

PLAN FORM 6 (2013)

WARNING: Creasing or folding will lead to rejection

ePlan

DEPOSITED PLAN ADMINISTRATION SHEET

Sheet 1 of 3 sheet(s)

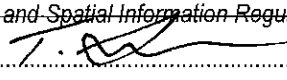
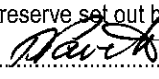
<p>Registered:  27.8.2015 Office Use Only</p> <p>Title System: TORRENS</p> <p>Purpose: SUBDIVISION</p> <p>PLAN OF SUBDIVISION OF LOT 39 DP812338.</p>	<p style="font-size: 2em; font-weight: bold;">DP1209574</p> <p>Office Use Only</p>
<p>PLAN OF SUBDIVISION OF LOT 39 DP812338.</p>	<p>LGA: LAKE MACQUARIE</p> <p>Locality: EDGEWORTH</p> <p>Parish: TERALBA</p> <p>County: NORTHUMBERLAND</p>
<p style="text-align: center;">Crown Lands NSW/Western Lands Office Approval</p> <p>I, (Authorised Officer) in approving this plan certify that all necessary approvals in regard to the allocation of the land shown herein have been given.</p> <p>Signature:</p> <p>Date:</p> <p>File Number:</p> <p>Office:</p>	<p style="text-align: center;">Survey Certificate</p> <p>I, TROY DANIEL SUMNER – PULVER, COOPER & BLACKLEY PTY LTD of 98 LAWES ST, EAST MAITLAND a surveyor registered under the <i>Surveying and Spatial Information Act 2002</i>, certify that:</p> <p>*(a) The land shown in the plan was surveyed in accordance with the <i>Surveying and Spatial Information Regulation 2012</i>, is accurate and the survey was completed on 12/06/2015.</p> <p>*(b) The part of the land shown in the plan (*being/*excluding ^.....) was surveyed in accordance with the <i>Surveying and Spatial Information Regulation 2012</i>, is accurate and the survey was completed on..... the part not surveyed was compiled in accordance with that Regulation.</p> <p>*(c) The land shown in this plan was compiled in accordance with the <i>Surveying and Spatial Information Regulation 2012</i>.</p> <p>Signature:  Dated: 12/06/2015</p> <p>Surveyor ID: 2481 8754</p> <p>Datum Line: 'X' – 'Y'</p> <p>Type: *Urban/*Rural</p> <p>The terrain is *Level-Undulating / *Steep-Mountainous.</p> <p>*Strike through if inapplicable.</p> <p>^Specify the land actually surveyed or specify any land shown in the plan that is not the subject of the survey.</p>
<p style="text-align: center;">Subdivision Certificate</p> <p>I, <u>DAVID WILLIAM PAVITT</u> *Authorised Person/*General Manager/*Accredited Certifier, certify that the provisions of s.109J of the <i>Environmental Planning and Assessment Act 1979</i> have been satisfied in relation to the proposed subdivision, new road or reserve set out herein.</p> <p>Signature: </p> <p>Accreditation number:</p> <p>Consent Authority: LAKE MACQUARIE</p> <p>Date of endorsement: <u>11 August 2015</u></p> <p>Subdivision Certificate number: <u>SC/52/2015</u></p> <p>File number: <u>DA/548/2014</u></p> <p>*Strike through if inapplicable.</p>	<p>Statements of intention to dedicate public roads create public reserves and drainage reserves, acquire/resume land.</p> <p>IT IS INTENDED TO DEDICATE LOT 27 AS DRAINAGE RESERVE.</p>
<p>Signatures, Seals and Section 88B Statements should appear on PLAN FORM 6A</p>	<p>Plans used in the preparation of survey/compitation. DP806642 DP813338 DP835829 DP1209573</p> <p style="text-align: right;">If space is insufficient continue on PLAN FORM 6A</p> <p>Surveyor's Reference: 14/17</p>

PLAN FORM 6A (2013)

WARNING: Creasing or folding will lead to rejection

ePlan

DEPOSITED PLAN ADMINISTRATION SHEET

Sheet 2 of 3 sheet(s)

Office Use Only

Office Use Only

Registered:  27.8.2015

DP1209574

PLAN OF SUBDIVISION OF LOT 39
DP812338.

This sheet is for the provision of the following information as required:

- A schedule of lots and addresses - See 60(c) *SSI Regulation 2012*
- Statements of intention to create and release affecting interests in accordance with section 88B *Conveyancing Act 1919*
- Signatures and seals- see 195D *Conveyancing Act 1919*
- Any information which cannot fit in the appropriate panel of sheet 1 of the administration sheets.

Subdivision Certificate number: SC/52/2015

Date of Endorsement: 11 August 2015

Lot	Street Number	Street Name	Street Type	Locality
1	22	Transfield	Avenue	Edgeworth
2	20	Transfield	Avenue	Edgeworth
3	18	Transfield	Avenue	Edgeworth
4	26	Transfield	Avenue	Edgeworth
5	24	Transfield	Avenue	Edgeworth
6	30	Transfield	Avenue	Edgeworth
7	28	Transfield	Avenue	Edgeworth
8	34	Transfield	Avenue	Edgeworth
9	32	Transfield	Avenue	Edgeworth
10	38	Transfield	Avenue	Edgeworth
11	36	Transfield	Avenue	Edgeworth
12	42	Transfield	Avenue	Edgeworth
13	40	Transfield	Avenue	Edgeworth
14	46	Transfield	Avenue	Edgeworth
15	44	Transfield	Avenue	Edgeworth
16	15	Baurea	Close	Edgeworth
17	48	Transfield	Avenue	Edgeworth
18	50	Transfield	Avenue	Edgeworth
19	17	Baurea	Close	Edgeworth
20	19	Baurea	Close	Edgeworth
21	52	Transfield	Avenue	Edgeworth
22	54	Transfield	Avenue	Edgeworth
23	21	Baurea	Close	Edgeworth
24	23	Baurea	Close	Edgeworth
25	56	Transfield	Avenue	Edgeworth
26	25	Baurea	Close	Edgeworth
27	58	Transfield	Avenue	Edgeworth

Pursuant to Section 88B of the Conveyancing Act 1919, as amended it is intended to create:

1. Easement to Drain Water 2 wide & variable (A)
2. Right of carriage way 5 wide (B)
3. Easement for services 5 wide (C)
4. Right of carriage way 2.5 wide (D)
5. Restriction on the Use of Land
6. Restriction on the Use of Land
7. Positive covenant

If space is insufficient use additional annexure sheet

Surveyor's Reference: 14/17

PLAN FORM 6A (2013)

WARNING: Creasing or folding will lead to rejection

ePlan

DEPOSITED PLAN ADMINISTRATION SHEET Sheet 3 of 3 sheet(s)

Registered:  27.8.2015
Office Use Only

PLAN OF SUBDIVISION OF LOT 39
DP812338.

DP1209574
Office Use Only

Subdivision Certificate number: SC/52/2015
Date of Endorsement: 11 August 2015

This sheet is for the provision of the following information as required:
• A schedule of lots and addresses - See 60(c) *SSI Regulation 2012*
• Statements of intention to create and release affecting interests in accordance with section 88B *Conveyancing Act 1919*
• Signatures and seals- see 195D *Conveyancing Act 1919*
• Any information which cannot fit in the appropriate panel of sheet 1 of the administration sheets.

EXECUTED by DPC holdings (NSW))
Pty Limited ACN 159 498 236)
in accordance with section 127 of the)
Corporations Act 2001 (Cth):)

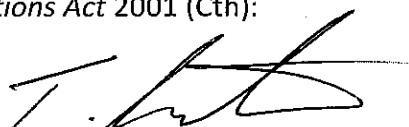

Signature of director/secretary

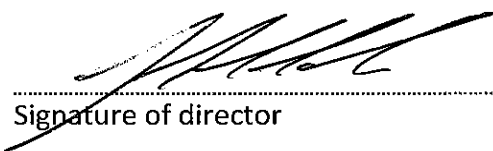

Signature of director

Tamie Arrateen

Name of director/secretary

John Nikolovski

Name of director

EXECUTED by COMMONWEALTH BANK
OF AUSTRALIA TRADING AS BANKWEST
ABN: 48 123 123 124 by its duly
constituted attorney under power
of attorney no. Book 4636 No. 768

Dated 7th August 2012 who at the date
hereof had no notice of revocation of such
power of attorney in the presence of:

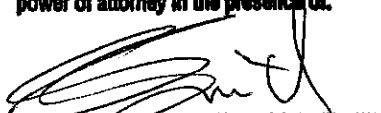

An Officer of the Bank

STEPHEN BARRY SMITH

Witness name

by its attorney:

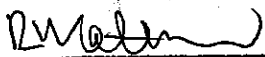

Signature

ROBERT JAMES MATTHEWS

Name

BANK MANAGER

Title

If space is insufficient use additional annexure sheet

Surveyor's Reference: 14/17

Instrument setting out terms of Easements or Profits a Prendre intended to be created or released and of Restrictions on the Use of Land or Positive Covenants intended to be created pursuant to Section 88B of the Conveyancing Act, 1919.

Lengths are in metres

(Sheet 1 of 7 Sheets)

Plan: DP1209574

Plan of Subdivision of Lot 39 DP 812338 covered by Council Subdivision Certificate No. *52/2015* dated *11 August 2015*

Full name and address of the owner of the land

DPC Holdings (NSW) Pty. Ltd.
 A.C.N. 159 498 236
 258 Darby Street, Cooks Hill NSW 2300

Full name and address of mortgagee of land

Commonwealth Bank of Australia
 Ground Floor, Tower 1, 201 Sussex Street
 Sydney NSW 2000

PART 1 (Creation)

Number of items shown in the intention panel on the plan	Identity of easement, profit a prendre, restriction or positive covenant to be created and referred to in the plan	Burdened lot(s) or parcel(s)	Benefited lot(s), road(s), Bodies or Prescribed Authorities
1.	Easement to Drain Water 2 wide and variable (A)	2 5 4 7 9 11 10 13 12 15 14 17 16 19 20 23 24 25	1 and 3 1 to 4 inclusive 1 to 3 inclusive 1 to 4 inclusive 8 8 8, 11 8, 11, 12 8, 11 8, 11, 12 8, 11, 12, 15 8, 11, 12, 15 8, 11, 12, 15 8, 11, 12, 15, 16 8, 11, 12, 15, 16, 19 8, 11, 12, 15, 16, 19, 20 8, 11, 12, 15, 16, 19, 20, 23 23, 20, 26 8, 11, 12, 15, 16, 19, 20, 24, 26 , 23 24, 26
2.	Right of carriage way 5 wide (B)	3	2

Instrument setting out terms of Easements or Profits a Prendre intended to be created or released and of Restrictions on the Use of Land or Positive Covenants intended to be created pursuant to Section 88B of the Conveyancing Act, 1919.

Lengths are in metres

(Sheet 2 of 7 Sheets)

Plan: DP1209574

Plan of Subdivision of Lot 39 DP 812338 covered by Council Subdivision Certificate No. *52/2015* dated *11 August 2015*

3.	Easement for services 5 wide (C)	3	2
4.	Right of carriage way 2.5 wide (D)	4 7 8 11 12 15	7 4 11 8 15 12
5.	Restrictions on the use of Land	3, 4, 7, 8, 11, 12, 15	Lake Macquarie City Council
6.	Restrictions on the use of Land	Each lot except Lot 27	Every other lot except Lot 27
7.	Positive covenant	Each lot except Lot 27	Lake Macquarie City Council

PART 2 (Terms)

1. **TERMS OF RIGHT OF CARRIAGEWAY NUMBERED 2 AND 4 IN THE PLAN**
 - 1.1 Full and free right for every person who is at any time entitled to an estate or interest in possession in the land herein indicated as the dominant tenement or any part thereof with which the right shall be capable of enjoyment and every person authorised by that person, to go, pass and repass at all times and for all purposes with or without animals or vehicles or both to and from the said dominant tenement or any such part thereof.
 - 1.2 The costs of maintenance and repair in respect of the right of carriageway are to be borne by the owners of the lots burdened and benefited in equal proportions.
 - 1.3 If one of the lot owners incurs costs referred to in subclause 1.2, that lot owner may demand in writing from the other lot owner the amount that the other lot owner is liable to contribute under that subclause to those costs.

Instrument setting out terms of Easements or Profits a Prendre intended to be created or released and of Restrictions on the Use of Land or Positive Covenants intended to be created pursuant to Section 88B of the Conveyancing Act, 1919.

Lengths are in metres

(Sheet 3 of 7 Sheets)

Plan: DP1209574

Plan of Subdivision of Lot 39 DP 812338 covered by Council Subdivision Certificate No. *52/2015* dated *11 August 2015*

- 1.4 Any demand made under subclause 1.3 ;must be accompanied by receipts or invoices or copies of receipts or invoices that evidence the expenditure to which the demand relates.
- 1.5 If a lot owner fails to comply with any such demand within 7 days after it has been made, the amount demanded may be recovered in a court of competent jurisdiction as a debt due to the person making the demand.
2. **TERMS OF RESTRICTIONS ON USE OF LAND NUMBERED 5 IN THE PLAN**
 - 2.1 Direct vehicular access to or from Baurea Close from the lots burdened is prohibited.
 - 2.2 No solid fencing including but not limited to 'colourbond' or lapped timber fencing shall be constructed below the top of the existing batter fronting Baurea Close. No other open style pool fences below the top of the existing batter fronting Baurea Close of a dark and sympathetic colouring combined with suitable landscaping will be permitted without the approval of Council.
3. **TERMS OF RESTRICTIONS ON THE USE OF THE LAND NUMBERED 6 IN THE PLAN**
 - (a) No building shall be erected or permitted to remain erected on any lot burdened unless totally constructed (at the time of its erection on the lot) of new materials.
 - (b) No garage or outbuilding shall be erected or permitted to remain on Lot burdened except until after or concurrently with the erection of any such main building.
 - (c) No structure of a temporary character, tent, shack, garage, trailer, camper caravan, lawn locker, mobile home or any outbuilding shall be used at any time as a dwelling on any lot burdened.
 - (d) No factory manufactured homes, mobile homes, demountable homes, shipping containers or other dwellings manufactured or previously situated elsewhere shall be placed on or permitted to remain on any lot burdened.

Instrument setting out terms of Easements or Profits a Prendre intended to be created or released and of Restrictions on the Use of Land or Positive Covenants intended to be created pursuant to Section 88B of the Conveyancing Act, 1919.

Lengths are in metres

(Sheet 4 of 7 Sheets)

Plan: DP1209574

Plan of Subdivision of Lot 39 DP 812338
covered by Council Subdivision Certificate
No. *52/2015* dated *11 August 2015*

- (e) That for the benefit of any adjoining land owned by the transferor but only during the ownership therein by the transferor its successors and assigns other than purchasers of sale, no fences shall be erected on any lot to divide the same from such adjoining land without the consent of the transferor but such consent shall not be withheld if such fence is erected without expense to the registered proprietor and in favour of any person dealing with the transferee such consent shall be deemed to have been given respect of every such fence for the time being erected.
- (f) No fuel storage tanks (except any such tanks used for oil heating purposes) shall be placed upon or permitted to remain on any lot burdened.
- (g) No noxious, noisome or offensive occupation, trade, business, manufacturing or home industry shall not be conducted or carried out on any lot burdened.
- (h) No commercial or boarding kennels shall be constructed or permitted to remain on any lot burdened.
- (i) No motor truck, lorry or semi-trailer with a load carrying capacity exceeding two point five (2.5) tonnes shall be parked or permitted to remain on any lot burdened unless the same is used in connection with the erection of a dwelling on the relevant lot burdened.
- (j) No air conditioning plant and/or equipment shall be installed or permitted to remain on any building erected on the lot burdened unless the same is either:-
 - (i) Not visible from any public road and/or place; or
 - (ii) is screened from any public road and/or place in a manner approved by DPC Holdings (NSW) Pty. Ltd.
- (k) No radio masts and/or antennas shall be erected or permitted to remain on the lot burdened unless the same are not visible from any public road and/or place.

Instrument setting out terms of Easements or Profits a Prendre intended to be created or released and of Restrictions on the Use of Land or Positive Covenants intended to be created pursuant to Section 88B of the Conveyancing Act, 1919.

Lengths are in metres

(Sheet 5 of 7 Sheets)

Plan: DP1209574

Plan of Subdivision of Lot 39 DP 812338 covered by Council Subdivision Certificate No. *52/2015* dated *11 August 2015*

- (l) No television masts and/or antennas shall be erected or permitted to remain on the lot burdened unless the same are erected at or near the rear of the main building erected on the lot burdened, or appropriately screened such that it is not visible from any public road or place.
- (m) No hot water systems and/or water tanks shall be erected or permitted to remain on the lot burdened unless they are placed at or near the rear of the main building and if visible from any public road or place the hot water system and/or water tanks are to be screened with materials approved by DPC Holdings (NSW) Pty. Ltd.

4. TERMS OF POSITIVE COVENANT NUMBERED 7 REFERRED TO IN THE PLAN

The registered proprietor of each lot burdened shall, within the site of this easement, at all times, manage the area as an inner protection ('IPA') as outlined within Section 4.1.3 and Appendix 5 of 'Planning for Bush Fire Protection 2006' and the NSW Rural Fire Service's production 'Standards for Asset Protection Zones'.

NAME OF PERSON OF AUTHORITY EMPOWERED TO RELEASE, VARY OR MODIFY EASEMENTS NUMBERED 1 AND 3 IN THE PLAN AND RIGHTS OF CARRIAGEWAY NUMBERED 2 AND 4 IN THE PLAN AND RESTRICTION NUMBERED 5 IN THE PLAN AND POSITIVE COVENANT NUMBERED 7 IN THE PLAN.

Lake Macquarie City Council

The cost and expense of any release, variation or modification shall be borne by the person or corporation requesting the same in all respects.

NAME OF PERSON OR AUTHORITY EMPOWERED TO RELEASE, VARY OR MODIFY RESTRICTION NUMBERED 6 IN THE PLAN

DPC Holdings (NSW) Pty. Ltd. its successors in title or assigns for such time as it remains the registered proprietor of any lot or lots in the said plan and thereafter by the person in whom the legal estate in fee simple is for the time being vested in any

Instrument setting out terms of Easements or Profits a Prendre intended to be created or released and of Restrictions on the Use of Land or Positive Covenants intended to be created pursuant to Section 88B of the Conveyancing Act, 1919.

Lengths are in metres

(Sheet 6 of 7 Sheets)

Plan: DP1209574

Plan of Subdivision of Lot 39 DP 812338 covered by Council Subdivision Certificate No. *52/2015* dated *11 August 2015*

lots in the plan (other than the public area) having a common boundary with the lot burdened PROVIDED that any release variation or modification shall, if approved, be effected in all respects at the cost and expense of the person or persons requesting the release, variation or modification.

Executed by **DPC Holdings (NSW)**)
Pty. Ltd. ACN 159 498 236 in)
accordance with Section 127 of the)
Corporations Act 2001)

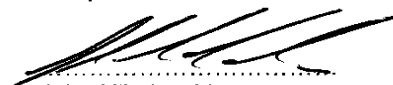

John Nikolovski
Director

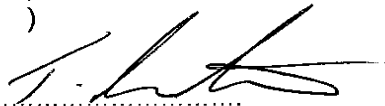

Jamie Arratoon
Director



Authorised Person
Lake Macquarie City Council

Instrument setting out terms of Easements or Profits a Prendre intended to be created or released and of Restrictions on the Use of Land or Positive Covenants intended to be created pursuant to Section 88B of the Conveyancing Act, 1919.

Lengths are in metres

(Sheet 7 of 7 Sheets)

Plan: **DP1209574**

Plan of Subdivision of Lot 39 DP 812338 covered by Council Subdivision Certificate No. *52/2015* dated *11 August 2015*

Executed by **COMMONWEALTH BANK OF AUSTRALIA**

)
)

Lake Macquarie City Council
Approved 88B instrument for
SUBDIVISION CERTIFICATE
SC *52 / 2015*
Authorised Person: *[Signature]*
Date: *11 / 8 / 15*

EXECUTED by COMMONWEALTH BANK OF AUSTRALIA TRADING AS BANKWEST ABN: 48 123 123 124 by its duly constituted attorney under power of attorney no. Book 4836 No. 703

Dated 7th August 2012 who at the date hereof had no notice of revocation of such power of attorney in the presence of:

[Signature]
An Officer of the Bank

Grant Vesper
Witness name

By its attorney:

[Signature]
Signature
ROBERT JAMES MATTHEWS
Name
BANK MANAGER
Title

17335

REGISTERED  27.8.2015



FOLIO: 2/1225469

SEARCH DATE	TIME	EDITION NO	DATE
22/8/2025	3:35 PM	4	24/2/2020

LAND

LOT 2 IN DEPOSITED PLAN 1225469
 AT EDGEWORTH
 LOCAL GOVERNMENT AREA LAKE MACQUARIE
 PARISH OF TERALBA COUNTY OF NORTHUMBERLAND
 TITLE DIAGRAM DP1225469

FIRST SCHEDULE

EGON JAMES KUSTER
 REBECCA ANNE KUSTER
 AS JOINT TENANTS

SECOND SCHEDULE (10 NOTIFICATIONS)

- 1 RESERVATIONS AND CONDITIONS IN THE CROWN GRANT(S)
- 2 DP1209574 RESTRICTION(S) ON THE USE OF LAND REFERRED TO AND NUMBERED (6) IN THE S.88B INSTRUMENT
- 3 DP1209574 POSITIVE COVENANT
- 4 DP1225469 EASEMENT FOR SUPPORT VARIABLE WIDTH REFERRED TO AND NUMBERED (1) IN THE S.88B INSTRUMENT AFFECTING THE SITE DESIGNATED (E) IN THE TITLE DIAGRAM
- 5 DP1225469 EASEMENT FOR SUPPORT VARIABLE WIDTH REFERRED TO AND NUMBERED (1) IN THE S.88B INSTRUMENT APPURTENANT TO THE LAND ABOVE DESCRIBED
- 6 DP1225469 RIGHT OF CARRIAGEWAY VARIABLE WIDTH AFFECTING THE PART(S) SHOWN SO BURDENED IN THE TITLE DIAGRAM
- 7 DP1225469 RIGHT OF CARRIAGEWAY VARIABLE WIDTH APPURTENANT TO THE LAND ABOVE DESCRIBED
- 8 DP1225469 EASEMENT FOR SUPPORT VARIABLE WIDTH REFERRED TO AND NUMBERED (3) IN THE S.88B INSTRUMENT AFFECTING THE SITE DESIGNATED (S) IN THE TITLE DIAGRAM
- 9 DP1225469 EASEMENT FOR SUPPORT VARIABLE WIDTH REFERRED TO AND NUMBERED (3) IN THE S.88B INSTRUMENT APPURTENANT TO THE LAND ABOVE DESCRIBED
- 10 AP921211 MORTGAGE TO BENDIGO AND ADELAIDE BANK LIMITED

NOTATIONS

UNREGISTERED DEALINGS: NIL

*** END OF SEARCH ***

32434...

PRINTED ON 22/8/2025

* Any entries preceded by an asterisk do not appear on the current edition of the Certificate of Title. Warning: the information appearing under notations has not been formally recorded in the Register. InfoTrack an approved NSW Information Broker hereby certifies that the information contained in this document has been provided electronically by the Registrar General in accordance with Section 96B(2) of the Real Property Act 1900.



26 August 2025

INFOTRACK PTY LTD
PO Box 4029
SYDNEY NSW 2001

Our Ref:178510
Your Ref: 32434:206526
ABN 81 065 027 868

**PLANNING CERTIFICATE UNDER THE
ENVIRONMENTAL PLANNING AND ASSESSMENT ACT, 1979**

Fee Paid: 70.60
Receipt No: 14214073
Receipt Date: 22 August 2025

DESCRIPTION OF LAND

Address: 54A Transfield Avenue, EDGEWORTH NSW 2285
Lot Details: Lot 2 DP 1225469
Parish: Teralba
County: Northumberland

For: MORVEN CAMERON
GENERAL MANAGER

A handwritten signature in black ink, appearing to read "J. Hayes".

ADVICE PROVIDED IN ACCORDANCE WITH SUBSECTION (2)

1 Names of Relevant Planning Instruments and Development Control Plans

- (1) The name of each environmental planning instrument and development control plan that applies to the carrying out of development on the land.

Lake Macquarie Local Environmental Plan 2014

Lake Macquarie Development Control Plan 2014

State Environmental Planning Policy (Biodiversity and Conservation) 2021

Chapter 4 Koala habitat protection 2021

State Environmental Planning Policy (Building Sustainability Index: BASIX) 2004

State Environmental Planning Policy (Exempt and Complying Development Codes) 2008

State Environmental Planning Policy (Housing) 2021

State Environmental Planning Policy (Industry and Employment) 2021

Chapter 3 Advertising and signage

State Environmental Planning Policy (Planning Systems) 2021

Chapter 2 State and regional development

State Environmental Planning Policy (Planning Systems) 2021

Chapter 4 Concurrences and consents

State Environmental Planning Policy (Precincts-Central River City) 2021

Chapter 2 State significant precincts

State Environmental Planning Policy (Precincts-Eastern Harbour City) 2021

Chapter 2 State significant precincts

State Environmental Planning Policy (Precincts-Regional) 2021

Chapter 2 State significant precincts

State Environmental Planning Policy (Precincts-Western Parkland City) 2021

Chapter 2 State significant precincts

State Environmental Planning Policy (Primary Production) 2021

Chapter 2 Primary production and rural development

State Environmental Planning Policy (Resilience and Hazards) 2021

Chapter 3 Hazardous and offensive development

State Environmental Planning Policy (Resilience and Hazards) 2021

Chapter 4 Remediation of land

State Environmental Planning Policy (Resources and Energy) 2021

Chapter 2 Mining, petroleum production and extractive industries

State Environmental Planning Policy (Transport and Infrastructure) 2021

Chapter 2 Infrastructure

State Environmental Planning Policy (Transport and Infrastructure) 2021

Chapter 3 Educational establishments and child care facilities

State Environmental Planning Policy No. 65 - Design Quality of Residential Apartment Development

- (2) The name of each proposed environmental planning instrument and draft development control plan, which is or has been subject to community consultation or public exhibition under the Act, that will apply to the carrying out of development on the land.

Lake Macquarie Draft Development Control Plan 2014

- (3) Subsection (2) does not apply in relation to a proposed environmental planning instrument or draft development control plan if —
- (a) it has been more than 3 years since the end of the public exhibition period for the proposed instrument or draft plan, or
 - (b) for a proposed environmental planning instrument—the Planning Secretary has notified the council that the making of the proposed instrument has been deferred indefinitely or has not been approved.
- (4) In this section, proposed environmental planning instrument includes a planning proposal for a Local Environmental Plan or a Draft environmental planning instrument.

2 Zoning and land use under relevant Local Environmental Plans

(1) The following answers (a) to (f) relate to the instrument (see 1(1) above).

(a) (i) The identity of the zone applying to the land.

R2 Low Density Residential

under Lake Macquarie Local Environmental Plan 2014

(ii) The purposes for which the Instrument provides that development may be carried out within the zone without the need for development consent.

Exempt development as provided in Schedule 2; Home-based child care; Home occupations

(iii) The purposes for which the Instrument provides that development may not be carried out within the zone except with development consent.

Bed and breakfast accommodation; Boat sheds; Building identification signs; Business identification signs; Centre-based child care facilities; Community facilities; Dwelling houses; Emergency services facilities; Environmental facilities; Environmental protection works; Exhibition homes; Exhibition villages; Flood mitigation works; Group homes; Health consulting rooms; Home businesses; Home industries; Kiosks; Neighbourhood shops; Oyster aquaculture; Places of public worship; Pond-based aquaculture; Recreation areas; Residential accommodation, Respite day care centres; Roads; Sewage reticulation systems; Sewage treatment plants; Tank-based aquaculture; Water recreation structures; Water recycling facilities; Water supply systems

(iv) The purposes for which the Instrument provides that development is prohibited within the zone.

Any other development not specified in item (ii) or (iii)

NOTE: The advice in sections (a) above relates only to restrictions that apply by virtue of the zones indicated. The Lake Macquarie LEP 2014 includes additional provisions that require development consent for particular types of development, or in particular circumstances, irrespective of zoning.

(b) Whether additional permitted uses apply to the land,

No

(c) Whether development standards applying to the land fix minimum land dimensions for the erection of a dwelling-house on the land and, if so, the minimum land dimensions so fixed.

There are no development standards applying to the land that fix minimum land dimensions for the erection of a dwelling house.

(d) Whether the land is in an area of outstanding biodiversity value under the *Biodiversity Conservation Act 2016*,

No

(e) Whether the land is in a conservation area (however described).

No

- (f) Whether an item of environmental heritage (however described) is situated on the land.

Local Environmental Plan 2014 Schedule 5 Part 1 Heritage Items

There are no items listed for this land under Local Environmental Plan 2014 Schedule 5 Part 1 Heritage items.

Local Environmental Plan 2014 Schedule 5 Part 2 Heritage conservation areas

There are no items listed for this land under Local Environmental Plan 2014 Schedule 5 Part 2 Heritage conservation areas.

Local Environmental Plan 2014 Schedule 5 Part 3 Archaeological sites

There are no items listed for this land under Local Environmental Plan 2014 Schedule 5 Part 3 Archaeological sites.

Local Environmental Plan 2014 Schedule 5 Part 4 Landscape Items

There are no items listed for this land under Local Environmental Plan 2014 Schedule 5 Part 4 Landscape items.

Local Environmental Plan 2004 Schedule 4 Part 1 Heritage Items

There are no heritage items listed for this land within Local Environmental Plan 2004 Schedule 4 Part 1.

Local Environmental Plan 2004 Part 11 Clause 150 Environmental Heritage

There are no heritage items listed for this land within Local Environmental Plan 2004 Part 11 Clause 150 – South Wallarah Peninsula.

Local Environmental Plan 2014 Heritage Map

The land is not identified as a Village Precinct on the Heritage Map.

NOTE: An item of environmental heritage, namely Aboriginal heritage, listed within the Aboriginal Heritage Information Management System (AHIMS), may affect the land. Aboriginal objects are protected under the National Parks and Wildlife Act 1974. If Aboriginal objects are found during development, works are to stop and the Office of Environment and Heritage (OEH) contacted immediately. For further information and to access the AHIMS registrar, refer to <http://www.environment.nsw.gov.au>

- (2) The following answers relate to the Draft Instrument (see 1(2) above).

- (a) Nil

NOTE: The advice in section (a) above relates only to restrictions that apply by virtue of the zones indicated. The Draft instrument may include additional provisions that require development consent for particular types of development, or in particular circumstances, irrespective of zoning.

- (b) Whether draft additional permitted uses apply to the land

No

- (c) Whether any draft development standards applying to the land fix minimum land dimensions for the erection of a dwelling-house on the land and, if so, the minimum land dimensions so fixed.

There are no development standards applying to the land that fix minimum land dimensions for the erection of a dwelling house.

- (d) Whether the land is in a draft area of outstanding biodiversity value under *the Biodiversity Conservation Act 2016*,

No

- (e) Whether the land is in a draft conservation area (however described).

No

- (f) Whether a draft item of environmental heritage (however described) is situated on the land.

No

3 Contributions Plans

- (1) The name of each contributions plan under the Act, Division 7.1 applying to the land, including draft contributions plans.

Lake Macquarie City Council Development Contributions Plan - Glendale Contributions Catchment - 2015

The Lake Macquarie City Council Section 7.12 Contributions Plan – Citywide 2019

The following Draft Citywide Development Contributions Plans apply to the land:

Draft Lake Macquarie City Council Section 7.12 Citywide Development Contributions Plan – 2025

Draft Lake Macquarie City Council Section 7.11 Citywide Development Contributions Plan – 2025

NOTE: **The Draft Citywide Development Contributions Plans can be viewed on Council's Website [Shape Lake Mac | Draft Citywide Development Contributions Plans](#)**

- (2) If the land is in a region within the meaning of the Act, Division 7.1, Subdivision 4, and the name of the Ministerial planning order in which the region is identified.

Yes,

The subject land is within The Lower Hunter Region to which the Environmental Planning and Assessment (Housing and Productivity Contribution) Order 2023 applies.

- (3) If the land is in a special contributions area to which a continued 7.23 determination applies,

Nil

- (4) In this section continued 7.23 determination means a 7.23 determination that -

(a) has been continued in force by the Act, Schedule 4, Part 1, and

(b) has not been repealed as provided by that part.

NOTE: The Act, Schedule 4, Part 1 contains other definitions that affect the interpretation of this section.

4 Complying development

The extent to which the land is land on which complying development may be carried out under each of the codes for complying development because of the provisions of clauses 1.17A (1) (c) to (e), (2), (3) or (4), and 1.18 (1) (c3) and 1.19 of *State Environmental Planning Policy (Exempt and Complying Development Codes) 2008*.

Housing Code

Note: If a lot is not specifically listed in this section then, complying development under this Code **MAY** be carried out on any part of that lot.

NOTE: This information needs to be read in conjunction with the whole of the State Environmental Planning Policy (Exempt and Complying Development Codes) 2008.

Rural Housing Code

Note: If a lot is not specifically listed in this section then, complying development under this Code **MAY** be carried out on any part of that lot.

NOTE: This information needs to be read in conjunction with the whole of the State Environmental Planning Policy (Exempt and Complying Development Codes) 2008.

Low Rise Housing Diversity Code

Note: If a lot is not specifically listed in this section then, complying development under this Code **MAY** be carried out on any part of that lot.

NOTE: This information needs to be read in conjunction with the whole of the State Environmental Planning Policy (Exempt and Complying Development Codes) 2008.

Pattern Book Development Code

Note: If a lot is not specifically listed in this section then, complying development under this Code **MAY** be carried out on any part of that lot.

NOTE: This information needs to be read in conjunction with the whole of the State Environmental Planning Policy (Exempt and Complying Development Codes) 2008.

Greenfield Housing Code

Note: If a lot is not specifically listed in this section then, complying development under this Code **MAY** be carried out on any part of that lot.

NOTE: This information needs to be read in conjunction with the whole of the State Environmental Planning Policy (Exempt and Complying Development Codes) 2008.

Housing Alterations Code

Note: If a lot is not specifically listed in this section then, complying development under this Code **MAY** be carried out on any part of that lot.

NOTE: This information needs to be read in conjunction with the whole of the State Environmental Planning Policy (Exempt and Complying Development Codes) 2008.

General Development Code

Note: If a lot is not specifically listed in this section then, complying development under this Code **MAY** be carried out on any part of that lot.

NOTE: This information needs to be read in conjunction with the whole of the State Environmental Planning Policy (Exempt and Complying Development Codes) 2008.

Industrial and Business Alterations Code

Note: If a lot is not specifically listed in this section then, complying development under this Code **MAY** be carried out on any part of that lot.

NOTE: This information needs to be read in conjunction with the whole of the State Environmental Planning Policy (Exempt and Complying Development Codes) 2008.

Industrial and Business Buildings (New Buildings and Additions) Code

Note: If a lot is not specifically listed in this section then, complying development under this Code **MAY** be carried out on any part of that lot.

NOTE: This information needs to be read in conjunction with the whole of the State Environmental Planning Policy (Exempt and Complying Development Codes) 2008.

Container Recycling Facilities Code

Note: If a lot is not specifically listed in this section then, complying development under this Code **MAY** be carried out on any part of that lot.

NOTE: This information needs to be read in conjunction with the whole of the State Environmental Planning Policy (Exempt and Complying Development Codes) 2008.

Subdivisions Code

Note: If a lot is not specifically listed in this section then, complying development under this Code **MAY** be carried out on any part of that lot.

NOTE: This information needs to be read in conjunction with the whole of the State Environmental Planning Policy (Exempt and Complying Development Codes) 2008.

Demolition Code

Note: If a lot is not specifically listed in this section then, complying development under this Code **MAY** be carried out on any part of that lot.

NOTE: This information needs to be read in conjunction with the whole of the State Environmental Planning Policy (Exempt and Complying Development Codes) 2008.

Fire Safety Code

Note: If a lot is not specifically listed in this section then, complying development under this Code **MAY** be carried out on any part of that lot.

NOTE: This information needs to be read in conjunction with the whole of the State Environmental Planning Policy (Exempt and Complying Development Codes) 2008.

Agritourism and Farm Stay Accommodation Code

Note: If a lot is not specifically listed in this section then, complying development under this Code **MAY** be carried out on any part of that lot.

NOTE: This information needs to be read in conjunction with the whole of the State Environmental Planning Policy (Exempt and Complying Development Codes) 2008.

5 Exempt development

The extent to which the land is land on which exempt development may be carried out under each of the codes for exempt development because of the provisions of clauses 1.16(1)(b1)–(d) or 1.16A of *State Environmental Planning Policy (Exempt and Complying Development Codes) 2008*.

Note: If a lot is not specifically listed in this section then, Exempt development under this Code **MAY** be carried out on the lot.

NOTE: This information needs to be read in conjunction with the whole of the **State Environmental Planning Policy (Exempt and Complying Development Codes) 2008**.

6 Affected building notices and building product rectification orders

- (1) (a) Whether there is any affected building notice of which the council is aware that is in force in respect of the land.

No, Council **has not** been notified that an affected building notice is in force in respect of this land.

- (b) Whether there is any building product rectification order of which the council is aware that is in force in respect of the land and has not been fully complied with.

A building rectification order **is not** in force in respect of this land.

- (c) Whether any notice of intention to make a building product rectification order of which the council is aware has been given in respect of the land and is outstanding.

A notice of intention to make a building product rectification order **has not** been given in respect of this land.

- (2) In this section -

Affected building notice has the same meaning as in Part 4 of the *Building Products (Safety) Act 2017*

Building product rectification order has the same meaning as in the *Building Products (Safety) Act 2017*

7 Land reserved for acquisition

Whether or not any environmental planning instrument or proposed environmental planning instrument referred to in Section 1 makes provision in relation to the acquisition of the land by a public authority, as referred to in section 3.15 of the Act.

No

8 Road widening and road realignment

Whether the land is affected by any road widening or realignment under:

- (a) Division 2 of Part 3 of the *Roads Act 1993*.

No

- (b) any environmental planning instrument.

No

- (c) any resolution of the Council.

No, other road widening proposals may affect this land and if so, will be noted on the Section 10.7 Subsection (5) certificate.

9 Flood related development controls information

- (1) If the land or part of the land is within the flood planning area and subject to flood related development controls.

No

- (2) If the land or part of the land is between the flood planning area and the probable maximum flood and subject to flood related development controls.

No

- (3) In this section -

flood planning area has the same meaning as in the Flood Risk Management Manual.

Flood Risk Management Manual means the *Flood Risk Management Manual*, ISBN 978-1-923076-17-4, published by the NSW Government in June 2023.

probable maximum flood has the same meaning as in the Flood Risk Management Manual.

10 Council and other public authority policies on hazard risk restrictions

- (1) Whether or not the land is affected by a **POLICY** that restricts the development of the land because of the likelihood of:

- (a) land slip or subsidence

Yes

Relevant sections of Lake Macquarie Development Control Plan 2014 and Lake Macquarie Development Control Plan No.1 apply when development is proposed on land covered by Council's geotechnical areas map. The map is available for viewing at the Council. If you require any further clarification on the policy and how it may affect any possible development contact the Council on 02 4921 0333.

- (b) bushfire

Yes

- (c) tidal inundation

No

- (d) acid sulfate soils

Yes

Relevant sections of Lake Macquarie Development Control Plan 2014 and Lake Macquarie Development Control Plan No.1 apply when development is proposed on land covered by the Acid Sulfate Soils Map. If you require any further clarification on the policy and how it may affect any possible development contact the Council on 02 4921 0333.

- (e) contaminated or potentially contaminated land

Yes

Council has adopted a policy that may restrict the development of Contaminated or Potentially Contaminated land. This policy is implemented when zoning, development, or land use changes are proposed. Council does not hold sufficient information about previous use of the land to determine whether the land is contaminated. Consideration of Council's adopted Policy located in the applicable DCP noted in Clause 1(3) above, and the application of provisions under relevant State legislation is recommended.

- (f) aircraft noise

No

- (g) salinity

No

- (h) any other risk (other than flooding).

No

- (2) In this section —

adopted policy means a policy adopted —

- (a) by the council, or

- (b) by another public authority, if the public authority has notified the council that the policy will be included in a planning certificate issued by the council.

NOTE: The absence of a council policy restricting development of the land by reason of a particular natural hazard does not mean that the risk from that hazard is non-existent.

11 Bush Fire Prone Land

Note: If a lot is not specifically listed in this section then, **NONE** of that lot is bush fire prone land.

Lot 2 DP 1225469 - ALL of the land is bush fire prone land.

12 Loose-fill asbestos insulation

If the land includes any residential premises (within the meaning of Division 1A of Part 8 of the *Home Building Act 1989*) that are listed on the register that is required to be maintained under that Division

No. Council **has not** been notified that a residential premises erected on this land has been identified in the NSW Fair Trading Loose-Fill Asbestos Insulation Register as containing loose-fill asbestos ceiling insulation.

13 Mine subsidence

Whether the land is declared to be a mine subsidence district, within the meaning of the *Coal Mine Subsidence Compensation Act 2017*.

The land IS WITHIN a declared Mine Subsidence District under section 20 of the Coal Mine Subsidence Compensation Act 2017. Development in a Mine Subsidence District requires approval from Subsidence Advisory NSW. Subsidence Advisory NSW provides compensation to property owners for mine subsidence damage. To be eligible for compensation, development must be constructed in accordance with Subsidence Advisory NSW approval. Subsidence Advisory NSW has set surface development guidelines for properties in Mine Subsidence Districts that specify building requirements to help prevent potential damage from coal mine subsidence.

NOTE: The advice in section 13 above relates only to a Mine Subsidence District. Further information relating to underground mining which may occur outside Mine Subsidence Districts should be sought. Underground mining information can be found on the Subsidence Advisory NSW website.

14 Paper subdivision information

- (1) The name of any development plan adopted by a relevant authority that applies to the land or that is proposed to be subject to a consent ballot.
Nil
- (2) The date of any subdivision order that applies to the land.
Not Applicable
- (3) Words and expressions used in this section have the same meaning as in this Regulation, Part 10 and the Act, Schedule 7.

15 Property Vegetation Plans

The land IS NOT subject to a property vegetation plan approved under Part 4 of the Native Vegetation Act 2003 (and that continues in force).

16 Biodiversity stewardship sites

The land is not a biodiversity stewardship site under a biodiversity stewardship agreement under Part 5 of the Biodiversity Conservation Act 2016.

NOTE: Biodiversity stewardship agreements include biobanking agreements under the [Threatened Species Conservation Act 1995](#), Part 7A that are taken to be biodiversity stewardship agreements under the [Biodiversity Conservation Act 2016](#), Part 5.

17 Biodiversity Certified Land

This land is not biodiversity certified land under Part 8 of the Biodiversity Conservation Act 2016.

NOTE: Biodiversity certified land includes land certified under the [Threatened Species Conservation Act 1995](#), Part 7AA that is taken to be certified under the [Biodiversity Conservation Act 2016](#), Part 8.

18 Orders under *Trees (Disputes Between Neighbours) Act 2006*

Has an order been made under the *Trees (Disputes Between Neighbours) Act 2006* to carry out work in relation to a tree on the land (but only if the council has been notified of the order).

The land IS NOT subject to an order made under the *Trees (Disputes Between Neighbours) Act 2006* to carry out work in relation to a tree on the land.

19 Annual charges under *Local Government Act 1993* for coastal protection services that relate to existing coastal protection works

Whether the owner (or any previous owner) of the land has consented in writing to the land being subject to annual charges under section 496B of the *Local Government Act 1993* for coastal protection services that relate to existing coastal protection works (within the meaning of section 553B of that Act).

Nil

NOTE: “Existing coastal protection works” are works to reduce the impact of coastal hazards on land (such as seawalls, revetments, groynes and beach nourishment) that existed before the commencement of section 553B of the *Local Government Act 1993*.

20 Western Sydney Aerotropolis

Under [State Environmental Planning Policy \(Precincts—Western Parkland City\) 2021](#), Chapter 4, **is the land:**

This chapter does not apply to the Lake Macquarie Local Government Area.

21 Conditions for seniors housing

If *State Environmental Planning Policy (Housing) 2021*, Chapter 3, Part 5 applies to the land, a statement setting out terms of a kind referred to in the Policy, clause 88(2) that have been imposed as a condition of development consent granted after 11 October 2007 in relation to the land.

Nil

22 Site compatibility certificates and conditions for affordable rental housing

- (1) Whether there is a current site compatibility certificate, or a former site compatibility certificate, of which the council is aware, in relation to proposed development on the land.

Council is not aware of any site capability certificate for any proposed development on the land.

- (2) If *State Environmental Planning Policy (Housing) 2021*, Chapter 2, Part 2, Division 1 or 5 applies to the land, any conditions of a development consent in relation to the land that are of a kind referred to in that Policy, section 21(1) or 40(1).

Nil

- (3) Any conditions of a development consent in relation to land that are of a kind referred to in *State Environmental Planning Policy (Affordable Rental Housing) 2009*, clause 17(1) or 38(1).

Council is not aware of any conditions of a development consent referred to in *State Environmental Planning Policy (Affordable Rental Housing) 2009*, clause 17(1) or 38(1).

- (4) In this section—

former site compatibility certificate means a site compatibility certificate issued under *State Environmental Planning Policy (Affordable Rental Housing) 2009*.

23 Water or sewerage services

Whether water or sewerage services are, or are to be, provided by a utility, other than a public water utility, under the Water Industry Competition Act 2006.

No

24 Special Entertainment Precincts

Whether the land or part of the land is in a special entertainment precinct within the meaning of the [Local Government Act 1993, section 202B](#).

No

NOTE: The following matters are prescribed by section 59 (2) of the *Contaminated Land Management Act 1997* as additional matters to be specified in a planning certificate:

Matters arising under the Contaminated Land Management Act 1997 (s59 (2))

- (a) The land to which the certificate relates is significantly contaminated land within the meaning of that Act - if the land (or part of the land) is significantly contaminated land at the date when the certificate is issued,

No

- (b) The land to which the certificate relates is subject to a management order within the meaning of that Act - if it is subject to such an order at the date when the certificate is issued,

No

- (c) The land to which the certificate relates is the subject of an approved voluntary management proposal within the meaning of that Act - if it is the subject of such an approved proposal at the date when the certificate is issued,

No

- (d) The land to which the certificate relates is subject to an ongoing maintenance order within the meaning of that Act - if it is subject to such an order at the date when the certificate is issued,

No

- (e) The land to which the certificate relates is the subject of a site audit statement within the meaning of that Act - if a copy of such a statement has been provided at any time to the local authority issuing the certificate.

No



HUNTER WATER CORPORATION

A.B.N. 46 228 513 446

SERVICE LOCATION PLAN

Enquiries: 1300 657 657

APPLICANT'S DETAILS



InfoTrack
54A TRANSFIELD
EDGEWORTH NSW

APPLICATION NO.: 2619864
APPLICANT REF: M 32434
RATEABLE PREMISE NO.: 6319737580

PROPERTY ADDRESS: 54A TRANSFIELD AVE EDGEWORTH 2285
LOT/SECTION/DP:SP: 2//DP 1225469

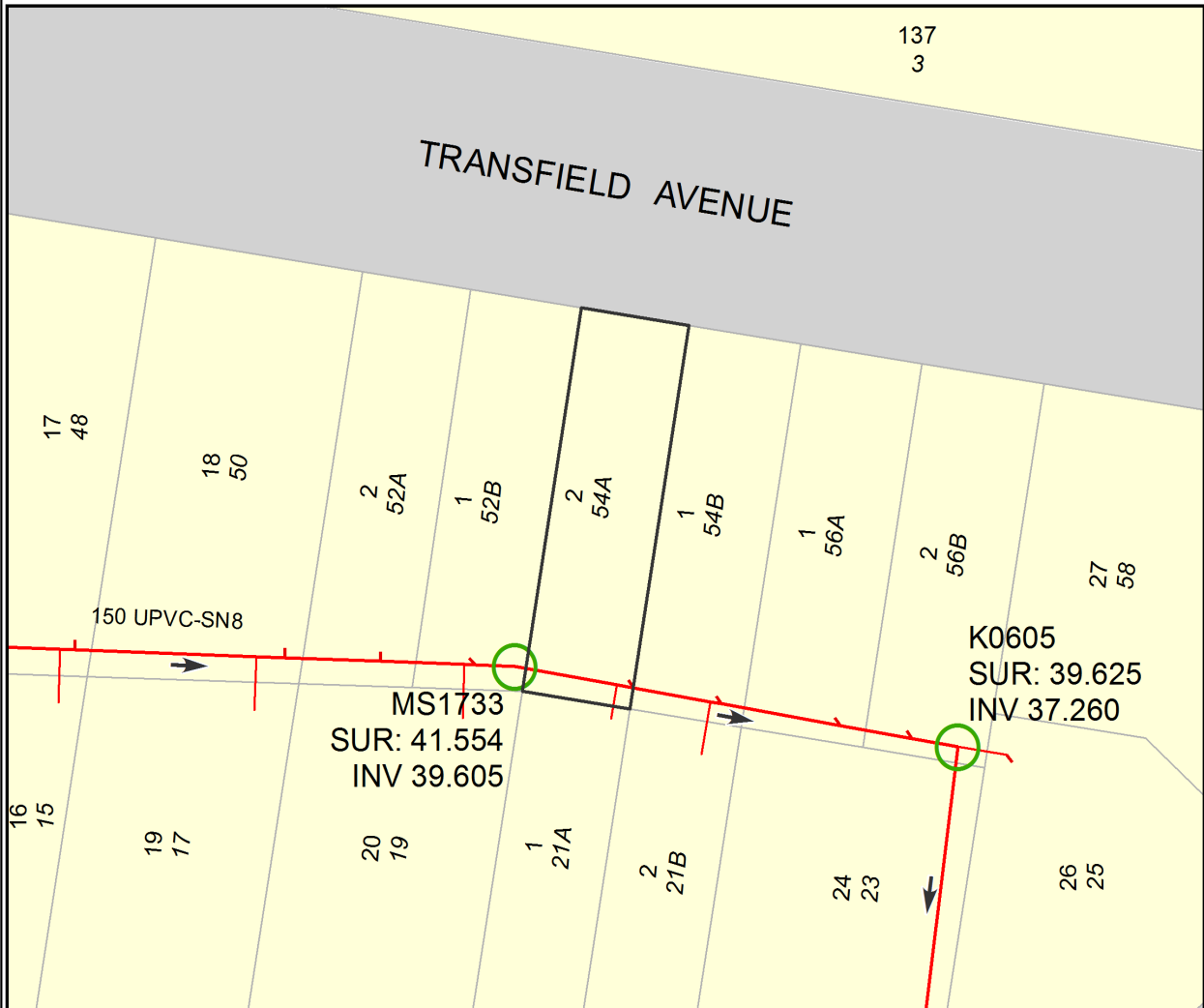

SEWER POSITION APPROXIMATE ONLY.
SUBJECT PROPERTY BOLDED.
ALL MEASUREMENTS ARE METRIC.

IF A SEWERMAIN IS LAID WITHIN THE BOUNDARIES OF THE LOT, SPECIAL REQUIREMENTS FOR THE PROTECTION OF THE SEWERMAIN APPLY IF DEVELOPMENT IS UNDERTAKEN. IN THESE CASES, IT IS RECOMMENDED THAT YOU SEEK ADVICE ON THE SPECIAL REQUIREMENTS PRIOR TO PURCHASE. PHONE 1300 657 657, FOR MORE INFORMATION.

IMPORTANT:
IF THIS PLAN INDICATES A SEWER CONNECTION IS AVAILABLE OR PROPOSED FOR THE SUBJECT PROPERTY, IT IS THE INTENDING OWNERS RESPONSIBILITY TO DETERMINE WHETHER IT IS PRACTICABLE TO DISCHARGE WASTEWATER FROM ALL PARTS OF THE PROPERTY TO THAT CONNECTION.

ANY INFORMATION ON THIS PLAN MAY NOT BE UP TO DATE AND THE CORPORATION ACCEPTS NO RESPONSIBILITY FOR ITS ACCURACY.

Date: 22/08/2025

Scale at A4: 1:500

CADASTRAL DATA © LPI OF NSW
CONTOUR DATA © AAMHatch
© Department of Planning

SEWER/WATER/RECYCLED WATER
UTILITY DATA
© HUNTER WATER CORPORATION