



**RECORD OF TITLE
UNDER LAND TRANSFER ACT 2017
FREEHOLD**

**Guaranteed Search Copy issued under Section 60 of the Land
Transfer Act 2017**



R. W. Muir
Registrar-General
of Land

Identifier **HBY1/651**
Land Registration District **Hawkes Bay**
Date Issued 04 October 2000

Prior References

HBW4/747

Estate Fee Simple
Area 1.6682 hectares more or less
Legal Description Lot 2 Deposited Plan 28215

Registered Owners

Alison Cherie Brittain and Napier Independent Trustees No. 7 Limited

Interests

Appurtenant hereto are rights to drain water and to convey water and electric power specified in Easement Certificate 693696.2 - 6.10.1999 at 11.40 am

Some of the easements specified in Easement Certificate 693696.2 are subject to Section 243 (a) Resource Management Act 1991 - See DP 27787

Appurtenant hereto are rights to convey water and electric power specified in Easement Certificate 693696.3 - 6.10.1999 at 11.40 am

The easements specified in Easement Certificate 693696.3 are subject to Section 243 (a) Resource Management Act 1991

707912.1 Consent Notice pursuant to Section 221(1) Resource Management Act 1991 - 4.10.2000 at 11.31 am

707912.3 Consent Notice pursuant to Section 221(1) Resource Management Act 1991 - 4.10.2000 at 11.31 am

Subject to a right (in gross) to permit for the purposes of soil conservation and river control as a flood detention area over part marked AF on DP 28215 in favour of (now) Hastings District Council created by Transfer 707912.10 - 4.10.2000 at 11.31 am

Land Covenant in Transfer 5209803.2 - 2.5.2002 at 11:02 am

12903182.2 Mortgage to ASB Bank Limited - 21.12.2023 at 8:45 am

Signed for and on behalf of
Chambers Land Holdings Limited

REGISTERED PROPRIETORS

I hereby certify that this plan was approved by the Hastings District Council in accordance with section 223 of the Resource Management Act 1991 on the 27th day of March 2000

Subject to the Granting or Reserving of the easements set out in the Memorandum hereon and Subject to the Amalgamation Conditions set out hereon

Signed on behalf of the Hastings District Council by
[Signature]
Authorised Officer

HDC REF 990/715

Free Book 264, 265, 266, 267, 268, 269, 270, 271, 272, 273, 274, 275, 276, 277, 278, 279, 280, 281, 282, 283, 284, 285, 286, 287, 288, 289, 290, 291, 292, 293, 294, 295, 296, 297, 298, 299, 300, 301, 302, 303, 304, 305, 306, 307, 308, 309, 310, 311, 312, 313, 314, 315, 316, 317, 318, 319, 320, 321, 322, 323, 324, 325, 326, 327, 328, 329, 330, 331, 332, 333, 334, 335, 336, 337, 338, 339, 340, 341, 342, 343, 344, 345, 346, 347, 348, 349, 350, 351, 352, 353, 354, 355, 356, 357, 358, 359, 360, 361, 362, 363, 364, 365, 366, 367, 368, 369, 370, 371, 372, 373, 374, 375, 376, 377, 378, 379, 380, 381, 382, 383, 384, 385, 386, 387, 388, 389, 390, 391, 392, 393, 394, 395, 396, 397, 398, 399, 400, 401, 402, 403, 404, 405, 406, 407, 408, 409, 410, 411, 412, 413, 414, 415, 416, 417, 418, 419, 420, 421, 422, 423, 424, 425, 426, 427, 428, 429, 430, 431, 432, 433, 434, 435, 436, 437, 438, 439, 440, 441, 442, 443, 444, 445, 446, 447, 448, 449, 450, 451, 452, 453, 454, 455, 456, 457, 458, 459, 460, 461, 462, 463, 464, 465, 466, 467, 468, 469, 470, 471, 472, 473, 474, 475, 476, 477, 478, 479, 480, 481, 482, 483, 484, 485, 486, 487, 488, 489, 490, 491, 492, 493, 494, 495, 496, 497, 498, 499, 500, 501, 502, 503, 504, 505, 506, 507, 508, 509, 510, 511, 512, 513, 514, 515, 516, 517, 518, 519, 520, 521, 522, 523, 524, 525, 526, 527, 528, 529, 530, 531, 532, 533, 534, 535, 536, 537, 538, 539, 540, 541, 542, 543, 544, 545, 546, 547, 548, 549, 550, 551, 552, 553, 554, 555, 556, 557, 558, 559, 560, 561, 562, 563, 564, 565, 566, 567, 568, 569, 570, 571, 572, 573, 574, 575, 576, 577, 578, 579, 580, 581, 582, 583, 584, 585, 586, 587, 588, 589, 590, 591, 592, 593, 594, 595, 596, 597, 598, 599, 600, 601, 602, 603, 604, 605, 606, 607, 608, 609, 610, 611, 612, 613, 614, 615, 616, 617, 618, 619, 620, 621, 622, 623, 624, 625, 626, 627, 628, 629, 630, 631, 632, 633, 634, 635, 636, 637, 638, 639, 640, 641, 642, 643, 644, 645, 646, 647, 648, 649, 650, 651, 652, 653, 654, 655, 656, 657, 658, 659, 660, 661, 662, 663, 664, 665, 666, 667, 668, 669, 670, 671, 672, 673, 674, 675, 676, 677, 678, 679, 680, 681, 682, 683, 684, 685, 686, 687, 688, 689, 690, 691, 692, 693, 694, 695, 696, 697, 698, 699, 700, 701, 702, 703, 704, 705, 706, 707, 708, 709, 710, 711, 712, 713, 714, 715, 716, 717, 718, 719, 720, 721, 722, 723, 724, 725, 726, 727, 728, 729, 730, 731, 732, 733, 734, 735, 736, 737, 738, 739, 740, 741, 742, 743, 744, 745, 746, 747, 748, 749, 750, 751, 752, 753, 754, 755, 756, 757, 758, 759, 760, 761, 762, 763, 764, 765, 766, 767, 768, 769, 770, 771, 772, 773, 774, 775, 776, 777, 778, 779, 780, 781, 782, 783, 784, 785, 786, 787, 788, 789, 790, 791, 792, 793, 794, 795, 796, 797, 798, 799, 800, 801, 802, 803, 804, 805, 806, 807, 808, 809, 810, 811, 812, 813, 814, 815, 816, 817, 818, 819, 820, 821, 822, 823, 824, 825, 826, 827, 828, 829, 830, 831, 832, 833, 834, 835, 836, 837, 838, 839, 840, 841, 842, 843, 844, 845, 846, 847, 848, 849, 850, 851, 852, 853, 854, 855, 856, 857, 858, 859, 860, 861, 862, 863, 864, 865, 866, 867, 868, 869, 870, 871, 872, 873, 874, 875, 876, 877, 878, 879, 880, 881, 882, 883, 884, 885, 886, 887, 888, 889, 890, 891, 892, 893, 894, 895, 896, 897, 898, 899, 900, 901, 902, 903, 904, 905, 906, 907, 908, 909, 910, 911, 912, 913, 914, 915, 916, 917, 918, 919, 920, 921, 922, 923, 924, 925, 926, 927, 928, 929, 930, 931, 932, 933, 934, 935, 936, 937, 938, 939, 940, 941, 942, 943, 944, 945, 946, 947, 948, 949, 950, 951, 952, 953, 954, 955, 956, 957, 958, 959, 960, 961, 962, 963, 964, 965, 966, 967, 968, 969, 970, 971, 972, 973, 974, 975, 976, 977, 978, 979, 980, 981, 982, 983, 984, 985, 986, 987, 988, 989, 990, 991, 992, 993, 994, 995, 996, 997, 998, 999, 1000

CLASS OF SURVEY I
Total Area 37:3255ha
Comprised in CT W4/747

I, COLIN GEORGE SHANLEY, being a person entitled to the surveys to which this document relates, do hereby certify that the information contained in this document is true and correct, and was undertaken by me or under my supervision in accordance with the Survey Regulations Act 1988 and the Survey Regulations 1988.

(b) This document is accurate, and has been created in accordance with that Act and those Regulations.

Dated at Hastings this 1st day of March 2000

Signature *[Signature]*
Colin George Shanley

Free Book 264, 265, 266, 267, 268, 269, 270, 271, 272, 273, 274, 275, 276, 277, 278, 279, 280, 281, 282, 283, 284, 285, 286, 287, 288, 289, 290, 291, 292, 293, 294, 295, 296, 297, 298, 299, 300, 301, 302, 303, 304, 305, 306, 307, 308, 309, 310, 311, 312, 313, 314, 315, 316, 317, 318, 319, 320, 321, 322, 323, 324, 325, 326, 327, 328, 329, 330, 331, 332, 333, 334, 335, 336, 337, 338, 339, 340, 341, 342, 343, 344, 345, 346, 347, 348, 349, 350, 351, 352, 353, 354, 355, 356, 357, 358, 359, 360, 361, 362, 363, 364, 365, 366, 367, 368, 369, 370, 371, 372, 373, 374, 375, 376, 377, 378, 379, 380, 381, 382, 383, 384, 385, 386, 387, 388, 389, 390, 391, 392, 393, 394, 395, 396, 397, 398, 399, 400, 401, 402, 403, 404, 405, 406, 407, 408, 409, 410, 411, 412, 413, 414, 415, 416, 417, 418, 419, 420, 421, 422, 423, 424, 425, 426, 427, 428, 429, 430, 431, 432, 433, 434, 435, 436, 437, 438, 439, 440, 441, 442, 443, 444, 445, 446, 447, 448, 449, 450, 451, 452, 453, 454, 455, 456, 457, 458, 459, 460, 461, 462, 463, 464, 465, 466, 467, 468, 469, 470, 471, 472, 473, 474, 475, 476, 477, 478, 479, 480, 481, 482, 483, 484, 485, 486, 487, 488, 489, 490, 491, 492, 493, 494, 495, 496, 497, 498, 499, 500, 501, 502, 503, 504, 505, 506, 507, 508, 509, 510, 511, 512, 513, 514, 515, 516, 517, 518, 519, 520, 521, 522, 523, 524, 525, 526, 527, 528, 529, 530, 531, 532, 533, 534, 535, 536, 537, 538, 539, 540, 541, 542, 543, 544, 545, 546, 547, 548, 549, 550, 551, 552, 553, 554, 555, 556, 557, 558, 559, 560, 561, 562, 563, 564, 565, 566, 567, 568, 569, 570, 571, 572, 573, 574, 575, 576, 577, 578, 579, 580, 581, 582, 583, 584, 585, 586, 587, 588, 589, 590, 591, 592, 593, 594, 595, 596, 597, 598, 599, 600, 601, 602, 603, 604, 605, 606, 607, 608, 609, 610, 611, 612, 613, 614, 615, 616, 617, 618, 619, 620, 621, 622, 623, 624, 625, 626, 627, 628, 629, 630, 631, 632, 633, 634, 635, 636, 637, 638, 639, 640, 641, 642, 643, 644, 645, 646, 647, 648, 649, 650, 651, 652, 653, 654, 655, 656, 657, 658, 659, 660, 661, 662, 663, 664, 665, 666, 667, 668, 669, 670, 671, 672, 673, 674, 675, 676, 677, 678, 679, 680, 681, 682, 683, 684, 685, 686, 687, 688, 689, 690, 691, 692, 693, 694, 695, 696, 697, 698, 699, 700, 701, 702, 703, 704, 705, 706, 707, 708, 709, 710, 711, 712, 713, 714, 715, 716, 717, 718, 719, 720, 721, 722, 723, 724, 725, 726, 727, 728, 729, 730, 731, 732, 733, 734, 735, 736, 737, 738, 739, 740, 741, 742, 743, 744, 745, 746, 747, 748, 749, 750, 751, 752, 753, 754, 755, 756, 757, 758, 759, 760, 761, 762, 763, 764, 765, 766, 767, 768, 769, 770, 771, 772, 773, 774, 775, 776, 777, 778, 779, 780, 781, 782, 783, 784, 785, 786, 787, 788, 789, 790, 791, 792, 793, 794, 795, 796, 797, 798, 799, 800, 801, 802, 803, 804, 805, 806, 807, 808, 809, 810, 811, 812, 813, 814, 815, 816, 817, 818, 819, 820, 821, 822, 823, 824, 825, 826, 827, 828, 829, 830, 831, 832, 833, 834, 835, 836, 837, 838, 839, 840, 841, 842, 843, 844, 845, 846, 847, 848, 849, 850, 851, 852, 853, 854, 855, 856, 857, 858, 859, 860, 861, 862, 863, 864, 865, 866, 867, 868, 869, 870, 871, 872, 873, 874, 875, 876, 877, 878, 879, 880, 881, 882, 883, 884, 885, 886, 887, 888, 889, 890, 891, 892, 893, 894, 895, 896, 897, 898, 899, 900, 901, 902, 903, 904, 905, 906, 907, 908, 909, 910, 911, 912, 913, 914, 915, 916, 917, 918, 919, 920, 921, 922, 923, 924, 925, 926, 927, 928, 929, 930, 931, 932, 933, 934, 935, 936, 937, 938, 939, 940, 941, 942, 943, 944, 945, 946, 947, 948, 949, 950, 951, 952, 953, 954, 955, 956, 957, 958, 959, 960, 961, 962, 963, 964, 965, 966, 967, 968, 969, 970, 971, 972, 973, 974, 975, 976, 977, 978, 979, 980, 981, 982, 983, 984, 985, 986, 987, 988, 989, 990, 991, 992, 993, 994, 995, 996, 997, 998, 999, 1000

Approved as to Survey
2/18/2000
Chief Surveyor

Deposited this 4th day of March 2000

FOR REGISTRAR GENERAL OF LAND
Shantley & Co.
28215

File No. 339
Platform Approval
WGM 95/2

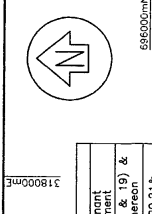

Memorandum of Easements	
Shown	Dominant Tenement
Right of Way	Lots 16, 19 & Lot 18 hereon.
Right to Drain Water	Lots 15, 20, 21 & Lot 22 hereon.

Schedule of Existing Easements	
Shown	Document
Right to Drain Water	Lots 2, 3, 4, 5 & 6 hereon.
Right to Drain Water	Lots 2, 3, 4, 5 & 6 hereon.

Schedule of Proposed Easements	
Shown	Servient Tenement
Right to Convey Water	Lot 29 hereon.
Right to Convey Water	Lots 2, 3, 4, 5 & 6 hereon.

NEW CTs ALLOCATED

Lot 1
Lot 2
Lot 3
Lot 4
Lot 5
Lot 6
Lot 7
Lot 8
Lot 9
Lot 10
Lot 11
Lot 12
Lot 13
Lot 14
Lot 15
Lot 16
Lot 17
Lot 18
Lot 19
Lot 20
Lot 21
Lot 22
Lot 23
Lot 24
Lot 25
Lot 26
Lot 27
Lot 28
Lot 29
Lot 30
Lot 31
Lot 32
Lot 33
Lot 34
Lot 35
Lot 36
Lot 37
Lot 38
Lot 39
Lot 40
Lot 41
Lot 42
Lot 43
Lot 44
Lot 45
Lot 46
Lot 47
Lot 48
Lot 49
Lot 50
Lot 51
Lot 52
Lot 53
Lot 54
Lot 55
Lot 56
Lot 57
Lot 58
Lot 59
Lot 60
Lot 61
Lot 62
Lot 63
Lot 64
Lot 65
Lot 66
Lot 67
Lot 68
Lot 69
Lot 70
Lot 71
Lot 72
Lot 73
Lot 74
Lot 75
Lot 76
Lot 77
Lot 78
Lot 79
Lot 80
Lot 81
Lot 82
Lot 83
Lot 84
Lot 85
Lot 86
Lot 87
Lot 88
Lot 89
Lot 90
Lot 91
Lot 92
Lot 93
Lot 94
Lot 95
Lot 96
Lot 97
Lot 98
Lot 99
Lot 100

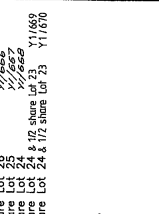

SCHEDULE OF PROPOSED EASEMENTS	
PURPOSE	SHOWN
Right to Convey Water	(A) Lot 29 hereon.
Right to Convey Water	(B) Lot 15 hereon.
Right to Convey Water	(C) Lot 20 hereon.
Right to Convey Water	(D) Lot 25 hereon.
Right to Convey Water	(E) Lot 30 hereon.

SCHEDULE OF PROPOSED EASEMENTS	
PURPOSE	SERVIENT TENEMENT
Right to Convey Water	Lot 15 hereon.
Right to Convey Water	Lot 20 hereon.
Right to Convey Water	Lot 25 hereon.
Right to Convey Water	Lot 30 hereon.

Scale 1:4000 Date MARCH 2000

TERRITORIAL AUTHORITY HASTINGS DISTRICT
Surveyed by Shantley & Co.
Scale 1:4000 Date MARCH 2000

PLAN OF LOTS 1 to 31
FORMERLY LOT 1 DP27742

SHEET ONE OF THREE SHEETS

AMALGAMATION CONDITIONS:

i) That Lots 19 and 16 hereon be held in the same certificate of title

ii) That Lots 6 and 29 hereon be held in the same certificate of title

iii) That Lot 23 hereon (legal access) be held as to two undivided 1/2 shares by the owners of lots 21 and 22 hereon as tenants in common in the said shares and that individual certificates of title are issued in accordance therewith

iv) That Lot 24 hereon (legal access) be held as to four undivided 1/4 shares by the owners of lots 18 and 22 hereon as tenants in common in the said shares and that individual certificates of title are issued in accordance therewith

v) That Lot 25 hereon (legal access) be held as to two undivided 1/2 shares by the owners of lots 18 and 22 hereon as tenants in common in the said shares and that individual certificates of title are issued in accordance therewith

vi) That Lot 26 hereon (legal access) be held as to two undivided 1/2 shares by the owners of lots 18 and 22 hereon as tenants in common in the said shares and that individual certificates of title are issued in accordance therewith

vii) That Lot 28 hereon (legal access) be held as to two undivided 1/2 shares by the owners of lots 5 and 14 hereon as tenants in common in the said shares and that individual certificates of title are issued in accordance therewith

SEE CSN 690165-1

SCHEDULE OF PROPOSED EASEMENTS IN GROSS

PURPOSE	SHOWN	GRANTEE
RIGHT TO CONVEY WATER AND RIGHT TO DRAIN SEWAGE	(A) LOT 16 HEREON	HASTINGS DISTRICT COUNCIL
RIGHT TO CONVEY WATER	(B) LOT 24 HEREON	HASTINGS DISTRICT COUNCIL
RIGHT TO DRAIN WATER	(C) LOT 15 HEREON	HASTINGS DISTRICT COUNCIL
RIGHT TO DRAIN WATER	(D) LOT 20 HEREON	HASTINGS DISTRICT COUNCIL
RIGHT TO CONVEY ELECTRIC POWER	(E) LOT 24 HEREON	HASTINGS DISTRICT COUNCIL
RIGHT TO CONVEY ELECTRIC POWER	(F) LOT 15 HEREON	HASTINGS DISTRICT COUNCIL
RIGHT TO CONVEY ELECTRIC POWER	(G) LOT 20 HEREON	HASTINGS DISTRICT COUNCIL
RIGHT TO CONVEY ELECTRIC POWER	(H) LOT 25 HEREON	HASTINGS DISTRICT COUNCIL
RIGHT TO CONVEY ELECTRIC POWER	(I) LOT 30 HEREON	HASTINGS DISTRICT COUNCIL
RIGHT TO CONVEY ELECTRIC POWER	(J) LOT 15 HEREON	HASTINGS DISTRICT COUNCIL
RIGHT TO CONVEY ELECTRIC POWER	(K) LOT 20 HEREON	HASTINGS DISTRICT COUNCIL
RIGHT TO CONVEY ELECTRIC POWER	(L) LOT 25 HEREON	HASTINGS DISTRICT COUNCIL
RIGHT TO CONVEY ELECTRIC POWER	(M) LOT 30 HEREON	HASTINGS DISTRICT COUNCIL
RIGHT TO CONVEY ELECTRIC POWER	(N) LOT 15 HEREON	HASTINGS DISTRICT COUNCIL
RIGHT TO CONVEY ELECTRIC POWER	(O) LOT 20 HEREON	HASTINGS DISTRICT COUNCIL
RIGHT TO CONVEY ELECTRIC POWER	(P) LOT 25 HEREON	HASTINGS DISTRICT COUNCIL
RIGHT TO CONVEY ELECTRIC POWER	(Q) LOT 30 HEREON	HASTINGS DISTRICT COUNCIL

LAND DISTRICT
SURVEY BLK & DIST.
NZMS 261 SH1

Hawkes Bay
REC MAP NO

LAND DISTRICT
SURVEY BLK & DIST.
NZMS 261 SH1

Hawkes Bay
REC MAP NO

LAND DISTRICT
SURVEY BLK & DIST.
NZMS 261 SH1

Hawkes Bay
REC MAP NO

LAND DISTRICT
SURVEY BLK & DIST.
NZMS 261 SH1

Hawkes Bay
REC MAP NO

LAND DISTRICT
SURVEY BLK & DIST.
NZMS 261 SH1

Hawkes Bay
REC MAP NO

LAND DISTRICT
SURVEY BLK & DIST.
NZMS 261 SH1

Hawkes Bay
REC MAP NO

LAND DISTRICT
SURVEY BLK & DIST.
NZMS 261 SH1

Hawkes Bay
REC MAP NO

LAND DISTRICT
SURVEY BLK & DIST.
NZMS 261 SH1

Hawkes Bay
REC MAP NO

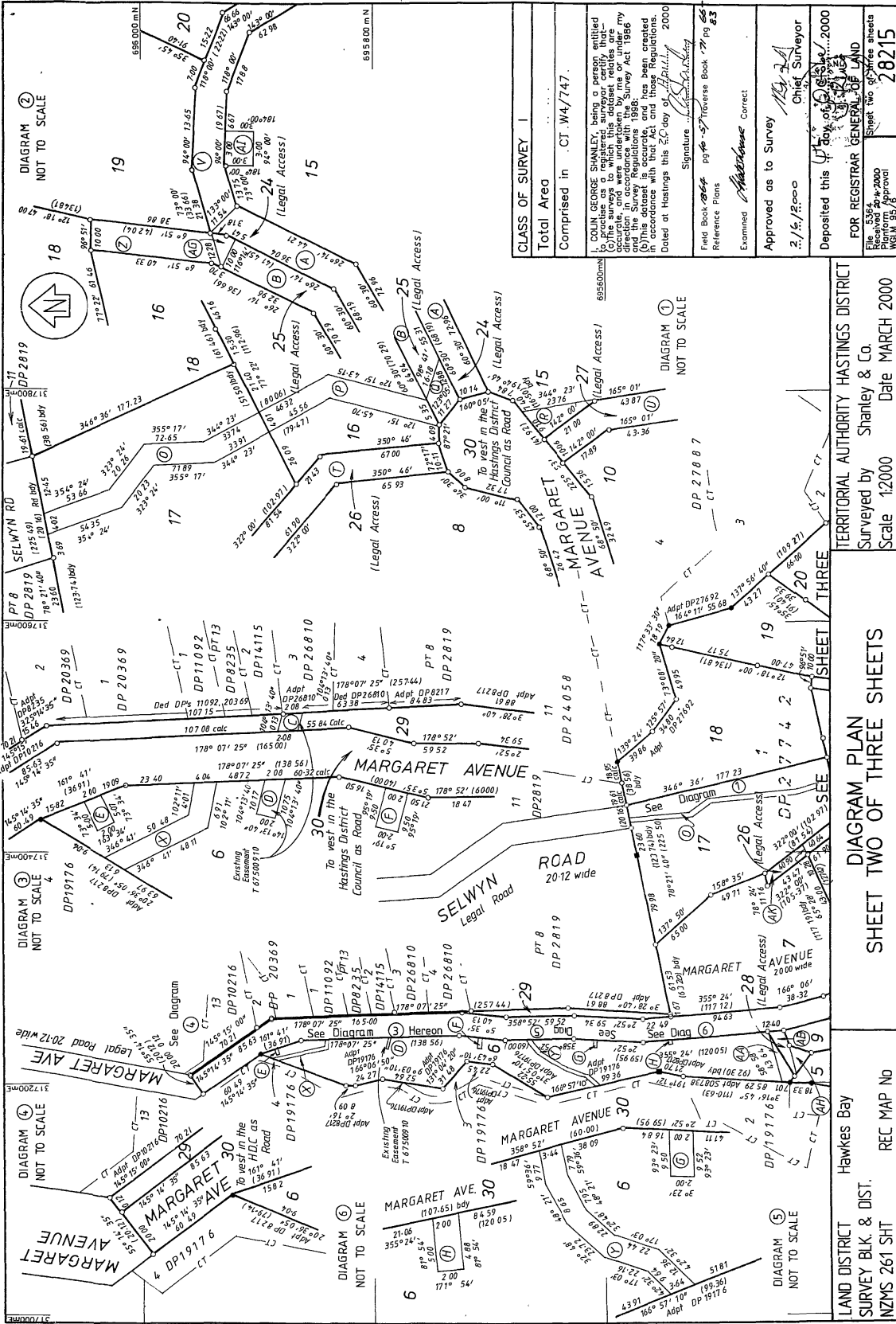

CLASS OF SURVEY I	
Total Area	695650m ²
Comprised in	CT. W4/747.

I, COLIN GEORGE SHANLEY, being a person entitled to practise as a surveyor under the provisions of (a) the Survey Act 1986 and (b) the Survey Regulations 1986, certify that the survey to which this dataset relates are accurate, and were undertaken by me or under my supervision, and that the survey was conducted in accordance with the Survey Act 1986 and the Survey Regulations 1986. (b) This dataset is accurate, and has been created and checked in accordance with the Survey Act 1986 and the Survey Regulations 1986. Dated at Hastings this 20th day of February, 2000

Signature: *Colin G. Shanley*
 Title: Chief Surveyor

Field Book: *1998-027* Reverse Book: *77 pg 63*
 Reference: *None*
 Examined: *Shanley* Correct
 Approved as to Survey: *MS* Chief Surveyor
 Date: *2/1/2000*
 Deposited this day of *February*, 2000

FOR REGISTRAR GENERAL OF LAND
 Received: *20/02/2000*
 Plan No: *1998/027*
 Sheet No: *28215*

DIAGRAM PLAN SHEET TWO OF THREE SHEETS
 Scale 1:2000 Date MARCH 2000
 TERRITORIAL AUTHORITY HASTINGS DISTRICT
 Surveyed by *Shanley & Co*
 REC MAP NO
 HAWKES BAY SURVEY BLK. & DIST.
 NZMS 261 SHT

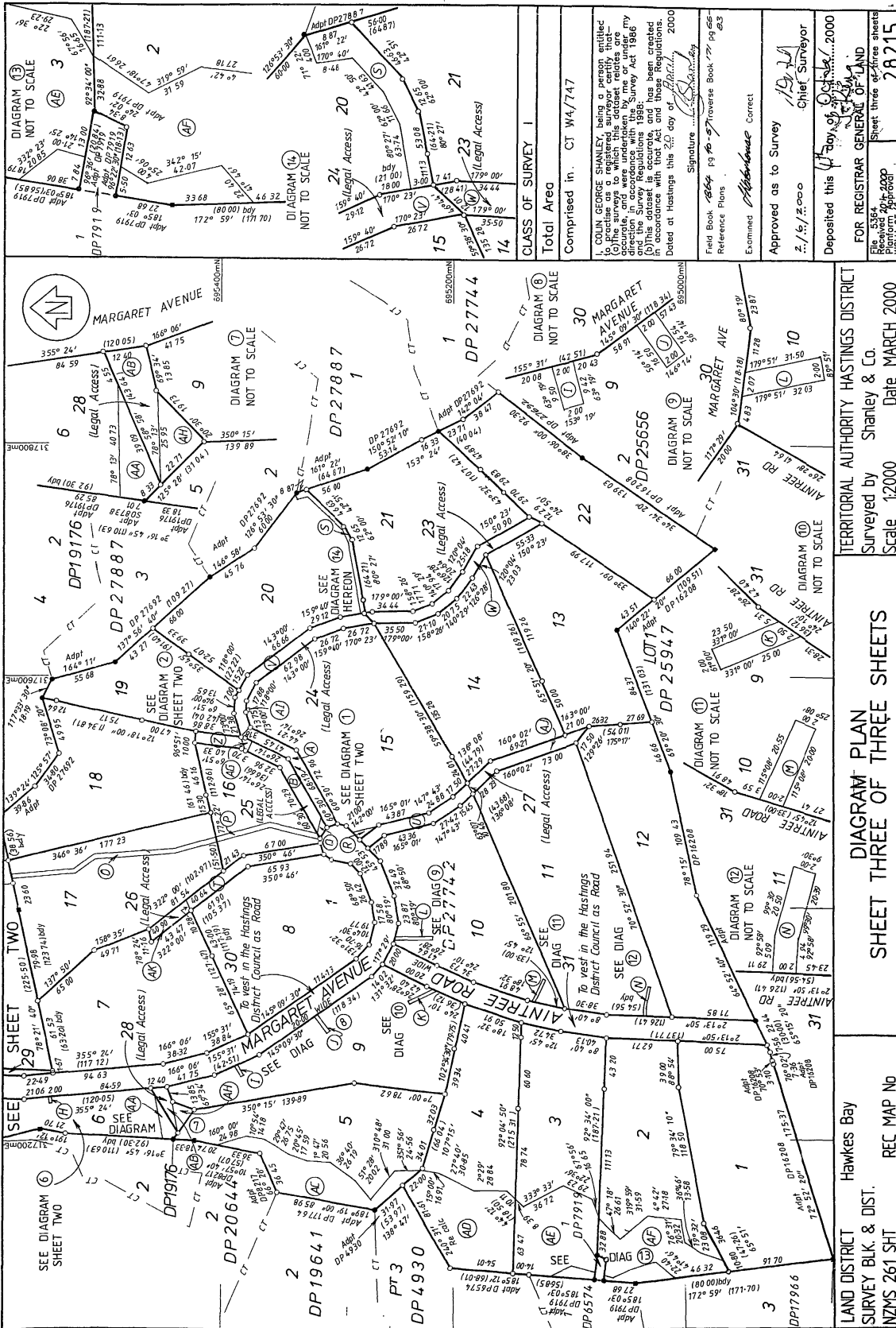

LAND DISTRICT Hawkes Bay
 SURVEY BLK. & DIST.
 NZMS 261 SH1

REC MAP NO

SHEET THREE OF THREE SHEETS

Scale 1:2000 Date MARCH 2000

TERRITORIAL AUTHORITY HASTINGS DISTRICT
 Surveyed by Stanley & Co.

CLASS OF SURVEY I
 Total Area
 Comprised in. CT W4/747

I, COLIN GEORGE SHANLEY, being in person mentioned to certify as a registered surveyor, certify that the survey to which this diagram relates are in accordance with the Survey Act 1986 in the direction of the Survey Regulations 1986. This survey has been created in accordance with that Act and these Regulations. Dated at Hastings this 22nd day of February 2000

Signature ...
 Reference Plans
 Examined ...
 Approved as to Survey
 Deposited this ...

FOR REGISTRAR GENERAL OF LAND
 Received ...
 Sheet three of three sheets
 28215