



**RECORD OF TITLE
UNDER LAND TRANSFER ACT 2017
FREEHOLD
Limited as to Parcels**



**Guaranteed Search Copy issued under Section 60 of the Land
Transfer Act 2017**

R.W. Muir
Registrar-General
of Land

Identifier **OT311/101**

Land Registration District **Otago**

Date Issued 06 October 1943

Prior References

OT248/41 OT308/24

Estate Fee Simple
Area 1012 square metres more or less
Legal Description Lot 10 Block IX Deeds Plan 104

Registered Owners

Rochelle May-Anna Langley

Interests

12879408.2 Mortgage to Kiwibank Limited - 15.11.2023 at 2:49 pm

104

104

PLAN of

BLOCK IX, 2 parts of VII.

TOWNSHIP of

MILTON

Comprising parts of Sections 137, Block XVII, Thompson District
The Property of
James Smith Esq. 138
Oct. 1873.

237

X 10694 Approve Subdivision.

John

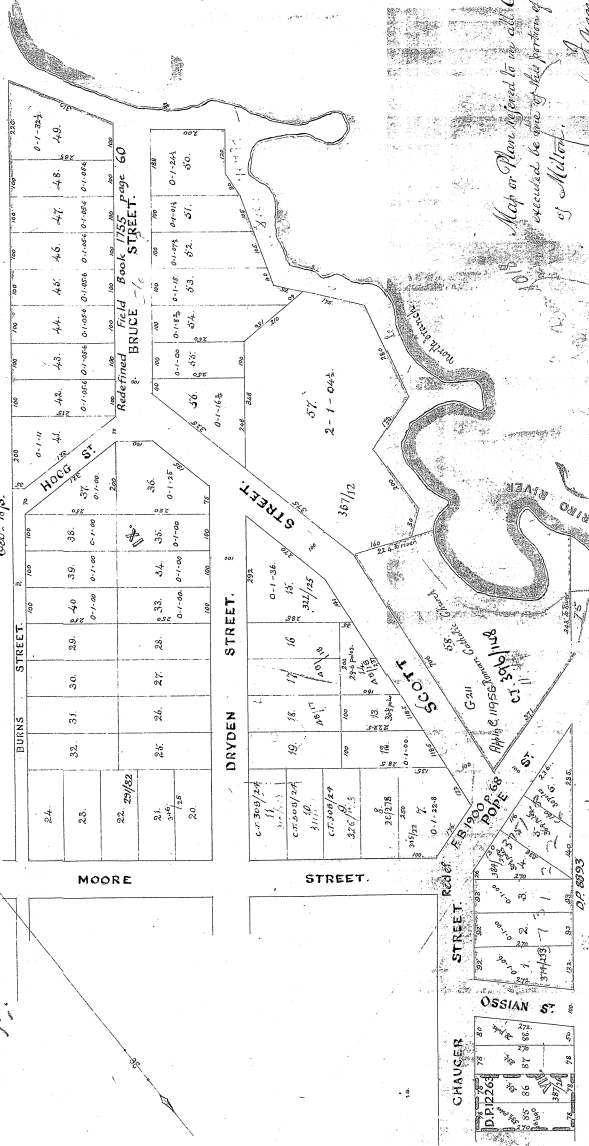

Map or Plan signed to me as Clerk of Court and to be executed by me by this return of the Township of Milton.

James Smith

Received for deposit in the office of the Register of Deeds at Washington on the 17th April 1874.

James Smith
24/1/73
Township Manager

Scale 2 chains to the inch.

Note. This Plan is a further subdivision of part of Section 137, Block XVII, and an extension of the same subdivision in March 1862. Of the former subdivision sections 88, Block VII and 1, Block IX, have been altered to enable Cassin Street to match Mill Subdivision; sections 7, 8, 9, 10, 11, 12, 13, 14, 15, 16, 17, 18, 19, 20, 21, 22, 23, 24, 25, 26, 27, 28, 29, 30, 31, 32, 33, 34, 35, 36, 37, 38, 39, 40, 41, 42, 43, 44, 45, 46, 47, 48, 49, 50, 51, 52, 53, 54, 55, 56, 57, 58, 59, 60, 61, 62, 63, 64, 65, 66, 67, 68, 69, 70, 71, 72, 73, 74, 75, 76, 77, 78, 79, 80, 81, 82, 83, 84, 85, 86, 87, 88, 89, 90, 91, 92, 93, 94, 95, 96, 97, 98, 99, 100, have been enlarged, 12 each, reduced. Section 14 of part of former 14 and 15. Section 16 is now subdivided into 16, 17, 18, 19, 20, 21, 22, 23, 24, 25, 26, 27, 28, 29, 30, 31, 32, 33, 34, 35, 36, 37, 38, 39, 40, 41, 42, 43, 44, 45, 46, 47, 48, 49, 50, 51, 52, 53, 54, 55, 56, 57, 58, 59, 60, 61, 62, 63, 64, 65, 66, 67, 68, 69, 70, 71, 72, 73, 74, 75, 76, 77, 78, 79, 80, 81, 82, 83, 84, 85, 86, 87, 88, 89, 90, 91, 92, 93, 94, 95, 96, 97, 98, 99, 100. All streets shown on this Plan are Public. See 4253

104