



**RECORD OF TITLE
UNDER LAND TRANSFER ACT 2017
FREEHOLD**

**Guaranteed Search Copy issued under Section 60 of the Land
Transfer Act 2017**



R. W. Muir
Registrar-General
of Land

Identifier NL3B/816
Land Registration District Nelson
Date Issued 15 September 1970

Prior References
NL2A/530

Estate Fee Simple
Area 817 square metres more or less
Legal Description Lot 4 Deposited Plan 6413

Registered Owners
Jocelyn Frances Winn

Interests
78247 Building Line Restriction

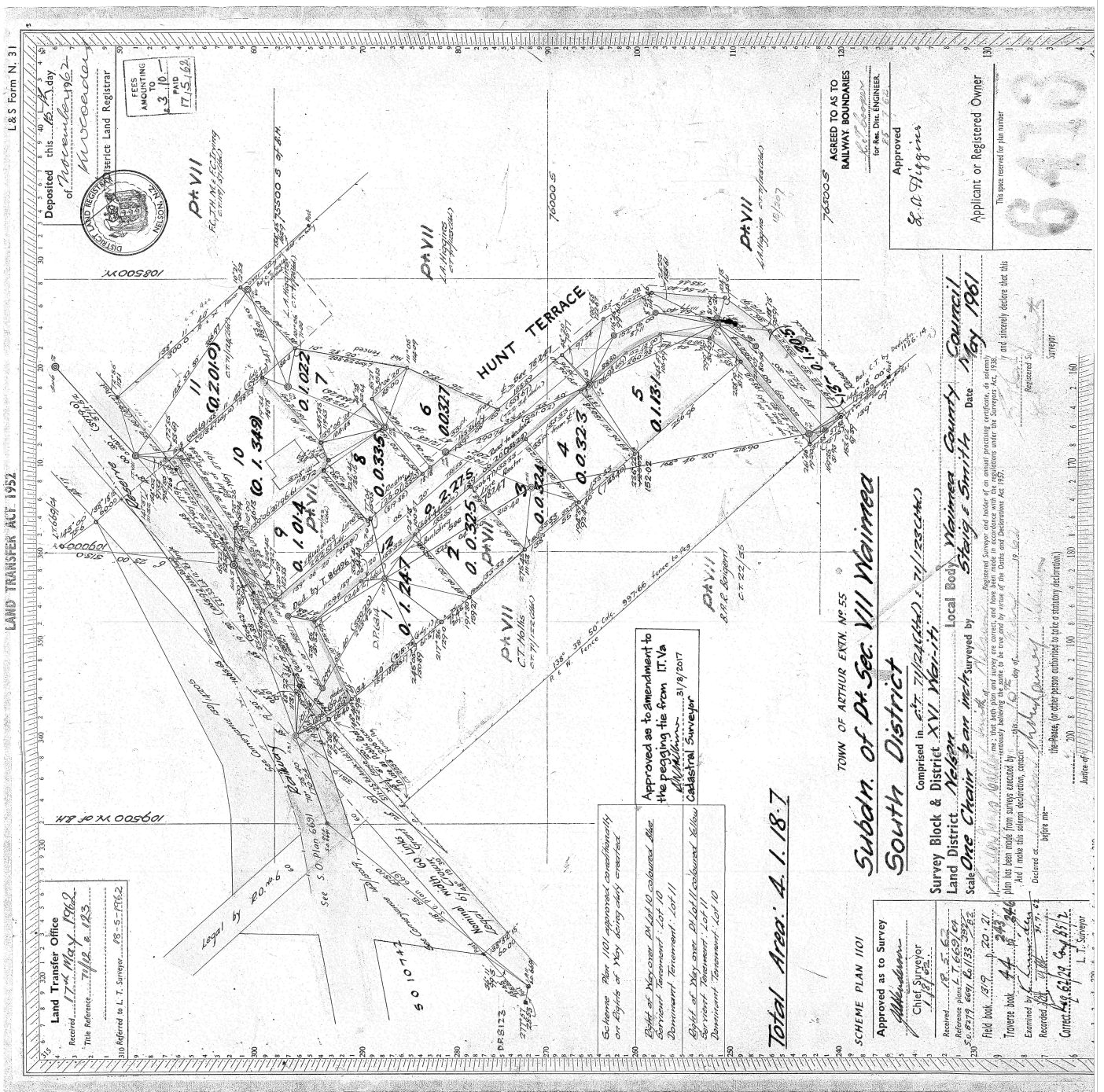

L & S Form N. 31

LAND TRANSFER ACT, 1952.

109500 Yr. of R.H.

Land Transfer Office
 Received 17th May 1962
 Title Reference 71/2-6-123
 310 Referred to L. T. Surveynor 15-5-1962

FEES AMOUNTING TO
 PAID
 3.10
 17/5/62



Pt VII
 F.C. 11/11/1962
 Survey Subdiv.

Pt VII
 A.M. Higgins
 19/10/67

Pt VII
 A.M. Higgins
 19/10/67

AGREED TO AS TO
 RAILWAY BOUNDARIES
 for Res. Dist. ENGINEER
 Approved
 S. A. Higgins

Applicant or Registered Owner
 This space reserved for plan number
 6413

Approved as to amendment to the pegging tie from IT.Va
 M. J. McMillan
 3/18/2017
 Cadastral Surveyor

Scheme Plan 1101 approved conditionally on Ejecta of 1961 being duly executed
 1961
 1961
 1961
 1961
 1961
 1961

Total Area: 4.1.18.7

TOWN OF ARTHUR EXTRA. NO. 55

Subdiv. of Pt. Sec. VIII Naimia
 South District

Survey Block & District XVI Meriti
 Land District Nelson
 Scale One Chain to an inch surveyed by
 Local Body Naimia County Council
 Date 17th May 1961
 Surveyor Steig Smith

Comprising in all 11 lots of the said surveying plan, the area of 4.1.18.7
 and I hereby declare that this plan has been made from surveys executed by me and by virtue of the Ordinance and Regulations Act 1957.
 I, the person named above, being duly sworn, depose and affirm that the above is a true and correct copy of the original plan and survey and have been made in accordance with the regulations under the Survey Act, 1957.
 Declared at Nelson on this 17th day of May 1962
 L. T. Surveynor
 Chief Surveyor

Approved as to Survey
 Chief Surveyor
 Received 17th May 1962
 Reference plan L.T. 6652/64
 S.O. 8279 6691 6.11.33 1962
 Field book 17-20-71
 Traversed book 17-20-71
 Examined by L. T. Surveynor 17-7-62
 Corrected by L. T. Surveynor 17-7-62