

# GRIFFIOEN.

## EQC CLAIM DOCUMENTATION

Statement of Passing Over: This documentation has been supplied to us by the Earthquake Commission under the Official Information Act. GRIFFIOEN. (Powered by Ownly Limited, Licensed REAA 2008) is merely passing over this information as supplied to us.

We cannot guarantee its accuracy as we have not checked, audited, or reviewed the information and all intending purchasers are advised to seek your own advice as to the information contained in this document.

To the maximum extent permitted by law we do not accept any responsibility to any party for the accuracy or use of the information herein.

# CASH SETTLED CLAIM(S)

The following information contains documents relating to claim(s) that were cash settled for the property.

If you require sign off or repair completion documents, they may be obtainable from the contractors who completed the substantive repairs at the property.



## Statement of Claim Checklist†

CLM/2010/049833

Date: 11/1/10Author: Chris HogganC I COLVILL  
18 Heathglen Ave  
Parklands  
ChristchurchLA: Chris HogganEstimator: Andrew Musackis

Room	Damage	Walls	Ceiling	Floor	Description of Damage
	Y/N	✓	✓	✓	
Lounge	Y	✓			cracking door frames
Dining Room	Y	✓			door frames cracking
Kitchen	Y	✓			bench pulled from wall, cracking door frames, cracking window frames
Family Room	N/A	—	—	—	
Bedroom 1	Y	✓			cracking window frames + cornices
En Suite	N/A	—	—	—	
Bedroom 2	Y			✓	skirting board base pulled.
Bedroom 3 UPSTAIRS	NIL				nil reported/checked
Bedroom 4	N/A	—	—	—	
Bathroom includes 2 toilets	Y	✓	✓		cracking window frames + cornices
Toilet 1	Y/NIL				cracking window frames + cornices nil reported
Toilet 2	N/A	—	—	—	
Office/Study	N/A	—	—	—	
Rumpus UPSTAIRS	NIL				nil reported/checked - balcony OK.
Entry/Hall(s) DOWN	Y	✓	✓		cracking at door frames, + cornices pulling ceiling / wall joins
Stairwell	Y	✓			skirting board base pulling
Laundry IN KITCHEN	N/A	—	—	—	cracked frame window
Other		—	—	—	

Item		Event Damage	Description of Damage	Appoint Engineer
		Y/N		Y/N
Roof		N	appears solid - front half inspected from upper level	
External Walls	North	Y	Crack in foundation wall	
	South	Y	Crack in foundation wall	
	East	Y	Crack in foundation wall	
	West	Y	Crack in foundation wall and step cracks	
Decks		N	Timber at rear	
Chimney	Base			
	Ceiling Cavity		has old disconnected chimney system - redundant.	
	Above Roof			
	Fireplace			
Foundations			north, east, west, south faces cracked below wall.	
Piling		N	concrete.	
Services		N	all resumed	
Other Dwelling Items			nil	
Outbuildings Garage			cracked mortar backwall.	
Land & Retaining Walls <small>(Discuss with Supervisor)</small>			Ground adjacent no liquefaction / land displacement driveway cracking & exposed since event.	

I confirm the rooms and areas listed above have been inspected by an EQC representative.

Damage caused by the event has been noted and to my knowledge there are no other areas of damage resulting from the event.

Signature of Claimant: 

Dated: 1st 11 2010

























Date: 01-11-10

Claim No: 2010/ 049833

Estimator's Name: A. Maroulis

**Dwelling Inspection Checklist: Show measurements, indicate damage**

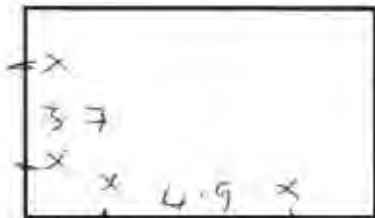

Lounge

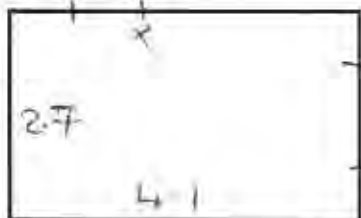

Dining Room

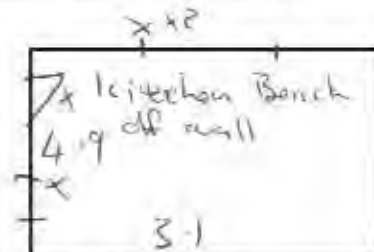

Kitchen



Family Room

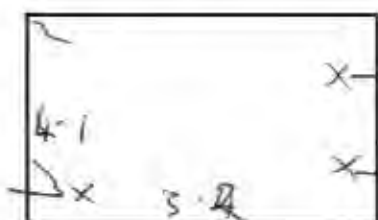

Bed 1



Ensuite

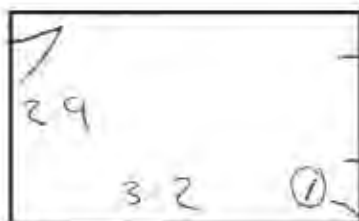

Bed 2

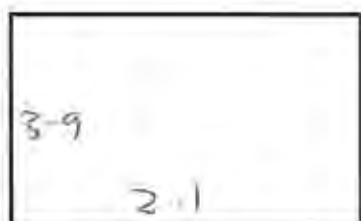

Bed 3



Bed 4

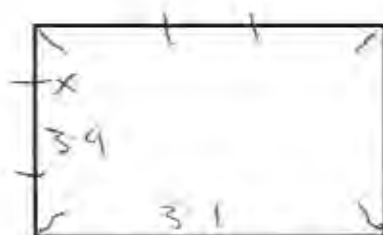

Main Bathroom

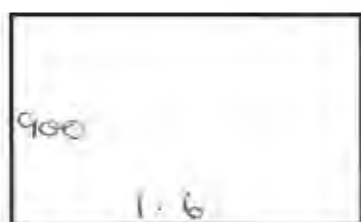

Toilet 1



Toilet 2



Office/Study

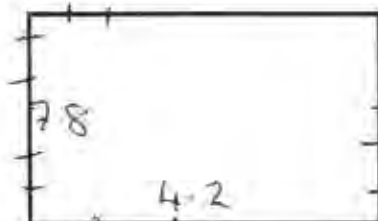

Rumpus



Entry/Halls

Date: 01-11-10

Claim No: 2010/ 049833

Estimator's Name: A. Meroulis

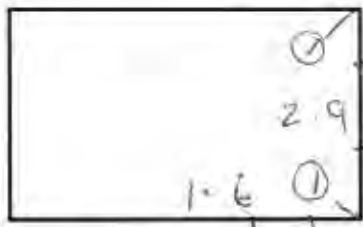

Stairwell



Laundry



Outbuildings/Garage



**Legend**

x	Window Frame cracked
∨	cornice cracked internal corner
①	skirting
—	Cornice all wall

Date: 01-11-10

Claim Number: 2010/ 0498933

Estimator's Name: A. Maroulis

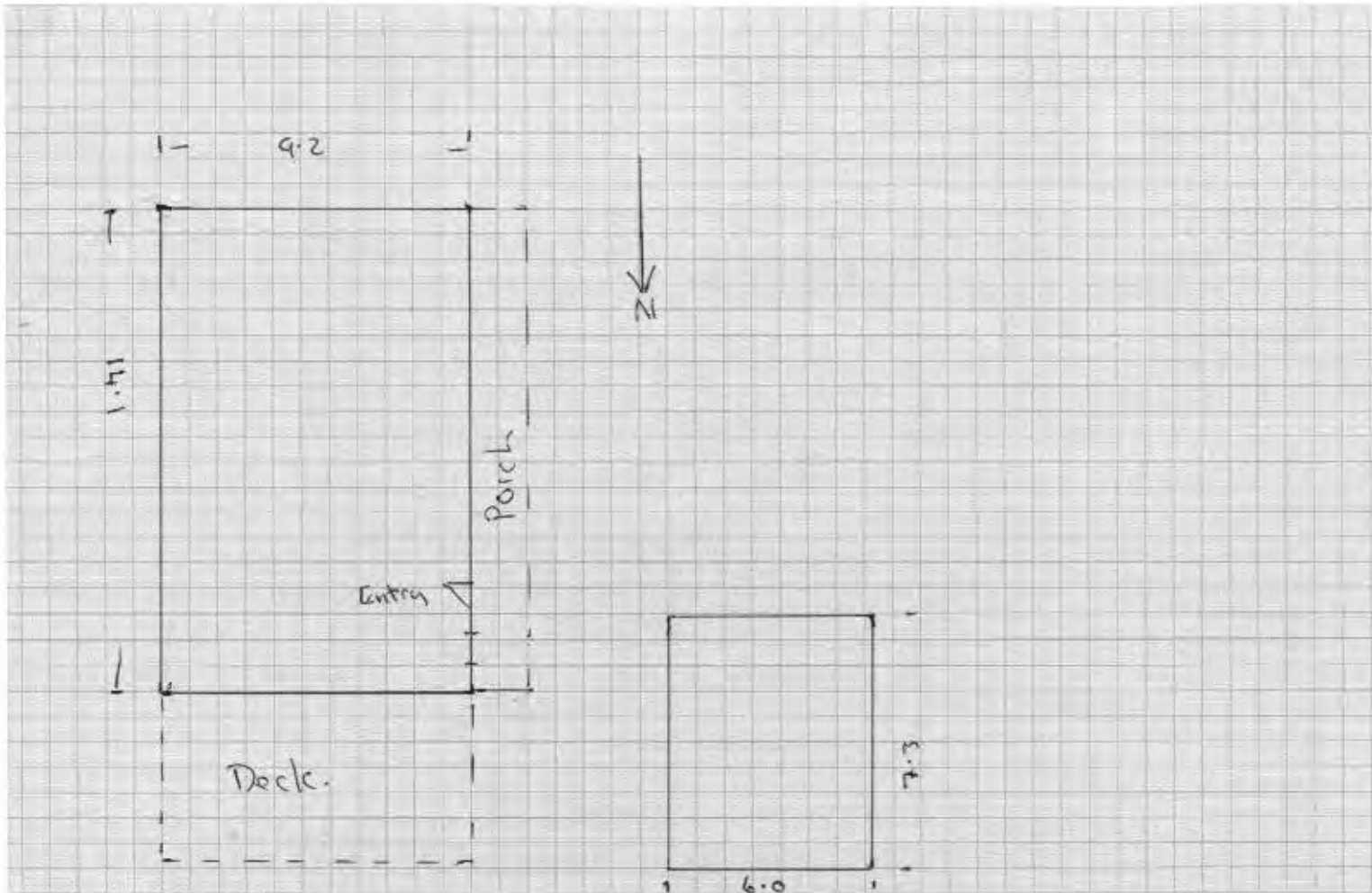

Area m <sup>2</sup> : <u>177</u>				
Stud Heights: <u>2.4</u>				
Wall Finish:	Wallpaper	Plastered	<input checked="" type="checkbox"/> Paint finish	
Other				
Services:	Specify damage:			
Chimneys:	Construction type: <u>Flue</u>			
<u>Nil Damage</u>	Height: <u>5m</u>			
	Damage description:	Above Roof	Below Roof	Total Repair
Foundations Damage:	Timber	<input checked="" type="checkbox"/> Concrete Ring		Concrete Slab
	<input checked="" type="checkbox"/> Minor	Moderate	Severe	Other (specify):
	House moved off foundations?: <u>N</u>			
Concrete slab cracked?		Crack width .....	Crack length .....	
Roof:	<input checked="" type="checkbox"/> Framed	<input type="checkbox"/> Trussed		
	Type:	Clay Tiles	Concrete tiles	Metal tiles
Damage: <u>Nil</u>		Other (specify): <u>Decorative Tiles</u>		
Cladding Type:	<input checked="" type="checkbox"/> Weatherboard	<input checked="" type="checkbox"/> Brick Veneer	<input checked="" type="checkbox"/> Hardi Plank	Other

Additional Information

---



---



---

3073

Plan 010/049 833

# Sketch Plan of Property

Affix Label Here

Completed By: A. Meroulis  
 Supvr ID  
 LA ID

---

Date: 01-11-10

---

LA File Ref:

PLAN SKETCH OF PROPERTY (identify each room, indicate damage). Attach photo if available

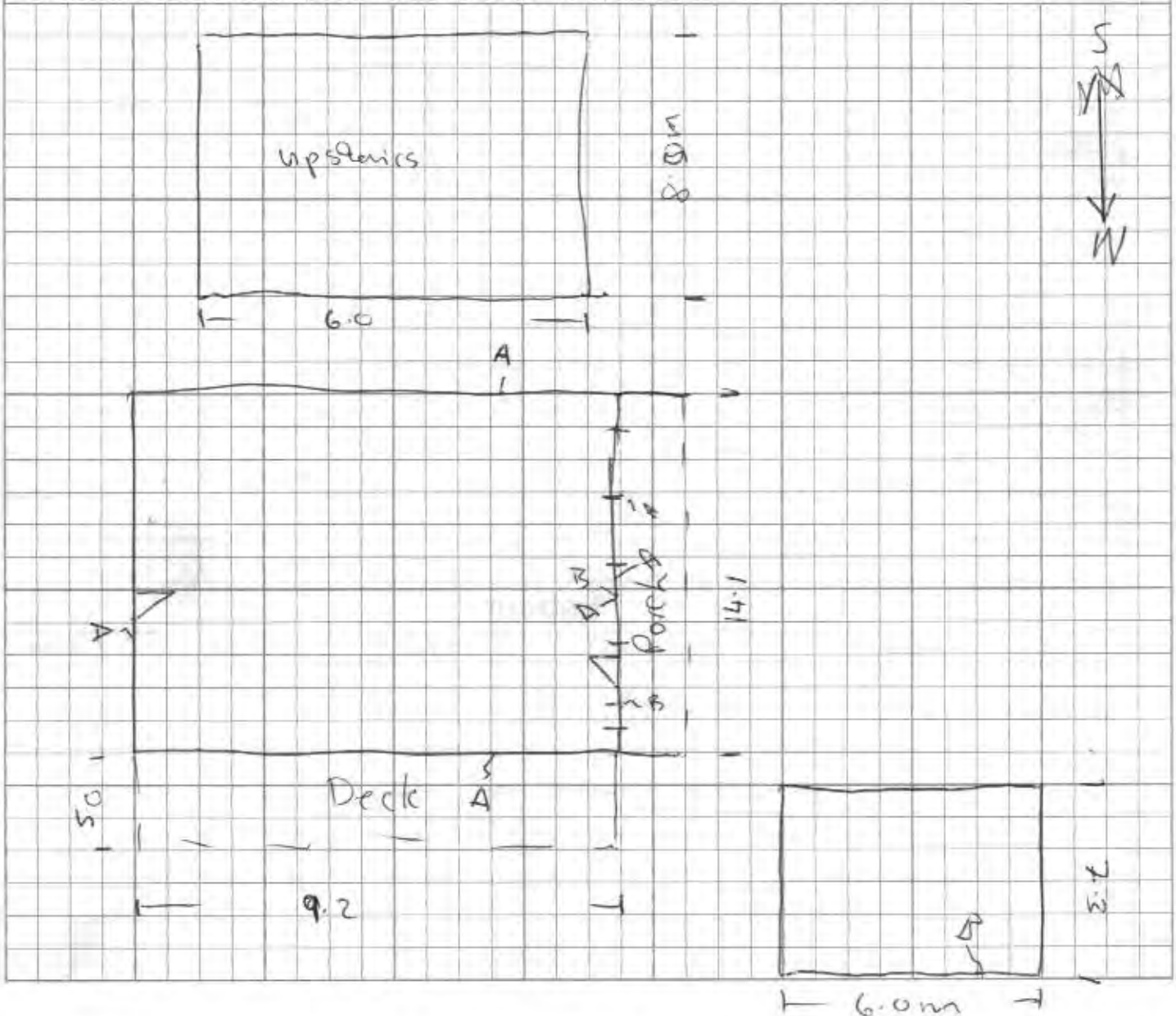

**Additional Information**

A/ Crack foundation  
 B/ Step crack

Surrounds Blockwork

129-2

**TERRY GRIFFITHS PLUMBING**

974 LOWER STYX ROAD

BROOKLANDS

CHRISTCHURCH 8083

Phone : 03 3298830 Fax : 03 3298887

**COPY TAX INVOICE**

Chris Colvill  
18 Heathglen Ave  
Parklands  
CH CH 8083



Date : 01/09/2011  
Order No :  
Account : 50  
Invoice # : 1034  
GST No : 67-054-733

Description	Quantity	Rate	Total
To replace damaged & leaking pipework to HW cylinder due to earthquake.EQC clm no 2011/198599.			
MATERIALS	1.00	88.57	88.57
LABOUR	2.50	65.00	162.50
vehicle	1.00	15.00	15.00

Please pay by the 20th of the month to our  
westpac acc 031585 0037240 00  
Thankyou

GST Exclusive	266.07
Add GST	39.91
GST Inclusive	305.98



## Statement of Claim

**Claim Number:** CLM/2016/010270  
**Damage Address:** 18 Heathglen Avenue, Parklands, Christchurch 8083  
**Claimant:** Christopher Colvill

## Internal Damage Items

Item	Event Damage?	Description
Lounge	No	
Dining Room	No	
Kitchen	Yes	4.0 x 3.2. Realign door 1.
Family Room	No	
Bedroom 1	No	
En Suite	No	
Bedroom 2	Yes	3.0 x 3.0. Edge & Repaint Door 1.
Bedroom 3	Yes	2.8 x 4.3. Crack to wall 3.0. Paint ceiling 2.8 x 4.3. Paint wall 2.9 x 4.3.
Bedroom 4	Yes	3.8 x 3.8. Crack to wall 3.0. Paint wall 2.9 x 3.8. Paint ceiling 3.8 x 3.8. FP 14.44
Bathroom	No	
Toilet 1	No	
Toilet 2	No	
Office/Study	No	
Rumpus	No	
Entry/Hall(s)	Yes	1.6 x 1.6. Cracks to the grout.
Stairwell	Yes	3.6 x 1.6. Crack to wall 2.0. Paint Wall 4.6 x 3.6. Paint ceiling 3.6 x 1.6. Scaffold.
Laundry	No	
Other #1	No	
Other #2	Yes	7.0 x 6.0. Garage, East Wall. Step cracking to blockwork 3.0. Paint wall 6.0 x 2.0. Crack to floor not event related.
Other #3	No	

## External Damage Items

Item	Event Damage?	Description
Roof	No	
External Walls - North	Yes	Cracks to Wall 1.0. Paint Wall 2.5 x 10.7. Crack to Ring Foundation. Grind out & Epoxy 0.4. Crack to weather board 4.0 x 0.3. Point Weather board 4.0 x 0.3.
External Walls - South	Yes	Crack to Ring Foundation 0.4. Crack to Weather Board 6.0 x 3.0. Paint Wall 7.4 x 2.5. Crack to Wall 1.0.
External Walls - East	Yes	Cracked to Sill 1.0. Paint Wall 2.7 x 0.5.
External Walls - West	Yes	9.5 x 4.0. Cracked to Bricks 1.0. Paint Wall 4.0 x 9.5.
Decks	No	
Chimney - Base	No	
Chimney - Ceiling Cavity	No	
Chimney - Above Roof	No	
Chimney - Fireplace	No	
Foundations	No	
Piling	No	
Services	No	
Other Dwelling Items	No	
Outbuildings	No	
Land & Retaining Walls	No	



## Scope of Works



<b>Completed By:</b>	<b>L Hampton</b>	<b>Claim Number:</b>	<b>2016 / 010270</b>
<b>Date:</b>	<b>7/09/2016</b>	<b>Customer Name:</b>	<b>Christopher Colvill</b>
<b>Page</b>	<b>2 OF 4</b>	<b>Address:</b>	<b>18 Heathglen Avenue Parklands Christchurch</b>

**Description** This SOW is for only the elements being cash settled

## Line Items:

Element :		Units	Length	Breadth	Depth	Qty	Rate	Cost
<b>External Element</b>	<b>West Wall</b>							
Wall Cladding	Grind out and repoint mortar joints	m				1.00	\$49.50	\$49.50
Wall Cladding	Paint Textured wall	m2	4.00	9.50		38.00	\$27.25	\$1,035.50
<b>External Element</b>	<b>North Wall</b>							
Wall Cladding	Grind out and repoint mortar joints	m				1.00	\$49.50	\$49.50
Wall Cladding	Paint Textured wall	m2	2.50	10.70		26.75	\$27.25	\$728.94
Ring Foundation	Grind out and epoxy cracks 0-5mm wide	m				0.40	\$120.00	\$48.00
Wall Cladding	Remove dispose supply and install Linea	m2	4.00	0.30		1.20	\$177.50	\$213.00
Wall Cladding	Paint Textured wall	m2	4.00	0.30		1.20	\$27.25	\$32.70
<b>External Element</b>	<b>East Wall</b>							
Wall Cladding	Grind out and repoint mortar joints	m				1.00	\$49.50	\$49.50
Wall Cladding	Paint Textured wall	m2	2.70	0.50		1.35	\$27.25	\$36.79
<b>External Element</b>	<b>South Wall</b>							
Wall Cladding	Grind out and repoint mortar joints	m				1.00	\$49.50	\$49.50
Wall Cladding	Paint Textured wall	m2	7.40	2.50		18.50	\$27.25	\$504.13
Ring Foundation	Grind out and epoxy cracks 0-5mm wide	m				0.40	\$120.00	\$48.00
Wall Cladding	Remove dispose supply and install Linea	m2	6.00	0.30		1.80	\$177.50	\$319.50
Wall Cladding	Paint Textured wall	m2	6.00	0.30		1.80	\$27.25	\$49.05
<b>Interior Room</b>	<b>Entry</b>							
Floor	Grind out and regrout tiles	m				3.20	\$33.00	\$105.60
<b>Interior Room</b>	<b>Kitchen</b>							
Door External	Re-align Door	No				1.00	\$98.75	\$98.75
<b>Interior Room</b>	<b>Bedroom 2</b>							
Door Internal	Ease and paint door	No				1.00	\$202.50	\$202.50

\* Unit categories to be used as follows: Each, Sheet, Kilogram, Linear metre, Square metre, Cubic metre, Per hour, Per day, Per week. Cubic metre calculations must include length, breadth and depth figures. Square metre calculations must include length and breadth figures.

**Sub Total** \$3,620.45

**Preliminaries & General** \$289.64

**Margin** \$391.01

**SUB TOTAL (Excluding GST)** \$4,301.09





# Scope of Works



<b>Completed By:</b>	L Hampton	<b>Claim Number:</b>	2016 / 010270
<b>Date:</b>	7/09/2016	<b>Customer Name:</b>	Christopher Colvill
<b>Page</b>	4 OF 4	<b>Address:</b>	18 Heathglen Avenue
			Parklands
			Christchurch

## TOTALS PAGE :

### P & G's Page:

**P & G's - Page 1** \$2,813.45

**P & G's Page - Sub Total** \$2,813.45

### Building Damage Page:

**Scope Of Works Page 2** \$4,301.09

**Scope Of Works Page 3** \$3,087.52

**Scope Of Works Pages - Sub Total** \$7,388.61

\* Unit categories to be used as follows: Each, Sheet, Kilogram, Linear metre, Square metre, Cubic metre, Per hour, Per day, Per week. Cubic metre calculations must include length, breadth and depth figures. Square metre calculations must include length and breadth figures.

**Sub Total** \$10,202.06

**GST** \$1,530.31

**TOTAL** \$11,732.37



# EARTHQUAKE RECOVERY (EQR) DOCUMENTATION

The documents within the Earthquake Recovery Documentation section, encompass all works completed under the Canterbury Home Repair Programme (CHRP). These contain assessments, contractor quotes, work orders and sign offs.

Released Under the Official Information Act 1982  
**EQR Property Overview Report**

Company Fletcher EQR (division of FCC) as agent for EQC

Printed Date: 26-04-2018

EQC Property ID	Property Address	Vulnerable?	Property F Status	Property Finalisation Indicator		
2010049833	18 HEATHGLEN AVENUE, PARKLANDS		F3 - Complete & Finalised	Some Finalisation has taken place		
Main Contractor:	CLOSED OUT-Ben Rees Builders ***** (SC62)		Property F2'd By:	System Generated Finalisation	F2 Completed Date:	22-12-2014
Cont Managing Hub:	Pages	Not Vulnerable	Property F3'd By:	System Generated Finalisation	F3 Completed Date:	22-12-2014

Adjustments											
				Original Budget			Budget Variation			Gross Claimed	Gross Certified
EQC Claim Number + Address	Project	Status	Unmapped Adjmt Lines	Total OB	Allocated	Unallocated	Total BV	Allocated	Unallocated		
CLM/2011/198599 18 HEATHGLEN AVENUE	E013	F3	0	10,377.93	10,377.93	0.00	13,568.07	13,568.07	0.00	23,946.00	23,946.00
<b>Property Total</b>			<b>0</b>	<b>10,377.93</b>	<b>10,377.93</b>	<b>0.00</b>	<b>13,568.07</b>	<b>13,568.07</b>	<b>0.00</b>	<b>23,946.00</b>	<b>23,946.00</b>

Assignments											
EQC Claim Number + Address	CC + Hub Status	Assignment	Subcontractor Hub Comments	Workflow Status	Contractor Quote	Adjustment Line Count	Gross Claimed	Gross Certified			
CLM/2011/198599 18 HEATHGLEN AVENUE		Emergency Works - Primary	CLOSED OUT-Meyer Cooke Builders Limited ***** (S820)	COMPLETIONS	0.00	1	125.50	125.50	Allocated To Hub -> Awaiting Claim File Review		
			Ewecured back door. INV 804174 12/10/11 19/10/11	DP entered							
CLM/2011/198599 18 HEATHGLEN AVENUE		Emergency Works - Primary	CLOSED OUT-Meyer Cooke Builders Limited ***** (S820)	COMPLETIONS	0.00	0	0.00	0.00	Allocated To Hub -> Awaiting Claim File Review		
			inv:898001repolaced damaged striker plate and eased door. 10/1/2012 MS								
CLM/2011/198599 18 HEATHGLEN AVENUE		Substantive Works - Primary	CLOSED OUT-Ben Rees Builders ***** (SC62)	COMPLETIONS	22,639.16	10	23,700.50	23,700.50	Transmitted To Hub -> Claim File Review Complete		
CLM/2011/198599 18 HEATHGLEN AVENUE		Substantive Works - Specialist Contractor	CLOSED OUT-Oceanside Electrical Limited ***** (SG19)	COMPLETIONS	120.00	1	120.00	120.00	Transmitted To Hub -> Awaiting Claim File Review		
			ELECTRICAL TEST								
<b>Property Total</b>					<b>22,759.16</b>	<b>12</b>	<b>23,946.00</b>	<b>23,946.00</b>			

Works Orders											
EQC Claim Number	WO Number	Assignment	Subcontractor	Workflow Status	Issuing QS	WO Status	Issued Date	Works Order Value			
CLM/2011/198599	E013-01268	Substantive Works - Specialist Contractor - 31-Jul-2013	CLOSED OUT-Oceanside Electrical Limited ***** (SG19)	COMPLETIONS	Owen Shiel	Issued	08/08/2013	120.00			
CLM/2011/198599	E013-01388	Substantive Works - Primary - 14-Dec-2012	CLOSED OUT-Ben Rees Builders ***** (SC62)	COMPLETIONS	Owen Shiel	Issued	21/08/2013	22,639.16			
<b>Property Total</b>								<b>22,759.16</b>			

Released Under the Official Information Act 1982  
**EQR Property Overview Report**

Company Fletcher EQR (division of FCC) as agent for EQC

Printed Date: 26-04-2018

EQC Property ID	Property Address	Vulnerable?	Property F Status	Property Finalisation Indicator		
<b>2010049833</b>	<b>18 HEATHGLEN AVENUE, PARKLANDS</b>		<b>F3 - Complete &amp; Finalised</b>	<b>Some Finalisation has taken place</b>		
Main Contractor:	CLOSED OUT-Ben Rees Builders ***** (SC62)		Property F2'd By:	System Generated Finalisation	F2 Completed Date:	22-12-2014
Cont Managing Hub:	Pages	Not Vulnerable	Property F3'd By:	System Generated Finalisation	F3 Completed Date:	22-12-2014

**Claims / Certs / Payables**

<b>S820 CLOSED OUT-Meyer Cooke Builders Limited *****</b>									
EQC Claim Num	Line Type	Approval Type	Claim No	Claimed By	Remaining	Claim Date	This Claim		
CLM/2011/198599	E3Emg BV	Emergency Under 2k (Delegated)	21	EQR\EddieC	\$0.00	20-Oct-2011	\$125.50		
EQC Claim Num	Line Type	Approval Type	Cert No	Certified By	Remaining	Certified Date	This Cert	Cert Line Notes	
CLM/2011/198599	E3Emg BV	Emergency Under 2k (Delegated)	21	EQR\EddieC	\$0.00	20-Oct-2011	\$125.50		
<b>S820</b>	<b>CLOSED OUT-Meyer Cooke Builders Limited ***** Total</b>					<b>Claims</b>	<b>\$125.50 Certs</b>	<b>\$125.50 Payables</b>	<b>\$0.00</b>

<b>SG19 CLOSED OUT-Oceanside Electrical Limited *****</b>									
EQC Claim Num	Line Type	Approval Type	Claim No	Claimed By	Remaining	Claim Date	This Claim		
CLM/2011/198599	Electrical Test BV	Scope Addition	3	EQR\JamesL	\$0.00	29-Aug-2013	\$120.00		
EQC Claim Num	Line Type	Approval Type	Cert No	Certified By	Remaining	Certified Date	This Cert	Cert Line Notes	
CLM/2011/198599	Electrical Test BV	Scope Addition	3	EQR\JamesL	\$0.00	29-Aug-2013	\$120.00	Inv 0575	
<b>SG19</b>	<b>CLOSED OUT-Oceanside Electrical Limited ***** Total</b>					<b>Claims</b>	<b>\$120.00 Certs</b>	<b>\$120.00 Payables</b>	<b>\$0.00</b>

<b>SC62 CLOSED OUT-Ben Rees Builders *****</b>									
EQC Claim Num	Line Type	Approval Type	Claim No	Claimed By	Remaining	Claim Date	This Claim		
CLM/2011/198599	Subst OB	Substantive Works	46	EQR\JamesL	\$0.00	14-Nov-2013	\$10,377.93		
CLM/2011/198599	Subst BV	Scope Addition	46	EQR\JamesL	\$0.00	14-Nov-2013	\$12,261.23		
CLM/2011/198599	Subst BV	Variation	46	EQR\JamesL	\$0.00	14-Nov-2013	\$1,061.34		
EQC Claim Num	Line Type	Approval Type	Cert No	Certified By	Remaining	Certified Date	This Cert	Cert Line Notes	
CLM/2011/198599	Subst OB	Substantive Works	43	EQR\JamesL	\$0.00	14-Nov-2013	\$10,377.93	Inv 0020	
CLM/2011/198599	Subst BV	Scope Addition	43	EQR\JamesL	\$0.00	14-Nov-2013	\$12,261.23	Inv 0020	
CLM/2011/198599	Subst BV	Variation	43	EQR\JamesL	\$0.00	14-Nov-2013	\$1,061.34	Inv 0020	
<b>SC62</b>	<b>CLOSED OUT-Ben Rees Builders ***** Total</b>					<b>Claims</b>	<b>\$23,700.50 Certs</b>	<b>\$23,700.50 Payables</b>	<b>\$0.00</b>

<b>Property Total</b>						<b>Claims</b>	<b>\$23,946.00 Certs</b>	<b>\$23,946.00 Payables</b>	<b>\$0.00</b>
-----------------------	--	--	--	--	--	---------------	--------------------------	-----------------------------	---------------

Released Under the Official Information Act 1982  
**EQR Property Overview Report**

Company Fletcher EQR (division of FCC) as agent for EQC

Printed Date: 26-04-2018

EQC Property ID	Property Address	Vulnerable?	Property F Status	Property Finalisation Indicator		
<b>2010049833</b>	<b>18 HEATHGLEN AVENUE, PARKLANDS</b>		<b>F3 - Complete &amp; Finalised</b>	<b>Some Finalisation has taken place</b>		
Main Contractor:	CLOSED OUT-Ben Rees Builders ***** (SC62)		Property F2'd By:	System Generated Finalisation	F2 Completed Date:	22-12-2014
Cont Managing Hub:	Pages	Not Vulnerable	Property F3'd By:	System Generated Finalisation	F3 Completed Date:	22-12-2014

No Open Complaints / Remedial Issues on this Property

**Finalisation Documents**

EQC Claim Number	Document Type	Hub Zone	File Last Modified Date
CLM/2011/198599	Construction Completion Inspection		11/11/2013
CLM/2011/198599	Construction Completion Inspection	Pages	29/11/2013
CLM/2011/198599	Final Account Agreement	Pages	29/11/2013
CLM/2011/198599	Defects Liability Certificate	Pages	19/08/2014

**Property Total** **Finalisation Documents Present: 4**

No Technical Services Referrals on this Property

**Asbestos Test Information**

EQC Claim Number	Claim Address	Asbestos Test Required?	Asbestos Test Result
CLM/2011/198599	18 HEATHGLEN AVENUE	No	<NOT SPECIFIED>

**Property Total** **Number of Claims: 1**

**Contractors**

Contractor	Accreditation Status	Accreditation Number	Classification	Type of Work on the Property
S820 CLOSED OUT-Meyer Cooke Builders Limited *****	Rationalised	EQRC0781	Main Contractor	Emergency Works
SC62 CLOSED OUT-Ben Rees Builders *****	Accredited	EQRC1193	Main Contractor	Substantive Works
SG19 CLOSED OUT-Oceanside Electrical Limited *****	Accredited	SPLE0011	Specialist Subcontractor	Substantive Works

**Property Total** **Number of Contractors: 3**

# Scope of Works



**Customer:** CHRISTOPHER COLVILL

## Document explanatory note:

This document provides a summary of the earthquake damage identified by the EQC assessment team. Land, building and room by room damage is listed along with an indication of how this damage is to be repaired. A glossary of terms describing the type of damage that may be listed on your Scope of Works is provided at the end of this document.

## Assessment of Property at 18 HEATHGLEN AVENUE, PARKLANDS, CHRISTCHURCH 8083 on 1/07/2011

### Site

Element	Damage	Repair
Land (Exposed - Soil - 512.00 m2)		
Land (Under dwelling - Soil - 140.00 m2)		

### Services

Element	Damage	Repair
Sewerage (Town Connection - PVC Pipe - 10.00 l/m)	No Earthquake Damage	
Water Supply (Town Connection - Plastic - 10.00 l/m)	No Earthquake Damage	

## Main Building

### Exterior

#### Elevation (North ground floor)

Element	Damage	Repair
Wall Cladding (Brick Veneer - Oamaru Stone - 24.18 m2)	Cracking Cracking to paint Cracking to paint Cracking to paint	Grind out and repoint mortar 8.00 l/m   Paint wall 27.30 m2
Wall framing (Timber Frame - Timber - 24.18 m2)	No Earthquake Damage	

#### Elevation (North level. One )

Element	Damage	Repair
No Damage		

#### Elevation (East. Ground level)

Element	Damage	Repair
Wall Cladding (Brick Veneer - Oamaru Stone - 33.80 m2)	Cracking Cracking to paint	Grind out and epoxy fill 10.00 l/m Paint wall 33.80 m2
Wall framing (Timber Frame - Timber - 33.80 m2)	No Earthquake Damage	

#### Elevation (West ground level)

Element	Damage	Repair
Wall Cladding (Brick Veneer - Oamaru Stone - 33.80 m2)	Cracking Cracking to paint	Grind out and epoxy fill 9.00 l/m Paint wall 33.80 m2

Wall Cladding (Brick Veneer - Oamaru Stone - No Earthquake Damage  
33.80 m2)

Wall framing (Timber Frame - Timber - No Earthquake Damage  
33.80 m2)

**Elevation (East level. One. )**

Element	Damage	Repair
No Damage		

**Elevation (West. Level one)**

Element	Damage	Repair
No Damage		

**Elevation (West. Ground level)**

Element	Damage	Repair
Wall Cladding (Brick Veneer - Oamaru Stone - 33.80 m2)	Cracking	Grind out and epoxy fill 7.00 l/m
	Cracking to paint	Paint wall 33.80 m2
Wall framing (Timber Frame - Timber - 33.80 m2)	No Earthquake Damage	

**Elevation (South main wall)**

Element	Damage	Repair
Wall Cladding (Brick Veneer - Oamaru Stone - 46.50 m2)	Cracking	Grind out and epoxy fill 3.00 l/m
	Cracking to paint	Paint wall 46.50 m2
	Cracking to paint	
Wall framing (Timber Frame - Timber - 22.32 m2)	No Earthquake Damage	

**Roof (Decramastic pressed metal tiles in very good original condition)**

Element	Damage	Repair
No Damage		

**Foundations (Concrete ring)**

Element	Damage	Repair
No Damage		

**Elevation (South level. One)**

Element	Damage	Repair
No Damage		

**Foundations (Conical Concrete piles. Main dwelling)**

Element	Damage	Repair
No Damage		

**Interior**

**Ground Floor - Room (Other) (Timber deck. Main entrance. West side)**

Room Size: 2.20 x 2.40 = 5.28 (length(m) x width(m) = Area Size(m2))

Stud Height: 2.40 m

Element	Damage	Repair
No Damage		

**Ground Floor - Entry**

Room Size: 1.60 x 1.60 = 2.56 (length(m) x width(m) = Area Size(m2))

Stud Height: 2.40 m

Element	Damage	Repair	
Ceiling (Gib - Paint - 2.56 m2)	No Earthquake Damage		
Door (External) (SG Single - Timber - 1.00 item)	Cosmetic damage	Realign	1.00 No of
Door (Internal) (Single Hollow Core - Timber - 1.00 No of)	No Earthquake Damage		
Floor (Chipboard - Tiles - 2.56 m2)	Cosmetic damage	Grind out and re-grout tiles	2.00 l/m
Trim (Painted MDF - Trim 60mm - 6.00 l/m)	Damaged finish	Gap fill and paint trims	6.00 l/m
Wall covering (Gib - Paint - 15.36 m2)	No Earthquake Damage		

**Ground Floor - Stairwell**

Room Size: 1.60 x 2.10 = 3.36 (length(m) x width(m) = Area Size(m2))

Stud Height: 5.00 m

Element	Damage	Repair	
Ceiling (Gib - Paint - 3.36 m2)	No Earthquake Damage		
Door (Internal) (Single Hollow Core - Timber - 1.00 No of)	No Earthquake Damage		
Floor (Chipboard - Carpet - 3.36 m2)	No Earthquake Damage		
Handrails (Bar - Timber - 4.00 l/m)	No Earthquake Damage		
Stairs (Internal) (Box - MDF - 7.00 l/m)	No Earthquake Damage		
Wall covering (Gib - Paint - 37.00 m2)	Cosmetic damage	Rake out and stop	6.00 l/m
	Cosmetic damage	Paint wall	37.00 m2

**Ground Floor - Lounge**

Room Size: 0.70 x 4.80 = 3.36 (length(m) x width(m) = Area Size(m2))

Stud Height: 2.40 m

Element	Damage	Repair	
Ceiling (Gib - Paint - 3.36 m2)	No Earthquake Damage		
Door (External) (SG Sliding - Aluminium - 1.00 item)	No Earthquake Damage		
Door (Internal) (Single Hollow Core - Timber - 1.00 No of)	No Earthquake Damage		
Floor (Chipboard - Carpet - 3.36 m2)	No Earthquake Damage		
Wall covering (Gib - Paint - 26.40 m2)	No Earthquake Damage		
Window (Aluminium Awning - Pane single glazed - 1.00 No of)	No Earthquake Damage		

**Ground Floor - Kitchen**

Room Size: 3.30 x 4.00 = 13.20 (length(m) x width(m) = Area Size(m2))

Stud Height: 2.40 m

Element	Damage	Repair	
Ceiling (Gib - Paint - 13.20 m2)	No Earthquake Damage		
Door (External) (DG Single - Aluminium - 1.00 item)	No Earthquake Damage		
Floor (Chipboard - Tiles - 13.20 m2)	No Earthquake Damage		
Hob (Gas - Standard Spec - 1.00 item)	No Earthquake Damage		
Kitchen joinery (Medium Spec - MDF - 1.00 item)	No Earthquake Damage		
Range Hood (Over Head - Medium spec - 1.00 item)	No Earthquake Damage		
Wall covering (Gib - Paint - 35.04 m2)	No Earthquake Damage		
Window (Aluminium Awning - Pane single glazed - 1.00 No of)	No Earthquake Damage		

Work top (Kitchen work top - Laminate - 7.00 l/m) No Earthquake Damage

**Ground Floor - Dining Room**

Room Size: 2.80 x 3.90 = 10.92 (length(m) x width(m) = Area Size(m2))

Stud Height: 2.40 m

Element	Damage	Repair	
Ceiling (Gib - Paint - 10.92 m2)	No Earthquake Damage		
Floor (Chipboard - Vinyl - 10.92 m2)	No Earthquake Damage		
Trim (Painted MDF - Trim 60mm - 7.00 l/m)	Damaged finish	Gap fill and paint trims	7.00 l/m
Wall covering (Gib - Paint - 32.16 m2)	Cosmetic damage	Rake out and stop	3.00 l/m
	Cosmetic damage	Paint wall	32.16 m2

**Ground Floor - Bedroom (Masterbed)**

Room Size: 3.30 x 4.00 = 13.20 (length(m) x width(m) = Area Size(m2))

Stud Height: 2.40 m

Element	Damage	Repair	
No Damage			

**Ground Floor - Bedroom (Masterbed wardrobe)**

Room Size: 0.70 x 3.00 = 2.10 (length(m) x width(m) = Area Size(m2))

Stud Height: 2.40 m

Element	Damage	Repair	
No Damage			

**Ground Floor - Bedroom (Bed 2, between master bed and dining)**

Room Size: 2.90 x 2.80 = 8.12 (length(m) x width(m) = Area Size(m2))

Stud Height: 2.40 m

Element	Damage	Repair	
Ceiling (Gib - Paint - 8.12 m2)	No Earthquake Damage		
Door (Internal) (Single Hollow Core - Timber - 1.00 No of)	No Earthquake Damage		
Floor (Chipboard - Carpet - 8.12 m2)	No Earthquake Damage		
Trim (Painted MDF - Trim 60mm - 4.00 l/m)	Damaged finish	Gap fill and paint trims	4.00 l/m
Wall covering (Gib - Paint - 27.36 m2)	No Earthquake Damage		
Window (Aluminium Awning - Pane double glazed - 1.00 No of)			

**Ground Floor - Bathroom**

Room Size: 3.50 x 3.50 = 12.25 (length(m) x width(m) = Area Size(m2))

Stud Height: 2.40 m

Element	Damage	Repair	
No Damage			

**Ground Floor - Toilet**

Room Size: 0.90 x 1.70 = 1.53 (length(m) x width(m) = Area Size(m2))

Stud Height: 2.40 m

Element	Damage	Repair	
No Damage			

**Ground Floor - Hallway (Hallway, includes linen and store)**

Room Size: 2.00 x 4.00 = 8.00 (length(m) x width(m) = Area Size(m2))

Stud Height: 2.40 m

Element	Damage	Repair	
Ceiling (Gib - Paint - 8.00 m2)	No Earthquake Damage		
Floor (Chipboard - Carpet - 8.00 m2)	No Earthquake Damage		
Wall covering (Gib - Paint - 28.80 m2)	Cosmetic damage	Gap fill cracks	3.00 l/m
	Cosmetic damage	Paint wall	9.00 m2

**Ground Floor - Laundry**

Room Size: 1.00 x 1.80 = 1.80 (length(m) x width(m) = Area Size(m2))

Stud Height: 2.40 m

Element	Damage	Repair	
No Damage			

**First Floor - Bedroom (Bedroom, games room)**

Room Size: 4.00 x 7.80 = 31.20 (length(m) x width(m) = Area Size(m2))

Stud Height: 3.00 m

Element	Damage	Repair	
Ceiling (Gib - Stipple - 31.20 m2)	Cosmetic Damage	Rake out and stop	10.00 l/m
	Cosmetic Damage	Paint Ceiling	31.20 m2
Door (External) (SG Sliding - Aluminium - 1.00 item)	Cosmetic damage	Realign	1.00 No of
Floor (Chipboard - Carpet - 31.20 m2)	No Earthquake Damage		
Wall covering (Gib - Paint - 70.80 m2)	Cosmetic damage	Rake out and stop	5.00 l/m
	Cosmetic damage	Paint wall	70.80 m2
Window (Aluminium Awning - Pane single glazed - 3.00 No of)	No Earthquake Damage		

**First Floor - Room (Other) (Timber deck level one. North face )**

Room Size: 1.20 x 2.80 = 3.36 (length(m) x width(m) = Area Size(m2))

Stud Height: 2.40 m

Element	Damage	Repair	
No Damage			

**First Floor - Office/Study**

Room Size: 2.00 x 4.00 = 8.00 (length(m) x width(m) = Area Size(m2))

Stud Height: 3.00 m

Element	Damage	Repair	
No Damage			

**First Floor - Room (Other) (Top floor landing)**

Room Size: 1.00 x 1.80 = 1.80 (length(m) x width(m) = Area Size(m2))

Stud Height: 2.40 m

Element	Damage	Repair	
No Damage			

**External garage**

**Exterior****Elevation (External garage. North wall inside of blockwork. Some hairline crack )**

Element	Damage	Repair	
Wall Cladding (Brick Veneer - Oamaru Stone - 43.31 m2)	Structural damage	Relay and re-bed loose bricks	0.04 m2
Wall Cladding (Brick Veneer - Oamaru Stone - .04 m2)	Cracking to paint	Paint wall	0.04 m2
Wall framing (Block - Block - 43.31 m2)	Cosmetic damage	Grind out and re-mortar	8.00 l/m

**Elevation (Timber trim. Beneath. Ranchslider. West side )**

Element	Damage	Repair	
Trim (Painted Timber - Trim 90 mm - 2.00 l/m)	Removal required for other repair	Supply Replace Trim	2.00 l/m

**Interior****Ground Floor - Room (Other) (External garage. )**

Room Size: 6.10 x 7.20 = 43.92 (length(m) x width(m) = Area Size(m2))

Stud Height: 2.40 m

Element	Damage	Repair
No Damage		

**Scope of Works - Glossary of Terms**

<b>Cosmetic Damage</b>	Cosmetic damage is used to record repairs to an element that can be done in situ e.g. minor cracking to plasterboard. For example a repair strategy may state "rake, stop and paint" and this is carried out without needing to remove or replace the damaged element. Where the plasterboard for example needs to be removed and replaced, this will be recorded as 'structural damage'.
<b>Impact Damage</b>	Impact damage is where an element or part of a building sustains earthquake damage and then breaks away or collapses causing damage to another part of the building. An example is a chimney that has collapsed and caused damage to roof tiles.
<b>Structural Damage</b>	The term structural damage is used where a repair requires an element to be removed and replaced e.g. major cracking to plasterboard or external cladding that has been dislodged. This term does not relate to the structural integrity of the building as a whole, but to the individual element only.

**Additional Information**

<b>Building Terms</b>	The Department of Building and Housing website has a comprehensive list of common building terms: <a href="http://www.dbh.govt.nz/building-az-wxyz">http://www.dbh.govt.nz/building-az-wxyz</a>
-----------------------	---

## EQC Full Assessment Report

**Claim Number:** CLM/2011/198599  
**Claimant:** CHRISTOPHER COLVILL  
**Property Address:** 18 HEATHGLEN AVENUE  
 PARKLANDS  
 CHRISTCHURCH 8083

**Assessment Date:** 01/07/2011 16:08  
**Assessor:** fellows, chris  
**Estimator:** Goodall, Mike  
**Property Occupied By:** Owner Occupied

## Claimant Setup

Type	Name	Home Number	Mobile Number	Work Number	Email Address
Owner	CHRISTOPHER, COLVILL				

## Insurance &amp; Mortgage Details

## Insurance Details - From Claim Centre

Insurer	Policy Type	Policy Number	Insurance Sighted	Insurance Valid
AMI Insurance	Dwelling		Yes	

## Insurance Details - Added in COMET

Insurer	Policy Type	Policy Number	Insurance Sighted	Insurance Valid
AMI Insurance	Contents		Yes	

## Insurance Details - Comments

## Mortgage Details - From Claim Centre

## Bank

## Mortgage Details - Added in COMET

## Bank

KIWIBANK

## Mortgage Details - Comments

## Opt Out

For repairs costing between \$10,000 and \$100,000 the claimant wishes to manage their own repairs? No

## Hazards

**Hazards:** Nil hazards

**Property Sticker:** No Sticker

## Building Configurations

Leaky Home Syndrome? No

Building Name	Number of floors	Building Finish	Age of house	Footprint	Area (m2)
Main Building	2	Standard	1961 - 1980	Rectangular	134.62
External garage	1	Standard	1961 - 1980	Rectangular	44.59

## Full Assessment

### Site

Element	Type	Material	Damages	Measure	Rate	Cost
Land	Exposed	Soil	No Earthquake Damage			
Land	Under dwelling	Soil	No Earthquake Damage			

#### General Comments:

### Services

Element	Type	Material	Damages	Measure	Rate	Cost
Sewerage	Town Connection	PVC Pipe	No Earthquake Damage			
Water Supply	Town Connection	Plastic	No Earthquake Damage			

#### General Comments:

### Main Building

#### Exterior

#### Elevation (North ground floor)

**Damage:** Earthquake damage

**Require Scaffolding?** No

Element	Type	Material	Damages	Measure	Rate	Cost
Wall Cladding	Brick Veneer	Oamaru Stone	Cracking			
			Grind out and repoint mortar	8.00 l/m	35.00	280.00
			Cracking to paint			
			Cracking to paint			
Wall Cladding	Brick Veneer	Oamaru Stone	Cracking to paint			
			Paint wall	27.30 m2	29.00	791.70
Wall framing	Timber Frame	Timber	No Earthquake Damage			

**General Comments:** Brick veneer. Painted in very good condition  
Some stair step cracking  
9.3. Metres. Long. X. 2.6. Metres high

#### Elevation (North level. One )

**Damage:** No damage

**Require Scaffolding?** No

**General Comments:** 6.2. Metres wide. X 4 metres. High  
Hardies. Weatherboard in very good conditipn

#### Elevation (East. Ground level)

**Damage:** Earthquake damage

**Require Scaffolding?** No

Element	Type	Material	Damages	Measure	Rate	Cost
Wall Cladding	Brick Veneer	Oamaru Stone	Cracking			
			Grind out and epoxy fill	10.00 l/m	35.00	350.00
			Cracking to paint			
Wall Cladding	Brick Veneer	Oamaru Stone	Paint wall	33.80 m2	29.00	980.20
			Cracking to paint			
Wall framing	Timber Frame	Timber	No Earthquake Damage			

**General Comments:** 13. Metres. Long. X. 2.6. Metres high  
Painted. Brick veneer

#### Elevation (West ground level)

**Damage:** Earthquake damage

**Require Scaffolding?** No

Element	Type	Material	Damages	Measure	Rate	Cost
Wall Cladding	Brick Veneer	Oamaru Stone	Cracking			
			Grind out and epoxy fill	9.00 l/m	35.00	315.00
			Cracking to paint			

Wall Cladding	Brick Veneer	Oamaru Stone	Paint wall	33.80 m2	29.00	980.20
---------------	--------------	--------------	------------	----------	-------	--------

No Earthquake Damage

Wall framing	Timber Frame	Timber	No Earthquake Damage
--------------	--------------	--------	----------------------

**General Comments:** 13. Metres. Long. X. 2.6. Metres. High

#### Elevation (East level. One.)

**Damage:** No damage

**Require Scaffolding?** No

**General Comments:** James. Hardie. Weatherboards. Good condition  
8. Metres long. X. 1.8 metres high.

#### Elevation (West. Level one)

**Damage:** No damage

**Require Scaffolding?** No

**General Comments:** 8. Metres. Long. X. 1.8. Metres high in good condition

#### Elevation (West. Ground level)

**Damage:** Earthquake damage

**Require Scaffolding?** No

Element	Type	Material	Damages	Measure	Rate	Cost
Wall Cladding	Brick Veneer	Oamaru Stone	Cracking			
			Grind out and epoxy fill	7.00 l/m	35.00	245.00
			Cracking to paint			
			Paint wall	33.80 m2	29.00	980.20

Wall framing	Timber Frame	Timber	No Earthquake Damage
--------------	--------------	--------	----------------------

**General Comments:** 13. Metres long. X. 2.6. Metres high

#### Elevation (South main wall)

**Damage:** Earthquake damage

**Require Scaffolding?** Yes

Element	Type	Material	Damages	Measure	Rate	Cost
Wall Cladding	Brick Veneer	Oamaru Stone	Cracking			
			Grind out and epoxy fill	3.00 l/m	35.00	105.00
			Cracking to paint			
			Paint wall	46.50 m2	29.00	1,348.50
			Cracking to paint			

Wall framing	Timber Frame	Timber	No Earthquake Damage
--------------	--------------	--------	----------------------

**General Comments:** 9.3. Metres wide. X. 5. Metres high.  
Cracking around glass block window.

#### Roof (Decramastic pressed metal tiles in very good original condition)

**Damage:** No damage

**Require Scaffolding?** No

**General Comments:**

#### Foundations (Concrete ring)

**Damage:** No damage

**Require Scaffolding?** No

**General Comments:** in very good original condition  
A few minor historical cracks around vents  
Not structural

#### Elevation (South level. One)

**Damage:** No damage

**Require Scaffolding?** No

**General Comments:** 6.2. Metres long. X. 2.4. Metres. High  
James Hardie. Weatherboards in excellent condition

#### Foundations (Conical Concrete piles. Main dwelling)

**Damage:** No damage

**Require Scaffolding?** No

**General Comments:** in excellent condition  
Ground under dwelling is dry and solid

**Ground Floor - Room (Other) (Timber deck. Main entrance. West side)**

**Damage:** No damage

**Require Scaffolding?** No

**General Comments:** In very good condition

**Ground Floor - Entry**

**Damage:** Earthquake damage

**Require Scaffolding?** No

Element	Type	Material	Damages	Measure	Rate	Cost
Ceiling	Gib	Paint	No Earthquake Damage			
Door (External)	SG Single	Timber	Cosmetic damage			
			Realign	1.00 No of	90.00	90.00
Door (Internal)	Single Hollow Core	Timber	No Earthquake Damage			
Floor	Chipboard	Tiles	Cosmetic damage			
			Grind out and re-grout tiles	2.00 l/m	50.00	100.00
Trim	Painted MDF	Trim 60mm	Damaged finish			
			Gap fill and paint trims	6.00 l/m	12.00	72.00
Wall covering	Gib	Paint	No Earthquake Damage			

**General Comments:**

**Ground Floor - Stairwell**

**Damage:** Earthquake damage

**Require Scaffolding?** No

Element	Type	Material	Damages	Measure	Rate	Cost
Ceiling	Gib	Paint	No Earthquake Damage			
Door (Internal)	Single Hollow Core	Timber	No Earthquake Damage			
Floor	Chipboard	Carpet	No Earthquake Damage			
Handrails	Bar	Timber	No Earthquake Damage			
Stairs (Internal)	Box	MDF	No Earthquake Damage			
Wall covering	Gib	Paint	Cosmetic damage			
			Rake out and stop	6.00 l/m	10.00	60.00
			Cosmetic damage			
			Paint wall	37.00 m2	24.00	888.00

**General Comments:**

**Ground Floor - Lounge**

**Damage:** Earthquake damage

**Require Scaffolding?** No

Element	Type	Material	Damages	Measure	Rate	Cost
Ceiling	Gib	Paint	No Earthquake Damage			
Door (External)	SG Sliding	Aluminium	No Earthquake Damage			
Door (Internal)	Single Hollow Core	Timber				
Floor	Chipboard	Carpet	No Earthquake Damage			
Wall covering	Gib	Paint	No Earthquake Damage			
Window	Aluminium Awning	Pane single glazed	No Earthquake Damage			

**General Comments:**

**Ground Floor - Kitchen**

**Damage:** Earthquake damage

**Require Scaffolding?** No

Element	Type	Material	Damages	Measure	Rate	Cost
Ceiling	Gib	Paint	No Earthquake Damage			
Door (External)	DG Single	Aluminium				

Floor	Chipboard	Tiles	No Earthquake Damage
Hob	Gas	Standard Spec	No Earthquake Damage
Kitchen joinery	Medium Spec	MDF	No Earthquake Damage
Range Hood	Over Head	Medium spec	No Earthquake Damage
Wall covering	Gib	Paint	No Earthquake Damage
Window	Aluminium Awning	Pane single glazed	No Earthquake Damage
Work top	Kitchen work top	Laminate	No Earthquake Damage

**General Comments:** Architrave to window and door cracks

**Ground Floor - Dining Room**

**Damage:** Earthquake damage

**Require Scaffolding?** No

Element	Type	Material	Damages	Measure	Rate	Cost
Ceiling	Gib	Paint	No Earthquake Damage			
Floor	Chipboard	Vinyl	No Earthquake Damage			
Trim	Painted MDF	Trim 60mm	Damaged finish			
			Gap fill and paint trims	7.00 l/m	12.00	84.00
Wall covering	Gib	Paint	Cosmetic damage			
			Rake out and stop	3.00 l/m	10.00	30.00
			Cosmetic damage			
			Paint wall	32.16 m2	24.00	771.84

**General Comments:**

**Ground Floor - Bedroom (Masterbed)**

**Damage:** No damage

**Require Scaffolding?** No

**General Comments:**

**Ground Floor - Bedroom (Masterbed wardrobe)**

**Damage:** No damage

**Require Scaffolding?** No

**General Comments:**

**Ground Floor - Bedroom (Bed 2, between master bed and dining)**

**Damage:** Earthquake damage

**Require Scaffolding?** No

Element	Type	Material	Damages	Measure	Rate	Cost
Ceiling	Gib	Paint	No Earthquake Damage			
Door (Internal)	Single Hollow Core	Timber	No Earthquake Damage			
Floor	Chipboard	Carpet	No Earthquake Damage			
Trim	Painted MDF	Trim 60mm	Damaged finish			
			Gap fill and paint trims	4.00 l/m	12.00	48.00
Wall covering	Gib	Paint	No Earthquake Damage			
Window	Aluminium Awning	Pane double glazed				

**General Comments:** skirting board damage behind bed

**Ground Floor - Bathroom**

**Damage:** No damage

**Require Scaffolding?** No

**General Comments:**

**Ground Floor - Toilet**

**Damage:** No damage

**Require Scaffolding?** No

**General Comments:**

**Ground Floor - Hallway (Hallway, includes linen and store)**

**Damage:** Earthquake damage

**Require Scaffolding?** No

Element	Type	Material	Damages	Measure	Rate	Cost
Ceiling	Gib	Paint	No Earthquake Damage			
Floor	Chipboard	Carpet	No Earthquake Damage			
Wall covering	Gib	Paint	Cosmetic damage			
			Gap fill cracks	3.00 l/m	12.00	36.00
			Cosmetic damage			
			Paint wall	9.00 m2	24.00	216.00

**General Comments:** Cracking between scotia and wall at end next to master bedroom and bathroom

**Ground Floor - Laundry**

**Damage:** No damage

**Require Scaffolding?** No

**General Comments:**

**First Floor - Bedroom (Bedroom, games room)**

**Damage:** Earthquake damage

**Require Scaffolding?** No

Element	Type	Material	Damages	Measure	Rate	Cost
Ceiling	Gib	Stipple	Cosmetic Damage			
			Rake out and stop	10.00 l/m	10.00	100.00
			Cosmetic Damage			
			Paint Ceiling	31.20 m2	24.00	748.80
Door (External)	SG Sliding	Aluminium	Cosmetic damage			
			Realign	1.00 No of	90.00	90.00
Floor	Chipboard	Carpet	No Earthquake Damage			
Wall covering	Gib	Paint	Cosmetic damage			
			Rake out and stop	5.00 l/m	10.00	50.00
			Cosmetic damage			
			Paint wall	70.80 m2	24.00	1,699.20

Window Aluminium Awning Pane single glazed No Earthquake Damage

**General Comments:** Minor cracking to walls

Ceiling ok, cracks between ceiling and beams. Gap fill and possible ceiling touchup

**First Floor - Room (Other) (Timber deck level one. North face )**

**Damage:** No damage

**Require Scaffolding?** No

**General Comments:** Cantilevered deck in very good condition

**First Floor - Office/Study**

**Damage:** No damage

**Require Scaffolding?** No

**General Comments:**

**First Floor - Room (Other) (Top floor landing)**

**Damage:** No damage

**Require Scaffolding?** No

**General Comments:**

**External garage**

**Exterior**

**Elevation (External garage. North wall inside of blockwork. Some hairline crack )**

**Damage:** Earthquake damage

**Require Scaffolding?** No

Element	Type	Material	Damages	Measure	Rate	Cost
Wall Cladding	Brick Veneer	Oamaru Stone	Cracking to paint			
			Paint wall	0.04 m2	29.00	1.16
			Structural damage			
			Relay and re-bed loose bricks	0.04 m2	85.00	3.40

Wall framing	Block	Block	Cosmetic damage			
			Grind out and re-mortar	8.00 l/m	50.00	400.00

**General Comments:** Also. Right hand wing wall right hand side of tilt a door loose brick. Rebed brick and grind out and remortar inside north block wall

**Elevation (Timber trim. Beneath. Ranchslider. West side )**

**Damage:** Earthquake damage

**Require Scaffolding?** No

Element	Type	Material	Damages	Measure	Rate	Cost
Trim	Painted Timber	Trim 90 mm	Removal required for other repair			
			Supply Replace Trim	2.00 l/m	25.00	50.00

**General Comments:** replace timber trim

**Ground Floor - Room (Other) (External garage. )**

**Damage:** No damage

**Require Scaffolding?** No

**General Comments:** Concrete slab. Concrete. Filled. Concrete blocks  
Historical cracking in slab

**Fees**

**Fees**

Name	Duration	Estimate
------	----------	----------

**Overheads**

Name	Estimate
Preliminary and general	953.14
Margin	1,286.73
GST	2,123.11

## Scope Of Works Estimate

### Property

Description	Estimate
Site	0.00
Services	0.00
	0.00

### Main Building

Name	Description	Estimate
Exterior	Foundations (Concrete ring)	0.00
	Foundations (Conical Concrete piles. Main dwelling)	0.00
	Roof (Decramastic pressed metal tiles in very good original condition)	0.00
	Elevation (East level. One. )	0.00
	Elevation (East. Ground level)	1,330.20
	Elevation (North ground floor)	1,071.70
	Elevation (North level. One )	0.00
	Elevation (South level. One)	0.00
	Elevation (South main wall)	1,453.50
	Elevation (West ground level)	1,295.20
	Elevation (West. Ground level)	1,225.20
	Elevation (West. Level one)	0.00
		6,375.80

Floor	Description	Estimate
First Floor	Bedroom (Bedroom, games room)	2,688.00
	Office/Study	0.00
	Room (Other) (Timber deck level one. North face )	0.00
	Room (Other) (Top floor landing)	0.00
	2,688.00	

Ground Floor	Bathroom	0.00
	Bedroom (Bed 2, between master bed and dining)	48.00
	Bedroom (Masterbed)	0.00
	Bedroom (Masterbed wardrobe)	0.00
	Dining Room	885.84
	Entry	262.00
	Hallway (Hallway, includes linen and store)	252.00
	Kitchen	0.00
	Laundry	0.00
	Lounge	0.00
	Room (Other) (Timber deck. Main entrance. West side)	0.00
	Stairwell	948.00
	Toilet	0.00
		2,395.84

5,083.84

### External garage

Name	Description	Estimate
Exterior	Elevation (External garage. North wall inside of blockwork. Some hairline crack )	404.56
	Elevation (Timber trim. Beneath. Ranchslider. West side )	50.00
	454.56	

<b>Floor</b>	<b>Description</b>	<b>Estimate</b>
Ground Floor	Room (Other) (External garage. )	0.00
		0.00
		0.00

**Fees**

<b>Description</b>	<b>Estimate</b>
--------------------	-----------------

**Overheads**

<b>Description</b>	<b>Estimate</b>
Preliminary and general	953.14
Margin	1,286.73
GST	2,123.11
	4,362.98
<b>Total Estimate</b>	16,277.18

## Inspection Sign Off

Description	Answer	comments
<b>Land Damage</b>		
Is there land damage?	No	Minor land movement
<b>Contents Damage</b>		
Has the contents schedule been left with claimant?	No	
Have the contents been sighted?	No	
<b>Was a full inspection done?</b>		
In roof space	Yes	
On roof?	Yes	
Under sub floor?	Yes	
<b>Decline Claim</b>		
Recommend Declining Claim	No	
<b>Next Action:</b>		
Process claim		

### Previous Claim Numbers (recorded manually in field)

- CLM/2010/049833
- CLM/2011/024212

### File Notes

**Date Created:** 01/07/2011 15:36  
**Created :** fellows, chris  
**Subject:** Apportioning damage from various events  
**Note:** Claimant has advised  
 September event caused. 20. %. Damage  
 February. Event. Caused. 80. %. Damage  
**Next Action:** Process claim

**Date Created:** 10/11/2012 00:04  
**Created :** Administrator, Alchemy  
**Subject:** COMET sent to EQR on 01/11/2011  
**Note:** COMET sent to EQR on 01/11/2011  
**Next Action:**

### Urgent Works Items

**Date Created:** 01/07/2011 15:38  
**Created :** fellows, chris  
**Situation Of Loss:** Rear aluminum door east wall  
**Urgency:** Category 1 - 24 hour  
**Scope Of Works:** Rear aluminum door east wall

## CLM/2011/198599 - Scope Change Summary

Scope Change Summary- Property Details			
Claim Number	CLM/2011/198599	Hub Zone	North New Brighton Hub
Contractor Name	Ben Rees Builders	Supervisor	Geoff Newman
Property Address	18 HEATHGLEN AVENUE, PARKLANDS	Main Contact Name	CHRISTOPHER COLVILL
Customer name	CHRISTOPHER COLVILL	Customer Email	██████████
Home Phone	██████████	Mobile Phone	██████████
Created By	Geoff Newman (EQR)	Form Completed	30/07/2013 12:13:30 p.m.

This form is to record any scope changes or alternative repair methodologies to those described in the EQC assessment documentation. It is vital that for all amendments that 'photos' are taken to assist with the E.Q.C approval of the scope changes

Type of Scope Change	Room (Dimensions)	Element	Changes to Original EQC Scope	E.Q.C Approval
	Elevation North		Remove Heat pump for other trades 1 No Grind out and epoxy foundation cracks 1.5L/m Splash coat repair to foundation, 2m2	
	Elevation East		Grind out and repoint cracks to summerhill stone, 15m2	
	Elevation West		remove, relay cill blocks 4 L/m	
	Elevation South		Mobile scaffold 22.32m2	
	Entry		Replace Floor tile supplied by H/O 1 No Door external, realign, OMIT	
	Lounge		Walls, rake plaster and paint, 26.4m2 Door external, realign 1 No Door internal, CA slider, paint jambs and architraves, 1 No	
	Kitchen		Window, Door external, paint trims, 12 L/m Walls, rake plaster and paint, 25m2	
	Bed 2		Walls, rake plaster and paint, 27.36m2 Door internal, ease and paint surround 1 No	
	Bathroom,		Windows, paint trims 10 L/m	
	Hallway		Walls, gap fill and paint, 28.8m2	
	First floor		Ceiling, gap fill and paint, 41m2 Walls, rake out, plaster and paint, 70.8m2	
	Office,		Walls, rake out, plaster and paint, 30m2	
	Garage East wall,		paint with elastomeric paint, 30m2	
	Garage south elevation,		Rebed loose brick 1 No Paint wall both sides, 4 m2	
	Elevation West		painted timber beneath dining ranchslider door, gap fill and paint trim, 2L/m	

Fletcher EQR has recorded the above scope changes to the EQC claim assessment at this property.

The above scope changes should be added to the EQC assessment for EQC to review/approve prior to confirmation with customer and issue of any Works Order.

MS-SF0405

---

**CLM/2011/198599 - Scope Change Summary**

**EQR Contracts Supervisor:**

Geoff Newman

30/07/2013

Name

Signature

Date

**EQC Representative:**

30/07/2013

Name

Signature

Date

## EQC Claim Assessment

<b>Address</b>	18 HEATHGLEN AVENUE, PARKLANDS, CHRISTCHURCH, 8083	<b>EQC Claim Number</b>	CLM/2011/198599
<b>Hazards</b>	Nil hazards	<b>EQC Assessor (L,F)</b>	fellows, chris
<b>Inspection Date</b>	01-Jul-2011	<b>Placard</b>	No Sticker
<b>Status</b>	Current	<b>EQC Estimator (L,F)</b>	Goodall, Mike

### Claimants

Name	Home Phone	Work Phone	Mobile Phone	Email Address
COLVILL CHRISTOPHER				

### Property Detail - Services

Element	Description / Damage / Repair Strategy	Measure
<b>Water Supply</b>	Town Connection, Plastic	10 m
<b>Sewerage</b>	Town Connection, PVC Pipe	10 m

### Property Detail - Site

Element	Description / Damage / Repair Strategy	Measure
<b>Land</b>	Exposed, Soil	512 m2
<b>Land</b>	Under dwelling, Soil	140 m2

<b>MAIN BUILDING</b>	Age 1961 - 1980	Area 134.6m2	Footprint Rectangular
----------------------	-----------------	--------------	-----------------------

Element	Description / Damage / Repair Strategy	Measure
<b>Elevation (North ground floor)</b>		
Wall framing	Timber Frame, Timber (24.18 m2)	
Wall cladding	Brick veneer, Oamaru Stone (24.18 m2) Cracking Grind out and repoint mortar	8 m
Wall cladding	Brick veneer, Oamaru Stone (24.18 m2) Cracking to paint Paint wall	27.3 m2

*Remove HP for other trades*  
*Grind out epoxy foundation cracks splash coat repair 2m2*  
*1.5m*  
*8m*  
*27.3m*

**Comments:** Brick veneer. Painted in very good condition  Some stair step cracking  9.3. Metres. Long. X. 2.6. Metres high

Element	Description / Damage / Repair Strategy	Measure
<b>Elevation (North level. One )</b>		
<b>Comments:</b> 6.2. Metres wide. X 4 metres. High <input type="checkbox"/> Hardies. Weatherboard in very good conditipn		

Element	Description / Damage / Repair Strategy	Measure
<b>Elevation (East. Ground level)</b>		
Wall framing	Timber Frame, Timber (33.80 m2)	
Wall cladding	Brick veneer, Oamaru Stone (33.80 m2) Cracking Grind out and epoxy fill	10 m

*repoint*  
*15m*

EQC Claim Number CLM/2011/198599

Wall cladding	Brick veneer, Oamaru Stone (33.80 m2)		
	Cracking to paint		
	Paint wall		33.8 m2

Comments: 13. Metres. Long. X. 2.6. Metres high  Painted. Brick veneer

Element	Description / Damage / Repair Strategy	Measure
---------	--	---------

**Elevation (West ground level)**

Wall framing	Timber Frame, Timber (33.80 m2)		
Wall cladding	Brick veneer, Oamaru Stone (33.80 m2)	<i>Remove Rekey with bricks</i>	<i>4m1 ✓</i>
Wall cladding	Brick veneer, Oamaru Stone (33.80 m2)	Cracking	
	Grind out and epoxy fill		9 m ✓
Wall cladding	Brick veneer, Oamaru Stone (33.80 m2)	Cracking to paint	
	Paint wall		33.8 m2 ✓

Comments: 13. Metres. Long. X. 2.6. Metres. High

Element	Description / Damage / Repair Strategy	Measure
---------	--	---------

**Elevation (East level. One.)**

Comments: James. Hardie. Weatherboards. Good condition  8. Metres long. X. 1.8 metres high.

Element	Description / Damage / Repair Strategy	Measure
---------	--	---------

**Elevation (West. Level one)**

Comments: 8. Metres. Long. X. 1.8. Metres high in good condition

Element	Description / Damage / Repair Strategy	Measure
---------	--	---------

**Elevation (West. Ground level)**

Wall framing	Timber Frame, Timber (33.80 m2)		
Wall cladding	Brick veneer, Oamaru Stone (33.80 m2)	Cracking	
	Grind out and epoxy fill		7 m
Wall cladding	Brick veneer, Oamaru Stone (33.80 m2)	Cracking to paint	
	Paint wall		33.8 m2

Comments: 13. Metres long. X. 2.6. Metres high

Element	Description / Damage / Repair Strategy	Measure
---------	--	---------

**Elevation (South main wall)**

Wall framing	Timber Frame, Timber (22.32 m2)	<i>Mobile Scaffold</i>	<i>✓</i>
Wall cladding	Brick veneer, Oamaru Stone (46.50 m2)	Cracking	
	Grind out and epoxy fill		3 m ✓
Wall cladding	Brick veneer, Oamaru Stone (46.50 m2)	Cracking to paint	
	Paint wall		46.5 m2

Comments: 9.3. Metres wide. X. 5. Metres high.  Cracking around glass block window.

Element	Description / Damage / Repair Strategy	Measure
---------	--	---------

**Elevation (South level. One)**

EQC Claim Number CLM/2011/198599

**Comments:** 6.2. Metres long. X. 2.4. Metres. High  James Hardie. Weatherboards in excellent condition

Element	Description / Damage / Repair Strategy	Measure
---------	--	---------

**Foundations (Concrete ring)****Comments:** in very good original condition  A few minor historical cracks around vents  Not structural

Element	Description / Damage / Repair Strategy	Measure
---------	--	---------

**Foundations (Conical Concrete piles. Main dwelling)****Comments:** in excellent condition  Ground under dwelling is dry and solid

Element	Description / Damage / Repair Strategy	Measure
---------	--	---------

**Roof (Decramastic pressed metal tiles in very good original condition)****Ground Floor**

Room / Element	Description / Damage / Repair Strategy	Measure
----------------	--	---------

**Room (Other) Timber deck. Main entrance. West side (L=2.4m W=2.2m H=2.4m)****Room - Comments:** In very good condition**Room - Additional Notes:****Entry (L=1.6m W=1.6m H=2.4m)**

Floor	Chipboard, Tiles (2.56 m2) Cosmetic damage Grind out and re-grout tiles	<i>Replace 1 tile by H/O</i> ✓ 2 m ✓
-------	---	---

Wall covering Gib, Paint (15.36 m2)

Ceiling Gib, Paint (2.56 m2)

Trim Painted MDF, Trim 60mm (6.00 m)

Damaged finish  
Gap fill and paint trims

6 m ✓

Door (External) SG Single, Timber (1.00 Item)

Cosmetic damage  
Realign*omit* ✓

1 No of

Door (Internal) Single Hollow Core, Timber (1.00 No of)

**Room - Additional Notes:****Stairwell (L=2.1m W=1.6m H=5.0m)**

Handrails Bar, Timber (4.00 m)

Stairs (Internal) Box, MDF (7.00 m)

Floor Chipboard, Carpet (3.36 m2)

Wall covering Gib, Paint (37.00 m2)

Cosmetic damage  
Paint wall  
Rake out and stop

37 m2 ✓

6 m ✓

Ceiling Gib, Paint (3.36 m2)

Door (Internal) Single Hollow Core, Timber (1.00 No of)

Room - Additional Notes:

**Lounge (L=4.8m W=0.7m H=2.4m)**

Window	Aluminium Awning, Pane single glazed (1.00 No of)		
Floor	Chipboard, Carpet (3.36 m2)		
Wall covering	Gib, Paint (26.40 m2)	RPP ✓	✓
Ceiling	Gib, Paint (3.36 m2)		
Door (External)	SG Sliding, Aluminium (1.00 Item)	Realign ✓	✓
Door (Internal)	Single Hollow Core, Timber (1.00 No of)	Paint Jambs + Arch ✓	✓

Room - Additional Notes:

**Kitchen (L=4.0m W=3.3m H=2.4m)**

Window	Aluminium Awning, Pane single glazed (1.00 No of)		
Floor	Chipboard, Tiles (13.20 m2)		
Door (External)	DG Single, Aluminium (1.00 Item)	Paint Trims ✓	12m ✓
Hob	Gas, Standard Spec (1.00 Item)	Realign ✓	✓
Wall covering	Gib, Paint ( <del>35.04</del> m2)	RPP 25m <sup>2</sup> ✓	✓
Ceiling	Gib, Paint (13.20 m2)		
Work top	Kitchen work top, Laminate (7.00 m)		
Kitchen joinery	Medium Spec, MDF (1.00 Item)		
Range Hood	Over Head, Medium spec (1.00 Item)		

Room - Comments: Architrave to window and door cracks

Room - Additional Notes:

**Dining Room (L=3.9m W=2.8m H=2.4m)**

Floor	Chipboard, Vinyl (10.92 m2)		
Ceiling	Gib, Paint (10.92 m2)		
Wall covering	Gib, Paint (32.16 m2)		
	Cosmetic damage		
	Paint wall	32.16 m2	✓
	Rake out and stop	3 m	
Trim	Painted MDF, Trim 60mm (7.00 m)		
	Damaged finish		
	Gap fill and paint trims	7 m	✓

Room - Additional Notes:

**Bedroom Masterbed (L=4.0m W=3.3m H=2.4m)**

Room - Additional Notes:

**Bedroom Masterbed wardrobe (L=3.0m W=0.7m H=2.4m)**

Room - Additional Notes:

**Bedroom Bed 2, between master bed and dining (L=2.8m W=2.9m H=2.4m)**

Window	Aluminium Awning, Pane double glazed (1.00 No of)	
Floor	Chipboard, Carpet (8.12 m2)	
Ceiling	Gib, Paint (8.12 m2)	
Wall covering	Gib, Paint (27.36 m2)	RPP ✓ ✓
Trim	Painted MDF, Trim 60mm (4.00 m)	
	Damaged finish	<del>4m</del>
	Gap fill and paint trims	✓
Door (Internal)	Single Hollow Core, Timber (1.00 No of)	ease & part surround ✓

Room - Comments: skirting board damage behind bed

Room - Additional Notes:

**Bathroom (L=3.5m W=3.5m H=2.4m)**

Room - Additional Notes:	Part trims 10 m to windows ✓
--------------------------	------------------------------

**Toilet (L=1.7m W=0.9m H=2.4m)**

Room - Additional Notes:	Master Bed: OK ✓
--------------------------	------------------

**Hallway Hallway, includes linen and store (L=4.0m W=2.0m H=2.4m)**

Floor	Chipboard, Carpet (8.00 m2)	
Ceiling	Gib, Paint (8.00 m2)	
Wall covering	Gib, Paint (28.80 m2)	
	Cosmetic damage	
	Gap fill cracks	28.8m <sup>2</sup> 3 m ✓
	Paint wall	<del>9m<sup>2</sup></del>

Room - Comments: Cracking between scotia and wall at end next to master bedroom and bathroom

Room - Additional Notes:

**Laundry (L=1.8m W=1.0m H=2.4m)**

Room - Additional Notes:	<del>4m<sup>2</sup></del>
--------------------------	---------------------------

**First Floor**

Room / Element	Description / Damage / Repair Strategy	Measure
<b>Bedroom Bedroom, games room (L=7.8m W=4.0m H=3.0m)</b>		
Window	Aluminium Awning, Pane single glazed (3.00 No of)	
Floor	Chipboard, Carpet (31.20 m2)	
Ceiling	Gib, Stipple (31.20 m2)	31.2 4/m <sup>2</sup>

EQC Claim Number CLM/2011/198599

		Cosmetic Damage		
		Paint Ceiling	<i>Gap fill + Paint 4m<sup>2</sup></i>	31.2 m <sup>2</sup> ✓
		Rake out and stop		10 m ✓
Wall covering	Gib, Paint (70.80 m <sup>2</sup> )	Cosmetic damage	<i>RPP</i>	70.8 m <sup>2</sup> ✓
		Paint wall		5 m ✓
		<del>Rake out and stop</del>		
Door (External)	SG Sliding, Aluminium (1.00 Item)	Cosmetic damage		1 No of ✓
		Realign		

**Room - Comments:** Minor cracking to walls □□ Ceiling ok, cracks between ceiling and beams. Gap fill and possible ceiling touchup

**Room - Additional Notes:**

**Room (Other) Timber deck level one. North face (L=2.8m W=1.2m H=2.4m)**

**Room - Comments:** Cantilevered deck in very good condition ✓

**Room - Additional Notes:**

**Office/Study (L=4.0m W=2.0m H=3.0m)**

*walls RPP 30m<sup>2</sup>* ✓

**Room - Additional Notes:**

**Room (Other) Top floor landing (L=1.8m W=1.0m H=2.4m)**

**Room - Additional Notes:**

**EXTERNAL GARAGE**      Age 1961 - 1980      Area 44.6m<sup>2</sup>      Footprint Rectangular

**Structure**

Element	Description / Damage / Repair Strategy	Measure
<b>Elevation (External garage. North wall inside of blockwork. Some hairline crack)</b>		
Wall framing	Block (43.31 m <sup>2</sup> )	
	Cosmetic damage	
	Grind out and re-mortar	8 m ✓
Wall cladding	Brick veneer, Oamaru Stone (43.31 m <sup>2</sup> )	
	Structural damage	
	Relay and re-bed loose bricks	0.04 m <sup>2</sup>
Wall cladding	Brick veneer, Oamaru Stone (0.04 m <sup>2</sup> )	
	<i>EAST</i> Cracking to paint	<i>15m + 15m</i> 30m <sup>2</sup> ?
	Paint wall	0.04 m <sup>2</sup>

**Comments:** Also. Right hand wing wall right hand side of tilt a door loose brick. Rebed brick and grind out and remortar inside north block wall *South paint. 4m<sup>2</sup>* *include* ✓

**Elevation (Timber trim. Beneath. Ranchslider. West side)**

Element	Description / Damage / Repair Strategy	Measure
---------	--	---------

EQC Claim Number CLM/2011/198599

Trim	Painted Timber, Trim 90 mm (2.00 m)		
	Removal required for other repair	<i>Gap fill + Paint</i>	
	Supply Replace Trim		2 m

Comments: replace timber trim

Ground Floor

Room / Element	Description / Damage / Repair Strategy	Measure
----------------	--	---------

Room (Other) External garage. (L=7.2m W=6.1m H=2.4m)

Room - Comments: Concrete slab. Concrete. Filled. Concrete blocks  Historical cracking in slab

Room - Additional Notes:

Of Assessment

EMERGED  
14/8/2023

## Quote for: Ben Rees Builders

18 Heathglen Avenue  
CLM/2011/198599

PRELIMINARIES AND GENERAL	Quantity	Per	Rate including	
			Margin	Total
Project supervision	1	No	\$ 1,209.38	\$ 1,209.38
Rubbish removal	1	No	\$ 365.50	\$ 365.50
Clean upon completion	1	No	\$ 376.25	\$ 376.25
Floor protection	1	No	\$ 477.49	\$ 477.49
				<b>\$ 2,428.62</b>

### TAGS AND CLARIFICATIONS

NO ALLOWANCE TO MOVE CONTENTS  
 NO ALLOWANCE FOR STORAGE OF CONTENTS  
 NO ALLOWANCE FOR CONTENTS REMOVAL INSURANCE  
 RAKE OUT PLASTER AND PAINT/PAINT TO WALLS/CEILINGS INCLUDES FOR ONE  
 MATCHING COLOUR IN WATER BASED ACRYLIC ONLY  
 NO ALLOWANCE FOR LEVEL 5 FINISH  
 NO ALLOWANCE TO REMOVE OR TEST FOR ASBESTOS  
 NO ALLOWANCE TO REPLACE CORNICE/SCOTIA  
 NO ALLOWANCE FOR CONSENTS/DESIGN FEES/ENG FEES  
 NO ALLOWANCE TO REPLACE PILES  
 NO ALLOWANCE FOR ANY STRUCTURAL REPAIR WORK  
 NO ALLOWANCE FOR WATER BLASTING TO EXTERIOR  
 NO ALLOWANCE FOR ROOF/EDGE PROTECTION  
 NO ALLOWANCE FOR HIDDEN WORKS  
 NO ALLOWANCE FOR LAND REMEDIATION  
 ALL VARIATIONS WILL BE PROCESSED USING THE SAME METHOD OF MEASUREMENT  
 AS THE ORIGINAL SCOPE IE NO DEDUCTIONS FOR WINDOWS AND DOORS  
 ALL VARIATIONS WILL BE PROCESSED TO INCLUDE FOR P&G AND WILL USE THE  
 SAME RATES AS APPROVED IN THE ORIGINAL QUOTE  
 THIS QUOTE IS VALID FOR 30 DAYS FROM DATE OF SUBMISSION

**Elevation North Ground**

Wall cladding - Grind out and repoint mortar	8 m	\$	48.38	\$	387.00	✓
Wall cladding - Paint wall	27.3 m <sup>2</sup>	\$	29.03	\$	792.38	✓
Heat pump - Remove heat pump for other trades - scope change	1 no	\$	263.38	\$	263.38	✓
Foundation - Grind out and epoxy foundation cracks - scope change	1.5 m	\$	129.00	\$	193.50	✓
Foundation - Splash coat repair to foundation - scope change	2 m <sup>2</sup>	\$	59.13	\$	118.25	✓
				\$	<b>1,754.51</b>	

**Elevation East Ground**

Wall cladding - Grind out and epoxy fill	10 m	\$	129.00	\$	1,290.00	✗
Wall cladding - Paint wall	33.8 m <sup>2</sup>	\$	29.03	\$	981.05	✓
Wall cladding - Grind out and repoint cracks to Summerhill stone - scope change	15 m <sup>2</sup>	\$	48.38	\$	725.63	✓
				\$	<b>2,996.67</b>	

**Elevation West Ground**

Wall cladding - Grind out and epoxy fill	9 m	\$	129.00	\$	1,161.00	✓
Wall cladding - Paint wall	33.8 m <sup>2</sup>	\$	29.03	\$	981.05	✓
Wall cladding - Remove and relay sill blocks - scope change	4 m	\$	75.25	\$	301.00	✓
				\$	<b>2,443.05</b>	

**Elevation South Main Wall**

Wall cladding - Grind out and epoxy fill	3 m	\$	129.00	\$	387.00	✓
Wall cladding - Paint wall	46.5 m <sup>2</sup>	\$	34.40	\$	1,599.60	✓
Scaffold - Mobile scaffold - scope change	2 wks	\$	344.00	\$	688.00	✓
				\$	<b>2,674.60</b>	

**Ground Floor****Entry**

Floor - Grind out and regrout tiles	2 m	\$	26.88	\$	53.75	✓
Trim - Gap fill and paint trim	6 m	\$	16.13	\$	96.75	✓
Floor - Replace 1no floor tile supplied by H/O - scope change	1 sum	\$	53.75	\$	53.75	✓
				\$	<b>204.25</b>	

**Stairwell**

Wall covering - Paint wall	37 m <sup>2</sup>	\$	20.96	\$	775.61	✓
Wall covering - Rake out and stop	6 m	\$	16.13	\$	96.75	✓
				\$	<b>872.36</b>	

<b>Lounge</b>				
Wall covering - Rake out, plaster and paint - scope change	26.4 m <sup>2</sup>	\$	27.95	\$ 737.88 ✓
Door (external) - Realign - scope change	1 no	\$	96.75	\$ 96.75 ✓
Door (internal) - Cavity slider, paint jambs and architraves - scope change	1 no	\$	107.50	\$ 107.50 ✓
				<u>\$ 942.13</u>

<b>Kitchen</b>				
Trim - Paint trim - scope change	12 m	\$	16.13	\$ 193.50 ✓
Wall covering - Rake out, plaster and paint - scope change	25 m <sup>2</sup>	\$	27.95	\$ 698.75 ✓
				<u>\$ 892.25</u>

<b>Dining Room</b>				
Wall covering - Paint wall	32.16 m <sup>2</sup>	\$	20.96	\$ 674.15 ✓
Wall covering - Rake out and stop	3 m	\$	16.13	\$ 48.38 ✓
Trim - Gap fill and paint trim	7 m	\$	16.13	\$ 112.88 ✓
				<u>\$ 835.40</u>

<b>Bedroom 2, between master bed and dining</b>				
Trim - Gap fill and paint trim	4 m	\$	16.13	\$ 64.50 ✓
Wall covering - Rake out, plaster and paint - scope change	27.36 m <sup>2</sup>	\$	27.95	\$ 764.71 ✓
Door (internal) - Ease and paint surround - scope change	1 no	\$	182.75	\$ 182.75 ✓
				<u>\$ 1,011.96</u>

<b>Bathroom</b>				
Window - Paint trim - scope change	10 m	\$	16.13	\$ 161.25 ✓
				<u>\$ 161.25</u>

<b>Hallway, includes linen and store</b>				
Wall covering - Gap fill and paint - scope change	28.8 m <sup>2</sup>	\$	26.88	\$ 774.00 ✓
				<u>\$ 774.00</u>

<b>First Floor</b>				
<b>Bedroom, games room</b>				
Ceiling - Gap fill and paint - scope change	41 m <sup>2</sup>	\$	26.88	\$ 1,101.88 ✓
Wall covering - Rake out, plaster and paint - scope change	70.8 m <sup>2</sup>	\$	27.95	\$ 1,978.86 ✓
Door (external) - Realign	1 no	\$	96.75	\$ 96.75 ✓
				<u>\$ 3,177.49</u>

<b>Office</b>				
Wall covering - Rake out, plaster and paint - scope change	30 m <sup>2</sup>	\$	27.95	\$ 838.50 ✓
				<u>\$ 838.50</u>

**External Garage**

**Elevation, East wall**

Wall cladding - Paint with elastomeric paint - scope change	30 m <sup>2</sup>	\$	34.40	\$	1,032.00 ✓
					<u>\$ 1,032.00</u>

**Elevation, South**

Wall cladding - Rebed loose brick 1no - scope change	1 sum	\$	53.75	\$	53.75 ✓
Wall cladding - Paint wall both sides - scope change	4 m <sup>2</sup>	\$	34.40	\$	137.60 ✓
					<u>\$ 191.35</u>

**Elevation, North wall inside of blockwork**

Wall framing - Grind out and remortar	8 m	\$	48.38	\$	387.00 ✓
Wall cladding - Relay and rebed loose bricks 0.04m <sup>2</sup>	1 sum	\$	107.50	\$	107.50 ✓
Wall cladding - Paint wall 0.04m <sup>2</sup>	1 sum	\$	53.75	\$	53.75 ✓
					<u>\$ 548.25</u>

**Elevation, West side**

Trim - Supply and replace trim	2 m	\$	21.50	\$	43.00 ✓
Trim - Painted timber beneath dining Ranchslider, gap fill and paint trim - scope change	1 sum	\$	107.50	\$	107.50 ✓
					<u>\$ 150.50</u>

22639-16. Sub Total \$ 23,929.13 X  
 Excluded 11290-w Plus GST \$ 3,589.37  
 East Elevation. as per GRAND TOTAL \$ 27,518.50  
 Supervisor



Fletcher EQR acting as agent for EQC  
(divn of FletcherConstruction)  
P O Box 80105  
CHRISTCHURCH 8440

Telephone 03 341 9900  
Facsimile 03 343 4167

## Works Order

**To:**

Oceanside Electrical Ltd  
30 Keppel Street North New Bri

**Christchurch**

Phone 021 070 8159  
Email oceansideelectrical@xtra.co.nz

**Order No E013-01268**

Please quote Works Order Number on  
all invoices, correspondences etc

Accreditation Number **SPLE0011**  
Contractor Code **SG19**

**From:**

Hub North New Brighton Hub  
Works Order Date 08-Aug-2013

Project Number **E013**

**Please proceed with the works outlined in the attached approved Scope of Works for:**

EQC Claim Number	Address	Start Date	\$ Ex. GST
CLM/2011/198599	18 HEATHGLEN AVENUE, PARKLANDS	08-Aug-2013	120.00
<b>NZ Govt Goods and Services Tax Is Not Included In This Total</b>			<b>Total Cost 120.00</b>

The above stated contract price is deemed to be a complete price to undertake and complete the works as detailed within the attached Scope of Works. The Scope of Works shall not be varied without Fletcher EQR's prior written consent. No additional costs will be accepted unless approved by a written Variation Order issued and signed by Fletcher EQR. Any request for payment based on an invalid variation instruction will be refused.  
All Works shall be completed in accordance with the approved Scope of Works unless varied as above.

Authorised By **Owen Shiel**  
On behalf of Fletcher Construction  
as agent for Earthquake Commission Signature

**IMPORTANT**

This Works Order is only valid when authorized and signed by a Fletcher EQR Quantity Surveyor.  
This Works Order is to be read in conjunction with the attached approved Scope of Works referencing this Works Order.  
If no Scope of Works is attached please contact the issuing Quantity Surveyor for a copy of the Scope of Works.  
This Works Order is subject to the terms and conditions contained in the Short Form Agreement for engagement of contractors between the parties.  
Please send all invoices and correspondence to the Fletcher EQR Hub responsible for issuing this Works Order.

The Contractor is responsible for all Warranties to be passed onto the homeowner.  
No additional private work is to be undertaken. Fletcher EQR reserves the right to terminate the contract and de-accredit any contractor working on site without approval.  
EQC and Fletcher EQR employ zero tolerance in relation to fraud and will prosecute offenders.



Fletcher EQR acting as agent for EQC  
(divn of FletcherConstruction)  
P O Box 80105  
CHRISTCHURCH 8440

Telephone 03 341 9900  
Facsimile 03 343 4167

# Works Order

**To:**

**Ben Rees Builders**  
**265 Marine Parade**  
**New Brighton**  
**Christchurch 8061**

Phone 03 3885887

Email reeso246@yahoo.co.nz

**Order No E013-01388**

Please quote Works Order Number on  
all invoices, correspondences etc

Accreditation Number EQRC1193

Contractor Code SC62

**From:**

Hub North New Brighton Hub

Project Number E013

Works Order Date 21-Aug-2013

**Please proceed with the works outlined in the attached approved Scope of Works for:**

EQC Claim Number	Address	Start Date	\$ Ex. GST
CLM/2011/198599	18 HEATHGLEN AVENUE, PARKLANDS	19-Sep-2013	22,639.16
<b>NZ Govt Goods and Services Tax Is Not Included In This Total</b>			<b>Total Cost 22,639.16</b>

The above stated contract price is deemed to be a complete price to undertake and complete the works as detailed within the attached Scope of Works. The Scope of Works shall not be varied without Fletcher EQR's prior written consent. No additional costs will be accepted unless approved by a written Variation Order issued and signed by Fletcher EQR. Any request for payment based on an invalid variation instruction will be refused.  
All Works shall be completed in accordance with the approved Scope of Works unless varied as above.

Authorised By **Owen Shiel**

On behalf of Fletcher Construction  
as agent for Earthquake Commission Signature

**IMPORTANT**

This Works Order is only valid when authorized and signed by a Fletcher EQR Quantity Surveyor.  
This Works Order is to be read in conjunction with the attached approved Scope of Works referencing this Works Order.  
If no Scope of Works is attached please contact the issuing Quantity Surveyor for a copy of the Scope of Works.  
This Works Order is subject to the terms and conditions contained in the Short Form Agreement for engagement of contractors between the parties.  
Please send all invoices and correspondence to the Fletcher EQR Hub responsible for issuing this Works Order.

The Contractor is responsible for all Warranties to be passed onto the homeowner.  
No additional private work is to be undertaken. Fletcher EQR reserves the right to terminate the contract and de-accredit any contractor working on site without approval.  
EQC and Fletcher EQR employ zero tolerance in relation to fraud and will prosecute offenders.



# Works Order

Fletcher EQR acting as agent for EQC  
(divn of FletcherConstruction)  
P O Box 80105  
CHRISTCHURCH 8440

Telephone 03 341 9900

Facsimile 03 343 4167

**To:**

**Ben Rees Builders**  
**265 Marine Parade**  
**New Brighton**  
**Christchurch 8061**  
Phone **03 3885887**  
Email **reeso246@yahoo.co.nz**

**Order No E013-01388**

Please quote Works Order Number on  
all invoices, correspondences etc

Accreditation Number **EQRC1193**

Contractor Code **SC62**

**From:**

Hub **North New Brighton Hub**  
Works Order Date **21-Aug-2013**

Project Number **E013**

**Please proceed with the works outlined in the attached approved Scope of Works for:**

EQC Claim Number	Address	Start Date	\$ Ex. GST
CLM/2011/198599	18 HEATHGLEN AVENUE, PARKLANDS	19-Sep-2013	22,639.16
NZ Govt Goods and Services Tax Is Not Included In This Total			<b>Total Cost 22,639.16</b>

The above stated contract price is deemed to be a complete price to undertake and complete the works as detailed within the attached Scope of Works. The Scope of Works shall not be varied without Fletcher EQR's prior written consent. No additional costs will be accepted unless approved by a written Variation Order issued and signed by Fletcher EQR. Any request for payment based on an invalid variation instruction will be refused.  
All Works shall be completed in accordance with the approved Scope of Works unless varied as above.

Authorised By **Owen Shiel**

On behalf of Fletcher Construction  
as agent for Earthquake Commission Signature

**IMPORTANT**

This Works Order is only valid when authorized and signed by a Fletcher EQR Quantity Surveyor.  
This Works Order is to be read in conjunction with the attached approved Scope of Works referencing this Works Order.  
If no Scope of Works is attached please contact the issuing Quantity Surveyor for a copy of the Scope of Works.  
This Works Order is subject to the terms and conditions contained in the Short Form Agreement for engagement of contractors between the parties.  
Please send all invoices and correspondence to the Fletcher EQR Hub responsible for issuing this Works Order.

The Contractor is responsible for all Warranties to be passed onto the homeowner.  
No additional private work is to be undertaken. Fletcher EQR reserves the right to terminate the contract and de-accredit any contractor working on site without approval.  
EQC and Fletcher EQR employ zero tolerance in relation to fraud and will prosecute offenders.

# 1

MS-SF0505 Variation to Works Order



Claim Number	2011/193599	Contractor Name	BEN PEES BUILDERS
Customer Name		Supervisor	GEOFF NEWMAN
Main Contact		Date	21/10/13
Property Address	18 HEATHGLEN	Customer email	
Phone		QS Name	

For all Variations please contact your Contract Supervisor before proceeding with any work. *This section must be filled out by the contractor in full with as much supporting information as possible: Descriptions, Repair Strategies, Quantities, Units, Rates, Photos where appropriate - The contractor must ensure the reason for the variation is clearly stated (For example - unforeseen additional scope required, alternative repair strategy required etc...) and that works to be undertaken have not been previously allowed for.*

**Section 1** Completed by Contractor

Reason for Submitting a Variation  
UNFORESEEN ADDITIONAL SCOPE REQUIRED

Item	Description	Quantity	Unit	Rate	Amount
ENTRY	CEILING <u>add</u> : Rake, Plaster + Paint.	2.56	m <sup>2</sup>	27.95	71.55
	FLOOR <u>add</u> : Grind out + REPOINT TILES	7.60	m <sup>2</sup>	26.88	204.28
STAIRS	CEILING <u>add</u> : Rake, Plaster, Paint -	8.14	m <sup>2</sup>	27.95	227.51
	<u>add</u> : Mobile scaffold	1 No	Sum	150.00	150.00
HALLWAY	SCOTIA <u>add</u> : paint + gap trims only	19.0	LM	(16.13)	306.47
BED 1	ARCHITRAVES <u>add</u> : gap + paint.	15.0	LM	(16.13)	241.95
Rates Reduced per EQC allowance 05/11/13 KMG					
<b>Total</b>					<b>1201.76</b>

71.55  
204.28  
227.51  
150  
228  
180

\$ 1,001.34

**Section 2** Completed by Contract Supervisor

Work sighted Yes  No

Notes ENTRY - CEILING HAS MINOR CRACK, EXTRA LOOSE GRUNT IN FLOOR TILES  
STAIRS - MINOR CRACKING DISCOVERED, HALLWAY - CRACKING TO SCOTIA TRIMS ONLY, BED 1 WINDOW + DOOR TRIMS CRACKED AT MITRES

Name G. Newman Date 21/10/13 Signature [Signature]

**Section 3** Completed by EQC Representative

Instruction given for work to proceed Yes  No  Work sighted Yes  No

Notes J LINDSAY Approved

Name J LINDSAY Date 31 OCT 2013 Signature [Signature]

**Section 4** Completed by Quantity Surveyor

Claimed \$ 1201.76 Hub Name NNB  
Variation Total \$ 1001.34 Hub Number NNB. E

Name Kieran Mc Glynn Date 05/11/13 Signature [Signature]  
Tax Invoice/Payment Claim No. \_\_\_\_\_

# 1

MS-SF0505 Variation to Works Order



Claim Number	2011/198599	Contractor Name	BEN PEES BUILDERS
Customer Name		Supervisor	GEORGE NEWMAN
Main Contact		Date	21/10/13
Property Address	18 HEATHGLEN	Customer email	
Phone		QS Name	

For all Variations please contact your Contract Supervisor before proceeding with any work. **This section must be filled out by the contractor in full with as much supporting information as possible: Descriptions, Repair Strategies, Quantities, Units, Rates, Photos where appropriate - The contractor must ensure the reason for the variation is clearly stated (For example - unforeseen additional scope required, alternative repair strategy required etc...) and that works to be undertaken have not been previously allowed for.**

**Section 1 Completed by Contractor**

Reason for Submitting a Variation  
 UNFORESEEN ADDITIONAL SCOPE REQUIRED

Item	Description	Quantity	Unit	Rate	Amount
ENTRY	CEILING <u>add</u> : Rake, Plaster + Paint.	2.56	m <sup>2</sup>	27.95	71.55
	FLOOR <u>add</u> : Grind out + REPOINT TILES	7.60	m <sup>2</sup>	26.88	204.28
STAIRS	CEILING <u>add</u> : Rake, Plaster, Paint.	8.14	m <sup>2</sup>	27.95	227.51
	<u>add</u> : Mobile scaffold	1 No	Sum	150.00	150.00
HALLWAY	SCOTIA <u>add</u> : paint + gap trims only	19.0	LM	16.13	306.47
BED 1	ARCHITRAVES <u>add</u> : gap + paint.	15.0	LM	16.13	241.95
<b>Total</b>					<b>1201.76</b>

**Section 2 Completed by Contract Supervisor**

Work sighted Yes  No

Notes ENTRY - CEILING HAS MINOR CRACK, EXTRA LOOSE GRUNT IN FLOOR TILES  
 STAIRS - MINOR CRACKING DISCOVERED, HALLWAY - CRACKING TO SCOTIA TRIMS ONLY, BED 1 WINDOW + DOOR TRIMS CRACKED AT MITRES

Name G. Newman Date 21/10/13 Signature

**Section 3 Completed by EQC Representative**

Instruction given for work to proceed Yes  No  Work sighted Yes  No

Notes  
 J LINDSAY  
 EQC ESTIMATOR

Approved

Name J LINDSAY Date 31 OCT 2013 Signature

**Section 4 Completed by Quantity Surveyor**

Claimed \$ \_\_\_\_\_ Hub Name \_\_\_\_\_  
 Variation Total \$ \_\_\_\_\_ Hub Number \_\_\_\_\_ E \_\_\_\_\_  
 Tax Invoice/Payment Claim No. \_\_\_\_\_  
 Name 5556 Date \_\_\_\_\_ Signature \_\_\_\_\_

# 1

**Variation to Works Order**



Claim Number	2011-198599	Contractor Name	Ben Lees Builders
Customer Name	Chris	Supervisor	Creaff
Main Contact		Date	21/10/13
Property Address	18 Herbyes	Customer email	
Phone			

For all Variations please contact your Contract Supervisor before proceeding with any work. *This section must be filled out by the contractor in full with as much supporting information as possible: Descriptions, Repair Strategies, Quantities, Units, Rates, Photos where appropriate. The contractor must ensure the reason for the variation is clearly stated (For example - unforeseen additional scope required, alternative repair strategy required etc...) and that works to be undertaken have not been previously allowed for.*

**Section 1** Completed by Contractor

Reason for Submitting a Variation

Unforeseen additional scope required.

Item	Description	Quantity	Unit	Rate	Amount
Elevation North:	grand floor: add: Paint Omani stone	27.3	m <sup>2</sup>	29.03	792.81
Entry:	Ceiling: add: Rake Plaster + paint	2.56	m <sup>2</sup>	27.95	71.55 ✓
	Floor: add: grind out + re-grout tiles	7.60	M	26.88	204.28 ✓
Stairwell:	Ceiling: add: Rake plaster + paint	8.14	m <sup>2</sup>	27.95	227.51 ✓
	add: mobile scaffold	1	sum	150	150 ✓
Garage:	walls: <del>add: Rake Plaster + paint</del>	<del>14.8</del>	<del>m<sup>2</sup></del>	<del>27.95</del>	<del>415.89</del> ✓ in SCS
Hallway	Stair: add: paint + gap trim	19.0	L/M	16.13	306.47 ✓
<b>Total</b>					

? IN SCOPE

✓ in SCS

**Section 2** Completed by Contract Supervisor

Instruction given for work to proceed Yes  No  Work sighted Yes  No

Notes

Name \_\_\_\_\_ Date \_\_\_\_\_ Signature \_\_\_\_\_

**Section 4** Completed by Quantity Surveyor

Claimed \$ \_\_\_\_\_ Hub Name \_\_\_\_\_  
 Variation Total \$ \_\_\_\_\_ Hub Number \_\_\_\_\_ E \_\_\_\_\_

Name \_\_\_\_\_ Date \_\_\_\_\_ Signature \_\_\_\_\_  
 Tax Invoice/Payment Claim No. \_\_\_\_\_

**Section 5** Completed by EQC Representative

Instruction given for work to proceed Yes  No  Work sighted Yes  No

Notes

Name \_\_\_\_\_ Date \_\_\_\_\_ Signature \_\_\_\_\_



# Variation to Works Order

Claim Number	2011-198599	Contractor Name	Ken Lees Builders
Customer Name		Supervisor	
Main Contact		Date	
Property Address	18 Heathglan	Customer email	
Phone			

For all Variations please contact your Contract Supervisor before proceeding with any work. *This section must be filled out by the contractor in full with as much supporting information as possible: Descriptions, Repair Strategies, Quantities, Units, Rates, Photos where appropriate. The contractor must ensure the reason for the variation is clearly stated (For example - unforeseen additional scope required, alternative repair strategy required etc.) and that works to be undertaken have not been previously allowed for.*

**Section 1** Completed by Contractor

Reason for Submitting a Variation

unforeseen additional scope required.

Item	Description	Quantity	Unit	Rate	Amount
Master Bed:	walls: add: lake plaster paint	27.12	m <sup>2</sup>	27.95	758.04
	Architraves/Trims:				
	add: paint + gppill	15.00	M	16.13	241.95
garage	With elastomeric: add: paint wall with elastomeric paints.	14.4	m <sup>2</sup>	29.03	418.03
<b>Total</b>					<b>3586.23</b>

X  
NOT REQD  
✓  
X IN SCOPE CHANGE

**Section 2** Completed by Contract Supervisor

Instruction given for work to proceed Yes  No  Work sighted Yes  No

Notes

Name \_\_\_\_\_ Date \_\_\_\_\_ Signature \_\_\_\_\_

**Section 4** Completed by Quantity Surveyor

Claimed \$ \_\_\_\_\_ Hub Name \_\_\_\_\_  
Variation Total \$ \_\_\_\_\_ Hub Number \_\_\_\_\_ E \_\_\_\_\_

Tax Invoice/Payment Claim No. \_\_\_\_\_

Name \_\_\_\_\_ Date \_\_\_\_\_ Signature \_\_\_\_\_

**Section 5** Completed by EQC Representative

Instruction given for work to proceed Yes  No  Work sighted Yes  No

Notes

Name \_\_\_\_\_ Date \_\_\_\_\_ Signature \_\_\_\_\_

Schedule **E4** **Defects Liability Certificate**

---

Contract: E013 - 01388 BEN REES BUILDERS  
Claim Number: 2011 / 198599  
Location: 18 HEATHGLEN AVENUE, PARKLANDS

**End of Defects Liability period**

The Principal is required to issue a Defects Liability Certificate. The NBC SW Standard Conditions rule 13.1 states that:

The Principal must certify to the Contractor when in relation to the Contract Works or a Separate Section of them:

- (a) the Defects Liability Period has ended; and
- (b) the Contractor has completed all minor omissions and corrected all minor defects referred to in rule 12.1; and
- (c) the Contractor has completed agreed deferred work.

**This Certificate**

This is to certify that in accordance with rule 13.1, the above named Contract Works the Defects Liability Period has ended, all deferred work has been completed and all defects have been corrected

The issuing of this certificate does not affect the Contractor's liability to fulfil any obligation in the Contract which remains unperformed or not properly performed.

The Principal has used all reasonable care and skill in the preparation of this Certificate

The certificate cannot be relied on for any other purpose.

Signed by/date:



24/2/14  
(Date signed)

For and behalf of EQR acting as agents for EQC

MS-SF0702

## CLM/2011/198599 - Construction Completion Inspection

## Scope Meeting Record - Property Details

<b>Claim Number</b>	CLM/2011/198599	<b>Hub Zone</b>	
<b>Contractor Name</b>	Ben Rees Builders	<b>Supervisor</b>	Geoff Newman
<b>Property Address</b>	18 HEATHGLEN AVENUE, PARKLANDS	<b>Main Contact Name</b>	CHRISTOPHER COLVILL
<b>Customer name</b>	CHRISTOPHER COLVILL	<b>Customer Email</b>	██████████
<b>Home Phone</b>	██████████	<b>Mobile Phone</b>	██████████
<b>Date Started</b>	11/11/2013 12:04:36 p.m.	<b>Date Completed</b>	11/11/2013 01:00:00 p.m.

## Description of Works

Grind, repoint and paint summer hill stone  
Cosmetic works internally

## Defects

None

## Deferred Works

Commercial clean

**This is to advise that the earthquake repair work performed under this contract has been reviewed and it has been agreed that works has been completed as per EQC Assessment, Approved EQR Scope and approved Variations, excluding any minor defects or omissions.**

Contractor Signature:

Ben Rees



11/11/2013

Name

Signature

Date

Owner/Agent Signature:

Chris Colvill



11/11/2013

Name

Signature

Date

MS-SF0702

**CLM/2011/198599 - Construction Completion Inspection**

Fletcher Construction Company Ltd - EQC

Geoff Newman



11/11/2013

Name

Signature

Date

MS-SF0509



## FINAL ACCOUNT AGREEMENT

CLAIM NUMBER:

2	0	1	1	1	9	8	5	9	9
---	---	---	---	---	---	---	---	---	---

**Property Address:** 18 Heathglen Ave **Date:** 12/11/2013  
 Parklands **Hub:** Pages Rd  
 CHRISTCHURCH **Contracts Supervisor:** Geoff Newman  
**Property Contact Name:** Christopher Colvill  
**Contractor Details:** Ben Rees Builders **Accreditation No:** EQRC1193  
**Contact details:** Ph. (1) 027405692 **Ph. (2)** \_\_\_\_\_  
 email \_\_\_\_\_

Original Contract Value	(Ex GST)	\$ <del>23,929.13</del> 22,639.16
Variation 1	(Ex GST)	\$ <del>1,201.76</del> 1,061.34
Final Contract Value	(Ex GST)	\$ <del>25,130.89</del> 23,700.50
Less Previous Payments	(Ex GST)	\$
GST Amount		\$ <del>3,769.63</del> 3,555.08
Amount for Final payment	(Including GST)	\$ <del>28,900.52</del> 27,255.58

We hereby confirm that this statement represents the full and Final Contract Value and amount outstanding for all matters relating to this subcontract.

Contract Start Date: 30/09/2013

Contract Finish Date: 08/11/2013

<b>Signature of Contractor:</b>	<b>Date:</b> 12/11/2013
Print Name	
<b>Signature of Contracts Supervisor:</b>	<b>Date:</b> 13/11/13
Print Name: G. Newman	13/11/13
<b>Signature of Quantity Surveyor:</b>	<b>Date:</b> 14/11/13
Print Name: James Longden	



MS-SF0409

EXEMPT BUILDING WORK  
FILE RECORD

CLAIM NUMBER:

2	0	1	1	1	9	8	5	9	9
---	---	---	---	---	---	---	---	---	---

THIS IS A RECORD OF THE DECISION TO COMPLETE EARTHQUAKE REPAIRS WITHOUT BUILDING CONSENT. THE WORKS DESCRIBED HAVE BEEN DETERMINED AS EXEMPT FROM THE NEED FOR BUILDING CONSENT.

PROPERTY ADDRESS: 18 HEATHGLEN AVENUE DATE 25 / 7 / 2013  
 PARKLANDS HUB NNB  
 PROPERTY CONTACT NAME: CHRISTOPHER COLVILL CONT. SUPERVISOR GEOFF NEWMAN

CONTACT DETAILS: PH.(1) [REDACTED] EMAIL: [REDACTED]  
 PH.(2) [REDACTED]

CONTRACTOR: BEN REES BUILDERS

SITE SUPERVISOR NAME: BEN REES

CONTACT DETAILS: PH. 027 405 6492 EMAIL: [reeso246@yahoo.co.nz](mailto:reeso246@yahoo.co.nz)

A brief description of the work is as follows (and as otherwise described within the body of the claim file);

Repair of all work undertaken as per EQC scope of works.
Cosmetic repairs internally
Grind + repoint mortar joints in brickwork.
Repair minor foundation cracks

Accordingly I have determined that this work is exempted under Schedule 1(.....)of the Building Act 2004

This assessment and record was completed by myself as an authorised agent of The Fletcher Construction Company Limited, acting under the delegated authority of the company to determine exempted work on behalf of the owner.

Provided to homeowner/agent Name)..... Date.....  
(provided to the property owner or his/her authorised agent on request only).

Note<sup>1</sup> The homeowners/agents authority to apply Exemption status is given in the Building Act 2004, Schedule 1, this exemption information is augmented by supplementary guidance issued by The Department of Building & Housing and by the relevant Councils (i.e. - CCC Form B390).

Note<sup>2</sup> Only work prescribed within Schedule 1(a- j) and (m & n)of the Building Act 2004 is recorded on this form.

Note<sup>3</sup> Work Exempted under Schedule 1(k) of the Building Act 2004 is not to be recorded on this form. Claimants should refer to the formal "Exemption from building consent" records of the relevant City or District Council. (viewing EQR Aconex File Recording System may assist).

Note<sup>4</sup> For background information refer to 'Your guide to the repair process (with Fletcher EQR)' the home owners information bulletin provided by EQR staff, usually the Community Liaison Officer, just prior to or at the time of the scoping of the works.

Note<sup>5</sup> This record applies to earthquake damaged residential buildings in the Canterbury Region following earthquake events of 2010/2011.

Note<sup>6</sup> Building remediation work for the majority of Fletcher EQR projects is completed by Licensed Building Practitioners (LBP's)

Note<sup>7</sup> This record will usually be completed by the Contracts Supervisor, but may be completed by his/her immediate (Hub) Works Manager.

Note<sup>8</sup> This record is held in the Fletcher EQR Aconex File Recording System (an online information management system).

## FILING AN EXEMPT BUILDING WORK RECORD EXPLANATORY NOTE

Every EQR project is required to comply with both the Building Act (2004) and its Regulation (1992).

Building work usually entails the issuing of a building consent to the property owner or their authorised agent. On completion of the work the local or district Council 'signs off' that work and issues a Code Compliance Certificate (a CCC) confirming compliance with the Building Act. The Council is also compelled to hold that information on its property files. This record is heavily relied on for its completeness at the time that properties change hands.

It's estimated that 90%<sup>1</sup> of Fletcher EQR Projects won't need a Building Consent because they're exempted under criteria set in the first Schedule of the Building Act. The majority<sup>2</sup> of all exempted work may be completed "as of right", no Council approval is required (the exception is Schedule 1 Item [K] of the Act).

This creates a unique situation and potential problem for homeowners as Fletcher EQR customers.

The issue is that the Exemption process has no requirement to create file records of the sort that Councils keep on individual property files. The property file is used to detail "all that the Council knows" when a LIM<sup>3</sup> is requested. A LIM<sup>4</sup> can be requested by anyone, it's most commonly sought by a potential buyer at the time of a possible sale.

In the EQR 'Homeowners Guide' (p2, 'Building Consent Issues') we have specifically discussed the issue of Consents and exemptions. We have undertaken to act as agent in making Consent or Exemption decisions. We have also undertaken to assist with documentation and to make available that record if the homeowner wishes. The record is supplied for the homeowner's personal file but they may choose to lodge it as a formal record with their Council.

For consistency and ease of process we will use the 'Exempt Building Work' form. This should be completed by the Contracts SuperSupervisor at (or about) the time of the scoping exercise as this will usually be the point at which a decision about the need for a consent is made (if the form is not completed then, there's a risk it will be overlooked).

This 'adequacy of file records' is an unfamiliar issue for homeowners, few will understand the significance of the availability of suitable documentation and the importance of filing that information with their respective Councils.

This EQ event is unprecedented and purchaser's legal representatives will be looking for a form of documentation related to repair works. We are assisting Homeowners by anticipating their requests, be they current or future by consistently completing the 'Exempt Building Work' File Record. It must be filed in the Aconex filing system.

When completing the form, the majority of EQR work (99.9%) will fall within the Schedule 1(a) category, it becomes 1(k) only when Council approval has been asked for and given.

---

**Note**<sup>1</sup>this stems from the current estimate' that somewhere between 10 – 12% of all EQR works will require a Building Consent

**Note**<sup>2</sup>Work prescribed within Schedule 1(a- j) and (m & n) of the Building Act 2004. Schedule 1(k) requires Councils (discretionary) approval.

**Note**<sup>3</sup>When each house is transacted, a Land Information Memoranda (a LIM), will be requested by the purchaser's lawyer as a standard part of the conveyance procedure. The LIM records all works completed under a Building Consent (and any item 'K' Exemption where applicable) as well as a myriad of other information relevant to that property. The LIM uptake in Canterbury is one of the highest in New Zealand.

**Note**<sup>4</sup>The gaining of a LIM to facilitate a property transaction is driven by LGOIMA, this stands for – 'Local Government Official Information and Meetings Act 1987 No 174 (as at 01 November 2010), Public Act'. S4 (a) requires Councils "to provide for the availability to the public of official information held by local authorities"...4 (b) "to provide for proper access by each person to official information relating to that person". This Act compels the authorities to disclose "what's known" about a property.

# LAND DOCUMENTS

The following information contains documents relating to the land assessments that were either cash settled or declined:

*The attached land document(s) help NHC Toka Tū Ake identify information that may be relevant to its assessment of your residential land claims. They are not intended to form a complete technical report on land damage to your land. The land information, including valuations, repair costs and estimates, do not necessarily reflect the final land settlement received*

STEPHANIE NG  
18 HEATHGLEN AVENUE  
PARKLANDS  
CHRISTCHURCH

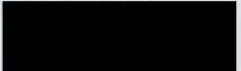

TODD NICCOL 7150  
19/3/13

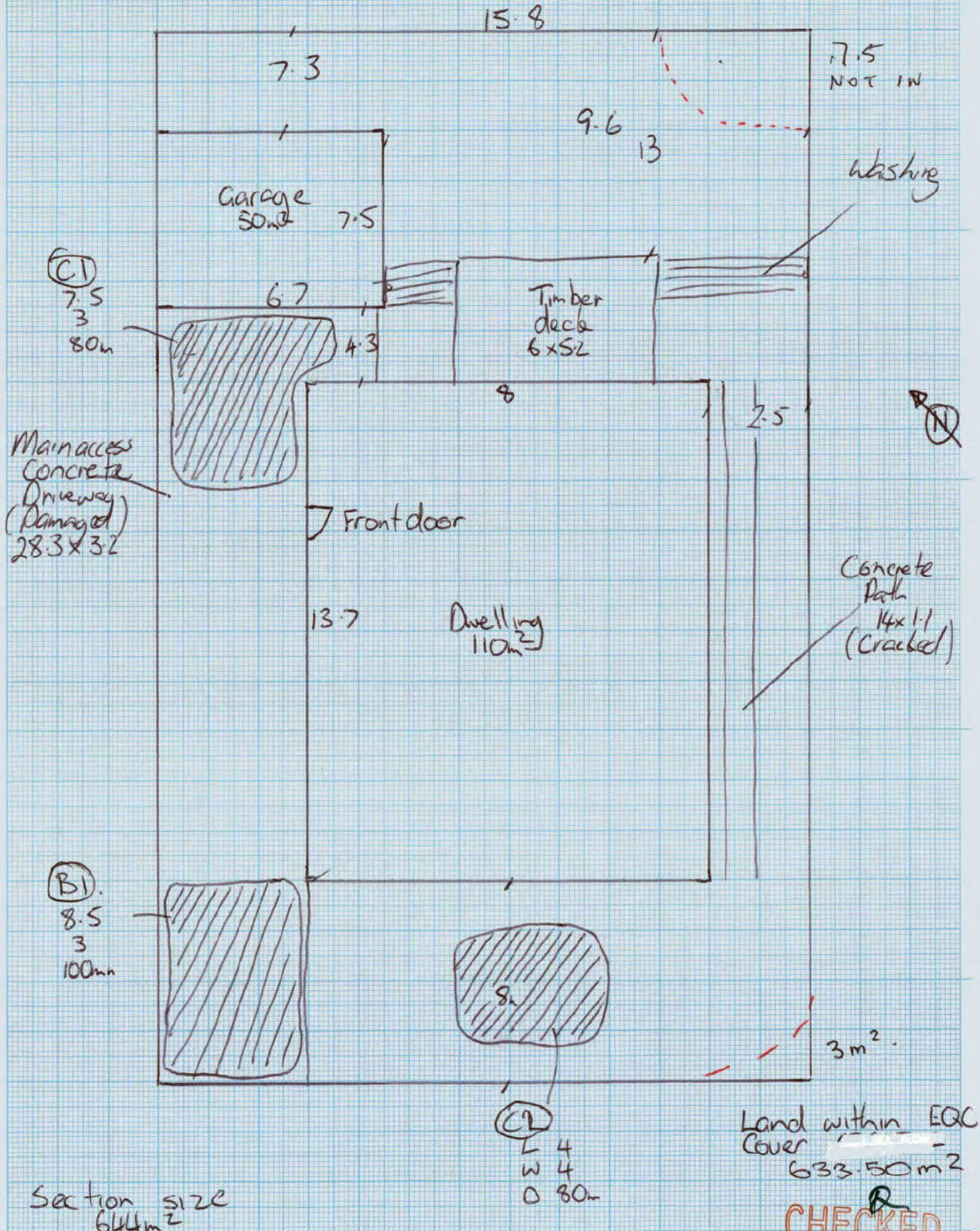



**EARTHQUAKE COMMISSION**  
Kōmihana Rūwhenua

# Land Assessment – Legend Sheet Complex Flat Land Claims

Claim N°: 2011/024212

Claimant: STEPHANIE NG.

Date: 19/03/13

Situation of Loss: 18 HEATHGLEN AVE PARKLANDS

Author: BERT AH MU

Item N°	Description/Construction	Length	Height/Width	Depth	Damage	Damaged Area	Evacuated m <sup>2</sup>	Inundated m <sup>2</sup>	Debris m <sup>3</sup>	Access	
										E	D
B1	ACCESS WAY CONCRETE DRIVE.	8.5	3.0	100mm	UNDULATING	25.50	25.50				E
C1	CONCRETE DR.	7.5	3.0	80mm	UNDULATING	22.50	22.50				R
C2	LAWN.	4.0	4.0	80mm	UNDULATING	16.00	16.00				E



CLM / 2011 / 024212  
STEPHANIE NG  
18 HEATHGLEN AVENUE  
PARKLANDS  
CHRISTCHURCH

64.50m<sup>2</sup>

CHECKED

# Inspection Summary

Completed by: BERT AH MU.

Date: 19/03/13 Page: 1 of 1  
dd / mm / yy



CLM / 2011 / 024212  
STEPHANIE NG  
18 HEATHGLEN AVENUE  
PARKLANDS  
CHRISTCHURCH

Time arrived at site: 8:00 Time left site: 8:40 Was an inspection carried out? Yes  No

Customer present: Yes  No  Customer Name: STEPHANIE NG.

Access denied  Loose dogs  Other  If other, please provide reason

If No inspection carried out, why not?

**Where an inspection has been conducted:**

	Yes	No	Notes
- Any land damage under the main access way or other hard surfaces?	<input checked="" type="checkbox"/>	<input type="checkbox"/>	<u>CONCRETE DRIVE</u>
- Were any bridges or culverts damaged within EQC Cover?	<input type="checkbox"/>	<input checked="" type="checkbox"/>	
- Were any retaining walls damaged within EQC Cover?	<input type="checkbox"/>	<input checked="" type="checkbox"/>	
- Is an engineer required?	<input type="checkbox"/>	<input checked="" type="checkbox"/>	
- Is a valuation required?	<input type="checkbox"/>	<input checked="" type="checkbox"/>	
- Is a resource consent required for any remediation work? (proximity to protected trees and waterways)	<input type="checkbox"/>	<input checked="" type="checkbox"/>	
- Has anything in this pack been escalated?	<input type="checkbox"/>	<input checked="" type="checkbox"/>	
- Customer has advised of invoices for emergency work?	<input type="checkbox"/>	<input checked="" type="checkbox"/>	
- Customer advised of next action?	<input checked="" type="checkbox"/>	<input type="checkbox"/>	
- Was any silt found under the dwelling?	<input type="checkbox"/>	<input checked="" type="checkbox"/>	<u>RAISED FLOOR FLE.</u>
- If there was nil damage, why was that?	Building removed <input type="checkbox"/> Building repairs have fixed <input type="checkbox"/> No visible damage <input type="checkbox"/>		
- If a potential or actual 8/9 property, was the dwelling present?	Building removed <input type="checkbox"/> Building present <input type="checkbox"/>		

Land Damage to Area A? If Yes, add details

Yes  No

Land Damage to Area B? If Yes, add details

Yes  No  B1 REFER TO LEGEND.

Land Damage to Area C? If Yes, add details

Yes  No  C1 & C2 Refer to Legend

Total m<sup>2</sup> of Damaged Land: 64 m<sup>2</sup>

Notional Land Damage Value @\$300/m<sup>2</sup> (Incl GST): \$19,200.

Next action

REFER TO SETTLEMENT

R  
**CHECKED**



# Scope of Works

Completed by: BERT A.H. MUDate: 17/03/13 - Page: 1 of 1

dd / mm / yy

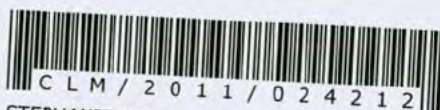
 STEPHANIE NG  
 18 HEATHGLEN AVENUE  
 PARKLANDS  
 CHRISTCHURCH
Description: **Damage to Land**

Repair Strategy: Removal and/or import materials and labour to repair land

64.0 m<sup>2</sup>

Description - Removal of Debris/Minor Works	Units	Length	Breadth	Depth	Quantity	Rate	Cost
Transporter- machine	each					\$160	
Machine Hire	hrs					\$110	
Truck Hire	hrs					\$100	
Labour	hrs					\$45	
Contaminated Spoil Removal	m <sup>3</sup>					\$100	
Spoil Removal/Tip Fees (clean)	m <sup>3</sup>					\$20	
Skip (4m <sup>3</sup> )	each					\$190	
Materials	each						

 NB A Small/Minor Works cost may only be applied when there is only land repair to the site/property; a total area of damage under 15m<sup>2</sup>; no further works required

Description - Supply and level hard fill	Units	Length	Breadth	Depth	Quantity	Rate	Cost
Land Under Residential Buildings (Type 'A') - Supply and level hard fill	m <sup>2</sup>					\$12	
Land Under Access way <b>B1</b> (Type 'B') - Supply and level hard fill	m <sup>2</sup>	8.5	3.0	100mm	25.50	\$12	306.00
Land Under Pavers/Patio/Concrete <b>C1</b> (Type 'C') - Supply and level hard fill	m <sup>2</sup>	7.5	3.0	80mm	22.50	\$12	270.00
Land Under Lawn Areas <b>C2</b> (Type 'C') - Level and Seed	m <sup>2</sup>	4.0	4.0	80mm	16.00	\$10	160.00
Lateral Spread Cracks under 10mm but greater than 5mm	Lm					\$25	
Lateral Spread Cracks greater than 10mm	Lm					\$90	

\* Unit categories to be used as follows:

Each, Sheet, Kilogram, Linear metre, Square metre, Cubic metre, Per hour, Per day, Per week.

Cubic metre calculations must include length, breadth and depth figures.

Square metre calculations must include length and breadth figures.

Sub-total

736.00

P&amp;G, Margin &amp; GST (Figure x 1.3662)

269.52

Total

1,005.52

 CHECKED  
 17.03.2013

DG 18/8/11



1147516 2011 CHCH EQ - LAND ENGINEERING REPORT

EQC Claim Number:	New: 201 / Old: 201 /	Significant Risk to Safety:	YES <input type="radio"/> NO <input checked="" type="radio"/>
Claimant Name:		Engineer's Names:	J. Power E. Nelidova
Claimants Address:	18 Heathglen Ave Parklands	Engineers E-mail:	NOT REQ'D
		Date:	2/8 /2011 Team no: 24

Was an EQC Engineering Land Assessment undertaken following the Darfield Earthquake (4 September 2010) and prior to 22 February 2011:

YES NO

GENERAL				
Type of Damage	Earthquake	Landslip	Storm/Flood	Other
EQC Priority of claims	1 - Home/Land seriously damaged and uninhabitable		2 - Home/Land seriously damaged but habitable	
	3 - Home/Land moderately damaged & Habitables		4 - All other damage	
Is this natural Disaster Damage?	YES	NO		
Is there an Imminent Risk of Loss?	YES	NO	(If 'YES' - Fill in Summary Information Table and Imminent Loss Checklist)	

INSPECTION DATA & DISCUSSION WITH CLAIMANT(S)				
Discussion with Claimant/Occupier?	YES	NO		
What happened? Claimant's story	Not home. Concrete drive is cracked in multiple areas, cracks from 2mm - 50mm. 50mm crack is between concrete drive & garage slab			

SITE DESCRIPTION (Refer Site Plan and/or Cross Section)	
General:	Cracks in brickwork & footings of house. Paths/patio cracked and moved.

LAND - (DAMAGED ACCESS, LAND, & DESTROYED LAND, & RETAINING WALLS, BRIDGES, CULVERTS)

LIQUEFACTION/Flat land damage	None	Sand boils	Lateral spreading	Settlement	Remediation Rqd (TBC in office)		
					Yes	No	Notes
Land damage observed:							
(i) Lateral Spreading	Not Observed	Spreading <100mm over property Spreading >100mm over property	Tilt > 5 degrees Vertical offset > 50 mm			✓	
(ii) Crust Thinning (TBC in office)							
(iii) Cracks	Not Observed	Distribution: Crack Width: Resulting from:	Single crack >100mm <100mm <5mm Lateral spreading	Multiple cracks >100mm <100mm <5mm Liquefaction		✓	
(iv) Undulating land	Not Observed	Lawn: > 50 mm high Lawn < 50 mm high	Lawn steeper than 1 in 20 slope Lawn shallower than 1 in 20 slope	Patio/Paths >10 mm high Patio/Paths <10 mm high	Ground oscillation Patio/Paths steeper than 1 in 100 Patio/Paths shallower than 1 in 100	✓	✓
(v) Flood risk (TBC in office)		Above 50yfl pre 4 Sept Below 50yfl pre 4 Sept	Above 50yfl pre 22 Feb Below 50yfl pre 22 Feb	Above 50yfl post 22 Feb Below 50yfl post 22 Feb	No Increased Flood Risk Increased Flood Risk		
(vi) Local Ponding	Not Observed	Observed within EQC covered land				✓	
(vii) Localised settlement causing drainage issues	Not Observed	Property no longer draining to road/public services					
(viii) New Groundwater Springs	Not Observed	Observed				✓	
(ix) Inundation of land with sand to silt	Not Observed	Observed	Already Removed			✓	

Refer to the Potential Remedial Works page of this report

**LAND - (DAMAGED ACCESS, LAND, & DESTROYED LAND, & RETAINING WALLS, BRIDGES, CULVERTS ) Continued**

LIQUEFACTION/Flat land damage comments:

OTHER Flat land damage	<u>None</u>	Settlement resulting from:	Ground Oscillation	
			Consolidation of fill	
	Other (specify) .....			

**LANDSLIDE/SLOPING LAND & RETAINING WALL DAMAGE** None      Landslip      Rockfall      Retaining wall damage      Other

					Imminent risk (Y/N)	Remediation (TBC in office)
Geological situation (fill/loess/bedrock etc):						Refer to the Potential Remedial Works page of this report
Groundwater situation (seepage/runoff etc):						
Landslip:	Tension Cracks	Toe-bulge	Erosion	Surface slump		
	Rotational Slip	Translational Slip	Ridge-venting	Other.....		
Description:						
Rockfall:	Source:	Upslope	Within property boundary			
		Downslope	Beyond property boundary			
Description:						
Are multiple properties affected:	Yes	No				
If Yes, list affected properties:	.....					

Comments:

**RETAINING WALL DAMAGE**

					Imminent risk (Y/N)	Remediation (TBC in office)
Retaining wall damaged?	<u>None</u>	No. of walls damaged .....				Refer to the Potential Remedial Works page of this report
Description:						
Type of damage to retaining wall(s) :	Cracks	Rotated/leaning	Slid	Bulging		
	Settlement					
Location of retaining wall(s) :	Within 8m of building	Within 60m & needed to protect of land within 8m of accessway/building				
	Other					
Are multiple properties affected:	Yes	No				
If Yes, list affected properties:	.....					

Comments:

compare with # 20

EQC Claim Number: 201 /

**LAND - (DAMAGED ACCESS, LAND, & DESTROYED LAND, & RETAINING WALLS, BRIDGES, CULVERTS ) Continued**

**LAND DAMAGE AREAS** (see table on page 6 for more details)

Areas of land Damage	Entire Site	<u>Portion of Site</u>	None
Land beneath Main access way damaged?	<u>No-N/A</u>	Within 60m of building	Other.....

**PRELIMINARY LAND REMEDIAL OPTION & COST (Refer Site Plan and Cross Section)**

Land Remedial option	Drainage	Retaining Wall	Palisade Wall	Soil Nail/Rock Bolt	<u>Earthworks</u>
	Debris Wall/Catch Fence	Remove rock hazard	Other	Combination of Above	None
Estimated Land Remedial Cost	<u>TBC - (To be confirmed by Cost Estimator)</u>				

**DWELLING DESCRIPTION (Refer Site Plan and Cross Section)**

General : (eg. Single level, roof type, foundations, cladding etc)	<i>2 storey, lower level, brick veneer, tin roof on piles with concrete footing. 2nd level, weatherboard clad. Separate garage, concrete block, tin roof on slabs.</i>
---	--

**BUILDING DAMAGE - GENERAL**

Has the building been Damaged?	<u>YES</u>	NO
Is the Dwelling at Imminent Risk?	YES	<u>NO</u>
Estimated Remedial Value?	<u>TBC - (To be confirmed by Cost Estimator)</u> <i>Garage</i>	
Have any Appurtenant structures been damaged?	<u>YES</u>	NO
Are any appurtenant structures at Imminent Risk?	YES	<u>NO</u> (Does not include Patios/Paving)
Have any services within 60 m of dwelling been damaged?	<u>YES</u>	NO
Are any services within 60 m of dwelling at Imminent Risk?	YES	<u>NO</u>

**DAMAGED DWELLING, APPURTENANT STRUCTURES, & SERVICES (Refer Site Plan and Cross Section)**

Dwelling : features damaged :	None	<u>External walls</u>	Internal walls	Ceiling	<u>Door/window frames</u>
	Window glass	<u>Steps</u>	<u>Foundation/slab</u>	Roof	Chimney
	Other: .....				







Type of damage to Dwelling:	<u>Cracks (walls)</u>	Cracks (ceiling)	Cracks (window glass)	Cracks (chimney)	Floor sloping
	<u>Racking/sagging</u>	Walls etc out of vertical	Crack in slab	<u>Crack in footing</u>	Other: .....

Appurtenant structure(s) damaged :	None	<u>Garage/shed</u>	Carport	Deck	Other: .....
------------------------------------	------	--------------------	---------	------	--------------

What services have been damaged?	Water	Sewer	Drainage	Gas	Electrical
	Telephone	Service structures	<u>Don't Know</u>	Other: .....	None

**GENERAL :**

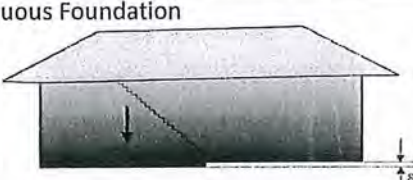
Floors and Foundations	Roof Cladding	Wall Cladding
Timber floor on piles	Light: Iron roof	Light: weatherboard/plywood/stucco etc <i>2nd level</i>
Timber on internal piles with perimeter concrete footing <i>House</i>	Heavy: concrete tiles/clay tiles/slate etc	heavy: brick veneer/stone/solid plaster <i>Lower level</i>
Concrete slab on grade <i>Garage</i>		

Damage to Dwelling predominantly from:	Shaking		Land damage	
	Severity			
	Minor	Moderate	Major	
<b>Stretching</b> 	X	0 to 5mm	5 to 30mm	>30mm
<b>Hogging</b> 	X	0 to 20mm	20 to 50mm	>50mm
<b>Dishing</b> 	X	0 to 20mm	20 to 50mm	>50mm
<b>Racking/Twisting</b> 		0 to 10mm	10 to 30mm	>30mm
<b>Tilting</b> 	X	0 to 20mm	20 to 50mm	>50mm
<b>Discontinuous Foundation</b> 	X	0 to 10mm	10 to 20mm	>20mm
<b>Global Settlement</b> 	X	0 to 50mm	50 to 100mm	>100mm

### Potential Remedial Works

The works described below are to repair or protect insured land (i.e. within the property boundary, on or supporting the main access within 60m of the dwelling, or within 8m of a residential building) and the structure(s) that has/have been damaged or is/are at imminent risk as a direct result of the natural disaster that has occurred.

A solution that reinstates the damaged land and removes the imminent risk threat would comprise the following works:

- ~~Underpinning beneath concrete drive.~~
- Underpinning land repair is required below the dwelling and access way. *Repairing, rebuilding or releveling the dwelling and driveway may remove the requirement for*
- *undertaking repairs to the land damaged beneath the*
- *accessway and dwelling*

Additional information for cost estimation:

<u>Construction Issues</u>	<u>Easy</u>	<u>Moderate</u>	<u>Hard</u>	<u>N/A</u>
• Construction Access	✓			
• Drilling				✓
• Reinstatement		✓		





This preliminary design is for the purposes of costing for the claim settlement process only, it is not for construction. There may be a solution that is more cost effective and/or appropriate. Even if this concept is considered to be appropriate, further subsurface investigation, detailed design and consenting may be required prior to construction.

We estimate the cost (excluding GST) to construct the proposed solution will be as follows:

Engineering investigation, design and drawings	\$
Construction Observations and PS4	\$
Survey (if required)	\$
Building/Resource consents (if required)	\$
Project Management	\$
Construction of .....(as detailed above)	
(Cost to be determined by cost estimator)	\$ TBC
<hr/>	
TOTAL non construction Costs (Excluding GST)	\$

The total construction cost estimates should be confirmed by a contractor or estimator.

**Preliminary Summary Information (all costs excl GST)**

Is this Natural Disaster damage?	Yes
<b>Land within 8m of dwelling or appurtenant structures</b>	
Area of Land damaged Evacuated: Inundated:	4/6m <sup>2</sup>
Area of Land at imminent risk Evacuation: Inundation:	
<b>Main access way within 60m of dwelling (or an appurtenant structure)</b>	
Area of Land damaged on accessway or supporting accessway: Evacuated: Inundated:	
Additional Area of Land at imminent risk on accessway or supporting accessway: Evacuation: Inundation:	
<b>Retaining Walls within 8m of Dwelling or Appurtenant Structure</b>	
Description.....(list and describe each affected wall)..... Damaged: (face area - m2); At imminent risk: (face area - m2);	
<b>Dwelling &amp; Appurtenant Structures</b>	
Has dwelling or appurtenant structure been damaged as a result of the natural disaster? Description..... <i>Shaking Damage</i> .....	Yes
Cost to repair damage:	TBC
Is dwelling (or appurtenant structure) at imminent risk as a result of the natural disaster: Description.....	
Cost to remove imminent loss threat to dwelling (or appurtenant structure):	TBC
Value of imminent risk damage to dwelling (or appurtenant structures) :	
<b>Services within 60m of Dwelling or Appurtenant Structure</b>	
Services damaged (list) Services at imminent risk (list)	<i>Don't know</i>
Remedial Option: <i>Earthworks</i> Description.....	TBC (excluding GST)

TBC – To be calculated & confirmed by cost estimator

Heathglen Avenue  
85020300  
611 m<sup>2</sup>

22 Heathglen Avenue  
2185022200  
644 m<sup>2</sup>

23 Ingrid Street  
2185023104  
715 m<sup>2</sup>

20 Heathglen Avenue  
2185022100  
643 m<sup>2</sup>

21 Ingrid Street  
2185023105  
631 m<sup>2</sup>

18 Heathglen Avenue  
2185022000  
644 m<sup>2</sup>

19 Ingrid Street  
2185023106  
649 m<sup>2</sup>

16 Heathglen Avenue  
2185021900  
643 m<sup>2</sup>

14 Heathglen Avenue  
2185021800  
643 m<sup>2</sup>

Lot 15 DP 34107

Portion of site  
new driveway

20-25 mm gap

= 60 mm ÷ 70 mm crack

step cracks

Portion of site

new concrete patio

new fence

Notes:

A4 SCALE 1:250

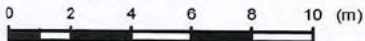

Drawn by: E. Nelidova  
Date: 2-08-2011



22 FEB 2011 - EARTHQUAKE  
PARKLANDS, CHRISTCHURCH  
(C113-064565) - 18 Heathglen Avenue

EQC Claim No: 201 \_ /