

# GRIFFIOEN.

## EQC CLAIM DOCUMENTATION

Statement of Passing Over: This documentation has been supplied to us by the Earthquake Commission under the Official Information Act. GRIFFIOEN. (Powered by Ownly Limited, Licensed REAA 2008) is merely passing over this information as supplied to us.

We cannot guarantee its accuracy as we have not checked, audited, or reviewed the information and all intending purchasers are advised to seek your own advice as to the information contained in this document.

To the maximum extent permitted by law we do not accept any responsibility to any party for the accuracy or use of the information herein.

# CASH SETTLED CLAIM(S)

The following information contains documents relating to claim(s) that were cash settled for the property.

If you require sign off or repair completion documents, they may be obtainable from the contractors who completed the substantive repairs at the property.

# Scope of Works



## Document explanatory note:

This document provides a summary of the earthquake damage identified by the EQC assessment team. Land, building and room by room damage is listed along with an indication of how this damage is to be repaired. A glossary of terms describing the type of damage that may be listed on your Scope of Works is provided at the end of this document.

**Customer:** G DITFORT

## Assessment of Property at 20 ROBIN STREET, BURWOOD, CHRISTCHURCH 8083 on 1/08/2011

### Site

Element	Damage	Repair
Land (Exposed - Soil - 607.00 m2)		

### Services

Element	Damage	Repair
Sewerage (Town Connection - Clay pipes - 5.00 l/m)	No Earthquake Damage	
Water Supply (Town Connection - Steel - 5.00 l/m)	No Earthquake Damage	

## Main Building

### Exterior

#### Elevation (North)

Element	Damage	Repair
No Damage		

#### Elevation (South)

Element	Damage	Repair
No Damage		

#### Elevation (East)

Element	Damage	Repair
No Damage		

#### Elevation (West)

Element	Damage	Repair
No Damage		

### Foundations

Element	Damage	Repair
Piles (Ordinary - Concrete - 1.00 item)	No Earthquake Damage	
Ring foundation (Load bearing - Concrete - 44.00 l/m)	Cracks to ring foundation	Grind out and epoxy fill cracks 2.00 l/m
	Cracks to ring foundation	Solid Plaster Repair 7.20 m2

### Roof

Element	Damage	Repair
No Damage		

**Interior****Ground Floor - Office/Study**Room Size: 3.30 x 3.60 = 11.88 (length(m) x width(m) = Area Size(m<sup>2</sup>))

Stud Height: 2.40 m

Element	Damage	Repair	
Ceiling (Softboard - Paint - 11.88 m <sup>2</sup> )	Cosmetic Damage	Paint Ceiling	11.88 m <sup>2</sup>
Floor (T&G - Carpet - 11.88 m <sup>2</sup> )	No Earthquake Damage		
Wall covering (Gib - Paint - 33.12 m <sup>2</sup> )	Cosmetic damage	Rake out, plaster and paint	33.12 m <sup>2</sup>

**Ground Floor - Lounge**Room Size: 4.80 x 4.20 = 20.16 (length(m) x width(m) = Area Size(m<sup>2</sup>))

Stud Height: 2.40 m

Element	Damage	Repair	
Ceiling (Softboard - Paint - 20.16 m <sup>2</sup> )	Cosmetic Damage	Gap fill and paint	20.16 m <sup>2</sup>
Door (Internal) (Single Hollow Core - Timber - 1.00 No of)	No Earthquake Damage		
Floor (T&G - Carpet - 20.16 m <sup>2</sup> )	No Earthquake Damage		
Wall covering (Gib - Paint - 43.20 m <sup>2</sup> )	Cosmetic damage	Rake out, plaster and paint	43.20 m <sup>2</sup>
Window (Timber medium - Pane single glazed - 1.00 No of)	No Earthquake Damage		

**Ground Floor - Hallway**Room Size: 1.20 x 4.60 = 5.52 (length(m) x width(m) = Area Size(m<sup>2</sup>))

Stud Height: 2.40 m

Element	Damage	Repair	
Ceiling (Gib - Paint - 5.52 m <sup>2</sup> )	Cosmetic Damage	Gap fill and paint	5.52 m <sup>2</sup>
Door (External) (Single solid Door - Timber - 1.00 item)	Cosmetic damage Structural damage	Gap fill and paint jambs / sills Supply and fit single door	6.00 l/m 1.00 No of
Floor (T&G - Carpet - 5.52 m <sup>2</sup> )	No Earthquake Damage		
Trim ( - - .00 l/m)			
Trim (Rimu - Trim 60mm - 5.00 l/m)	Removal required for other repair	Supply Replace Trim	5.00 l/m
Wall covering (Gib - Paint - 27.84 m <sup>2</sup> )	Cosmetic damage	Rake out, plaster and paint	27.84 m <sup>2</sup>

**Ground Floor - Bedroom (South west)**Room Size: 3.00 x 4.10 = 12.30 (length(m) x width(m) = Area Size(m<sup>2</sup>))

Stud Height: 2.40 m

Element	Damage	Repair	
Ceiling (Gib - Stipple - 12.30 m <sup>2</sup> )	Cosmetic Damage	Scrape off, rake out, fill, restipple	12.30 m <sup>2</sup>
	Cosmetic Damage	Paint Ceiling	12.30 m <sup>2</sup>
Door (Internal) (Single Hollow Core - Timber - 1.00 No of)	No Earthquake Damage		
Floor (T&G - Carpet - 12.30 m <sup>2</sup> )	No Earthquake Damage		
Wall covering (Gib - Paint - 34.08 m <sup>2</sup> )	Cosmetic damage	Rake out, plaster and paint	34.08 m <sup>2</sup>
Window (Timber medium - Pane single glazed - 1.00 No of)	No Earthquake Damage		

**Ground Floor - Bedroom (East)**Room Size: 3.30 x 3.70 = 12.21 (length(m) x width(m) = Area Size(m<sup>2</sup>))

Stud Height: 2.40 m

Element	Damage	Repair	
Ceiling (Softboard - Paint - 12.21 m <sup>2</sup> )	Cosmetic Damage	Gap fill and paint	12.21 m <sup>2</sup>

Door (Internal) (Single Hollow Core - Timber No Earthquake Damage  
- 1.00 No of)

Floor (T&G - Carpet - 12.21 m2) No Earthquake Damage

Wall covering (Gib - Lining paper - 33.60 m2) Cosmetic damage Remove, dispose, hang and paint lining paper 33.60 m2

Window (Timber medium - Pane single glazed No Earthquake Damage  
- 1.00 No of)

#### Ground Floor - Bedroom (North east)

Room Size: 3.50 x 4.10 = 14.35 (length(m) x width(m) = Area Size(m2))

Stud Height: 2.40 m

Element	Damage	Repair	
Ceiling (Gib - Paint - 14.35 m2)	Cosmetic Damage	Rake out, plaster and paint	14.35 m2
Door (Internal) (Single Hollow Core - Timber - 1.00 No of)	No Earthquake Damage		
Floor (T&G - Carpet - 14.35 m2)	No Earthquake Damage		
Wall covering (Gib - Wallpaper - 36.48 m2)	Cosmetic damage	Remove, rake out, plaster, supply and replace wallpaper	36.48 m2
Window (Timber medium - Pane single glazed - 2.00 No of)	No Earthquake Damage		

#### Ground Floor - Porch

Room Size: 1.90 x 0.90 = 1.71 (length(m) x width(m) = Area Size(m2))

Stud Height: 2.40 m

Element	Damage	Repair	
No Damage			

#### Ground Floor - Laundry

Room Size: 3.00 x 1.90 = 5.70 (length(m) x width(m) = Area Size(m2))

Stud Height: 2.40 m

Element	Damage	Repair	
No Damage			

#### Ground Floor - Kitchen

Room Size: 5.40 x 3.00 = 16.20 (length(m) x width(m) = Area Size(m2))

Stud Height: 2.40 m

Element	Damage	Repair	
No Damage			

#### Ground Floor - Toilet

Room Size: 2.00 x 0.90 = 1.80 (length(m) x width(m) = Area Size(m2))

Stud Height: 2.40 m

Element	Damage	Repair	
No Damage			

#### Ground Floor - Bathroom

Room Size: 2.00 x 1.60 = 3.20 (length(m) x width(m) = Area Size(m2))

Stud Height: 2.40 m

Element	Damage	Repair	
No Damage			

**External garage****Exterior****Elevation (North)**

Element	Damage	Repair
---------	--------	--------

No Damage

**Elevation (South)**

Element	Damage	Repair
---------	--------	--------

No Damage

**Elevation (East)**

Element	Damage	Repair
---------	--------	--------

No Damage

**Elevation (West)**

Element	Damage	Repair
---------	--------	--------

No Damage

**Foundations**

Element	Damage	Repair
---------	--------	--------

No Damage

**Roof**

Element	Damage	Repair
---------	--------	--------

No Damage

**Interior****Ground Floor - Internal Garage**Room Size: 4.00 x 6.00 = 24.00 (length(m) x width(m) = Area Size(m<sup>2</sup>))

Stud Height: 2.20 m

Element	Damage	Repair
---------	--------	--------

No Damage

**Scope of Works - Glossary of Terms**

<b>Cosmetic Damage</b>	Cosmetic damage is used to record repairs to an element that can be done in situ e.g. minor cracking to plasterboard. For example a repair strategy may state "rake, stop and paint" and this is carried out without needing to remove or replace the damaged element. Where the plasterboard for example needs to be removed and replaced, this will be recorded as 'structural damage'.
<b>Impact Damage</b>	Impact damage is where an element or part of a building sustains earthquake damage and then breaks away or collapses causing damage to another part of the building. An example is a chimney that has collapsed and caused damage to roof tiles.
<b>Structural Damage</b>	The term structural damage is used where a repair requires an element to be removed and replaced e.g. major cracking to plasterboard or external cladding that has been dislodged. This term does not relate to the structural integrity of the building as a whole, but to the individual element only.

**Additional Information**

<b>Building Terms</b>	The Department of Building and Housing website has a comprehensive list of common building terms: <a href="http://www.dbh.govt.nz/building-az-wxyz">http://www.dbh.govt.nz/building-az-wxyz</a>
-----------------------	---

## EQC Full Assessment Report

**Claim Number:** CLM/2011/105168  
**Claimant:** G DITFORT  
**Property Address:** 20 ROBIN STREET  
 BURWOOD  
 CHRISTCHURCH 8083

**Assessment Date:** 01/08/2011 15:08  
**Assessor:** godman, John  
**Estimator:** Payne, Ricky  
**Property Occupied By:** Owner Occupied

## Claimant Setup

Type	Name	Home Number	Mobile Number	Work Number	Email Address
Owner	G, DITFORT				
Owner	NATHDAN FAMILY TRUST				

## Insurance &amp; Mortgage Details

## Insurance Details - From Claim Centre

Insurer	Policy Type	Policy Number	Insurance Sighted	Insurance Valid
IAG - ASB Bank Insurance Scheme	Dwelling		Yes	

## Insurance Details - Added in COMET

Insurer	Policy Type	Policy Number	Insurance Sighted	Insurance Valid
---------	-------------	---------------	-------------------	-----------------

## Insurance Details - Comments

Policy renewal. 16/05. Premium paid monthly

## Mortgage Details - From Claim Centre

Bank
------

## Mortgage Details - Added in COMET

Bank
ANZ BANK LENDING SERVICES CENTRE

## Mortgage Details - Comments

## Opt Out

For repairs costing between \$10,000 and \$100,000 the claimant wishes to manage their own repairs? No

## Hazards

**Hazards:** Dog on property  
**Property Sticker:** No Sticker

## Building Configurations

Leaky Home Syndrome? No

Building Name	Number of floors	Building Finish	Age of house	Footprint	Area (m2)
Main Building	1	Standard	1935 - 1960	Rectangular	108.36
External garage	1	Standard	Post 1980	Rectangular	24.50

## Full Assessment

### Site

Element	Type	Material	Damages	Measure	Rate	Cost
Land	Exposed	Soil	No Earthquake Damage			

#### General Comments:

### Services

Element	Type	Material	Damages	Measure	Rate	Cost
Sewerage	Town Connection	Clay pipes	No Earthquake Damage			
Water Supply	Town Connection	Steel	No Earthquake Damage			

#### General Comments:

### Main Building

#### Exterior

##### Elevation (North)

<b>Damage:</b>	No damage
<b>Require Scaffolding?</b>	No
<b>General Comments:</b>	8x2.5 Timber weatherboard

##### Elevation (South)

<b>Damage:</b>	No damage
<b>Require Scaffolding?</b>	No
<b>General Comments:</b>	8x2.5 Timber weatherboard

##### Elevation (East)

<b>Damage:</b>	No damage
<b>Require Scaffolding?</b>	No
<b>General Comments:</b>	Timber weather board 14x2.5

##### Elevation (West)

<b>Damage:</b>	No damage
<b>Require Scaffolding?</b>	No
<b>General Comments:</b>	timber weatherboard 14x2.5

#### Foundations

<b>Damage:</b>	Earthquake damage
<b>Require Scaffolding?</b>	No

Element	Type	Material	Damages	Measure	Rate	Cost
Piles	Ordinary	Concrete	No Earthquake Damage			
Ring foundation	Load bearing	Concrete	Cracks to ring foundation			
			Grind out and epoxy fill cracks	2.00 l/m	30.00	60.00
			Cracks to ring foundation			
			Solid Plaster Repair	7.20 m2	85.00	612.00

#### General Comments:

#### Roof

<b>Damage:</b>	No damage
<b>Require Scaffolding?</b>	No
<b>General Comments:</b>	Concrete tile Timber frame

#### Ground Floor - Office/Study

<b>Damage:</b>	Earthquake damage
<b>Require Scaffolding?</b>	No

Element	Type	Material	Damages	Measure	Rate	Cost
Ceiling	Softboard	Paint	Cosmetic Damage			
			Paint Ceiling	11.88 m2	24.00	285.12
Floor	T&G	Carpet	No Earthquake Damage			
Wall covering	Gib	Paint	Cosmetic damage			
			Rake out, plaster and paint	33.12 m2	34.00	1,126.08

**General Comments:****Ground Floor - Lounge****Damage:** Earthquake damage**Require Scaffolding?** No

Element	Type	Material	Damages	Measure	Rate	Cost
Ceiling	Softboard	Paint	Cosmetic Damage			
			Gap fill and paint	20.16 m2	34.00	685.44
Door (Internal)	Single Hollow Core	Timber	No Earthquake Damage			
Floor	T&G	Carpet	No Earthquake Damage			
Wall covering	Gib	Paint	Cosmetic damage			
			Rake out, plaster and paint	43.20 m2	34.00	1,468.80
Window	Timber medium	Pane single glazed	No Earthquake Damage			

**General Comments:****Ground Floor - Hallway****Damage:** Earthquake damage**Require Scaffolding?** No

Element	Type	Material	Damages	Measure	Rate	Cost
Ceiling	Gib	Paint	Cosmetic Damage			
			Gap fill and paint	5.52 m2	34.00	187.68
Door (External)	Single solid Door	Timber	Cosmetic damage			
			Gap fill and paint jambs / sills	6.00 l/m	25.00	150.00
			Structural damage			
			Supply and fit single door	1.00 No of	1,170.00	1,170.00
Floor	T&G	Carpet	No Earthquake Damage			
Trim						
Trim	Rimu	Trim 60mm	Removal required for other repair			
			Supply Replace Trim	5.00 l/m	25.00	125.00
Wall covering	Gib	Paint	Cosmetic damage			
			Rake out, plaster and paint	27.84 m2	34.00	946.56

**General Comments:****Ground Floor - Bedroom (South west)****Damage:** Earthquake damage**Require Scaffolding?** No

Element	Type	Material	Damages	Measure	Rate	Cost
Ceiling	Gib	Stipple	Cosmetic Damage			
			Scrape off, rake out, fill, restipple	12.30 m2	50.00	615.00
			Cosmetic Damage			
			Paint Ceiling	12.30 m2	24.00	295.20
Door (Internal)	Single Hollow Core	Timber	No Earthquake Damage			
Floor	T&G	Carpet	No Earthquake Damage			
Wall covering	Gib	Paint	Cosmetic damage			
			Rake out, plaster and paint	34.08 m2	34.00	1,158.72
Window	Timber medium	Pane single glazed	No Earthquake Damage			

**General Comments:****Ground Floor - Bedroom (East)****Damage:** Earthquake damage

Require Scaffolding? No

Element	Type	Material	Damages	Measure	Rate	Cost
Ceiling	Softboard	Paint	Cosmetic Damage			
			Gap fill and paint	12.21 m2	34.00	415.14
Door (Internal)	Single Hollow Core	Timber	No Earthquake Damage			
Floor	T&G	Carpet	No Earthquake Damage			
Wall covering	Gib	Lining paper	Cosmetic damage			
			Remove, dispose, hang and paint lining paper	33.60 m2	55.00	1,848.00
Window	Timber medium	Pane single glazed	No Earthquake Damage			

**General Comments:****Ground Floor - Bedroom (North east)****Damage:** Earthquake damage**Require Scaffolding?** No

Element	Type	Material	Damages	Measure	Rate	Cost
Ceiling	Gib	Paint	Cosmetic Damage			
			Rake out, plaster and paint	14.35 m2	34.00	487.90
Door (Internal)	Single Hollow Core	Timber	No Earthquake Damage			
Floor	T&G	Carpet	No Earthquake Damage			
Wall covering	Gib	Wallpaper	Cosmetic damage			
			Remove, rake out, plaster, supply and replace wallpaper	36.48 m2	43.00	1,568.64
Window	Timber medium	Pane single glazed	No Earthquake Damage			

**General Comments:****Ground Floor - Porch****Damage:** No damage**Require Scaffolding?** No**General Comments:****Ground Floor - Laundry****Damage:** No damage**Require Scaffolding?** No**General Comments:** Ceiling- pinex  
Walls- hardboard  
Floor- t&g  
1x window**Ground Floor - Kitchen****Damage:** No damage**Require Scaffolding?** No**General Comments:** Ceiling- pinex  
Walls- hardboard  
Floor- vinyl  
2x windows**Ground Floor - Toilet****Damage:** No damage**Require Scaffolding?** No**General Comments:****Ground Floor - Bathroom****Damage:** No damage**Require Scaffolding?** No**General Comments:****External garage****Exterior****Elevation (North)****Damage:** No damage**Require Scaffolding?** No

**General Comments:** 6x2.2  
Veratile garage

**Elevation (South)**

**Damage:** No damage

**Require Scaffolding?** No

**General Comments:** 6x2.2  
Versatile garage

**Elevation (East)**

**Damage:** No damage

**Require Scaffolding?** No

**General Comments:** 4x2.2  
Versatile garage

**Elevation (West)**

**Damage:** No damage

**Require Scaffolding?** No

**General Comments:** 4x2.2  
Versatile garage

**Foundations**

**Damage:** No damage

**Require Scaffolding?** No

**General Comments:** Concrete slab 6.0x4.0

**Roof**

**Damage:** No damage

**Require Scaffolding?** No

**General Comments:** Iron cladding  
Timber framing

**Ground Floor - Internal Garage**

**Damage:** No damage

**Require Scaffolding?** No

**General Comments:** Versatile garage

**Fees**

**Fees**

<b>Name</b>	<b>Duration</b>	<b>Estimate</b>
Scaffold hire - Mobile single lift aluminium	2.00	300.00
Contents movement fee	1.00	531.44

**Overheads**

<b>Name</b>	<b>Estimate</b>
Preliminary and general	1,056.42
Margin	1,509.31
GST	2,490.37

## Scope Of Works Estimate

### Property

Description	Estimate
Site	0.00
Services	0.00
	0.00

### Main Building

Name	Description	Estimate
Exterior	Foundations	672.00
	Roof	0.00
	Elevation (East)	0.00
	Elevation (North)	0.00
	Elevation (South)	0.00
	Elevation (West)	0.00
		672.00

Floor	Description	Estimate
Ground Floor	Bathroom	0.00
	Bedroom (East)	2,263.14
	Bedroom (North east)	2,056.54
	Bedroom (South west)	2,068.92
	Hallway	2,579.24
	Kitchen	0.00
	Laundry	0.00
	Lounge	2,154.24
	Office/Study	1,411.20
	Porch	0.00
	Toilet	0.00

12,533.28

### External garage

Name	Description	Estimate
Exterior	Foundations	0.00
	Roof	0.00
	Elevation (East)	0.00
	Elevation (North)	0.00
	Elevation (South)	0.00
	Elevation (West)	0.00
		0.00

Floor	Description	Estimate
Ground Floor	Internal Garage	0.00
		0.00

0.00

### Fees

Description	Estimate
Scaffold hire - Mobile single lift aluminium	300.00
Contents movement fee	531.44
	831.44

**Overheads**

<b>Description</b>	<b>Estimate</b>
Preliminary and general	1,056.42
Margin	1,509.31
GST	2,490.37
<hr/>	5,056.11
<hr/>	
<b>Total Estimate</b>	19,092.83

**Inspection Sign Off**

Description	Answer	comments
<b>Contents Damage</b>		
Has the contents schedule been left with claimant?	No	
Have the contents been sighted?	No	
<b>Land Damage</b>		
Is there land damage?	No	
Landslip damage has been assessed on paper	No	
<b>Was a full inspection done?</b>		
In roof space	Yes	
On roof?	Yes	
Under sub floor?	Yes	
<b>Decline Claim</b>		
Recommend Declining Claim	No	
<b>Next Action:</b>		

**Previous Claim Numbers (recorded manually in field)**

- 2011/181039

**File Notes**

**Date Created:** 01/08/2011 17:52

**Created :** godman, John

**Subject:** Property overview

**Note:** This is an older ex state home, and rented by the same tenant for 8 or so years. Property in general is in need of maintenance internally and externally. Has minor internal cosmetic damage Buht in places, difficult to distinguish from general damage. tenant not keen for a thorough inspection externally. Dog made it less than attractive to try.

**Next Action:**

**Date Created:** 08/08/2011 22:03

**Created :** Administrator, Alchemy

**Subject:** COMET sent to EQR on 08/08/2011

**Note:** COMET sent to EQR on 08/08/2011

**Next Action:**

**Urgent Works Items**



APPROVED

## Statement of Claim Checklist / Repair Strategy

Date: 30/1/15

Author: DEREK LARSEN

  
 C L M / 2 0 1 5 / 0 0 0 1 8 1  
 SIMON JOHNSON  
 20 ROBIN STREET  
 BURWOOD  
 CHRISTCHURCH  
 H: & W:  
 M: 027 -322-0602  



LA: DEREK LARSEN

Estimator: DEAN AXAM

Room	Earthquake Damage	Walls	Ceiling	Floor	Repair Strategy
	Y/N	✓	✓	✓	
4.7 x 3.5 Lounge	N				
Dining Room	N				
5.40 x 2.4 Kitchen	N				
3.5 x 3.4 Family Room	N				
3.9 x 3.2 Bedroom 1		✓			0.6LM APPEARING CRACK BELOW WINDOW. THERMAL MOVEMENT. NO E.G. DAMAGE
Ensuite	N/A				
4.2 x 3.0 Bedroom 2	N				
4.0 x 3.5 Bedroom 3	N				

.....  
(Initials)

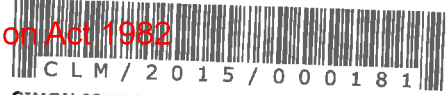
APPROVED



SIMON JOHNSON  
 20 ROBIN STREET  
 BURWOOD  
 CHRISTCHURCH  
 H: & W:  
 M: 027 -322-0602

Repair Strategy

Room	Earthquake Damage	Walls	Ceiling	Floor
	Y/N	✓	✓	✓
Bedroom 4	N/A			
2.0 x 1.5 Bathroom	N			
2.0 x 1.0 Toilet 1	N			
Toilet 2	N/A			
Office / Study	N/A			
Rumpus	N/A			
4.7 x 1.2 Entry / Hall(s)	N.			
Stairwell	N/A.			
2.0 x 2.0 Laundry	N			
5.2 x 5.0 Garage	N			
Other	N/A			

.....  
 (Initials)



SIMON JOHNSON  
 20 ROBIN STREET  
 BURWOOD  
 CHRISTCHURCH  
 H: & W:  
 M: 027 -322-0602

APPROVED

Item		Event Damage
		Y / N
Roof		N.
EXTERNAL WALLS	North	N
	South	N
	East	N
	West.	N
Decks		N/A.
CHIMNEY	Base	N/A.
	Ceiling Cavity	N
	Above Roof	N
	Fireplace	N/A.

.....  
 (Initials)

CLM / 2015 / 000181  
 SIMON JOHNSON  
 20 ROBIN STREET  
 BURWOOD  
 CHRISTCHURCH  
 H: & W:  
 M: 027 -322-0602

Item	Event Damage	
	Y / N	
Foundations	N	0.2m HAZELINE CRACK TO REAR FOUNDATION SETTLEMENT AREA, DISCOLOURATION, NO EQ DAMAGE.
Piling	N	
Services	N	
Other Dwelling Items	N/A	
Outbuildings	N/A	
Land & Retaining Walls <i>(Discuss with Supervisor)</i>	N	

**Supplementary Notes:**

I confirm the rooms and areas listed above have been inspected by an EQC representative.  
 Damage caused by the event has been noted and to my knowledge there are no other areas of damage resulting from the event.

**Signature of Claimant:** ..... **Dated:** .....

.....  
 (Initials)

# Drainworkz Ltd

16 Dalefield Drive

Cashmere

CHRISTCHURCH 1

8022

QUOTE

GST # 83-456-663

PH 03 3316 585

CELL 0272 555 116

Nicola Johnson  
20 Robin St  
Burwood  
CHCH

EARTHQUAKE JOB

EMERGENCY REPAIRS

JOB=20 Robin St Burwood

\*To renew the earthquake damaged sewer from ccc pvc at boundry to top of line / old gullys ok can stay

\*Have done as built drawing showing whats needed

\*Will cart all excess & put lawn soil & seed on front

lawn & compacted ap40 down side of house in dr side

\*Complete drainage job / Will leave site tidy

\*26 m of sewer to be replaced

\*Have done unblock , video ,reports early in the year

EQC JOB

QUOTE 70047

DATE 8/09/2015

Order Nicola #0213600610

QTY	DESCRIPTION	PRICE
16 HOURS	\$65 LABOUR TROY	\$1,040
16 HOURS	\$65 LABOUR JAD	\$1,040
16 HOURS	\$45 LABOUR RORY	\$720
26 m	\$20 Pipe 4 inch	\$520
	\$300 Digger	\$300
	\$200 Tip trucks	\$200
	\$200 Chip	\$200
	\$150 Cartage	\$150
	\$180 Ap40	\$180
	\$400 Fittings 4 inch	\$400
	\$200 Lawn soil & seed	\$200
	\$50 Compactor	\$50
SUBTOTAL		\$ 5,000.00
GST		\$ 750.00
BALANCE DUE		\$ 5,750.00

THANK YOU

BANK DETAILS BNZ 020828 0001249 00



0800 DAMAGE (0800 32 62 43)

25 August 2016

Claim No. CLM/2011/105168

Mr S Johnson and Mrs N Johnson  
 20 Robin Street  
 Burwood  
 Christchurch 8083

Dear Mr Johnson and Mrs Johnson

**Insured Name:** NATHDAN FAMILY TRUST**Damage Location:** 20 ROBIN STREET, BURWOOD, CHRISTCHURCH 8083

EQC is satisfied the additional damage (as detailed in the quote from Drainworkz provided by you) is earthquake damage covered by EQC.

EQC has now calculated your claim entitlement and paid the following amount(s).

**Claim summary**

Claim Number	Event Date	Claim Detail	EQC Entitlement	Excess Deducted	Amount
2011/105168	22/02/2011	<b>Already Paid</b>			
		Dwelling	\$17,040.77	\$200.00	\$16,840.77
2011/105168	22/02/2011	<b>This Payment</b>			
		Dwelling	\$5,750.00	\$27.91	\$5,722.09
		<b>Total</b>	<b>\$22,790.77</b>	<b>\$227.91</b>	<b>\$22,562.86</b>

Excess is calculated at 1% of the amount of the building and contents costs, with a minimum of \$200 per claim.

**Payment by cheque**

The payment cheque is enclosed with this letter. If you are expecting further payments from EQC, and would prefer payment by direct credit, please send us a pre-printed bank deposit slip or a letter from your bank confirming the account number and names. We can accept these electronically if they are scanned and emailed. Please remember to include your claim number in any correspondence.



### **What to do with your payment**

It is important that this payment is used for the purpose of repair or replacement of damaged property. In some circumstances, your future entitlement to EQC cover may be affected if your payment is not used for this purpose. If you believe there are outstanding aspects of your claim, you should keep your payment(s) and EQC will continue to respond to your queries. Banking your claim settlement does not affect your current or any future entitlement(s).

### **Your obligations**

By accepting this payment from EQC, you are agreeing that the claim information you submitted was true and accurate; that you have not withheld any material information; that you will inform EQC if any information provided later becomes incorrect; and that you will provide any further information required for EQC to assess your claim.

### **How to contact us**

If you require further information please visit [www.eqc.govt.nz](http://www.eqc.govt.nz) or phone 0800 DAMAGE (0800 326243) between 7am-9pm Monday-Friday or 8am-6pm on Saturday. Alternatively, email [info@eqc.govt.nz](mailto:info@eqc.govt.nz). To assist with the processing of your inquiry, please ensure you include your claim number in the email subject line.

Yours sincerely

*Trish Keith*

General Manager, Customer and Claims

**Drainworkz Ltd****16 Dalefield Drive****Cashmere****CHRISTCHURCH 1**

8022

**TAX INVOICE STATEMENT**

GST # 83-456-663

PH 03 3316 585

CELL 0272 555 116

Nichola Johnson  
20 Robin St  
 Burwood  
 CHCH

EARTHQUAKE JOB Diagnosis Costs  
 EMERGENCY REPAIRS

JOB=20 Robin St Burwood

\*To unblock &amp; video sewer to check for EQ damage

\*Video shows cracking, damage &amp; roots in drains

\*Have done report for EQC

\*Nichola has dvd as proof

\*Nichola to lodge job to 0800 damage

\*Have plotted sewer at boundry with orange dazzle

EQC JOB

INVOICE 7315

DATE 29/07/2015

Order Nichola #021360610

QTY	DESCRIPTION	PRICE
	\$130 BLOCKED SEWER	\$130
	\$150 VIDEO FEE	\$150
	\$100 REPORT FEE	\$100
PAYMENT DUE BY		SUBTOTAL \$ 380.00
7 DAY ACCOUNT		GST \$ 57.00
THANK YOU		BALANCE DUE \$ 437.00

BANK DETAILS BNZ 020828 0001249 00



0800 DAMAGE (0800 32 62 43)

28 October 2015

Claim No. CLM/2011/105168

Mr S Johnson and Mrs N Johnson  
 20 Robin Street  
 Burwood  
 Christchurch 8083

Dear Mr Johnson and Mrs Johnson

**Insured Name: NATHDAN FAMILY TRUST****Damage Location: 20 ROBIN STREET, BURWOOD, CHRISTCHURCH 8083****Your settlement calculation**

EQC has now calculated your claim entitlement and paid the following amount(s).

Item	Amount	Excess	Balance
Dwelling (invoice 7315)	\$437.00	\$0.00	\$437.00
<b>Total</b>			<b>\$437.00</b>

Total amount of this payment is **\$437.00** including GST, which has been paid directly to you.**Payment**

It is important that the payment(s) made to you are used for the purpose of repair or replacement of damaged property.

If you have not provided EQC with a bank deposit slip (to enable electronic payment) your payment will be made by cheque. If you are expecting further payments from EQC and would prefer payment by direct credit, please send us a bank deposit slip or a letter from your bank identifying your bank account number. We can accept these electronically if they are scanned and emailed. Please include your claim number in any correspondence to us.

If you believe there are outstanding aspects of your claim, you should bank your cheque(s) and EQC will continue to respond to your queries. Banking your claim settlement cheque does not affect your correct or any future entitlement(s).

**Your obligations**

By accepting this payment from EQC, you are agreeing that the claim information that you submitted was true and accurate; that you have not withheld any material information; that you will inform EQC if any information provided later becomes incorrect; and that you will provide any further information required for EQC to assess your claim.



**Further contact**

If you have any concerns about your claim please contact us either by sending an email to [claims@eqc.govt.nz](mailto:claims@eqc.govt.nz) or call our free phone number 0800 508 765.

Yours sincerely

*Bryan Dunne*

Acting General Manager, Customer and Claims



**Tony's Painting Services**

**181 Guthries Road**

**Phone 021 062 1539**

**GST Reg # 46-496-248**

**RECEIPT: 20465.1**

**15 September 2013**

Mr Grant Ditfort



Ref: CLM/2011/105168, 20 Robin Street, Burwood, Christchurch.

As per quotation dated 7 March 2012. For EQC repairs undertaken at 20 Robin Street, Burwood, Christchurch.

Amount Invoiced: \$15,862.82

Inc GST of: \$ 2,069.07

Amount Received: \$15,862.82

Thank you for choosing Tony's Painting Services.

We stand by all that we do.



Canterbury Waterblast Limited  
44 Maces Road  
Bromley  
Christchurch, 8062  
Phone: 03 365 7960  
Fax: 03 384 8748

**Tax Invoice 43113**

GST # 95-160-085

**Date** 31 December 2014  
**Account #** 19396  
**Customer Order #**  
**Payment Due Date** 13.01.2015

Page 1 of 1

**Invoice To :**

SIMON JOHNSON  
20 ROBIN STREET  
BURWOOD  
CHRISTCHURCH 8013

**Deliver To :**

20 ROBIN STREET  
BURWOOD  
CHRISTCHURCH 8013

Stockcode	Description	Quantity	Unit Price	Discount	Line Total
WATER	WATERBLAST DRAIN	1	140.00		140.00

31/12/2014

ATTEND SITE TO CLEAR BLOCKED SEWER.

BLASTED APPROXIMATELY 17 METRES FROM THE GULLY.

UNABLE TO DETERMINE THE CAUSE OF THE BLOCKAGE.

**SubTotal** 140.00

**GST** 21.00

**Amount** **161.00**

Bank Account number for payments is 03-1592-0353276-00. Please ensure that you include account details.  
Payment made by Visa / Mastercard will incur a 2% processing fee.  
Please note, unless arranged, payment is required within 7 days.

As per the Fair Trading Act 1986 we reserve the right to pass on collection costs should this account become delinquent.

Notification must be made in writing of a disputed account within 21 days from date of this invoice. Any dispute received outside of this time will not be valid.

**Remittance Advice - Please Detach and Return With Payment**

Account # 19396  
SIMON JOHNSON

Invoice No 43113  
Invoice Date 31.12.2014  
Invoice Amount \$161.00

Amount Paid

Canterbury Waterblast Limited, 44 Maces Road, Bromley, Christchurch, 8062



0800 DAMAGE (0800 32 62 43)

28 October 2015

Claim No. CLM/2011/105168

Mr S Johnson and Mrs N Johnson  
 20 Robin Street  
 Burwood  
 Christchurch 8083

Dear Mr Johnson and Mrs Johnson

**Insured Name: NATHDAN FAMILY TRUST****Damage Location: 20 ROBIN STREET, BURWOOD, CHRISTCHURCH 8083****Your settlement calculation**

EQC has now calculated your claim entitlement and paid the following amount(s).

Item	Amount	Excess	Balance
Dwelling (invoice 43251)	\$161.00	\$0.00	\$161.00
<b>Total</b>			<b>\$161.00</b>

Total amount of this payment is **\$161.00** including GST, which has been paid directly to you.**Payment**

It is important that the payment(s) made to you are used for the purpose of repair or replacement of damaged property.

If you have not provided EQC with a bank deposit slip (to enable electronic payment) your payment will be made by cheque. If you are expecting further payments from EQC and would prefer payment by direct credit, please send us a bank deposit slip or a letter from your bank identifying your bank account number. We can accept these electronically if they are scanned and emailed. Please include your claim number in any correspondence to us.

If you believe there are outstanding aspects of your claim, you should bank your cheque(s) and EQC will continue to respond to your queries. Banking your claim settlement cheque does not affect your correct or any future entitlement(s).



**Your obligations**

By accepting this payment from EQC, you are agreeing that the claim information that you submitted was true and accurate; that you have not withheld any material information; that you will inform EQC if any information provided later becomes incorrect; and that you will provide any further information required for EQC to assess your claim.

**Further contact**

If you have any concerns about your claim please contact us either by sending an email to [claims@eqc.govt.nz](mailto:claims@eqc.govt.nz) or call our free phone number 0800 508 765.

Yours sincerely

*Bryan Dunne*

Acting General Manager, Customer and Claims

# Drainworkz Ltd

16 Dalefield Drive  
Cashmere  
CHRISTCHURCH



## TAX INVOICE STATEMENT

GST # 83-456-663  
PH 03 3316 585  
CELL 0272 555 116

Nicola Johnson  
20 Robin St  
Burwood  
CHCH 8083

EARTHQUAKE JOB Diagnosis Costs  
EMERGENCY REPAIRS  
JOB=20 Robin St Burwood  
\*To unblock the earthquake damaged sewer drain  
\*Whole sewer blocked causing toilet inside to block  
\*Went down side of house gully to clear / Was able to unblock to make house liveable  
\*Have videoed ,reports ,quotes etc last year & owner  
Nicola is waiting for EQC to sort sewer out  
\*Eqc should re-imbuse for this invoice

EQC JOB

INVOICE 7899  
DATE 17/03/2016  
Order Nicola \*021360610

QTY	DESCRIPTION	PRICE
	\$130 BLOCKED SEWER	\$130

PAYMENT DUE BY  
7 DAY ACCOUNT  
THANK YOU

SUBTOTAL	\$ 130.00
GST	\$ 19.50
BALANCE DUE	\$ 149.50

BANK DETAILS BNZ 020828 0001249 00

Attention EQC: 7 27/9/16

Claim No: CLM/2011/105168

Address: 20 Robin St

RECEIVED Burwood 8083

Chch

06 OCT 2016

Occupants: Mr S & Mrs N

BY:

Johnson.

Please find attached two  
invoices for the unblocking  
of our drains in 2016,  
prior to you paying out  
for the drains to be  
re-laid. We look forward  
to reimbursement.

Thank you so much &

Kind regards,

Nicola Johnson

NJohnson.

# Drainworkz Ltd

16 Dalefield Drive  
Cashmere  
CHRISTCHURCH



## TAX INVOICE STATEMENT

GST # 83-456-663  
PH 03 3316 585  
CELL 0272 555 116

Nickola Johnson  
20 Robin St  
Burwood  
CHCH 8083

EARTHQUAKE JOB Diagnosis Costs  
EMERGENCY REPAIRS\*  
JOB=20 Robin St Burwood  
\*To unblock sewer for house again  
\*Sewer was blocked 12 m down near boundry  
\*Was able to unblock to make house liveable  
\*NOTE=Sewer has been videod & owner Nickola is waiting for 2 years for EQC to sort  
\*Eqc should re-imbuse owner for this drain clear  
\*Sewer has bad earthquake damage in whole line

EQC JOB

INVOICE 8181  
DATE 6/07/2016  
Order Nickola \*021360610

QTY	DESCRIPTION	PRICE
	\$130 BLOCKED SEWER	\$130

PAYMENT DUE BY  
7 DAY ACCOUNT  
THANK YOU

SUBTOTAL	\$ 130.00
GST	\$ 19.50
BALANCE DUE	\$ 149.50

BANK DETAILS BNZ 020828 0001249 00



0800 DAMAGE (0800 32 62 43)

19 April 2017

Claim No. CLM/2011/105168

Mrs N Johnson and Mr S Johnson  
 20 Robin Street  
 Burwood  
 Christchurch 8083

Dear Mrs Johnson and Mr Johnson

**Insured Name:** NATHDAN FAMILY TRUST**Damage Location:** 20 ROBIN STREET, BURWOOD, CHRISTCHURCH 8083**Your Invoice Settlement**

Please find below remittance advice for Invoice 7928, Invoice 40532 and Invoice 40818, Invoice 39669, calculated as follows:

Item	Invoice total	Amount
Drainworkz Ltd - Invoice 8181 – 6/07/2016	\$149.50	\$149.50
Drainworkz Ltd - Invoice 7899 – 17/03/2016	\$149.50	\$149.50
<b>Less Excess</b>		-\$2.99
<b>Total</b>	<b>\$299.00</b>	<b>\$296.01</b>

Total amount of this payment is **\$296.01**

Excess is calculated at 1% of the amount of the building and contents costs, with a minimum of \$200 per claim.

**Payment by cheque**

The payment cheque is enclosed with this letter.

If you are expecting further payments from EQC, and would prefer payment by direct credit, please send us a pre-printed bank deposit slip or a letter from your bank confirming the account number and names. We can accept these electronically if they are scanned and emailed. Please remember to include your claim number in any correspondence.



**How to contact us**

If you require further information please visit [www.eqc.govt.nz](http://www.eqc.govt.nz) or phone 0800 DAMAGE (0800 326243) between 7am-9pm Monday-Friday or 8am-6pm on Saturday. Alternatively, email [info@eqc.govt.nz](mailto:info@eqc.govt.nz). To assist with the processing of your inquiry, please ensure you include your claim number in the email subject line.

Yours sincerely

*Trish Keith*

General Manager, Customer and Claims

# DECLINED AND/OR WITHDRAWN CLAIM(S)

The following information contains documents relating to claims that were declined by NHC Toka Tū Ake and/or withdrawn by the claimant.

APPROVED

Date: 30/1/15	Claim Number: 2010/ 2015/000181	Estimator Name: D Adlam
------------------	------------------------------------	----------------------------

### Dwelling Inspection Checklist: Show measurements indicate damage

<p>Lounge 4.7</p>	<p>Dining Room 5.4</p>	<p>Kitchen</p>
<p>Family Room 3.5</p>	<p>Bed 1 3.9</p>	<p>Ensuite</p>
<p>Bed 2 4.2</p>	<p>Bed 3 4</p>	<p>Bed 4</p>
<p>Bathroom 2</p>	<p>Toilet 1 2</p>	<p>Toilet 2</p>
<p>Office/Study</p>	<p>Rumpus</p>	<p>Entry/Hall(s) 4.7</p>

APPROVED



Date: 30/1/15	Claim Number: 2010/ 2015/000181	Estimator Name: D Adlam
------------------	------------------------------------	----------------------------

**Dwelling Inspection Checklist: Show measurements indicate damage**

N/A

Stairwell

2  
N/D  
2

Laundry

5  
N/D

Outbuilding/Garage 5.2

Legend

—	Crack to ceiling (show length)
~	Crack to wall (show length)
X	External damage
○	Foundation damage

Date: 30/1/15	Claim Number: 2010/ 2015/000181	Estimator Name: D Adlam
------------------	------------------------------------	----------------------------

**Dwelling Inspection Checklist: Show measurements indicate damage**

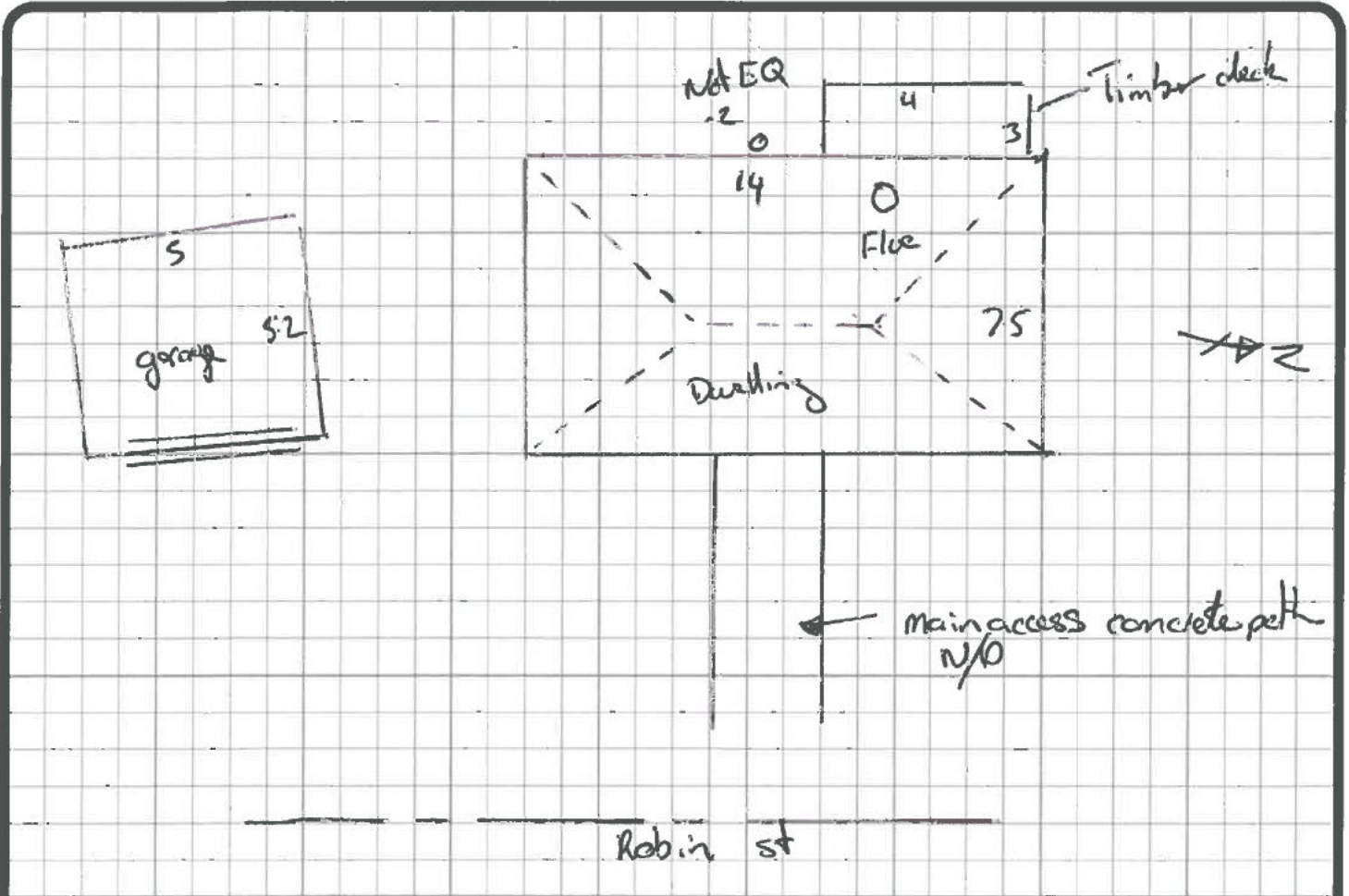

Area m2:	105
Stud Heights:	2.4
Wall Finish:	Wallpaper      Plastered <u>Paint Finish</u>
Other:	
Services:	Specify Damage:
Chimneys:	Construction Type: <u>Flue inside brick to roof line</u> Height N/O Damage Description: Above Roof    Below Roof    Total Repair
Foundations Damage:	Timber <u>Concrete Ring</u> Concrete Slab    Other (Specify): Minor    Moderate    Severe House Moved off Foundations? Concrete Slab Cracked? Crack Width: ..... Crack Length: .....
Roof:	<u>Framed</u> Trussed N/O Type: Clay Tiles <u>Concrete Tiles</u> Rolled Metal    Other Damage:
Cladding Type:	<u>Weatherboard</u> <sup>pointed</sup> Brick Veneer    Hardi Plank    Other N/O

APPROVED



## Statement of Claim Checklist / Repair Strategy

Date: 30/1/15

Author: DEREK LARSEN

CLM / 2015 / 000181

SIMON JOHNSON  
20 ROBIN STREET  
BURWOOD  
CHRISTCHURCH  
H: [REDACTED]  
M: [REDACTED]

LA: DEREK LARSEN

Estimator: DEAN AXMAN

Room	Earthquake Damage	Walls	Ceiling	Floor	Repair Strategy
	Y/N	✓	✓	✓	
4.7 x 3.5 Lounge	N				
Dining Room	N				
5.40 x 2.4 Kitchen	N				
3.5 x 3.4 Family Room	N				
3.9 x 3.2 Bedroom 1		✓			0.6LM APPEARING CRACK BELOW WINDOW. THERMAL MOVEMENT. NO E.G. DAMAGE
Ensuite	N/A				
4.2 x 3.0 Bedroom 2	N				
4.0 x 3.5 Bedroom 3	N				

.....  
(Initials)



SIMON JOHNSON  
 20 ROBIN STREET  
 BURWOOD  
 CHRISTCHURCH  
 H: [REDACTED]  
 M: [REDACTED]

REMOVED

Repair Strategy

Room	Earthquake Damage	Walls	Ceiling	Floor	
	Y/N	✓	✓	✓	
Bedroom 4	N/A				
2.0 x 1.5 Bathroom	N				
2.0 x 1.0 Toilet 1	N				
Toilet 2	N/A				
Office / Study	N/A				
Rumpus	N/A				
4.7 x 1.2 Entry / Hall(s)	N.				
Stairwell	N/A.				
2.0 x 2.0 Laundry	N				
5.2 x 5.0 Garage	N				
Other	N/A				

.....  
 (Initials)

APPROVED



SIMON JOHNSON  
20 ROBIN STREET  
BURWOOD  
CHRISTCHURCH

H  
M

Item		Event Damage Y / N
Roof		N.
EXTERNAL WALLS	North	N
	South	N
	East	N
	West.	N
Decks		N/A.
CHIMNEY	Base	N/A.
	Ceiling Cavity	N
	Above Roof	N
	Fireplace	N/A.

.....  
(Initials)

CLM / 2015 / 000181  
 SIMON JOHNSON  
 20 ROBIN STREET  
 BURWOOD  
 CHRISTCHURCH  
 H: [REDACTED]  
 M: [REDACTED]

Item	Event Damage	
	Y / N	
Foundations	N	0.21M HAZELINE CRACK TO REAR FOUNDATION SETTLEMENT AREA, DISCOLOURATION, NO EQ DAMAGE.
Piling	N	
Services	N	
Other Dwelling Items	N/A	
Outbuildings	N/A	
Land & Retaining Walls <i>(Discuss with Supervisor)</i>	N	

**Supplementary Notes:**

I confirm the rooms and areas listed above have been inspected by an EQC representative.  
 Damage caused by the event has been noted and to my knowledge there are no other areas of damage resulting from the event.

**Signature of Claimant:** ..... **Dated:** .....

.....  
 (Initials)