

STATEMENT OF PASSING OVER INFORMATION

This information has been supplied by the vendor or the vendor's agents. Accordingly, Ownly (REAA 2008) and Sold On Kapiti Limited is merely passing over the information as supplied to us by the vendor of the vendor's agents.

We cannot guarantee its accuracy and reliability as we have not checked, audited, or reviewed the information and all the intending purchasers are advised to conduct their own due diligence investigation into the same.

To the maximum extent permitted by law Ownly (REAA 2008) and Sold On Kapiti Limited does not accept any responsibility to any person for the accuracy of the information herein.



SOLD ON KĀPITI
real estate

Note:
- Kitchen layout diagrammatic and only to be used for drainage reference, refer to kitchen plans for exact design.

BC220040
Received by
Kapiti Coast District Council
17/01/2023
via simpli

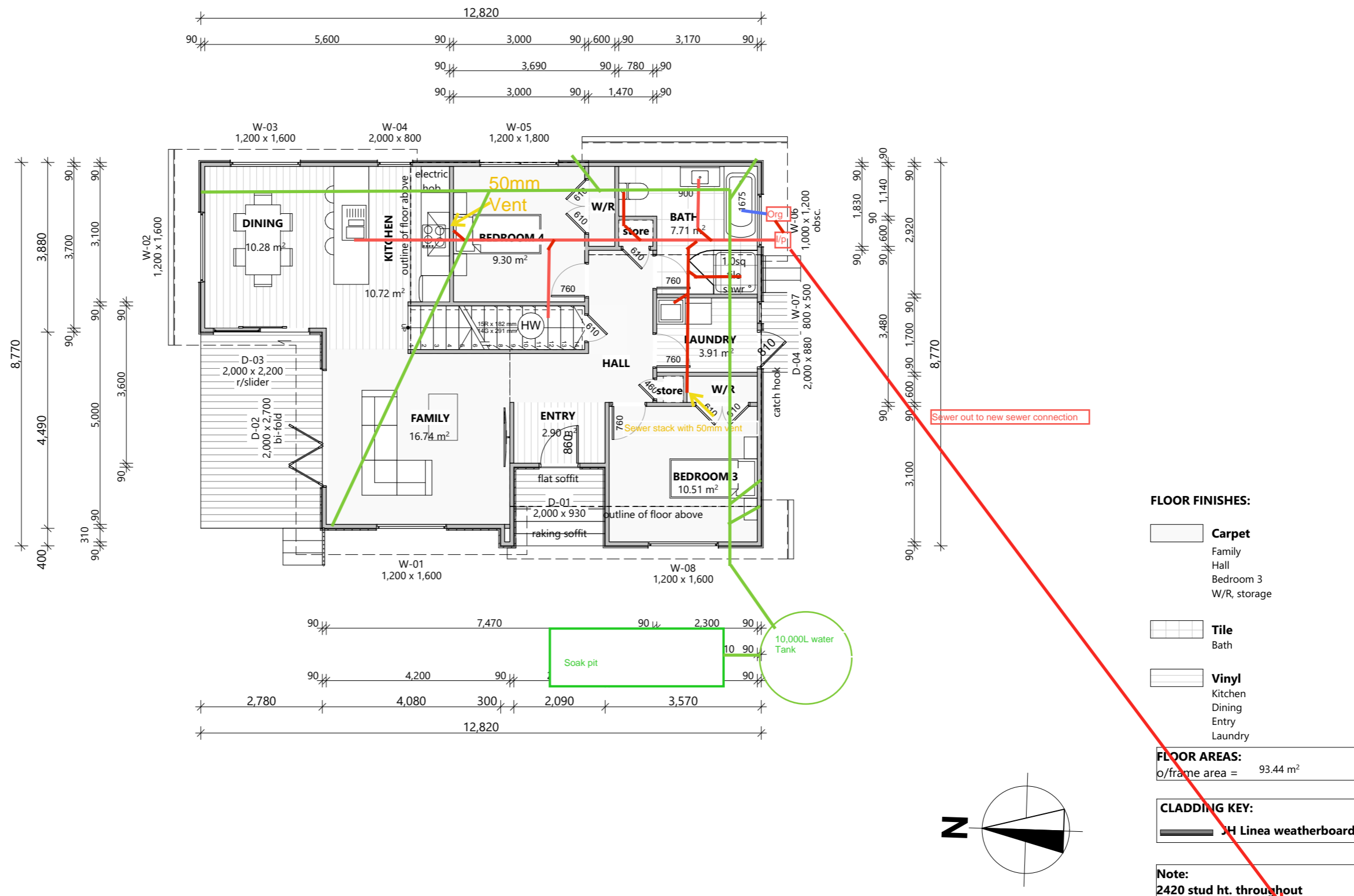

	GROUND FLOOR PLAN				Scale: 1:100	Sheet no: 4	Client Details: Botica & Blair	Job no: AW368
	Design: A1	Drawn: TN	Check: AG/UP	LBP: UP	Date: 4/06/2021	Call 0800 A1homes 2 1 4 6 6 3 www.A1homes.co.nz	Address: 46 Nimmo Avenue West Waikanae	KH136
	Wind: Very High	Earthq: 3	Exposure: C	Snow: N0	Climate: 2			

DO NOT scale off drawings. Cross reference all drawings. Any discrepancies MUST be clarified with the designer immediately before commencing works or ordering. NO construction or site works are to commence until Building Consent becomes unconditional.

COPYRIGHT: Any and all drawings commissioned remain the property of A1 Homes Limited, including all copyright and similar rights subsisting in those drawings, and are solely for use as described on the drawings, and may not be used for any other purpose or reproduced in whole or in part without written permission obtained from A1 Homes Limited.