



**RECORD OF TITLE
UNDER LAND TRANSFER ACT 2017
FREEHOLD**

**Guaranteed Search Copy issued under Section 60 of the Land
Transfer Act 2017**



R. W. Muir
Registrar-General
of Land

Identifier **CB28B/1253**
Land Registration District **Canterbury**
Date Issued 24 March 1986

Prior References
CB3A/296

Estate Fee Simple
Area 1011 square metres more or less
Legal Description Lot 1 Deposited Plan 21305
Registered Owners
A & L NZ Limited

Interests

12701778.2 Mortgage to AMFL Limited and Westside Holdings (2018) Limited - 29.7.2024 at 2:13 pm

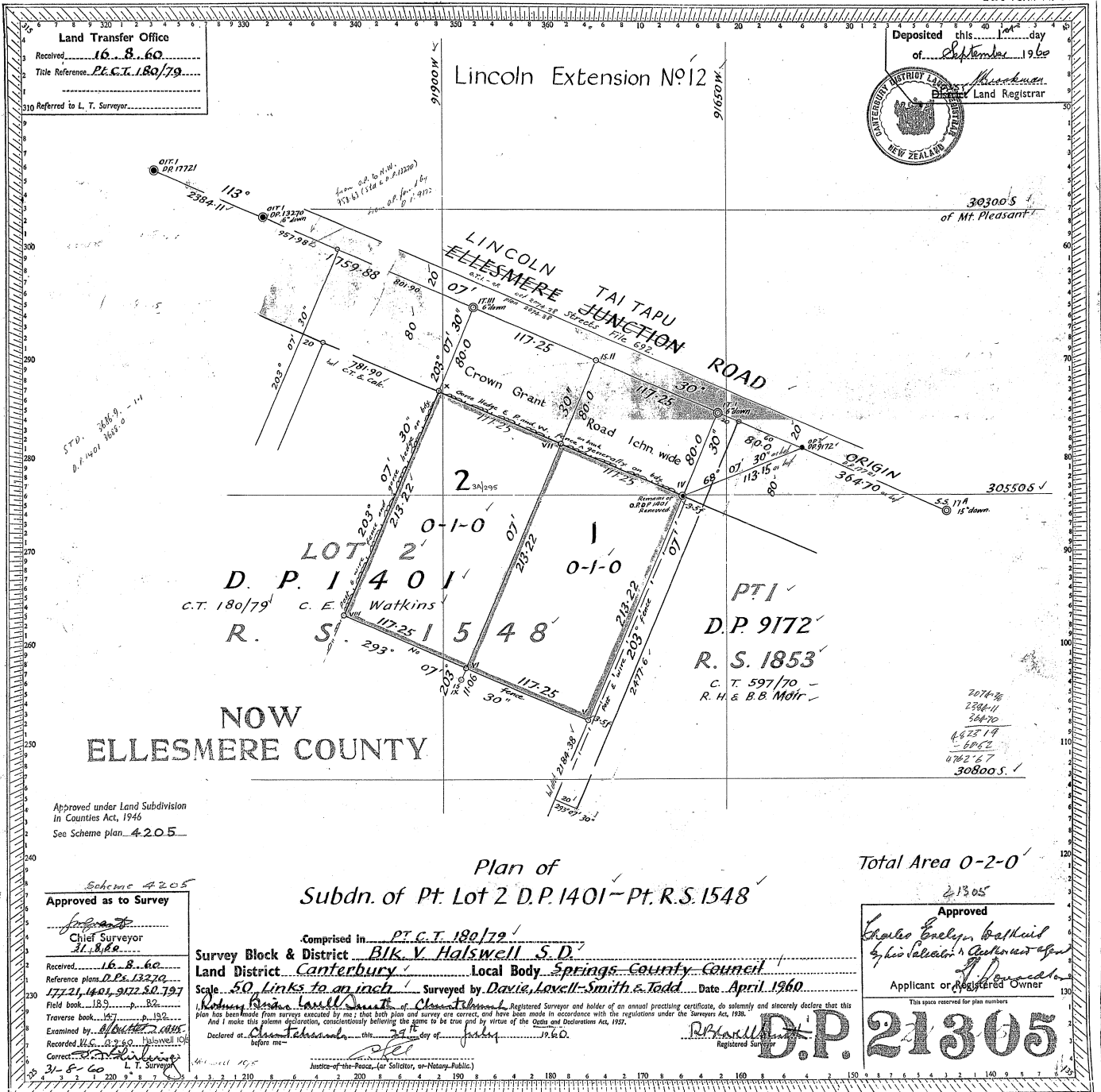

Land Transfer Office
 Received 16.8.60
 Title Reference P.C.T. 180/79
 310 Referred to L. T. Surveyor

Deposited this 1st day
 of September 1960
 District Land Registrar
 Canterbury District
 NEW ZEALAND

570. 388.9 - 14
 D.P. 1401 388.0

30300 S
 of Mt. Pleasant

NOW
 ELLESMERE COUNTY

Approved under Land Subdivision
 in Counties Act, 1946
 See Scheme plan 4205

Scheme 4205
 Approved as to Survey
 Chief Surveyor
 31.8.60
 Received 16.8.60
 Reference plan D.P. 13270
 1771, 1401, 9122, 80, 797
 Field book 18.5, 19.2
 Traverse book 147, 192
 Examined by G. J. G. Halswell 10/8
 Recorded U.C. 4.2.60
 Corrected 31.8.60
 L. T. Surveyor

Plan of
 Subdn. of Pt. Lot 2 D.P. 1401 - Pt. R.S. 1548

Total Area 0-2-0

Comprised in Pt. C.T. 180/79
 Survey Block & District Bk. V. Halswell S.D.
 Land District Canterbury Local Body Springs County Council
 Scale 50 Links to an inch Surveyed by Davie, Lovell, Smith & Todd Date April 1960
 Registered Surveyor and holder of an annual practicing certificate, do solemnly and sincerely declare that this
 plan has been made from surveys executed by me; that both plan and survey are correct, and have been made in accordance with the regulations under the Surveyors Act, 1938.
 And I make this solemn declaration, conscientiously believing the same to be true and by virtue of the Oaths and Declarations Act, 1957.
 Declared at Christchurch this 21st day of July 1960 J.P. & D.
 Justice-of-the-Peace, (or Solicitor, or Notary Public)

21305
 Approved
 Charles Evelyn Ballin
 by his solicitor & Applicant's Agent
 Applicant or Registered Owner

D.P. 21305
 Registered