

# PROPERTY INFORMATION

A

+ S

**AMY + SHAR**

021 077 9945 / 027 555 0654

[amy@asrealestate.co.nz](mailto:amy@asrealestate.co.nz)

[shar@asrealestate.co.nz](mailto:shar@asrealestate.co.nz)

# STATEMENT OF PASSING OVER

This information has been supplied by the vendor or third party. A+S (Powered by Ownly Limited, Licensed REAA 2008) is merely passing over this information as supplied to us.

We cannot guarantee its accuracy and reliability as we have not checked, audited, or reviewed the information and all intending purchasers are advised to conduct their own due diligence investigation seeking the relevant independent legal or technical advice.

To the maximum extent permitted by law we do not accept any responsibility to any party for the accuracy or use of the information herein.

A  
+ S



**RECORD OF TITLE  
UNDER LAND TRANSFER ACT 2017  
FREEHOLD**

**Guaranteed Search Copy issued under Section 60 of the Land  
Transfer Act 2017**



  
R. W. Muir  
Registrar-General  
of Land

**Identifier** **225839**  
**Land Registration District** **Canterbury**  
**Date Issued** 22 February 2006

**Prior References**  
CB44B/950

---

**Estate** Fee Simple  
**Area** 2513 square metres more or less  
**Legal Description** Lot 3 Deposited Plan 355380

**Registered Owners**  
Keryn Marie Hansen and Dwayne Norman Hansen

---

**Interests**

Fencing Covenant in Transfer A361560.6 - 23.7.1998 at 10.57 am

Subject to a right of way and a right to convey water, electricity, telecommunications and computer media over part marked B on DP 355380 created by Easement Instrument 6761564.3 - 22.2.2006 at 9:00 am

Appurtenant hereto is a right of way and a right to convey water, electricity, telecommunications and computer media created by Easement Instrument 6761564.3 - 22.2.2006 at 9:00 am

The easements created by Easement Instrument 6761564.3 are subject to Section 243 (a) Resource Management Act 1991

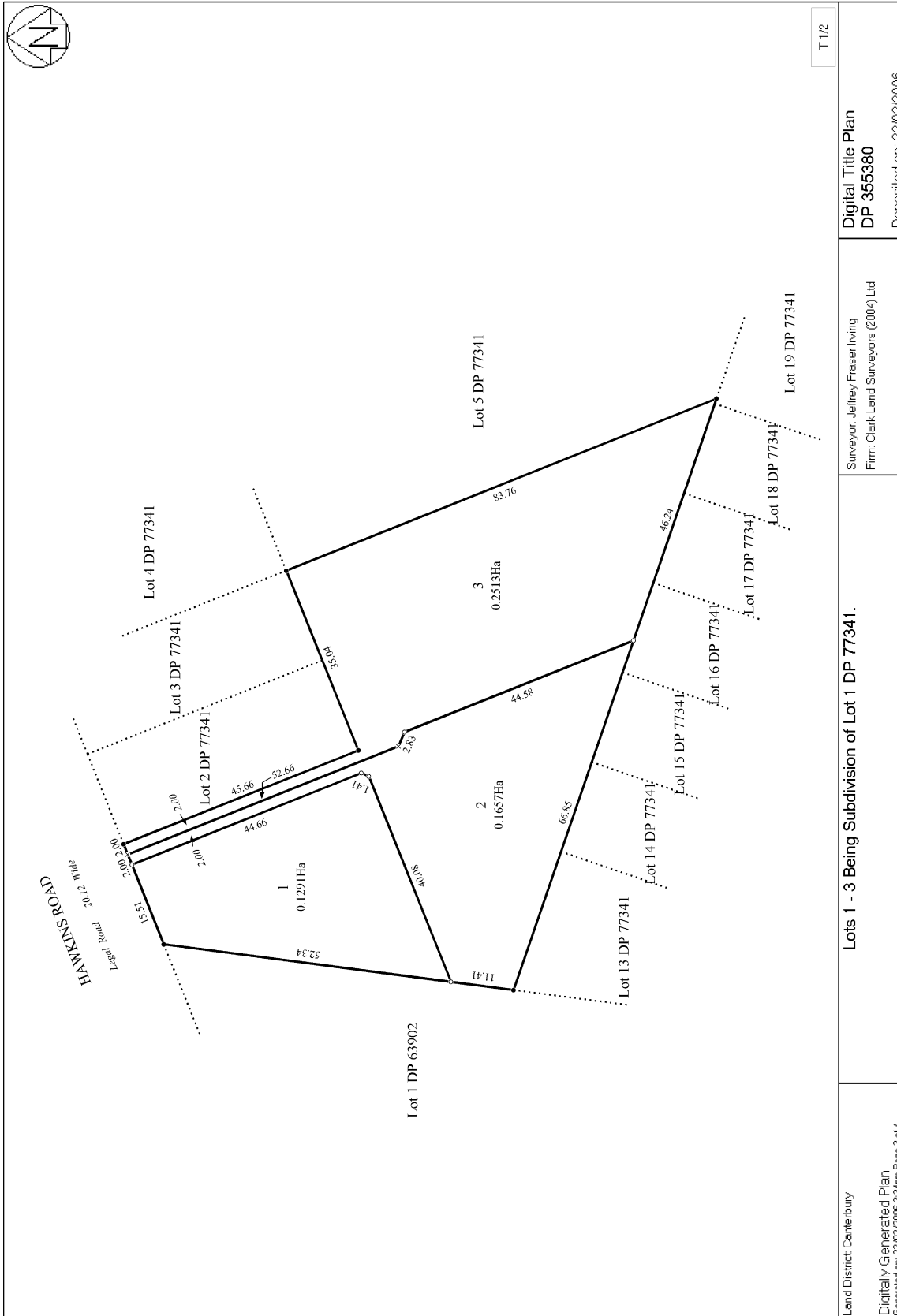



TRANSFER  
Land Transfer Act 1952

A361560.6 T

\$380-00

If there is not enough space in any of the panels below, the two page form incorporating the Annexure Schedule should be used: no other format will be received.

Land Registration District

CANTERBURY

Certificate of Title No. All or Part? Area and legal description — Insert only when part or Stratum, CT

a) 44B 950  
b) 44B 965

A11  
A11

10TAT1 20/05/1998 2026789  
NZ Stamp Duty - Stamp  
Self assessed duty 380.00

Transferor Surnames must be underlined

GLENROY FARMS LIMITED

Transferee Surnames must be underlined

CHRISTOPHER NORMAN JOSE, Architectural Designer and RACHEL JUDITH GOODMAN, Laboratory Technician, both of Christchurch

Estate or Interest or Easement to be created: Insert e.g. Fee simple; Leasehold in Lease No. ....; Right of way etc.

a) Fee simple  
b) Fee simple

and the transferee shall be bound by a fencing covenant as defined in Section 2 of the Fencing Act 1978 in favour of the transferor

Consideration

a) \$38,000.00  
b) \$16,000.00

Operative Clause

For the above consideration (receipt of which is acknowledged) the TRANSFEROR TRANSFERS to the TRANSFEREE all the transferor's estate and interest in the land in the above Certificate(s) of Title and if an easement is described above such is granted or created.

Dated this 11<sup>th</sup> day of May 19 98

Attestation

Signed in my presence by the Transferor  
Signature of Witness

Witness to complete in BLOCK letters  
(unless typewritten or legibly stamped)

Witness name

Occupation John Neville Creighton  
Solicitor  
Address Christchurch

Signature, or common seal of Transferor

Certified correct for the purposes of the Land Transfer Act 1952

~~Certified that no conveyance duty is payable by virtue of Section 24(1) of the Stamp and Cheque Duties Act 1977  
(DELETE IN APPLICABLE CERTIFICATE)~~

Solicitor for the Transferee

Approved by Registrar-General  
of Land under No. 1995/1003

# TRANSFER

## Land Transfer Act 1952

Law Firm Acting
JOAN ROTHERHAM SOLICITOR CHRISTCHURCH

Auckland District Law Society  
REF. 4130

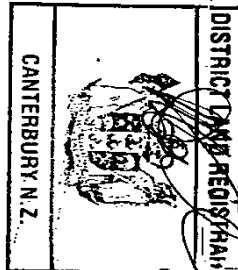

10.57 23.JUL.98 A 361560  
PARTICULARS ENTERED IN REGISTER  
LAND REGISTRY CANTERBURY  
ASST LAND REGISTRAR

This page is for Land Registry Office use only.  
(except for "Law Firm Acting")

• 6 ⊠

Approved by Registrar-General of Land under No. 2002/6055  
**Easement instrument to grant easement or profit à prendre, or create land covenant**  
 Sections 90A and 90F, Land Transfer Act 1952

**EI 6761564.3 Easemen**

Cpy - 01/01, Pgs - 006, 21/02/06, 14:24



DocID: 211663096

Surname(s) must be underlined or in CAPITALS.

Land registration district

**CANTERBURY**

Grantor

**Kurt Michael HORE and Keryn Marie HORE**

Grantee

Surname(s) must be underlined or in CAPITALS.





**Kurt Michael HORE and Keryn Marie HORE**

**Grant\* of easement or profit à prendre or creation or covenant**

The Grantor, being the registered proprietor of the servient tenement(s) set out in Schedule A, grants to the Grantee (and, if so stated, in gross) the easement(s) or profit(s) à prendre set out in Schedule A, or creates the covenant(s) set out in Schedule A, with the rights and powers or provisions set out in the Annexure Schedule(s).

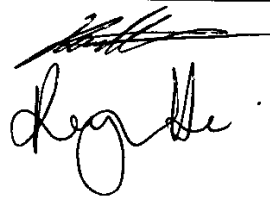
Dated this 26<sup>th</sup> day of January 2006

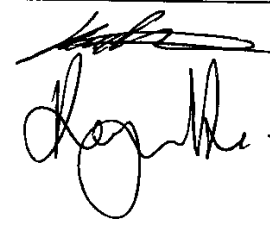
**Attestation**

 Signature [common seal] of Grantor	<p><b>Signed in my presence by the Grantor</b></p>  Signature of witness Witness to complete in BLOCK letters (unless legibly printed) Witness name Occupation WILLIAM EDMOND HERBISON SOLICITOR Address CHRISTCHURCH
 Signature [common seal] of Grantee	<p><b>Signed in my presence by the Grantee</b></p>  Signature of witness Witness to complete in BLOCK letters (unless legibly printed) Witness name Occupation WILLIAM EDMOND HERBISON SOLICITOR Address CHRISTCHURCH

Certified correct for the purposes of the Land Transfer Act 1952.



[Solicitor for] the Grantee

\*If the consent of any person is required for the grant, the specified consent form must be used.

**Annexure Schedule 1**



Easement instrument

Dated 26 - 1 - 06

Page 2 of 4 pages

**Schedule A**

*(Continue in additional Annexure Schedule if required.)*

Purpose (nature and extent) of easement, profit, or covenant	Shown (plan reference)	Servient tenement (Identifier/CT)	Dominant tenement (Identifier/CT or in gross)
<b>Right of Way</b>	<b>A DP 355380</b>	<b>Lot 2, CT 225838</b>	<b>Lot 3, CT 225839</b>
<b>Right to convey water, electricity, telecommunications and computer media</b>	<del>DP 355380</del> A DP 355380	<del>Lot 2, CT 225838</del> Lot 2 CT 225838	<del>Lot 3, CT 225839</del> Lot 3 CT 225839
Right of Way	B DP 355380	Lot 3 CT 225839	Lot 2 CT 225838
Right to convey water, electricity, telecommunications and computer media	B DP 355380	Lot 3 CT 225839	Lot 2 CT 225838

**Easements or profits à prendre rights and powers (including terms, covenants, and conditions)**

*Delete phrases in [ ] and insert memorandum number as required.  
Continue in additional Annexure Schedule if required.*

Unless otherwise provided below, the rights and powers implied in specific classes of easement are those prescribed by the Land Transfer Regulations 2002 and/or the Ninth Schedule of the Property Law Act 1952.

The implied rights and powers are **[varied]** ~~[negated]~~ ~~[added to]~~ or ~~[substituted]~~ by:

~~[Memorandum number \_\_\_\_\_, registered under section 155A of the Land Transfer Act 1952].~~

[the provisions set out in Annexure Schedule 2].

**Covenant provisions**

*Delete phrases in [ ] and insert memorandum number as required.  
Continue in additional Annexure Schedule if required.*

The provisions applying to the specified covenants are those set out in:

~~[Memorandum number \_\_\_\_\_, registered under section 155A of the Land Transfer Act 1952].~~

[Annexure Schedule 2].

**All signing parties and either their witnesses or solicitors must sign or initial in this box**

*[Handwritten signature]*

**Annexure Schedule 2**



Insert type of instrument  
"Mortgage", "Transfer", "Lease" etc

Easement

Dated 26 - 1 - 06

Page 3 of 4 pages

(Continue in additional Annexure Schedule, if required.)

**RIGHTS AND POWERS**

1. The rights and powers set out in the Fourth Schedule to the Land Transfer Regulations 2002 and the Ninth Schedule to the Property Law Act 1952 are herein implied except as they are added to or substituted hereto.
2. Where there is a conflict between the provisions of the Fourth Schedule to the Land Transfer Regulations 2002 and the Ninth Schedule to the Property Law Act 1952, the provisions of the Ninth Schedule must prevail.
3. Where there is a conflict between the provisions of the Fourth Schedule to the Land Transfer Regulations 2002 and the Ninth Schedule to the Property Law Act 1952 and the modifications in this Easement Instrument the modifications must prevail.
4. No power is implied in respect of any easement for the Grantor to determine the easement for breach of any provision of this instrument (whether express or implied) or for any other cause, it being the intention of the parties that each easement shall subsist for all time unless it is surrendered.

The Maintenance Provisions in the Fourth Schedule of the Land Transfer Regulations 2002 are modified as follows:

1. The word "equally" in clause 11 (2) of the Fourth Schedule of the Land Transfer Regulations 2002 shall read as "for a reasonable contribution in proportion to their use".
2. Any maintenance, repair or replacement of right of way and telecommunication and electric power cables and computer media on the servient or dominant land over the stipulated course that is necessary because of any act or omission by the Grantor must be carried out promptly by the Grantor and at the sole cost of the Grantor. Where the act or omission is the partial cause of the maintenance repair or replacement the costs payable by the Grantor responsible must be in proportion to the amount attributable to that act or omission (with the balance payable in accordance with clause 11 of the Fourth Schedule to the Land Transfer Regulations 2002).

If this Annexure Schedule is used as an expansion of an instrument, all signing parties and either their witnesses or solicitors must sign or initial in this box.

**Annexure Schedule**



Insert type of instrument  
"Mortgage", "Transfer", "Lease" etc

Easement

Dated

26 - 1 - 06

Page

4

of

4

pages

(Continue in additional Annexure Schedule, if required.)

**ANNEXURE SCHEDULE 2 CONTINUED**

3. Any maintenance, repair or replacement of right of way and telecommunication and electric power cables and computer media on the servient or dominant land over the stipulated course that is necessary because of any act or omission by the Grantee must be carried out promptly by the Grantee and at the Grantee's sole cost. Where the act or omission is the partial cause of the maintenance repair or replacement the costs payable by the Grantee responsible must be in proportion to the amount attributable to that act or omission (with the balance payable in accordance with clause 11 of the Fourth Schedule to the Land Transfer Regulations 2002).

If this Annexure Schedule is used as an expansion of an instrument, all signing parties and either their witnesses or solicitors must sign or initial in this box.

**MORTGAGEE'S CONSENT**

ANZ NATIONAL BANK LIMITED the Mortgagee under and by virtue of Memorandum of Mortgage 6107903.2 HEREBY CONSENTS to the within Easement instrument and order for new Titles but WITHOUT PREJUDICE to the Mortgage's rights powers and remedies under the said Mortgage.

Dated this 26 day of January 2006

Signed by ANZ NATIONAL BANK LIMITED

by its Attorney

  
Rene Joy Brettigny  
Team leader of ANZ National Bank Limited

Witness to the execution by

ANZ NATIONAL BANK LIMITED

Witness:

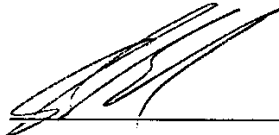
  
\_\_\_\_\_

Occupation: Scott Goddard  
Bank officer  
Auckland

Address: P O Box 9886  
NEWMARKET

**ANZ NATIONAL BANK LIMITED**

**CERTIFICATE OF NON-REVOCATION OF POWER OF ATTORNEY**

I, *Rene Joy Brettenny of Auckland* in New Zealand, Team Leader of ANZ National Bank Limited, hereby certify that:

1. By Deed dated 9 January 2005 ("*The Deed*"), I was appointed an Additional Attorney of ANZ National Bank Limited, a Company incorporated in New Zealand and having its head office at Wellington on the terms and subject to the conditions set out in that deed.
2. At the date of this certificate, I am a Team Leader, Securities of ANZ, part of ANZ National Bank Limited.
3. At the date hereof I have not received any notice of the revocation of that appointment by the winding up or dissolution of ANZ National Bank Limited or otherwise.
4. The Deed is registered with Land Information, New Zealand, Dealing Number PA 6275223.1.

SIGNED by the abovenamed )  
Attorney at Auckland on this )  
26<sup>th</sup> day of *January* 2006. )

  
\_\_\_\_\_  
Signature

# Land Information Memorandum L261125

## Application

A + S Real Estate Limited	<b>No.</b>	L261125
A + S Real Estate Limited	<b>Application date</b>	08/05/2026
41E South terrace	<b>Issue date</b>	13/05/2026
Darfield 7510	<b>Phone</b>	0277484093

## Property

<b>Valuation No.</b>	2423020634
<b>Location</b>	1/367 Hawkins Road
<b>Legal Description</b>	LOT 3 DP 355380 BLK XII HORORATA SD
<b>Owner</b>	Hansen Keryn Marie and Hansen Dwayne Norman
<b>Area (hectares)</b>	0.2513

## Rates

### Rateable Value

The date of Selwyn's last General Revaluation was 1/09/24. For further information please contact Council's Rates Department.

<b>Revaluation Year</b>	2024
<b>Land</b>	\$235,000.00
<b>Improvements</b>	\$415,000.00
<b>Capital Value</b>	\$650,000.00

### Current Rates Year 2025 to 2026

<b>Annual Rates</b>	\$4,340.85
<b>Current Instalment</b>	\$1,031.80
<b>Current Year - Outstanding Rates</b>	-\$71.20
<b>Arrears for Previous Years</b>	\$0.00

**Next Instalment Due**

15/06/2026

Next Revaluation Due 2027

The rates listed for this property are correct as at the date of this report being issued.

If this property is vacant land, and the applicant intends building a house or making other improvements, additional rates and charges will be added. Such rates and charges are for the operation of the District libraries, local community centre and recreation reserves, sewerage and water systems and refuse collections and recycling.

If a ratepayer in the district purchases additional properties, that ratepayer maybe eligible for certain rating exemptions due to multiple ownership. The exemptions would only apply to uniform library charges on bare land blocks and an exemption from the uniform annual general charge if contiguous or same use land is purchased.

Please contact the Councils rates team if you require clarification on 0800 SELWYN (735 996).

Note: Rates are charged in four equal instalments for the period commencing 1 July and ending 30 June each year.

## **Planning/Resource Management**

**Partially Operative District Plan:** Settlement zone

**Operative District Plan Zoning:** Living 1

The Council has undertaken a review of the Operative District Plan and through this process it has developed a New District Plan ('The Partially Operative District Plan') which provides clear objectives, policies and rules to manage the effects of land use activities on the environment, but also sets a clear direction for our district's development and reflects our communities' needs and expectations. It also incorporates any changes in legislation, national and regional policy statements, environmental standards and other regulations.

The period for lodging appeals against decisions on the Partially Operative District Plan closed on the 6<sup>th</sup> of October 2023 and the Council released the Appeals Version of the Partially Operative District Plan on 27<sup>th</sup> November 2023. Many provisions in Partially Operative District Plan are now beyond challenge and are operative/treated as operative (pursuant cl 103 of Schedule 1 and s86F of the Resource Management Act (1991). The Operative District Plan now only applies where a relevant provision in the Partially Operative District Plan remains subject to appeal. For more information visit <https://selwyn.govt.nz/property-And-building/planningstrategies-and-plans/selwyn-district-plan/selwyn-district-plan-review>

Resource Consent R307204  
To Create 3 Lots Zoned Urban / Living 1  
Completion Certificate 12/12/2005  
Granted By Local Authority Officer 27/05/2005

## Planning Notes

The information provided on this LIM has come from the information lodged against the property file/information and GIS at the time of processing. Please note that the resource consents, fill certificates and other relevant property files listed are based on what is available on our general property information, and that there may be other documents for the property which have not yet been added to the property record.

Resource Consents often contain a multitude of information and reports that are not ordinarily separately referenced or included in the LIM itself. Information identifying each (if any) special feature or characteristic of the land concerned, including but not limited to potential erosion, falling debris, subsidence, slippage, alluvion, or inundation, or likely presence of hazardous contaminants.

Preliminary Site Investigation Reports, Detailed Investigation Site Reports and Geotechnical Reports are submitted as part of the subdivision Resource Consent Process it is not likely to be currently of relevance in relation to the "land concerned", otherwise it would be elsewhere noted on the LIM to the extent any issues still apply following subdivision).

Any resource applications or consents that may contain information relating to the land which is not otherwise included in the LIM, including Geotechnical, Environmental and other expert reports, can be obtained via Selwyn District Council Information Management team on [information.management@selwyn.govt.nz](mailto:information.management@selwyn.govt.nz)

## Building

Building Consent 060466  
Domestic Dwelling  
Withdrawn

Building Consent 100902  
Garage With Sleepout  
CCC refused

Building Consent 060955  
Domestic Dwelling  
Code Compliance Certificate Issued 31/03/2009

Buildings erected prior to 1965 may not have a building permit record or had inspections carried out.

All building products and materials have a designed life, and must be maintained in accordance with the manufacturer's specifications.

In the case of building permits and building consents no further inspections have been carried out by the council since these structures were completed.

Any concerns of this nature should be referred to an organization that carries out property checks or the product manufacturers.

### **Schedule 1 Exempt Building Work**

Under section 42A of the Building Act 2004 building owners can carry out certain types of building work specified in Schedule 1 of the Building Act 2004 without need to obtain building consent approval. Where Council holds any information provided by a property owner in relation to exempt works undertaken on the property it is important to note that Council do not check or review the documentation for compliance, it is simply filed for record keeping purposes and not to satisfy any statutory obligation. Any information held of this nature has been provided at Councils discretion under Section 44A (3) of the Local Government Official Information and Meetings Act 1987 without any representation or warranty.

## **Services**

### **Water**

Council Water Scheme is available and connected.

This property is connected to a restricted water supply scheme - Hororata. The maximum number of water units permitted for this property under the zone rules is 1.5 units. The number of water units currently able to be supplied (piped capacity) is 2.14 units, based on the available hydraulic capacity of the scheme. 1 water unit = 1,000 litres per 24 hours (1,000 litres = approximately  $1\text{m}^3 = 100$  buckets). An average New Zealand household uses 250–300 litres of water per person per day. This does not include outdoor water use such as garden irrigation. A minimum of 2 units is generally recommended for a family dwelling. As this is a restricted supply, the property must have onsite storage equivalent to at least 3 days of supply. For example, if the property receives 2 units, the minimum storage required is 6,000 litres. If the property is located on a closed water scheme, no additional units would be available beyond the current piped capacity, even if the maximum zoning allocation is higher.

## Sewer

Council Sewer Scheme is not available

On-site sewage treatment and disposal.

The property is not serviced through Council sewer network. Any onsite wastewater treatment or changes to it will require Environment Canterbury consent.

If there is an existing domestic onsite wastewater treatment system on this property, the owner is responsible for ensuring regular maintenance and servicing is carried to ensure it continues to function satisfactorily.

Any new or replacement of domestic onsite wastewater treatment system will need to meet the requirements of Rule 5.8 of the Canterbury Land and Water Regional Plan to be considered a permitted activity and will require a building consent from Selwyn District Council prior to installation.

Any property with onsite sewage treatment and disposal, animal effluent disposal or water extraction for irrigation may have or require consent from Environment Canterbury and may require consent from the surrounding properties for a variety of discharges. This could have an adverse effect on the neighbouring property in relation to odour, potable water supply quality, or be of a general nuisance factor.

Information regarding what consents have been granted for this or surrounding properties can be obtained by contacting the issuing authority Environment Canterbury.

Land used to dispose of waste or to spread effluent or treated sewage, may be contaminated due to the concentrations or mix of material deposited onto the land over time. If any soil tests have been carried out, please forward a copy to the Council in order for the records to be updated.

For those properties not connected to a Council reticulated sewer system, it is important that the effluent system is regularly checked and maintained. You should also be aware of the limits on what can and should not be disposed of through these systems. Any concerns should be referred to an organization that carries out checks and maintenance or to the product manufacturers.

## Stormwater

EN10- Soakhole

This property may be located within an area covered by Environment Canterbury stormwater consent. It is the responsibility of the property owner to contact Environment Canterbury

customer services to ensure that any activity undertaken on site complies with the relevant consent conditions.

Note – the above describes the current roof water disposal type and does not reflect the future situation, which should be determined as part of the subdivision (if applicable). For more information please contact Council.

Copy of drainage plan attached.

If you have any questions about the Water, Sewage or Stormwater information above please contact the Selwyn District Council Water Department at 0800 SELWYN or [contactus@selwyn.govt.nz](mailto:contactus@selwyn.govt.nz)

## **Water Races**

None known

## **Drains**

None known

## **Kerbside Waste Collections**

The Council provides refuse and recycling collection services for most residential and rural residential properties where these properties occur alongside maintained public roads. Private roads and Right of Ways (as maybe referenced in the Transportation Notes pertaining to this LIM) will not be directly serviced as these access ways are not usually of a sufficient standard to be used safely and efficiently by the collection vehicles. This could also apply to other public roads or streets that are narrow and/or have a lack of vehicle turning facilities. Rural and high country areas and settlements are not covered by regular collection services however localised refuse drop off facilities maybe available for use in specific areas. For further details and advice on refuse collection and recycling services as they may pertain to the property please phone the Council's Asset department on phone 3472 800. [Selwyn District Council - Collection Days & Routes](#)

If your address shows “no results found”, this means:

- your property is not serviced directly by kerbside collections
- you have a new property and either
- you have requested for your property to be added to the route and it is in the process of being added
- you have not yet requested for your property to be added to the route.

Please contact the Council for further detail.

## Land and Building Classifications

### Energy Infrastructure and Transport

None known

### Culture and Heritage

None known

### Natural Environment

None known

### District-wide matters

None known

### Area-specific matters

None known

## Land Notes

Land Notes: There are height restrictions for buildings and trees surrounding the Hororata Domain which may affect this property. Please refer to the attached map to see location of these restrictions. For further information please refer to Variation No. 27 in the District Plan or alternatively contact Council's Planning Department on 0800 SELWYN (0800735996).

Land Notes: Central Plains Water Trust holds various resource consents to convey and apply irrigation water to land and to construct and operate a distribution network for the Central Plains Water Enhancement Scheme. Although this property is within the command area of the Scheme, it will not be directly affected by the distribution network.

Land Notes: For further information on the Central Plains Water Enhancement Scheme including relevant maps, please contact Selwyn District Council and/or Central Plains Water Limited.

Property owners can contact Central Plains Water Limited (CPW) to update their details on (03) 928 2960.

### Listed Land Use Register (LLUR):

Hazardous activities and industries involve the use, storage or disposal of hazardous substances. These substances can sometimes contaminate the soil. Environment Canterbury identifies land that is used or has been used for hazardous activities and industries. This

information is held on a publicly available database administered by Environment Canterbury called the Listed Land Use Register (LLUR). The Selwyn District Council may not hold information that is held on the LLUR, therefore, it is recommended that you check Environment Canterbury's online database at [www.llur.ecan.govt.nz](http://www.llur.ecan.govt.nz).

## Residential Swimming Pool

No pool registered to this property.

## Land Transport Requirement

Hawkins Road is a formed and sealed local road maintained by Selwyn District Council. Direct access is via a private right of way (ROW) which is not maintained by Council.

## Natural Hazards

This section sets out information that the Council holds relating to natural hazards, such as earthquake, tsunami, erosion, landslip, liquefaction/sedimentation and subsidence, wind and snow, or flooding/inundation.

Climate change is causing natural hazards to become more severe, occur more often, and affect a wider range of areas.

If the Property is identified below as being subject to a natural hazard, it may have been issued a building consent with a waiver or modification of the Building Code to confirm that building work will accelerate, worsen, or result in a natural hazard on the land on which the building work is to be carried out or any other property. If a waiver or modification has been issued, this will be noted in the Building section of the LIM above.

You can obtain further information about natural hazard matters from:

- The District Plan Natural Hazard chapter: [District Plan - Partially Operative Selwyn District Plan \(Appeals Version\)](#)
- [https://experience.arcgis.com/experience/f7b9c60d5a624147bb731b1afa7788dd#data\\_s=where%3AdataSource\\_2-19b106a45d6-layer-17%3A%22Assessment\\_ID%22%3D%272423020634%27&zoom\\_to\\_selection=true](https://experience.arcgis.com/experience/f7b9c60d5a624147bb731b1afa7788dd#data_s=where%3AdataSource_2-19b106a45d6-layer-17%3A%22Assessment_ID%22%3D%272423020634%27&zoom_to_selection=true)
- – use this map to view any of the natural hazards identified below that impact this Property or in the vicinity of the Property
- Our Duty Planner service at [planning.technical@selwyn.govt.nz](mailto:planning.technical@selwyn.govt.nz), or call 0800 SELWYN (735 996).

## Earthquake

All properties in New Zealand may be affected by earthquakes, however, the Council holds no additional information about potential earthquake hazards at this Property.

### Earthquake Prone Buildings

If this Property has an Earthquake Prone Building, this will be noted in the Building section of this LIM under “Earthquake Prone Buildings”.

## Erosion

### District Plan information relating to erosion

None known

## Landslip and Rockfall

### Regional mapping of landslides / rock avalanches

An earthquake hazard assessment for infrastructure commissioned by Environment Canterbury in 2006 included a regional-scale map of earthquake-induced landslide susceptibility and locations of known rock avalanches. Further information can be found in the technical report: [Selwyn District Engineering Lifelines Project: Earthquake Hazard Assessment](#), Geotech Consulting Ltd commissioned by Environment Canterbury, August 2006. The scope of this report is the Selwyn District. The purpose of the report was to assess earthquake hazards and their potential impacts on engineering lifelines (infrastructure) in Selwyn District.

Climate change may cause increased rain and storm intensity and frequency, and vegetation changes. These impacts of climate change may reduce the Property’s resilience and exacerbate the landslip and rockfall hazard.

None known

## Liquefaction and Subsidence

### Liquefaction / Geotechnical risk

The Property is within an area where liquefaction damage is possible in future earthquakes. The Selwyn District Council has mapped areas where a liquefaction assessment is required, and other areas where a liquefaction assessment is only needed for certain activities. [View Selwyn District Council’s maps](#). [View Selwyn District Plan rules relating to liquefaction / geotechnical planning requirements](#). Environment Canterbury has separately identified additional areas where liquefaction is possible. [View Environment Canterbury’s map showing areas where](#)

liquefaction is possible. Further information about liquefaction generally can be found in the following technical reports:

- Review of liquefaction hazard information in eastern Canterbury, including Christchurch City and parts of Selwyn, Waimakariri and Hurunui Districts, Environment Canterbury, December 2012. This report covers the Coastal Canterbury from the Waipara River mouth to the Rakaia River mouth, including Banks Peninsula, and inland to Rangiora, Aylesbury, Selwyn and Southbridge. The purpose of this report was to collate liquefaction occurrence during the 2010/11 Canterbury earthquakes, and to determine liquefaction vulnerability.
- Selwyn District Engineering Lifelines Project: Earthquake Hazard Assessment, Geotech Consulting Ltd commissioned by Environment Canterbury, August 2006. This report covers the Selwyn District. The purpose of the report was to assess earthquake hazards and their potential impacts on engineering lifelines (infrastructure) in Selwyn District and for use in infrastructure and emergency management planning.

Climate change may cause changes in groundwater and sea level rise. These impacts of climate change may reduce the Property's resilience and exacerbate the impacts of the liquefaction and subsidence hazard.

As part of any building consent application, you may need a site-specific assessment or site subsoil investigation to establish the level of susceptibility to liquefaction or to confirm that 'good ground' can be achieved for any building work. The scope and testing of any site-specific assessment must be carried out by a CPEng Geotechnical engineer. The ground bearing capacity in this area may not achieve the requirements of the NZ Building Code Clause B1, and specific design may be required. The definition of 'good ground' can be found in the Definitions section of the NZ Building Code Handbook, and appropriate test methods are detailed in either NZS3604, or NZBC B1/VM4.

Areas where there was evidence of liquefaction were mapped following the 2010/11 Canterbury earthquakes by Tonkin & Taylor for the Earthquake Commission (urban areas) and by a group of researchers for Environment Canterbury (rural, commercial and industrial areas). These are available on Environment Canterbury's liquefaction map. Further information can be found in the technical report: Review of liquefaction hazard information in eastern Canterbury, including Christchurch City and parts of Selwyn, Waimakariri and Hurunui Districts, Environment Canterbury, December 2012. This report covers Coastal Canterbury from the Waipara River mouth to the Rakaia River mouth, including Banks Peninsula, and inland to Rangiora, Aylesbury, Selwyn and Southbridge. The purpose of this report was to collate liquefaction occurrence during the 2010/11 Canterbury earthquakes, and to determine liquefaction vulnerability.

## Tsunami

None known

## Flooding and Inundation

### District Plan information relating to flooding and inundation

This Property is within the following flooding or inundation overlay(s) or areas in the District Plan. Information and reports about the relevant overlay are included below. Climate change may cause increased rain and storm intensity and frequency, and sea level rise. These impacts of climate change may reduce the Property's resilience and exacerbate any flooding and inundation hazard.

#### *Plains Flood Management Overlay*

The Plains Flood Management Overlay in the Council's District Plan identifies areas where flooding from a 200-year Average Recurrence Interval (ARI) flood event needs to be managed. View a map of the overlay. View the rules relating to the overlay. Further information can be found in the following technical reports:

- Selwyn River/Waikirikiri floodplain investigation, ECAN report, September 2019
- Regional Policy Statement Modelling for Selwyn District Council – District Plan, DHI Water and Environment Limited report, November 2019

### Environment Canterbury information regarding flooding and inundation

#### *Historic Flooding Photographs*

Photographs showing the property during or following past flood events may be available. Flood photographs are available on Environment Canterbury's [flood imagery register](#).

### Other flooding and inundation information

Climate change may cause increased rain and storm intensity and frequency, and sea level rise. These impacts of climate change may reduce the Property's resilience and exacerbate any flooding and inundation hazard.

#### *Flood modelling*

This Property may be susceptible to flooding from the Selwyn River and/or in heavy rainfall events. View the flood model results. More detail can be found in the technical report: Selwyn District Flood Model - Hydraulic Model Build Report, Tonkin + Taylor commissioned by Selwyn District Council, August 2025.

### Ground Water Level

The ground water level at this Property is Less than 30m below ground for this Property. A high ground water level may exacerbate any flooding at this Property, or the impact of any flooding at this Property.

## Exposure Zones

Exposure zones are standardised categories for a property's potential exposure to certain risks. Any proposed building work may need specific engineering design, depending on the exposure of the construction site. The categories are based on two standards: NZS3604:2011 and AS/NZS1170:2002.

	NZS3604:2011	AS/NZS1170:2002
<b>Wind Region</b>	A	A7
<b>Snow Zone</b>	N4	N4 Sub-alpine
<b>Earthquake</b>	Zone: 2	Z Factor: 0.3
<b>Approximate Altitude (Amsl)</b>	184m	-
<b>Exposure Zone</b>	B	-

## Exposure Zone Descriptions

### Zone B: Low

Inland areas with little risk from wind blown sea-spray salt deposits

### Zone C: Medium

Inland coastal areas with medium risk from wind blown sea-spray salt deposits. This zone covers mainly coastal areas relatively low salinity. The extent of the affected area varies significantly with factors such as winds, topography and vegetation.

### Zone D: High

Coastal areas with high risk wind blown sea-spray salt deposits. This is defined as within 500 m of the sea including harbours, or 100 m from tidal estuaries and sheltered inlets.

## Special Land Features

### Soil Type

Hororata stony and shallow silt loam

### Land Fill

None known

## Licences/Environmental Health

None known

## Network Utility Operators

Information related to the availability of supply, authorisations etc. (e.g. electricity or gas) can be obtained from the relevant Network Utility Operator.

## Other Information

1. The applicant is advised that the Environment Canterbury may have other information in relation to this property including, but not limited to:
  - a) Discharge consents.
  - b) Well permits.
  - c) Consents to take water.
  - d) The existence of contamination and/or hazardous sites.
  - e) Flooding.
  - f) Clean air discharge compliance.

Further information may be obtained from Environment Canterbury by requesting a Land Information Request (LIR). To find out more contact the Environment Canterbury on 0800 ECINFO (0800 324 636) or at <http://www.ecan.govt.nz/>

2. The following further information is supplied on the basis set out in note 2 below.

## Notes

1. The information supplied in the sections of this report, other than 'Other Information', is made available to the applicant pursuant to Section 44A(2) of the Local Government and Official Information Act 1987 by reference to Council files and records. No property inspection, or title search, has been undertaken. To enable the Council to measure the

accuracy of this LIM document based on our current records we would appreciate your response should you find any information contained herein which may be considered to be incorrect or omitted. Please telephone the Council on 0800 SELWYN (375 996).

2. The information or documents supplied to the applicant and referred to in the 'Other Information' section of this report has been supplied to the Council by property owners, their agents and other third parties. That information is made available pursuant to section 44A(3) of the Local Government and Official Information Act 1987 on the basis that:

- a) The information may be relevant to the purposes for which this report is obtained;
- b) The Council does not warrant or represent the accuracy or reliability of the information. If the subject matter of that information is important to the applicant it is recommended that relevant professional advice should be taken before reliance is placed upon that information.

3. The information included in the LIM is based on a search of Council records only and there may be other information relating to the land which is unknown to the Council. Council records may not show illegal or unauthorised building or works on the property. The applicant is solely responsible for ensuring that the land is suitable for a particular purpose.

#### 4. Schedule 1 Exempt Building Work

Building owners can carry out certain types of building work without needing to obtain a building consent. This exempt building work is listed in Schedule 1 of the Building Act 2004.

It is the owners' responsibility to ensure that any exempt building work done complies with the Building Code and fits within the provisions of the schedule before they carry out the work.

Please note that Council do not check or review documentation for compliance where information on exempt work has been provided by a property owner to Council. This information is simply filed for record keeping purposes and not to meet any statutory obligation.

Any information of this nature held by Council has been provided at Councils discretion under Section 44A (3) of the Local Government Official Information and Meetings Act 1987 without any representation or warranty.

5. The Council has used its best endeavors to ensure that all information provided in this LIM report is correct and complete in all material respects. In the event that a material error or omission can be proven the Council's liability, whether in contract or in tort shall be limited to the fee paid to Council to obtain this report.

6. This information reflects the Selwyn District Council's current understanding of the site, which is based only on the information thus far provided to it and held on record concerning

the site. It is released only as a copy of those records and is not intended to provide a full, complete or totally accurate assessment of the site. As a result the Council is not in a position to warrant that the information is complete or without error and accepts no liability for any inaccuracy in, or omission from, this information.

7. The information contained in this Land Information Memorandum is current at the date the memorandum is issued. Further relevant information may come into the Council's possession subsequent to the date of issue.

Information Management Team

Date: 13/05/2026

# LIM Report Legend

## Base Layers

- Road
  - Road
- Railway
  - Railway
- District Boundary
  - ⬡ District Boundary
- Township Boundary
  - ⬡ Township Boundary
- Ratepayer Information
  - Ratepayer Information
- Parcels
  - Parcels

## PODP - Zones and Precincts

- Precincts
  - ⬡ Commercial Precincts
  - ⬡ Industrial Precincts
  - ⬡ Airfield Precincts
  - ⬡ Rural Precincts

## Zones

- Large lot residential zone
- Low density residential zone
- General residential zone
- Medium density residential zone
- Settlement zone
- General rural zone
- Neighbourhood centre zone
- Local centre zone
- Large format retail zone
- Town centre zone
- General industrial zone
- Special purpose zone

## Zone and Water Services

### SWL Water Points

- Supply Point
- Valve
- Node
- Hydrant
- Tank
- Irrigation
- Equipment
- Facility
- Meter
- Fire Plant

### SWL Water Lines

- Pipe - Treated
- Irrigation
- Pipe - Untreated
- Pipe - Sewer
- Pipe - Unknown
- Other

### SWL Private Water Points

- 

## SWL Private Water Lines

- 

### SDC Water Points

- EQUIPMENT - BORE
- EQUIPMENT - GENERATOR
- EQUIPMENT - SAMPLE TAP
- EQUIPMENT - OTHER
- FACILITY
- FIRE PLANT
- HYDRANT
- IRRIGATION
- NODE
- OBSOLETE
- SUPPLY POINT
- TANK
- VALVE

### SDC Water Lines

- DIM LINE
- DUCT
- IRRIGATION
- NON SDC SERVICE
- OBSOLETE
- OUTLINE
- PIPE - TREATED
- PIPE - UNTREATED
- PIPE - SEWER
- SITE\_BOUNDARY

### SWL Sewer Points

- Manhole
- Valve
- Chamber
- Node
- Equipment
- Facility

### SWL Sewer Lines

- Gravity
- Pressure
- Rising
- Other

## SWL Private Sewer Points

- 

### SWL Private Sewer Lines

- 

### SDC Sewer Points

- TYPE
- CHAMBER
- EQUIPMENT
- FACILITY
- MANHOLE
- NODE
- VALVE

### SDC Sewer Lines

- OUTLINE
- DIM LINE
- DUCT
- IRRIGATION
- NON SDC SERVICE
- OBSOLETE
- OUTLINE
- PIPE\_GRAVITY
- PIPE\_RISINGMAIN
- SITE\_BOUNDARY

### Storm Points

- TYPE
- CHAMBER
- EQUIPMENT
- FACILITY
- INLET/OUTLET
- MANAGEMENT
- MANHOLE
- NODE
- SOAKHOLE
- SUMP
- VALVE

### Storm Lines

- TYPE
- CHANNEL
- DIM LINE
- OBSOLETE
- OUTLINE
- PIPE

## SITE\_BOUNDARY

- Soakhole w/Hoz Soakage
- StopBank

## Storm Polygons

- TYPE
- CATCHMENTS
- CONSENT AREA
- GROUNDWATER LESS 6M
- OUTLINE OF BASIN
- RATED AREA

## Stormwater Management Area

- Stormwater Management Area

## West Melton Observatory Zone

- West Melton Observatory Zone

## Planning Zones

- High Country
- Port Hills
- Existing Development Area
- Living 1
- Living 2
- Living 3
- Living X
- Living West Melton (North)
- Living Z
- Deferred Living
- Business 1
- Business 2
- Business 3
- Inner Plains
- Outer Plains
- Malvern Hills
- Key Activity Centre
- Living West Melton (South)

## Liquefaction Drains and Water Race

### CDrain\_pt

- GATE
- Site
- WEIR

### CDrain\_In

- DRAIN
- ECan
- OUTLINE
- StopBank
- Site Boundary

### WRace\_pt

- DISCHARGE
- DIVIDE
- EQUIPMENT
- GATE
- GRILL
- HEADWALL
- MANHOLE
- NODE
- POND
- SHAFT
- SOAKHOLE

### WRace\_In

- AQUEDUCT
- CULVERT
- DIM LINE
- EMERGENCY DISCHARGE
- INTAKE
- LATERAL
- LOCAL
- MAIN
- OBSOLETE
- OUTLINE
- SIPHON
- TUNNEL

## SDC Cleaned

- SDC Cleaned

## Project Extent

- Project Extent

## Boundary Between Liquefaction Assessment Zones

- Boundary Between Liquefaction Assessment Zones

## Liquefaction Susceptibility

- DBH TC Zoned Area
- Damaging liquefaction unlikely
- Liquefaction assessment needed

## Ecan River Protection Scheme

- Properties Beside Rivers
- Halswell Staff Gauges
- Halswell Floodgates
- Halswell Drainage

## Greendale Fault

- Greendale Fault 50m Buffer
- Fault Lines (GNS 2013)
- Folds (GNS 2013)

## Biodiversity

- Canterbury Plains SDC AB and C Classes
- Endangered Flora and Fauna
- Potentially Significant Sites
- Confirmed SNA Sites
- Significant Natural Areas (Final 115)

# LIM REPORT - Zone and Water Services

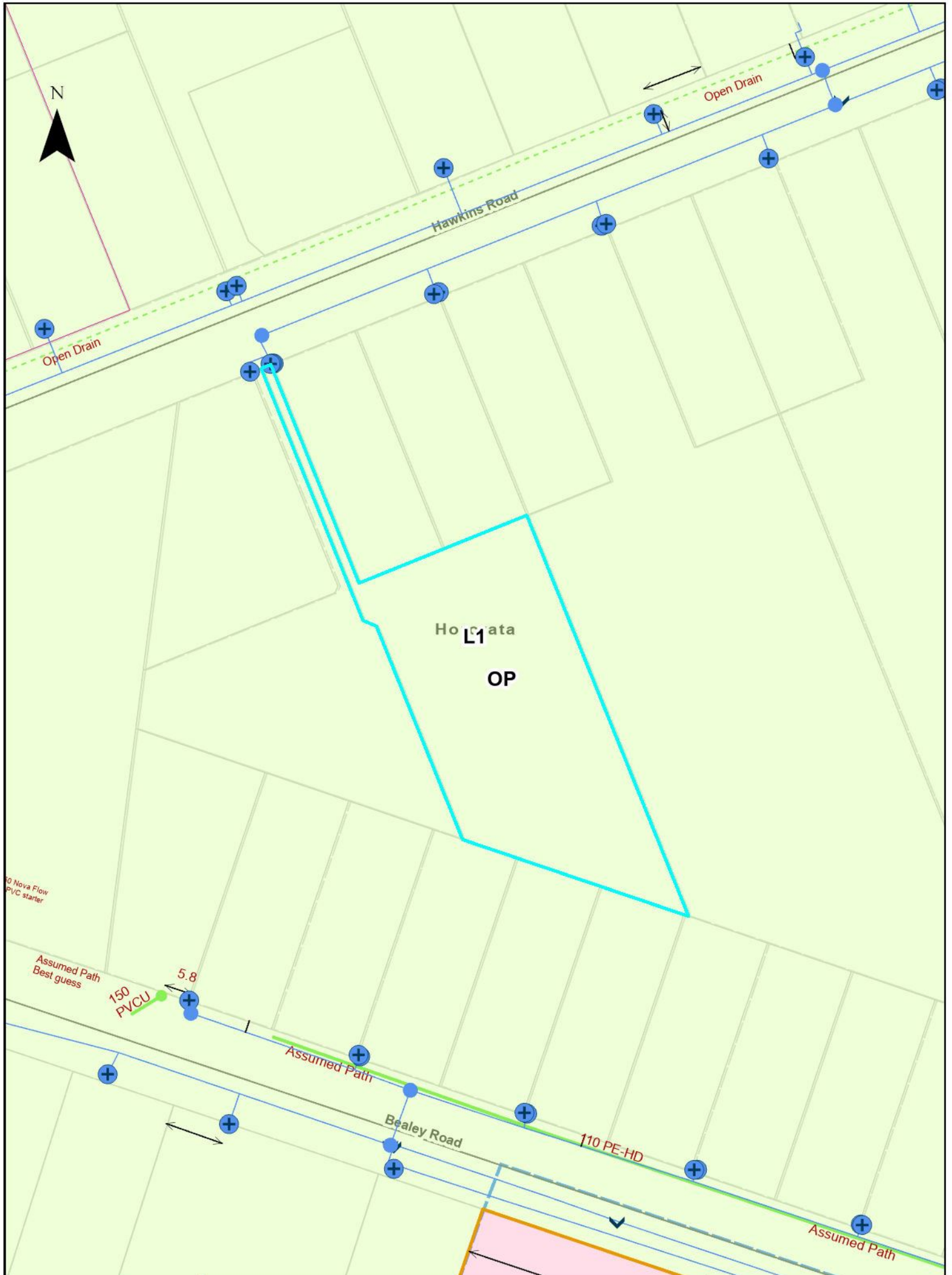

# LIM REPORT - PODP Zone and Precinct

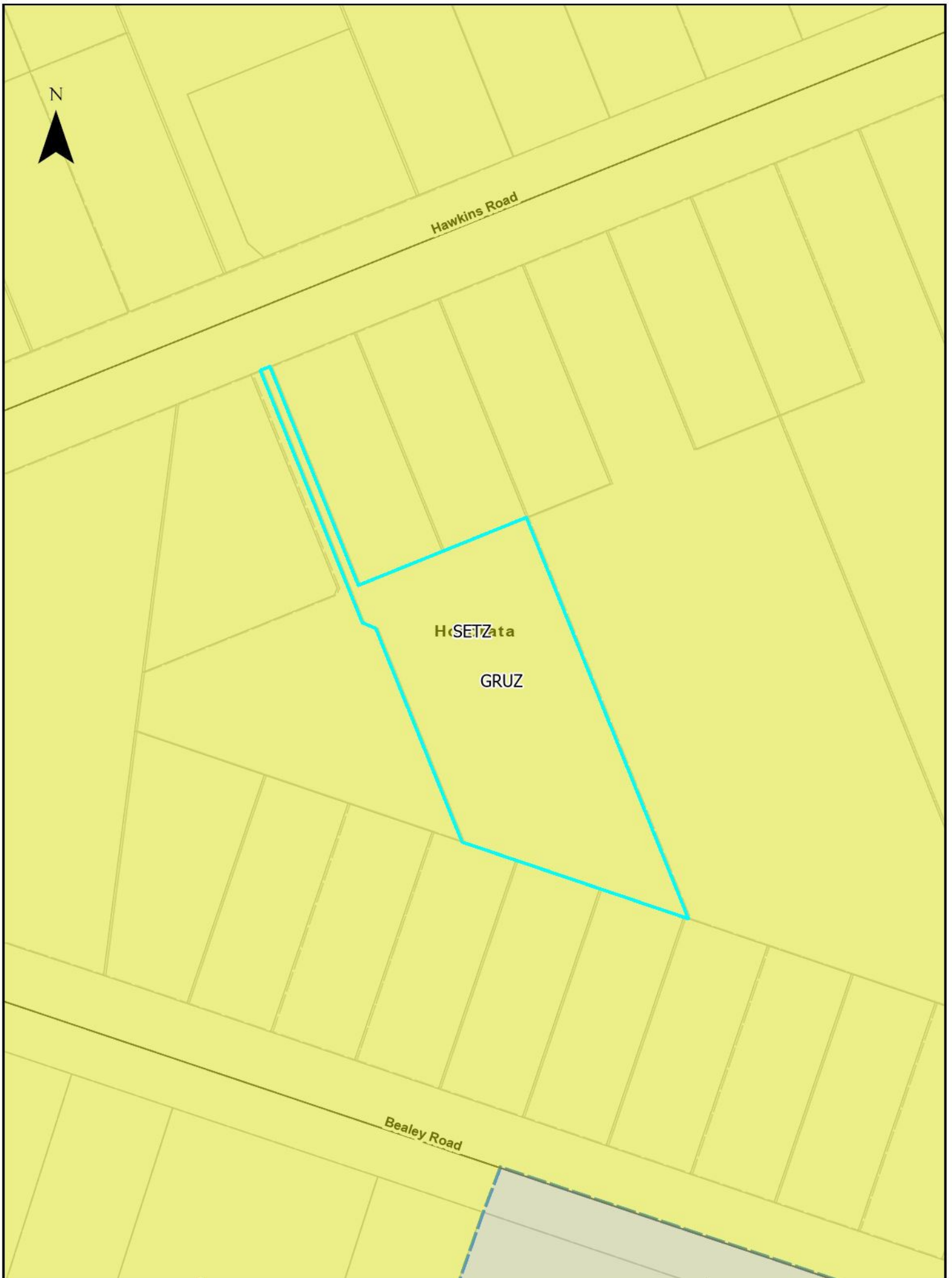

## RESOURCE CONSENT INFORMATION

This document is one of three pages titled “Resource Consent Information” which should be read together.

- Because of the large number of resource consents only consents which fall within the red buffer as identified on the map have been included with this report.
- If further information is required please contact the Council’s Planning Department – Phone Direct 03 3472 868.
- Every effort is made by the Council to identify resource consent in proximity to the property subject to this LIM application. However, it is suggested that a site inspection be undertaken by prospective purchasers to identify any land uses of interest. These may include uses which have existing use rights or other uses which are permitted under the Council’s District Plan.

### Resource Consent Status Codes:

GHP	Granted by Hearing
GEC	Granted by Environment Court
GDEL	Granted by Delegation
GCOM	Granted by Commissioner
DCOM	Declined by Commissioner
DHP	Declined by Hearing
WD	Withdrawn application
AP	Approved
DC	Declined
Blank	No decision issued
DN	Decision Notified

ADN	Appeal Decision Notified
AE	Appeal expiry
AEC	Appeal Heard by Environment
AN	Abatement Notice
AR	Appeal received
ARI	Application returned incomplete
AWD	Appeal withdrawn
CC	Cancelled
CCI	Certificate Compliance Issued
D37	Deferred under s.37
D37E	s.37 deferral ends
D91	Deferred under s.91
D91E	s.91 deferral ends
ECDN	Environment Court Decision notified
FI	Further Information
FICR	Further Information request - no clock restart
FR	Formally received
HD	Hearing Date
HH	Hearing held
INV	Invoiced
IR	Information received
LAPS	Lapsed
LD	Lodged
LN	Limited Notified
LS	Lapsed
ODN	Objection decision notified
OH	On Hold
OR	Objection received

PA	Pre- application
PN	Publically notified
PS	Process suspended
RAD	Recommendation adopted by Council
RRA	Recommendation to required authority
S223	Section 223
S224	Section 224
SC	submissions closed
WAR	Written Approval Requested
WARE	Written Approvals Received

2423020634

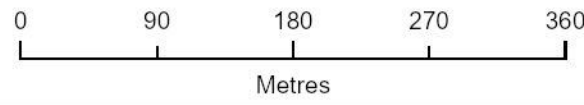
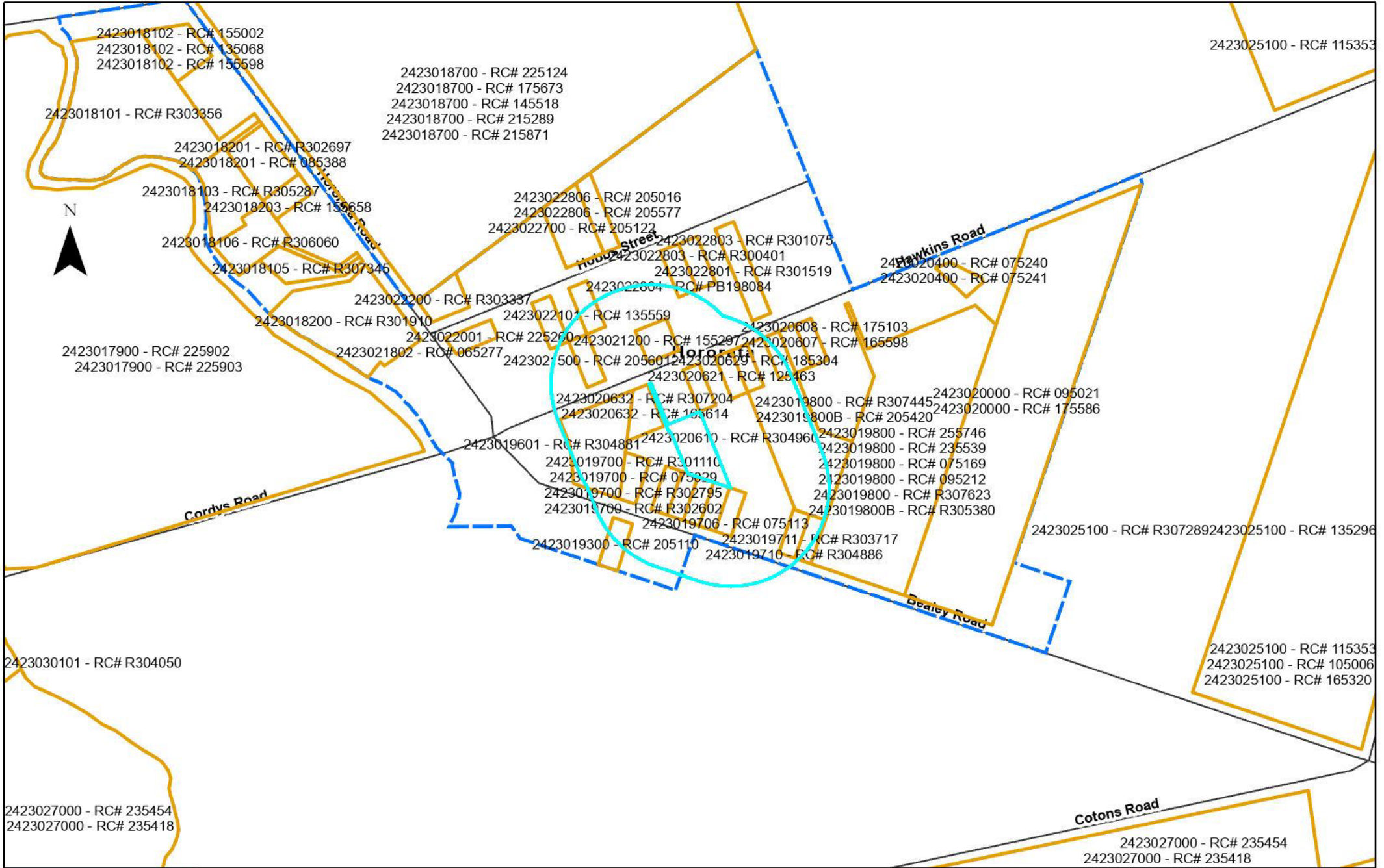

Date: 11/05/2028  
 Cadastral Information derived from Land Information  
 New Zealand's Digital Cadastral Database (DCDB)  
 CROWN COPYRIGHT RESERVED  
 Approved for internal reproduction by Selwyn District Council  
 Digital Licence No.133562-01  
 Data Projection: NZGD2000 - New Zealand Transverse

Assessment_ID	RC Number	Proposal	Decision Date
2423019300	205110	To relocate a dwelling.	2020-03-12
2423019601	R304881	TO ESTABLISH & OPERATE A RETAIL OUTLET IN EXISTING DWELLING INCLUDING SIGNAGE	2001-05-24
2423019700	075029	RELOCATE DWELLING	2007-03-16
2423019700	R301110	TO CREATE 24 RESIDENTIAL LOTS	1994-09-01
2423019700	R302602	RELOCATE DWELLING	1997-03-03
2423019700	R302795	RELOCATE DWELLING	
2423019702	135174	To relocate dwelling.	2014-01-23
2423019703	135423	To relocate dwelling and detached garage to Hororata	2013-09-10
2423019704	195361	To relocate a dwelling and construct a vehicle crossing in a non-complying position	2019-07-12
2423019705	R305487	RELOCATE DWELLING	2002-05-08
2423019706	075113	TO RELOCATE DWELLING	2007-05-11
2423019710	R304886	TO ERECT DWELLING WITH SEWAGE DISPOSAL SYSTEM & NON COMPLYING LENGTH	2001-04-02
2423019711	R303717	TO ERECT A GARAGE IN NON-COMPLYING POSITION	1999-03-23
2423020609	R306614	TO ERECT DWELLING WITH NON-COMPLYING SITING	2004-02-17
2423020610	R304960	TO ERECT DWG WITH SEWAGE DISPOSAL SYSTEM	2001-06-12

2423020620	R307165	TO RELOCATE DWELLING TO A RURAL LOT	2004-12-16
2423020621	125463	Fast track. Lot 6 DP 77341. To erect garage in a non-complying position	2012-12-21
2423020629	125309	To relocate dwelling	2012-11-19
2423020629	185304	To relocate dwelling	2018-06-25
2423020632	R307204	TO CREATE 3 LOTS ZONED URBAN / LIVING 1	2005-05-27
2423020632	165614	To relocate a dwelling	2016-12-08
2423021200	155297	To undertake a subdivision to create four new residential allotments.	2015-06-23
2423021500	205601	To relocate an existing dwelling onto the subject site.	2020-10-07
2423022001	225260	To relocate an existing dwelling to the site.	2022-04-14
2423022101	135559	Lot 1. Relocate a dwelling	
2423022804	PB198084	FAST TRACK - To erect a dwelling with restricted discretionary siting	2019-06-07

**Code Compliance Certificate** **COPY** **060955**  
**Section 95, Building Act 2004**

**The Owner**

Name of Owner: Hore Kurt Michael & Hore Keryn Marie  
Mailing address: PO Box 86, HORORATA 7544  
Street address/registered office:  
Phone number:  
Landline: Daytime: 347 6422  
Mobile: 0210608850 After hours: 347 6422  
Facsimile number:  
Email address:  
Website:

**The Building Work**

Street Address of Building: HAWKINS ROAD, HORORATA  
Legal Description of land where building is located: LOT 3 DP 355380 BLK XII HORORATA SD  
Valuation Number: 2423020634  
Current lawfully established use: DOMESTIC DWELLING  
Type of work: 3 Bedroom Dwelling with Rumpus Room plus Solid Fuel Heater in Lounge. – 161sqm.  
Estimated Value: \$165,000  
Location of building within site/block number:  
Building Name: Year Construction 2006  
Commenced:

**Code Compliance Certificate:**

The Building Consent Authority named above is satisfied on reasonable grounds, that the Building work complies with the Building Consent



Selwyn District Council Building Consent Authority Signatory

Issue Date: 31/03/09

26 October 2023

K Hore  
P O Box 86  
Hororata 7544

Dear Sir/Madam

**RE: REFUSAL OF CODE COMPLIANCE CERTIFICATE**

**Building Consent: 100902**  
**Project: Garage with Sleepout**  
**Address: 1/367 Hawkins Road Horotata**

Section 93 of the Building Act 2004 prescribes that a Building Consent Authority must decide whether to issue a code compliance certificate within:

- a) 20 working days from the date on which application for a code compliance certificate is made; or
- b) 2 years after the date on which the building consent for the building work was granted; or
- c) any further period that may be agreed between the Building Consent Authority and Owner

The Council has completed a review of your project and the records received throughout construction. Please accept this letter as formal notice under Section 95A of the Building Act 2004 that the Building Consent Authority refuses to issue the code compliance certificate for the following reasons:

- A review of council records has identified that the work in relation to this building consent has not received a Code of Compliance Certificate (CCC).
- Our records show that the building work, when last inspected remained incomplete and therefore not in accordance with the approved plans.

The Decision has been made to refuse CCC at this time. Please note that you may reapply for a Code Compliance Certificate in the future when all items have been addressed and Council will reconsider its decision at that time.

Should you wish to contest Council's decision, then an application must be made to the Ministry of Business, Innovation and Employment for a determination. Information on determinations is available on the following website:

<http://www.building.govt.nz/resolving-problems/resolution-options/determinations>  
or by telephone to 0800 242 243.

Yours faithfully



Karen Fitzpatrick  
Contractor

Hawkins Rd Hororata

T. McKay Dramage

21-3-07

BC 060955

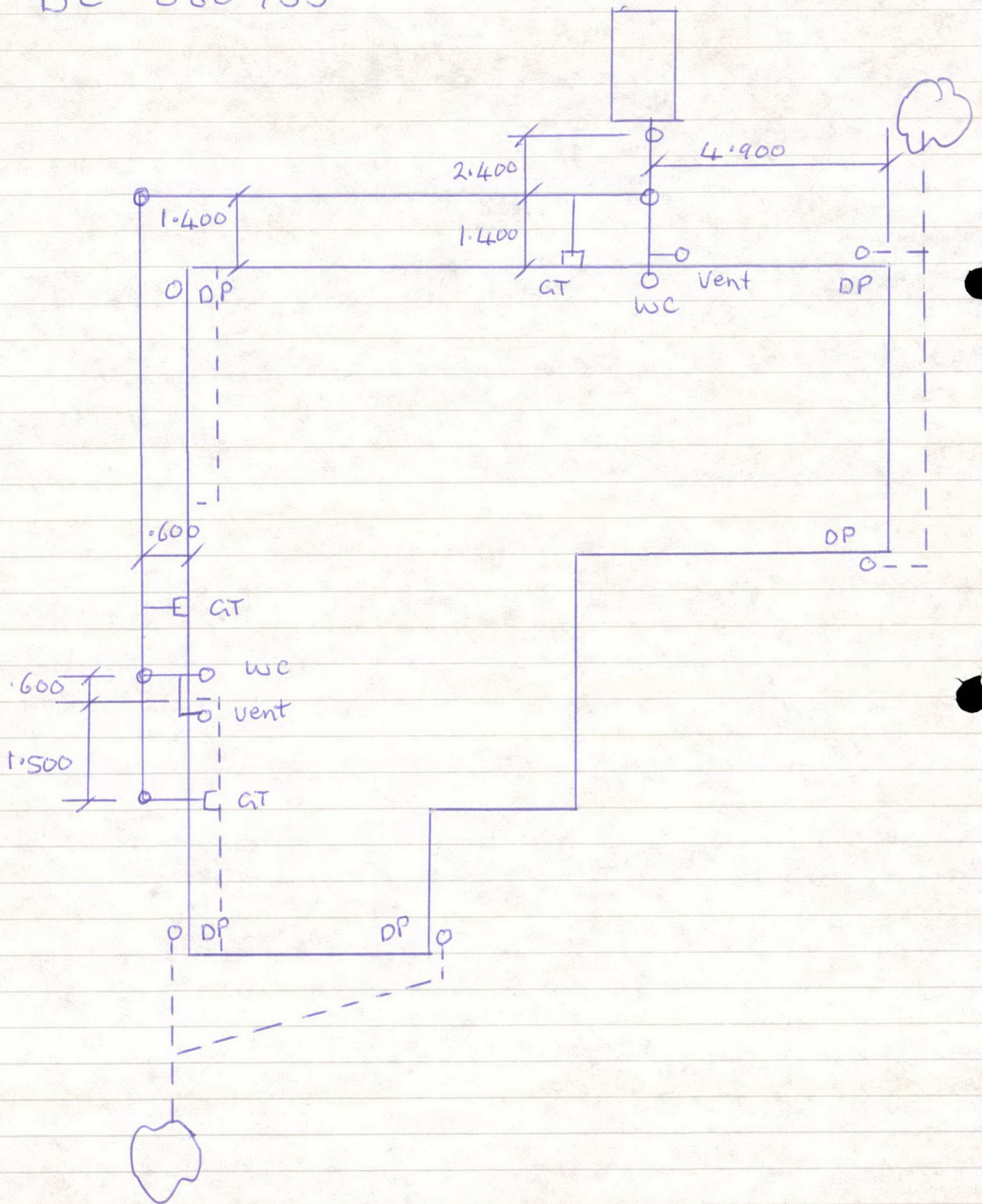



## **IMPORTANT INFORMATION TO ALL NEW HOME/LAND OWNERS**

### **STREET TREES AND IRRIGATION**

The Selwyn District Council would like to make all new home/land owners and their contractors aware of the process of gaining approval to relocate/remove street trees, or alter Council irrigations systems.

In some areas of the Selwyn District, various types of linked dripper irrigation systems are installed to water establishing street trees. In some cases, the system has not been installed very deep in the ground. It is particularly important that any contractors who are going to be excavating within road berms are aware of this and excavate carefully to locate irrigation lines or drippers, or seek assistance from Council as to their presence/location before excavating. Similarly, care should be taken when excavating near street trees to avoid damage to tree roots.

The developer has put a lot of effort into enhancing the streetscape and providing an attractive environment within your subdivision. It is accepted that in some cases when a new home is built, a planted street tree and associated irrigation system may need to be shifted or removed to facilitate vehicle access to the site. Upon formal request, Council will consider giving approval for such changes to the initial planting plan or irrigation system on a case by case basis, after exploring all alternative options available.

Where it has been qualified that trees can be removed or relocated and/or an irrigation system needs to be shifted, then these works are to be organised by Council and/or the Developer and carried out by one of their approved contractors. All costs associated with these works are to be borne by the requesting land owner.

Please be aware, that in some situations, street trees can be removed and landscaping in a subdivision might still be under the management of the developer. In such cases, Council should still be contacted in the first instance, who will forward the request onto the developer for a response.

The following procedure is to be followed by a land owner who is wanting to request removal or relocation of a street tree and/or associated irrigation systems, in order to facilitate vehicle access to their property.

Requests for the removal or shifting of a tree must be made in writing to the Council Reserves Department stating:

- Street address of the property and the lot number;
- Name of the contact person;
- Contact details;
- Reason for the tree to be removed

On receipt of this formal request, Council staff will assess the following:

- Quality of the tree and whether or not the tree can successfully be moved;
- Whether an irrigation system is present and also needs shifting or decommissioning;
- Any conditions of sale by the developer;
- Any Resource Consent conditions;
- Streetscape theme and amenity value contribution of the tree.

If a tree is not able to be shifted and has to be removed, the landowner may also be required to pay for the cost to plant another tree of the same species and of similar size within the road berm as a replacement.

If an agent of the land owner makes the request to Council, then the agent is deemed to be the person responsible for the payment of all expenses relating to this procedure.

#### CARE FOR ESTABLISHING STREET TREES

Although the Developer and/or Council endeavours to water in newly planted street trees during their initial establishment years, the public is encouraged to assist with watering trees on your road berm. Establishing a tree in an urban environment faces many challenges so give your tree the best chance of reaching its full potential and value.

Council implements an annual programme of street tree inspections and maintenance throughout the district. Street tree maintenance is the responsibility of the Council, who employs a contractor to provide arboricultural services. It is critical that any other tree maintenance required is undertaken by our appointed contractor to ensure consistency in both quality and tree form.

Please contact us by lodging a Service request if your tree requires any tree maintenance.

Thank you for your assistance and co-operation

Reserves Maintenance Staff  
**Selwyn District Council**

# Be water wise



Reducing water use is important as Selwyn households tend to be high users of water. Residential properties connected to a Council supply used an average of 1,470 litres of water per day in 2012/13 and 1,386 litres per day in 2011/12. As a comparison, typical household use in New Zealand is around 675 litres per day.

Part of the reason why Selwyn households have higher water consumption is because properties tend to have large sections and over dry summers water use can increase

significantly. Additional bores can be added to increase the capacity of Council water supplies, but this is costly and unsustainable.

Over summer, demand for water is much higher than in winter, as people use more water to maintain their lawns. When demand for water is very high during dry summers, water restrictions can be introduced if necessary.

Demand is especially high at the peak times of 6–9am in the morning and 4–9pm in the evening, when people

use water for cooking, washing and dishwashers, and often water their lawns at the same time.

We are asking everyone to be careful about how they use water, especially in summer when there is more demand for water. Some areas like Rolleston and Darfield also pay for their water based on metered use so reducing your water consumption will mean you spend less on water bills.

## How much water do you use?

This chart shows the amount of water typically used for different household activities. Once you know where your water is going, you can think about how you could reduce your water use. If your water is metered and billed this will help reduce how much you spend on water.

Kitchen—Activity	Water used	Buckets
Dishwashing by Hand	12 to 15 litres per wash	1–1½
Dishwasher	20 to 60 litres per wash	2–6
Drinking, Cooking, Cleaning	8 litres per person	¾–1
Bathroom—Activity	Water used	Buckets
Toilet	4.5 to 11 litres per flush	½–1
Bath	50 to 120 litres (half full)	5–12
Shower (8 minutes)	70 to 160 litres per 8 minutes	7–16
Handbasin	5 litres	½
Tap Running (Cleaning teeth, washing hands)	5 litres	½
Leaking Tap	200 litres	20
Laundry—Activity	Water used	Buckets
Washing Machine (Front loading)	23 litres per kg of dry clothing	4–5
Washing Machine (Top Loading)	31 litres per kg of dry clothing	5–6
Outside—Activity	Water used	Buckets
Hand Watering by Hose	600 to 900 litres per hour	60–90
Garden Sprinkler	Up to 1500 litres per hour	150
Car Wash with Hose	100 to 300 litres	10–30
Filling Swimming Pool	20,000 to 50,000 litres	2,000–5,000
Leaking Pipe (1.5mm hole)	300 litres per day	30



## Tips for managing your water use

You can help manage your water consumption wisely by following these tips:

### Your garden and lawn

- Water your garden and lawn every few days rather than every day. Wetting the soil surface every day encourages roots to develop at the surface, making them more vulnerable to hot dry spells.
- Water your garden and lawn outside of peak water usage hours (avoid 6am–9am, and 4pm–9pm). Watering in the early morning (before 6am) or late evening (after 9pm) will minimise evaporation loss. Also avoid watering in a Nor' West wind as the water will quickly evaporate.
- Using a watering can or hand watering plants by hose often uses far less water than a sprinkler.
- Use a timer to avoid overwatering as it makes plants more susceptible to fungus diseases and will leach out soil nutrients.
- Use mulch or cover the soil with a layer of organic matter to keep the soil moist. Mulches help protect plant roots from drying effects of sun and wind and also reduce weed growth.

- Check if the soil needs watering by digging down with a trowel and having a look. This is a more accurate way to see if watering is needed than looking at the surface.
- Check you have the right head for your sprinkler. Sprinklers should apply water gently so that it seeps into the soil. Some sprinklers apply water faster than the soil can absorb.
- When planting choose drought resistant plants that don't require a lot of water.



### Outdoors

- Wash your car with a bucket of water rather than a hose.
- Use a broom rather than hosing down paths and driveways.
- Inspect hoses and taps both indoors and outdoors to check for leaks which waste water.
- Collect rainwater for use watering gardens and lawns.
- If you have a swimming pool, keep it covered to stop the water evaporating.

### Indoors

- Reduce your water consumption at the peak times of 6-9am and 4-9pm. Easy ways to do this include using your washing machine after 9pm at night, and putting your dishwasher on just before you go to bed.
- Take a short shower instead of a bath.
- Don't switch on the dishwasher or washing machine until you have a full load.
- Use a half flush when using the toilet.

# Buying or selling your property?

**REA**  
REAL ESTATE AUTHORITY  
TE MANA PAPAWHENUA

---

New Zealand Residential Property  
Sale and Purchase Agreement Guide





## This guide tells you...

---

what a sale and purchase agreement is

---

what's in a sale and purchase agreement

---

what happens after you sign the sale and purchase agreement

---

what happens if you have a problem

---

where to go for more information

### Where to go for more information

This guide is available in other languages. You can find translated copies of this guide on [rea.govt.nz](https://www.rea.govt.nz) and [settled.govt.nz](https://www.settled.govt.nz).

The New Zealand Residential Property Agency Agreement Guide is also available on [settled.govt.nz](https://www.settled.govt.nz). The guide tells you more about the agreement you sign with the agency helping to sell your property.

**We welcome any feedback you have on this publication.**

The information in this guide was accurate when published. However, the requirements this information is based on can change at any time. Up-to-date information is available at [rea.govt.nz](https://www.rea.govt.nz).

# Key things to know about sale and purchase agreements

---

- A sale and purchase agreement is a legally binding contract between you and the other party involved in buying or selling a property.
- You must sign a written sale and purchase agreement to buy or sell a property.
- You need to read and understand the sale and purchase agreement before you sign it.
- Even if a standard sale and purchase agreement is being used, you should always get legal advice before you sign the agreement and throughout the buying and selling process.
- You can negotiate some of the terms and conditions in a sale and purchase agreement.
- You can include additional clauses, such as what to do if there are special circumstances. Your lawyer plays an important role in providing advice on what the sale and purchase agreement should say.
- A sale and purchase agreement becomes unconditional once all the conditions are met.
- In most cases, the real estate professional is working for the seller of the property, but they must treat the buyer fairly.
- If your real estate professional or anyone related to them wants to buy your property, they must get your written consent to do this. They must also give you a valuation of your property by an independent registered valuer.
- The sale and purchase agreement is only available in English. You may need assistance interpreting it if English is not your primary language.

## What a sale and purchase agreement is

---

A sale and purchase agreement is a legally binding contract between you and the other party involved in buying or selling a property. It sets out all the details, terms and conditions of the sale. This includes things such as the price, any chattels being sold with the property, whether the buyer

needs to sell another property first or needs a property inspection and the settlement date.

A sale and purchase agreement provides certainty to both the buyer and the seller about what will happen when.



# What's in a sale and purchase agreement

Your sale and purchase agreement should include the following things.

## Basic details of the sale

Different sale methods like tender or auction might mean the sale and purchase agreement can look different, but all sale and purchase agreements should contain:

- the names of the people buying and selling the property
- the address of the property
- the type of title, for example, freehold or leasehold
- the price
- any deposit the buyer must pay
- any chattels being sold with the property, for example, whiteware or curtains
- any specific conditions you or the other party want fulfilled
- how many working days you have to fulfil your conditions (if there are any conditions)
- the settlement date (the date the buyer pays the rest of the amount for the property, which is usually also the day they can move in)
- the rate of interest the buyer must pay on any overdue payments (such as being late on paying the deposit or the remaining amount at the settlement date).

## General obligations and conditions you have to comply with

The sale and purchase agreement includes general obligations and conditions that you will need to comply with. For example, these may include:

- access rights – what access the buyer can have to inspect the property before settlement day
- insurance – to make sure the property remains insured until the settlement date and outline what will happen if any damage occurs before settlement day
- default by the buyer – the buyer may have to compensate the seller if they don't settle on time, for example, with interest payments
- default by the seller – the seller may have to compensate the buyer if they don't settle on time, for example, by paying accommodation costs
- eligibility to buy property in New Zealand – people who have migrated to New Zealand may not be permitted to immediately buy property or may need to get consent from the Overseas Investment Office.

Your lawyer will explain these clauses to you.

### Check...

Always check your sale and purchase agreement with a lawyer before signing.

Buying or selling a property where the owner isn't able to participate, like a mortgagee sale or deceased estate, can mean the real estate professional has limited information about the property. It pays to allow for this when deciding what conditions the buyer and seller might need.

### Remember...

Before you sign a sale and purchase agreement, whether you're the buyer or the seller, the real estate professional must give you a copy of this guide. They must also ask you to confirm in writing that you've received it.

## Specific conditions a buyer may include

Some buyers will present an unconditional offer, which means there are no specific conditions to be fulfilled. Some buyers will include one or more conditions (that must be fulfilled by a specified date) in their offer such as:

- title search – this is done by the buyer's lawyer to check who the legal owner of the property is and to see if there are any other interests over the property such as caveats or easements
- finance – this refers to the buyer arranging payment, often requiring bank approval for a mortgage or loan
- valuation report – a bank may require the buyer to obtain a valuation of the property (an estimate of the property's worth on the current market) before they agree to a loan
- Land Information Memorandum (LIM) – provided by the local council, this report provides information about the property such as rates, building permits and consents, drainage, planning and other important information
- property inspection – a buyer paying for an inspection provides an independent overview of the condition of the property rather than relying on an inspection that has been arranged by the seller

- engineer's or surveyor's report – similar to the above but more focused on the entire section and the structure of the property
- sale of another home – the buyer may need to sell their own home in order to buy another.

The real estate professional helps the buyer and the seller to include the conditions they each want. Even though the real estate professional works for the seller, they also have to deal fairly and honestly with the buyer. While they're not expected to discover hidden defects, they can't withhold information and must tell the buyer about any known defects with the property. If a buyer needs time to check a property for defects, including a property inspection condition may be important.



# What happens after you sign the sale and purchase agreement

---

Signing the sale and purchase agreement is not the end of the sale or purchase process.

## Both parties work through the conditions until the agreement is unconditional

A conditional agreement means the sale and purchase agreement has one or more conditions that must be met by a specified date and before the sale goes through.

The buyer pays the deposit. Depending on what the sale and purchase agreement says, the buyer may pay the deposit when they sign the agreement or when the agreement becomes unconditional. If the deposit is made to the real estate agency, it must be held in their agency's trust account for 10 working days before it can be released to the seller.

## An agreement for sale and purchase commits you to buy or sell

Once you've signed the sale and purchase agreement and any conditions set out in it have been met, you must complete the sale or purchase of the property.

The length of time between the conditions being met and the settlement date varies. Settlement periods can be lengthy if the property hasn't been built yet or the sale and purchase agreement includes conditions for one party to buy or sell another property. The real estate professional has obligations to keep you informed of important updates that come up during this time.

## Pre-settlement inspection

This is the chance for the buyer to check the property and chattels are in the same condition they were when the sale and purchase agreement was signed and to check that the seller has met any conditions, for example, there is no damage to walls or chattels haven't been removed from the property.

It's important to raise any concerns you find at the pre-settlement inspection with your lawyer and the real estate professional as soon as possible to allow enough time for an issue to be resolved. If it's less than 24 hours before settlement, the vendor may not be obligated to set things right.

## Payment of a commission

Once the sale is complete, the seller pays the real estate professional for their services. The real estate agency usually takes the commission from the deposit they're holding in their trust account. The seller should make sure the deposit is enough to cover the commission. The real estate professional cannot ask the buyer to pay for their services if they have been engaged by the seller.

## The buyer pays the rest

The buyer pays the remainder of the amount for the property on the day of settlement, usually through their lawyer.

## Buying a tenanted property

If the property is tenanted, the agreement for sale and purchase should specify this. It may also contain a specific date for possession that may differ from the settlement date.

If the buyer requires the property to be sold with 'vacant possession', it is the seller's responsibility to give the tenant notice to vacate in accordance with the tenant's legal rights.

It is recommended that you seek legal advice if you are buying a property that is currently tenanted.

## What happens if you have a problem

---

If something has gone wrong, first discuss your concern with the real estate professional or their manager. All agencies must have in-house procedures for resolving complaints.

If you can't resolve the issue with the real estate agency or you don't feel comfortable discussing it with them, you can contact the Real Estate Authority (REA). We can help in a number of ways if your complaint is about the real estate professional. For example, we can help you and the real estate professional or agency to resolve

the issue and remind them of their obligations under the Real Estate Agents Act 2008. When you contact us, we'll work with you to help you decide the best thing to do.

Call us on **0800 367 7322**, email us at [info@rea.govt.nz](mailto:info@rea.govt.nz) or visit us online at [rea.govt.nz](http://rea.govt.nz)

## About settled.govt.nz

---



### Settled.govt.nz guides you through home buying and selling.

Buying or selling your home is one of the biggest financial decisions you will make. It's a complex and sometimes stressful process with potentially significant emotional and financial impacts if things go wrong.

**Settled.govt.nz** provides comprehensive independent information and guidance for home buyers and sellers. You can find information about the risks and how they can impact you and get useful tips on how to avoid some of the major potential problems.

**Settled.govt.nz** will help to inform and guide you through the process from when you're thinking of buying or selling right through to when you're moving in or out. You'll find valuable information, checklists, quizzes, videos and tools. From understanding LIMs, to sale and purchase agreements, to when to contact a lawyer, **settled.govt.nz** explains what you need to know.

**Settled.govt.nz** is brought to you by the Real Estate Authority – Te Mana Papawhenua (REA).

### For more information

For more information on home buying and selling, visit [settled.govt.nz](http://settled.govt.nz) or email [info@settled.govt.nz](mailto:info@settled.govt.nz)



# About the Real Estate Authority – Te Mana Papawhenua (REA)

REA is the independent government agency that regulates the New Zealand real estate profession.

Our purpose is to promote and protect the interests of consumers buying and selling real estate and to promote public confidence in the performance of real estate agency work.

## What we do

Our job is to promote a high standard of conduct in the real estate profession and protect buyers and sellers of property from harm.

- We provide independent information for people who are buying and selling property through our [settled.govt.nz](https://settled.govt.nz) website.
- We provide guidance for real estate professionals and oversee a complaints process.
- We license people and companies working in the real estate industry.

- We maintain a Code of Conduct setting out the professional standards real estate professionals must follow.
- We maintain a public register of real estate professionals that includes information about disciplinary action taken in the last 3 years.

The Real Estate Agents Authority is a Crown agent, established under the Real Estate Agents Act 2008. The Real Estate Authority is the operating name of the Real Estate Agents Authority.

## For more information

To find out more about REA, visit [rea.govt.nz](https://rea.govt.nz), call us on 0800 367 7322 or email us at [info@rea.govt.nz](mailto:info@rea.govt.nz)



Approved under section 133 of the Real Estate Agents Act 2008. Effective from 14 October 2022.

