



**RECORD OF TITLE
UNDER LAND TRANSFER ACT 2017
CROSS LEASE
Search Copy**



R. W. Muir
Registrar-General
of Land

Identifier **NA86A/792**
Land Registration District **North Auckland**
Date Issued 07 May 1991

Prior References
NA397/237

Estate Fee Simple - 1/3 share
Area 905 square metres more or less
Legal Description Lot 27 Deposited Plan 17077
Registered Owners
Carole Mary Archibald as Executor

Estate	Leasehold	Instrument	L C262527.1
		Term	999 years commencing on 1 April 1991

Legal Description Flat 1 Deposited Plan 145250
Registered Owners
Carole Mary Archibald as Executor

Interests

Fencing Agreement in Transfer 181271 (Affects Fee Simple)
Land Covenant in Lease C262527.1 - 7.5.1991 (Affects Fee Simple)
C262527.1 Lease of Flat 1 DP 145250 Term 999 years commencing on 1 April 1991 Composite CT NA86A/792 issued - 7.5.1991 (Affects Fee Simple)
C262527.2 Lease of Flat 2 Composite CT NA86A/793 issued - 7.5.1991 (Affects Fee Simple)
Land Covenant in Lease C262527.2 - 7.5.1991 (Affects Fee Simple)
C281990.1 Lease of Flat 3 Plan 146327 Term 999 years commencing on the 1st July 1991 Composite CT NA87B/157 issued - 8.7.1991 at 11.38 am (Affects Fee Simple)
Land Covenant in Lease C281990.1 - 8.7.1991 at 11.38 am (Affects Fee Simple)

Approved



Yellowish double line survey and plan detail survey by other authority. Reference to R.P. 10/88.

Registered Owners

Pursuant to Section 314 of the Local Government Act 1974 I hereby certify that construction of the building depicted hereon commenced after 1st April 1979 and a building permit for the construction of the building depicted has been issued by the Whangarei District Council pursuant to the By-laws.

Dated this 11 day of May 1991

Authorised officer Whangarei District C.

Note: The boundaries of the area to be leased are the exterior faces of the outer walls. Area (C) to be subject to a restrictive covenant. Covenant boundaries are not visibly defined.

New C.T. Allocated:

FLAT 3, C.T. 878/157

I Robert Selwyn Bryant of Whangarei, Registered Surveyor and holder of an annual practising certificate hereby certify that the building shown hereon is erected in the position shown and is situated within the boundaries of C.T. 897/237 and that the plan is correct.

Dated 12/6/91 Signed R. Bryant

Total Area 205 m²

Comprised in C.T. 897/237 (6a1), C.T. 86A/792 (a1), C.T. 86A/793 (a1)

Registered Surveyor and holder of an annual practising certificate who may act as a registered surveyor pursuant to section 26 of the Survey Act 1980 hereby certify that this plan has been made from surveys executed by me or under my directions, that the plan and survey are correct and have been made in accordance with the Survey Regulations 1972 or any regulations made in substitution thereof.

Dated at this city

Field Book p. Traverse Book p. Reference Plans

Examined Rex Holmes Corner Manners

Approved as to Survey

28/6/91

Deposited this 1st day of May 1991

Registrar

DP 146327

DEED FORM D8

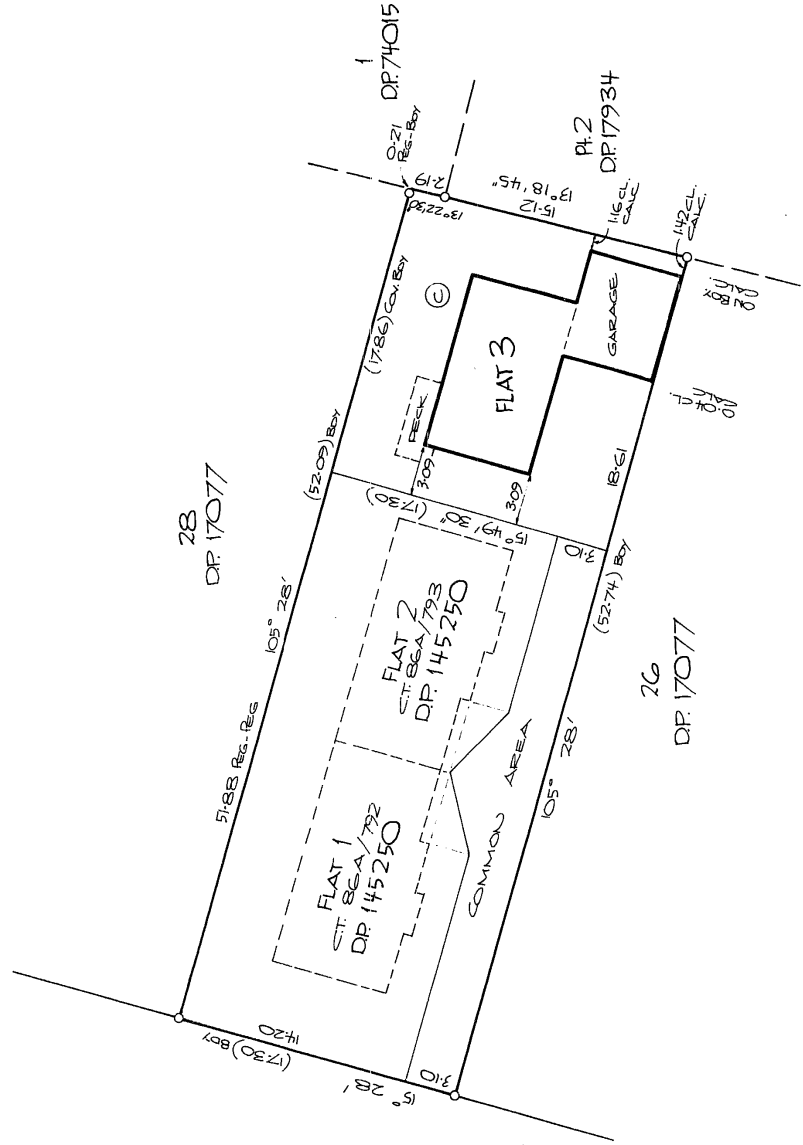
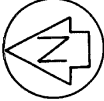

LEGAL BOUNDARY

TERRITORIAL AUTHORITY WHANGAREI DISTRICT
Surveyed by REYBURN & BRYANT
Scale 1:200 Date MAY 1991

FLAT 3 ON LOT 27, DP 17077

LAND DISTRICT NORTH AUCKLAND
SURVEY BLK. & DIST. IX WHANGAREI
NZMS 261 SHT 006 RECORD MAP No 4140

W.A. ROBERTSON SURVEYOR GENERAL DEPARTMENT OF SURVEY AND LAND INFORMATION NEW ZEALAND

APEX HOMES 113 - 2393

CENTIMETRES 1 2 3 4 5 6 7 8 9 10 11 12 13 14 15 16 17 18 19 20 21 22 23 24 25 26 27 28 29 30 31 32 33 34 35 36 37 38 39 40 41 42 43 44 45 46 47 48 49 50 51

Supplied by G.S.D. Press Limited