

Assembly Instructions

VAHN Office Chair

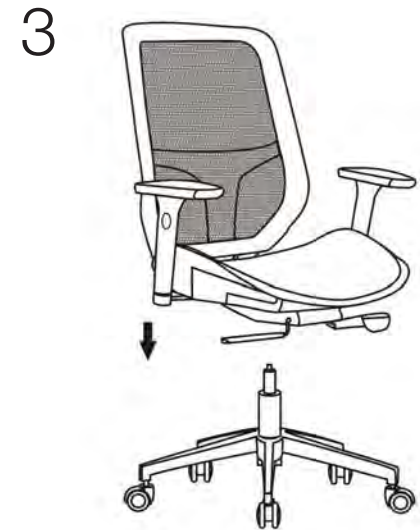

PLEASE NOTE: Check that you have received all components and hardware before assembling. If you are missing any parts, contact your retailer.

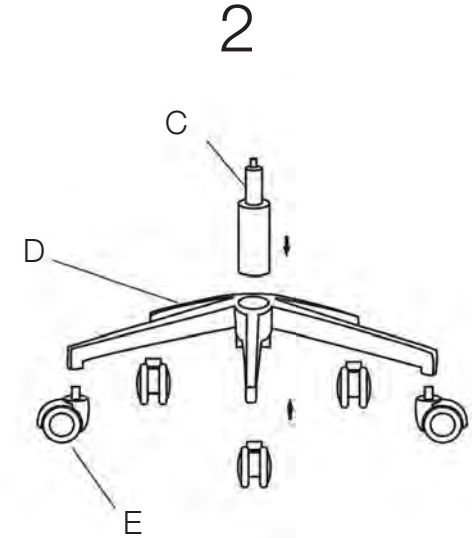
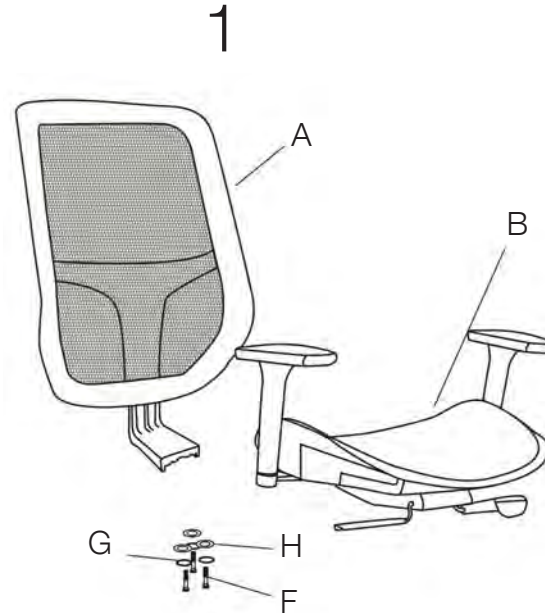

A (1 pc)



B (1 pc)



C (1 pc)



D (1 pc)



E (5 pcs)



F (3 pcs)
8M x 20mm



G (3 pcs)



H (3 pcs)



I (1 pc)
6mm

During assembly, hand tighten screws only. When the screws are in place, tighten completely.

Function Description

1 Chair height adjustable



2 Chair Tilt and lock



3 Arm pad sliding

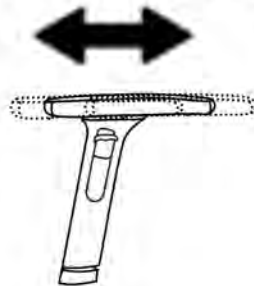

4 Arm height adjustable

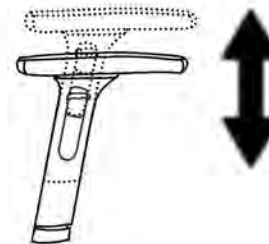

5 Arm angle adjustment

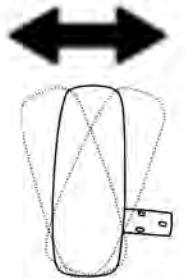

During assembly, hand tighten screw only. When the screw is in place, tighten completely.