



HEBEI GIMARPOL

MACHINERY TECHNOLOGY CO., LTD

GMP

HEBEI CHINA

**TRADE
EXPORT**



COMPANY PROFILE

Hebei Gimarpol Machinery Technology Co.,Ltd is located in hebei province of China.

Our company is specialized in manufacturing and exporting of drilling tools, such as tapered and thread rod, Chisel and button bit for mining with own factory.



With our rich experience for over a decade and with professional engineers and sales term, we focus on providing complete solutions for mining machinery. Target market is gradually shifted from domestic market to international market, products are exported to more than thirty countries and regions, including Southeast Asia, the United States, Germany, Britain, South Africa, Poland, Russia Middle Asia and so on, and established a good brand and reputation in the international market.

Looked forward to the future, we will continue to adhere to the development trend of “Sincerity&Continuous improvement”, bring wealth to our employees, and create quality for our enterprise, value for our customers, and benefits for the society.

LOW Pressure DTH HAMMERDTH HAMMER:

HR90 DTH HAMMERDTH HAMMER:

	Item Description (零件名称)	Weight (重量) Kg	Part Number (零件代号)		
	1、接头 Top Sub	2.80	HR9001		
	2、顶头 Valve Seal	0.01	HR9002		
	3、逆止阀 Check Valve	0.02	HR9003		
	4、弹簧 Spring	0.01	HR9004		
	5、承压垫 Compression Buffer	0.01	HR9005		
	6、胶圈 "O" Ring	0.01	HR9006		
	7、阀盖 Valve cover	0.60	HR9007		
	8、导向管 Guide Tube	0.01	HR9008		
	9、阀片 Valve	0.01	HR9009		
	10、阀座 Air Distributor	0.60	HR9010		
	11、内缸 Internal Cylinder	2.00	HR9011		
	12、活塞 Piston	4.00	HR9012		
	13、外缸 External Cylinder	5.80	HR9013		
	14、衬套 Guided Sleeve	1.20	HR9014		
	15、挡柱 Stop Ring	0.01	HR9015		
	16、卡钎套 Drive Chuck	1.60	HR9016		
17、钻头 Drill Bit	3.50	HR9017			
技术参数 Technical Data					
总长 (不含钻头) Length(Less bit)	总重 (不含钻头) Weight(Less bit)	冲击器外径 External diameter	可配钻头钎柄 Bit Shank	钻孔范围 Hole Range	后接头螺纹 Connection Thread
800mm	19.00Kg	Φ80mm	C1R90	Φ85—Φ110	T48x10x2
可用工作风压 Working Pressure	在0.5Mpa时的冲击频率 Impact rate at 0.5Mpa	推荐转速 Recommended rotation speed	耗风量 Air consumption		
			0.5Mpa	0.7Mpa	
0.5—0.7Mpa	14HZ	25—40r/min	6.5m ³ /min	8m ³ /min	

HR110 DTH HAMMERDTH HAMMER:

Item Description (零件名称)	Weight (重量) Kg	Part Number (零件代号)
1、接头 Top Sub	5.00	HR11001
2、顶头 Valve Seal	0.01	HR11002
3、逆止阀 Check Valve	0.02	HR11003
4、弹簧 Spring	0.005	HR11004
5、承压垫 Compression Buffer	0.015	HR11005
6、胶圈 "O" Ring	0.01	HR11006
7、阀盖 Valve Cover	0.80	HR11007
8、导向管 Guide Tube	0.01	HR11008
9、阀片 Valve	0.015	HR11009
10、阀座 Air Distributor	1.00	HR11010
11、内缸 Internal Cylinder	2.80	HR11011
12、活塞 Piston	7.00	HR11012
13、外缸 External Cylinder	8.80	HR11013
14、衬套 Guided Sleeve	1.40	HR11014
15、挡柱 Stop Ring	0.01	HR11015
16、卡钎套 Drive Chuck	3.80	HR11016
17、钻头 Drill Bit	6.40	HR11017

技术参数
Technical Data

总长 (不含钻头) Length(Less bit)	总重 (不含钻头) Weight(Less bit)	冲击器外径 External diameter	可配钻头钎柄 Bit Shank	钻孔范围 Hole Range	后接头螺纹 Connection Thread
839mm	32.00Kg	Φ98mm	C1R110	Φ110—Φ135	API 2 ^{3/8} Reg Box
可用工作风压 Working Pressure	在0.5Mpa时的冲击频率 Impact rate at 0.5Mpa	推荐转速 Recommended rotation speed	耗风量 Air consumption		
			0.5Mpabar	0.7Mpa	
0.5—0.7Mpa	14HZ	25—40r/min	9.5m ³ /min	11m ³ /min	

HR150 DTH HAMMERDTH HAMMER



技术参数
Technical Data

总长(不含钻头) Length(Less bit)	总重(不含钻头) Weight(Less bit)	冲击器外径 External diameter	可配钻头钎柄 Bit Shank	钻孔范围 Hole Range	后接头螺纹 Connection Thread
908mm	69.00Kg	Φ137mm	CIR150	Φ155—Φ178	T75x10x2.5 Box
可用工作风压 Working Pressure	在0.5Mpa时的冲击频率 Impact rate at 0.5Mpa	推荐转速 Recommended rotation speed	耗风量 Air consumption		
			0.5Mpa	0.7Mpa	
0.5—0.7Mpa	13HZ	25—40r/min	15m ³ /min	17m ³ /min	

Middle LOW Pressure DTH HAMMERDTH HAMMER

HBR1A DTH HAMMERDTH HAMMER:



Item Description (零件名称)	Weight (重量) Kg	Part Number (零件代号)
1、接 头 Top Sub	1.70	HBR101
2、逆 止 阀 Check Valve	0.10	HBR102
3、弹 簧 Spring	0.05	HBR103
4、配 气 座 Air Distributor	0.80	HBR104
5、内 缸 Internal Cylinder	0.80	HBR105
6、活 塞 Piston	1.20	HBR106
7、外 缸 External Cylinder	4.00	HBR107
8、衬 套 Guided Sleeve	0.15	HBR108
9、卡环O形圈 "O" Ring of Stop Ring	0.05	HBR109
10、卡 环 Stop Ring	0.10	HBR110
11、卡 钎 套 Drive Chuck	0.80	HBR111
12、钻 头 Drill Bit	1.70	HBR112

技术参数
Technical Data

总长 (不含钻头) Length(Less bit)	总重 (不含钻头) Weight(Less bit)	冲击器外径 External diameter	可配钻头钎柄 Bit Shank	钻孔范围 Hole Range	后接头螺纹 Connection Thread
760mm	10.00Kg	Φ54mm	BR1	Φ64—Φ76	RD40 BOX
可用工作风压 Working Pressure	在1.4Mpa时的冲击频率 Impact rate at 1.4Mpa	推荐转速 Recommended rotation speed	耗风量 Air consumption		
			0.7Mpa	1.0Mpa	1.4Mpa
0.7—1.75Mpa	27HZ	25—40r/min	1.5m ³ /min	2.5m ³ /min	3m ³ /min

HRB2A DTH HAMMERDTH HAMMER:

Item Description (零部件名称)	Weight (重量) Kg	Part Number (零部件代号)
1、接 头 Top Sub	2.60	HBR201
2、逆 止 阀 Check Valve	0.10	HBR202
3、弹 簧 Spring	0.05	HBR203
4、配 气 座 Air Distributor	0.60	HBR204
5、内 缸 Internal Cylinder	0.80	HBR205
6、活 塞 Piston	3.80	HBR206
7、外 缸 External Cylinder	4.50	HD2507
8、衬 套 Guided Sleeve	0.60	HBR208
9、卡环O形圈 "O" Ring of Stop Ring	0.005	HBR209
10、卡 环 Stop Ring	0.10	HBR210
11、卡 钎 套 Drive Chuck	1.20	HBR211
12、钻 头 Drill Bit	2.50	HBR212

技术参数 Technical Data					
总长 (不含钻头) Length(Less bit)	总重 (不含钻头) Weight(Less bit)	冲击器外径 External diameter	可配钻头钎柄 Bit Shank	钻孔范围 Hole Range	后接头螺纹 Connection Thread
880mm	14.50Kg	Φ62mm	BR2	Φ70—Φ90	RD50 BOX
可用工作风压 Working Pressure	在1.4Mpa时的冲击频率 Impact rate at 1.4Mpa	推荐转速 Recommended rotation speed	耗风量 Air consumption		
			0.7Mpa	1.0Mpa	1.4Mpa
0.7—1.75Mpa	25HZ	25—40r/min	2.5m ³ /min	4m ³ /min	5m ³ /min

HRB3A DTH HAMMERDTH HAMMER:



技术参数
Technical Data

总长 (不含钻头) Length(Less bit)	总重 (不含钻头) Weight(Less bit)	冲击器外径 External diameter	可配钻头钎柄 Bit Shank	钻孔范围 Hole Range	后接头螺纹 Connection Thread
889mm	26.00Kg	Φ82mm	BR3	Φ90—Φ110	API 2 $\frac{1}{2}$ " Reg
可用工作风压 Working Pressure	在1.4Mpa时的冲击频率 Impact rate at 1.4Mpa	推荐转速 Recommended rotation speed	耗风量 Air consumption		
			0.7Mpa	1.0Mpa	1.4Mpa
0.7—1.75Mpa	25HZ	25—40r/min	4m ³ /min	6m ³ /min	8m ³ /min

High Pressure DTH HAMMER with Nylon Tubo :

HD35 DTH HAMMER DTH HAMMER:



Item Description (零件名称)	Weight (重量) Kg	Part Number (零件代号)
1、接 头 Top Sub	4.20	HD3501
2、接头O形圈 "O" Ring of Top Sub	0.01	HD3502
3、逆 止 阀 Check Valve	0.20	HD3503
4、弹 簧 Spring	0.02	HD3504
5、承 压 垫 Compression Buffer	0.02	HD3505
6、配 气 座 Air Distributor	1.40	HD3506
7、内 缸 Internal Cylinder	1.50	HD3507
8、活 塞 Piston	5.60	HD3508
9、外 缸 External Cylinder	9.90	HD3509
10、卡环O形圈 "O" Ring of Stop Ring	0.01	HD3510
11、卡 环 Stop Ring	0.15	HD3511
12、卡 钎 套 Drive Chuck	1.90	HD3512
13、钻 头 Drill Bit	5.00	HD3513

技术参数
Technical Data

总长 (不含钻头) Length(Less bit)	总重 (不含钻头) Weight(Less bit)	冲击器外径 External diameter	可配钻头钎柄 Bit Shank	钻孔范围 Hole Range	后接头螺纹 Connection Thread
930mm	25.00Kg	Φ82mm	DHD3.5	Φ90—Φ110	API 2 ^{1/2} " Reg
可用工作风压 Working Pressure	在1.5Mpa时的冲击频率 Impact rate at 1.5Mpa	推荐转速 Recommended rotation speed	耗风量 Air consumption		
			1.0Mpa	1.5Mpa	
1.0—1.5Mpa	28HZ	25—40r/min	4.5m ³ /min	9.0m ³ /min	

HD45 DTH HAMMERDTH HAMMER:

Item Description (零部件名称)	Weight (重量) Kg	Part Number (零部件代号)
1、接 头 Top Sub	6.50	HD4501
2、接头O形圈 "O" Ring of Top Sub	0.01	HD4502
3、逆 止 阀 Check Valve	0.42	HD4503
4、弹 簧 Spring	0.04	HD4504
5、承 压 垫 Compression Buffer	0.04	HD4505
6、配 气 座 Air Distributor	2.20	HD4506
7、内 缸 Internal Cylinder	2.30	HD4507
8、活 塞 Piston	9.00	HD4508
9、外 缸 External Cylinder	15.00	HD4509
10、卡环O形圈 "O" Ring of Stop Ring	0.01	HD4510
11、卡 环 Stop Ring	0.20	HD4511
12、卡 钎 套 Drive Chuck	3.50	HD4512
13、钻 头 Drill Bit	9.00	HD4513

如客户要求，接头可采用两个方口，并在接头上装耐磨合金。需要加强排渣，可在逆止阀上钻调气孔。
According to your request, the top sub can be made into two spanners, and put protection buttons. An air controlling hole can be drilled on the check valve to provide more efficient cuttings discharge.

技术 参 数
Technical Data

总长 (不含钻头) Length(Less bit)	总重 (不含钻头) Weight(Less bit)	冲击器外径 External diameter	可配钻头钎柄 Bit Shank	钻孔范围 Hole Range	后接头螺纹 Connection Thread
1030mm	39.00Kg	Φ99mm	Cop44 DHD340	Φ110—Φ135	API 2 3/8" Reg
可用工作风压 Working Pressure	在1.7Mpa时的冲击频率 Impact rate at 1.7Mpa	推荐转速 Recommended rotation speed	耗风量 Air consumption		
			1.0Mpa	1.8Mpa	2.4Mpa
1.0—2.5Mpa	27HZ	25—40r/min	6m ³ /min	10m ³ /min	15m ³ /min

HSD4 DTH HAMMERDTH HAMMER:

Item Description (零部件名称)	Weight (重量) Kg	Part Number (零部件代号)
1、接 头 Top Sub	6.50	HSD401
2、接头O形圈 "O" Ring of Top Sub	0.01	HSD402
3、逆 止 阀 Check Valve	0.42	HSD403
4、弹 簧 Spring	0.04	HSD404
5、承 压 垫 Compression Buffer	0.04	HSD405
6、配 气 座 Air Distributor	2.20	HSD406
7、内 缸 Internal Cylinder	2.50	HSD407
8、活 塞 Piston	9.00	HSD408
9、外 缸 External Cylinder	15.60	HSD409
10、卡环O型圈 "O" Ring of Stop Ring	0.02	HSD410
11、卡 环 Stop Ring	0.20	HSD411
12、卡 钎 套 Drive Chuck	4.00	HSD412
13、钻 头 Drill Bit	9.60	HSD413

如客户需要，接头可采用两个方口，并在接头上装耐磨合金。需要加强排渣，可在逆止阀上钻调气孔。
According to your request, the top sub can be made into two spanners, and put protection buttons. An air controlling hole can be drilled on the check valve to provide more efficient cuttings discharge.

技术参数
Technical Data

总长 (不含钻头) Length(Less bit)	总重 (不含钻头) Weight(Less bit)	冲击器外径 External diameter	可配钻头钎柄 Bit Shank	钻孔范围 Hole Range	后接头螺纹 Connection Thread
1084mm	40.5Kg	Φ99mm	SD4	Φ110—Φ135	API 2 ^{1/2} " Reg
可用工作风压 Working Pressure	在1.7Mpa时的冲击频率 Impact rate at 1.7Mpa	推荐转速 Recommended rotation speed	耗风量 Air consumption		
			1.0Mpa	1.8Mpa	2.4Mpa
1.0—2.5Mpa	27HZ	25—40r/min	6m ³ /min	10m ³ /min	15m ³ /min

HQL4 DTH HAMMERDTH HAMMER:

Item Description (零件名称)	Weight (重量) Kg	Part Number (零件代号)
1、接 头 Top Sub	6.50	HQL401
2、接头O形圈 "O" Ring of Top Sub	0.01	HQL402
3、逆 止 阀 Check Valve	0.42	HQL403
4、弹 簧 Spring	0.04	HQL404
5、承 压 垫 Compression Buffer	0.04	HQL405
6、配 气 座 Air Distributor	2.20	HQL406
7、内 缸 Internal Cylinder	2.30	HQL407
8、活 塞 Piston	8.80	HQL408
9、外 缸 External Cylinder	16.50	HQL409
10、衬 套 Guided Sleeve	0.80	HQL410
11、卡环O形圈 "O" Ring of Stop Ring	0.01	HQL411
12、卡 环 Stop Ring	0.30	HQL412
13、卡 钎 套 Drive Chuck	3.00	HQL413
14、钻 头 Drill Bit	9.50	HQL414

如客户需要，接头可采用两个方口，并在接头上装耐磨合金。需要加强排渣，可在逆止阀上钻调气孔。
According to your request, the top sub can be made into two spanners, and put protection buttons. An air controlling hole can be drilled on the check valve to provide more efficient cuttings discharge.

技术 参 数 Technical Data

总长 (不含钻头) Length(Less bit)	总重 (不含钻头) Weight(Less bit)	冲击器外径 External diameter	可配钻头钎柄 Bit Shank	钻孔范围 Hole Range	后接头螺纹 Connection Thread
1097mm	41.00kg	Φ99mm	QL40	Φ110—Φ135	API 2 $\frac{3}{8}$ " Reg
可用工作风压 Working Pressure	在1.7Mpa时的冲击频率 Impact rate at 1.7Mpa	推荐转速 Recommended rotation speed	耗风量 Air consumption		
			1.0Mpa	1.8Mpa	2.4Mpa
1.0—2.5Mpa	27HZ	25—40r/min	6m ³ /min	10m ³ /min	15m ³ /min

HD55 DTH HAMMERDTH HAMMER:

Item Description (零部件名称)	Weight (重量) Kg	Part Number (零部件代号)
1、接 头 Top Sub	15.00	HD5501
2、接头O形圈 "O" Ring of Top Sub	0.01	HD5502
3、逆 止 阀 Check Valve	1.00	HD5503
4、弹 簧 Spring	0.04	HD5504
5、承 压 垫 Compression Buffer	0.06	HD5505
6、配 气 座 Air Distributor	3.70	HD5506
7、内 缸 Internal Cylinder	4.50	HD5507
8、活 塞 Piston	15.50	HD5508
9、外 缸 External Cylinder	30.00	HD5509
10、卡环O型圈 "O" Ring of Stop Ring	0.01	HD5510
11、卡 环 Stop Ring	0.30	HD5511
12、卡 钎 套 Drive Chuck	6.40	HD5512
13、钻 头 Drill Bit	16.00	HD5513

如客户需要，接头可采用两个方口，并在接头上装耐磨合金。需要加强排渣，可在逆止阀上钻调气孔。
According to your request, the top sub can be made into two spanners, and put protection buttons. An air controlling hole can be drilled on the check valve to provide more efficient cuttings discharge.

技术参数 Technical Data					
总长 (不含钻头) Length(Less bit)	总重 (不含钻头) Weight(Less bit)	冲击器外径 External diameter	可配钻头钎柄 Bit Shank	钻孔范围 Hole Range	后接头螺纹 Connection Thread
1214mm	76.5Kg	Φ125mm	Cop54 DHD350R	Φ135—Φ155	API 2 ³ / ₈ " Reg API 3 ¹ / ₂ " Reg
可用工作风压 Working Pressure	在1.7Mpa时的冲击频率 Impact rate at 1.7Mpa	推荐转速 Recommended rotation speed	耗风量 Air consumption		
			1.0Mpa	1.8Mpa	2.4Mpa
1.0—2.5Mpa	25HZ	20—35r/min	9m ³ /min	15m ³ /min	23m ³ /min

HD55C DTH HAMMERDTH HAMMER:

Item Description (零部件名称)	Weight (重量) Kg	Part Number (零部件代号)
1、接头 Top Sub	13.70	HD55C01
2、O-形圈 "O" -Ring	0.01	HD55C02
3、逆止阀 Check Valve	1.00	HD55C03
4、弹簧 Spring	0.04	HD55C04
5、承压垫 Compression Buffer	0.08	HD55C05
6、配气座 Air Distributor	3.50	HD55C06
7、内缸 Internal Cylinder	4.20	HD55C07
8、活塞 Piston	17.20	HD55C08
9、外缸 External Cylinder	26.50	HD55C09
10、衬套 Guided Sleeve	1.20	HD55C10
11、O-型圈 "O" -Ring	0.01	HD55C11
12、卡环 Stop Ring	0.50	HD55C12
13、卡钎套 Drive Chuck	4.50	HD55C13
14、钻头 Drill Bit	15.60	HD55C14

如客户要求，接头可采用两个方口，并在接头上装耐磨合金。需要加强排渣，可在逆止阀上钻调气孔。
According to your request, the top sub can be made into two spanners, and put protection buttons. An air controlling hole can be drilled on the check valve to provide more efficient cuttings discharge.

技术参数 Technical Data					
总长 (不含钻头) Length(Less bit)	总重 (不含钻头) Weight(Less bit)	冲击器外径 External diameter	可配钻头钎柄 Bit Shank	钻孔范围 Hole Range	后接头螺纹 Connection Thread
1160mm	72.50Kg	Φ125mm	HD55C DHD350Q	Φ135—Φ155	API 2 ³ / ₈ " Reg API 3 ¹ / ₂ " Reg
可用工作风压 Working Pressure	在1.7Mpa时的冲击频率 Impact rate at 1.7Mpa	推荐转速 Recommended rotation speed	耗风量 Air consumption		
			1.0Mpa	1.8Mpa	2.4Mpa
1.0—2.5Mpa	25HZ	20—35r/min	9m ³ /min	15m ³ /min	23m ³ /min

HSD5 DTH HAMMERDTH HAMMER:



Item Description (零件名称)	Weight (重量) Kg	Part Number (零件代号)
1、接 头 Top Sub	15.00	HSD501
2、接头O形圈 “O” Ring of Top Sub	0.01	HSD502
3、逆 止 阀 Check Valve	1.00	HSD503
4、弹 簧 Spring	0.10	HSD504
5、承 压 垫 Compression Buffer	0.05	HSD505
6、配 气 座 Air Distributor	3.50	HSD506
7、内 缸 Internal Cylinder	4.20	HSD507
8、活 塞 Piston	15.50	HSD508
9、外 缸 External Cylinder	25.00	HSD509
10、卡环O型圈 “O” Ring of Stop Ring	0.01	HSD510
11、卡 环 Stop Ring	0.50	HSD511
12、卡 钎 套 Drive Chuck	7.50	HSD512
13、钻 头 Drill Bit	15.60	HSD513

如客户要求，接头可采用两个方口，并在接头上装耐磨合金。需要加强排渣，可在逆止阀上钻调气孔。

According to your request, the top sub can be made into two spanners, and put protection buttons. An air controlling hole can be drilled on the check valve to provide more efficient cuttings discharge.

技术参数 Technical Data					
总长 (不含钻头) Length(Less bit)	总重 (不含钻头) Weight(Less bit)	冲击器外径 External diameter	可配钻头钎柄 Bit Shank	钻孔范围 Hole Range	后接头螺纹 Connection Thread
1175mm	72.50Kg	Φ125mm	SD5	Φ135—Φ155	API 3 1/2 Reg
可用工作风压 Working Pressure	在1.7Mpa时的冲击频率 Impact rate at 1.7Mpa	推荐转速 Recommended rotation speed	耗风量 Air consumption		
			1.0Mpa	1.8Mpa	2.4Mpa
1.0—2.5Mpa	25HZ	20—35r/min	9m ³ /min	15m ³ /min	23m ³ /min

HQL5 DTH HAMMERDTH HAMMER:

Item Description (零件名称)	Weight (重量) Kg	Part Number (零件代号)
1、接 头 Top Sub	15.00	HQL501
2、接头O形圈 "O" Ring of Top Sub	0.015	HQL502
3、逆 止 阀 Check Valve	1.00	HQL503
4、弹 簧 Spring	0.10	HQL504
5、承 压 垫 Compression Buffer	0.10	HQL505
6、配 气 座 Air Distributor	3.50	HQL5006
7、内 缸 Internal Cylinder	4.20	HD55C07
8、活 塞 Piston	19.00	HQL508
9、外 缸 External Cylinder	24.60	HQL509
10、衬 套 Guided Sleeve	0.90	HQL510
11、卡环O形圈 "O" Ring of Stop Ring	0.01	HQL511
12、卡 环 Stop Ring	0.40	HQL512
13、卡 钎 套 Drive Chuck	4.60	HQL513
14、钻 头 Drill Bit	15.50	HQL514

如客户需要，接头可采用两个方口，并在接头上装耐磨合金。需要加强排渣，可在逆止阀上钻调气孔。
According to your request, the top sub can be made into two spanners, and put protection buttons. An air controlling hole can be drilled on the check valve to provide more efficient cuttings discharge.

技术参数 Technical Data					
总长 (不含钻头) Length(Less bit)	总重 (不含钻头) Weight(Less bit)	冲击器外径 External diameter	可配钻头钎柄 Bit Shank	钻孔范围 Hole Range	后接头螺纹 Connection Thread
1156mm	73.00Kg	Φ 125mm	QL50	Φ 135—Φ 155	API 3½ Reg
可用工作风压 Working Pressure	在1.7Mpa时的冲击频率 Impact rate at 1.7Mpa	推荐转速 Recommended rotation speed	耗风量 Air consumption		
			1.0Mpa	1.8Mpa	2.4Mpa
1.0—2.5Mpa	25HZ	20—35r/min	9m ³ /min	15m ³ /min	23m ³ /min

HD65 DTH HAMMERDTH HAMMER:



Item Description (零部件名称)	Weight (重量) Kg	Part Number (零部件代号)
1、接 头 Top Sub	20.00	HD6501
2、接头O形圈 "O" Ring Of Top Sub	0.02	HD6502
3、逆 止 阀 Check Valve	1.00	HD6503
4、弹 簧 Spring	0.04	HD6504
5、承 压 垫 Compression Buffer	0.08	HD6505
6、配 气 座 Air Distributor	5.00	HD6506
7、内 缸 Internal Cylinder	5.00	HD6507
8、活 塞 Piston	23.60	HD6508
9、外 缸 External Cylinder	36.80	HD6509
10、衬 套 Guided Sleeve	2.40	HD6510
11、卡环O形圈 "O" Ring of Stop Ring	0.02	HD6511
12、卡 环 Stop Ring	0.60	HD6512
13、卡 钎 套 Drive Chuck	6.00	HD6513
14、钻 头 Drill Bit	26.00	HD6514

如客户要求，接头可采用两个方口，并在接头上装耐磨合金。需要加强排渣，可在逆止阀上钻调气孔。
According to your request, the top sub can be made into two spanners, and put protection buttons. An air controlling hole can be drilled on the check valve to provide more efficient cuttings discharge.

技术参数 Technical Data					
总长 (不含钻头) Length(Less bit)	总重 (不含钻头) Weight(Less bit)	冲击器外径 External diameter	可配钻头钎柄 Bit Shank	钻孔范围 Hole Range	后接头螺纹 Connection Thread
1248mm	100.00Kg	Φ142mm	Cop64 DHD360	Φ155—Φ190	API 3 1/2 Reg
可用工作风压 Working Pressure	在1.7Mpa时的冲击频率 Impact rate at 1.7Mpa	推荐转速 Recommended rotation speed	耗风量 Air consumption		
			1.0Mpa	1.8Mpa	2.4Mpa
1.0—2.5Mpa	23HZ	20—30r/min	10m ³ /min	20m ³ /min	28.5m ³ /min

HSD6 DTH HAMMERDTH HAMMER:

Item Description (零件名称)	Weight (重量) Kg	Part Number (零件代号)
1、接 头 Top Sub	20.00	HSD601
2、接头O形圈 "O" Ring Of Top Sub	0.01	HSD602
3、逆 止 阀 Check Valve	1.00	HSD603
4、弹 簧 Spring	0.05	HSD604
5、承 压 垫 Compression Buffer	0.10	HSD605
6、配 气 座 Air Distributor	5.00	HSD606
7、内 缸 Internal Cylinder	5.00	HSD607
8、活 塞 Piston	24.00	HSD608
9、外 缸 External Cylinder	35.00	HSD609
10、卡环O形圈 "O" Ring of Stop Ring	0.01	HSD610
11、卡 环 Stop Ring	0.50	HSD611
12、衬 套 Guided Sleeve	1.50	HSD612
13、卡 钎 套 Drive Chuck	7.50	HSD613
14、钻 头 Drill Bit	25.80	HSD614

如客户需要，接头可采用两个方口，并在接头上装耐磨合金。需要加强排渣，可在逆止阀上钻调气孔。
According to your request, the top sub can be made into two spanners, and put protection buttons. An air controlling hole can be drilled on the check valve to provide more efficient cuttings discharge.

技术参数 Technical Data					
总长 (不含钻头) Length(Less bit)	总重 (不含钻头) Weight(Less bit)	冲击器外径 External diameter	可配钻头钎柄 Bit Shank	钻孔范围 Hole Range	后接头螺纹 Connection Thread
1261mm	100.00Kg	Φ142mm	SD6	Φ155—Φ190	API 3 1/2" Reg
可用工作风压 Working Pressure	在1.7Mpa时的冲击频率 Impact rate at 1.7Mpa	推荐转速 Recommended rotation speed	耗风量 Air consumption		
			1.0Mpa	1.8Mpa	2.4Mpa
1.0—2.5Mpa	23HZ	20—30r/min	10m ³ /min	20m ³ /min	28.5m ³ /min

HQL6 DTH HAMMERDTH HAMMER:

Item Description (零部件名称)	Weight (重量) Kg	Part Number (零部件代号)
1、接 头 Top Sub	20.00	HQL601
2、接头O形圈 "O" Ring of Top Sub	0.02	HQL602
3、逆 止 阀 Check Valve	1.00	HQL603
4、弹 簧 Spring	0.10	HQL604
5、承 压 垫 Compression Buffer	0.10	HQL605
6、配 气 座 Air Distributor	6.00	HQL606
7、内 缸 Internal Cylinder	5.00	HQL607
8、活 塞 Piston	23.50	HQL608
9、外 缸 External Cylinder	31.00	HQL609
10、衬 套 Guided Sleeve	1.00	HQL610
11、卡环O形圈 "O" Ring of Stop Ring	0.02	HQL611
12、卡 环 Stop Ring	0.60	HQL612
13、卡 钎 套 Drive Chuck	5.40	HQL613
14、钻 头 Drill Bit	24.60	HQL614

如客户需要，接头可采用两个方口，并在接头上装耐磨合金。需要加强排渣，可在逆止阀上钻调气孔。
According to your request, the top sub can be made into two spanners, and put protection buttons. An air controlling hole can be drilled on the check valve to provide more efficient cuttings discharge.

技术参数 Technical Data

总长 (不含钻头) Length(Less bit)	总重 (不含钻头) Weight(Less bit)	冲击器外径 External diameter	可配钻头钎柄 Bit Shank	钻孔范围 Hole Range	后接头螺纹 Connection Thread
1212mm	95.00Kg	Φ 146mm	QL60	Φ 155—Φ 190	API 3 1/2 Reg
可用工作风压 Working Pressure	在17bar时的冲击频率 Impact rate at 17 Bar	推荐转速 Recommended rotation speed	耗风量 Air consumption		
			1.0Mpa	1.8Mpa	2.4Mpa
1.0—2.5Mpa	23HZ	20—30r/min	10m ³ /min	20m ³ /min	28.5m ³ /min

HD85 DTH HAMMERDTH HAMMER:



Item Description (零部件名称)	Weight (重量) Kg	Part Number (零部件代号)
1、接 头 Top Sub	41.00	HD8501
2、接头O形圈 "O" Ring of Top Sub	0.02	HD8502
3、接头垫片 Breakout Ring	0.20	HD8503
4、逆 止 阀 Check Valve	1.50	HD8504
5、弹 簧 Spring	0.10	HD8505
6、承 压 垫 Compression Buffer	0.42	HD8506
7、配 气 座 Air Distributor	0.13	HD8507
8、内 缸 Internal Cylinder	8.60	HD8508
9、活 塞 Piston	41.00	HD8509
10、外 缸 External Cylinder	62.00	HD8510
11、卡环O形圈 "O" Ring of Stop Ring	0.02	HD8511
12、卡 环 Stop Ring	1.20	HD8512
13、卡钎套垫片 Breakout Ring	0.20	HD8513
14、卡 钎 套 Drive Chuck	17.50	HD8514
15、钻 头 Drill Bit	40.00	HD8515

如客户要求，接头可采用两个方口，并在接头上装耐铝合金。需要加强排渣，可在逆止阀上钻调气孔。
According to your request, the top sub can be made into two spanners, and put protection buttons. An air controlling hole can be drilled on the check valve to provide more efficient cuttings discharge.

技术参数
Technical Data

总长 (不含钻头) Length(Less bit)	总重 (不含钻头) Weight(Less bit)	冲击器外径 External diameter	可配钻头钎柄 Bit Shank	钻孔范围 Hole Range	后接头螺纹 Connection Thread
1492mm	188Kg	Φ180mm	Cop84 DHD380	Φ195—Φ254	API 4 1/2 Reg
可用工作压力 Working Pressure	在1.7Mpa时的冲击频率 Impact rate at 1.7Mpa	推荐转速 Recommended rotation speed	耗风量 Air consumption		
			1.0Mpa	1.8Mpa	2.4Mpa
1.0—2.5Mpa	20HZ	20—30r/min	15m ³ /min	26m ³ /min	34m ³ /min

HSD8 DTH HAMMERDTH HAMMER:



Item Description (零部件名称)	Weight (重量) Kg	Part Number (零部件代号)
1、接头 Top Sub	41.00	HSD801
2、接头O形圈 "O" Ring of Top Sub	0.02	HSD802
3、接头垫片 Breakout Ring	0.20	HSD803
4、逆止阀 Check Valve	1.50	HSD804
5、弹簧 Spring	0.10	HSD805
6、承压垫 Compression Buffer	0.42	HSD806
7、配气座 Air Distributor	12.50	HSD807
8、内缸 Internal Cylinder	8.60	HSD808
9、活塞 Piston	42.00	HSD809
10、外缸 External Cylinder	65.00	HSD810
11、卡环O形圈 "O" Ring of Stop Ring	0.05	HSD811
12、卡环 Stop Ring	1.20	HSD812
13、衬套 Guided Sleeve	3.40	HSD813
14、卡钎套垫片 Breakout Ring	0.20	HSD814
15、卡钎套 Drive Chuck	15.50	HSD815
16、钻头 Drill Bit	37.00	HSD816

如客户需要，接头可采用两个方口，并在接头上装耐磨合金。需要加强排渣，可在逆止阀上钻调气孔。
According to your request, the top sub can be made into two spanners, and put protection buttons. An air controlling hole can be drilled on the check valve to provide more efficient cuttings discharge.

技术参数 Technical Data					
总长 (不含钻头) Length(Less bit)	总重 (不含钻头) Weight(Less bit)	冲击器外径 External diameter	可配钻头钎柄 Bit Shank	钻孔范围 Hole Range	后接头螺纹 Connection Thread
1463mm	192.00Kg	Φ180mm	SD8	Φ195—Φ254	API 4½Reg
可用工作压力 Working Pressure	在1.7Mpa时的冲击频率 Impact rate at 1.7Mpa	推荐转速 Recommended rotation speed	耗风量 Air consumption		
			1.0Mpa	1.8Mpa	2.4Mpa
1.0—2.5Mpa	20HZ	15—25r/min	15m ³ /min	26m ³ /min	34m ³ /min

HQL8 DTH HAMMERDTH HAMMER:



Item Description (零部件名称)	Weight (重量) Kg	Part Number (零部件代号)
1、接 头 Top Sub	41.00	HQL801
2、接头O形圈 "O" Ring of Top Sub	0.02	HQL802
3、接头垫片 Breakout Ring	0.30	HQL803
4、逆 止 阀 Check Valve	1.50	HQL804
5、弹 簧 Spring	0.10	HQL805
6、承 压 垫 Compression Buffer	0.42	HQL806
7、配 气 座 Air Distributor	13.00	HQL807
8、内 缸 Internal Cylinder	8.60	HQL808
9、活 塞 Piston	41.00	HQL809
10、外 缸 External Cylinder	60.00	HQL810
11、衬 套 Guided Sleeve	2.20	HQL811
12、卡环O形圈 "O" Ring of Stop Ring	0.02	HQL812
13、卡 环 Stop Ring	1.20	HQL813
14、卡钎套垫片 Breakout Ring	0.30	HQL814
15、卡 钎 套 Drive Chuck	12.00	HQL815
16、钻 头 Drill Bit	35.00	HQL816

如客户需要，接头可采用两个方口，并在接头上装耐磨合金。需要加强排渣，可在逆止阀上钻调气孔。
According to your request, the top sub can be made into two spanners, and put protection buttons. An air controlling hole can be drilled on the check valve to provide more efficient cuttings discharge.

技术参数 Technical Data					
总长 (不含钻头) Length(Less bit)	总重 (不含钻头) Weight(Less bit)	冲击器外径 External diameter	可配钻头钎柄 Bit Shank	钻孔范围 Hole Range	后接头螺纹 Connection Thread
1465mm	182.00kg	Φ 180mm	QL80	Φ 195—Φ 254	API 4 1/2 Reg
可用工作风压 Working Pressure	在1.7Mpa时的冲击频率 Impact rate at 1.7Mpa	推荐转速 Recommended rotation speed	耗风量 Air consumption		
			1.0Mpa	1.8Mpa	2.4Mpa
1.0—2.5Mpa	20HZ	15—25r/min	15m ³ /min	26m ³ /min	34m ³ /min

HSD10 DTH HAMMERDTH HAMMER:



Item Description (零部件名称)	Weight (重量) Kg	Part Number (零部件代号)
1、接头 Top Sub	59.00	HSD1001
2、接头O形圈 "O" Ring of Top Sub	0.03	HSD1002
3、接头垫片 Breakout Ring	0.30	HSD1003
4、逆止阀 Check Valve	1.40	HSD1004
5、弹簧 Spring	0.30	HSD1005
6、承压垫 Compression Buffer	0.60	HSD1006
7、配气座 Air Distributor	11.50	HSD1007
8、内缸 Internal Cylinder	11.00	HSD1008
9、活塞 Piston	62.00	HSD1009
10、外缸 External Cylinder	110.00	HSD1010
11、卡环O型圈 "O" Ring of Stop Ring	0.03	HSD1011
12、卡环 Stop Ring	1.60	HSD1012
13、衬套 Guided Sleeve	4.50	HSD1013
14、卡钎套垫片 Breakout Ring	0.30	HSD1014
15、卡钎套 Drive Chuck	24.00	HSD1015
16、钻头 Drill Bit	115.00	HSD1016

如客户需要，接头可采用两个方口，并在接头上装耐磨合金。需要加强排渣，可在逆止阀上钻调气孔。
According to your request, the top sub can be made into two spanners, and put protection buttons. An air controlling hole can be drilled on the check valve to provide more efficient cuttings discharge.

技术参数 Technical Data					
总长 (不含钻头) Length(Less bit)	总重 (不含钻头) Weight(Less bit)	冲击器外径 External diameter	可配钻头钎柄 Bit Shank	钻孔范围 Hole Range	后接头螺纹 Connection Thread
1502mm	290.00Kg	Φ226mm	SD10	Φ254—Φ311	API 4 1/2 Reg API 6 5/8 Reg
可用工作风压 Working Pressure	在1.7Mpa时的冲击频率 Impact rate at 1.7Mpa	推荐转速 Recommended rotation speed	耗风量 Air consumption		
			1.0Mpa	1.8Mpa	2.4Mpa
1.0—2.5Mpa	18HZ	15—25r/min	22m ³ /min	40m ³ /min	55m ³ /min

HN100 DTH HAMMERDTH HAMMER:



Item Description (零部件名称)	Weight (重量) Kg	Part Number (零部件代号)
1、接头 Top Sub	59.00	HN10001
2、接头O形圈 "O" Ring of Top Sub	0.03	HN10002
3、接头垫片 Breakout Ring	0.40	HN10003
4、逆止阀 Check Valve	1.60	HN10004
5、弹簧 Spring	0.30	HN10005
6、承压垫 Compression Buffer	0.60	HN10006
7、配气座 Air Distributor	11.50	HN10007
8、内缸 Internal Cylinder	11.00	HN10008
9、活塞 Piston	62.00	HN10009
10、外缸 External Cylinder	112.00	HN10010
11、卡环O型圈 "O" Ring of Stop Ring	0.03	HN10011
12、卡环 Stop Ring	1.50	HN10012
13、卡钎套垫片 Breakout Ring	0.40	HN10013
14、卡钎套 Drive Chuck	26.00	HN10014
15、钻头 Drill Bit	115.00	HN10015

如客户要求，接头可采用两个方口，并在接头上装耐磨合金。需要加强排渣，可在逆止阀上钻调气孔。
According to your request, the top sub can be made into two spanners, and put protection buttons. An air controlling hole can be drilled on the check valve to provide more efficient cuttings discharge.

技术参数
Technical Data

总长 (不含钻头) Length(Less bit)	总重 (不含钻头) Weight(Less bit)	冲击器外径 External diameter	可配钻头钎柄 Bit Shank	钻孔范围 Hole Range	后接头螺纹 Connection Thread
1510mm	288.00Kg	Φ226mm	NUMA100	Φ254—Φ311	API 6 ³ / ₈ "Reg
可用工作风压 Working Pressure	在1.7Mpa时的冲击频率 Impact rate at 1.7Mpa	推荐转速 Recommended rotation speed	耗风量 Air consumption		
			1.0Mpa	1.8Mpa	2.4Mpa
1.0—2.5Mpa	18HZ	15—25r/min	22m ³ /min	45m ³ /min	60m ³ /min

HD1120 DTH HAMMERDTH HAMMER:



Item Description (零部件名称)	Weight (重量) Kg	Part Number (零部件代号)
1、接头 Top Sub	70.00	HD112001
2、接头O形圈 "O" Ring of Top Sub	0.04	HD112002
3、接头垫片 Breakout Ring	0.80	HD112003
4、逆止阀 Check Valve	3.00	HD112004
5、弹簧 Spring	0.10	HD112005
6、承压垫 Compression Buffer	1.00	HD112006
7、配气座 Air Distributor	20.00	HD112007
8、内缸 Internal Cylinder	23.00	HD112008
9、活塞 Piston	125.00	HD112009
10、外缸 External Cylinder	170.00	HD112010
11、衬套 Guided Sleeve	16.00	HD112011
12、卡环O形圈 "O" Ring of Stop Ring	0.04	HD112012
13、卡环 Stop Ring	4.50	HD112013
14、卡钎套垫片 Breakout Ring	0.80	HD112014
15、卡钎套 Drive Chuck	48.00	HD112015
16、钻头 Drill Bit	120.00	HD112016

如客户要求，接头可采用两个方口，并在接头上装耐磨合金。需要加强排渣，可在逆止阀上钻调气孔。
According to your request, the top sub can be made into two spanners, and put protection buttons. An air controlling hole can be drilled on the check valve to provide more efficient cuttings discharge.

技术参数 Technical Data					
总长(不含钻头) Length(Less bit)	总重(不含钻头) Weight(Less bit)	冲击器外径 External diameter	可配钻头钎柄 Bit Shank	钻孔范围 Hole Range	后接头螺纹 Connection Thread
1900mm	480.00Kg	Φ275mm	DHD1120	Φ305—Φ445	API 6 3/8" Reg
可用工作风压 Working Pressure	在1.7Mpa时的冲击频率 Impact rate at 1.7Mpa	推荐转速 Recommended rotation speed	耗风量 Air consumption		
			1.0Mpa	1.8Mpa	2.4Mpa
1.0—2.5Mpa	16HZ	15—25r/min	30m ³ /min	56m ³ /min	78m ³ /min

HSD12 DTH HAMMERDTH HAMMER:



Item Description (零部件名称)	Weight (重量) Kg	Part Number (零部件代号)
1、接 头 Top Sub	70.00	HSD1201
2、接头O形圈 "O" Ring of Top Sub	0.04	HSD1202
3、接头垫片 Breakout Ring	0.80	HSD1203
4、逆 止 阀 Check Valve	3.00	HSD1204
5、弹 簧 Spring	0.10	HSD1205
6、承 压 垫 Compression Buffer	1.00	HSD1206
7、配 气 座 Air Distributor	20.00	HSD1207
8、内 缸 Internal Cylinder	23.00	HSD1208
9、活 塞 Piston	125.00	HSD1209
10、外 缸 External Cylinder	170.00	HSD1210
11、卡环O型圈 "O" Ring of Stop Ring	0.04	HSD1211
12、卡 环 Stop Ring	4.80	HSD1212
13、衬 套 Guided Sleeve	18.00	HSD1213
14、卡钎套垫片 Breakout Ring	0.80	HSD1214
15、卡 钎 套 Drive Chuck	51.00	HSD1215
16、钻 头 Drill Bit	120.00	HSD1216

如客户要求，接头可采用两个方口，并在接头上装耐磨合金。需要加强排渣，可在逆止阀上钻调气孔。
 According to your request, the top sub can be made into two spanners, and put protection buttons. An air controlling hole can be drilled on the check valve to provide more efficient cuttings discharge.

技术参数
Technical Data

总长 (不含钻头) Length(Less bit)	总重 (不含钻头) Weight(Less bit)	冲击器外径 External diameter	可配钻头钎柄 Bit Shank	钻孔范围 Hole Range	后接头螺纹 Connection Thread
1880mm	487.00Kg	Φ275mm	SD12	Φ305—Φ445	API 6 ^{3/4} Reg
可用工作风压 Working Pressure	在1.7Mpa时的冲击频率 Impact rate at 1.7Mpa	推荐转速 Recommended rotation speed	耗风量 Air consumption		
			1.0Mpa	1.8Mpa	2.4Mpa
1.0—2.5Mpa	16HZ	15—25r/min	30m ³ /min	56m ³ /min	78m ³ /min

HN120 DTH HAMMERDTH HAMMER:

技术参数 Technical Data					
总长 (不含钻头) Length(Less bit)	总重 (不含钻头) Weight(Less bit)	冲击器外径 External diameter	可配钻头钎柄 Bit Shank	钻孔范围 Hole Range	后接头螺纹 Connection Thread
1900mm	485.00Kg	Φ275mm	NUMA120	Φ305—Φ445	API 6 5/8" Reg
可用工作风压 Working Pressure	在17bar时的冲击频率 Impact rate at 17 Bar	推荐转速 Recommended rotation speed	耗风量 Air consumption		
			1.0Mpa	1.8Mpa	2.4Mpa
1.0—2.5Mpa	16HZ	15—25r/min	30m ³ /min	56m ³ /min	78m ³ /min



Item Description (零部件名称)	Weight (重量) Kg	Part Number (零部件代号)
1、接头 Top Sub	70.00	HN12001
2、接头O形圈 "O" Ring of Top Sub	0.04	HN12002
3、接头垫片 Breakout Ring	0.80	HN12003
4、逆止阀 Check Valve	3.00	HN12004
5、弹簧 Spring	0.10	HN12005
6、承压垫 Compression Buffer	1.00	HN12006
7、配气座 Air Distributor	20.00	HN12007
8、内缸 Internal Cylinder	23.00	HN12008
9、活塞 Piston	125.00	HN12009
10、外缸 External Cylinder	170.00	HN12010
11、衬套 Guided Sleeve	18.00	HN12011
12、卡环O形圈 "O" Ring of Stop Ring	0.04	HN12012
13、卡环 Stop Ring	4.50	HN12013
14、卡钎套垫片 Breakout Ring	0.80	HN12014
15、卡钎套 Drive Chuck	49.00	HN12015
16、钻头 Drill Bit	120.00	HN12016

如客户要求，接头可采用两个方口，并在接头上装耐腐合金。需要加强排渣，可在逆止阀上钻调气孔。
According to your request, the top sub can be made into two spanners, and put protection buttons. An air controlling hole can be drilled on the check valve to provide more efficient cuttings discharge.

HN125 DTH HAMMERDTH HAMMER:



Item Description (零部件名称)	Weight (重量) Kg	Part Number (零部件代号)
1、接头 Top Sub	70.00	Hn12501
2、接头O形圈 "O" Ring of Top Sub	0.04	HN12502
3、接头垫片 Breakout Ring	0.80	HN12503
4、逆止阀 Check Valve	3.00	HN12504
5、弹簧 Spring	0.10	HN12505
6、承压垫 Compression Buffer	1.00	HN12506
7、配气座 Air Distributor	20.00	HN12507
8、内缸 Internal Cylinder	23.00	HN12508
9、活塞 Piston	125.00	HN12509
10、外缸 External Cylinder	170.00	HN12510
11、卡环O形圈 "O" Ring of Stop Ring	0.01	HN12511
12、卡环 Stop Ring	4.00	HN12512
13、卡钎套垫片 Breakout Ring	0.80	Hn12513
14、卡钎套 Drive Chuck	45.00	Hn12514
15、钻头 Drill Bit	175.00	HN12515

如客户要求，接头可采用两个方口，并在接头上装耐磨合金。需要加强排渣，可在逆止阀上钻调气孔。

According to your request, the top sub can be made into two spanners, and put protection buttons. An air controlling hole can be drilled on the check valve to provide more efficient cuttings discharge.

技术参数 Technical Data

总长 (不含钻头) Length(Less bit)	总重 (不含钻头) Weight(Less bit)	冲击器外径 External diameter	可配钻头钎柄 Bit Shank	钻孔范围 Hole Range	后接头螺纹 Connection Thread
1900mm	480.00Kg	Φ275mm	NUMA125	Φ305—Φ445	API 6 $\frac{1}{2}$ "Reg
可用工作风压 Working Pressure	在1.7Mpa时的冲击频率 Impact rate at 1.7Mpa	推荐转速 Recommended rotation speed	耗风量 Air consumption		
			1.0Mpa	1.8Mpa	2.4Mpa
1.0—2.5Mpa	16HZ	15—25r/min	30m ³ /min	56m ³ /min	78m ³ /min

High Pressure DTH HAMMERDTH HAMMER(No Nylon Tube):

HD25A DTH HAMMERDTH HAMMER:

Item Description (零部件名称)	Weight (重量) Kg	Part Number (零部件代号)
1、接头 Top Sub	3.10	HD25A01
2、逆止阀 Check Valve	0.10	HD25A02
3、弹簧 Spring	0.05	HD25A03
4、配气座 Air Distributor	0.60	HD25A04
5、内缸 Internal Cylinder	0.80	HD25A05
6、活塞 Piston	3.80	HD25A06
7、外缸 External Cylinder	4.50	HD25A07
8、衬套 Guided Sleeve	0.60	HD2508
9、O-形圈 "O" -Ring	0.005	HD25A09
10、卡环 Stop Ring	0.10	HD25A10
11、卡钎套 Drive Chuck	1.40	HD25A11
12、钻头 Drill Bit	3.20	HD25A12

技术参数 Technical Data					
总长 (不含钻头) Length(Less bit)	总重 (不含钻头) Weight(Less bit)	冲击器外径 External diameter	可配钻头钎柄 Bit Shank	钻孔范围 Hole Range	后接头螺纹 Connection Thread
872mm	16.00Kg	Φ71mm	HD25	Φ76—Φ90	T42x10x1.5
可用工作风压 Working Pressure	在1.5Mpa时的冲击频率 Impact rate at 1.5Mpa	推荐转速 Recommended rotation speed	耗风量 Air consumption		
			1.0Mpa	1.5Mpa	
1.0—1.5Mpa	25HZ	22—35r/min	4m ³ /min	6m ³ /min	

HD35A DTH HAMMERDTH HAMMER:

Item Description (零部件名称)	Weight (重量) Kg	Part Number (零部件代号)
1、接 头 Top Sub	4.20	HD35A01
2、接头O形圈 "O" Ring of Top Sub	0.01	HD35A02
3、逆 止 阀 Check Valve	0.20	HD35A03
4、弹 簧 Spring	0.02	HD35A04
5、配 气 座 Air Distributor	0.80	HD35A05
6、内 缸 Internal Cylinder	1.30	HD35A06
7、活 塞 Piston	5.50	HD35A07
8、外 缸 External Cylinder	9.50	HD35A08
9、衬 套 Guided Sleeve	1.00	HD35A09
10、卡环O形圈 "O" Ring of Stop Ring	0.05	HD35A10
11、卡 环 Stop Ring	0.15	HD35A11
12、卡 钎 套 Drive Chuck	1.90	HD35A12
13、钻 头 Drill Bit	5.00	HD35A13

如客户需要，接头可采用两个方口。需要加强排渣，可在逆止阀上钻调气孔。
According to your request, the top sub can be made into two spanners.
An air controlling hole can be drilled on the check valve to provide more efficient cuttings discharge.

技术参数 Technical Data					
总长 (不含钻头) Length(Less bit)	总重 (不含钻头) Weight(Less bit)	冲击器外径 External diameter	可配钻头钎柄 Bit Shank	钻孔范围 Hole Range	后接头螺纹 Connection Thread
888mm	25.00Kg	Φ82mm	IR3.5	Φ90—Φ115	API 2 $\frac{3}{8}$ " Reg
可用工作风压 Working Pressure	在1.5Mpa时的冲击频率 Impact rate at 1.5Mpa	推荐转速 Recommended rotation speed	耗风量 Air consumption		
			1.0Mpa	1.5Mpa	
1.0—1.5Mpa	25HZ	25—40r/min	3.8m ³ /min	7.5m ³ /min	

HD45A DTH HAMMERDTH HAMMER:

Item Description (零部件名称)	Weight (重量) Kg	Part Number (零部件代号)
1、接 头 Top Sub	6.50	HD45A01
2、接头O形圈 "O" Ring of Top Sub	0.01	HD45A02
3、逆 止 阀 Check Valve	0.35	HD45A03
4、弹 簧 Spring	0.05	HD45A04
5、配 气 座 Air Distributor	1.50	HD45A05
6、内 缸 Internal Cylinder	2.10	HD45A06
7、活 塞 Piston	8.50	HD45A07
8、外 缸 External Cylinder	15.20	HD45A08
9、衬 套 Guided Sleeve	1.30	HD45A09
10、卡环O形圈 "O" Ring of Stop Ring	0.01	HD45A0
11、卡 环 Stop Ring	0.30	HD45A11
12、卡 钎 套 Drive Chuck	3.40	HD45A12
13、钻 头 Drill Bit	9.00	HD45A13

如客户要求，接头可采用两个方口，并在接头上装耐磨合金。需要加强排渣，可在逆止阀上钻调气孔。
According to your request, the top sub can be made into two spanners, and put protection buttons. An air controlling hole can be drilled on the check valve to provide more efficient cuttings discharge.

技术参数 Technical Data					
总长 (不含钻头) Length(Less bit)	总重 (不含钻头) Weight(Less bit)	冲击器外径 External diameter	可配钻头钎柄 Bit Shank	钻孔范围 Hole Range	后接头螺纹 Connection Thread
1011mm	43.20Kg	Φ99mm	Cop44 DHD340	Φ110—Φ135	API 2 $\frac{1}{2}$ "Reg
可用工作风压 Working Pressure	在1.7Mpa时的冲击频率 Impact rate at 1.7Mpa	推荐转速 Recommended rotation speed	耗风量 Air consumption		
			1.0Mpa	1.8Mpa	2.4Mpa
1.0—2.5Mpa	30HZ	22—35r/min	6m ³ /min	10m ³ /min	15m ³ /min

HD45S DTH HAMMERDTH HAMMER:

Item Description (零部件名称)	Weight (重量) Kg	Part Number (零部件代号)
1、接 头 Top Sub	6.00	HD45S01
2、接头O形圈 "O" Ring of Top Sub	0.01	HD45S02
3、逆 止 阀 Check Valve	0.30	HD45S03
4、弹 簧 Spring	0.05	HD45S04
5、配 气 座 Air Distributor	1.30	HD45S05
6、内 缸 Internal Cylinder	1.90	HD45S06
7、活 塞 Piston	7.80	HD45S07
8、外 缸 External Cylinder	14.60	HD45S08
9、衬 套 Guided Sleeve	1.20	HD45S09
10、卡环O型圈 "O" Ring of Stop Ring	0.005	HD45S10
11、卡 环 Stop Ring	0.20	HD45S11
12、卡 钎 套 Drive Chuck	3.40	HD45S12
13、钻 头 Drill Bit	8.50	HD45S13

如客户需要，接头可采用两个方口，并在接头上装耐磨合金。需要加强排渣，可在逆止阀上钻调气孔。
According to your request, the top sub can be made into two spanners, and put protection buttons. An air controlling hole can be drilled on the check valve to provide more efficient cuttings discharge.

技术参数
Technical Data

总长 (不含钻头) Length(Less bit)	总重 (不含钻头) Weight(Less bit)	冲击器外径 External diameter	可配钻头钎柄 Bit Shank	钻孔范围 Hole Range	后接头螺纹 Connection Thread
986mm	37.00Kg	Φ92mm	Cop44 DHD340	Φ105—Φ120	API 2 3/8" Reg
可用工作风压 Working Pressure	在1.7Mpa时的冲击频率 Impact rate at 1.7Mpa	推荐转速 Recommended rotation speed	耗风量 Air consumption		
			1.0Mpa	1.8Mpa	2.4Mpa
1.0—2.5Mpa	30HZ	25—40r/min	5m ³ /min	8m ³ /min	13m ³ /min

HSD4A DTH HAMMERDTH HAMMER:

Item Description (零件名称)	Weight (重量) Kg	Part Number (零件代号)
1、接 头 Top Sub	6.50	HSD4A01
2、接头O形圈 "O" Ring of Top Sub	0.01	HSD4A02
3、逆 止 阀 Check Valve	0.35	HSD4A03
4、弹 簧 Spring	0.05	HSD4A04
5、配 气 座 Air Distributor	1.50	HSD4A05
6、内 缸 Internal Cylinder	2.10	HSD4A06
7、活 塞 Piston	8.50	HSD4A07
8、外 缸 External Cylinder	15.30	HSD4A08
9、衬 套 Guided Sleeve	1.30	HSD4A09
10、卡环O型圈 "O" Ring of Stop Ring	0.005	HSD4A10
11、卡 环 Stop Ring	0.20	HSD4A11
12、卡 钎 套 Drive Chuck	4.00	HSD4A12
13、钻 头 Drill Bit	9.80	HSD4A13

如客户需要，接头可采用两个方口，并在接头上装耐磨合金。需要加强排渣，可在逆止阀上钻调气孔。
According to your request, the top sub can be made into two spanners, and put protection buttons. An air controlling hole can be drilled on the check valve to provide more efficient cuttings discharge.

技术参数 Technical Data					
总长 (不含钻头) Length(Less bit)	总重 (不含钻头) Weight(Less bit)	冲击器外径 External diameter	可配钻头钎柄 Bit Shank	钻孔范围 Hole Range	后接头螺纹 Connection Thread
1012mm	40.00Kg	Φ99mm	SD4	Φ110—Φ135	API 2 $\frac{3}{8}$ " Reg
可用工作风压 Working Pressure	在1.7Mpa时的冲击频率 Impact rate at 1.7Mpa	推荐转速 Recommended rotation speed	耗风量 Air consumption		
			1.0Mpa	1.8Mpa	2.4Mpa
1.5—2.0Mpa	30HZ	25—40r/min	6m ³ /min	9m ³ /min	14m ³ /min

HM4A DTH HAMMERDTH HAMMER:

Item Description (零部件名称)	Weight (重量) Kg	Part Number (零部件代号)
1、接 头 Top Sub	6.50	HM4A01
2、接头O形圈 "O" Ring of Top Sub	0.01	HM4A02
3、逆 止 阀 Check Valve	0.35	HM4A03
4、弹 簧 Spring	0.05	HM4A04
5、配 气 座 Air Distributor	1.50	HM4A05
6、内 缸 Internal Cylinder	2.10	HM4A06
7、活 塞 Piston	8.50	HM4A07
8、外 缸 External Cylinder	14.80	HM4A08
9、衬 套 Guided Sleeve	1.80	HM4A09
10、卡环O型圈 "O" Ring of Stop Ring	0.005	HM4A10
11、卡 环 Stop Ring	0.30	HM4A11
12、卡 钎 套 Drive Chuck	3.80	HM4A12
13、钻 头 Drill Bit	6.60	HM4A13

如客户需要，接头可采用两个方口，并在接头上装耐磨合金。需要加强排渣，可在逆止阀上钻调气孔。
According to your request, the top sub can be made into two spanners, and put protection buttons. An air controlling hole can be drilled on the check valve to provide more efficient cuttings discharge.

技术参数 Technical Data					
总长 (不含钻头) Length(Less bit)	总重 (不含钻头) Weight(Less bit)	冲击器外径 External diameter	可配钻头钎柄 Bit Shank	钻孔范围 Hole Range	后接头螺纹 Connection Thread
1005mm	40.00Kg	Φ99mm	HM4	Φ110—Φ135	API 2 $\frac{1}{2}$ "Reg
可用工作风压 Working Pressure	在1.7Mpa时的冲击频率 Impact rate at 1.7Mpa	推荐转速 Recommended rotation speed	耗风量 Air consumption		
			1.0Mpa	1.8Mpa	2.4Mpa
1.0—2.5Mpa	30HZ	25—40r/min	5m ³ /min	9m ³ /min	14m ³ /min

DTH HAMMER for water wells, construction piles and oil drilling:

HD142ADTH HAMMERDTH HAMMER:



Item Description (零部件名称)	Weight (重量) Kg	Part Number (零部件代号)
1、接 头 Top Sub	20.00	HD142A01
2、接头O形圈 "O" Ring of Top Sub	0.02	HD142A02
3、逆 止 阀 Check Valve	0.70	HD142A03
4、弹 簧 Spring	0.10	HD142A04
5、配 气 座 Air Distributor	3.50	HD142A05
6、内 缸 Internal Cylinder	4.20	HD142A06
7、活 塞 Piston	23.00	HD142A07
8、外 缸 External Cylinder	31.50	HD142A08
9、衬 套 Guided Sleeve	6.50	HD142A09
10、卡环O形圈 "O" Ring of Stop Ring	0.01	HD142A10
11、卡 环 Stop Ring	0.60	HD142A11
12、垫 片 Breakout Ring	0.20	HD142A12
13、卡 钎 套 Drive Chuck	5.00	HD142A13
14、防 脱 套 Retainer	3.50	HD142A14
15、钻 头 Drill Bit	27.00	HD142A15

如客户要求，接头可采用两个方口，并在接头上装耐磨合金。需要加强排渣，可在逆止阀上钻调气孔。
 According to your request, the top sub can be made into two spanners, and put protection buttons. An air controlling hole can be drilled on the check valve to provide more efficient cuttings discharge.

技术参数 Technical Data					
总长 (含钻头) Length(With bit)	总重 (不含钻头) Weight(Less bit)	冲击器外径 External diameter	可配钻头钎柄 Bit Shank	钻孔范围 Hole Range	后接头螺纹 Connection Thread
1388mm	102.00Kg	Φ142mm	DHD360	Φ155—Φ195	API 3/4Reg
可用工作压力 Working Pressure	在1.7Mpa时的冲击频率 Impact rate at 1.7Mpa	推荐转速 Recommended rotation speed	耗风量 Air consumption		
			1.0Mpa	1.8Mpa	2.4Mpa
1.0—2.5Mpa	25HZ	20—30r/min	9m ³ /min	18m ³ /min	26m ³ /min

HD180A DTH HAMMERDTH HAMMER:



Item Description (零部件名称)	Weight (重量) Kg	Part Number (零部件代号)
1、接 头 Top Sub	34.00	HD180A01
2、接头O形圈 "O" Ring of Top Sub	0.015	HD180A02
3、垫 片 Breakout Ring	0.60	HD180A03
4、逆 止 阀 Check Valve	1.20	HD180A04
5、弹 簧 Spring	0.10	HD180A05
6、配 气 座 Air Distributor	6.00	HD180A06
7、内 缸 Internal Cylinder	6.50	HD180A07
8、活 塞 Piston	42.50	HD180A08
9、外 缸 External Cylinder	60.00	HD180A09
10、衬 套 Guided Sleeve	6.30	HD180A10
11、卡环O形圈 "O" Ring of Stop Ring	0.01	HD180A11
12、卡 环 Stop Ring	1.40	HD180A12
13、垫 片 Breakout Ring	0.60	HD180A13
14、卡 钎 套 Drive Chuck	12.00	HD180A14
15、防 脱 套 Retainer	6.50	HD180A15
16、钻 头 Drill Bit	37.00	HD180A16

如客户需要，接头可采用两个方口，并在接头上装耐磨合金。需要加强排渣，可在逆止阀上钻调气孔。
According to your request, the top sub can be made into two spanners, and put protection buttons. An air controlling hole can be drilled on the check valve to provide more efficient cuttings discharge.

技术参数
Technical Data

总长 (含钻头) Length(With bit)	总重 (不含钻头) Weight(Less bit)	冲击器外径 External diameter	可配钻头钎柄 Bit Shank	钻孔范围 Hole Range	后接头螺纹 Connection Thread
1520mm	178.00Kg	Φ180mm	QL80	Φ195—Φ254	API 4½Reg
可用工作风压 Working Pressure	在1.7Mpa时的冲击频率 Impact rate at 1.7Mpa	推荐转速 Recommended rotation speed	耗风量 Air consumption		
			1.0Mpa	1.8Mpa	2.4Mpa
1.0—2.5Mpa	20HZ	20—30r/min	12m³/min	22m³/min	28m³/min

HD225A DTH HAMMERDTH HAMMER:



Item Description (零件名称)	Weight (重量) Kg	Part Number (零件代号)
1、接 头 Top Sub	59.00	HD225A01
2、接头O形圈 "O" Ring of Top Sub	0.03	HD225A02
3、垫 片 Breakout Ring	0.80	HD225A03
4、逆 止 阀 Check Valve	1.40	HD225A04
5、弹 簧 Spring	0.30	HD225A05
6、配 气 座 Air Distributor	10.50	HD225A06
7、内 缸 Internal Cylinder	12.50	HD225A07
8、活 塞 Piston	77.00	HD225A08
9、外 缸 External Cylinder	110.00	HD225A09
10、衬 套 Guided Sleeve	4.50	HD225A10
11、卡环O形圈 "O" Ring of Stop Ring	0.02	HD225A11
12、卡 环 Stop Ring	1.90	HD225A12
13、垫 片 Breakout Ring	0.80	HD225A13
14、卡 钎 套 Drive Chuck	21.00	HD225A14
15、防 脱 套 Retainer	9.00	HD225A15
16、钻 头 Drill Bit	68.00	HD225A16

如客户需要，接头可采用两个方孔，并在接头上装耐磨合金。需要加强排渣，可在逆止阀上钻调气孔。
According to your request, the top sub can be made into two spanners, and put protection buttons. An air controlling hole can be drilled on the check valve to provide more efficient cuttings discharge.

技术参数
Technical Data

总长 (含钻头) Length(With bit)	总重 (不含钻头) Weight(Less bit)	冲击器外径 External diameter	可配钻头钎柄 Bit Shank	钻孔范围 Hole Range	后接头螺纹 Connection Thread
1745mm	315.00Kg	Φ225mm	Numa100	Φ254—Φ311	API 4 1/2 Reg API 6 5/8 Reg
可用工作风压 Working Pressure	在1.7Mpa时的冲击频率 Impact rate at 1.7Mpa	推荐转速 Recommended rotation speed	耗风量 Air consumption		
			1.0Mpa	1.8Mpa	2.4Mpa
1.0—2.5Mpa	20HZ	15—25r/min	22m ³ /min	40m ³ /min	65m ³ /min

HD275A DTH HAMMERDTH HAMMER:



Item Description (零部件名称)	Weight (重量) Kg	Part Number (零部件代号)
1、接头 Top Sub	230.00	HD275A01
2、接头O形圈 "O" Ring of Top Sub	0.04	HD275A02
3、垫片 Breakout Ring	1.00	HD275A03
4、逆止阀 Check Valve	2.00	HD275A04
5、弹簧 Spring	0.50	HD275A05
6、配气座 Air Distributor	16.00	HD275A06
7、内缸 Internal Cylinder	25.00	HD275A07
8、活塞 Piston	113.00	HD275A08
9、外缸 External Cylinder	170.00	HD275A09
10、衬套 Guided Sleeve	23.00	HD275A10
11、卡环O形圈 "O" Ring of Stop Ring	0.03	HD275A11
12、卡环 Stop Ring	4.00	HD275A12
13、垫片 Breakout Ring	1.00	HD275A13
14、卡钎套 Drive Chuck	34.00	HD275A14
15、防脱套 Retainer	30.00	HD275A15
16、钻头 Drill Bit	185.00	HD275A16

可根据工地使用情况，选用不同直径气孔的逆止阀，以保证排渣效果。
According to the different drilling situation, you can choose check valves of different size air exhaust holes to assure the effective cuttings discharge.

技术参数 Technical Data					
总长 (含钻头) Length(With bit)	总重 (不含钻头) Weight(Less bit)	冲击器外径 External diameter	可配钻头钎柄 Bit Shank	钻孔范围 Hole Range	后接头螺纹 Connection Thread
2626mm	650.00Kg	Φ275mm	Numa125	Φ305—Φ445	API 6 ⁵ / ₈ Reg API 7 ⁵ / ₈ Reg
可用工作风压 Working Pressure	在1.7Mpa时的冲击频率 Impact rate at 1.7Mpa	推荐转速 Recommended rotation speed	耗风量 Air consumption		
			1.0Mpa	1.8Mpa	2.4Mpa
1.0—2.5Mpa	20HZ	15—25r/min	28m ³ /min	50m ³ /min	71m ³ /min

Reverse cycle DTH Hammer:

HRC45 Reverse cycle DTH Hammer:



Item Description (零部件名称)	Weight (重量) Kg	Part Number (零部件代号)
1、卡簧 Internal Circlip	0.03	HRC4501
2、透气筛 Air Screen	0.35	HRC4502
3、接头 Top Sub	6.50	HRC4503
4、O-形圈 "O" Ring	0.01	HRC4504
5、采集管 Sample Tube	5.10	HRC4505
6、逆止阀 Check Valve	0.25	HRC4506
7、弹簧 Spring	0.04	HRC4507
8、O-形圈 "O" Ring	0.01	HRC4508
9、配气座 Air Distributor	0.85	HRC4509
10、O-形圈 "O" Ring	0.02	HRC4510
11、内缸 Internal Cylinder	2.20	HRC4511
12、活塞 Piston	8.50	HRC4512
13、外缸 External Cylinder	14.50	HRC4513
14、衬套 Guided Sleeve	1.20	HRC4514
15、卡钎套 Drive Chuck	3.20	HRC4515
16、挡珠 Bit Retaining Pin	0.01	HRC4516
17、钻头 Drill Bit	10.50	HRC4517

技术参数 Technical Data					
总长 (不含钻头) Length(Less bit)	总重 (不含钻头) Weight(Less bit)	冲击器外径 External diameter	可配钻头钎柄 Bit Shank	钻孔范围 Hole Range	后接头螺纹 Connection Thread
1020mm	94.0Kg	Φ99mm	HRC45	Φ114—Φ127	根据客户钻管螺纹确定 Upon the thread of the drill tube.
可用工作风压 Working Pressure	在1.7Mpa时的冲击频率 Impact rate at 1.7Mpa	推荐转速 Recommended rotation speed	耗风量 Air consumption		
			1.0Mpa	1.8Mpa	2.4Mpa
1.0—3.0Mpa	30HZ	25—40r/min	8m ³ /min	12m ³ /min	16m ³ /min

HRC55 Reverse cycle DTH Hammer:



Item Description (零部件名称)	Weight (重量) Kg	Part Number (零部件代号)
1、卡簧 Internal Circlip	0.04	HRC5501
2、通气筛 Air Screen	0.44	HRC5502
3、接头 Top Sub	9.65	HRC5503
4、O-形圈 "O" Ring	0.02	HRC5504
5、采集管 Sample Tube	6.72	HRC5505
6、逆止阀 Check Valve	0.68	HRC5506
7、弹簧 Spring	0.12	HRC5507
8、O-形圈 "O" Ring	0.02	HRC5508
9、配气座 Air Distributor	1.48	HRC5509
10、O-形圈 "O" Ring	0.01	HRC5510
11、内缸 Internal Cylinder	4.12	HRC5511
12、活塞 Piston	16.9	HRC5512
13、外缸 External Cylinder	19.5	HRC5513
14、衬套 Guided Sleeve	0.90	HRC5514
15、卡钎套 Drive Chuck	5.65	HRC5515
16、挡珠 Bit Retaining Pin	0.15	HRC5516
17、钻头 Drill Bit	15.80	HRC5517

技术参数 Technical Data					
总长 (不含钻头) Length(Less bit)	总重 (不含钻头) Weight(Less bit)	冲击器外径 External diameter	可配钻头钎柄 Bit Shank	钻孔范围 Hole Range	后接头螺纹 Connection Thread
1111mm	66.5Kg	Φ126mm	HRC55	Φ133—Φ152	根据客户钻管螺纹确定 Upon the thread of the drill tube.
可用工作风压 Working Pressure	在2.4Mpa时的冲击频率 Impact rate at 2.4Mpa	推荐转速 Recommended rotation speed	耗风量 Air consumption		
			1.7Mpa	2.4Mpa	3.0Mpa
1.5—3.5Mpa	35HZ	25—40r/min	16m ³ /min	22m ³ /min	28m ³ /min

HRC65 Reverse cycle DTH Hammer:



Item Description (零件名称)	Weight (重量) Kg	Part Number (零件代号)
1、卡簧 Internal Circlip	0.05	HRC6501
2、通气筛 Air Screen	0.65	HRC6502
3、接头 Top Sub	20.00	HRC6503
4、O-形圈 "O" Ring	0.02	HRC6504
5、采集管 Sample Tube	12.50	HRC6505
6、逆止阀 Check Valve	0.85	HRC6506
7、弹簧 Spring	0.10	HRC6507
8、O-形圈 "O" Ring	0.02	HRC6508
9、配气座 Air Distributor	3.50	HRC6509
10、O-形圈 "O" Ring	0.02	HRC6510
11、内缸 Internal Cylinder	4.20	HRC6511
12、活塞 Piston	24.00	HRC6512
13、外缸 External Cylinder	32.00	HRC6513
14、衬套 Guided Sleeve	5.50	HRC6514
15、卡钎套 Drive Chuck	6.50	HRC6515
16、挡珠 Bit Retaining Pin	0.30	HRC6516
17、钻头 Drill Bit	31.00	HRC6517

技术参数 Technical Data					
总长 (不含钻头) Length(Less bit)	总重 (不含钻头) Weight(Less bit)	冲击器外径 External diameter	可配钻头钎柄 Bit Shank	钻孔范围 Hole Range	后接头螺纹 Connection Thread
1250mm	110.0Kg	Φ146mm	HRC65	Φ155—Φ190	根据客户钻管螺纹确定 Upon the thread of the drill tube.
可用工作风压 Working Pressure	在2.4Mpa时的冲击频率 Impact rate at 2.4Mpa	推荐转速 Recommended rotation speed	耗风量 Air consumption		
			1.7Mpa	2.0Mpa	3.0Mpa
1.5—3.5Mpa	28HZ	25—40r/min	20m ³ /min	262m ³ /min	35m ³ /min

HRC52 Reverse cycle DTH Hammer:



Item Description (零部件名称)	Weight (重量) Kg	Part Number (零部件代号)
1、卡簧 Internal Circlip	0.04	HPR5201
2、通气筛 Air Screen	0.44	HPR5202
3、接头 Top Sub	9.65	HPR5203
4、O-形圈 "O" Ring	0.02	HPR5204
5、采集管 Sample Tube	6.75	HPR5205
6、逆止阀 Check Valve	0.68	HPR5206
7、弹簧 Spring	0.12	HPR5207
8、O-形圈 "O" Ring	0.02	HPR5208
9、配气座 Air Distributor	1.48	HPR5209
10、O-形圈 "O" Ring	0.01	HRC6510
11、内缸 Internal Cylinder	4.12	HPR5211
12、活塞 Piston	16.9	HPR5212
13、外缸 External Cylinder	21.50	HPR5213
14、衬套 Guided Sleeve	1.90	HPR5214
15、O-形圈 "O" Ring	0.02	HPR5215
16、O-形圈 "O" Ring	0.01	HPR5216
17、卡环 Stop Ring	0.32	HPR5217
18、耐磨套 Shroud	1.86	HPR5218
19、卡钎套 Drive Chuck	4.17	HPR5219
20、钻头 Drill Bit	11.05	HPR5220

技术参数 Technical Data					
总长 (不含钻头) Length(Less bit)	总重 (不含钻头) Weight(Less bit)	冲击器外径 External diameter	可配钻头钎柄 Bit Shank	钻孔范围 Hole Range	后接头螺纹 Connection Thread
1208mm	70.0Kg	Φ126mm	PR52	Φ133—Φ146	根据客户钻管螺纹确定 Upon the thread of the drill tube.
可用工作压力 Working Pressure	在2.4Mpa时的冲击频率 Impact rate at 2.4mpa	推荐转速 Recommended rotation speed	耗风量 Air consumption		
			1.7Mpa	2.4Mpa	3.0Mpa
1.5—3.5Mpa	35HZ	25—40r/min	16m ³ /min	22m ³ /min	28m ³ /min

1-2 Inches Middle Pressure DTH Drill Bit:

钻头系列 Drill Bit	钻头 直径 Bit Dia. (mm)	排气孔 数量 NO. Air Holes	边齿 Gauge Buttons	中齿 Front Buttons	重量 Weight (Kg)	编号 Part No.
BR1 	64	2	6 × φ 10	3 × φ 10	2.6	HBR1—64
	70	2	6 × φ 12	4 × φ 9	2.8	HBR1—70
	76	2	6 × φ 12	5 × φ 10	3.2	HBR1—76
BR2 	76	2	6 × φ 12	5 × φ 10	3.6	HBR2—76
	80	2	6 × φ 13	5 × φ 10	4.0	HBR2—80
	90	2	6 × φ 13	6 × φ 10	4.2	HBR2—90
HD25 	76	2	6 × φ 13	5 × φ 10	3.6	Hd25—76
	82	2	6 × φ 14	4 × φ 11	4.0	HD25—82
	90	2	8 × φ 12	5 × φ 12	4.2	Hd25—90

我们可根据客户对钻头直径大小、排气孔数量、合金齿形状和钻头头部形状的不同要求分别设计制造。
We can design and manufacture according to customer's requirement of the Bit Dia, No. of air holes, carbide button shape and the face shape.

3 Inches High Pressure DTH Drill Bit:

钻头系列 Drill Bit	钻头 直径 Bit Dia. (mm)	排气孔 数量 NO. Air Holes	边齿 Gauge Buttons	中齿 Front Buttons	重量 Weight (Kg)	编号 Part No.
 COP32	85	2	6 × φ 13	4 × φ 12	4.2	COP32—85
	90	2	6 × φ 14	4 × φ 12	4.5	COP32—90
	95	2	6 × φ 14	4 × φ 13	4.7	COP32—95
	100	2	6 × φ 14	5 × φ 12	5.0	COP32—100
	105	2	6 × φ 14	5 × φ 13	5.3	COP32—105
 BR3	85	2	6 × φ 13	4 × φ 12	3.8	BR3—85
	90	2	6 × φ 14	4 × φ 12	4.0	BR3—90
	95	2	6 × φ 14	5 × φ 12	4.3	BR3—95
	100	2	8 × φ 13	6 × φ 13	4.8	BR3—100
	105	2	8 × φ 13	6 × φ 13	5.2	BR3—105
 HD35 (IR3.5, COP34)	85	2	6 × φ 13	4 × φ 12	4.2	HD35—85
	90	2	6 × φ 14	4 × φ 12	4.5	HD35—90
	95	2	6 × φ 14	4 × φ 13	4.8	HD35—95
	100	2	6 × φ 14	5 × φ 12	5.0	HD35—100
	105	2	6 × φ 14	5 × φ 13	5.5	HD35—105
 QL30(COP34)	85	2	6 × φ 13	4 × φ 12	4.5	QL30—85
	90	2	6 × φ 14	4 × φ 12	4.7	QL30—90
	95	2	6 × φ 14	4 × φ 13	4.9	QL30—95
	100	2	6 × φ 14	5 × φ 12	5.0	QL30—100
	105	2	6 × φ 14	5 × φ 13	5.5	QL30—105

我们可根据客户对钻头直径大小、排气孔数量、合金齿形状和钻头头部形状的不同要求分别设计制造。

We can design and manufacture according to customer's requirement of the Bit Dia, No. of air holes, carbide button shape and the face shape.

4 Inches High Pressure DTH Drill Bit:

钻头系列 Drill Bit	钻头 直径 Bit Dia. (mm)	排气孔 数量 NO. Air Holes	边齿 Gauge Buttons	中齿 Front Buttons	重量 Weight (Kg)	编号 Part No.
HD45 (DHD340A、 COP44) 	105	2	6 × φ 14	5 × φ 13	8.5	HD45—105
	110	2	7 × φ 14	6 × φ 13	8.8	HD45—110
	115	2	7 × φ 14	6 × φ 13	9.0	HD45—115
	120	2	8 × φ 14	7 × φ 13	9.8	HD45—120
	127	2	8 × φ 14	7 × φ 13	11.0	HD45—127
SD4 	105	2	6 × φ 14	5 × φ 13	9.0	SD4—105
	110	2	7 × φ 14	6 × φ 13	9.5	SD4—110
	115	2	7 × φ 14	6 × φ 13	9.8	SD4—115
	120	2	8 × φ 14	7 × φ 13	11.5	SD4—120
	127	2	8 × φ 14	7 × φ 13	12.3	SD4—127
QL40 	105	2	6 × φ 14	5 × φ 13	9.0	QL40—105
	110	2	7 × φ 14	6 × φ 13	9.2	QL40—110
	115	2	7 × φ 14	6 × φ 13	9.5	QL40—115
	120	2	8 × φ 14	7 × φ 13	10.3	QL40—120
	127	2	8 × φ 14	7 × φ 13	11.5	QL40—127
HM4 	105	2	6 × φ 14	5 × φ 13	6.0	HM4—105
	110	2	7 × φ 14	6 × φ 13	6.2	HM4—110
	115	2	7 × φ 14	6 × φ 13	6.6	HM4—115
	120	2	8 × φ 14	7 × φ 13	7.0	HM4—120
	127	2	8 × φ 14	7 × φ 13	7.4	HM4—127

我们可根据客户对钻头直径大小、排气孔数量、合金齿形状和钻头头部形状的不同要求分别设计制造。
We can design and manufacture according to customer's requirement of the Bit Dia, No. of air holes, carbide button shape and the face shape.

5 Inches High Pressure DTH Drill Bit:

钻头系列 Drill Bit	钻头 直径 Bit Dia. (mm)	排气孔 数量 NO. Air Holes	边齿 Gauge Buttons	中齿 Front Buttons	重量 Weight (Kg)	编号 Part No.
 HD55 (DHD350R、COP54)	135	2	7 × φ 18	6 × φ 14	15.0	Hd55—135
	140	2	7 × φ 18	7 × φ 14	16.0	HD55—140
	146	2	7 × φ 18	7 × φ 14	17	HD55—146
	152	2	8 × φ 18	8 × φ 14	17.5	HD55—152
	165	2	8 × φ 18	8 × φ 16	18.5	HD55—165
 SD5	135	2	7 × φ 16	6 × φ 14	15.5	SD5—135
	140	2	7 × φ 18	7 × φ 14	16	SD5—140
	146	2	8 × φ 18	7 × φ 14	16.5	SD5—146
	152	2	8 × φ 18	8 × φ 14	17	SD5—152
	165	2	8 × φ 18	8 × φ 16	18	SD5—165
 QL50	135	2	7 × φ 18	6 × φ 14	15.5	QL50—135
	140	2	7 × φ 18	7 × φ 14	16	QL50—140
	146	2	7 × φ 18	7 × φ 14	16.5	QL50—146
	152	2	8 × φ 18	8 × φ 14	17	QL50—152
	165	2	8 × φ 18	8 × φ 16	18	QL50—165
 HM5	135	2	7 × φ 18	6 × φ 14	12.5	HM5—135
	140	2	7 × φ 18	7 × φ 14	13.5	HM5—140
	146	2	7 × φ 18	7 × φ 14	14	HM5—146
	152	2	8 × φ 18	8 × φ 14	14.4	HM5—152
	165	2	8 × φ 18	8 × φ 16	15	HM5—165

我们可根据客户对钻头直径大小、排气孔数量、合金齿形状和钻头头部形状的不同要求分别设计制造。
We can design and manufacture according to customer's requirement of the Bit Dia, No.of air holes, carbide button shape and the face shape.

Reaming Drill Bit:

DTH Reaming Drill Bit:

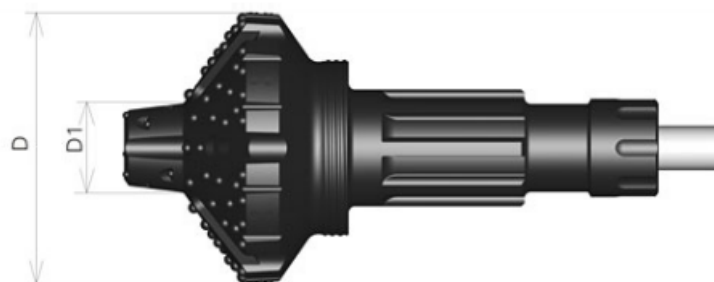

D mm	D1 mm	边齿 Gauge	正面齿 Front	产品编号 Part-No	可配钎柄 Shank
165	82	14	14	HK165/82-HD45	DHD340 SD4 QL40
178	99	16	14	HK178/99-HD45	
190	115	16	14	HK190/115-HD55	DHD350 SD5 QL50
216	138	16	14	HK216/138-HD55	
254	159	16	14	HK254/159-HD65	DHD360 SD6 QL60
305	208	16	16	HK305/208-HD65	
381	296	16	16	HK381/296-HD65	
305	208	16	16	HK305/208-HD85	DHD380 SD8 QL80
381	296	16	16	HK381/296-HD85	
445	305	18	16	HK445/305-SD10	SD10 Numa100
482	311	18	16	HK381/296-SD10	
660	445	19	18	HK660/445-SD12	SD12 Numa120

DTH Thread Reaming Drill Bit:



钎头直径D1 mm	导孔直径D2 mm	螺纹T Gauge	产品编号 Part-No
76	26	R32	HLK76/26-R32
89	43	R32	HLK89/26-R32
102	43	R38	HLK102/43-R38
115	76	R38	HLK115/76-R38
102	43	T38	HLK102/43-T38
115	76	T38	HLK115/76-T38
127	76	T45	HLK127/76-T45
140	89	T45	HLK140/89-T45
165	102	T51	HLK165/102-T51

Opener Reaming Drill Bit:

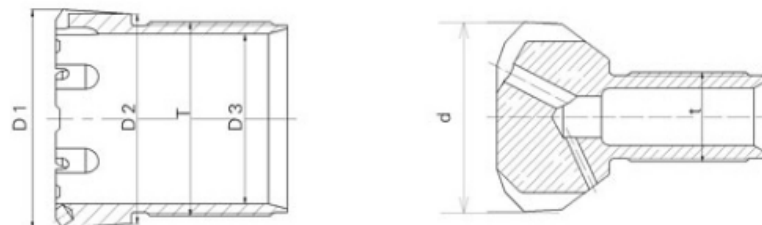

产品名称 Name of product	D1 mm	D2 mm	D3 mm	边齿 Gauge	正面齿 Front	产品编号 Part-No	螺纹型号 Thread
Crown Opener Bits 	125	118	88	16	14	HQK125/88-T104.5	T104.5
	140	133	108	16	14	HQK140/108-T122	T122
	152	133	108	16	16	HQK152/108-T122	T122
	172	165	133	16	16	HQK172/165-T146.5	T146.5
	225	216	178	18	16	HQK225/216-T203	T203
Inner Opener Bits	d mm	t mm	边齿 Gauge	正面齿 Front	产品编号 Part-No	螺纹型号 Thread	
	83	56	13	12	HWQK83-R56	R56x12.7	
	102	56	14	14	HWQK102-R56	R56x12.7	
	116	78	16	14	HWQK116-R78	R78x22.56	
	128	83	16	16	HWQK128-R83	R83x22.56	
	165	120	18	16	HWQK165-R120	R120x22.56	



**HEBEI GIMARPOL
MACHINERY TECHNOLOGY CO., LTD**

Add:No.466 Zhongshan Road ,Shijiazhuang City,China

Tel:86-0311-80691845

Email:admin@gimarpol.com

Website:<http://gimarpol.en.alibaba.com>