



MINING
CEMENT

PORT
AGGREGATE

BUSINESS of **CEITEC**

BULK MATERIAL TECHNOLOGY

CONNECT AND DRIVE THE WORLD

Bulk Material Handling Conveyor System

Your Reliable Partner

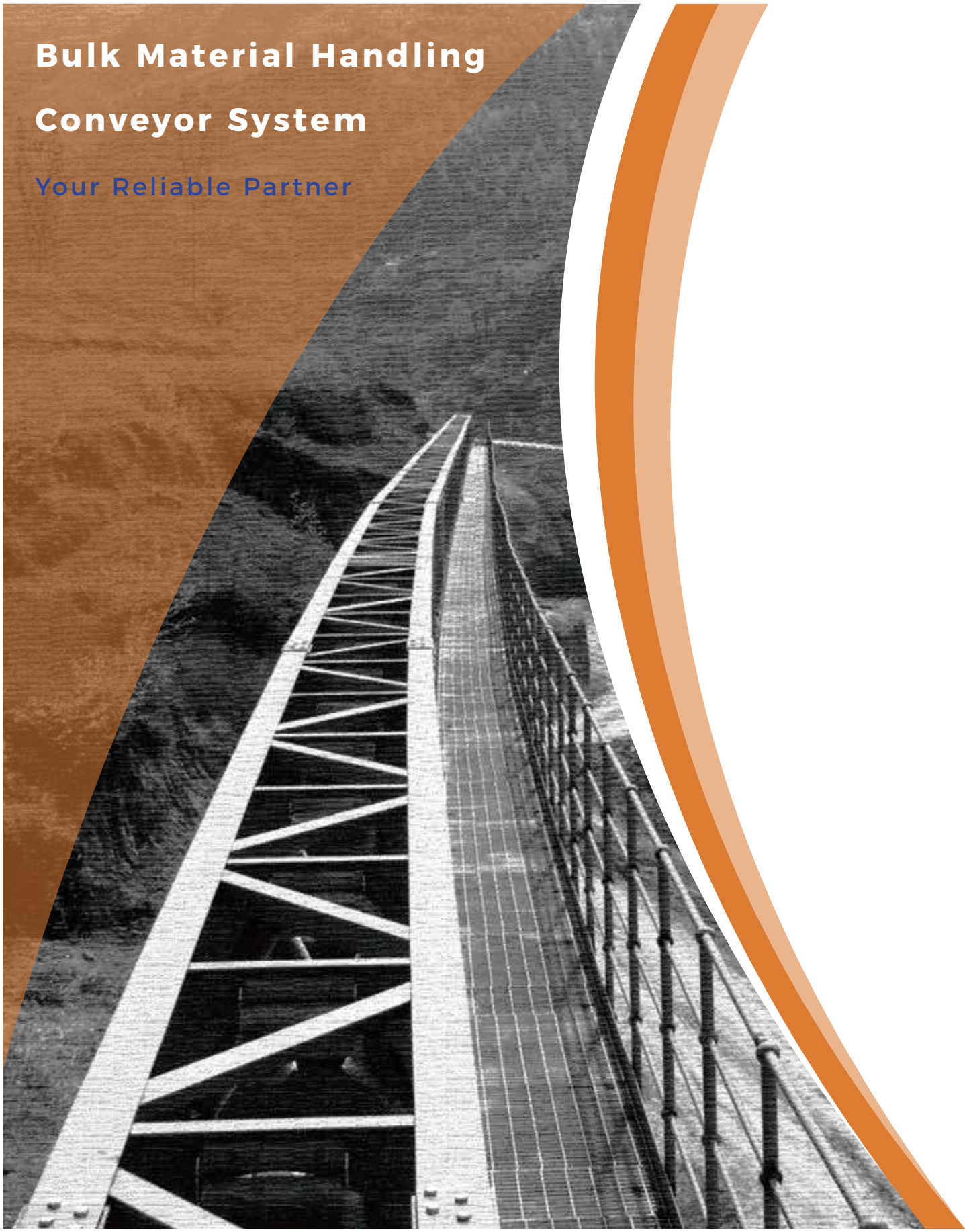

CONTENTS

- ◆ Company Profile /01
- ◆ Business Scope /05
- ◆ Technology /07
- ◆ Products /09
- ◆ Achievements /13
- ◆ Highlights /15

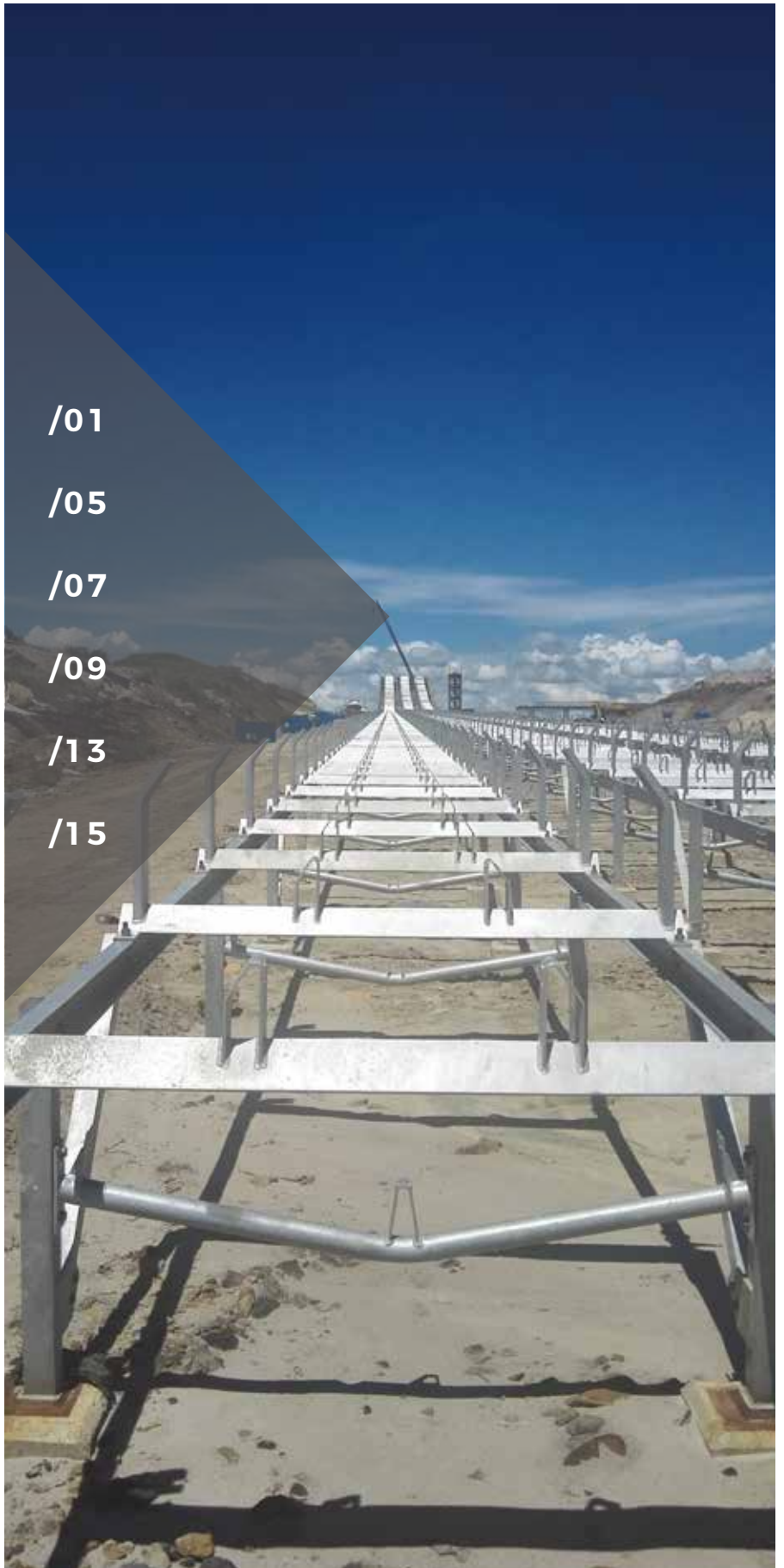



Overview

BULKTEC Co., Ltd as a member of the National High-tech Enterprise **CETEC Co., Ltd** specializes in the research, engineering, design and manufacturing of complete sets of material handling equipment (belt conveyors, radial stacker, mobile tripper and pipe conveyors etc.). Members of the company include CETEC Co., Ltd., LIBO International Mechanical & Electrical Co., Ltd., BULKTEC Co., Ltd.

BULKTEC Co., Ltd provides customers with a full package of services from feasibility study, design, production, build, maintenance. It also provides customers with overall solutions for intelligent conveying systems upgrading. The company has first-class production, testing equipment and perfect quality assurance system. We have passed ISO9001 Quality system, ISO14001 Environmental system, GB / T28001 occupational health and safety management system and ISO10012 Measurement Management System certification. Our customers are in **Mining & Metal, Cement, Building Materials, Power Plants, Port** and other industries, including CRH, LafargeHolcim, Cemex, Heidelberg, AngloGold Ashanti, Posco E&C, Formosa Plastics and many other leading international companies.



About Us

BULKTEC Co., Ltd has rich experience in the design, manufacture, construction, operation and maintenance of long distance belt conveyors, large capacity conveyors and conveyors under complicated conditions. We provide full life cycle services and assist our customers to upgrade the intelligent control system for the belt conveyor.

The company manufactures belt conveyors, belt feeders, mobile tripper, distributor conveyors, crawlers, rollers, idlers, pulley, steel structures, power distribution & control systems and other relevant products. We can also customize the steel wire conveyor belts, fabric core belt and other special conveyor belt for customers.

BULKTEC Co., Ltd has advanced production and processing technology, full set of automatic production equipment and a thorough manufacturing QAQC system. Our technical and project management team have rich international project contracting and construction experiences.



Manufacturing Capacity

The company has advanced design, analysis, and drawing software for belt conveyors and round tube belt conveyors, including static calculation and dynamic analysis software, steel structure design and analysis software, material discrete element analysis software, and two-dimensional and three-dimensional drawing software, Overland calculation and analysis software.

We can provide accurate calculation and dynamic analysis for large inclination, long distance, linear friction multi-point drive, curved belt conveyor, tube belt conveyor, effectively improve energy efficiency, reduce material transfer dust, and improve Rubber conveyor belt life.

The 3D deepening design software for steel structure greatly improves the design efficiency and accuracy and ensures the engineering quality.





BULKTEC is committed to the R&D, design and manufacturing of green energy-saving belt conveyor system and new high-strength carcass, to improve the performance such as energy-saving, environmental protection and durability.



Our conveyor belt products include steel cord belts, fabric belt and belts with special structure (heat-resistant, high-temperature resistant, flame retardant, high-strength, energy-saving and environment friendly), which are widely used in mining, metal, metallurgy, cement, port and power plant.



With years of experience in R&D, manufacturing and operation of conveyor belts, **BULKTEC** has taken the lead in entering the business of total package service for conveyor system. **BULKTEC** has fully integrated products, technologies, services, management and other resources to provide a service package of selection, design, manufacturing, installation, repair, maintenance, renewal, replacement, upgrade and recycling.



Business Scope

- ◆ Belt Conveyor System Design
- ◆ Conveyor & Components Supply
- ◆ Intelligitize & Informationize System (RFID)
- ◆ Steel Structure Supply

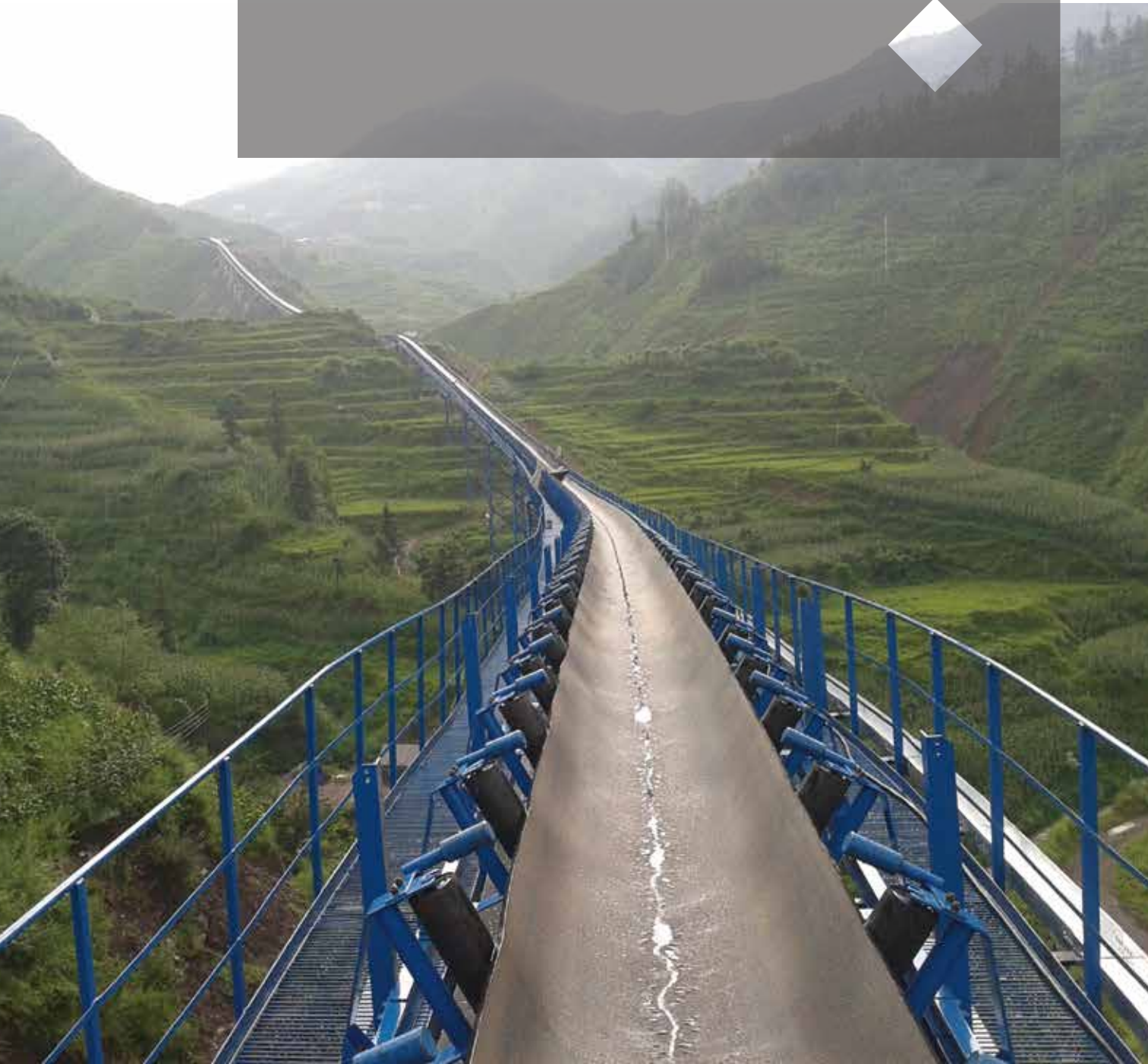



◆ MINING



◆ CEMENT

We focus on continuous innovation in bulk material handling technology, in in the fields of

Mining ◆ Cement ◆ Aggregate ◆ Port

We strive to bring customers maximum benefits with

- ◆ The Most Advanced Technology
- ◆ The Best Quality Equipment
- ◆ The Optimized Cost

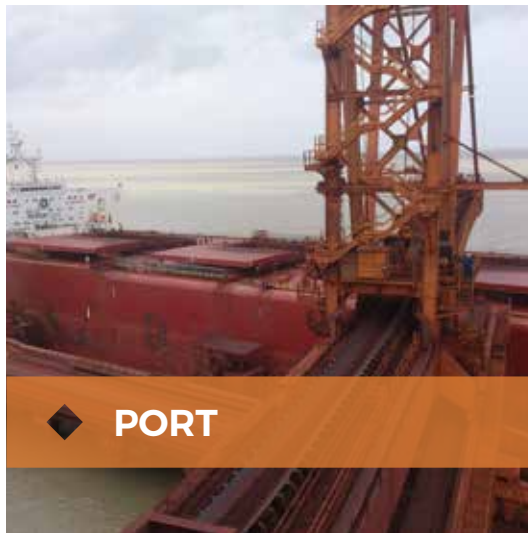

◆ PORT



◆ AGGREGATE

Technology

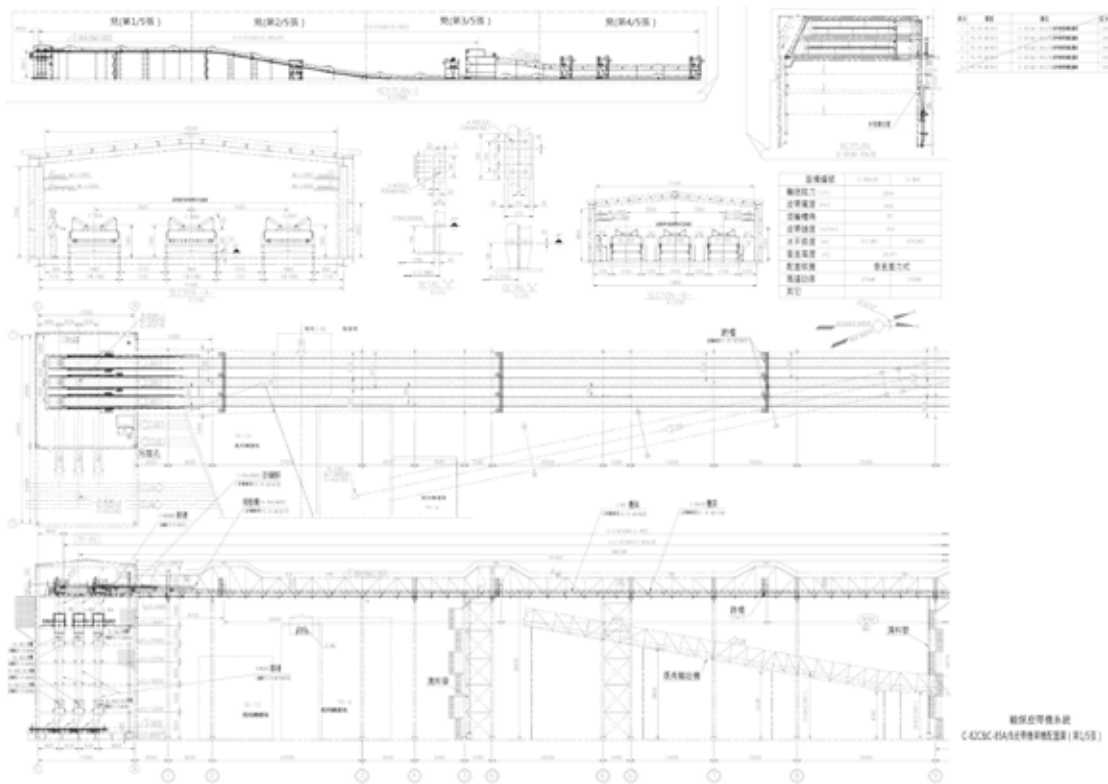

Bulk Handling Layout Services

Provide PID and GA according to DIN, ISO, CEMA, or GB standards;
Dynamic analysis for long distance and curved belt conveyors.



Steel Structure Engineering and Detailing

Engineering Code

- ◆ China GB.50017
- ◆ US: AISC
- ◆ Europe: BS EN1993-1-8

Engineer Verification

- ◆ LEED Accredited Professional, USA
- ◆ Class 1 Registered Structural Engineer, PRC
- ◆ Master degree of Civil & Structural Engineering, PRC



DEM application for Transfer Chute

Avoid misalign discharge;

Keep the material flow shape and low dust generating;

Guide the out let flow in receiving belt run direction;

Control the flow speed and provide lower abrasion and noiseless.

Optimized Compact Design, cost saving.

DEM simulation

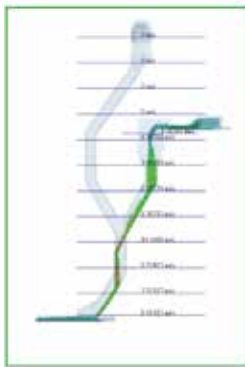

FEM analysis

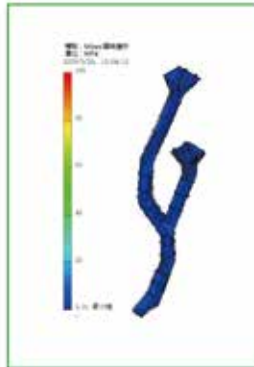

3D modelling and shop drawing

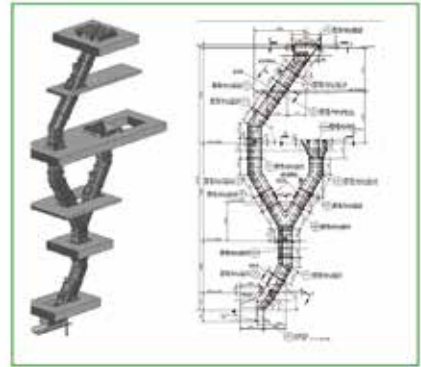

3D Plant BIM application

3D Plant modelling and detailing engineering, including conveyors and transfer tower, other machines and steel truss. We develop all belt conveyors, dust exhaust system which could perform interface check with steel structure and other facilities.

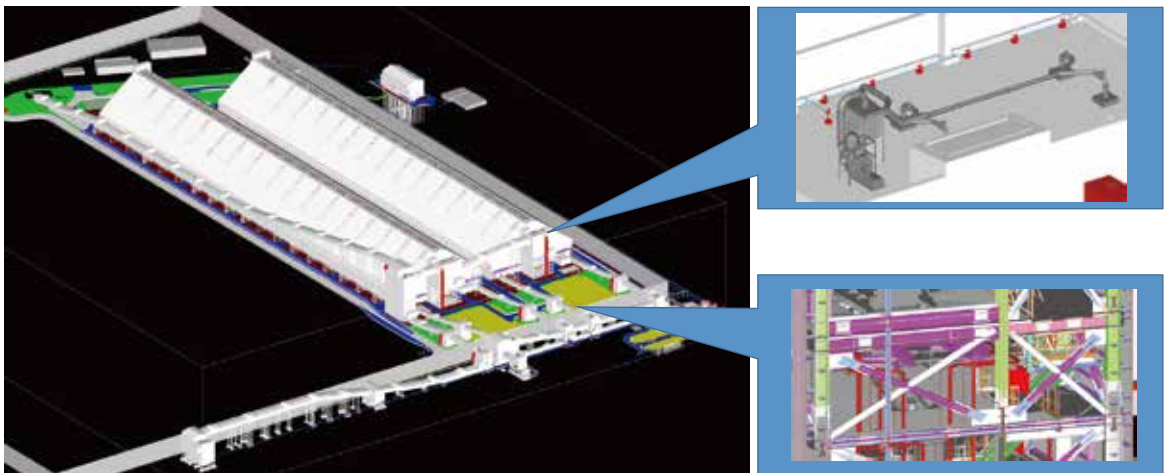

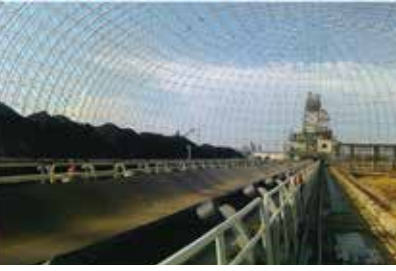

Overland Conveyor



Tunnel Conveyor



Pipe Conveyor

Conveyor

We can match all work conditions

- Long Distance
- Large Slope
- Overland
- Underground
- Tunnel
- Pipe



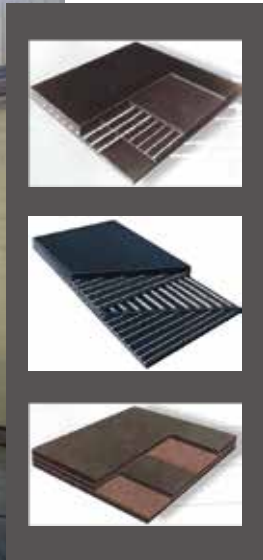

Conveyor Belt

Steel Structure



Conveyor Components



Product

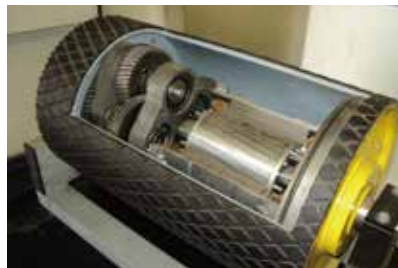

Conveyor
Components





SCRAPERS & SWEEPER

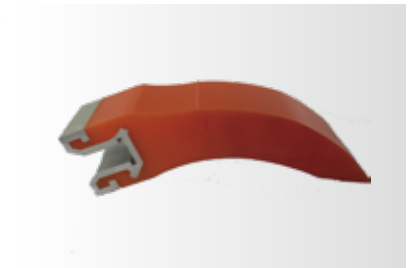

Sweeper & Components





The belt conveyor we supplied successful operation in vostochny port in Russia at **-40°C**



Supply belt conveyor to International Mining Giant **AngloGlod Ashanti** or Cement Leader **LafargeHolcim**



Cooperate with International General Contractor like **POSCO, CNBM, DF** in EPC projects depend on our quality assurance





Main Customer

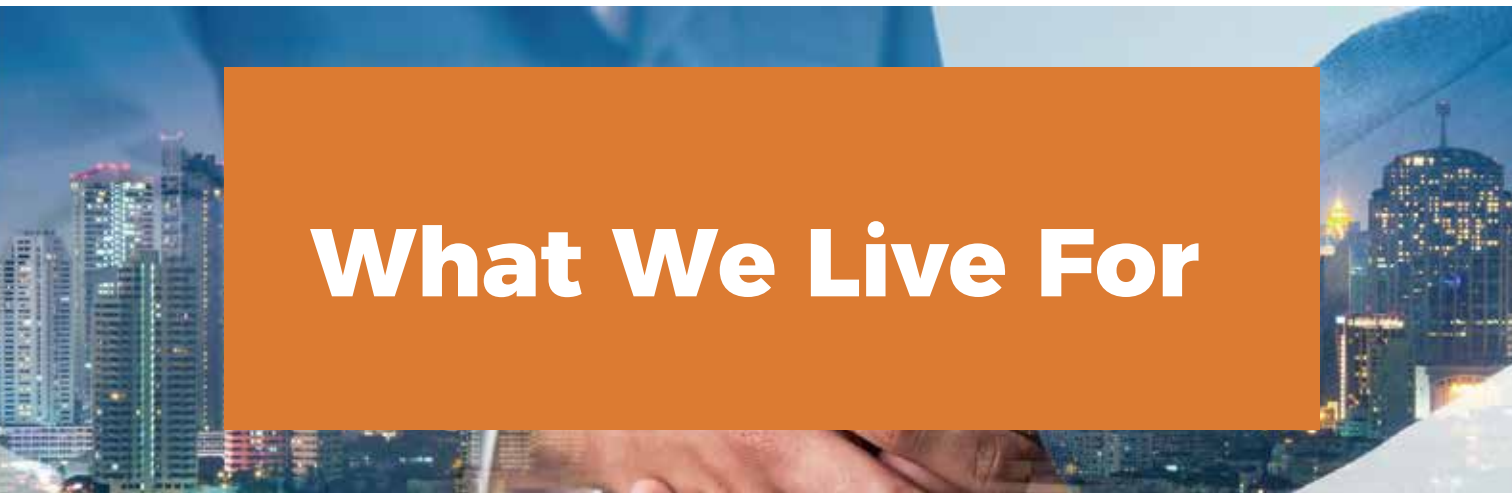

Main Partner

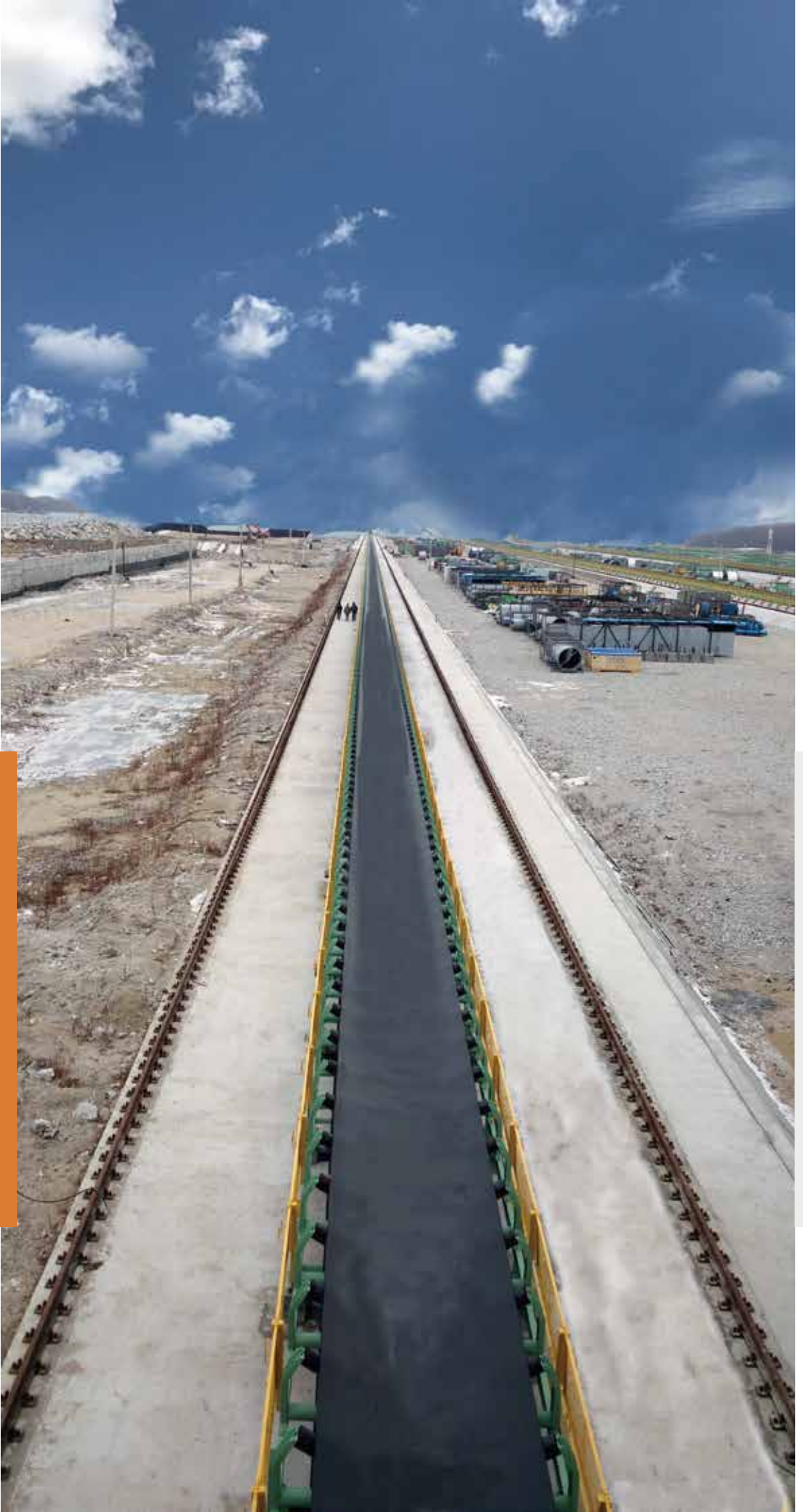

Belt model: B1600
Quantity: 6 Sets
Overall length: 6000m



Russia Vostochny Port Coal Handling Plant of Power Plant

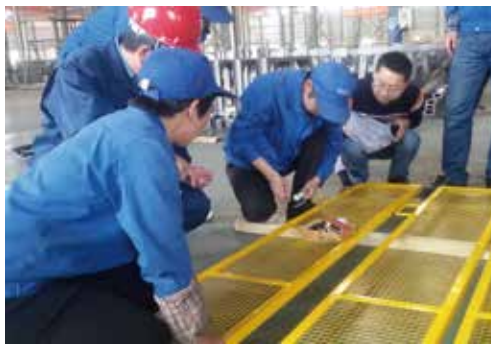

HIGHLIGHT

HIGHLIGHT
Idler for Steel Plant Belt Conveyor

Formosa Ha Tinh Steel Corporation
Idler for Steel Plant Belt Conveyor



Vietnam





Belt model: B1050
Belt model: B1200
Belt model: B1600
Belt model: B2000
Quantity: 45049 Sets

Shanxi Shuiyu Coal Handling Plant
Belt Conveyor for Coal Handling Plant



Sichuan Dazhou Coal Handling Plant
Belt Conveyor for Coal Handling Plant

Guizhou Xiangshui Mine Coal Handling Plant
Belt Conveyor for Coal Handling Plant



China





Belt model: B2100
Belt model: B1400
Quantity: 14 Sets
Capacity: 3500TPH



Indonesia Power SURALAYA
Extension of Coal Handling Plant





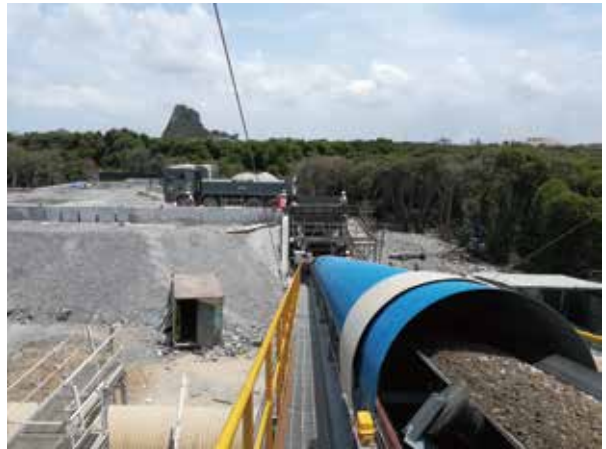

VIETNAM



Siam City Cement
Ship Loading System





KENYA



LafargeHolcim

Steel Structure Supply for NGP Dust Handling System





HIGHLIGHT

HIGHLIGHT
Long Steel Cord Belt(9km) Supply & Installation



LafargeHolcim

Long Steel Cord Belt(9km) Supply & Installation



NIGERIA







BUSINESS of CETEC

◆ **BULKTEC CO., LTD**

Tel: +86 10 64419379
Fax: +86 10 64429359
Email: daiyuanjun@libochina.cn
Add: Jinjiye Building,
No.2 Shengguzhong RD.
Chaoyang District
Beijing 100029, P.R. China

◆ **CETEC CO., LTD**

Tel: +86 10 64450371
Fax: +86 10 64423609
Email: cetec@cetecchina.com
Add: Jinjiye Building,
No.2 Shengguzhong RD.
Chaoyang District
Beijing 100029, P.R. China

◆ **LIBO INTERNATIONAL**
MECHANICAL&ELECTRICAL ENGINEERING CO.,LTD

Tel: +86 10 64419379
Fax: +86 10 64429359
Email: daiyuanjun@libochina.cn
Add: Jinjiye Building,
No.2 Shengguzhong RD.
Chaoyang District
Beijing 100029, P.R. China