

EXPLODED DRAWING—MODEL NO. 831.159342

PAGE 2 OF 2

R694B

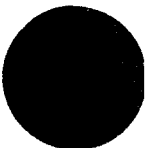

WEIGHT MECHANISM ASSEMBLY

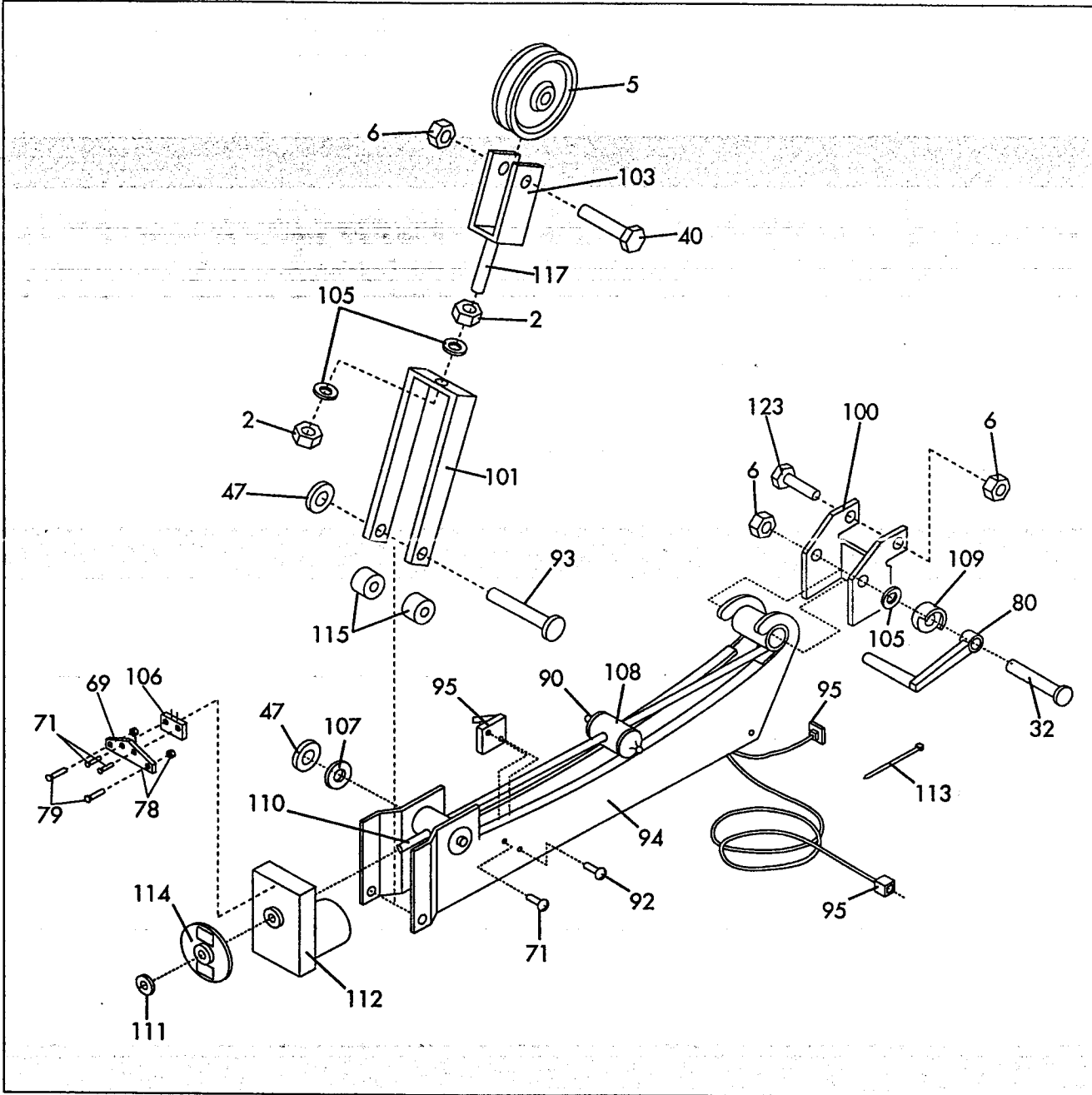

PART LIST—MODEL NO. 831.159342

KEY NO.	PART NO.	QTY.	DESCRIPTION	KEY NO.	PART NO.	QTY.	DESCRIPTION	KEY NO.	PART NO.	QTY.
1	112003	7	3/8" x 2 1/2" Carriage Bolt	52	117741	1	Weight Cable	103	117262	1
2	112004	10	3/8" Nut	53	117260	1	Adjustment Bracket	104	117881	1
3	112006	7	3/8" Lockwasher	54	117913	2	3/4" x 4" Axle	105	104345	3
4	117737	3	2" Pulley	55	117489	1	Selector Knob	106	115124	1
5	115370	9	3 1/2" Pulley	56	100151	2	5/8" Plastic Cap	107	014153	1
6	012149	25	3/8" Nylock Nut	57	103735	7	3/4" Plastic Cap	108	109568	1
7	117120	1	Front Base	58	100048	4	Plastic Bushing	109	116049	1
8	116746	1	Rear Base	59	013162	1	1/2" Pan Screw	110	117905	1
9	118474	1	Upright	60	116181	1	Long Pulley Bracket	111	105122	1
10	NSP	1	Tower Frame	61	115260	1	3/8" x 6 1/2" Bolt	112	115131	1
11	119583	1	Left Side Shield	62	013322	10	3/4" Tap Screw	113	016029	6
12	119584	1	Right Side Shield	63	116215	1	3/8" x 1 1/2" Full Thread Bolt	114	115110	1
13	106480	4	2 3/4" Pulley	64	014132	1	3/8" Flat Washer	115	019266	2
14	117732	2	Swivel Bracket	65	114958	1	Rubber Washer	116	117738	8
15	117908	1	Left Arm	66	117127	1	Locking Plate	117	110943	1
16	117909	1	Right Arm	67	115257	3	Cable Trap	118	013498	1
17	114797	2	Large Pad	68	013430	4	3/8" x 4" Bolt	119	013300	1
18	112560	4	Grip	69	116065	1	Reed Switch Bracket	120	117900	1
19	117104	1	Backrest	70	120446	1	1/2" x 4 1/2" Axle	121	117701	1
20	013468	2	1/4" x 5/8" Bolt	71	113795	4	Fastener	122	106718	1
21	114798	4	Small Pad	72	116630	1	Small Cable Trap	123	112001	1
22	108726	2	Pad Tube	73	105133	1	3/8" Zinc Jam Nut	124	116571	4
23	117910	1	Leg Developer	74	119865	1	Moment Arm	125	118471	1
24	116913	1	1/2" x 2 1/2" Axle	75	117916	1	Left Pedal	#	119804	1
25	103903	4	1/2" Plastic Cap	76	117917	1	Right Pedal	#	119805	1
26	109989	4	3/4" Brass Bushing	77	107148	2	Pedal Cover	#	111465	1
27	103833	2	1 1/2" x 1 1/2" Cap	78	012135	2	Nylock Nut	#	119585	1
28	117099	1	Seat	79	116109	2	7/8" Screw	#	117322	1
29	116149	1	Brace	80	116048	1	Actuator Arm			
30	108874	4	2" x 2" Cap	81	113349	1	Magnet Sleeve			
31	117332	4	3/8" x 3/4" Bolt	82	012003	1	5/16" Nut			
32	106879	1	3/8" x 3" Bolt	83	105101	2	3/4" Metal Cover			
33	115383	2	Cable Clip	84	109398	2	Resistance Cylinder			
34	107281	1	Rower Bar	85	109399	4	5/8" Bushing			
35	115177	1	Strap	86	116120	2	5/8" Spacer			
36	115115	1	Lat Bar	87	101149	1	3/8" Fender Washer			
37	106526	2	1 1/4" Cap	88	115126	1	Stepper Console			
38	118004	1	Chain	89	105136	2	Gas Shock			
39	109954	1	Transformer	90	105142	4	Ball Joint			
40	013399	12	3/8" x 1 3/4" Bolt	91	012082	2	5/16" Nylock Nut			
41	115762	1	1" Pulley	92	013510	2	3/4" Self Tapping Screw			
42	111000	2	1/2" Brass Bushing	93	115100	1	3/8" x 4" Clevis Pin			
43	012090	1	1/4" Nylock Nut	94	117920	1	Weight Mechanism			
44	117106	1	1/4" x 1" Shoulder Bolt	95	117921	1	Wire Harness			
45	013578	1	3/8" x 2 1/4" Bolt	96	115199	1	CUSTOM SMART CARD			
46	116185	2	1/4" x 2 1/2" Bolt	97	117298	1	PERSONAL TRAINER Computer			
47	105496	4	3/8" Push Nut	98	117323	1	Exercise Insert			
48	019115	5	Rubber Pad	99	117903	1	Reed Switch Wire			
49	115998	2	1 1/2" Internal Cap	100	117305	1	Mechanism Adjustment Bracket			
50	117541	1	2" Roller	101	117914	1	Mechanism Cable Bracket			
51	117386	1	Main Cable	102	117037	1	Foot Plate			

Note: "#" indicates
Specifications are su
See the back cover c
mation about orderi

PART IDENTIFICATION CHART

DESCRIPTION

- Bracket
- Plate Bracket
- Washer
- Reed Switch
- Washer
- Nut
- Inner Cup
- Screw
- 6" Push Nut
- Motor
- Tie
- Encoder Disk
- Spacer
- Shield Fastener
- 3/8" x 2 3/4" Carriage Bolt
- 3/8" x 2" Bolt
- Screw
- Switch Bracket
- Switch Fastener
- Cable Trap
- 3" x 3" Bolt
- Endcap
- 3" x 3 3/4" Bolt
- Owner's Manual
- List/Exploded Drawing
- Assessment Journal
- Assessment Cassette
- Assessment Exercise Decal Sheet

Note: Numbers in parenthesis refer to the key numbers; Numbers following dashes refer to quantities used in assembly.

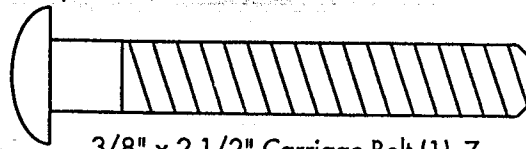

3/8" x 2 1/2" Carriage Bolt (1)-7

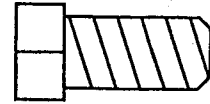

3/8" x 3/4" Bolt (31)-4

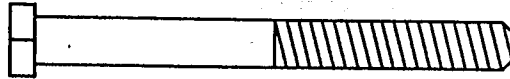

1/4" x 2 1/2" Bolt (46)-2

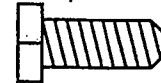

1/4" x 5/8" Bolt (20)-2



1/4" x 2" Bolt (118)-1

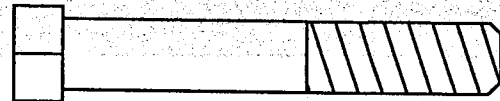

3/8" x 2 1/4" Bolt (45)-1

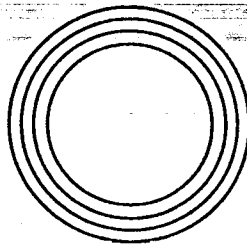

3/4" Plastic Cap (57)-5

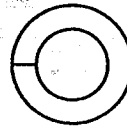

3/8" Lockwasher (3)-7

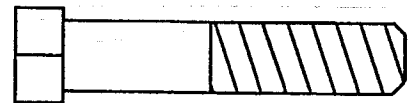

3/8" x 1 3/4" Bolt (40)-6

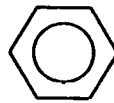

5/16" Nut (82)-1

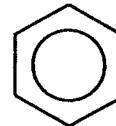

3/8" Nut (2)-7



3/8" Nylock Nut (6)-10

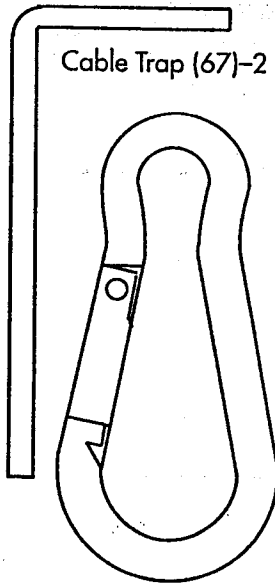

Cable Trap (67)-2

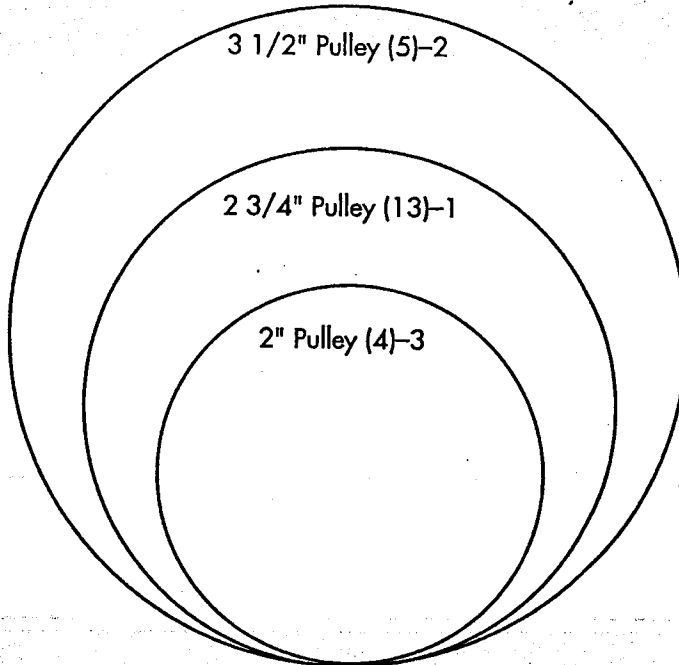

3 1/2" Pulley (5)-2

2 3/4" Pulley (13)-1

2" Pulley (4)-3

Cable Clip (33)-2

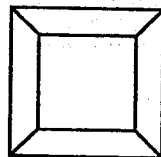

Rubber Pad (48)-5



3/4" x 4" Axle (54)-2

Illustrated part.
 to change without notice.
 owner's manual for infor-
 placement parts.

EXPLODED DRAWING—MODEL NO. 831.159342

R694B

PAGE 1 OF 2

