

EXPLODED DRAWING—Model No. 831.297362

PO596A

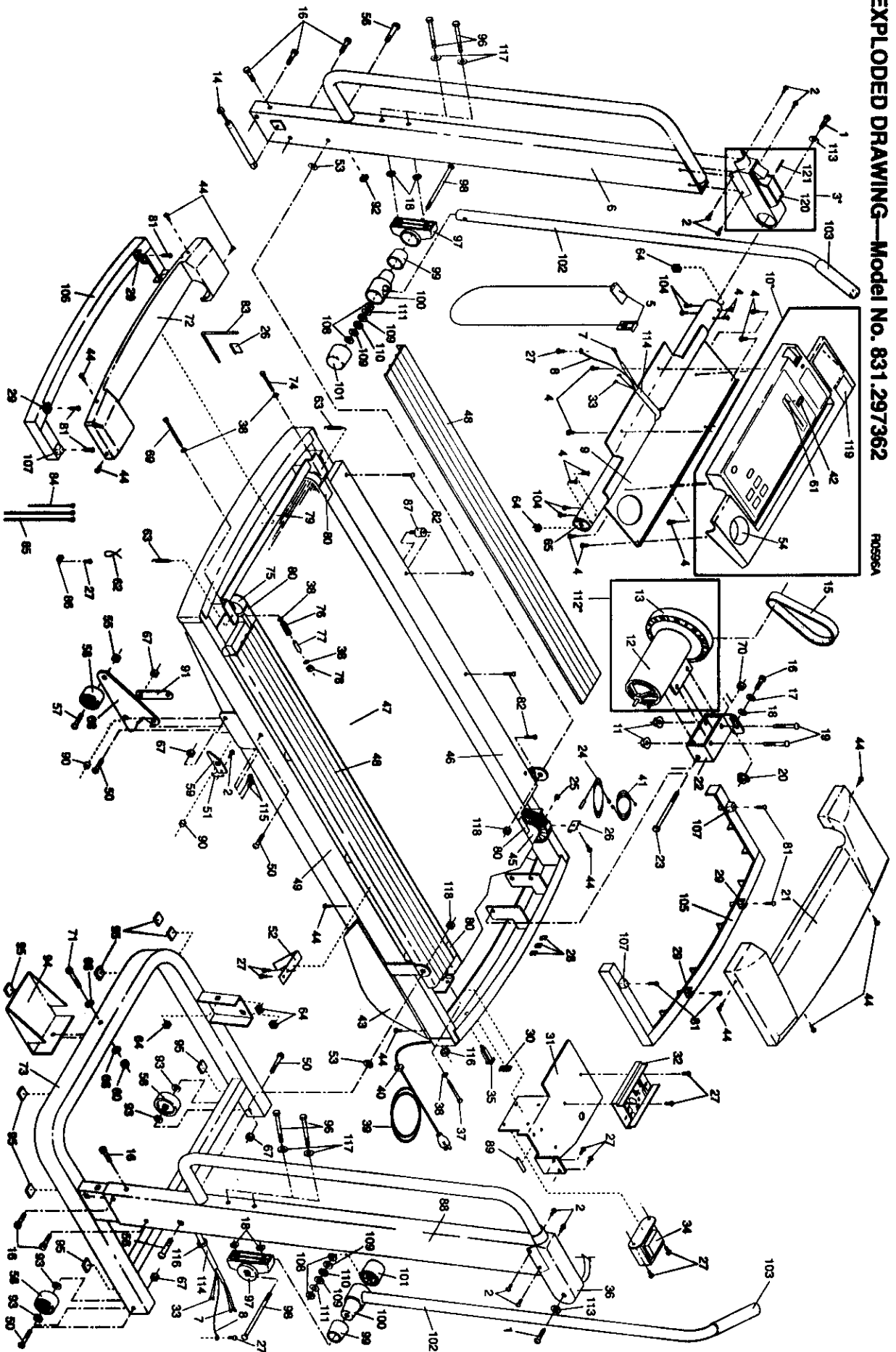

MODEL NUMBER: 29736
 VERSION: 02
 PRODUCT NAME: CROSSWALK SI
 PRODUCT DESC:

MODEL/PART BOOK LISTING

PAGE 1
 IN1023P1
 RUN DATE: 3/22/97
 RUN TIME: 9:50:19

KEY NUMBER	PART NUMBER	DESCRIPTION	QUANTITY
		PROFORM CROSSWALK SI	0
1	013438	CONSOLE BOLT	4
2	130459	CONSOLE BKT/RATCHET SCREW	10
3	127091	LEFT CONSOLE BRACKET	1
4	013540	CONSOLE SCREW	8
5	119038	SAFETY KEY CLIP	1
6	129893	LEFT UPRIGHT	1
7		SEE KEY#33	0
		(KEY#7 POT WIRE HRNS)	1
8		SEE KEY#33	0
		(KEY#8 100" GROUND WIRE)	1
9	129969	CONSOLE CROSSBAR	1
10	129169	CONSOLE	1
11	105477	MOTOR NUT	2
12	129667	MOTOR	1
13	112825	PULLY/FLYWHEEL/FAN	1
14	129814	BASE SHOCK	1
15	135866	MOTOR BELT	1
16	013547	MOTOR TENSION BOLT	1
17	122812	MOTOR TENSION WASHER	1
18	014117	STAR WASHER	5
19	113814	MOTOR BOLT	2
20	120867	MOTOR TENSION NUT	1
21	129028	FRONT HOOD	1
22	129799	MOTOR MOUNT BRACKET	1
23	107503	MOTOR SWIVEL BOLT	1
24		SEE KEY#33	0
		(KEY#24 REED SWITCH WIRE)	1
25	100498	MAGNET	1
26	016028	ADHESIVE CLIP	2
27	120630	SCREW	13
28	054023	WIRE CLIP	4
29	127419	HOOD ANCHOR	4
30	126130	SAFETY PLUG	1
31	126985	ELECTRONICS BRACKET	1
32	133553	CONTROLLER	1
33	134167	UPRIGHT WIRE HARNESS	1
34	031238	CHOKE	1
35	109382	CIRCUIT BREAKER	1
36	126641	RIGHT CONSOLE BRACKET	1
37	112609	FRONT ROLLER ADJ. BOLT	1
38	014127	ADJUSTMENT WASHER	5
39	124669	POWER CORD	1
40	124695	GROMMET	1
41	118196	REED SWTCH EXTENSION WIRE	1
42	129312	SPEED CONTROL KNOB	1
43	131610	SAFETY COVER	1
44	129168	SAFETY COVER SCREW	30
45	129022	FRONT ROLLER/PULLEY	1
46	127706	WALKING BRD W/FASTENERS	1
47	127707	WALKING BELT W/FASTENERS	1
48	129029	FOOT RAIL W/FASTENERS	2
49	NSP	FRAME	1
50	013544	INCLINE LEG/WHEEL BOLT	4

MODEL NUMBER: 29736
VERSION: 02
PRODUCT NAME: CROSSWALK SI
PRODUCT DESC:

MODEL/PART BOOK LISTING

PAGE 2

ENI023P1

RUN DATE: 3/22/97

RUN TIME: 9:50:19

KEY NUMBER	PART NUMBER	DESCRIPTION	QUANTITY
51	120655	INCLINE LEG SPRING	2
52	127098	BELT GUIDE	2
53	014170	UPRIGHT PIVOT WASHER	2
54	128119	BEVERAGE INSERT	1
55	.	SEE KEY# 70	2
	.	KEY#55 WHEEL NUT	0
56	126635	UPRIGHT PIVOT BOLT	2
57	117806	WHEEL BOLT	2
58	052012	INCLINE WHEEL	4
59	128416	INCLINE LEG LATCH	2
60	012056	STABILIZER PLATE NUT	1
61	128093	POTENTIOMETER	1
62	116926	WIRE TIE	1
63	127544	GUARD SPRING	2
64	111869	CROSSBAR CAGE NUT	2
65	128465	CROSSBAR BRACKET	2
66	014073	STABILIZER PLATE WASHER	2
67	119425	NUT	6
68	128875	INCLINE LEG	2
69	128260	RIGHT REAR ADJ BOLT	1
70	012149	MOTOR LOCK/WHEEL NUT	3
71	127948	STABILIZER PLATE BOLT	1
72	126572	REAR HOOD	1
73	129897	BASE	2
74	105444	LEFT REAR ADJ. BOLT	1
75	127009	REAR ROLLER	1
76	128986	RR ROLLER TENSION SPRING	1
77	123470	SPRING SLEEVE	1
78	119439	ROLLER TENSION NUT	1
79	129530	REAR ROLLER GUARD	1
80	128479	ROLLER GUARD	2
81	013529	HOOD ANCHOR SCREW	8
82	128272	PLATFORM SCREW	8
83	128457	ALLEN WRENCH	1
84	016029	4"WIRE TIE	1
85	016057	8" WIRE TIE	2
86	116927	TIE HOLDER CLAMP	1
87	127689	PLATFORM ISOLATOR	8
88	129891	RIGHT UPRIGHT	1
89	120885	WIRE GUARD	1
90	128271	INCLINE LEG SPACER	4
91	128575	INCLINE LEG BRACKET	2
92	126960	UPRIGHT PLUG	1
93	112628	WHEEL SPACER	4
94	129429	STABILIZER PLATE	1
95	129740	UPRIGHT FOOT	2
96	126963	RESISTANCE BRACKET BOLT	4
97	126773	RESISTANCE BRACKET	2
98	126644	RESISTANCE BOLT	2
99	129570	RESISTANCE SLEEVE	2
100	126828	RESISTANCE CONE BUSHING	2
101	126843	RESISTANCE KNOB	2
102	128598	UPPER BODY ARM W/FOAM	2
103	105500	FOAM GRIP	2

MODEL NUMBER: 29736
 VERSION: 02
 PRODUCT NAME: CROSSWALK SI
 PRODUCT DESC:

MODEL/PART BOOK LISTING

PAGE 3
 INI023P1
 RUN DATE: 3/22/97
 RUN TIME: 9:50:19

KEY NUMBER	PART NUMBER	DESCRIPTION	QUANTITY
104	013576	CROSSMEMBER SCREW	4
105	126956	FRONT HOOD SPACER	1
106	126987	REAR HOOD SPACER	1
107	125802	RUBBER HOOD MOUNT	4
108	014132	3/8" FLAT WASHER	4
109	102973	THRUST WASHER	4
110	106896	THRUST BEARING	2
111	128005	SPRING WASHER	2
112	129668	MOTOR/PULLEY/FLYWHEEL/FAN	1
113	014086	CONSOLE BRACKET WASHER	2
114	.	SEE KEY#33 (KEY#114 UPRT CABLE LOOM)	0
115	108080	RATCHET MOUNTING SCREW	4
116	129004	WIRE GROMMET	2
117	014063	RESISTANCE BRACKET WASHER	4
118	100553	UPRIGHT PIVOT NUT	2
119	128695	BATTERY COVER	1
120	130249	STORAGE LATCH	1
121	130728	LATCH PIN	1
*	.	NON-ILLUSTRATED PARTS	0
*	135025	BOOK RACK	1
*	131090	REED SWITCH WIRE CLAMP	1
*	127711	LATCH WARNING DECAL	1
*	124803	CONSOLE WARNING DECAL	1
*	107771	8" WHITE WIRE, M/F	1
*	114011	4" BLACK WIRE, M/F	1
*	126965	TECH SHEET	1
*	123945	TECH SHEET ENVELOPE	1
*	127860	FASTENERS	12
*	130062	USER'S MANUAL	1
*	130061	LITERATURE PACKET	1
.	130062	USER'S MANUAL	1
.	129740	BASE PAD	8
.	129447	HARDWARE KIT	1
.	013576	#8 X 1/2" SCREW	4
.	128457	ALLEN WRENCH	1
.	016028	WRENCH CLIP	1
.	127948	5/16" SCREW	1
.	014073	5/16" FLAT WASHER	2
.	012056	5/16" LOCK NUT	1