

EXPLODED DRAWING—Model No. IMTL30060

ROC97A

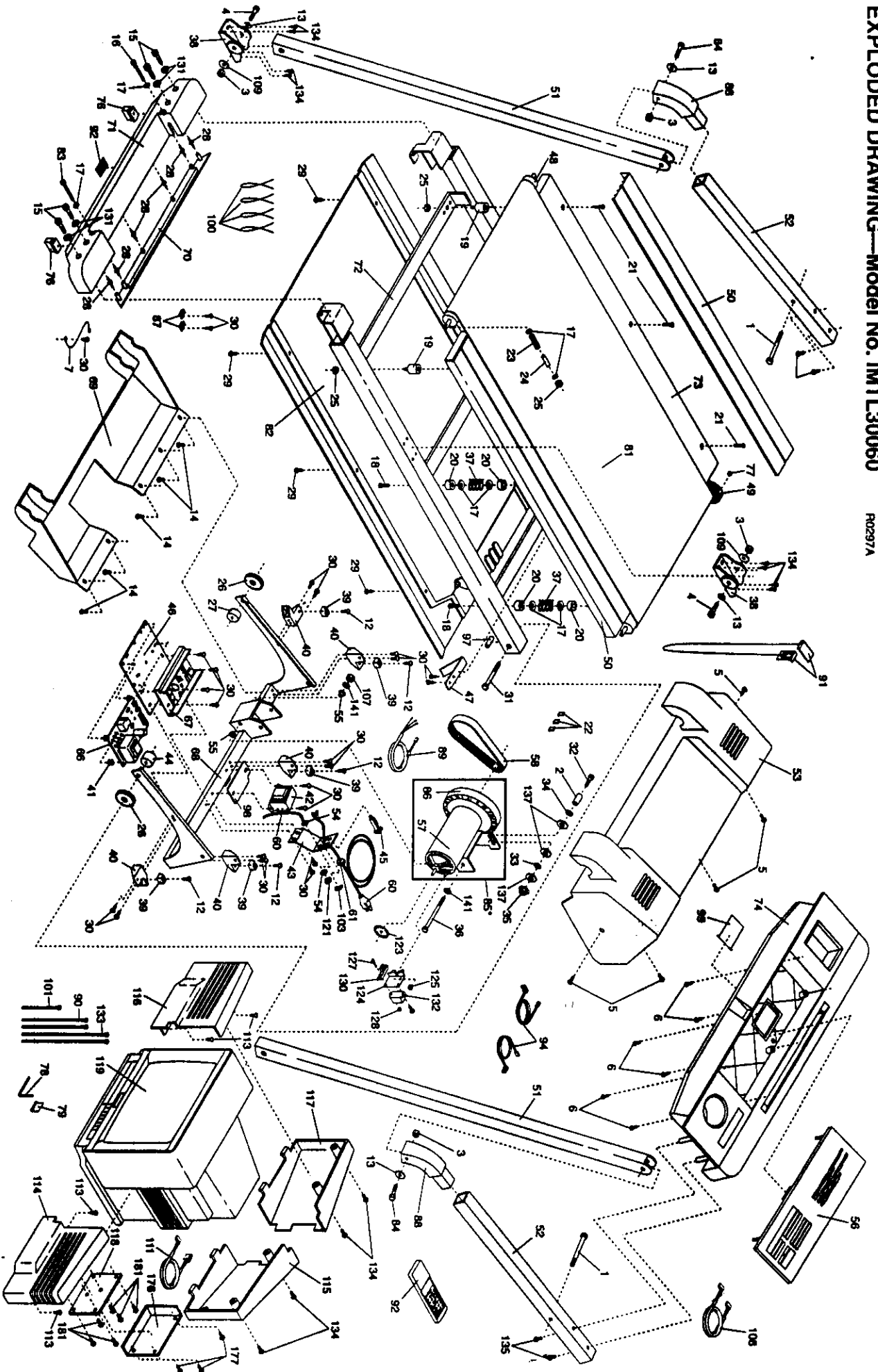

INTEL 3006 C

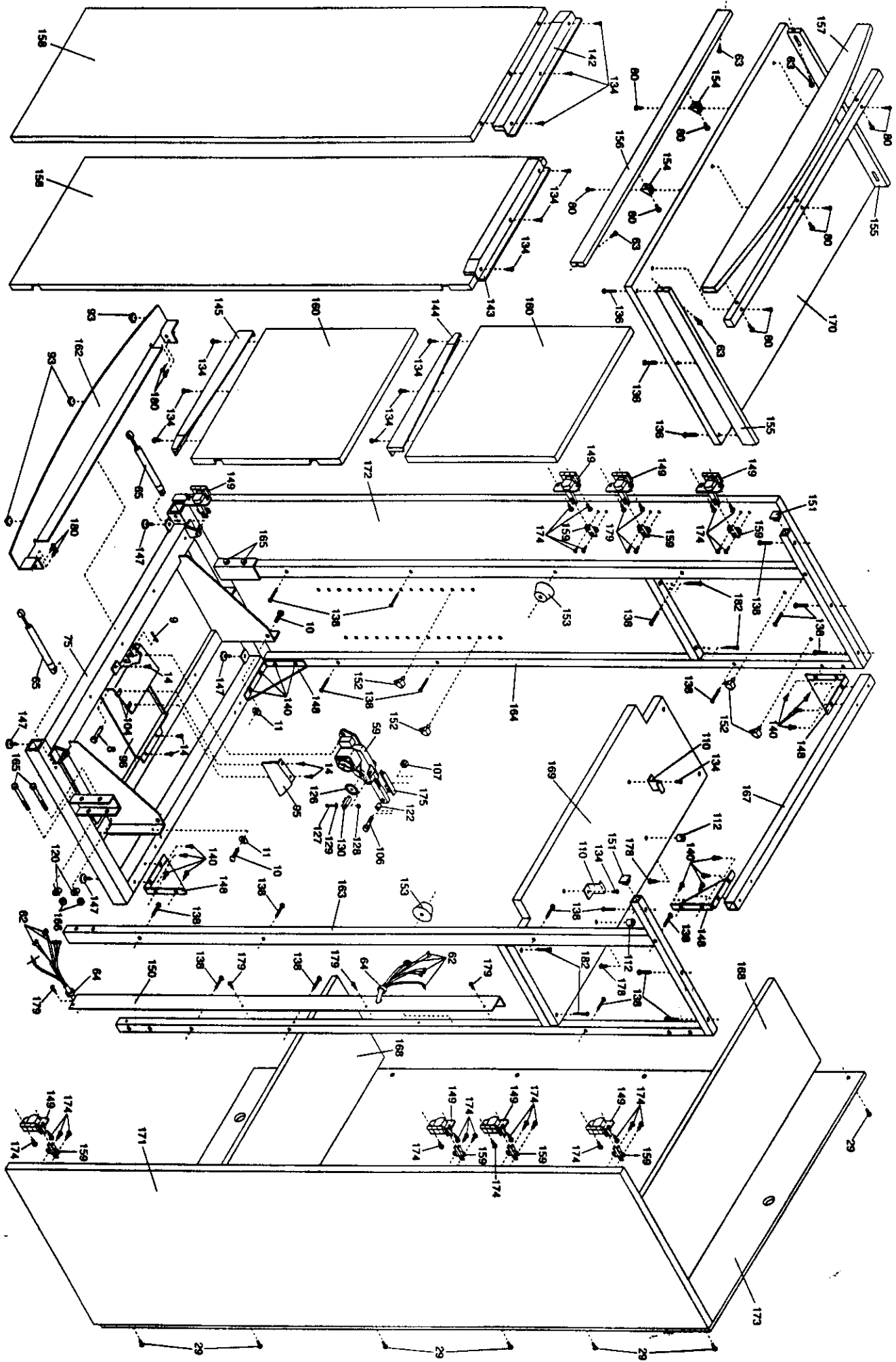

MODEL NUMBER: IMTL3006
VERSION: 00
PRODUCT NAME: IMAGE ACCESS 3000
PRODUCT DESC:

MODEL/PART BOOK LISTING

PAGE 1
INI023P1
RUN DATE: 3/21/97
RUN TIME: 9:40:16

KEY NUMBER	PART NUMBER	DESCRIPTION	QUANTITY
.	.	IMAGE ACCESS 3000	0
.	.	2/97 SMITHFIELD	0
1	136171	HANDLEBAR PIVOT BOLT	2
2	130284	MOTOR SLEEVE	1
3	100427	NUT	1
4	121421	UPRIGHT BRACKET BOLT	2
5	.	SMALL SCREW, WHICH ONE?	0
.	013529	HOOD SCREW	5
.	126996	HANDLEBAR ARM SCREW	4
6	013028	CONSOLE SCREW	6
7	132549	GROUND WIRE	1
8	112669	CLEVIS PIN	1
9	106334	COTTER PIN	1
10	132449	HEX HEAD BOLT	2
11	101149	WASHER	2
12	013300	SCREW	10
13	014073	WASHER	4
14	134594	COVER SCREW	6
15	131826	ENDCAP BOLT	4
16	105444	SHORT ADJUSTMENT BOLT	1
17	014127	ADJUSTMENT WASHER	8
18	013456	FRAME ISOLATOR SCREW	4
19	134300	ISOLATOR	2
20	132374	SPRING CUSHION	8
21	128272	PLATFORM SCREW	6
22	054023	WIRE CLIP	3
23	128986	TENSION SPRING	1
24	123470	SPRING SLEEVE	1
25	121576	ROLLER TENSION NUT	3
26	134388	SPACER	2
27	134360	LEFT ROLLER BUSHING	1
28	127597	ENDCAP FASTENER	6
29	013300	HOOD ANCHR/PAN/BACK SCREW	22
30	120630	SMALL SCREW	26
31	120354	FRAME PIVOT BOLT	2
32	013547	MOTOR TENSION BOLT	1
33	130248	STAR WASHER	1
34	122812	MOTOR TENSION WASHER	1
35	120867	MOTOR TENSION NUT	1
36	107503	MOTOR PIVOT BOLT	1
37	137365	SPRING	4
38	132422	UPRIGHT BRACKET	2
39	125677	HOOD ANCHOR	5
40	132394	HOOD BRACKET	5
41	125819	PLASTIC STAND-OFF	4
42	130993	CHOKE	1
43	135263	BRACKET	1
44	136552	RIGHT ROLLER BUSHING	1
45	109382	CIRCUIT BREAKER	1
46	132466	ELECTRONICS BRACKET	1
47	109265	BELT GUIDE	2
48	134303	REAR ROLLER	1
49	134305	FRONT ROLLER/PULLEY	1
50	134307	FOOT RAIL W/FASTENERS	2

MODEL NUMBER: IMTL3006
VERSION: 00
PRODUCT NAME: IMAGE ACCESS 3000
PRODUCT DESC:

MODEL/PART BOOK LISTING

PAGE 2
INI023P1
RUN DATE: 3/21/97
RUN TIME: 9:40:16

KEY NUMBER	PART NUMBER	DESCRIPTION	QUANTITY
51	135255	UPRIGHT ARM	2
52	135253	HANDLEBAR ARM	2
53	137085	HOOD	1
54	136018	SMALL PLASTIC WSHR (BSHG)	2
55	130403	MOTOR BUSHING	2
56	136863	CONSOLE	1
57	137358	MOTOR	1
58	135866	MOTOR BELT	1
59	129875	INCLINE MOTOR	1
60	124669	POWER CORD	1
61	124695	GROMMET	1
62	137086	WIRE HARNESS	1
63	136261	TRIM SCREW	4
64	129004	WIRE HARNESS GROMMET	2
65	134762	SHOCK	2
66	136800	POWER SUPPLY W/CLIPS	1
67	135052	CONTROLLER	1
68	135918	INCLINE LEG	1
69	132453	BELLY PAN	1
70	136203	ENDCAP PLUG	1
71	132218	REAR ROLLER ENDCAP	1
72	NSP	FRAME	1
73	134335	WALKING BOARD W/FASTENERS	1
74	137465	CONSOLE BASE	1
75	135234	BASE	1
76	132455	ENDCAP FOOT	2
77	100498	MAGNET	1
78	126040	ALLEN WRENCH	1
79	016028	ADHESIVE CLIP	1
80	135350	TRIM BRACKET SCREW	10
81	134342	WALKING BELT W/FASTENERS	1
82	134343	FRAME COVER	1
83	137409	LONG ADJUSTMENT BOLT	1
84	102083	ELBOW MOUNT BOLT	2
85	137360	MTR/PULY/FLWH/FAN	1
86	126747	PULLEY/FLYWHEEL/FAN	1
87	116927	WIRE TIE HOLDER	1
88	135180	HANDLEBAR ELBOW	2
89	125871	MOTOR/CONTROLLER WIRE	1
90	016057	8" WIRE TIE	6
91	119038	KEY/CLIP	1
92	135532	TV REMOTE CONTROL	1
93	129740	STABILIZER PAD	4
94	126911	OPTIC SWITCH WIRE	2
95	135274	INCLINE COVER SHIELD	1
96	135273	INCLINE COVER	1
97	134388	FRAME SPACER	2
98	135004	CHOKE PLATE	1
99	129639	BATTERY COVER	1
100	116926	RELEASEABLE TIE	4
101	016029	4" WIRE TIE	1
102	.	INCLINE BRACKET, NOT USED	0
103	119163	ON/OFF SWITCH	1
104	133333	INCLINE COVER CLIP	2

MODEL NUMBER: IMTL3006
VERSION: 00
PRODUCT NAME: IMAGE ACCESS 3000
PRODUCT DESC:

MODEL/PART BOOK LISTING

PAGE 3
INT023P1
RUN DATE: 3/21/97
RUN TIME: 9:40:16

KEY NUMBER	PART NUMBER	DESCRIPTION	QUANTITY
105	.	UPRIGHT PLUG, NOT USED	0
106	013375	INCLINE MOTOR BOLT	1
107	012149	INCLINE MOTOR NUT	2
108	137088	CONSOLE/CONTROL BRD WIRE	1
109	101149	LARGE WASHER	2
110	134732	MONITOR BRACKET	2
111	137093	TV/CONTROL BOARD WIRE	1
112	135349	MONITOR ISOLATOR	2
113	.	SCREW, WHAT SCREW NEEDED?	0
.	135350	PANEL SCREW	4
.	136432	CONTROL BOARD SCREW	6
114	134171	RIGHT FACE PANEL	1
115	134170	RIGHT REAR PANEL	1
116	134173	LEFT FACE PANEL	1
117	134172	LEFT REAR PANEL	1
118	136802	CONTROL BOARD	1
119	137523	COLOR TV MONITOR	1
120	.	CABLE CONNECTION, SEE#62	0
121	012156	CABLE CONNECTION NUT	1
122	114270	INCLINE MOTOR SPACER	1
123	119070	SPEED DISK	1
124	135927	OPTIC/FILTER BRACKET	1
125	122125	OPTIC SWITCH BRACKET NUT	1
126	109370	INCLINE OPTIC DISK	1
127	102959	BRACKET SCREW	2
128	012152	OPTIC SWITCH NUT	2
129	014157	OPTIC SWITCH STAR WASHER	2
130	102955	OPTIC SWITCH	2
131	014063	ENDCAP BOLT WASHER	4
132	135724	FILTER	1
133	.	PAD SCREW, NOT USED	0
134	013540	UPRIGHT BRACKET SCREW	20
135	.	SMALL WOOD SCREW,SEE# 134	12
136	136162	MEDIUM WOOD SCREW	6
137	130285	PLASTIC WASHER	2
138	135351	UPRIGHT SCREW	24
139	.	BACK BOARD SCREW,SEE# 29	12
140	.	SCREW, WHAT SCREW NEEDED?	16
.	134594	ANGLE BRACKET SCREW	16
.	130659	STABILIZER SCREW	4
.	130459	WIRE COVER SCREW	5
141	130403	MOTOR BUSHING	2
142	135266	LEFT LOWER DOOR HANDLE	1
143	135267	RIGHT LOWER DOOR HANDLE	1
144	135268	LEFT TOP DOOR HANDLE	1
145	135269	RIGHT TOP DOOR HANDLE	1
146	.	STABILIZER PAD, SEE#93	0
147	135332	BASE FOOT	4
148	135272	ANGLE BRACKET	4
149	136276	HINGE	8
150	136075	WIRE COVER	1
151	120696	UPRIGHT ENDCAP	2
152	135334	SHELF PIN	8
153	135188	HANDLEBAR PIVOT SPACER	2

MODEL NUMBER: IMTL3006
 VERSION: 00
 PRODUCT NAME: IMAGE ACCESS 3000
 PRODUCT DESC:

MODEL/PART BOOK LISTING

PAGE 4
 INI023P1

RUN DATE: 3/21/97
 RUN TIME: 9:40:16

KEY NUMBER	PART NUMBER	DESCRIPTION	QUANTITY
154	135335	TRIM BRACKET	5
155	137509	TOP TRIM BOARD	2
156	137510	INNER TRIM BOARD	1
157	137511	FRONT TRIM BOARD	1
158	137512	LOWER DOOR	2
159	136058	HINGE PLATE	8
160	137513	TOP DOOR	2
161	136161	CORNER BRACKET SCREW	4
162	135187	STABILIZER	1
163	137089	RIGHT UPRIGHT	1
164	137090	LEFT UPRIGHT	1
165	013578	UPRIGHT BOLT	4
166	012149	UPRIGHT NUT	4
167	137091	TOP CROSS MEMBER	1
168	137514	SHELF BOARD	2
169	137515	MONITOR SHELF	1
170	137516	TOP BOARD	1
171	137517	RIGHT SIDE BOARD	1
172	137518	LEFT SIDE BOARD	1
173	136633	BACK BOARD	1
174	136189	HINGE SCREW	32
175	116892	INCLINE STOP BRACKET	1
176	134739	CONTROL BOARD COVER	1
177	013162	CONTROL BOARD COVER SCREW	4
.	.	NON-ILLUSTRATED PARTS	0
#	136871	WOOD CLEAT	1
#	136550	18" TV WIRE HARNESS	1
#	014132	UPRIGHT WASHER	4
#	127860	FASTENER	12
#	102634	8" GREEN WIRE, F/RING	1
#	112083	8" BLUE WIRE, 2F	1
#	134487	6" BLACK WIRE, PIGTAIL	1
#	.	14" WHITE WIRE, NOT USED	0
#	102246	8" WHITE WIRE, 2F	1
#	101951	8" BLACK WIRE, 2F	1
#	136019	16" RED WIRE, 2F	1
#	135281	HOOD DECAL	1
#	134831	WIRE DIAGRAM	1
#	129232	WARNING DECAL	2
#	135282	USER'S MANUAL	1
#	135283	LITERATURE PACKET	1
.	135282	USER'S MANUAL	1
.	129740	BASE PAD	4
.	119038	KEY/CLIP	1
.	135284	HARDWARE KIT	1
.	126040	ALLEN WRENCH	1
.	016028	WRENCH CLIP	1
.	130659	#8 X 3/4" SCREW	4
.	135334	SHELF SUPPORT	8