

**PART LIST/EXPLODED DRAWING**  
**Model No. PF880030**

Kmv

R694A

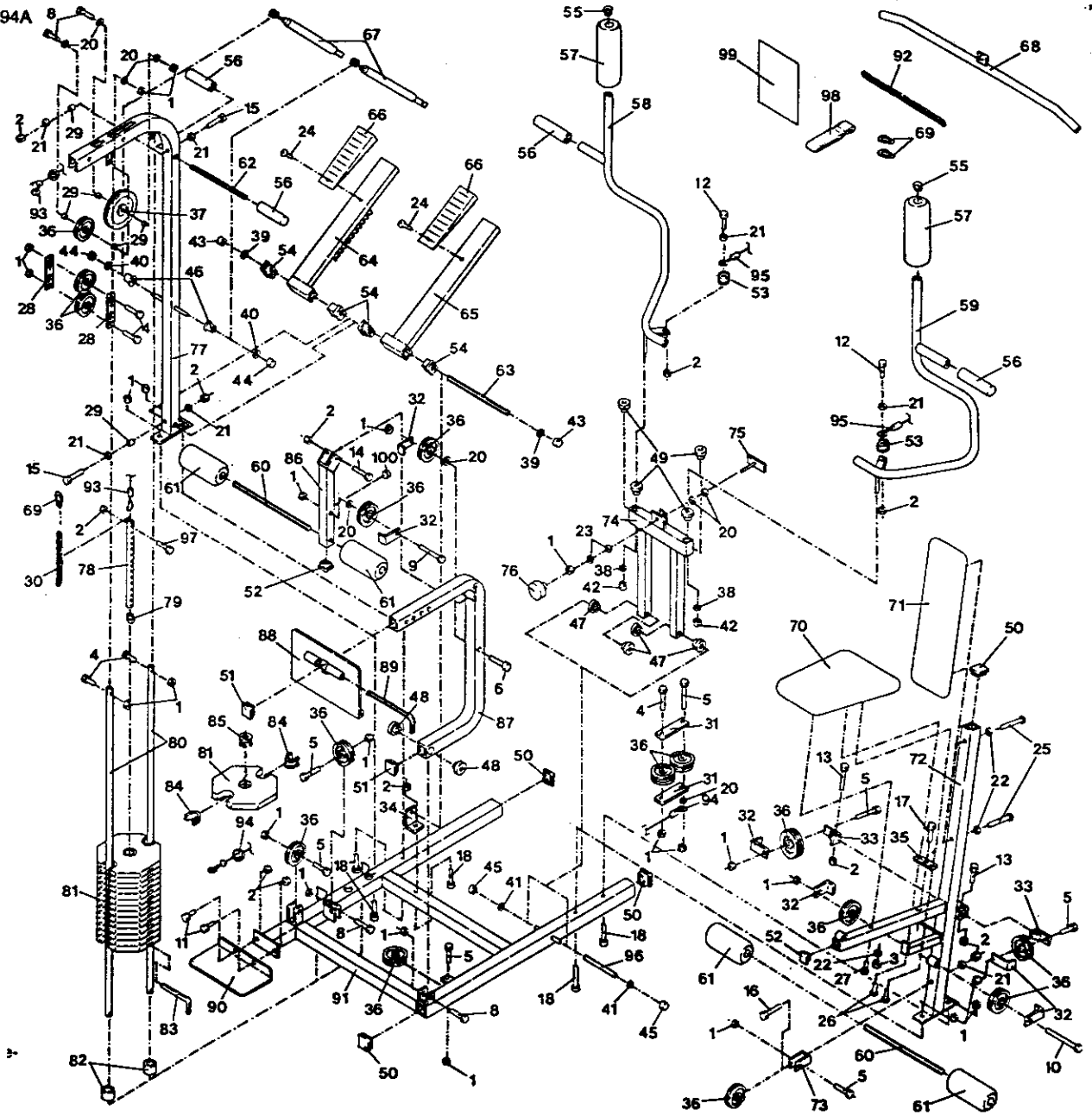

MODEL NUMBER: PF88003  
 VERSION: 00  
 PRODUCT NAME: PROFORM 880 CS  
 PRODUCT DESC:

MODEL/PART BOOK LISTING

PAGE 1  
 INI023P1  
 RUN DATE: 1/11/97  
 RUN TIME: 8:11:52

KEY NUMBER	PART NUMBER	DESCRIPTION	QUANTITY
1	012108	3/8" LOCK NUT	24
2	012082	5/16" LOCK NUT	12
3	012090	1/4" LOCK NUT	1
4	013564	3/8" X 1 3/4" BOLT	5
5	013580	3/8" X 2" BOLT	7
6	013574	3/8" X 2 1/4" BOLT	1
7	.	KEY# NOT USED	0
8	105329	3/8" X 2 3/4" BOLT	4
9	104049	3/8" X 3 1/2" BOLT	1
10	107503	3/8" X 5" BOLT	1
11	013211	5/16" X 3/4" BOLT	2
12	013303	5/16" X 1" BOLT	2
13	102884	5/16" X 2 1/4" BOLT	2
14	103053	5/16" X 2 1/2" BOLT	1
15	113744	5/16" X 2 3/4" BOLT	2
16	013231	5/16" X 3 1/4" BOLT	1
17	013330	1/4"X2 1/4" CARRIAGE BOLT	1
18	108674	3/8"X2 1/2" CARRIAGE BOLT	5
19	.	KEY# NOT USED	0
20	105495	3/8" WASHER	9
21	014041	5/16" WASHER	7
22	014127	1/4" WASHER	3
23	115158	3/8" PLASTIC WASHER *	2
24	013162	1/2" TAP SCREW	2
25	013341	1/4" X 2 1/2" SCREW	2
26	013456	1/4" X 3/4" SCREW	2
27	013275	1/4" X 2 1/4" SCREW	1
28	115506	LONG "I" BRACKET	2
29	111470	1/2" X 1/2" BUSHING	6
30	107768	SHORT CHAIN	1
31	115505	SHORT "I" BRACKET *	2
32	113662	"L" CABLE GUIDE BRACKET	6
33	113756	"L" PULLEY SWIVEL BRACKET	2
34	115511	PEDAL SUPPORT BRACKET *	1
35	113816	SEAT BRACKET *	1
36	115370	3.5" PULLEY	15
37	115513	6" PULLEY *	1
38	101578	3/4" PUSH NUT RETAINER	2
39	108778	1" PUSH NUT RETAINER	2
40	109551	5/8" PUSH NUT RETAINER	2
41	128388	1/2" PUSH NUT RETAINER	2
42	115402	3/4" RETAINER ENDCAP *	2
43	112299	1" RETAINER ENDCAP	2
44	115406	5/8" RETAINER ENDCAP *	2
45	115403	1/2" ENDCAP	2
46	112359	CYLINDER SPACER W/PUSHNUT	2
	.	109413 SPACER	1
	.	109551 PUSH NUT	1
47	111000	1/2" BUSHING	4
48	111644	3/8" BUSHING	2
49	121145	7/8" BUSHING	4
50	108874	2" SQUARE ENDCAP	4
51	113666	1 3/4" SQUARE ENDCAP *	2
52	103833	1 1/2" SQUARE ENDCAP	2

MODEL NUMBER: PF88003  
 VERSION: 00  
 PRODUCT NAME: PROFORM 880 CS  
 PRODUCT DESC:

MODEL/PART BOOK LISTING

PAGE 2  
 INI023P1  
 RUN DATE: 1/11/97  
 RUN TIME: 8:11:52

KEY NUMBER	PART NUMBER	DESCRIPTION	QUANTITY
53	124822	1/2" X 1/4" SPACER	2
54	112275	1 1/2" SQ BSHG W/PUSH NUT	2
	.	112276 SQUARE BUSHING	2
	.	108778 PUSH NUT	1
55	115998	1 1/2" ROUND ENDCAP	2
56	111388	HANDGRIP	4
57	114797	10 1/2" FOAM PAD	2
58	115462	RIGHT ARM ASSEMBLY *	1
	.	115477 RIGHT ARM	1
	.	101578 PUSH NUT	1
59	115481	LEFT ARM ASSEMBLY *	1
	.	115482 LEFT ARM	1
	.	101578 PUSH NUT	1
60	108726	3/4" X 13" FOAM PAD BAR	2
61	103805	6" FOAM PAD	4
62	111324	1" X 13" HANDLE	1
63	116570	1" X 13" PEDAL AXLE *	1
64	112270	RIGHT PEDAL	1
65	112269	LEFT PEDAL	1
66	112277	PEDAL COVER	2
67	109398	RESISTANCE CYLINDER	2
68	113739	LAT BAR *	1
69	103087	CABLE CLIP	3
70	115507	SEAT *	1
71	115491	BACKREST *	1
72	115492	SEAT UPRIGHT FRAME *	1
73	113755	"U" BRACKET *	1
74	115495	ARM FRAME ASSEMBLY *	1
75	114917	SELECTOR PLATE *	1
76	115154	SELECTOR KNOB *	1
77	115493	WEIGHT UPRIGHT FRAME *	1
78	115496	WEIGHT SELECTOR *	1
79	040119	ROUND ENDCAP	1
80	114789	WEIGHT GUIDE	2
81	115593	WEIGHT	15
82	105433	WEIGHT BUMPER	2
83	113754	WEIGHT PIN, 7" W/TAB	1
84	112639	WEIGHT SLEEVE	30
85	109976	WEIGHT CENTER SLEEVE	1
86	113762	LEG LEVER *	1
87	113711	LEG PRESS ARM *	1
88	113817	LEG PRESS PLATE *	1
89	111113	LEG PIN, 7" L *	1
90	115497	FOOT PLATE *	1
91	115498	BASE *	1
92	105315	LONG CHAIN	1
93	115510	WEIGHT CABLE *	1
94	115509	LONG CABLE *	1
95	115508	ARM CABLE *	1
96	108872	9 1/2" ARM FRAME PIN	1
97	013210	5/16" X 1 1/2" BOLT	1
98	115177	NYLON STRAP *	1
99	NLA	DECAL SHEET	1
100	116920	BUMPER W/BOLT	1

MODEL NUMBER: PF88003  
 VERSION: 00  
 PRODUCT NAME: PROFORM 880 CS  
 PRODUCT DESC:

MODEL/PART BOOK LISTING

PAGE 3  
 INI023P1  
 RUN DATE: 1/11/97  
 RUN TIME: 8:11:52

KEY NUMBER	PART NUMBER	DESCRIPTION	QUANTITY
		NON-ILLUSTRATED PARTS:	0
#	114063	PART ID CHART *	1
#	113924	EXERCISE MANUAL *	1
#	113518	OWNER'S MANUAL *	1
#	115500	LITERATURE PACKET	1
		113518 OWNER'S MANUAL	1
		114063 PART ID CHART	1
		113924 EXERCISE MANUAL	1
#	115504	HARDWARE KIT	1
		115513 PULLEY	1
		103087 CABLE HOOK	2
		105315 CHAIN	1
		115177 ANKLE STRAP	1
#	115501	HARDWARE KIT STEPS 1-11	1
		101278 3" SCREW	2
		012108 HEX NUT	7
		012082 HEX NUT	5
		013564 1.75" SCREW	2
		014041 FLAT WASHER	4
		013162 1/2" SCREW	2
		103833 ENDCAP	1
		108778 1" PUSH NUT	2
		112299 ENDCAP	2
		111388 HAND GRIP	2
		105433 BUMPER	2
		013211 SCREW	2
		109413 SPACER	2
		109551 PUSH NUT	2
#	115502	HARDWARE KIT STEPS 13-23	1
		012108 HEX NUT	8
		012082 HEX NUT	2
		013564 SCREW	2
		013580 SCREW	2
		103053 SCREW	1
		113666 ENDCAP	2
		105495 WASHER	4
		111470 BUSHING	4
		107768 CHAIN	1
		101578 PUSH NUT	2
		128388 PUSH NUT	2
		115402 ENDCAP	2
		111388 HAND GRIP	2
		103833 ENDCAP	1
		115998 ENDCAP	2
		103087 CABLE HOOK	1
		013210 SCREW	1
#	115503	HARDWARE KIT STEPS 24-36	1
		012108 HEX NUT	7
		012082 HEX NUT	5
		014127 FLAT WASHER	3
		013564 SCREW	1
		013580 SCREW	3
		104049 SCREW	2
		107503 SCREW	1

MODEL NUMBER: PF88003  
VERSION: 00  
PRODUCT NAME: PROFORM 880 CS  
PRODUCT DESC:

MODEL/PART BOOK LISTING

PAGE 4  
INI023P1

RUN DATE: 1/11/97  
RUN TIME: 8:11:52

KEY NUMBER	PART NUMBER	DESCRIPTION	QUANTITY
.		013303 SCREW	2
.		102884 SCREW	2
.		105495 FLAT WASHER	3
.		014041 FLAT WASHER	3
.		012090 HEX NUT	1
.		013341 SCREW	2
.		013456 SCREW	2
.		013275 SCREW	1
.		113756 BRACKET	2
.		013574 SCREW	1
.		013231 SCREW	1
.		013330 CARRIAGE BOLT	1
#		*--THESE ARE ESTIMATED	0
#		COSTS!!!!	0