

EXPLODED DRAWING - Model No. PFATP

Rev. 9/89

*Specifications are subject to change without notice.

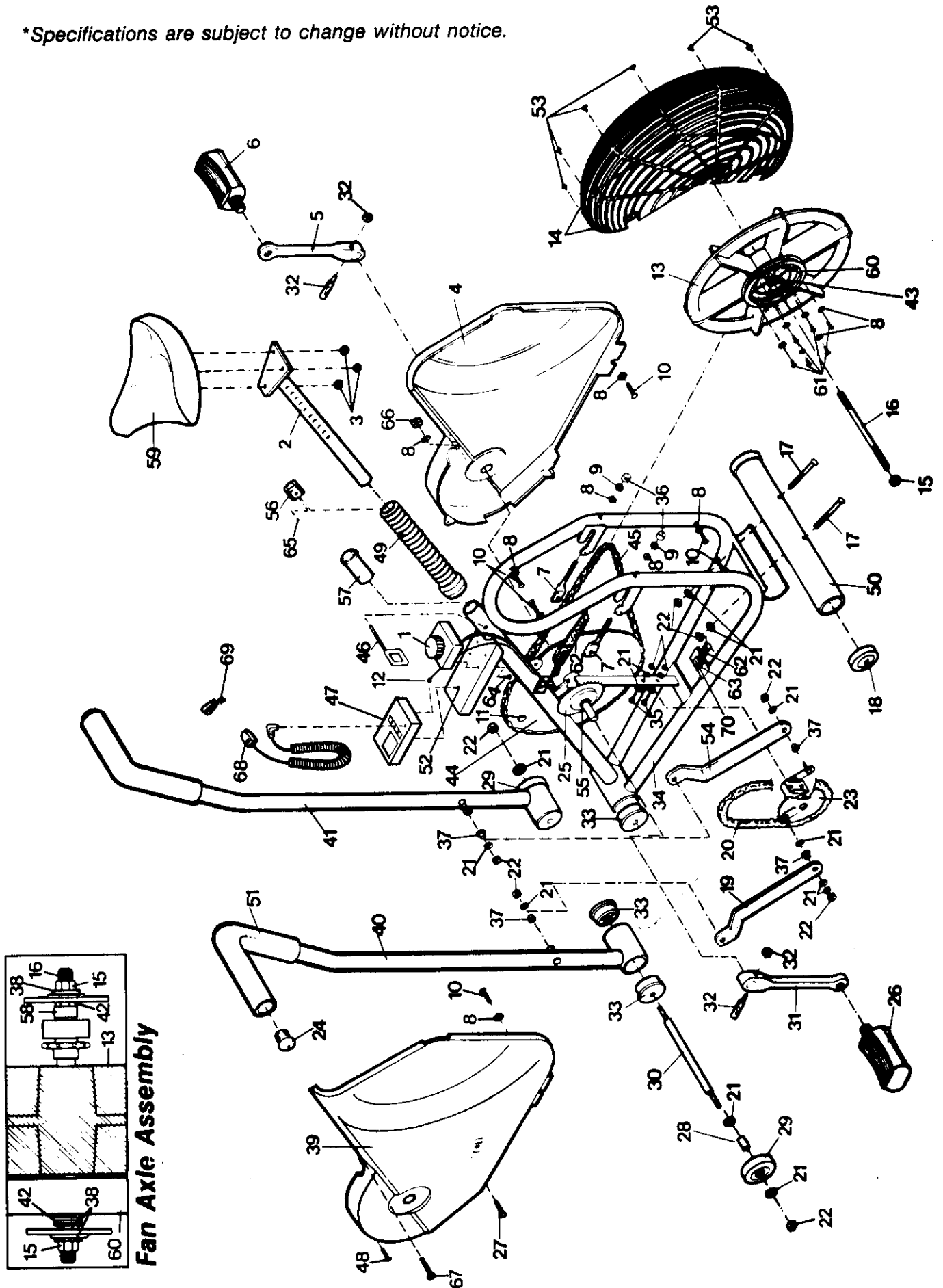

Fan Axle Assembly

PFATP

TO DETERMINE WHAT BIKE THE CUSTOMER HAS, ASK WHAT COLOR THE FAN COVER IS.

BLACK - GO TO PFATP LIST
RED - GO TO AB85 LIST

SOME AB85'S WERE DECALED AS PFATP'S. ALSO, SOME AB85'S HAVE ELECTRONICS WITH A PULSE CLIP.

MODEL NUMBER: PFATP
VERSION: 00
PRODUCT NAME: PFATP
PRODUCT DESC: BIKE

MODEL/PART BOOK LISTING

PAGE 1
INI023P1
RUN DATE: 1/31/97
RUN TIME: 9:47:29

KEY NUMBER	PART NUMBER	DESCRIPTION	QUANTITY
1	072046	TENSION KNOB W/CABLE	1
2	007107	SEAT POST	1
3	012002	SEAT NUT	3
4	NLA	RIGHT SIDESHIELD	1
5	NLA	RIGHT CRANK ARM	1
6	038033	RIGHT PEDAL	1
7	013411	FAN ADJUSTMENT BOLT	2
8	014033	WASHER	12
9	012111	FAN ADJUSTMENT NUT	2
10	013356	SCREW	6
11	033121	MAGNET	3
12	124434	SENSOR WIRE	1
13	021047	FAN W/SPROCKET	1
14	010186	FAN GUARD	2
15	012164	AXLE NUT	2
16	049070	FAN AXLE	1
17	013144	CARRIAGE BOLT	2
18	040134	LEG CAP	2
19	NLA	LEFT LINKARM	1
20	025048	ARM CHAIN	1
21	014030	WASHER	13
22	012042	NUT	10
23	NLA	ARM BEAR	1
24	040150	HANDLEBAR CAP	2
25	024020	ARM SPROCKET	1
26	038032	LEFT PEDAL	1
27	013512	LONG SIDESHIELD SCREW	1
28	019213	SPACER	2
29	052015	WHEEL	2
30	049080	PIVOT ROLL	1
31	NLA	LEFT CRANK ARM	1
32	015033	CRANK PIN SET	2
33	019305	LARGE BUSHING	6
34	NSP	FRAME	1
35	013056	BOLT	2
36	NLA	RUBBER CAP	2
37	019208	BUSHING	4
38	014040	LARGE WASHER	6
39	010132	LEFT SIDESHIELD	1
40	NLA	LEFT HANDLEBAR	1
41	NLA	RIGHT HANDLEBAR	1
42	012127	THIN NUT	2
43	019198	TAPERED BUSHING	1
44	NLA	SPROCKET/CRANK	1
45	025042	DRIVE CHAIN	1
46	015055	SEAT PIN	1
47	NLA	ELECTRONIC MONITOR	1
48	013380	SIDESHIELD SCREW	1
49	010150	SEAT POST BELLOWS	1
50	005058	REAR LEG	1
51	NLA	HANDLEBAR FOAM GRIP	2
52	013322	ELECTRONIC MTG. SCREW	2
53	100307	FAN GUARD SCREW	8
54	NLA	RIGHT HANDLEBAR ARM	1

MODEL NUMBER: PFATP
VERSION: 00
PRODUCT NAME: PFATP
PRODUCT DESC: BIKE

MODEL/PART BOOK LISTING

PAGE 2

INI023P1

RUN DATE: 1/31/97
RUN TIME: 9:47:29

KEY NUMBER	PART NUMBER	DESCRIPTION	QUANTITY
55	070516	CRANK ASSEMBLY	1
.	.	018001 BEARING	2
.	.	014009 KEY WASHER	1
.	.	012019 NUT W/2 SLOTS	1
.	.	012011 NUT W/3 SLOTS	1
.	.	012012 HEX NUT	1
.	.	014008 FLAT WASHER	1
56	037009	SEAT POST PILOT	1
57	019195	SEAT TUBE LINER	1
58	014104	TAPERED WASHER	1
59	042023	SEAT	1
60	020047	PULLEY	1
61	013356	PULLEY SCREW	6
62	035042	TENSION STRAP	1
63	050001	TENSION BUCKLE	1
64	013141	TENSION CONTROL SCREW	6
65	100244	PILOT SCREW	1
66	NLA	SIDESHIELD NUT	1
67	013550	SIDESHIELD BOLT	1
68	119946	PULSE MONITOR CLIP	1
69	054013	CLOTHES CLIP	1
70	013572	BUCKLE MOUNTING SCREW	1
#	044622	RIGHT FendersHIELD DECAL	1
#	NLA	LEFT FendersHIELD DECAL	1
#	102356	BEARINGS	2
#	045028	SOCKET TUBE	1
#	045022	WRENCH/SOCKET/SCREWDRIVER	1
#	089040	MONITOR OPERATION GUIDE	1
#	046197	OWNER'S MANUAL	1