

# EXPLODED DRAWING—Model No. WEBE30551

R09984

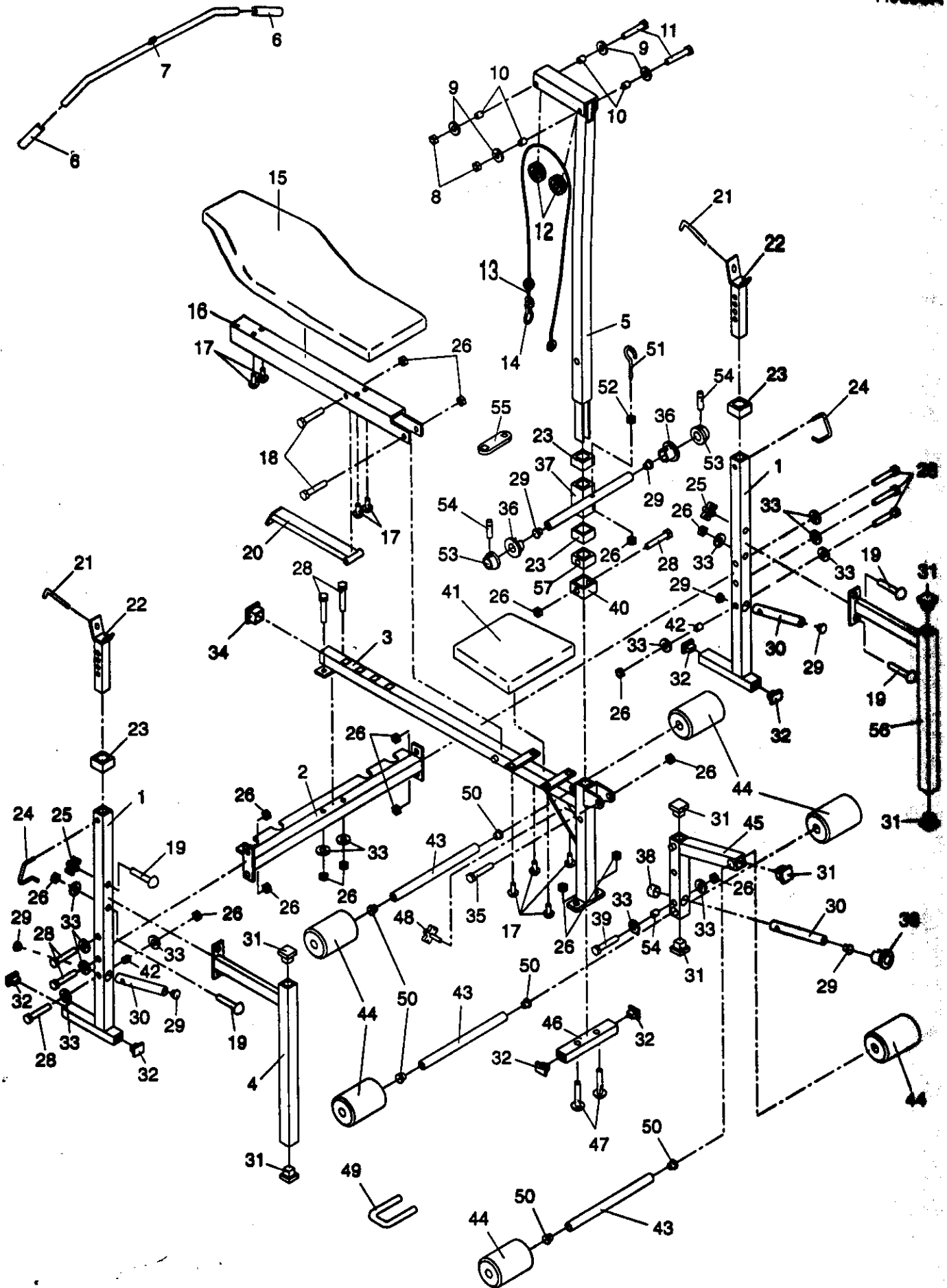

MODEL NUMBER: WEBE3055  
 VERSION: 01  
 PRODUCT NAME: WEIDER PRO 305  
 PRODUCT DESC:

MODEL/PART BOOK LISTING

PAGE 1  
 INI023P1  
 RUN DATE: 5/23/96  
 RUN TIME: 15:53:32

KEY NUMBER	PART NUMBER	DESCRIPTION	QUANTITY
	.	WEIDER PRO 305	0
1	127928	UPRIGHT *	2
2	127929	CROSSBAR *	1
3	127930	FRAME *	1
4	127931	RIGHT SPOTTER RACK *	1
5	127932	LAT TOWER *	1
6	112560	HAND GRIP	2
7	127933	LAT BAR *	1
8	119425	3/8" NYLON LOCKNUT	2
9	014132	3/8" WASHER	4
10	128051	1/2" X 5/8" SPACER	4
11	112001	3/8" X 3" BOLT	2
12	124590	PULLEY	2
13	127934	CABLE *	1
14	103087	CABLE CLIP	1
15	127935	BACKREST	1
16	127936	BACKREST RAIL *	1
17	123148	1/4" X 1/2" SCREW	8
18	124614	5/16" X 3.5" BOLT	2
19	127938	5/16" X 3.25" CARR BOLT *	4
20	127939	INCLINE BRACE	1
21	122693	L-PIN	2
22	127940	WEIGHT REST *	2
23	127941	2.5" SQ BUSHING	4
24	127942	LOCKING PIN	2
25	119192	5/16" KNOB	2
26	012056	5/16" NYLON LOCKNUT	18
27	128049	1/2" X 17/32" SPACER	1
	.	(NOTE: THIS IS SHOWN AS	0
	.	KEY#54 ON LEG LEVER, BUT	0
	.	KEY#54 IS THE SET SCREW	0
	.	FOR WEIGHT CARRIAGE.)	0
28	127943	5/16" X 3.25" BOLT	9
29	120733	1" ROUND CAP	7
30	127944	WEIGHT TUBE *	3
31	108874	2" SQ CAP	7
32	119300	1.5" X 2.5" CAP	6
33	014073	5/16" WASHER	14
34	113666	1.75" SQ CAP	1
35	126145	5/16" X 3" BOLT	1
36	123403	WEIGHT STOP	3
37	127946	WEIGHT CARRIAGE *	1
38	123396	1" ANGLED CAP	1
39	127948	5/16" X 2.5" BOLT	1
40	127949	WEIGHT CARRIAGE STOP *	1
41	128040	SEAT	1
42	119973	1/2" X 3/4" SPACER	2
43	128041	PAD TUBE *	3
44	103805	FOAM PAD	6
45	128042	LEG LEVER *	1
46	128043	STABILZER *	1
47	013278	5/16" X 2" CARR BOLT	2
48	128044	LAT TOWER KNOB	1
49	128045	U-HOOK *	1

MODEL NUMBER: WEBE3055  
 VERSION: 01  
 PRODUCT NAME: WEIDER PRO 305  
 PRODUCT DESC:

MODEL/PART BOOK LISTING

PAGE 2  
 INI023P1  
 RUN DATE: 5/23/96  
 RUN TIME: 18:53:32

KEY NUMBER	PART NUMBER	DESCRIPTION	QUANTITY
50	113667	3/4" ROUND CAP	6
51	129051	5/16" EYEBOLT	1
52	012003	5/16" NUT	1
53	123766	WEIGHT COLLAR	2
54	121992	SET SCREW	2
.	.	(NOTE: KEY# 54 IS THE SET	0
.	.	SCREW. FOR THE SPACER ON	0
.	.	LEG LEVER SEE KEY# 27.)	0
55	123744	SET SCREW WRENCH	1
56	128047	LEFT SPOTTER RACK *	1
57	128048	2.5" DRILLED BUSHING *	1
.	.	NON-ILLUSTRATED PARTS	0
#	128064	WEIDER NAME PLATE *	1
#	128052	DECAL SHEET *	1
#	127906	CN-ASSY UPDATE, STEP 7 *	1
#	127482	USER'S MANUAL *	1
#	128053	HARDWARE KIT, STEPS 1-5 *	1
.	.	129941 2.5" SQ BUSHING	2
.	.	123403 WEIGHT STOP	3
.	.	119300 1.5 X 2.5" CAP	6
.	.	127942 LOCKING PIN	2
.	.	122693 L-PIN	2
.	.	127943 5/16" X 3.25" BOLT	6
.	.	119973 1/2" X 3/4" SPACER	2
.	.	120733 1" ROUND CAP	4
.	.	012056 5/16" LOCKNUT	8
.	.	014073 5/16" WASHER	8
.	.	013278 2" CARRIAGE BOLT	2
#	128054	HARDWARE KIT, STEPS 6-12 *	1
.	.	108874 2" SQ CAP	7
.	.	123403 WEIGHT STOP	1
.	.	113666 1.75" SQ CAP	1
.	.	119192 5/16" KNOB	2
.	.	123396 1" ANGLED CAP	1
.	.	127943 3.25" BOLT	4
.	.	127938 3.25" CARR BOLT	4
.	.	127948 2.5" BOLT	1
.	.	012056 5/16" LOCKNUT	6
.	.	120733 1" ROUND CAP	1
.	.	128049 SPACER	1
.	.	123148 1/4" X 1/2" SCREW	8
#	128055	HARDWARE KIT, STEPS 13-18*	1
.	.	121992 SET SCREW	2
.	.	123766 WEIGHT COLLAR	2
.	.	123744 SET SCREW WRENCH	1
.	.	115370 PULLEY	2
.	.	128045 U-HOOK	1
.	.	128044 LAT TOWER KNOB	1
.	.	129051 EYEBOLT	1
.	.	103087 CABLE CLIP	1
.	.	012056 5/16" LOCKNUT	3
.	.	127943 3.25" BOLT	1
.	.	119425 3/8" LOCKNUT	2
.	.	014132 3/8" WASHER	4

MODEL NUMBER: WEBE3055  
VERSION: 01  
PRODUCT NAME: WEIDER PRO 305  
PRODUCT DESC:

MODEL/PART BOOK LISTING

PAGE 3  
01023P1  
RUN DATE: 5/23/96  
RUN TIME: 16:53:32

KEY NUMBER	PART NUMBER	DESCRIPTION	QUANTITY
.	.	128051 SPACER	4
.	.	112001 3" BOLT	2
.	.	120733 1" CAP	2
.	.	113667 3/4" CAP	6