

EXPLODED DRAWING—Model No. WG87750

R1094A

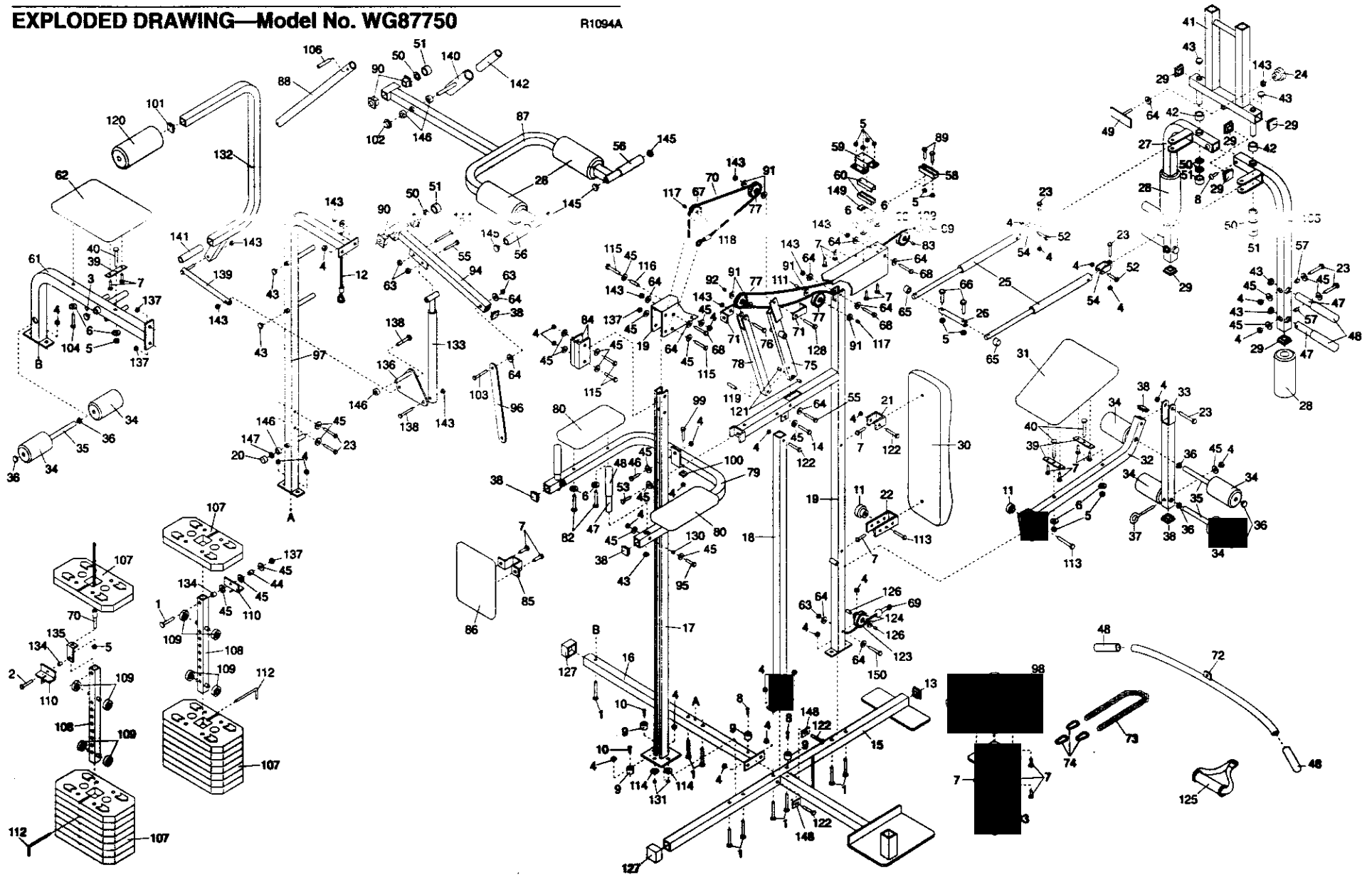

MODEL NUMBER: WG8775
 VERSION: 00
 PRODUCT NAME: WEIDER 8775
 PRODUCT DESC:

MODEL/PART BOOK LISTING

PAGE 1
 INI023P1
 RUN DATE: 5/23/96
 RUN TIME: 18:54:25

KEY NUMBER	PART NUMBER	DESCRIPTION	QUANTITY
	.	WEIDER 8775 HARD DRIVE SY	0
1	100994	5/16" X 2.5" CARR BOLT	10
2	013469	5/16" X 1.25" BOLT	1
3	119971	7/8" ROUND CAP	1
4	012082	5/16" NYLON LOCK NUT	32
5	012090	1/4" NYLON LOCK NUT	12
6	014127	1/4" FLAT WASHER	8
7	121686	1/4" X 3/4" SCREW	13
8	119445	1.25" TAP SCREW	4
9	123108	RUBBER BUMPER	4
10	122092	#8-32 SCREW	2
11	119192	5/16" KNOB	2
12	121916	STOP CABLE	1
13	108874	2" INNER CAP	1
14	103053	5/16" X 2.5" BOLT	1
15	122149	BASE	1
16	121921	STABILIZER	1
17	121782	REAR UPRIGHT	1
18	121818	CENTER UPRIGHT	1
19	126473	FRONT UPRIGHT ASSEMBLY	1
20	121907	1/2" PLASTIC CAP	1
21	121819	SMALL U-BRACKET	1
22	121820	ADJUSTMENT BRACKET	1
23	102884	5/16" X 2.25" BOLT	9
24	121961	SELECTOR KNOB	1
25	121696	ARM SHOCK	2
26	121821	SHOCK BAR	1
27	121923	LEFT ARM	1
28	121715	8" FOAM PAD	4
29	113666	1.75" INNER CAP	6
30	122100	LARGE BACKREST	1
31	121908	SEAT	1
32	121823	SEAT FRAME	1
33	121824	LEG LEVER	1
34	128720	7" FOAM PAD	6
35	121825	PAD TUBE	3
36	119170	3/4" PLASTIC CAP	6
37	121687	5/16" X 2" EYEBOLT	1
38	103833	1.5" INNER CAP	5
39	121826	SEAT BRACKET	3
40	121681	1/4" X 2.25" CARR. BOLT	3
41	121827	ARM FRAME	1
42	121828	PLASTIC BUSHING	2
43	118475	1" ROUND CAP	10
44	121700	1/2" X 1/4" BUSHING	1
45	014041	5/16" FLAT WASHER	30
46	122093	5/16" X 3/4" BOLT	1
47	121829	SHORT HANDLE	6
48	119702	5" GRIP	8
49	121830	SELECTOR PLATE	1
50	108778	1" RETAINER	6
51	120808	1" PLASTIC CAP	4
52	013293	5/16" X 1.75" BOLT	2
53	122090	5/16" X 1.75" SCREW	1

MODEL NUMBER: WG8775
VERSION: 00
PRODUCT NAME: WEIDER 8775
PRODUCT DESC:

MODEL/PART BOOK LISTING

PAGE 2
IN1023P1
RUN DATE: 5/23/96
RUN TIME: 18:54:25

KEY NUMBER	PART NUMBER	DESCRIPTION	QUANTITY
54	121832	SWIVEL U-BRACKET	2
55	105329	3/8" X 2.75" BOLT	3
56	104567	FOAM GRIP	2
57	119967	1/2" X 3/8" BUSHING	4
58	124253	BAR HOLDER	1
59	121835	ARM FRAME CAP	1
60	119217	ARM FRAME BUSHING	2
61	121924	AB SEAT FRAME	1
62	122102	AB SEAT	1
63	012108	3/8" NYLON LOCK NUT	8
64	105674	3/8" FLAT WASHER	12
65	115402	3/4" COVER CAP	2
66	013444	1/4" X 1.25" BOLT	2
67	124590	3.5" PULLEY	1
68	110375	3/8" X 3" BOLT	3
69	121884	CABLE, BALL/BALL,139.5"L	1
70	121883	CABLE, LOOP/THD,68"L	1
71	121836	L-BRACKET	2
72	121694	LAT BAR	1
73	107768	CHAIN	1
74	103087	CABLE CLIP	3
75	121837	PIVOT ARM	1
76	013564	3/8" X 1.75" BOLT	1
77	121838	THIN 3/8" PULLEY	3
78	121839	PIVOT ARM EXTENSION	1
79	125053	VKR ARM	1
80	121998	VKR ARMREST	2
81	.	SEE KEY #47	0
82	122692	1/4" X 2" SCREW	4
83	119644	1/2" X 5/8" SPACER	2
84	121699	UPRIGHT BRACKET	2
85	121841	VKR BACKREST BRACKET	1
86	122101	SMALL BACKREST	1
87	125063	MILITARY PRESS ARM	1
88	121927	LARGE LINK TUBE	1
89	122091	1/4"X3/4" TAPERED SCREW	2
90	112276	1 3/8" BUSHING	4
91	121844	SMALL FLANGED BUSHING	6
92	121845	5/8" X 1/2" SPACER	1
93	121901	SEAT POST	1
94	121846	LEVER	1
95	013464	5/16" X 2" BOLT	2
96	122143	LINK ARM	1
97	121928	AB UPRIGHT	1
98	121999	SQUAT SEAT	1
99	101278	5/16" X 3" BOLT	1
100	121867	SQUARE WASHER	1
101	120694	1.25" INNER CAP	1
102	100150	1/2" AXLECAP	1
103	108674	3/8" X 2.5" CARR. BOLT	1
104	121904	1/4" X 2.25" MACH SCREW	1
105	121960	RIGHT ARM	1
106	121959	1.5" ROLL PIN	1
107	119210	WEIGHT	16

MODEL NUMBER: WG8775
 VERSION: 00
 PRODUCT NAME: WEIDER 8775
 PRODUCT DESC:

MODEL/PART BOOK LISTING

PAGE 3
 INI023P1
 RUN DATE: 5/23/96
 RUN TIME: 18:54:25

KEY NUMBER	PART NUMBER	DESCRIPTION	QUANTITY
108	121854	WEIGHT TUBE	2
109	121855	ROLLER	8
110	121856	WEIGHT BRACKET	2
111	121857	1/2" X 1.75" BUSHING	1
112	119214	L-PIN	2
113	113814	5/16" X 2.75" CARR. BOLT	2
114	014140	#8 WASHER	2
115	116101	5/16" X 3.25" BOLT	4
116	121964	1/2" X 2.5" BUSHING	1
117	115648	1/2" X 1/2" BUSHING	2
118	121859	1/2" X 1.25" BUSHING	1
119	121860	5/16" X 1.5" ROLL PIN	1
120	121962	10" PAD	1
121	121963	3/8" X 5/16" BUSHING	2
122	113744	5/16" X 2.75" BOLT	4
123	121864	2 5/8" PULLEY	1
124	121865	LONG FLANGED BUSHING	2
125	115177	NYLON STRAP	1
126	.	SEE KEY #117	0
127	105723	2" OUTER CAP	2
128	121930	3/8" X 1.25" CARR. BOLT	1
129	115164	3.5" PULLEY	1
130	121703	1/2" X 5/16" BUSHING	2
131	012152	#8-32 NUT	2
132	121931	AB ARM	1
133	121957	MILITARY/SQUAT ARM SHOCK	1
134	119201	1/2" X 7/16" BUSHING	2
135	121833	CABLE BRACKET	1
136	121934	LINKAGE BRACKET	1
137	119440	5/16" JAM NUT	3
138	013369	3/8" X 1.5" BOLT	2
139	121935	SMALL LINK TUBE	1
140	121954	PIVOT BRACKET	1
141	121955	AB ARM BUSHING	1
142	121956	PIVOT BRACKET BUSHING	1
143	105133	3/8" JAM NUT	3
144	101263	3/8" X 4" BOLT	1
145	116855	1.25" ROUND CAP	4
146	121918	1/2"L BUSHING	4
147	103682	1/2" RETAINER	1
148	123687	RECTANGULAR WASHER	2
149	121704	THIN METAL PLATE	1
150	103045	3/8" X 2.5" BOLT	1
.	.	NON-ILLUSTRATED PARTS	0
#	121704	THIN METAL PLATE	1
#	122142	CONSUMER NOTICE	1
#	119837	DECAL SHEET	1
#	120232	PART ID CHART	1
#	125056	EXERCISE POSTER	1
#	120231	PART LIST/EXP DWG	1
#	120230	OWNER'S MANUAL	1
#	122163	LITERATURE PACKET	1
.	.	120230 OWNER'S MANUAL	1
.	.	120232 PART ID CHART	1

MODEL NUMBER: WG8775
 VERSION: 00
 PRODUCT NAME: WEIDER 8775
 PRODUCT DESC:

MODEL/PART BOOK LISTING

PAGE 4
 I01023P1
 RUN DATE: 5/23/96
 RUN TIME: 18:54:25

KEY NUMBER	PART NUMBER	DESCRIPTION	QUANTITY
.		122142 CONSUMER NOTICE	1
.		119837 DECAL SHEET	1
.		125056 EXERCISE POSTER	1
.		120231 PART LIST/EXP DWG	1
122164		HWKIT, STEPS 1-11	1
.		116101 3.25" SCREW	3
.		113744 2.75" SCREW	3
.		103053 2.5" SCREW	1
.		013469 1.25" SCREW	1
.		122090 1.75" SCREW	1
.		121686 1/4" X 3/4" SCREW	4
.		122091 1/4" X 3/4" SCREW	2
.		122092 #8 X 1.25" SCREW	2
.		119643 1.25" SCREW	2
.		100994 2.5" CARR BOLT	10
.		012082 5/16" HEX NUT	15
.		012090 1/4" HEX NUT	7
.		012152 #8-32 HEX NUT	2
.		108778 RETAINER	4
.		014041 5/16" FLAT WASHER	10
.		014127 1/4" FLAT WASHER	4
.		014140 #8 FLAT WASHER	2
.		119967 SPACER	1
.		119214 WT SELECT PIN	2
.		121704 PLATE BRACKET	1
.		105723 2" SQ ENDCAP	2
.		113666 1.75" SQ ENDCAP	6
.		108874 2" SQ ENDCAP	1
.		120808 1" RND ENDCAP	2
.		118475 RND ENDCAP	2
.		119217 ARM PRESS BUSHING	2
.		119216 ARM PRESS COVER	1
.		121699 UPRIGHT BRACKET	2
.		105433 RUBBER BUMPER	4
122165		HWKIT, STEPS 12-21	1
.		113744 2.75" SCREW	1
.		102884 2.25" SCREW	7
.		013293 1.75" SCREW	2
.		013444 1.25" SCREW	2
.		121686 1/4" X 3/4" SCREW	6
.		119643 1.25" SCREW	2
.		113814 2.75" CARR BOLT	2
.		119188 2.25" CARR BOLT	2
.		121687 2.5" EYEBOLT	1
.		105133 3/8" HEX NUT	1
.		012082 5/16" HEX NUT	11
.		012090 1/4" HEX NUT	4
.		105674 7/16" FLAT WASHER	1
.		014041 5/16" FLAT WASHER	9
.		014127 1/4" FLAT WASHER	2
.		119967 SPACER	4
.		103833 1.5" SQ ENDCAP	2
.		118475 1" RND ENDCAP	4
.		115402 3/4" RND ENDCAP	2

MODEL NUMBER: WG8775
 VERSION: 00
 PRODUCT NAME: WEIDER 8775
 PRODUCT DESC:

MODEL/PART BOOK LISTING

PAGE 5
 INFO23P1
 RUN DATE: 5/13/96
 RUN TIME: 18:54:25

KEY NUMBER	PART NUMBER	DESCRIPTION	QUANTITY
.		119170 .75" RND ENDCAP	4
.		119192 5/16" RND KNOB	2
.		121961 SELECTOR KNOB	1
122166		HWKIT, STEPS 22-44	1
.		101263 4" SCREW	1
.		105329 2.75" SCREW	1
.		013564 1.75" SCREW	1
.		013369 1.5" SCREW	1
.		101278 3" SCREW	1
.		102884 2.25" SCREW	2
.		013464 2" SCREW	2
.		122093 .75" SCREW	1
.		121904 2.25" SCREW	1
.		122095 2" SCREW	4
.		121686 .75" SCREW	8
.		108674 2.5" CARR BOLT	1
.		119188 2.25" CARR BOLT	1
.		012108 3/8" HEX NUT	1
.		105133 3/8" HEX NUT	5
.		012082 5/16" HEX NUT	5
.		119440 5/16" HEX NUT	3
.		012090 1/4" HEX NUT	1
.		108778 RETAINER	2
.		103682 PUSHNUT	1
.		105674 7/16" FLAT WASHER	2
.		014041 5/16" FLAT WASHER	10
.		014127 1/4" FLAT WASHER	6
.		119201 METAL SPACER	1
.		121703 METAL SPACER	2
.		121700 METAL SPACER	1
.		115366 RND ENDCAP	1
.		107768 CHAIN	1
.		115177 ANKLE STRAP	1
.		103087 SNAP HOOK	3
.		103833 1.5" SQ ENDCAP	3
.		120694 1.25" SQ ENDCAP	1
.		115354 1.25" SQ ENDCAP	4
.		120808 1" RND ENDCAP	2
.		118475 1" RND ENDCAP	4
.		119971 7/8" RND ENDCAP	1
.		115998 1.5" RND ENDCAP	1
.		119170 .75" RND ENDCAP	2
.		112276 BUSHING	4