

EXPLODED DRAWING—Model No. WLTL84563

RUS77A

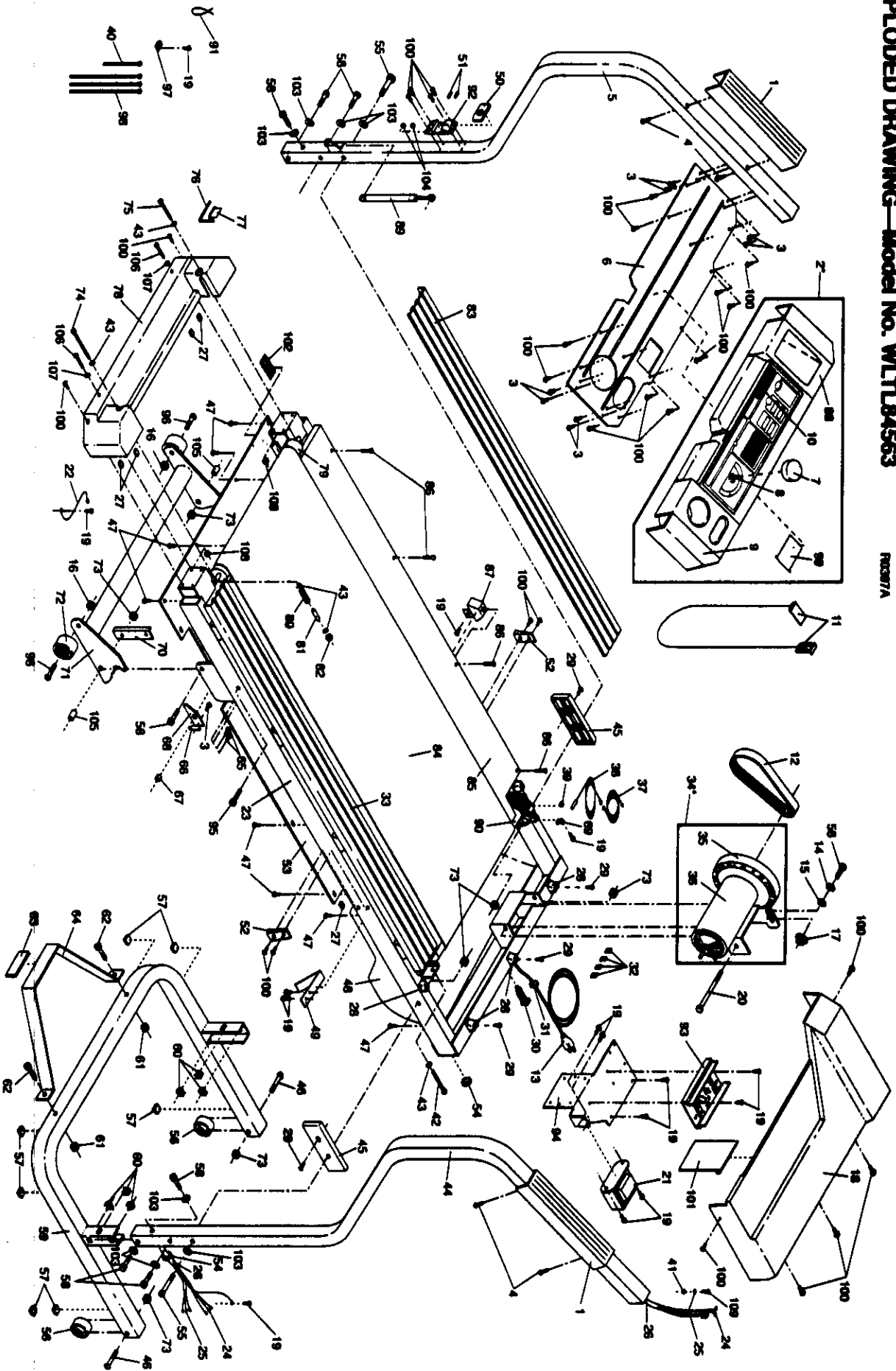

MODEL NUMBER: WLTL8456
VERSION: 03
PRODUCT NAME: CADENCE 845
PRODUCT DESC:

MODEL/PART BOOK LISTING

PAGE 1
INI023P1
RUN DATE: 3/27/97
RUN TIME: 14:17:56

KEY NUMBER	PART NUMBER	DESCRIPTION	QUANTITY
.	.	CADENCE 845	0
.	.	3/97 LOGAN	0
1	129631	HANDRAIL COVER	2
2	132384	CONSOLE	1
3	126996	CONSOLE PLATE SCREW	9
4	130463	HANDRAIL COVER SCREW	4
5	130271	LEFT HANDRAIL	1
6	130404	CONSOLE PLATE	1
7	110000	SPEED KNOB	1
8	129640	SPEED POTENTIOMETER	1
9	130100	RIGHT CONSOLE ATTACHMENT	1
10	131551	WARNING DECAL	1
11	119038	KEY/CLIP	1
12	135866	MOTOR BELT	1
13	124669	POWER CORD	1
14	122812	MOTOR TENSION WASHER	1
15	014117	STAR WASHER	1
16	012056	INCLINE WHEEL NUT	2
17	120867	MOTOR TENSION NUT	1
18	130415	MOTOR HOOD	1
19	120630	SMALL SCREW	25
20	107503	MOTOR PIVOT BOLT	1
21	130993	CHOKE	1
22	130426	GROUND WIRE	1
23	NSP	FRAME	1
24	124545	SPEED WIRE	1
25	129736	WIRE HARNESS	1
26	128265	CABLE LOOM	2
27	133333	COVER CLIP	6
28	125802	HOOD ANCHOR	5
29	013300	ANCHOR SCREW	7
30	109382	CIRCUIT BREAKER	1
31	124695	POWER CORD GROMMET	1
32	054023	WIRE CLIP	4
33	132386	RIGHT FOOT RAIL W/FASTENR	1
34	132388	MTR/PULY/FLWH/FAN	1
35	112825	PULLEY/FLYWHEEL/FAN	1
36	132387	MOTOR	1
37	118196	EXTENSION WIRE	1
38	118153	REED SWITCH	1
39	100498	MAGNET	1
40	016029	4" CABLE TIE	1
41	012152	GROUND WIRE NUT	1
42	112609	FRONT ROLLER ADJ BOLT	1
43	014127	ADJUSTMENT WASHER	5
44	130273	RIGHT HANDRAIL	1
45	129542	HANDRAIL SPACER	2
46	130868	BASE WHEEL BOLT	2
47	129168	BELLY PAN SCREW	23
48	131711	BELLY PAN	1
49	127098	BELT GUIDE	2
50	131738	STORAGE LATCH	1
51	136377	STORAGE LATCH SPRING	2
52	130251	FRAME GUIDE	2

MODEL NUMBER: WLTL8456
VERSION: 03
PRODUCT NAME: CADENCE 845
PRODUCT DESC:

MODEL/PART BOOK LISTING

PAGE 2
INI023P1
RUN DATE: 3/27/97
RUN TIME: 14:17:56

KEY NUMBER	PART NUMBER	DESCRIPTION	QUANTITY
53	137368	FRAME COVER	1
54	129004	WIRE HARNESS GROMMET	2
55	120003	HANDRAIL PIVOT BOLT	2
56	132314	BASE WHEEL	2
57	129740	BASE PAD	7
58	013547	HANDRAIL/MTR TENSION BOLT	9
59	137843	BASE	1
60	111869	CAGE NUT	6
61	012056	STABILIZER NUT	2
62	121421	STABILIZER BOLT	2
63	132548	STABILIZER PAD	1
64	130215	STABILIZER	1
65	108080	RATCHET SCREW	2
66	124565	INCLINE LEG SPRING	1
67	128271	INCLINE LEG SPACER, SHORT	1
68	131240	INCLINE LEG LATCH	1
69	131090	REED SWITCH CLAMP	1
70	131689	INCLINE LEG PLATE	1
71	134355	INCLINE LEG	1
72	052012	INCLINE LEG WHEEL	2
73	119425	INCLINE LEG NUT	8
74	128260	LONG ADJUSTMENT BOLT	1
75	105444	SHORT ADJUSTMENT BOLT	1
76	126040	ALLEN WRENCH	1
77	016028	ADHESIVE CLIP	2
78	136061	REAR ROLLER COVER	1
79	131739	REAR ROLLER	1
80	128986	ROLLER TENSION SPRING	1
81	123470	SPRING SLEEVE	1
82	121576	BELT TENSION NUT	1
83	132389	LEFT FOOT RAIL W/FASTENER	1
84	137956	WALKING BELT W/FASTENERS	1
85	132390	WALKING BOARD W/FASTENERS	1
86	101174	PLATFORM SCREW	8
87	134688	ISOLATOR	1
88	130099	LEFT CONSOLE ATTACHMENT	1
89	129814	SHOCK	1
90	131704	FRONT ROLLER/PULLEY	1
91	116926	RELEASEABLE CABLE TIE	1
92	131753	STORAGE LATCH BRACKET	1
93	129843	CONTROLLER	1
94	129468	ELECTRONICS BRACKET	1
95	013578	INCLINE LEG BOLT	1
96	117806	INCLINE LEG WHEEL BOLT	2
97	116927	CABLE TIE CLAMP	1
98	016057	8" CABLE TIE	3
99	129639	BATTERY COVER	1
100	013576	SCREW	26
101	129853	MOTOR GUARD	1
102	131605	LATCH DECAL	1
103	014132	FLAT WASHER	8
104	131562	LATCH BUMPERS	2
105	130518	INCLINE LEG SPACER, LONG	2
106	100606	REAR RLR CVR SCREW, LONG	2

MODEL NUMBER: WLTL8456
VERSION: 03
PRODUCT NAME: CADENCE 845
PRODUCT DESC:

MODEL/PART BOOK LISTING

PAGE 3
INI023P1
RUN DATE: 3/27/97
RUN TIME: 14:17:56

KEY NUMBER	PART NUMBER	DESCRIPTION	QUANTITY
107	014063	REAR RLR CVR/BLYPN WASHER	19
108	121576	REAR ROLLER COVER NUT	2
109	130853	GROUND WIRE SCREW	1
.	.	NON-ILLUSTRATED PARTS	0
#	101799	9" BLACK WIRE, M/F	1
#	101896	4" WHITE WIRE, M/F	1
#	130462	WIRE DIAGRAM	1
#	136999	USER'S MANUAL	1
#	136998	LITERATURE PACKET	1
.	136999	USER'S MANUAL	1
.	132548	STABILIZER FOOT	1
.	129740	BUMPER	7
.	130251	FRAME GUIDE	1
.	130425	HARDWARE KIT	1
.	126040	ALLEN WRENCH	1
.	016028	WRENCH CLIP	1
.	121421	2.25" SCREW	2
.	012056	5/16" NUT	2
.	013576	1/2" SCREW	2