

DUAL ACTION Horizon EXERCISE BIKE

Assembly Instructions

IMPORTANT! Read Instructions carefully and completely before beginning assembly.

1. Unpack carton. Check parts list to make sure all parts are included.

NOTE: Assembly can be completed using the wrench provided.

2. Remove Speedometer/Timer Unit (1) from box and attach to Bike Frame (2) as shown on the drawing. Insert the Cable (3) into the connection on the bottom of the Speedometer and tighten the Finger Nut.
3. Position Crossbar (4) as shown and attach with Bolts (31) and Nuts (12C) to the Rear Frame (5).
4. Thread the Left Pedal (marked "L") (6) to the left side of the Crank (7) and tighten with the wrench. Repeat on the right side with the Right Pedal (8).
5. Put the Handlebar (9) on the Handlebar Post (10) by pushing it through the Clamp (11) and tightening the Nut and Bolt (11A). Insert Post (10) into the Pivot Tube (12) (You may have to twist the Handlebar Post to get it in the Pivot Tube). Tighten the Front Post Clamp (13). (The Handlebar Post must be at least 2 inches or 5 cm deep.)
6. Attach the Tension Control Lever (14) to the Handlebar (9) and tighten the Screw. Moisten the Handlebar and push on the Hand Grips (15). (This will bond the Hand Grips to the Handlebar.) Screw on Cap Ends (16).
7. Insert Seat Post (17) into Seat (18) and tighten the Nut. Put Seat and Post into the Back Tube (19) and tighten the Back Post Clamp (20). (The Seat Post must be at least 2 inches or 5 cm deep.)
8. Set Tension Control (14) to "1" or "Low" and adjust Nylon Tension Belt (21) around Flywheel (22) to pressure desired by increasing or reducing tightness of the Belt through the Belt Tension Buckle (23).
9. Bolt the Hydraulic Shock (33) to the Rear Shock Bracket (34B) and the Front Shock Bracket (34A).

You are now ready to exercise. Instructions for an exercise and training program are explained in the Owner's Manual.

Replacement parts may be ordered quickly and easily from the Weslo Factory offices. If you need to order parts, please call Weslo Customer Service toll free at 800-824-3109 (or in Canada, 800-824-8949) during regular business hours: 8 a.m. to 5 p.m. Mountain Standard Time.

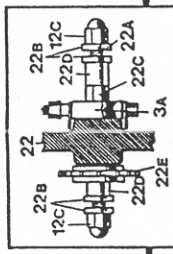
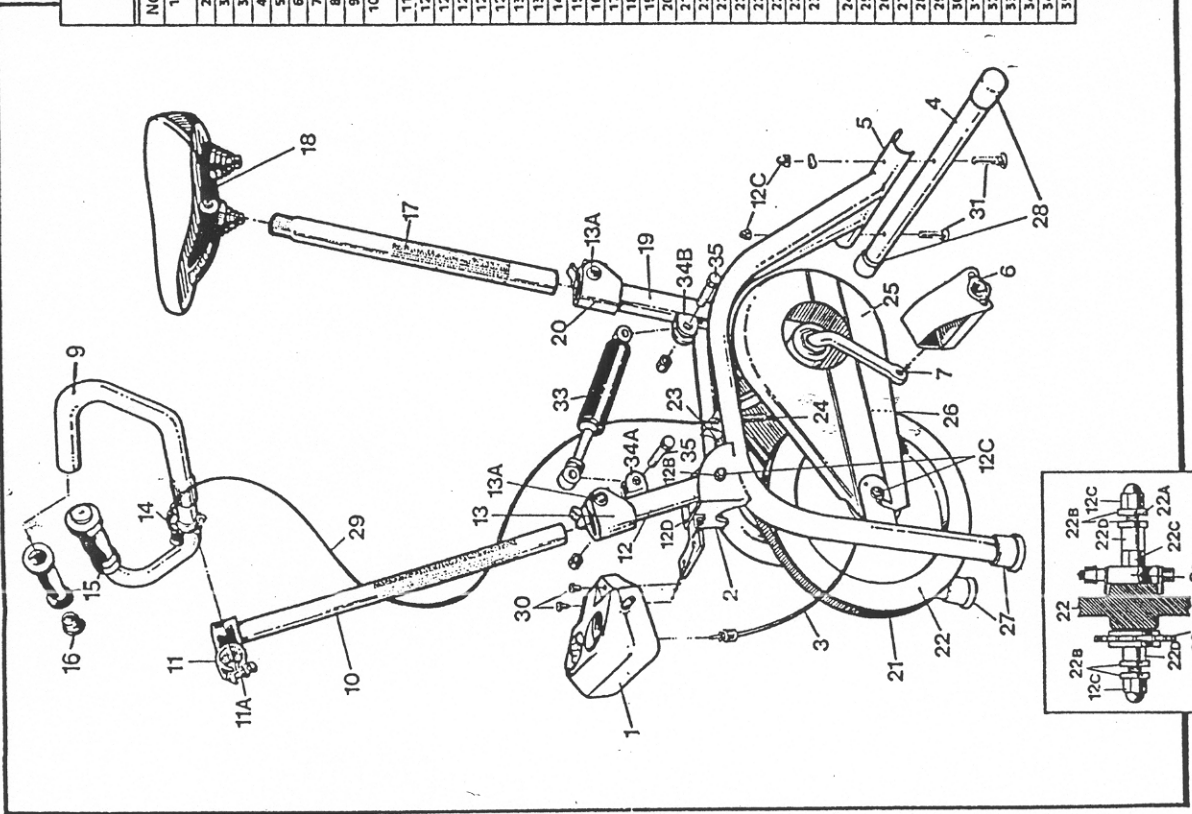
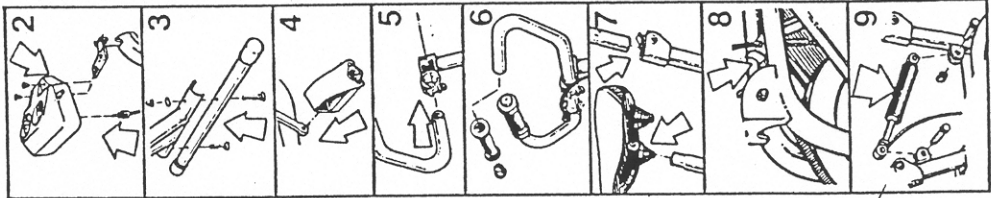

No.	Description	Quantity
1	Speedometer/Odometer and Timer Unit	1
2	Bike Frame	1
3	Speedometer Cable	1
3A	Speedometer Drive Gear	1
4	Crossbar	1
5	Rear Frame	1
6	Left Pedal	1
7	Crank w/Sprocket Wheel	1
8	Right Pedal	1
9	Curved Handlebar	1
10	Handlebar Post w/Handlebar Clamp (11)	1
11A	Clamp Bolt & Nut	1
12	Pivot Tube w/Plastic Bushing	1
12A	Pivot Axlebolt	1
12B	Washer Nut	2
12C	Cap Nut	6
12D	Stopper Bolt & Nut	1
13	Front Post Clamp	1
13A	Carriage Bolt & T. Wingnut	2
14	Tension/Resistance Control Lever	1
15	Hand Grip	2
16	Cap End	2
17	Seat Post	1
18	Seat	1
19	Back Tube w/Plastic Sleeve	1
20	Back Post Clamp	1
21	Nylon Tension Belt	1
22	Flywheel	1
22A	Flywheel Axlebolt	1
22B	Washer	4
22C	Nut	2
22D	Spacer	1
22E	Flywheel Sprocket Wheel	1
23	Belt Tension Buckle w/Mounting Screw	1
24	Spring Assembly	1
25	Left Chain Guard w/Screws	1
26	Right Chain Guard w/Screws	1
27	Front Plastic End Cap	2
28	Back Plastic End Cap	2
29	Tension Control Cable w/Cable Clip	1
30	Screw	2
31	Carriage Bolt & Washer	2
32	Chain	1
33	Hydraulic Shock	1
34A	Front Shock Bracket	1
34B	Rear Shock Bracket	1
35	Bolt and Nylon Locknut	2

PARTS LIST

Dual Action Chrome Bike #EB7712

PRODUCT NUMBER: EB7712
 VERSION NUMBER: EB7712

PRODUCT NAME: HORIZON
 FLYWHEEL EXERCISE BIKE
 DUAL ACTION

DATE: 03/06/91

KEY #	PART #	QTY.	DESCRIPTION
1	027005	1	SPEEDOMETER/TIMER UNIT
2	NSP	1	FRAME
3	026008	1	SPEEDOMETER CABLE
3A	028001	1	SPEEDOMETER DRIVE
4	006003	1	REAR STABILIZER BAR
5	NOT USED		
6	038001	1	LEFT PEDAL W/STRAP
7	QUESTION	1	CRANK DOES YOUR CRANK HAVE A SPIKE CONNECTING CRANK & SPROCKET? YES - 023021 NO - 023020
#		2	A 018001 BEARING
#		2	B 019003 BEARING CUP
#		1	C 012010 CRANK NUT 2-SLOT
#		1	D 012011 CRANK NUT 3-SLOT
#		1	E 012012 CRANK HEX NUT
#		1	F 014009 WASHER
#		1	G 014008 FLAT WASHER
8	038002	1	RIGHT PEDAL W/STRAP
9	001004	1	HANDLEBAR
10	007001	1	HANDLEBAR POST
11	NOT USED		
11A	013012	1	CARRIAGE BOLT
11B	012002	1	LOCK NUT
12	007004	1	PIVOTING POST
12A	013049	1	PIVOT BOLT
12B	012001	1	ACORN BOLT
12C	012008	2	ACORN NUT
12D	059001	1	RUBBER STOPPER
13	016001	1	HANDLEBAR POST CLAMP
14	072001	1	TENSION CONTROL LEVER/CABLE/SLEEVE
15	041001	2	HANDGRIP
16	040004	2	HANDLEBAR END CAP
17	007003	1	SEAT POST
18	042001	1	SEAT
18A	049003	1	SEAT CLAMP SHAFT
18B	014017	1	SEAT CLAMP WASHER
18C	012003	1	SEAT CLAMP NUT
19	NOT USED		
19A	019063	1	SEAT POST SLEEVE
20	016001	1	SEAT POST CLAMP
21	035002	1	NYLON TENSION BELT
22	021001	1	FLYWHEEL
A	049001	1	AXLE
B	014087	1	WASHER
C	012105	1	AXLE HEX NUT

PRODUCT NUMBER: EB7712
 VERSION NUMBER: EB7712

PRODUCT NAME: HORIZON
 FLYWHEEL EXERCISE BIKE
 DUAL ACTION

DATE: 03/06/91

KEY #	PART #	QTY.	DESCRIPTION
D	014004	1	BEVELED WASHER
E	024001	1	FREEWHEEL SPROCKET
F	QUESTION		SOME EB7711 & EB7712 BIKES USED A SMALLER FLYWHEEL AXLE BEARING AND SOME USED THE LARGER. THE QUESTION MAY BE ASKED, "WHAT IS THE OUTSIDE DIAMETER OF YOUR BEARINGS? LARGER - 018002, (7/8"). 87", 22 mm OD SMALLER -018003, 1.0", 26 mm OD
23	050001	1	TENSION BELT BUCKLE
23A	013035	1	BUCKLE BOLT
24	058028	1	SPRING ASSEMBLY
		1	012004
		2	012009
		1	013004
		1	013009
		1	014026
		1	058001
25	010001	2	LEFT & RIGHT CHAIN GUARD
26	SEE #25		RIGHT CHAIN GUARD
27	040001	2	FRONT END CAP
28	040006	2	REAR END CAP
29	SEE #14	1	TENSION CONTROL CABLE
29A	016003	1	CABLE CLIP
30	070044	2	ASSEMBLY (SET A)
		1	013110 BOLT
		1	014020 WASHER
31	070045	2	ASSEMBY (SET B)
		1	013011 BOLT
		1	014006 WASHER
		1	012001 ACORN NUT
32	025001	1	CHAIN (66 PINS)
33	043001	1	SHOCK
33A	019077	1	SHOCK BUSHING
34A	NOT USED		
34B	NOT USED		
35	070046	1	ASSEMBLY, NUT & BOLT
		1	013105 BOLT
		1	012002 NUT

PRODUCT NUMBER: EB7712
 VERSION NUMBER: EB7712

PRODUCT NAME: HORIZON
 FLYWHEEL EXERCISE BIKE
 DUAL ACTION

DATE: 03/06/91

KEY #	PART #	QTY.	DESCRIPTION
#	070078	1	AXLE ASSEMBLY
		1	028001 SPEEDOMETER DRIVE
		1	049001 AXLE
		2	019021 THIN AXLE SPACER
		2	012008 ACORN NUT
		2	012105 THICK NUT
		5	014015 WASHER
		1	019021 SPACER
		2	014004 BEVELED WASHER
		2	018002 BEARING
#	070081	1	CRANK ASSEMBLY
		1	014008 LARGE FLAT WASHER
		1	012011 3 KEYED CRANK NUT
		2	018001 BEARING
		1	012010 LARGE SLOTTED NUT
		1	014009 THIN WASHER
		1	012012 LARGE HEX NUT
#	046001	1	OWNER'S MANUAL
#	047001	1	ASSEMBLY INSTRUCTIONS