

IMAGETM 920

PERSONAL FITNESS SYSTEM

Model No. IM392012

Serial No. _____

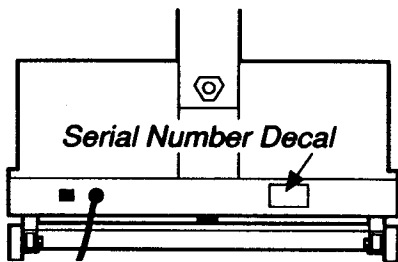

OWNER'S MANUAL

QUESTIONS?

As a manufacturer, we are committed to providing you complete customer satisfaction. If you have questions, or find there are missing or damaged parts, we will guarantee you complete satisfaction through direct assistance from our factory.

TO AVOID UNNECESSARY DELAYS, PLEASE CALL DIRECT TO OUR TOLL-FREE CUSTOMER HOT LINE.

The trained technicians on our Customer Hot Line will provide immediate assistance, free of charge to you.

CUSTOMER HOT LINE:

1-800-999-3756

Mon.-Fri., 6 a.m.-6 p.m. MST

CAUTION!

Read all safety precautions and instructions in this manual carefully before using this equipment. Save this manual for future reference.



LIMITED WARRANTY

Image, Inc. ("IMAGE"), warrants this product to be free from defects in workmanship and material, under normal use and service conditions, for a period of ninety (90) days from the date of purchase. This warranty extends only to the original purchaser. IMAGE's obligation under this warranty is limited to replacing or repairing, at IMAGE's option, the product at one of its authorized service centers. All products for which warranty claim is made must be received by IMAGE at one of its authorized service centers with all freight and other transportation charges prepaid, accompanied by sufficient proof of purchase. All returns must be pre-authorized by IMAGE. This warranty does not extend to any product or damage to a product caused by or attributable to freight damage, abuse, misuse, improper or abnormal usage or repairs not provided by an IMAGE authorized service center or for products used for commercial or rental purposes. No other warranty beyond that specifically set forth above is authorized by IMAGE.

IMAGE IS NOT RESPONSIBLE OR LIABLE FOR INDIRECT, SPECIAL OR CONSEQUENTIAL DAMAGES ARISING OUT OF OR IN CONNECTION WITH THE USE OR PERFORMANCE OF THE PRODUCT OR OTHER DAMAGES WITH RESPECT TO ANY ECONOMIC LOSS, LOSS OF PROPERTY, LOSS OF REVENUES OR PROFITS, LOSS OF ENJOYMENT OR USE, COSTS OF REMOVAL, INSTALLATION OR OTHER CONSEQUENTIAL DAMAGES OF WHATSOEVER NATURE. SOME STATES DO NOT ALLOW THE EXCLUSION OR LIMITATION OF INCIDENTAL OR CONSEQUENTIAL DAMAGES. ACCORDINGLY, THE ABOVE LIMITATION MAY NOT APPLY TO YOU.

THE WARRANTY EXTENDED HEREUNDER IS IN LIEU OF ANY AND ALL OTHER WARRANTIES AND ANY IMPLIED WARRANTIES OF MERCHANTABILITY OR FITNESS FOR A PARTICULAR PURPOSE IS LIMITED IN ITS SCOPE AND DURATION TO THE TERMS SET FORTH HEREIN. SOME STATES DO NOT ALLOW LIMITATIONS ON HOW LONG AN IMPLIED WARRANTY LASTS. ACCORDINGLY, THE ABOVE LIMITATION MAY NOT APPLY TO YOU.

This warranty gives you specific legal rights. You may also have other rights which vary from state to state.

IMAGE, INC., 1500 S. 1000 W., LOGAN, UT 84321-9813

IMAGETM 920

PERSONAL FITNESS SYSTEM

TABLE OF CONTENTS

Limited Warranty	2
Important Safety Precautions	4
Before You Begin	5
Assembly	6
Operation and Adjustment	7
Trouble-Shooting and Storage	10
Conditioning Guidelines	12
Part List	14
Exploded Drawing	15
Ordering Replacement Parts	Back Cover

WARNING: Before beginning this or any exercise program, consult your physician. This is especially important for persons over the age of 35 or persons with pre-existing health problems. Read all instructions before using. IMAGE assumes no responsibility for personal injury or property damage sustained by or through the use of this product.

IMPORTANT SAFETY PRECAUTIONS

WARNING: To reduce the risk of burns, fire, electric shock or injury to persons, read the following important safety precautions and information before operating the treadmill.

1. Position the treadmill on a level surface, with at least 8 feet of clearance behind the treadmill. Do not place the treadmill near water, outdoors or on a surface that may block any air opening. Do not operate where aerosol products are used or where oxygen is being administered.
2. Plug the power cord directly into a grounded circuit carrying 12 or more amps. No other appliances should be on the same circuit. (See the OPERATION AND ADJUSTMENT section of this manual for proper grounding instructions.) Keep the power cord away from heated surfaces. If an extension cord is required, use only a 14-gauge general-purpose cord of approximately five feet in length with a three-wire conductor.
3. Never move the walking belt while the power is turned off. Do not operate the treadmill if the power cord or plug is damaged, or if the treadmill is not working properly. (See the BEFORE YOU BEGIN section of this manual if the treadmill is not working properly.)
4. The roller guards must be 1/8 inch from the rear roller. Turn the power off and adjust the roller guards, if necessary.
5. Wear appropriate exercise attire when using the treadmill. Do not wear loose clothing that could become caught in the treadmill. *Always wear running shoes. Never use the treadmill with bare feet, wearing only stockings or in sandals.* Athletic support clothes are recommended for both men and women.
6. The pulse earclip is not a medical device. Various factors, including the user's movement while exercising, may affect the accuracy of heart rate readings. The earclip is intended only as an exercise aid in determining heart rate trends in general.
7. Never start the treadmill while you are standing on the walking belt. Always hold the handrail when exercising on the treadmill.
8. Use the treadmill only as described in this manual.
9. Keep small children away from the treadmill at all times. Never leave the treadmill unattended while it is running. Always turn the power off when the treadmill is not in use.
10. Never drop or insert any object into any opening.
11. Always unplug the power cord before performing the maintenance and adjustment procedures described in this manual. Never remove the motor hood unless instructed to do so by an authorized service representative. Servicing other than the procedures in this manual should be performed by an authorized service representative only.
12. To prevent overheating, do not operate the treadmill continuously for longer than 1 hour.
13. Never allow more than one person on the treadmill at a time. The treadmill should be used only by persons weighing 250 pounds or less.
14. The treadmill is capable of high speeds. Adjust the speed slowly to avoid sudden jumps in speed.

BEFORE YOU BEGIN

Thank you for selecting the IMAGE 920™ treadmill. The IMAGE 920 combines state-of-the-art technology with innovative design to let you enjoy an excellent form of cardiovascular exercise in the convenience and privacy of your home. Your exercise on the IMAGE 920 will be enhanced by such features as an oversized running surface, a key-activated power switch, electronic speed and incline control, and a multi-function exercise monitor.

For your safety and benefit, read this manual carefully before using this equipment. If you have additional questions, please call our Customer Service Department toll-free at **1-800-999-3756**, Monday through Friday, 6 a.m. until 6 p.m. Mountain Time (excluding holidays). To help us assist you, please mention your product model number and serial number when calling. The model number is printed on the front cover of this manual. The serial number can be found on a decal attached to the treadmill (see the drawing on the front cover).

Before reading further, please review the drawing below and familiarize yourself with the parts labeled.

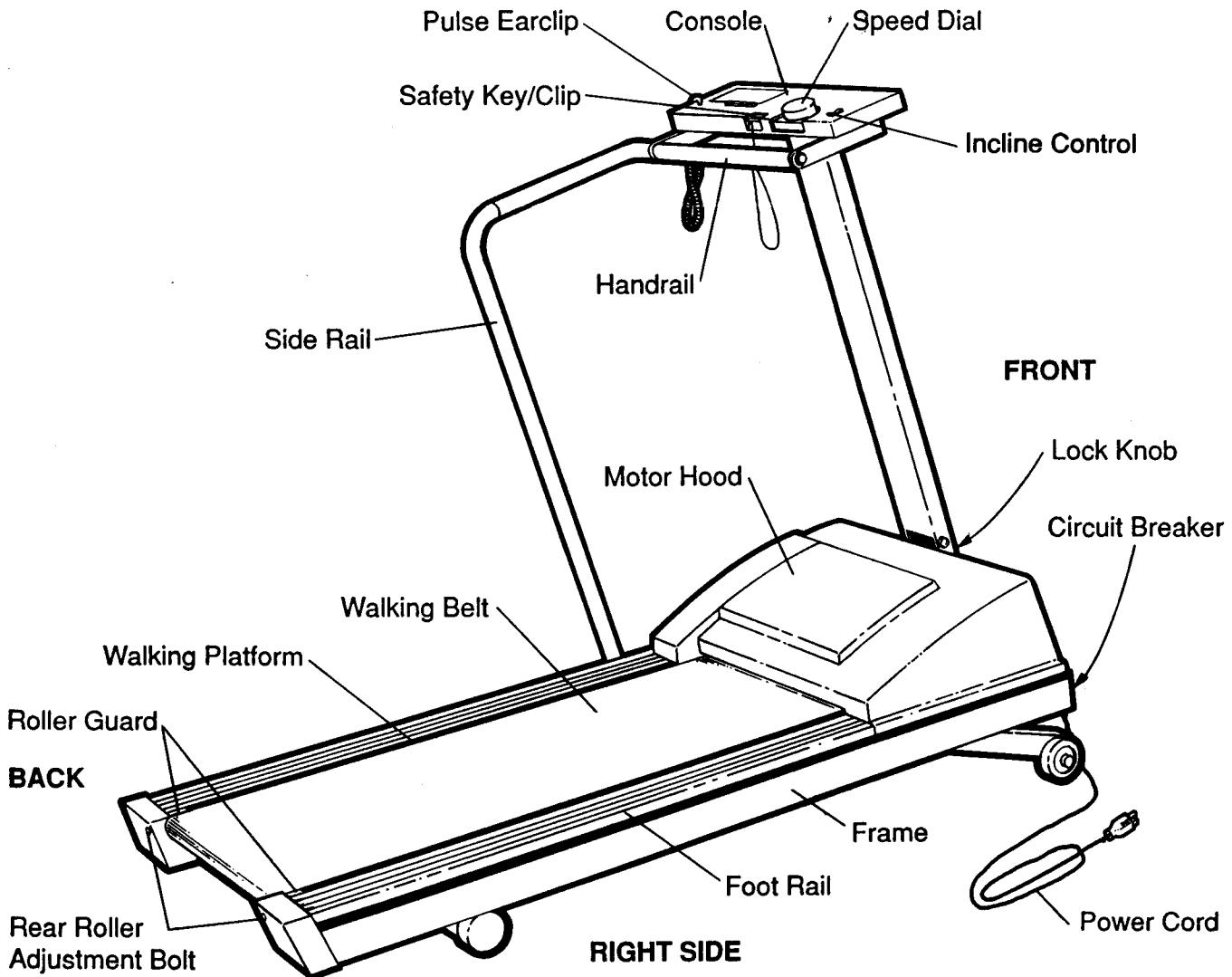

ASSEMBLY

Set the treadmill in a cleared area and remove all packing materials. **Be sure that all parts are included before disposing of the packing materials.**

1. Insert the Lock Knob (36), with the Lock Knob Washer (35), into the Upright Post (11). Raise the Upright Post to a vertical position. Turn the Lock Knob clockwise until it is almost tight. Leave a little play in the Upright Post for the following steps.

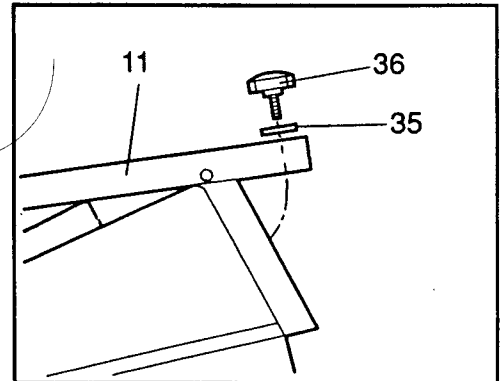

2. Align the upper end of the Side Rail (1) with the left end of the Handrail (12). Turn the Handrail in the direction shown to thread the Handrail into the Side Rail. (Note: If the Handrail will not turn easily, loosen the Handrail Bolt [10] slightly.) Tighten the Handrail and the Handrail Bolt.

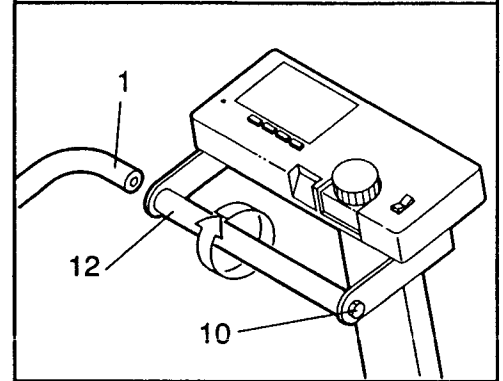

3. Align the lower end of the Side Rail (1) with the hole in the side of the treadmill Frame (62). Insert the Side Rail Bolt (75) through the Side Rail and Frame. Reach under the Frame and tighten the Side Rail Nut (76) onto the end of the Bolt. Tighten the Lock Knob (see step).

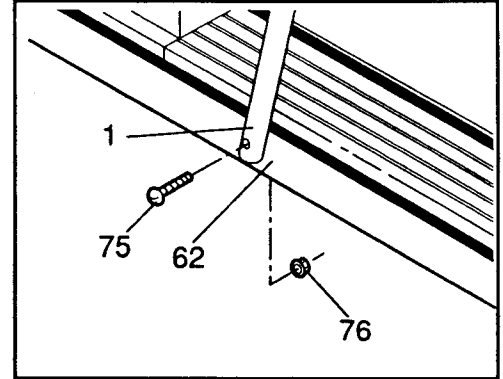

Make sure that all parts are tightened securely before using the treadmill.

OPERATION AND ADJUSTMENT

GROUNDING INSTRUCTIONS

This product must be grounded. If it should malfunction or break down, grounding provides a path of least resistance for electric current to reduce the risk of electric shock. This product is equipped with a cord having an equipment-grounding conductor and a grounding plug. **The plug must be plugged into an appropriate outlet that is properly installed and grounded in accordance with all local codes and ordinances.**

DANGER: Improper connection of the equipment-grounding conductor can result in a risk of electric shock. Check with a qualified electrician or serviceman if you are in doubt as to whether the product is properly grounded. Do not modify the plug provided with the product—if it will not fit the outlet, have a proper outlet installed by a qualified electrician.

This product is for use on a nominal 120-volt circuit, and has a grounding plug that looks like the plug illustrated in Drawing 1.

A temporary adapter that looks like the adapter illustrated in Drawing 2 may be used to connect this plug to a 2-pole receptacle as shown in Drawing 2 if a properly grounded outlet is not available. The temporary adapter should be used only until a properly grounded outlet (Drawing 1) can be installed by a qualified electrician. The green colored rigid ear, lug, or the like extending from the adapter **must be connected to a permanent ground such as a properly grounded outlet box cover.** Whenever the adapter is used it **must be held in place by a metal screw.**

Some 2-pole receptacle outlet box covers are not grounded. Contact a qualified electrician to determine if the outlet box cover is grounded before using an adapter.

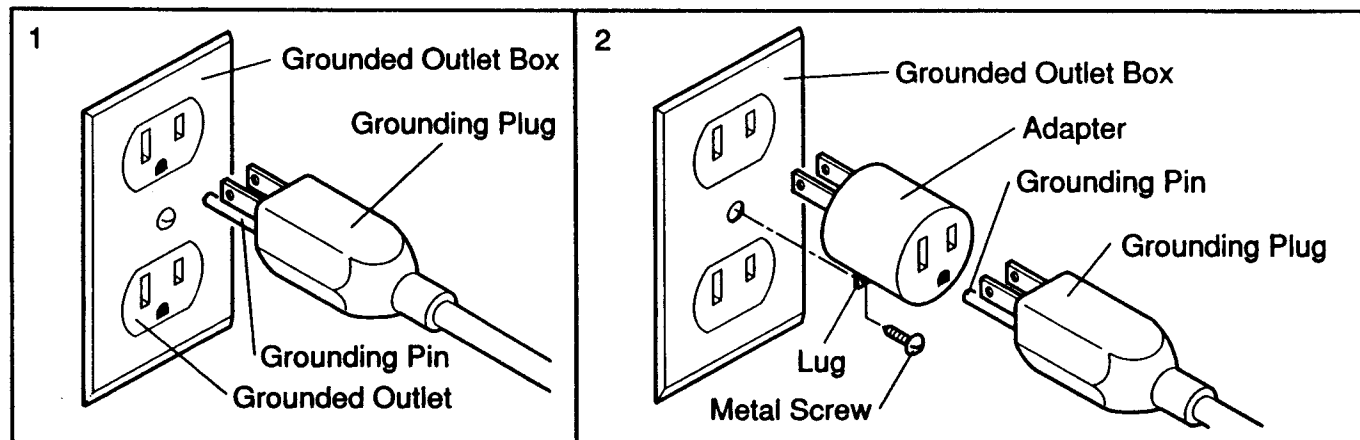

MAINTENANCE-FREE WALKING PLATFORM

This treadmill features a walking platform coated with a specially-designed hydrocarbon slip agent. **Do not apply silicone spray or any other substances to the walking platform or the walking belt.** Such substances will deteriorate the surface of the walking platform and cause excessive wear.

Walk on the treadmill for 10 minutes to break in the walking platform. During this break-in period, it is normal for the walking belt to slow.

DIAGRAM OF THE CONSOLE

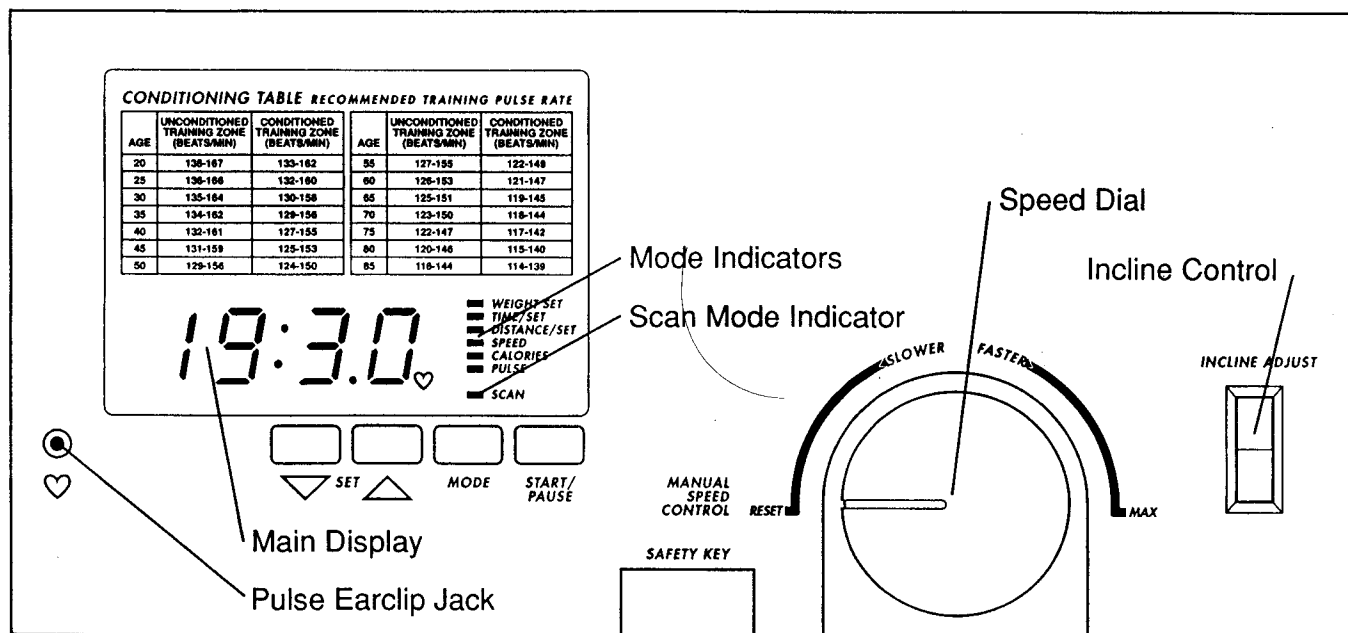

SET BUTTONS—These buttons are used to set time and distance goals, and to enter your weight into the console.

MODE BUTTON—This button is used to select monitor modes.

START/PAUSE BUTTON—This button starts and stops the console. The mode indicators will flash when the console is stopped.

SPEED DIAL—This dial is used to control the speed of the walking belt.

INCLINE CONTROL—This switch is used to control the incline of the treadmill.

TURNING ON THE POWER

Stand on the foot rails of the treadmill. Attach the clip on the safety key to the waistband of your clothing. Insert the safety key into the slot in the front of the console. **WARNING: Always wear the clip when operating the treadmill. If you fall while exercising, the safety key will be pulled from the console, instantly turning off the power. IMPORTANT: After inserting the key, wait for 3 seconds before operating the console.**

ADJUSTING THE INCLINE

To vary the intensity of your exercise, the incline of the treadmill can be changed using the incline control on the right side of the console. To increase the incline, press the end of the switch farthest from you. To decrease the incline, press the end of the switch closest to you.

ADJUSTING THE SPEED

When the power is turned on, the console will be stopped and the walking belt will be stationary. To start the walking belt, first turn the speed dial to the reset position. Next, turn the dial clockwise until the walking belt begins to move at slow speed. Step carefully onto the walking belt and begin exercising. Change the speed of the walking belt as desired by turning the dial. To stop the walking belt, turn the dial to the reset position.

The walking belt can also be stopped by pressing the START/ PAUSE button. This will stop the console. To start the walking belt after the console has been stopped, turn the speed dial to the reset position, press the START/PAUSE button, and then turn the dial clock-wise until the walking belt begins to move. **IMPORTANT: Each time the walking belt is stopped, the speed dial must be turned to the reset position before the walking belt can be restarted.**

SELECTING MONITOR MODES

The console features seven monitor modes to give you instant feedback as you exercise. When the power is turned on, the SCAN mode will be selected automatically. In the SCAN mode, the TIME/SET, DISTANCE/SET, SPEED, CALORIES and PULSE modes will all be displayed in a repeating cycle. (Note: The PULSE mode will be displayed only if the pulse earclip is worn [see PULSE below].) Individual modes can be selected by pressing the MODE button. Indicators will light to show which mode you have selected. The display can be reset to zero, if desired, by removing the safety key and then reinserting it. The seven modes are described below:

SCAN: This mode automatically displays all other modes, except WEIGHT SET, in a repeating cycle. Note: The PULSE mode will be displayed only if the pulse earclip is worn (see PULSE below).

WEIGHT SET: Before selecting the CALORIES mode, select the WEIGHT SET mode and press the SET buttons to enter your weight into the console. Each time one of the buttons is pressed, the weight displayed will change by 5 pounds. The buttons can be held down to enter your weight quickly.

TIME/SET: This mode displays the elapsed time. This mode also allows time goals to be set. To set a time goal, first select the TIME/SET mode. (A goal cannot be set while the SCAN mode is selected.) Press the SET buttons to set the length of time you plan to exercise. Each time one of the buttons is pressed, the time displayed will change by 10 seconds. The buttons can be held down to set a time goal quickly. When the console is started, the time will be counted down. When the time goal is completed, the console and the walking belt will stop.

DISTANCE/SET: This mode displays the distance you have traveled. This mode also allows distance goals to be set. To set a distance goal, first select the DISTANCE/SET mode. (A goal cannot be set while the SCAN mode is selected.) Press the SET buttons to set the distance you plan to travel. Each time one of the buttons is pressed, the distance displayed will change by 0.1 mile. The buttons can be held down to set a distance goal quickly. The distance will be counted down as you exercise. When the distance goal is completed, the console and the walking belt will stop.

SPEED: This mode displays the speed of the walking belt.

CALORIES: This mode displays the number of Calories you have burned. For accuracy, first select the WEIGHT SET mode, and enter your weight into the console.

PULSE: This mode displays your heart rate during your workout (your heart rate must be at least 70 beats per minute to be displayed). Plug the pulse earclip into the jack on the console, and attach the earclip to your left ear lobe. Slide the clothes clip onto your collar to prevent excessive movement of the earclip wire. If your heart rate is not displayed after a few seconds, rub your ear lobe and reposition the earclip.

TURNING OFF THE POWER

Stand on the foot rails. Remove the safety key from the console. **WARNING: Always remove the safety key when you are finished exercising.**

TROUBLE-SHOOTING AND MAINTENANCE

Most treadmill problems can be solved by following the simple steps below. If further assistance is needed, please call our Customer Service Department toll-free at 1-800-999-3756, Monday through Friday, 6 a.m. until 6 p.m. Mountain Time (excluding holidays).

1. SYMPTOM: THE POWER DOES NOT TURN ON

- a. Make sure the power cord is plugged into a properly grounded outlet. (See OPERATION AND ADJUSTMENT in this manual.) If an extension cord is necessary, use only a 14-gauge general-purpose cord of approximately five feet in length.
- b. Make sure the safety key is fully inserted into the console. Various indicators on the console should light. (See OPERATION AND ADJUSTMENT in this manual.)
- c. Check the circuit breaker located on the treadmill frame near the power cord. If the switch protrudes as shown, the circuit breaker has tripped. To reset the circuit breaker, wait for five minutes and then press the switch back in.

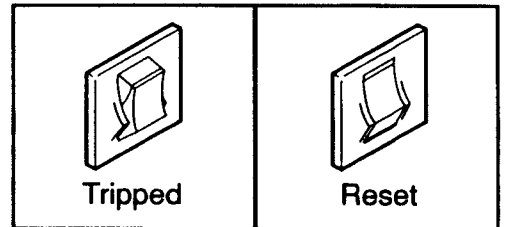

2. SYMPTOM: THE POWER TURNS OFF DURING USE

- a. Check the circuit breaker located on the treadmill frame near the power cord. If the switch protrudes, the circuit breaker has tripped. To reset the circuit breaker, wait for five minutes and then press the switch back in. (See the drawing above.)
- b. Make sure the power cord is plugged in.
- c. Remove the safety key from the console. Wait for 3 seconds and then reinsert the safety key fully into the console. Various indicators on the console should light.

3. SYMPTOM: THE PULSE EARCLIP DOES NOT FUNCTION PROPERLY

- a. Make sure the pulse earclip is plugged fully into the jack on the console. Attach the clothes clip to your collar.
- b. Rub your left ear lobe and reposition the earclip.
- c. Try standing still while measuring your pulse. **WARNING: The pulse earclip is not a medical device. Various factors, including the user's movement while exercising, may affect the accuracy of heart rate readings. The earclip is intended only as an exercise aid in determining heart rate trends in general.**
- d. The pulse earclip may need to be cleaned. Press the earclip open, and wipe the two clear circles inside the earclip, using a cotton swab saturated with denatured alcohol.

4. SYMPTOM: THE WALKING BELT SLOWS WHEN WALKED ON

- a. The walking platform has a break-in period of 5 to 10 minutes. During this period a drop in speed is normal.
- b. If an extension cord is necessary, use only a 14-gauge general-purpose cord of approximately five feet in length.

- c. If the walking belt is overtightened, treadmill performance may be reduced and the walking belt permanently damaged. **TURN THE POWER OFF.** Turn both rear roller adjustment bolts counterclockwise, 1/4 of a turn. Repeat until the tension of the walking belt is correct. When the tension is correct, you should be able to lift each side of the walking belt 3-4 inches off the walking platform. The center of the walking belt should remain just at the surface of the walking platform. Be careful to keep the walking belt centered on the walking platform.

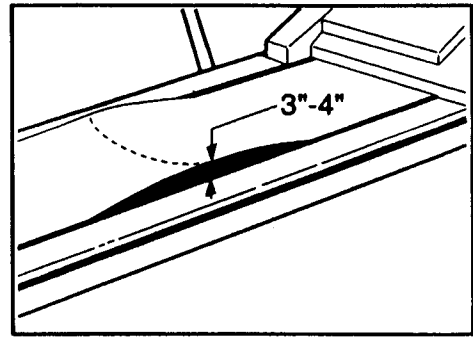

5. SYMPTOM: THE WALKING BELT IS OFF-CENTER OR SLIPS WHEN WALKED ON

- a. If the walking belt has shifted to the left, first **TURN THE POWER OFF.** Turn the left rear roller adjustment bolt clockwise, and the right bolt counterclockwise, 1/4 of a turn each. Repeat as necessary until the walking belt is centered.

- b. If the walking belt has shifted to the right, first **TURN THE POWER OFF.** Turn the left rear roller adjustment bolt counterclockwise, and the right bolt clockwise, 1/4 of a turn each. Repeat as necessary until the walking belt is centered.

- c. If the walking belt slips when walked on, first **TURN THE POWER OFF.** Turn both rear roller adjustment bolts clockwise, 1/4 of a turn. Repeat as necessary until the tension of the walking belt is correct. When the tension is correct, you should be able to lift each side of the walking belt 3-4 inches off the walking platform. The center of the walking belt should remain just at the surface of the walking platform. Be careful to keep the walking belt centered on the walking platform.

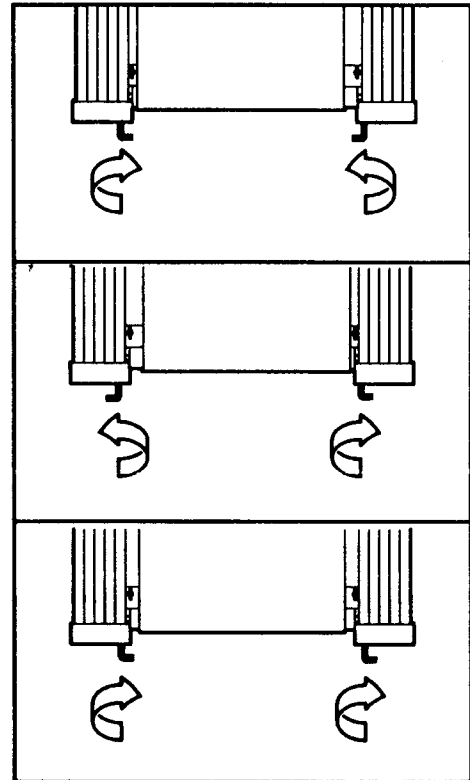

STORAGE

Always unplug the power cord when the treadmill is not in use. To convert the treadmill to the storage position, first remove the bolt and nut from the lower end of the side rail. Keep the bolt and nut in a secure location. Remove the side rail from the handrail. Loosen the lock knob and lower the upright post onto the walking belt. Lay the side rail on the treadmill.

CONDITIONING GUIDELINES

The following guidelines will help you to plan your exercise program. Remember that proper nutrition and adequate rest are essential for successful results. **WARNING: Before beginning this or any exercise program, consult your physician. This is especially important for individuals over the age of 35 or individuals with pre-existing health problems.**

EXERCISE INTENSITY

To maximize the benefits of exercising, it is important to exercise with the proper intensity. The proper intensity can be found by using your heart rate as a guide. For effective aerobic exercise, your heart rate should be maintained at a level between 70% and 85% of your maximum heart rate as you exercise. This is known as your training zone. You can find your training zone in the table below. Training zones are listed for both unconditioned and conditioned persons according to age.

AGE	UNCONDITIONED TRAINING ZONE (BEATS/MIN)	CONDITIONED TRAINING ZONE (BEATS/MIN)	AGE	UNCONDITIONED TRAINING ZONE (BEATS/MIN)	CONDITIONED TRAINING ZONE (BEATS/MIN)
20	138-167	133-162	55	127-155	122-149
25	136-166	132-160	60	126-153	121-147
30	135-164	130-158	65	125-151	119-145
35	134-162	129-156	70	123-150	118-144
40	132-161	127-155	75	122-147	117-142
45	131-159	125-153	80	120-146	115-140
50	129-156	124-150	85	118-144	114-139

During the first few months of your exercise program, keep your heart rate near the low end of your training zone as you exercise. After a few months of regular exercise, your heart rate can be increased gradually until it is near the middle of your training zone as you exercise. You can measure your heart rate using the pulse mode of the console. Exercise for at least four minutes, and then measure your heart rate immediately. If your heart rate is too high, decrease the intensity of your exercise. If your heart rate is too low, increase the intensity of your exercise. **WARNING: The pulse earclip is not a medical device. Various factors, including your movement during exercise, may affect the accuracy of heart rate readings. The earclip is intended only as an exercise aid in determining heart rate trends in general.**

WORKOUT GUIDELINES

Each workout should consist of three basic parts: a warm-up, 20 to 30 minutes of training zone exercise, and a cool-down. Warming up prepares the body for exercise by increasing circulation, delivering more oxygen to the muscles and raising the body temperature. Begin each workout with 5 to 10 minutes of stretching and light exercise to warm up. Then, increase the intensity of your exercise to raise your heart rate to your training zone for 20 to 30 minutes. Breathe regularly and deeply as you exercise—never hold your breath. Finish each workout with 5 to 10 minutes of stretching to cool down. This will increase the flexibility of your muscles as well as help to decrease soreness and other post-exercise problems.

To maintain or improve your condition, complete three workouts each week, with at least one day of rest between workouts. After a few months of regular exercise, you may complete up to five workouts each week, if desired. The key to success is **CONSISTENCY**.

SUGGESTED STRETCHES

The following stretches can provide a good warm-up or cool-down. Correct form for each stretch is shown in the drawings below. Move slowly as you stretch—never bounce.

TOE TOUCH STRETCH

Stand with your knees bent slightly and slowly bend forward from your hips. Allow your back and shoulders to relax as you reach down toward your toes as far as possible. Hold for 15 counts, then relax. Repeat 3 times.

Stretches: Hamstrings, back of knees and back.

HAMSTRING STRETCH

Sit with one leg extended. Bring the sole of the opposite foot toward you and rest it against the inner thigh of your extended leg. Reach toward your toes as far as possible. Hold for 15 counts, then relax. Repeat 3 times for both legs.

Stretches: Hamstrings, lower back and groin.

CALF/ACHILLES STRETCH

With one leg in front of the other, reach forward and place your hands against a wall. Keep your back leg straight and your back foot flat on the floor. Bend your front leg, lean forward and move your hips toward the wall. Hold for 15 counts, then relax. Repeat 3 times for both legs. To cause further stretching of the achilles tendons, bend your back leg as well.

Stretches: Calves, achilles tendons and ankles.

QUADRICEPS STRETCH

With one hand against a wall for balance, reach back and grasp one foot with your other hand. Bring your heel as close to your buttocks as possible. Hold for 15 counts, then relax. Repeat 3 times for both legs.

Stretches: Quadriceps and hip muscles.

INNER THIGH STRETCH

Sit with the soles of your feet together and your knees outward. Pull your feet toward your groin area as far as possible. Hold for 15 counts, then relax. Repeat 3 times.

Stretches: Quadriceps and hip muscles.

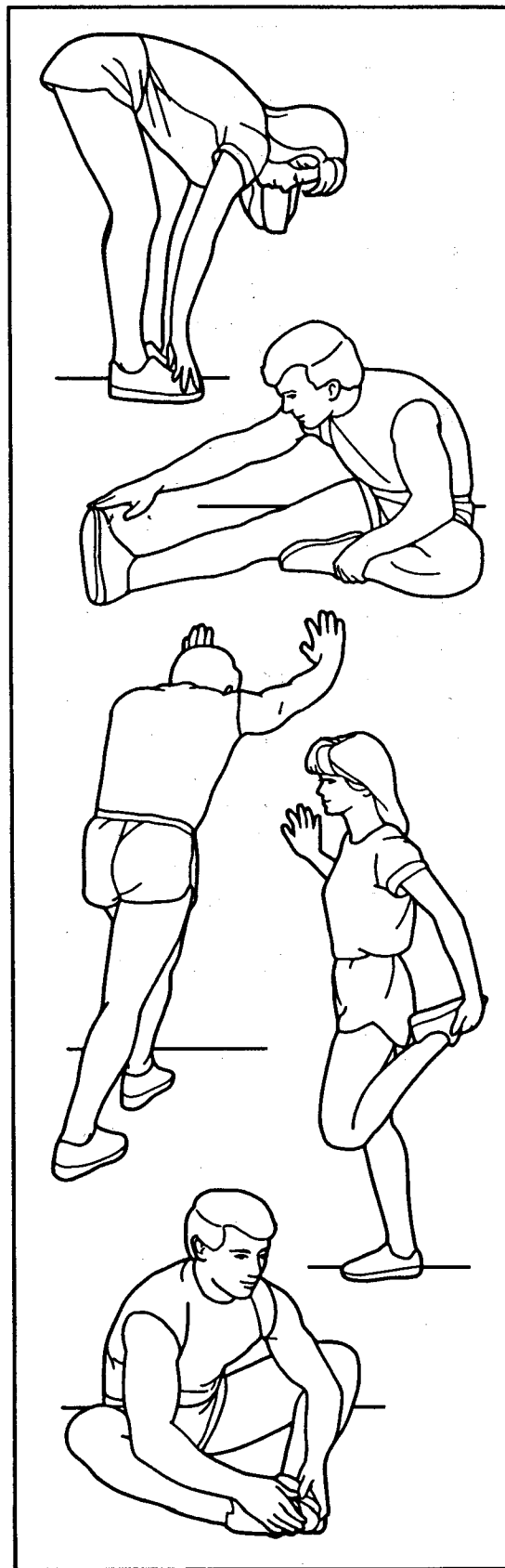

PART LIST—Model No. IM392012

Rev. 10/92

Key No.	Qty.	Description	Key No.	Qty.	Description
1	1	Side Rail w/Foam Grip	43	12	Plastic Clip
2	2	Foam Grip	44	2	Front Wheel
3	1	Console	45	3	Wheel Bolt/Incline Motor Bolt
4	26	Screw	46	1	Incline Leg
5	1	Speed Dial	47	2	Leg Bolt
6	1	Clothes Clip	48	2	U-Nut
7	1	Incline Control	49	1	Right Foot Rail
8	1	Bezel	50	1	Controller
9	1	Pulse Earclip	51	1	Choke
10	1	Handrail Bolt	52	3	Adjustment Washer
11	1	Upright Post	53	1	Swivel Bolt
12	1	Handrail/Foam Grip	54	1	Front Roller Adjustment Bolt
13	1	Safety Key/Clip	55	1	J-Bolt
14	1	Push Nut	56	1	Safety Cover
15	1	Incline Motor	57	1	Swivel Nut
16	6	Platform Clamp Bushing	58	1	Front Roller/Pulley
17	6	Small Bushing	59	6	Platform Screw
18	1	Flywheel	60	1	Walking Belt
19	4	Motor Mount Washer	61	1	Walking Platform
20	4	Motor Mount Nut	62	1	Frame
21	1	Motor	63	2	Rear Leg Endcap
22	1	Fan	64	6	Rear Leg Screw/Guard Screw
23	1	Motor Pulley	65	1	Right Endcap
24	3	Motor Mount Bolt	66	1	Allen Wrench
25	1	Motor Mount Bracket	67	2	Rear Roller Adjustment Bolt
26	1	Lower Motor Pin	68	1	Wrench Clip
27	1	Cotter Pin	69	1	Rear Roller
28	1	Incline Motor Spacer	70	2	Roller Guard
29	1	Power Supply Plate	71	2	High Density Foam
30	1	Power Supply	72	1	Left Endcap
31	4	Plastic Stand-off	73	1	Left Foot Rail
32	3	Wire Clip	74	1	Motor Hood w/Decal
33	6	Platform Clamp	75	1	Side Rail Bolt
34	4	Locknut	76	1	Side Rail Nut
35	1	Lock Knob Washer	77	4	Hood Mount Anchor
36	1	Lock Knob	78	1	Magnet
37	1	Pivot Bolt	79	1	Front Roller Insert
38	2	Washer	80	1	Reed Switch/Sensor Wire
39	1	Star Washer	81	2	Endcap Screw
40	1	Grommet	82	1	Belt
41	1	Power Cord	#	1	Owner's Manual
42	1	Circuit Breaker			

Note: "#" indicates a non-illustrated part. Specifications are subject to change without notice. See the back cover for information about ordering replacement parts.

EXPLODED DRAWING—Model No. IM392012

Rev. 10/92

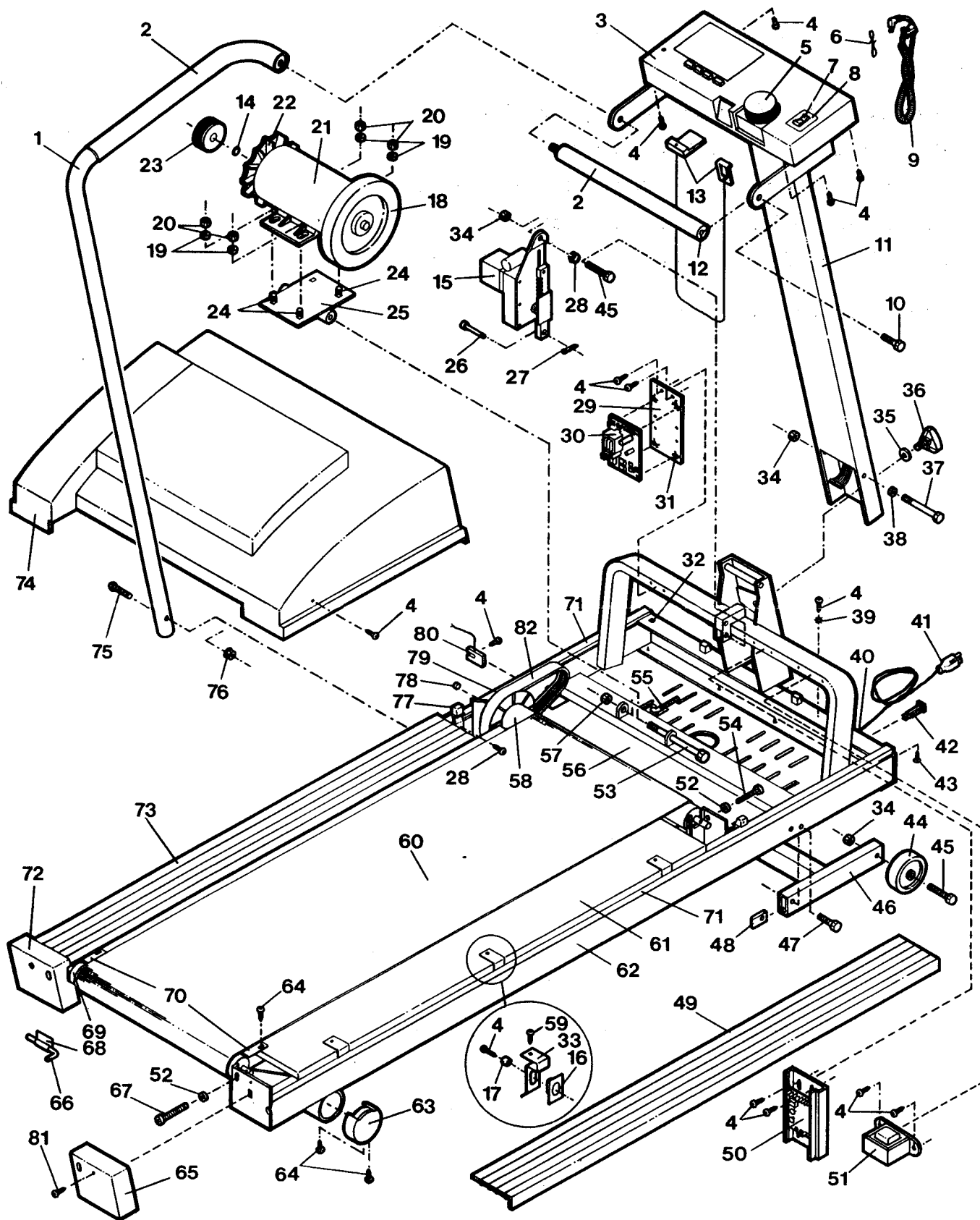

ORDERING REPLACEMENT PARTS

To order replacement parts, call our Customer Service Department toll-free at 1-800-999-3756, Monday through Friday, 6 a.m. until 6 p.m. Mountain Time (excluding holidays). When ordering parts, please be prepared to give the following information:

1. The MODEL NUMBER of the product (IM392012).
2. The NAME of the product (IMAGE 920™ treadmill).
3. The SERIAL NUMBER of the product (see the front cover of this manual).
4. The KEY NUMBER of the part(s) from page 14 of this manual.
5. The DESCRIPTION of the part(s) from page 14 of this manual.

If possible, place the treadmill near your telephone for easy reference when calling.