

JCS60664

WESLO® **EPIC 10pi**™ FITNESS

0-10 MPH • POWER INCLINE • PROGRAMMABLE SPEED • 26" WIDE BODY FRAME
1.5 HORSEPOWER DC MOTOR • CUSHION DECK • MADE IN THE U.S.A.

Model No. WL401523
Serial No. _____

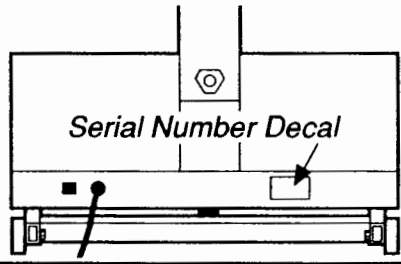

QUESTIONS?

As a manufacturer, we are committed to providing you complete customer satisfaction. If you have questions, or find there are missing or damaged parts, we will guarantee you complete satisfaction through direct assistance from our factory. TO AVOID UNNECESSARY DELAYS, PLEASE CALL DIRECT TO OUR TOLL-FREE CUSTOMER HOT LINE.

The trained technicians on our Customer Hot Line will provide immediate assistance, free of charge to you.

CUSTOMER HOT LINE:
1-800-999-3756
Mon.-Fri., 6 a.m.-6 p.m. MST

CAUTION:

Read all safety precautions and instructions in this manual carefully before using this equipment. Save this manual for future reference.

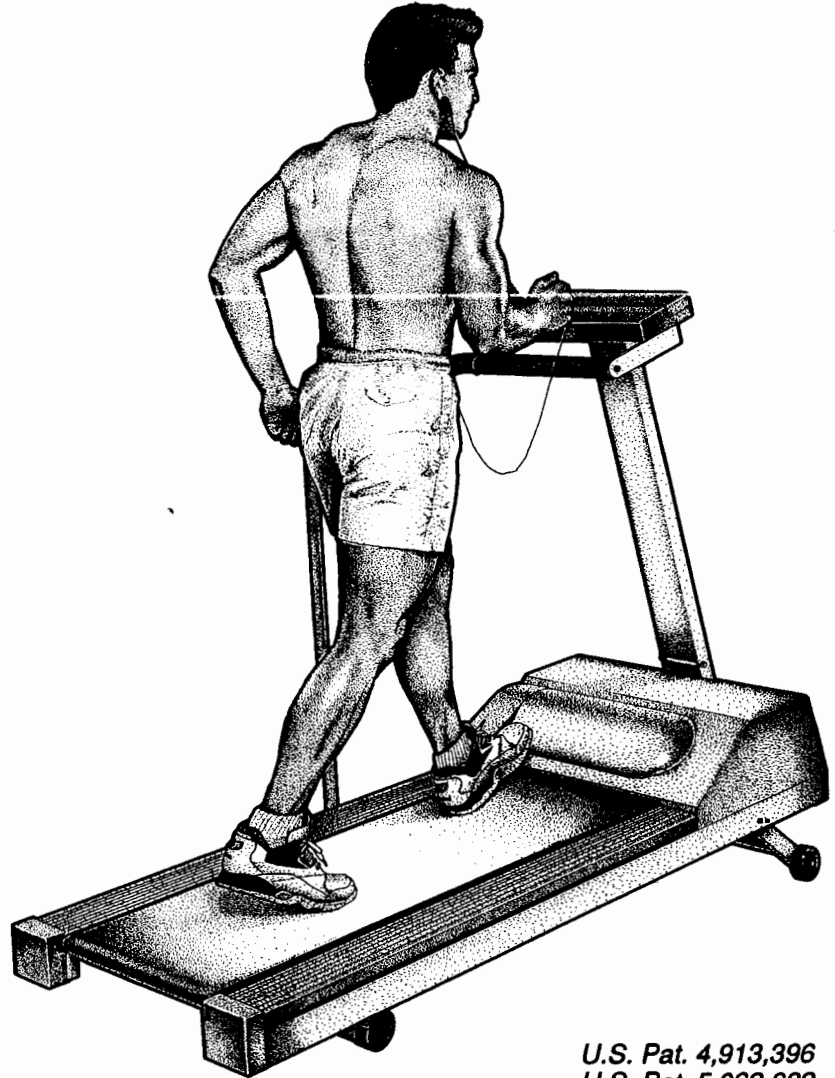

U.S. Pat. 4,913,396
U.S. Pat. 5,062,632
U.S. Pat. 4,918,266
U.S. Pat. Des. 316,124

OWNER'S MANUAL

WESLO®

EPIC 10pi™

FITNESS

0-10 MPH • POWER INCLINE • PROGRAMMABLE SPEED • 26" WIDE BODY FRAME
1.5 HORSEPOWER DC MOTOR • CUSHION DECK • MADE IN THE U.S.A.

TABLE OF CONTENTS

Important Safety Precautions	3
Before You Begin	4
Assembly	5
Operation and Adjustment	6
Trouble-Shooting and Maintenance	10
Conditioning Guidelines	13
Part List	14
Exploded Drawing	15
Ordering Replacement Parts	Back Cover
Warranty	Back Cover

WARNING: Before beginning this or any exercise program, consult your physician. This is especially important for persons over the age of 35 or persons with pre-existing health problems. Read all instructions before using. WESLO assumes no responsibility for personal injury or property damage sustained by or through the use of this product.

IMPORTANT SAFETY PRECAUTIONS

WARNING: To reduce the risk of burns, fire, electric shock or injury to persons, read the following important safety precautions and Information before operating the treadmill.

1. Position the treadmill on a level surface, with at least 8 feet of clearance behind the treadmill. Do not place the treadmill near water, outdoors or on a surface that blocks any air opening. Do not operate where aerosol products are used or where oxygen is being administered.
2. When connecting the power cord (see OPERATION AND ADJUSTMENT in this manual), plug the power cord directly into a grounded circuit capable of carrying 12 or more amps. No other appliances should be on the same circuit. Keep the power cord away from heated surfaces. If an extension cord is needed, use only a 14-gauge general-purpose cord of five feet or less in length with a three-wire conductor.
3. Never move the walking belt while the power is turned off. Do not operate the treadmill if the power cord or plug is damaged, or if the treadmill is not working properly. (See the BEFORE YOU BEGIN section of this manual if the treadmill is not working properly.)
4. The roller guards must be 1/8 inch from the rear roller. Turn the power off and adjust the roller guards, if necessary.
5. Wear appropriate exercise attire when using the treadmill. Do not wear loose clothing that could become caught in the treadmill. *Always wear running shoes. Never use the treadmill with bare feet, wearing only stockings or in sandals.* Athletic support clothes are recommended for both men and women.
6. The pulse earclip is not a medical device. Various factors, including the user's movement while exercising, may affect the accuracy of heart rate readings. The earclip is intended only as an exercise aid in determining heart rate trends in general.
7. Never start the treadmill while you are standing on the walking belt. Always hold the handrail when exercising on the treadmill.
8. Use the treadmill only as described in this manual.
9. Keep small children away from the treadmill at all times. Never leave the treadmill unattended while it is running. Always turn the power off when the treadmill is not in use.
10. Never drop or insert any object into any opening.
11. Always unplug the power cord before performing the maintenance and adjustment procedures described in this manual. Never remove the motor hood unless instructed to do so by an authorized service representative. Servicing other than the procedures in this manual should be performed by an authorized service representative only.
12. To reduce the possibility of overheating, do not operate the treadmill continuously for longer than 1 hour.
13. Never allow more than one person on the treadmill at a time. The treadmill should be used only by persons weighing 250 pounds or less.
14. The treadmill is capable of high speeds. Adjust the speed slowly to avoid sudden jumps in speed.

SAVE THESE INSTRUCTIONS

BEFORE YOU BEGIN

Thank you for selecting the WESLO® EPIC 10pi treadmill. The EPIC 10pi combines state-of-the-art technology with innovative design to let you enjoy an excellent form of cardiovascular exercise at your convenience, in the privacy of your home. The heart of the EPIC 10pi is the innovative EPIC™ console, offering an impressive array of features to help you get the most from your exercise.

For your safety and benefit, read this manual carefully before using the treadmill. If you have additional questions, please call our Customer Service Department toll-free at **1-800-999-3756**, Monday through Friday, 6 a.m. until 6 p.m. Mountain Time (excluding holidays). To help us assist you, please note the product model number and serial number before calling. The model number can be found on the front cover of this manual. The serial number can be found on a decal attached to the treadmill (see the drawing on the front cover for the location).

Before reading further, please review the drawing below and familiarize yourself with the parts that are labeled.

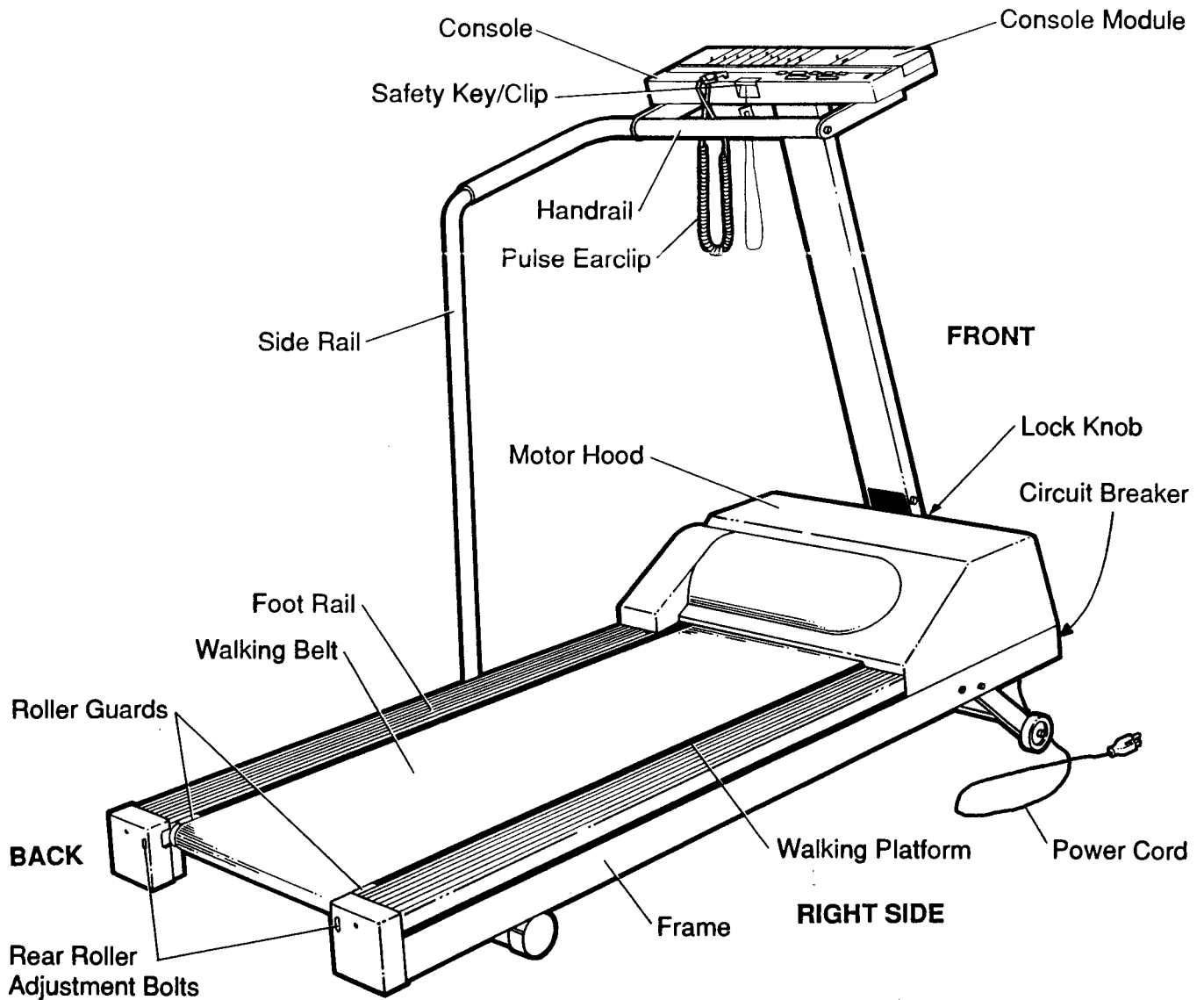

ASSEMBLY

Set the treadmill in a cleared area and remove all packing materials. Do not dispose of the packing materials until assembly is completed. **Assembly requires an 8" adjustable wrench and a standard screwdriver (not included).**

1. Remove the cardboard tube from the Lock Knob (31), and slide the Lock Knob Washer (30) onto the Lock Knob. Raise the Upright Post (9) to a vertical position. **Be careful not to pinch your fingers.** Insert the Lock Knob into the Upright Post and turn the Knob clockwise until it is almost tight. Leave a little play in the Upright Post for the following steps.

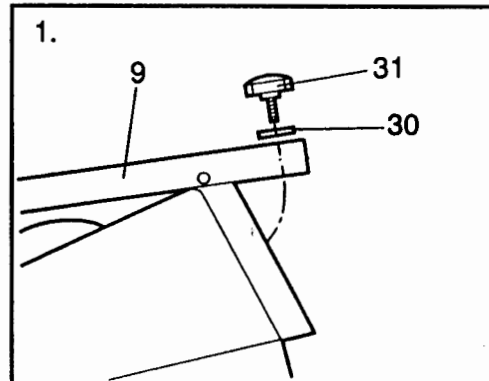

2. Align the upper end of the Side Rail (1) with the left end of the Handrail (10). Turn the Handrail in the direction shown to thread the Handrail into the Side Rail. (Note: If the Handrail will not turn easily, loosen the Handrail Bolt [7] slightly.) Tighten the Handrail and the Handrail Bolt.

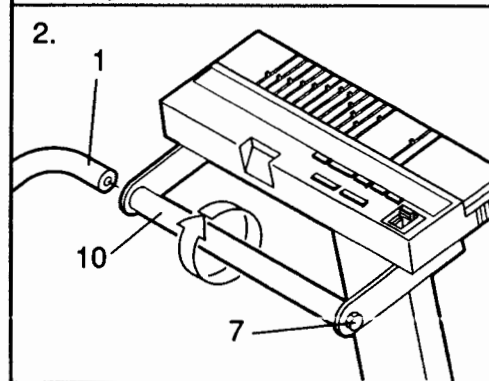

3. Align the lower end of the Side Rail (1) with the hole in the side of the treadmill Frame (54). Insert the Side Rail Bolt (81) through the Side Rail and Frame. Reach under the Frame and tighten the Side Rail Nut (82) onto the end of the Bolt. Tighten the Lock Knob (see step 1).

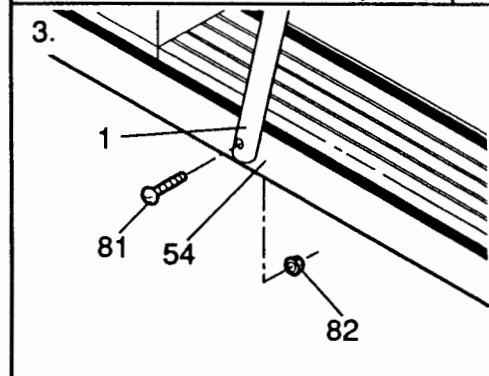

4. Remove the backing from the Wrench Clip (74), and press it onto the Right Endcap (72) in the indicated location. Press the Allen Wrench (73) into the Wrench Clip.

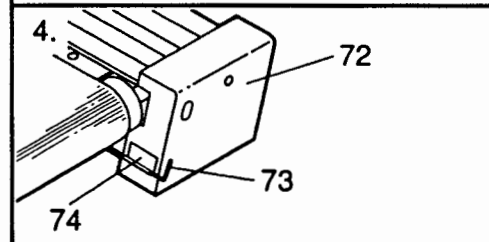

5. Slide the metal Clothes Clip (4) onto the Pulse Earclip (5) in the indicated location. The use of the Pulse Earclip is explained in SELECTING MONITOR MODES on page 9.

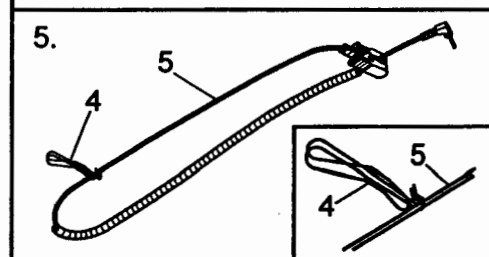

Make sure that all parts are tightened securely before using the treadmill.

OPERATION AND ADJUSTMENT

PLUGGING THE POWER CORD IN

This product must be grounded. If it should malfunction or break down, grounding provides a path of least resistance for electric current to reduce the risk of electric shock. This product is equipped with a cord having an equipment-grounding conductor and a grounding plug. **Plug the power cord into an appropriate outlet that is properly installed and grounded in accordance with all local codes and ordinances.**

DANGER: Improper connection of the equipment-grounding conductor can result in a risk of electric shock. Check with a qualified electrician or serviceman if you are in doubt as to whether the product is properly grounded. Do not modify the plug provided with the product—if it will not fit the outlet, have a proper outlet installed by a qualified electrician.

This product is for use on a nominal 120-volt circuit, and has a grounding plug that looks like the plug illustrated in Drawing 1.

A temporary adapter that looks like the adapter illustrated in Drawing 2 may be used to connect this plug to a 2-pole receptacle as shown in Drawing 2 if a properly grounded outlet is not available. The temporary adapter should be used only until a properly grounded outlet (Drawing 1) can be installed by a qualified electrician. The green colored rigid ear, lug, or the like extending from the adapter **must be** connected to a permanent ground such as a properly grounded outlet box cover. Whenever the adapter is used it **must be** held in place by a metal screw.

Some 2-pole receptacle outlet box covers are not grounded. Contact a qualified electrician to determine if the outlet box cover is grounded before using an adapter.

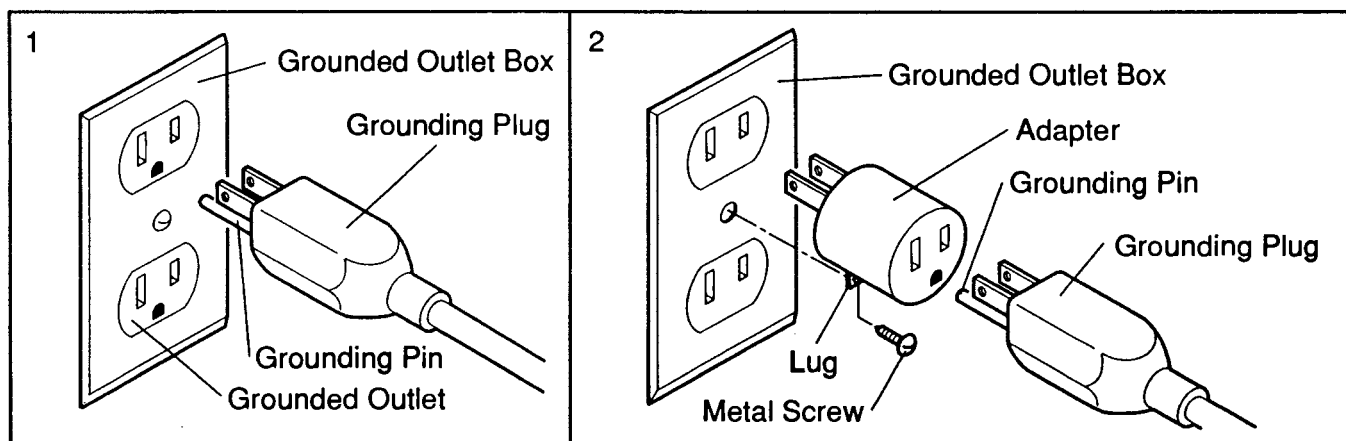

MAINTENANCE-FREE WALKING PLATFORM

This treadmill features a walking platform coated with a special hydrocarbon slip agent. **Do not apply silicone spray or any other substance to the walking platform or the walking belt.** Such substances will deteriorate the surface of the walking platform and cause excessive wear.

The first time you use the treadmill, walk on the treadmill for 10 minutes to break in the walking platform. During this initial break-in period, it is normal for the walking belt to slow.

CONSOLE OPERATION

The heart of the treadmill is the innovative EPIC console. The EPIC console features a safety key-operated power switch, a large easy-to-read LED display, convenient push-button speed and incline controls and a multiple-mode exercise monitor. The EPIC console can even control the treadmill automatically according to custom workout programs you create.

DIAGRAM OF THE CONSOLE



TURNING THE POWER ON

If the safety key is in the console, remove it. Plug the power cord in. (See PLUGGING THE POWER CORD IN on page 6 for proper grounding instructions.)

Step onto the foot rails of the treadmill. Find the clip attached by a cord to the safety key. Slide the clip onto your waistband.

WARNING: Do not stand on the walking belt when turning the power on. Always wear the clip when operating the treadmill; if you fall, the safety key will be pulled from the base console, instantly turning off the power.

Insert the safety key into the base console. NOTE: When the safety key is first inserted after the power cord is plugged in, the treadmill will perform an automatic incline test, rising to maximum incline and then returning to minimum incline. If the safety key is in the console when the power cord is plugged in, a "PO" may appear on the display. If a "PO" appears, remove the safety key, wait for ten seconds and then reinsert the safety key.

MANUAL MODE OPERATION

When the power is turned on, the console will be in the manual mode and the walking belt will be stationary. The speed of the walking belt can be controlled by pressing the SPEED buttons. The minimum speed setting is 0.5 miles per hour. Each time one of the buttons is pressed, the speed will change by 0.1 mile per hour. The buttons can be held down to change the speed quickly.

WARNING: After the SPEED buttons are pressed, it will take a few seconds for the walking belt to reach the selected speed setting. Adjust the speed gradually until you are familiar with the operation of the treadmill. When the SPEED buttons are pressed, the console will display the selected speed setting. The console will then change to display the actual speed of the walking belt until the walking belt reaches the selected speed setting.

Press the SPEED increase button until the walking belt begins to move at slow speed. Step carefully onto the walking belt and begin exercising. Change the speed of the walking belt as desired by pressing the SPEED buttons. To stop the walking belt, hold down the SPEED decrease button. The walking belt can be stopped quickly, if desired, by pressing the START/PAUSE button.

To vary the intensity of your exercise, the incline of the treadmill can be changed by pressing the INCLINE ADJUST buttons. Each time one of the buttons is pressed, the incline will change by 1.0%. The buttons can be held down to change the incline quickly. Indicators will light to show the current incline setting.

PROGRAMMABLE MODE OPERATION

In the programmable mode, the console will control either the speed or the incline of the treadmill automatically according to workout programs you create. To select the programmable mode, press the SELECT button on the console. The SPEED indicator will light to show that the console is set to control the speed of the treadmill. If you want the console to control the incline of the treadmill, press the SELECT button again. The INCLINE indicator will light.

Each workout program will consist of ten equal time periods, called segments. The speed or incline of the treadmill will change automatically at the beginning of each segment. The ten segment controls on the upper left of the console are used to program speed or incline settings for the ten segments.

If the console is set to control the speed of the treadmill, a speed setting should now be programmed for each segment by sliding the segment controls up or down. The "MIN" and "MAX" marks represent the speed range of the treadmill; the higher a control is moved, the faster the walking belt will move during that segment. You may wish to program a low setting for the first segment to provide a warm-up period, a combination of medium and high settings for the middle segments, and a low setting for the final segment for a cool-down period. An endless variety of speed settings can be programmed.

If the console is set to control the incline of the treadmill, an incline setting should now be programmed for each segment in the same manner.

Each workout program can be set to last for a minimum of 5 minutes, up to a maximum of 40 minutes, in increments of 5 minutes. To set the desired length of time, first select the TIME/SET mode by repeatedly pressing the MODE button (see SELECTING MONITOR MODES below). Next, slide the SEGMENT TIME control up or down. As you move the control, the length of time you have set will be displayed on the console. The numbers beside the SEGMENT TIME control show how long each segment will last.

To start the workout program, press the START/PAUSE button. The first segment will begin, and the speed or incline of the treadmill will automatically adjust to the first setting. There will be a brief pause before the walking belt begins to move. Step carefully onto the walking belt and begin exercising. If desired, the segment controls can be changed while the program is running. When the first segment is completed, the second segment indicator will light, and the speed or incline of the treadmill will automatically change to the second setting. If the console is controlling the speed of the treadmill, the incline can be controlled by moving the SPEED/INCLINE ADJUST control up or down. If the console is controlling the incline of the treadmill, the speed can be controlled by moving the SPEED/INCLINE ADJUST control. The workout program will continue in this manner until all ten segments have been

completed. The walking belt will then slow to a stop.

If you need to stop exercising before the workout program has ended, press the START/PAUSE button. When you are ready to resume exercising, press the START/PAUSE button again.

When the workout program has ended, press the MANUAL button to select the MANUAL mode.

SELECTING MONITOR MODES

The console offers a wide selection of monitor modes to give you instant exercise feedback. The monitor modes can be selected by repeatedly pressing the MODE button. Indicators will light to show which monitor mode is currently displayed. The display can be reset, if desired, by removing the safety key and then reinserting it. The monitor modes are described below.

WEIGHT SET: For the CALORIES mode to be accurate, your weight should be entered into the console. Select the WEIGHT SET mode and then press the SET buttons to enter your weight. Each time one of the buttons is pressed, the weight displayed will change by 1 pound. The buttons can be held down to enter your weight quickly.

TIME/SET: This mode displays the elapsed time. This mode also allows time goals to be set. To set a time goal, first select the TIME/SET mode. (Make sure that the SCAN mode is not selected.) Press the SET buttons to set the length of time that you plan to exercise. Each time one of the buttons is pressed, the time displayed will change by 10 seconds. The buttons can be held down to set a time goal quickly. As you exercise, the time will be counted down. When no time remains, a tone will sound. The console will then display the elapsed time since the goal was completed. Note: Time goals can be set only when the console is in the manual mode.

DISTANCE/SET: This mode displays the distance you have traveled. This mode also allows distance goals to be set. To set a distance goal, first select the DISTANCE/SET mode. (Make sure that the SCAN mode is not selected.) Press the SET buttons to set the distance that you plan to travel. Each time one of the buttons is pressed, the distance displayed will change by 0.2 miles. The buttons can be held down to set a distance goal quickly. As you exercise, the distance will be counted down. When the distance goal is completed, a tone will sound. The console will then display the distance you have traveled since the goal was completed. Note: Distance goals can be set only when the console is in the manual mode.

SPEED: This mode displays the speed of the walking belt. Note: Each time one of the SPEED buttons is pressed, this mode will be displayed automatically for approximately 5 seconds.

CALORIES: This mode displays the total number of nutritional Calories you have burned. For accuracy, first select the WEIGHT SET mode and enter your weight into the console.

PULSE: This mode displays your heart rate. Plug the pulse earclip into the jack on the console, and attach the earclip to your left ear lobe. Slide the metal clothes clip onto your collar. After a few seconds, your heart rate will be displayed. Note: If your heart rate is not displayed, rub your ear lobe lightly and reposition the earclip.

SCAN: This mode automatically displays all modes except WEIGHT SET, for approximately 3 seconds each, in a repeating cycle. Note: The PULSE mode will be displayed only if the pulse earclip is worn.

TURNING OFF THE POWER

To turn off the power, remove the safety key from the console. Keep the safety key in a secure location. **WARNING: Always remove the safety key from the console when you finish exercising.**

ADDITIONAL MODULES AVAILABLE

The EPIC console is designed to be expandable, offering you even more workout options. The INTERVAL TRAINER™ module at the top of the console can be removed, and other modules can be connected to the console. Three different modules are currently available. The modules are described below.

The state-of-the-art VIDEO TRACK™ module enables you to connect the EPIC console to your TV and VCR for exciting and motivating workouts. As you exercise, a videocassette will take you on a tour of some of the most breathtaking scenery in America, while the module controls the treadmill automatically to simulate the terrain you are viewing. **WARNING: Keep videocassettes at least two feet away from treadmill motor hoods. Treadmill motors contain magnets which can damage videocassettes.**

The powerful TRACK FIVE™ module offers five preset workout programs, each designed to give you a different type of workout. Simply select one of the programs, set the length of time that you plan to exercise and choose a workout intensity level. The TRACK FIVE module will control the treadmill automatically as it guides you through an invigorating cardiovascular workout.

The versatile PERSONAL TRAINER PLUS™ module lets you create an endless variety of custom workout programs. Up to four programs can be stored in the module's memory at the same time. The module is also compatible with PERSONAL TRAINER programs. Just connect the module to your telephone, and give your PERSONAL TRAINER a call. Your PERSONAL TRAINER will ask you questions about your fitness goals, and then program the module via a telephone hook-up, with a PERSONAL TRAINER program designed to help you achieve the specific results you want.

For more information, or to order additional modules, see ORDERING REPLACEMENT PARTS on the back cover of this manual.

TROUBLE-SHOOTING AND MAINTENANCE

Most treadmill problems can be solved by following the simple steps below. If further assistance is needed, please call our Customer Service Department toll-free at 1-800-999-3756, Monday through Friday, 6 a.m. until 6 p.m. Mountain Time (excluding holidays).

1. SYMPTOM: THE POWER DOES NOT TURN ON

- a. Make sure the power cord is plugged into a properly grounded outlet. (See OPERATION AND ADJUSTMENT in this manual.) If an extension cord is needed, use only a 14-gauge general-purpose cord of five feet or less in length.
- b. Make sure the safety key is fully inserted into the base console. Various indicators on the base console should light. (See OPERATION AND ADJUSTMENT in this manual.)
- c. Check the circuit breaker located on the treadmill frame near the power cord. If the switch protrudes as shown, the circuit breaker has tripped. To reset the circuit breaker, wait for five minutes and then press the switch back in.

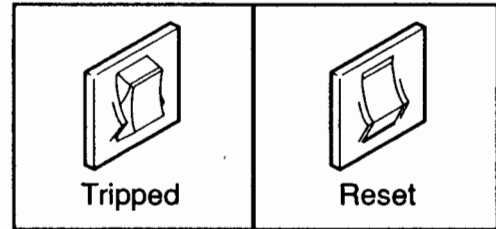

2. SYMPTOM: THE POWER TURNS OFF DURING USE

- a. Check the circuit breaker located on the treadmill frame near the power cord. If the switch protrudes, the circuit breaker has tripped. To reset the circuit breaker, wait for five minutes and then press the switch back in. (See the drawing above.)
- b. Make sure the power cord is plugged in.
- c. Remove the safety key from the base console. Reinsert the safety key fully into the base console. Various indicators on the base console should light.

3. SYMPTOM: THE CONSOLE DOES NOT FUNCTION PROPERLY

- a. If a console malfunction occurs, an error code ("PO" or "EEEE") may appear on the display. If an error code appears, remove the safety key, wait for ten seconds and then reinsert the safety key. If the error code appears again, call our Customer Service Department. Do not operate the treadmill until the problem is corrected.

4. SYMPTOM: THE PULSE EARCLIP DOES NOT FUNCTION PROPERLY

- a. Make sure the pulse earclip is plugged fully into the jack on the base console. Attach the clothes clip to your collar.
- b. Rub your left ear lobe and reposition the earclip.
- c. Stand still while measuring your pulse. **WARNING: The pulse earclip is not a medical device. Various factors, including the user's movement while exercising, may affect the accuracy of heart rate readings. The earclip is intended only as an exercise aid in determining heart rate trends in general.**
- d. The pulse earclip may need to be cleaned. Press the earclip open, and wipe the two clear circles inside the earclip, using a cotton swab saturated with denatured alcohol.

5. SYMPTOM: THE WALKING BELT SLOWS WHEN WALKED ON

- a. The first time the treadmill is used, the treadmill must be walked on for 10 minutes to break in the walking platform. During this initial break-in period, it is normal for the walking belt to slow.

- b. If an extension cord is needed, use only a 14-gauge general-purpose cord of five feet or less in length.
- c. If the walking belt is overtightened, treadmill performance may be reduced and the walking belt permanently damaged. Remove the safety key and UNPLUG THE POWER CORD. Using the allen wrench included, turn both rear roller adjustment bolts counterclockwise, 1/4 of a turn. When the tension of the walking belt is correct, you should be able to lift each side of the walking belt 3-4 inches off the walking platform. The center of the walking belt should just touch the surface of the walking platform. Be careful to keep the walking belt centered. Plug in the power cord and reinsert the safety key. Run the treadmill for a couple of minutes. Repeat until the tension of the walking belt is correct.

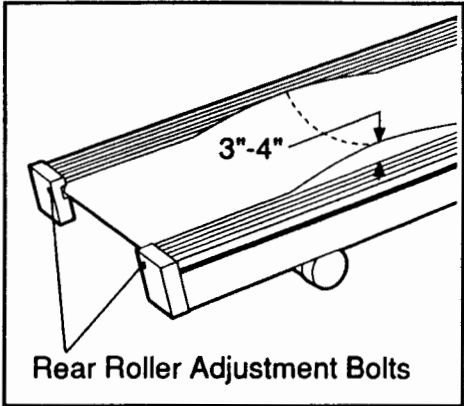

6. SYMPTOM: THE WALKING BELT IS OFF-CENTER OR SLIPS WHEN WALKED ON

- a. If the walking belt has shifted to the left, first remove the safety key from the console and UNPLUG THE POWER CORD. With the allen wrench included, turn the left rear roller adjustment bolt clockwise, and the right bolt counterclockwise, 1/4 of a turn each. Plug in the power cord and reinsert the safety key. Run the treadmill for a couple of minutes. Repeat as necessary until the walking belt is centered.
- b. If the walking belt has shifted to the right, first remove the safety key from the console and UNPLUG THE POWER CORD. With the allen wrench included, turn the left rear roller adjustment bolt counterclockwise, and the right bolt clockwise, 1/4 of a turn each. Plug in the power cord and reinsert the safety key. Run the treadmill for a couple of minutes. Repeat as necessary until the walking belt is centered.

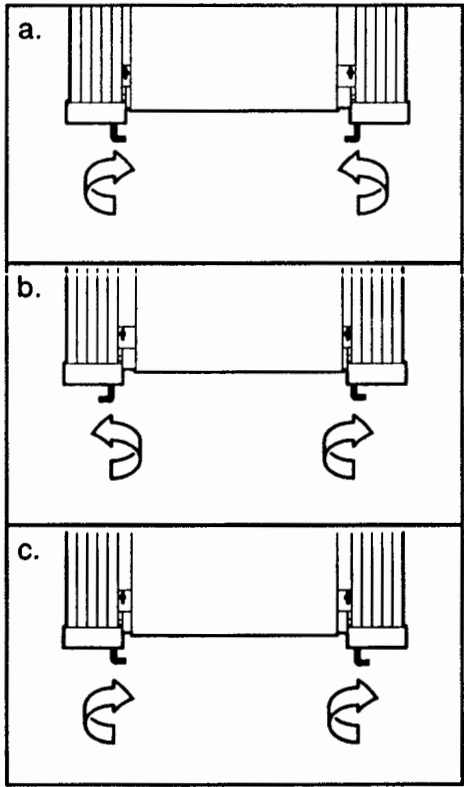

- c. If the walking belt slips when walked on, first remove the safety key from the console and UNPLUG THE POWER CORD. With the allen wrench included, turn both rear roller adjustment bolts clockwise, 1/4 of a turn. When the tension of the walking belt is correct, you should be able to lift each side of the walking belt 3-4 inches off the walking platform. The center of the walking belt should just touch the surface of the walking platform. Be careful to keep the walking belt centered on the walking platform. Plug in the power cord and reinsert the safety key. Run the treadmill for a couple of minutes. Repeat as necessary until the tension of the walking belt is correct.

CONDITIONING GUIDELINES

The following guidelines will help you to plan your exercise program. Remember that proper nutrition and adequate rest are essential for successful results. **WARNING: Before beginning this or any exercise program, consult your physician. This is especially important for individuals over the age of 35 or individuals with pre-existing health problems.**

EXERCISE INTENSITY

To maximize the benefits of exercising, it is important to exercise with the proper intensity. The proper intensity can be found by using your heart rate as a guide. For effective aerobic exercise, your heart rate should be maintained at a level between 70% and 85% of your maximum heart rate as you exercise. This is known as your training zone. You can find your training zone in the table below. Training zones are listed for both unconditioned and conditioned persons according to age.

AGE	UNCONDITIONED TRAINING ZONE (BEATS/MIN)	CONDITIONED TRAINING ZONE (BEATS/MIN)	AGE	UNCONDITIONED TRAINING ZONE (BEATS/MIN)	CONDITIONED TRAINING ZONE (BEATS/MIN)
20	138-167	133-162	55	127-155	122-149
25	136-166	132-160	60	126-153	121-147
30	135-164	130-158	65	125-151	119-145
35	134-162	129-156	70	123-150	118-144
40	132-161	127-155	75	122-147	117-142
45	131-159	125-153	80	120-146	115-140
50	129-156	124-150	85	118-144	114-139

During the first few months of your exercise program, keep your heart rate near the low end of your training zone as you exercise. After a few months of regular exercise, your heart rate can be increased gradually until it is near the middle of your training zone as you exercise. You can measure your heart rate using the pulse mode of the console. Exercise for at least four minutes, and then measure your heart rate immediately. If your heart rate is too high, decrease the intensity of your exercise. If your heart rate is too low, increase the intensity of your exercise. **WARNING: The pulse earclip is not a medical device. Various factors, including your movement during exercise, may affect the accuracy of heart rate readings. The earclip is intended only as an exercise aid in determining heart rate trends in general.**

WORKOUT GUIDELINES

Each workout should consist of three basic parts: a warm-up, 20 to 30 minutes of training zone exercise, and a cool-down. Warming up prepares the body for exercise by increasing circulation, delivering more oxygen to the muscles and raising the body temperature. Begin each workout with 5 to 10 minutes of stretching and light exercise to warm up. Then, increase the intensity of your exercise to raise your heart rate to your training zone for 20 to 30 minutes. Breathe regularly and deeply as you exercise—never hold your breath. Finish each workout with 5 to 10 minutes of stretching to cool down. This will increase the flexibility of your muscles as well as help to decrease soreness and other post-exercise problems.

To maintain or improve your condition, complete three workouts each week, with at least one day of rest between workouts. After a few months of regular exercise, you may complete up to five workouts each week, if desired. The key to success is **CONSISTENCY**.

PART LIST—Model No. WL401523

Rev. 2/93

Key No.	Qty.	Description	Key No.	Qty.	Description
1	1	Side Rail w/Foam Grip	47	1	Speed Encoder Assembly
2	1	Console	48	3	Adjustment Washer
3	24	Screw	49	1	Front Roller Adjustment Bolt
4	1	Clothes Clip	50	4	Hood Anchor
5	1	Pulse Earclip	51	1	Safety Cover
6	1	Safety Key/Clip	52	1	Front Roller/Pulley
7	1	Handrail Bolt	53	1	Walking Belt
8	2	Flat Washer	54	1	Frame
9	1	Upright Post	55	1	Right High Density Foam
10	1	Handrail w/Foam Grip	56	1	Walking Platform
11	1	Incline Motor	57	1	Incline Switch Insert
12	1	Left High Density Foam	58	2	Small Bolt
13	1	Handrail Foam Grip	59	2	Small Nut
14	4	Hood Screw	60	2	Photo Interrupter Switch
15	2	Endcap Screw	61	1	Incline Switch Bracket
16	1	Motor Ground Strap	62	1	Switch Bracket Screw
17	1	J-Bolt Nut	63	2	Ground Washer
18	1	Motor	64	1	Optic Disk
19	1	Pulley/Flywheel/Fan	65	1	Speed Switch Bracket
20	4	Motor Mount Isolator	66	2	Rear Leg Endcap
21	1	Motor Mount Swivel Shaft	67	6	Leg Screw/Guard Screw
22	1	Choke	68	6	Platform Screw
23	1	Wire Harness	69	6	Platform Clamp
24	1	Controller	70	6	Platform Clamp Bushing
25	1	J-Bolt	71	6	Small Bushing
26	1	Tension Washer	72	1	Right Endcap
27	1	Tension Spring	73	1	Allen Wrench
28	1	Incline Motor Spacer	74	1	Wrench Clip
29	4	Locknut	75	1	Rear Roller
30	1	Lock Knob Washer	76	2	Rear Roller Adjustment Bolt
31	1	Lock Knob	77	2	Roller Guard
32	1	Pivot Bolt	78	1	Left Endcap
33	1	Power Supply Plate	79	1	Left Foot Rail
34	4	Plastic Stand-Off	80	1	Motor Hood w/Decal
35	1	Power Supply	81	1	Side Rail Bolt
36	1	Power Cord	82	9	Side Rail Nut/Motor Nut
37	1	Grommet	83	1	Belt
38	1	Circuit Breaker	84	1	Front Roller Insert
39	12	Plastic Fastener	85	1	Console Module
40	3	Wheel Bolt/Lift Motor Bolt	86	1	Side Rail Foam Grip
41	2	Front Wheel	87	2	Roller Spacer
42	1	Incline Leg	88	1	Cotter Pin
43	2	Incline Leg Bolt	89	1	Incline Motor Pin
44	1	Right Foot Rail	90	1	Retainer
45	2	U-Nut	#	1	Owner's Manual
46	2	Shaft Bolt			

Note: "#" indicates a non-illustrated part. Specifications are subject to change without notice. See the back cover for information about ordering replacement parts.

EXPLODED DRAWING—Model No. WL401523

Rev. 2/93

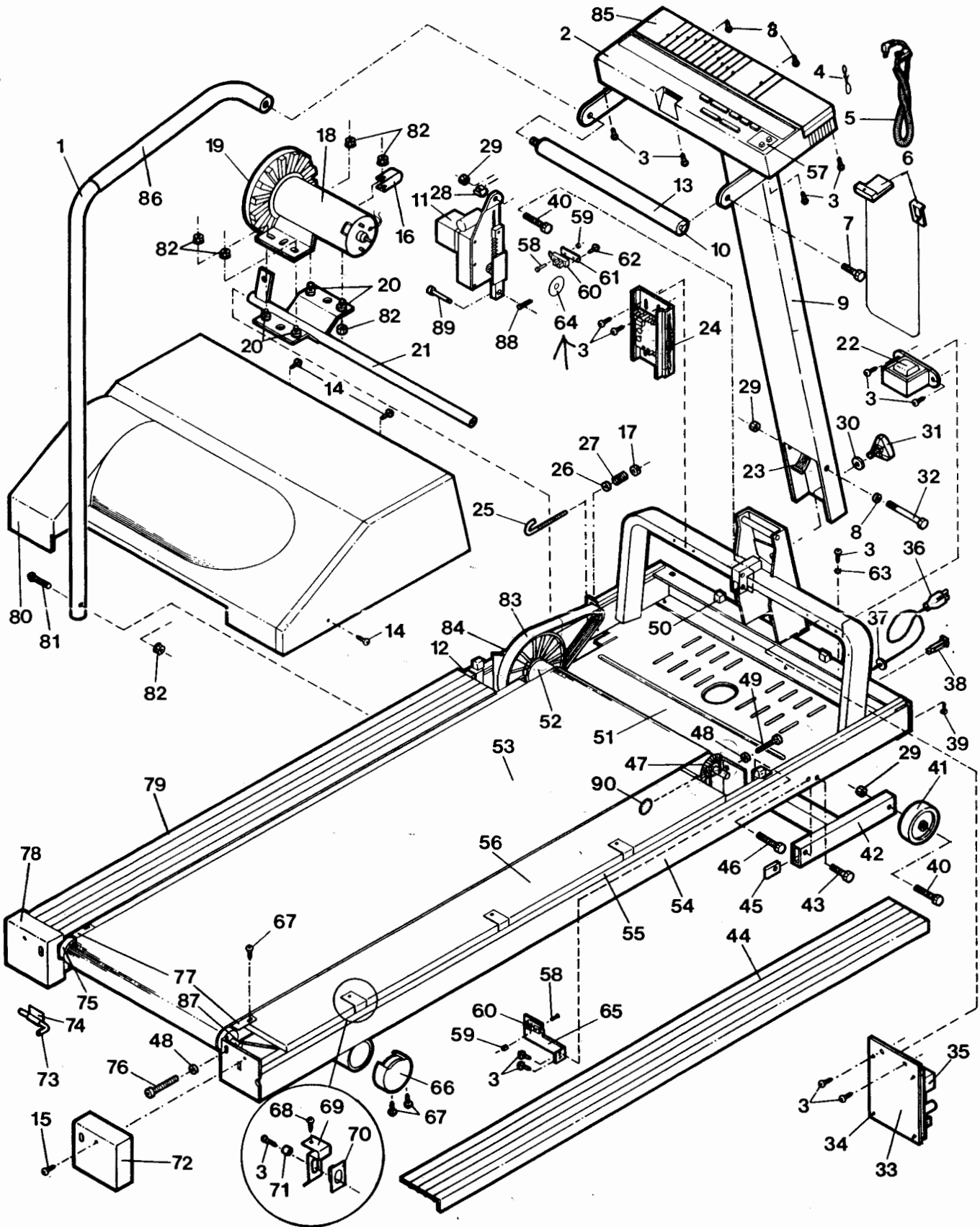

ORDERING REPLACEMENT PARTS

To order replacement parts, call our Customer Service Department toll-free at **1-800-999-3756**, Monday through Friday, 6 a.m. until 6 p.m. Mountain Time (excluding holidays). When ordering parts, please be prepared to give the following information:

1. The MODEL NUMBER of the product (WL401523).
2. The NAME of the product (WESLO® EPIC 10pi treadmill).
3. The SERIAL NUMBER of the product (see the front cover of this manual).
4. The KEY NUMBER of the part(s) from page 14 of this manual.
5. The DESCRIPTION of the part(s) from page 14 of this manual.

LIMITED WARRANTY

Weslo, Inc. ("WESLO"), warrants this product to be free from defects in workmanship and material, under normal use and service conditions, for a period of ninety (90) days from the date of purchase. This warranty extends only to the original purchaser. WESLO's obligation under this warranty is limited to replacing or repairing, at WESLO's option, the product at one of its authorized service centers. All products for which warranty claim is made must be received by WESLO at one of its authorized service centers with all freight and other transportation charges prepaid, accompanied by sufficient proof of purchase. All returns must be pre-authorized by WESLO. This warranty does not extend to any product or damage to a product caused by or attributable to freight damage, abuse, misuse, improper or abnormal usage or repairs not provided by a WESLO authorized service center or for products used for commercial or rental purposes. No other warranty beyond that specifically set forth above is authorized by WESLO.

WESLO IS NOT RESPONSIBLE OR LIABLE FOR INDIRECT, SPECIAL OR CONSEQUENTIAL DAMAGES ARISING OUT OF OR IN CONNECTION WITH THE USE OR PERFORMANCE OF THE PRODUCT OR OTHER DAMAGES WITH RESPECT TO ANY ECONOMIC LOSS, LOSS OF PROPERTY, LOSS OF REVENUES OR PROFITS, LOSS OF ENJOYMENT OR USE, COSTS OF REMOVAL, INSTALLATION OR OTHER CONSEQUENTIAL DAMAGES OF WHATSOEVER NATURE. SOME STATES DO NOT ALLOW THE EXCLUSION OR LIMITATION OF INCIDENTAL OR CONSEQUENTIAL DAMAGES. ACCORDINGLY, THE ABOVE LIMITATION MAY NOT APPLY TO YOU.

THE WARRANTY EXTENDED HEREUNDER IS IN LIEU OF ANY AND ALL OTHER WARRANTIES AND ANY IMPLIED WARRANTIES OF MERCHANTABILITY OR FITNESS FOR A PARTICULAR PURPOSE IS LIMITED IN ITS SCOPE AND DURATION TO THE TERMS SET FORTH HEREIN. SOME STATES DO NOT ALLOW LIMITATIONS ON HOW LONG AN IMPLIED WARRANTY LASTS. ACCORDINGLY, THE ABOVE LIMITATION MAY NOT APPLY TO YOU.

This warranty gives you specific legal rights. You may also have other rights which vary from state to state.

WESLO INC., 1500 S. 1000 W., LOGAN, UT 84321-9813