

LS-9100 Stairclimber

LS91-0102-25

Parts Manual

1/5/2019 15:09:55 PM

Table of Contents

[Component Assembly 1](#).....3
[Component Assembly 2](#).....4
[Component Assembly 3](#).....6

Component Assembly 1

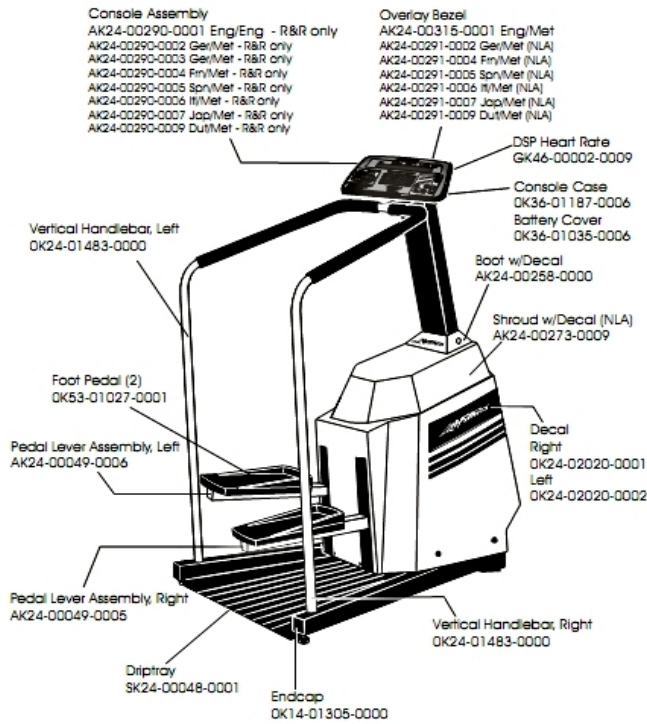

Not Shown:
 Main Cable
 AK24-00228-0002
 Parts Bag
 AK24-00268-0000

Ref #	Part Number	Qty	Description
-	OK24-01483-0000	4	Vertical Handle Right and Left
-	AK24-00273-0009	1	Shroud with Decal
-	AK24-00258-0000	1	Boot with Decal
-	AK24-00290-0001	1	Console English/Imperial - R&R only
-	OK36-01035-0006	1	Battery Cover
-	AK24-00315-0001	1	Overlay Bezel English/Metric
-	AK24-00268-0000	1	Parts Bag
-	OK24-02020-0002	1	Decal Left
-	AK24-00228-0002	1	Main Cable
-	OK14-01305-0000	2	Endcap
-	AK24-00049-0006	1	Pedal Lever Assembly - Left
-	OK36-01187-0006	1	Console Case
-	SK24-00048-0001	1	Drip Tray
-	OK24-02020-0001	1	Decal Right
-	OK53-01027-0003	2	Pedal: Purchased
-	AK24-00049-0005	1	Pedal Lever Assembly - Right
-	GK46-00002-0009	1	DSP Heart Rate

Component Assembly 2

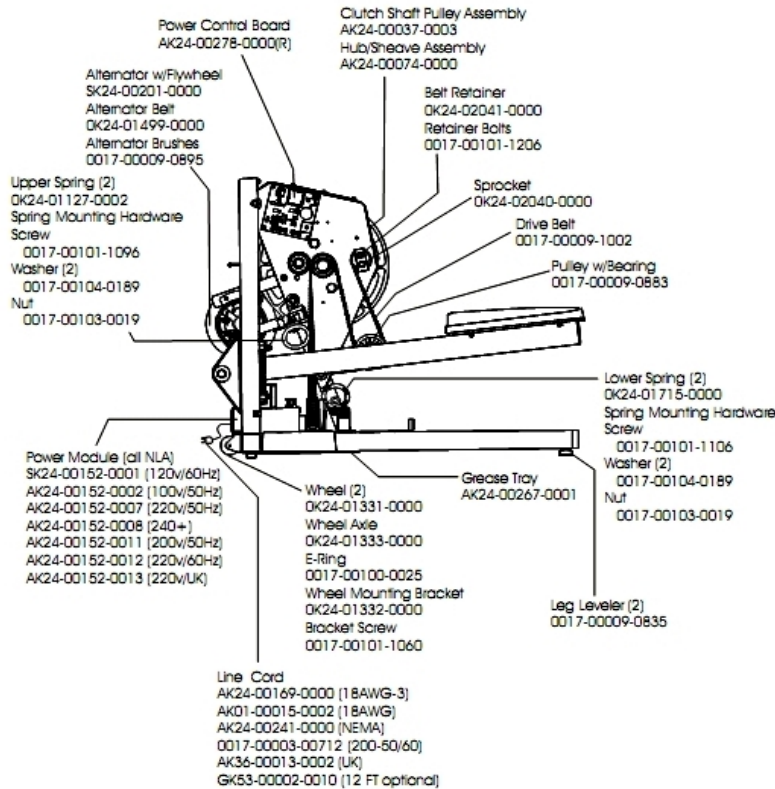

Ref #	Part Number	Qty	Description
-	SK24-00201-0000	1	Alternator with Flywheel
-	0017-00009-0883	1	Pulley with Bearing
-	0017-00101-1096	1	Hardware: Spring Mounting Screw
-	GK53-00002-0017	1	NLA: KIT: SERV; LINK+BUSHINGS BM
-	0017-00101-1206	1	Hardware: Retainer Bolts
-	0017-00104-0189	4	Hardware: Flat Washer 1" OD
-	OK24-01333-0000	1	Wheel Axle
-	AK24-00152-0013	1	Power Module (220v/UK)
-	AK24-00037-0003	1	Clutch Shaft Pulley Assembly
-	AK24-00267-0001	1	Grease Tray
-	OK24-02040-0000	1	Sprocket
-	OK24-01499-0000	1	Poly-V Belt
-	OK24-01331-0000	2	Wheel
-	0017-00100-0025	1	E-Ring
-	AK36-00013-0002	1	Line Cord (UK)
-	AK24-00278-0000	1	Power Control Board
-	AK24-00074-0000	1	Hub/Sheave Assembly
-	OK24-02041-0000	1	Belt Retainer
-	OK24-01715-0000	2	Lower Spring (2)
-	0017-00103-0019	2	Hardware: Locking Nut 1/4" ID
-	0017-00101-1106	1	Hardware: Spring Mounting Screw
-	0017-00009-0835	2	Leg Leveler

Ref #	Part Number	Qty	Description
-	0017-00003-0712	1	Line Cord (200-50/60)
-	0K24-01332-0000	1	Wheel Mounting Bracket
-	AK01-00015-0002	1	Line Cord 18AWG
-	0017-00101-1060	1	Hardware: Bracket Screw
-	0017-00009-1002	1	Drive Belt
-	0K24-01127-0002	2	Upper Spring
-	AK24-00169-0000	1	Line Cord (18AWG-3)
-	0017-00009-0895	1	Alternator Brush Kit

Component Assembly 3

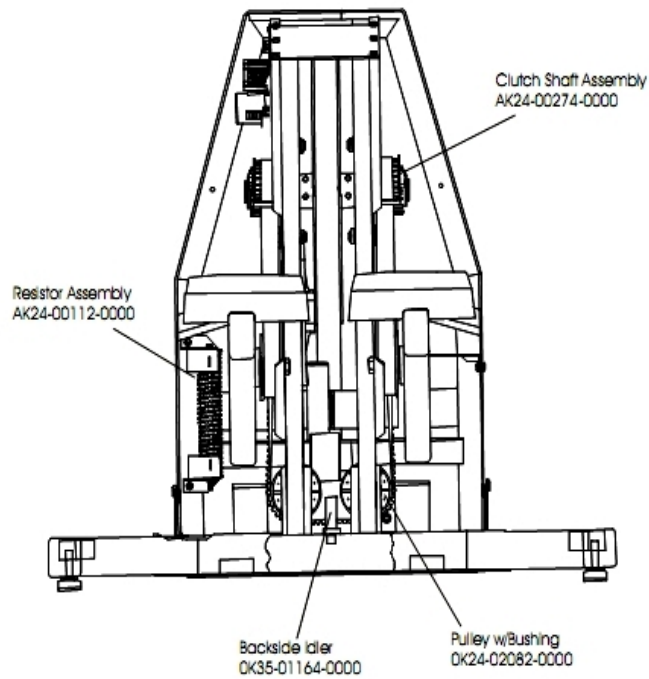

Ref #	Part Number	Qty	Description
-	OK24-02082-0000	1	Pulley with Bushing
-	OK35-01164-0000	1	Backside Idler
-	AK24-00112-0000	1	Resistor Assembly
-	AK24-00274-0000	1	Clutch Shaft Assembly

