

HAMMER STRENGTH®

**HAMMER
STRENGTH®**

FREE WEIGHT

PARTS MANUAL

**BUMPER PLATE LARGE
FWBPL & FW-BPL**

2/4/2015

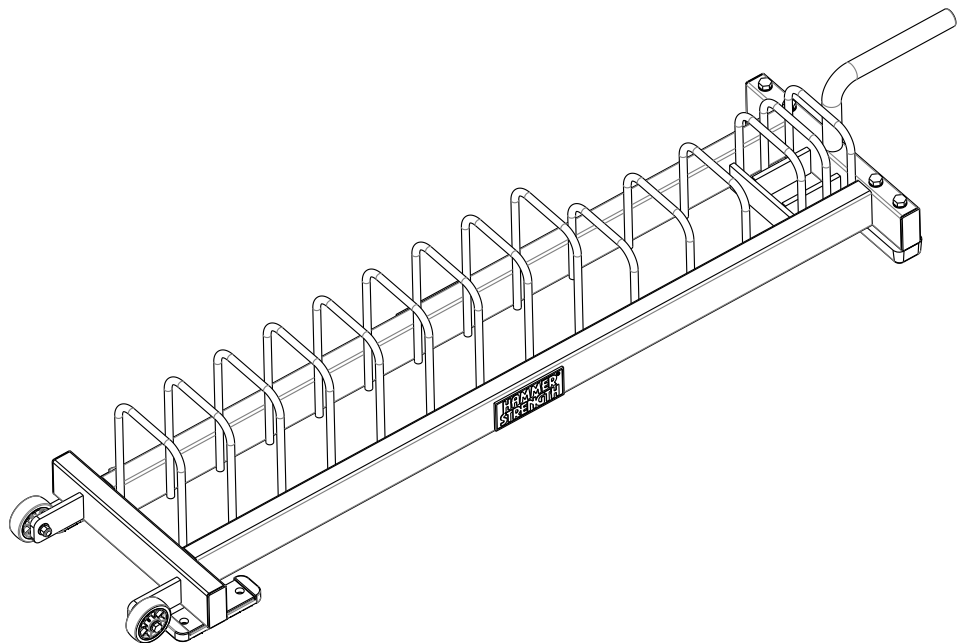



CONTENTS

COMPONENT ASSEMBLY PAGE 3

KEY

UPHOLSTERY ① ② ③

Items with Gray call-outs require the upholstery color listed within the order notes. IE: Putty

FRAME AND MOVEMENT ARM COLORS ① ② ③

Items with Blue call-outs require the powder coat frame color to be listed within the order notes.

COMPONENT ASSEMBLY

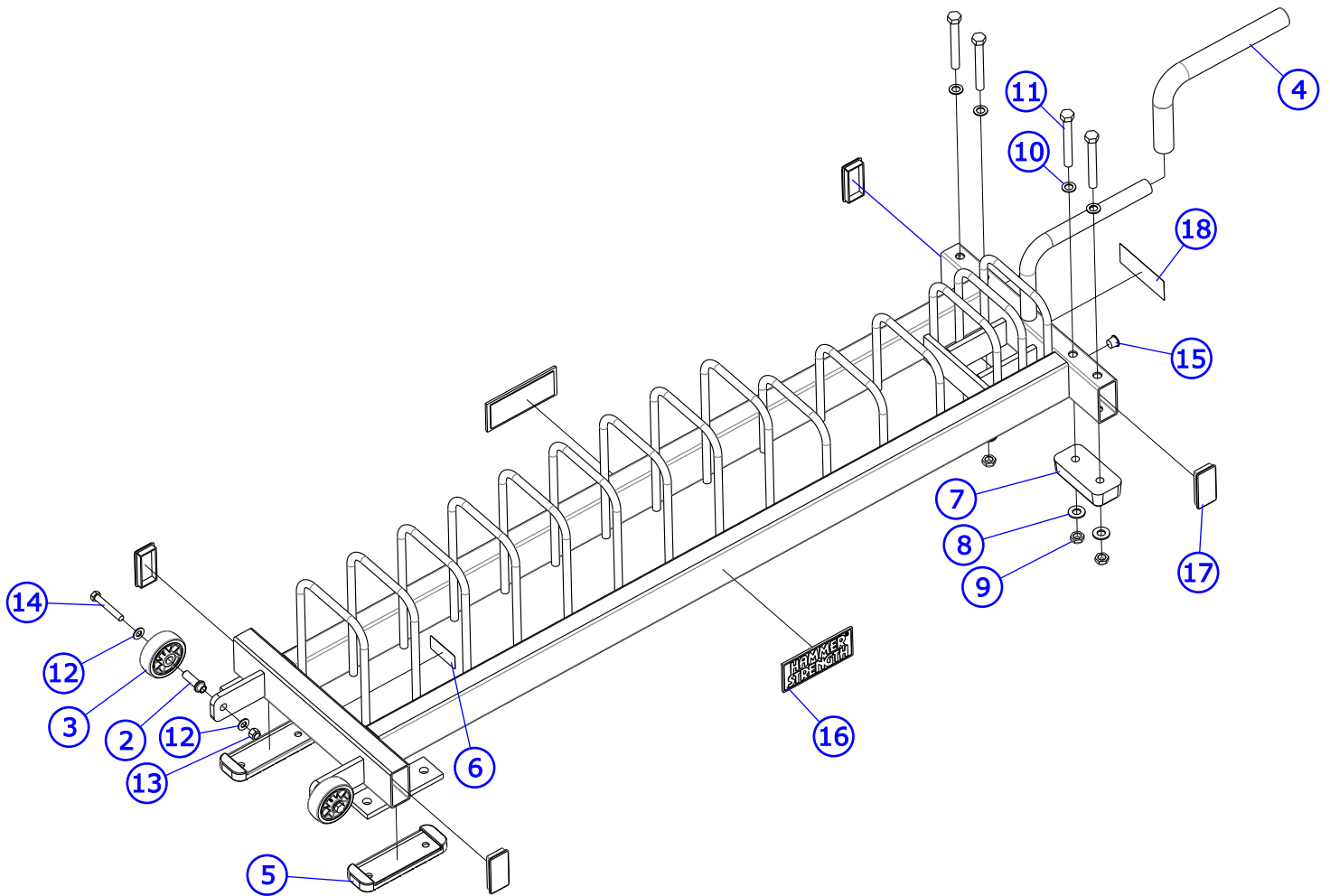

ITEM NO.	QTY.	PART NO.	DESCRIPTION
2	2	7961401	AXLE, FW, WHEEL
3	2	0K59-01164-0000	WHEEL, 3.0 OD X .50 ID OVERMOLD
4	1	H-GRIP	16" HANDGRIP
5	2	MM-8	2 X 6 FLANGE RUBBER SLIPPER
6	1	-	SERIAL NUMBER
7	2	H-BUMP-SML	SMALL BUMPER (VEN# MM3)
8	4	WASH.5SAE	1/2" SAE FLAT WASHER
9	4	NUT.5JAMLOCK	1/2 THIN LOCK NUT
10	4	WASH.5STAR	1/2" INTERNAL LOCK WASHER
11	4	HHB.5X4	1/2 X 4 BOLT
12	4	WASH.375SAE	3/8" SAE FLAT WASHER
13	2	NUT.375LOCK	3/8 THICK LOCK NUT
14	2	HHB.375X2.5	STEEL BOLT 3/8 X 2.5
15	2	H-HPLUG (REG)	HOLE PLUG
16	2	H-NAMEPLATE	HAMMER STRENGTH BADGE
17	4	RC1530-1Q1	CAP:1-1/2 X 3 RECTANGLE PLUG
18	1	8219801	LABEL, ASTM, FW HORZ