

CCN

GSA PriceList



---

FSC Group 71, Part 1 Office Furniture  
FSA Class 7110 (Office, conference  
Room, and Reception Area Furniture)

Federal Supply Service  
Authorized Federal Supply  
Schedule Price List

Business size: Small  
Cage Code: 3XYJ1  
DUNS #: 091675082

---

Contract #GS-28F-0017R

March 22, 2005 - March 21, 2020

---

On-line access to contract ordering information, terms and conditions, up-to-date pricing, and the option to create an electronic delivery order is available through GSA Advantage!, a menu-driven database system. The internet address to GSA Advantage! is [gsaadvantage.gov.com](http://gsaadvantage.gov.com)

For additional information on ordering from Federal Supply Schedules, please visit [fss.gsa.gov](http://fss.gsa.gov)



# GSA

---

contents:    GSA Program General Information  
                  About CCN  
                  Barrington  
                  Charisma  
                  Foundation  
                  Crofton  
                  Gallery Desks  
                  Tables

**Intended use:**

The furniture covered by Special Item Numbers 711-8, and 711-9, is intended for use by Government ex-ecutive (or equivalent military rank) in the Executive, Judicial, and Legislative Branches, or Armed Forces of the Federal Gov-ernment. The ordering agency or service is responsible for de-termining furniture appropriate for use in its offices which will fit within its budget and comply with applica-ble Federal or in-ternational agency procurement regulations.

To help customers make a good purchasing decision based on their needs and budget. GSA has established five grades of fur-niture. Grade (1) includes furniture that tends to be the most expensive on this schedule, Grade (2) furniture tends to be more moderately priced and Grades (3), (4) and (5) furniture tend to be affordably priced when compared to Grades (1) and (2). Some pieces of furniture on this schedule may be significantly higher in price than GSA Traditional and Contemporary Exec-utive Spe-cial Order Program furniture. The ordering agency or service is responsible for determining furniture appropriate for use in its offices which will fit within its budget and comply with appli-cable Federal or internal agency procurement regulations.

**Definition of Grades Grade (1)**

All exposed solid parts such as top rims, base rails etc. (except decora-tive accents, inlays and parts) shall be the same specials as the face veneer. Top and bottom edges of drawer fronts shall be solid wood in the same species as the face veneers. Drawer sides and backs shall be solid wood. All CCN products classify as Grade (1). Top and bottom edges of drawer fronts shall be solid wood in the same species as the face veneers. Drawer sides and backs shall be solid wood. All CCN products classify as Grade.

**1a. Award Special Item Numbers:**

711-8 Executive Wood Furniture  
711-9 Executive Conference Room Furniture  
711-95 Installation Services

**1b. Lowest priced model for each Special Item Number:**

711-8 \_SBU11-153029 Bookcase \$978.00L  
711-9 \_TS1COLG-4242 Square Conference Table  
w/Cube Base \$1586.00L

2. Order Limitation: Maximum order \$500,000.00. (if order exceeds this amount Government Client should negotiate further concessions with ven-dor.) All orders shall be as for one destination.
3. Minimum Order: \$100.00
4. Geographic Coverage: 48 Contiguous States and the District of Columbia. shipment for Alaska, Hawaii, Puerto Rico etc. are F.O.B. point of embarkation. Drawer sides and backs shall be solid wood. All CCN products classify as Grade (1).
5. Production Point: Geneva, Ontario County, New York
6. Discount 55% off of price list dated March, 2004.  
**Call customer service for your discount that would apply to your order.**

7. Quantity discount: None
8. Prompt payment discount: Net 30 days
- 9a. Government Commercial Credit Card is accepted below the micro-purchase threshold (with no additional discount). Written confirmation with authorized signature required. Card must be used at time of order placement with cash changed at time of shipment or performance.
- 9b. Government Commercial Credit Card will be accepted about the micro-purchase threshold.
10. All items assembled in the U.S.A.
- 11a. time of delivery: 70 days after receipt of order, or less. Orders which require delivery dates in excess of 70 days shall specify a (...do not ship until...) instruction.
12. FOB: Origin-freight prepaid- for freight rate, please contact CCN Customer Service at 315.789.4400
13. Ordering address: CCN  
200 LeHigh Street  
Geneva, New York, 14456  
Fax: 315.789.0376  
Email: gsa@ccnintl.com
14. Payment address: Same as #13 (above)
15. Standard Commercial Warranty: See commercial price lists for additional warranty information.
16. Export Packaging Chargers: Quoted upon request.
17. Government credit cards accepted for payment.
18. Terms and Conditions of rental, maintenance and repair: N/A
19. Terms and Conditions of installation: Installation fees for SIN #711-95 will be charged seperately on a per job basis. Industrial Funding Fee: 1% should be added to any installation amount that is included in a Government Purchase Order to CCN International. CCN International pays the fee to The General Services Administration quarterly.
20. Terms and Conditions of repair parts: Available on request.
21. List of service and distribution points: Contact factory.
22. List of participating dealers: Contact customer service for dealer listing.
23. Preventative maintenance: Contact factory
24. Environmental attributes: CCN is an FSC certified supplier. FSC certified products are available at an upcharge. Contact CCN customer service for further information.
25. Data Universal Number System (DUNS) number: 091675082
26. Central Contract Registration Number: 3XYJ1



Like many successful companies, our origins started in the garage of one of the owners in the spring of 1972 in Rochester, NY. Originally named Furniture Collaborative, we first started producing prototypes and custom solutions for a large wood contract furniture manufacturer, also located in Rochester.

Our young company soon developed working relationships with local office furniture dealers by providing them with pieces that were not offered by the larger contract furniture manufacturers. There was a ready market for our company's willingness to build those missing pieces as well as having the ability to match the fit and finish of comparable products in the marketplace, allowing the dealer to provide a seamless installation. These initial experiences gave us a solid insight to understanding the needs of the contract market and prepared us to introduce our first products under our new name, CCN International.

At that time we made the decision to move the factory from Rochester to Geneva, in the heart of the Finger Lakes region of beautiful Upstate New York. We moved with the explicit goal of setting up a more automated and efficient manufacturing facility. Over time, a bulk of our products were bespoke pieces for clients that could not find what they required from the larger manufacturers. Our ability to offer such specialized solutions entered us into the niche market of bespoke furniture. We were, and continue to fill a gap between the furniture manufactures with standard products, and the agility of a mill work shop. We continue to develop an array of standard products to offer our clients a common vocabulary, while tailoring each of those products into a custom solution for each customer.

For over 40 years we have maintained a flexible manufacturing process while continuing to invest in value adding equipment that enhances our capabilities. Our extensive veneering operation gives us the opportunity to offer a wide variety of wood species, our CNC machining stations give us precise components, and our finishing lab produces an impressive range of wood finishes. Our customer service team is set up to provide quotes, detailed drawings, and to answer any questions you may have in a timely fashion. Our robust project management team keeps a close eye on your project after receiving your order. We always know where your project stands within the timeline.

CCN stands out from the crowd due to our craftsmanship and ability to respond quickly and precisely to very specific and individual needs of each of our clients. We create product platforms, and when needed, we tailor them to fit your requirements. That is how we got our start back in 1972, and that is how we have stayed relevant in today's marketplace.

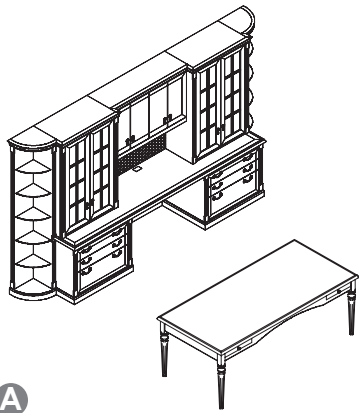

**A**

**Model number's**                      **D x W x H**                      **Standard Price (US \$)**                      **LE**                      **Weight (lbs.)**

**credenza configuration**

GXL003-2615477-UU                      25.5" x 153.5" x 77"                      29,977                      32,962                      1316

**Table Desk**

GTS4A-3072-0-DR2                      30" x 72" x 29"                      4363                      5109                      133  
 GTS4A-3672-0-DR2                      36" x 72" x 29"                      4573                      5434                      149  
 GTS4A-3678-0-DR2                      36" x 78" x 29"                      4751                      5672                      158  
 GTS4A-4284-0-DR2                      42" x 84" x 29"                      6279                      6279                      186

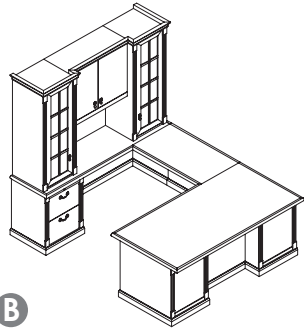

**B**

**configuration**

GXDL01-997877-CD                      98.5" x 78" x 77"                      22,550                      26,635                      982

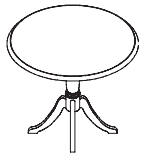

**C**

**Table**

GTR1Y-3636                      36" x 36" x 29"                      2882                      3423                      65  
 GTR1Y-4242                      42" x 42" x 29"                      3357                      4043                      91  
 GTR1Y-4848                      48" x 48" x 29"                      4281                      5131                      111

Model number's	D x W x H	Standard Price (US \$)	LE	Weight (lbs.)
----------------	-----------	------------------------	----	---------------

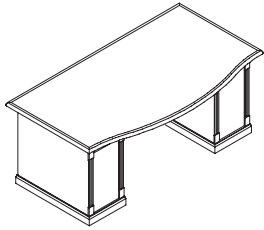

**Table Desk w/ Tulip Top**

GDTT-3966-PP	39.25" x 66" x 29"	7804	9507	199
GDTT-4072-PP	39.75" x 72" x 29"	7954	9775	212
GDTT-4378-PP	42.50" x 78" x 29"	8165	10146	230
GDTT-4384-PP	43.25" x 84" x 29"	8293	10380	241
GDTT-4378-AB	42.50" x 78" x 29"	8165	10146	300
GDTT-4384-AB	43.25" x 84" x 29"	8293	10380	311

D

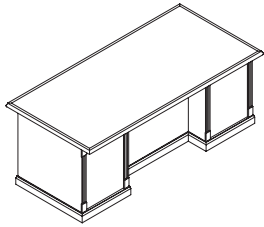

**Double Pedestal Desk**

GD0-3672-AB	36" x 72" x 29"	7777	10008	294
GD0-3678-CD	36" x 78" x 29"	7911	10262	305
GD0-3684-CD	36" x 84" x 29"	8044	10519	316

E

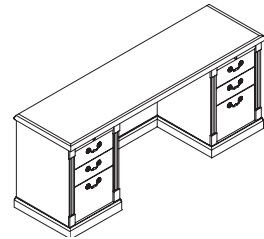

**Double Pedestal Kneespace Credenza**

GC0-2172-AA	20.5" x 72" x 29"	6489	7521	256
GC0-2178-CC	20.5" x 78" x 29"	6598	7625	264
GC0-2184-CC	20.5" x 84" x 29"	6708	7825	272
GC0-2196-CC	20.5" x 96" x 29"	6925	8131	288
GC0-2672-AA	25.5" x 72" x 29"	6613	7738	269
GC0-2678-CC	25.5" x 78" x 29"	6724	7901	278
GC0-2684-AA	25.5" x 84" x 29"	6836	8063	287
GC0-2696-CC	25.5" x 96" x 29"	7062	8388	305

F



<u>Model number's</u>	<u>D x W x H</u>	<u>Standard Price (US \$)</u>	<u>LE</u>	<u>Weight (lbs.)</u>
-----------------------	------------------	-------------------------------	-----------	----------------------

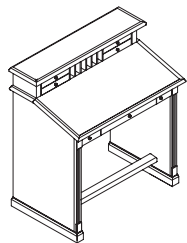

**Stand-Up Desk**

GDI-3348	33" x 48" x 52"	6248	7139	191
GDI-3354	33" x 54" x 52"	6539	7504	214



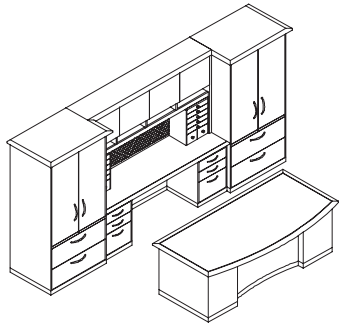

Model number's	D x W x H	Standard Price (US \$)	LE	Weight (lbs.)
<b>Hi-Rise Credenza Config. &amp; Bow Front Desk</b>				
CXJ001-2814476-AA	28" x 144" x 76"	29058	30532	1514
<b>Front Desk</b>				
CDDB-3678-CD	36" x 78" x 29"	8062	9214	305
CDDB-4284-CD	36" x 84" x 29"	8231	9428	316

A

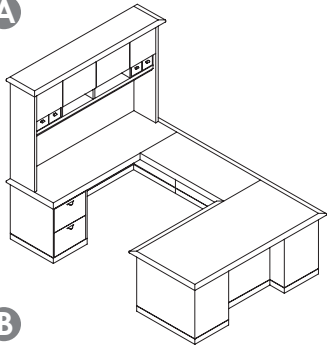

<b>Executive 'U' Configuration</b>				
CXDL01-1043476-AD	104" x 84" x 76"	18542	21045	839

B



<b>Oval Table Desk</b>				
CT016-3472	33.5" x 72" x 29"	9422	11024	150
CT016-3678	36.25" x 78" x 29"	9800	11513	163
CT016-3984	39" x 84" x 29"	10683	12084	179

C

**Model number's**                      **D x W x H**                      **Standard Price (US \$)**                      **LE**                      **Weight (lbs.)**

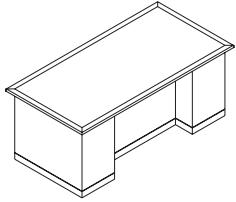

**Double Pedestal Desk**

CD0-3066-AB	30" x 66" x 29"	6731	7580	269
CD0-3072-AB	30" x 72" x 29"	6861	7757	279
CD0-3672-AB	36" x 72" x 29"	7020	7963	294
CD0-3678-CD	36" x 78" x 29"	7151	8141	305
CD0-3684-CD	36" x 84" x 29"	7284	8321	316

**D**

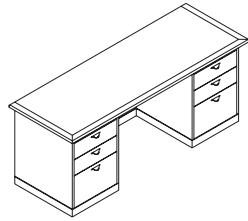

**Double Pedestal Kneespace Credenza**

CC0-2166-AA	21" x 66" x 29"	6214	6766	248
CC0-2172-AA	21" x 72" x 29"	6325	6906	256
CC0-2178-CC	21" x 78" x 29"	6432	7043	264
CC0-2184-CC	21" x 84" x 29"	6543	7185	272
CC0-2666-AA	26" x 66" x 29"	6335	6925	259
CC0-2672-AA	26" x 72" x 29"	6446	7065	269
CC0-2678-CC	26" x 78" x 29"	6558	7209	278
CC0-2684-CC	26" x 84" x 29"	6667	7351	287

**E**

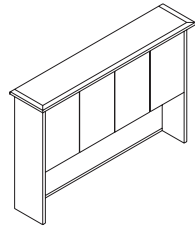

**Medium Profile Hi-Rise Storage**

CSUH21-1666	16" x 66" x 47"	4425	4929	227
CSUH21-1672	16" x 72" x 47"	4520	5053	243
CSUH21-1678	16" x 78" x 47"	4614	5178	259
CSUH21-1684	16" x 84" x 47"	4709	5303	275

**F**

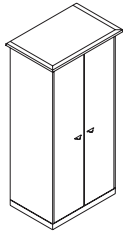

<u>Model number's</u>	<u>D x W x H</u>	<u>Standard Price (US \$)</u>	<u>LE</u>	<u>Weight (lbs.)</u>
<b>One Side Wardrobe/ One Side Shelving</b>				
CSD025-283476	28" x 34" x 76"	6845	6953	418
CSD025-284076	28" x 40" x 76"	7207	7322	463
<b>Full Wardrobe</b>				
CSC011-283476	28" x 34" x 76"	4857	4965	294
CSC011-284076	28" x 40" x 76"	5154	5269	325







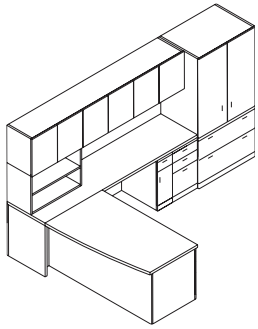

<u>Model number's</u>	<u>D x W x H</u>	<u>Standard Price (US \$)</u>	<u>LE</u>	<u>Weight (lbs.)</u>
<b>Configuration</b>				
_XUR01-729353-gC	84" x 132" x 70.5"	23604		1175

**A**

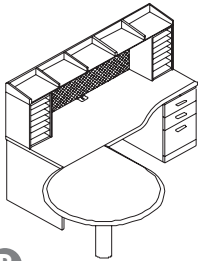

<b>Configuration</b>				
_XTR01-729353-A	72" x 93" x 53"	9991		389

**B**

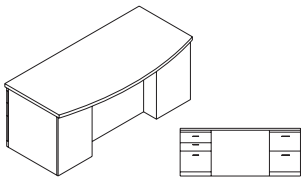

<b>Bow Top Double Pedestal Desk</b>				
_DB00S-3672-CD	30/36" x 72" x 29.25"	4905		292
_DB00S-3678-CD	30/36" x 78" x 29.25"	5029		303
_DB00S-3684-CD	30/36" x 84" x 29.25"	5157		314
_DB00S-4272-CD	36/42" x 72" x 29.25"	5154		307
_DB00S-4278-CD	36/42" x 78" x 29.25"	5282		319
_DB00S-4284-CD	36/42" x 84" x 29.25"	5413		332

**C**

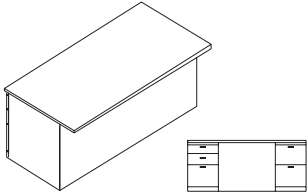
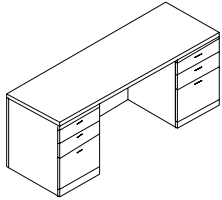
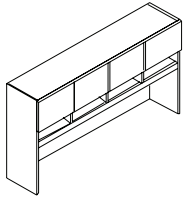

	<b>Model number's</b>	<b>D x W x H</b>	<b>Standard Price (US \$)</b>	<b>LE</b>	<b>Weight (lbs.)</b>	
 <p><b>D</b></p>	<b>Double Pedestal Desk</b>					
	_D0-3072-CD	30" x 72" x 29.25"	4334		277	
	_D0-3078-CD	30" x 78" x 29.25"	4434		287	
	_D0-3084-CD	30" x 84" x 29.25"	4538		297	
	_D0-3672-CD	36" x 72" x 29.25"	4562		292	
	_D0-3678-CD	36" x 78" x 29.25"	4669		303	
	_D0-3684-CD	36" x 84" x 29.25"	4775		314	
	 <p><b>E</b></p>	<b>Credenza</b>				
		_C000L-2072-CKC	20" x 72" x 29.25"	4018		252
_C000L-2078-CKC		20" x 78" x 29.25"	4115		260	
_C000L-2084-CKC		20" x 84" x 29.25"	4209		267	
_C000L-2090-CKC		20" x 90" x 29.25"	4304		275	
_C000L-2096-CKC		20" x 96" x 29.25"	4400		283	
_C000L-2472-CKC		24" x 72" x 29.25"	4208		262	
_C000L-2478-CKC		24" x 78" x 29.25"	4307		271	
_C000L-2484-CKC		24" x 84" x 29.25"	4402		279	
_C000L-2490-CKC		24" x 90" x 29.25"	4501		288	
_C000L-2496-CKC		24" x 96" x 29.25"	4598		296	
 <p><b>F</b></p>	<b>Hinged Door Hi-Rise Storage w/Organizer Bbelow</b>					
	xSUD20-1572	15" x 72" x 41.25"	3653		188	
	xSUD20-1578	15" x 78" x 41.25"	3718		202	
	xSUD30-1584	15" x 84" x 41.25"	4612		220	
	xSUD30-1590	15" x 90" x 41.25"	4677		233	
	xSUD30-1596	15" x 96" x 41.25"	4742		246	
	xSUD21-1572	15" x 72" x 53.25"	4211		258	
	xSUD21-1578	15" x 78" x 53.25"	4300		276	
	xSUD31-1584	15" x 84" x 53.25"	5353		303	
	xSUD31-1590	15" x 90" x 53.25"	5442		321	
	xSUD31-1596	15" x 96" x 53.25"	5528		339	

Model number's	D x W x H	Standard Price (US \$)	LE	Weight (lbs.)
----------------	-----------	------------------------	----	---------------

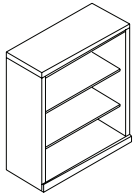

**Bookcase**

_SBU12-153043	15" x 30" x 42.75"	1445		98
_SBU12-153643	15" x 36" x 42.75"	1511		112
_SBU13-153055	15" x 30" x 55"	1676		122
_SBU13-153655	15" x 36" x 55"	1757		139

G

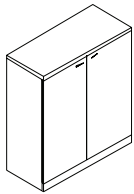

**Hinged Door storage**

xSHU12-163043	16" x 30.125" x 42.75"	2189		112
xSHU12-163643	16" x 36.125" x 42.75"	2348		129
xSHU12-203043	20" x 30.125" x 42.75"	2320		134
xSHU12-203643	20" x 36.125" x 42.75"	2493		153
xSHU12-243043	24" x 30.125" x 42.75"	2455		155
xSHU12-243643	24" x 36.125" x 42.75"	2635		177

H







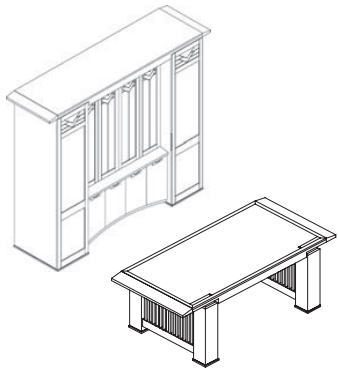

Model number's	D x W x H	Standard Price (US \$)	LE	Weight (lbs.)
----------------	-----------	------------------------	----	---------------

**Full Storage Credenza & Table Desk**

FXJ001-2110584-HHHH-4A	21" x 105" x 84"	33061		993
FXJ001-2111784-HHHH-4A	21" x 117" x 84"	34051		1064
FXJ001-2112984-HHHH-4A	21" x 129" x 84"	36587		1142

**Desk**

FDT-3872-0-OV2	37.5" x 72" x 29.5"	12200		258
FDT-4078-0-OV2	39.5" x 78" x 29.5"	12491		277
FDT-4184-0-OV2	40" x 84" x 29.5"	12862		305

**U-Shaped Workstation w/Run-Off Table & Hi-Rise Storage**

FXDL01-10511984-HCD-3A	105" x 119" x 84"	51398		1487
------------------------	-------------------	-------	--	------

**Round Conference Table**

FTR1W-4848	48" x 48" x 29.5"	8201		174
FTR1W-5454	54" x 54" x 29.5"	9073		222
FTR1W-6060	60" x 60" x 29.5"	10038		274

A

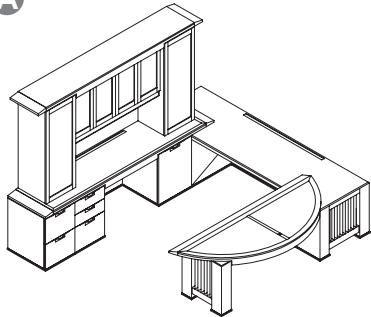

B

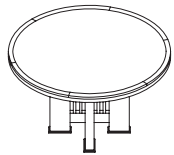

C

**Model number's**      **D x W x H**      **Standard Price (US \$)**      **LE**      **Weight (lbs.)**

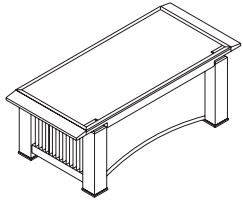

**Double Pedestal Desk**

FD0-4184-AB-OU2  
FD0-4390-AB-OU2

41" x 84" x 29.25"  
43" x 90" x 29.25"

17024  
17478

527  
561

**D**

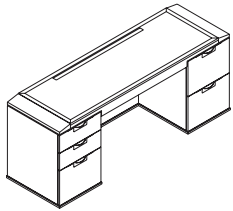

**Kneespace Credenza**

FC0-2472-CKD-PWC  
FC0-2478-CKD-PWC  
FC0-2484-CKD-PWC

24" x 72" x 29.5"  
24" x 78" x 29.5"  
24" x 84" x 29.5"

9477  
9784  
10097

326  
341  
357

**E**

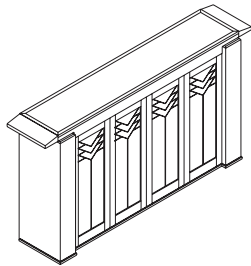

**Bookcase w/ Glass doors**

FSG022-168144  
FSG022-169344

16" x 81" x 44"  
16" x 93" x 44"

14197  
15899

368  
411

**F**

<u>Model number's</u>	<u>D x W x H</u>	<u>Standard Price (US \$)</u>	<u>LE</u>	<u>Weight (lbs.)</u>
-----------------------	------------------	-------------------------------	-----------	----------------------

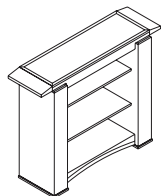

**Open Bookcase**

FSBQ12-165044

16" x 50" x 44"

6195

210

FSBQ12-165644

16" x 56" x 44"

6501

226

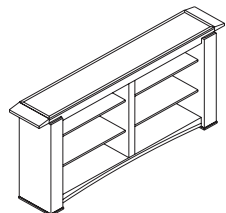

**Open Bookcase**

FSBQ22-168144

16" x 81" x 44"

8720

324

FSBQ22-169344

16" x 93" x 44"

9331

357





Model number's	D x W x H	Standard Price (US \$)	LE	Weight (lbs.)
----------------	-----------	------------------------	----	---------------

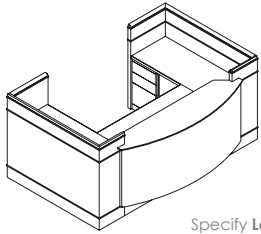

**Prima Vista 'U' Configuration, Rear Entry**

VGM-7286-CD-GL4	72" x 86" x 46"	22167		918
<b>Return Tops:</b>	21.75" x 35"			
<b>Desk Tops:</b>	23" x 82"			
VGM-72100-CD-GL4	72" x 100" x 46"	22928		954
<b>Return Tops:</b>	21.75" x 35"			
<b>Desk Tops:</b>	23" x 96"			

Specify **Left/Right** **Note:** Side entry, single return or no return also available

**A**

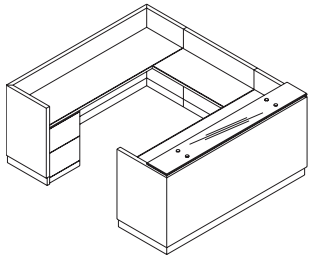

**Kubit 'U' Configuration Side Entry**

KGCL-10272-DC-GL4	102" x 72" x 42"	18893		761
<b>Desk Top:</b>	27.75" x 68"			
<b>Bridge Top:</b>	19" x 46"			
<b>Credenza Top:</b>	24" x 68"			
KGCL-10284-DC-GL4	102" x 84" x 42"	19902		833
<b>Desk Tops:</b>	27.75" x 80"			
<b>Bridge Top:</b>	24" x 46"			
<b>Credenza Top:</b>	24" x 80"			

Specify **Left/Right** **Note:** Rear entry, single return or no return also available

**B**

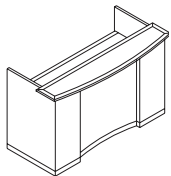

**Charisma Concave Stepped Modesty w/ Return**

CGALD-7772-CD-GL3	72" x 76.5" x 42.5"	13271		632
<b>Return Tops:</b>	65.5" x 24"			
<b>Desk Tops:</b>	40.75" x 22.5"			
CGALD-7784-CD-GL3	84" x 76.5" x 42.5"	13643		676
<b>Return Tops:</b>	22.5" x 40.75"			
<b>Desk Tops:</b>	24" x 77.5"			

Specify **Left/Right** **Note:** Rear entry, single return or no return also available

**C**

**Model number's**                      **D x W x H**                      **Standard Price (US \$)**                      **LE**                      **Weight (lbs.)**

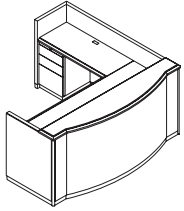

**Tocotta w/ Return**

TGAL-7872CD-GL3	78" x 72.75" x 43"	17191	732
<b>Return Tops:</b>	22" x 40"		
<b>Desk Tops:</b>	28" x 65"		
TGAL-7984-CD-GL3	78.75" x 84.75" x 43"	18068	776
<b>Return Tops:</b>	22" x 40"		
<b>Desk Tops:</b>	28" x 80"		

Specify **Left/Right**      **Note:** Rear entry 'U', side 'U', or no return also available  
Left Shown

**D**

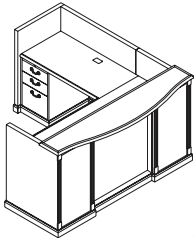

**Barrington w/ Return**

GCAL-7772-CD-GL3	77.25" x 72" x 42.5"	13447	589
<b>Desk Top:</b>	27" x 66"		
<b>Return Top:</b>	22" x 40"		
KGCL-10284-DC-GL4	78.75" x 84" x 42.5"	13909	637
<b>Desk Top:</b>	27" x 78"		
<b>Return Top:</b>	22" x 40"		

Specify **Left/Right**      **Note:** Rear entry, single return or no return also available  
Left Shown

**E**

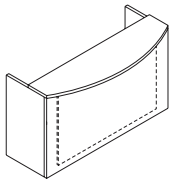

**Foundation Desk**

D0RT-3072-AB-GL2	30" x 72" x 42.75"	6709	451
<b>Desk Top:</b>	28.5" x 69"		
D0RT-3084-CD-GL2	30" x 84" x 42.75"	6981	485
<b>Desk Top:</b>	28.5" x 81"		

**Optional Feature Front:**

IWFI-15838 Vertical grain. Cherry or Maple.  
IWFI-16438 Vertical grain. Cherry or Maple.  
IWFIII-15838 Reverse box pattern. Birdseye Maple.  
IWFIII-16438 Reverse box pattern. Birdseye Maple.

Specify edge profile      **Note:** Rear entry 'U', Side entry 'U' and single return also available

**E**

Model number's	D x W x H	Barrington	Charisma	Weight (lbs.)
----------------	-----------	------------	----------	---------------

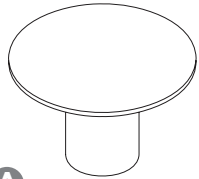

**A**

**Round w/ Drum base & straight grain top**

xTR1D0LG-4242	42" x 42" x 29"	3789*	3721	149
xTR1D0LG-4848	48" x 48" x 29"	4729*	4665	176
xTR1D0LG-5454	54" x 54" x 29"	5366	5277	218
xTR1D0LG-6060	60" x 60" x 29"	5891	5802	242

\* Indicates available w/ cabriole base.

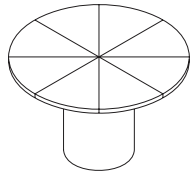

**B**

**Round w/ Drum Base & Sunburst Veneer Top**

xTR1S0LG-4242	42" x 42" x 29"	4312*	4245	149
xTR1S0LG-4848	48" x 48" x 29"	5415*	5348	176
xTR1S0LG-5454	54" x 54" x 29"	6479	6386	218
xTR1S0LG-6060	60" x 60" x 29"	7263	7174	242

\* Indicates available w/ cabriole base.

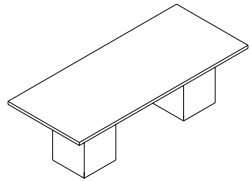

**C**

**Rectangular w/ 2 Cube Bases & Straight Top Grain**

xTS2C0LG-4248	42" x 84" x 29"	6137*	5420	372
xTS2C0LG-4296	42" x 96" x 29"	6489*	5770	389
xTS2C0LG-4896	48" x 96" x 29"	6789*	6074	426
xTS2C0LG-48120	48" x 120" x 29"	7562*	6849	466

\* Indicates available w/ cabriole base.

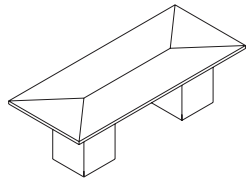

**D**

**Rectangular w/ 2 Cube Bases & Reverse Box Wedge Top**

xTS2C0RW-4248	42" x 84" x 29"	6928*	6211	372
xTS2C0RW-4296	42" x 96" x 29"	7393*	6677	389
xTS2C0RW-4896	48" x 96" x 29"	7824*	7108	426
xTS2C0RW-48120	48" x 120" x 29"	8855*	8142	466

\* Indicates available w/ cabriole base.

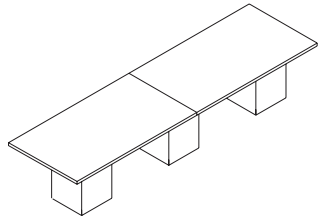

**E**

<u>Model number's</u>	<u>D x W x H</u>	<u>Barrington</u>	<u>Charisma</u>	<u>Weight (lbs.)</u>
<b>Rectangular w/ 3 Cube Bases &amp; Short Grain Top</b>				
xTS3C0SG-54144	54" x 144" x 29"	10688	9597	785
xTS3C0SG-60168	60" x 168" x 29"	12583	11497	865
xTS3C0SG-60192	60" x 192" x 29"	13628	12545	915
xTS3C0SG-60216	60" x 216" x 29"	14710	13630	965

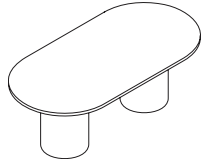

**F**

<b>Racetrack w/ 2 Drum bases &amp; Straight Grain Top</b>				
xTR2D0LG-4282	42" x 84" x 29"	6688*	6547	299
xTR2D0LG-4296	42" x 96" x 29"	7069*	6931	316
xTR2D0LG-4896	48" x 96" x 29"	7531*	7394	353
xTR2D0SG-48120	48" x 120" x 29"	8256*	8123	393

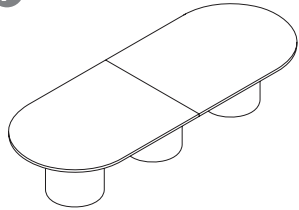

**G**

<b>Racetrack w/ 3 Drum bases &amp; Short Grain Top</b>				
xTR3D0SG-54144	54" x 144" x 29"	11374	11088	620
xTR3D0SG-60168	60" x 168" x 29"	13388	13104	700
xTR3C0SG-60192	60" x 192" x 29"	14387	14109	750
xTR3C0SG-60216	60" x 216" x 29"	15426	15148	800

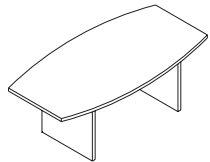

**H**

<b>Boat w/ 3 Panel Bases &amp; Straight Grain Top</b>				
xTB2POLG-4248	42" x 84" x 29"	6892	6240	194
xTB2POLG-4296	42" x 96" x 29"	7428	6774	211
xTB2POLG-4896	48" x 96" x 29"	7671	7021	231
xTB2POLG-48120	48" x 120" x 29"	8805	8159	271

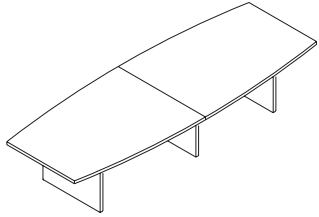

E

<u>Model number's</u>	<u>D x W x H</u>	<u>Barrington</u>	<u>Charisma</u>	<u>Weight (lbs.)</u>
<b>Rectangular w/ 3 Cube Bases &amp; Short Grain Top</b>				
xTB3POSG-54144	54" x 144" x 29"	11836	10862	401
xTB3POSG-60168	60" x 168" x 29"	14094	13122	482
xTB3POSG-60192	60" x 192" x 29"	15502	14533	532

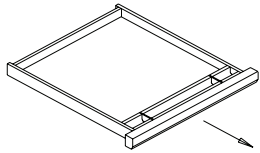

**A**

Model number's	D x W x H	Standard Price (US \$)	LE	Weight (lbs.)
----------------	-----------	------------------------	----	---------------

**Center Drawer/ Personal Drawer**

ACD-21	23" x 21" x 2"	275		
APD-28	23" x 28" x 2"	311		

Front pen and clip tray. Species and finish will match unit (drawer head only).



**D**

**Metal Grommet**

AG 225M	Matte Chrome	90		
	Polished Chrome	90		
	Satin Chrome	90		
	Black Chrome	90		
	Antique Brass	90		
	Polished Brass	90		

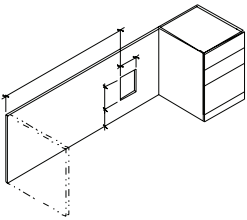

**E**

**Service Opening**

ASO-size		175		
----------	--	-----	--	--

Specify cut out in modesty for access to existing wall outlet.  
Field dimensions to correspond with building required.

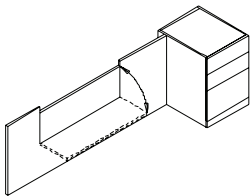

**F**

**Hinged Modesty Panel**

AHMPU		375		
-------	--	-----	--	--

The 2" opening at the top accomodates wire passageway  
36" (maximum) hinged modesty panel. Used in executive  
bridges and credenzas where access to wall mounted  
power/data is needed. Stepped forward to create cavity  
for wires and plugs.





I

Model number's	D x W x H	Finish	Standard Price (US \$)
----------------	-----------	--------	------------------------

**Flip-up Power/Data Module**

ATA-BB	4" x 4"	Brushed Brass	379
ATA-SS	4" x 4"	Brushed Stainless Steel	379
ATA-CH	4" x 4"	Polished Chrome	548

Unit complete with: (2) 15 amp power receptacles, (1) RJ-11 and (1) RJ-45 comm/data recept. Power cord length- 6' (hardware option not available) for flush mounting into worksurfaces. Unit can be installed in conference tables, credenzas, desks and computer tables. Unit flips open and is held by magnets. Mouse hole in top will allow cords to stay connected when unit is closed.

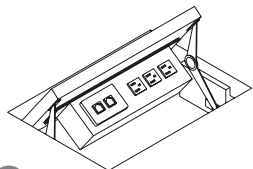

J

**Inset Power / Data Box w/ Flip-up Lid**

AMUPD-WT	12.5" x 5.5"	w/ Black Wood Accent Top w/ Non-Matching Veneer Top Wood Veneer Grain To Match Tbl Top	1026 1026 1271
----------	--------------	--	----------------------

Unit complete with: (3) 15 amp power receptacles, (1) RJ-11 and (1) RJ-45 comm/data recept. Power cord length- 8' (hardware option not available). Accessed by opening a lid that covers the submerged plug-ins. *Can be used in either open or closed position.* Cords are positioned in a slot between the lid and the work surface.

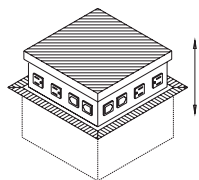

K

**Inset Power / Data Box w/ Flip-up Lid**

APR	13" x 13" (includes .75" brush manager on 4 sides. Extended height is 3")	w/ Black Wood Accent Top w/ Non-Matching Veneer Top Wood Veneer Grain To Match Tbl Top	1780 1780 2017
-----	--	--	----------------------

Unit complete with: (8) 15 amp power receptacles, (4) RJ-11 and (4) RJ-45 comm/data recept. Power cord length- 6' (hardware option not available). Provides access to power and comm/data on all four sides. Flush mounts into table top. Black fiber "brushes" rim parameter of opening to create a clean fit and permit wires to pass through when in a lowered position. Units are spring load-ed-when pressure is applied, unit will 'pop-up'. Press down to retract the unit.



**Model number's** \_\_\_\_\_ **D x W x H** \_\_\_\_\_ **Finish** \_\_\_\_\_ **Standard Price (US \$)** \_\_\_\_\_

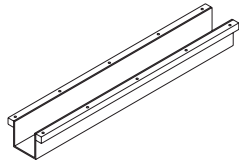

**L**

**Wire Trough**

AWT- (size)

41 per ft.

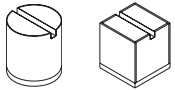

**Wire Pass Through Base**

SWPT

134

Provides a wire passageway when required. Use with wire Trough (see below).

**M**

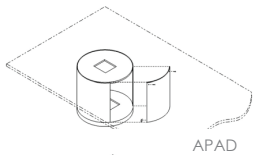

APAD

**Base Access Panel**

APAD  
AHAC

458  
458

Permits access to pwer/data located in the floor and enables power/data routing to the table top.

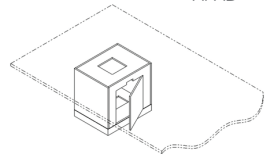

AHAC

**N**

ccnintl.com

CCN

200 LEHIGH STREET

GENEVA NY 14456

315.789.4400

GSA@CCNINTL.COM