



# ICEON™

LIMITER™

#8 SPRING/SUMMER 2014

iceon



iceon®

RIDEICON.COM  
ICON1000.COM



9901-1538



SPAZTYK COLLECTION





# SPAZTYK™ AIRMADA HELMET

## SHINE ON, YOU CRAZY DIAMOND

The Airmada Spaztyk is a metal-flaked highway hero rethought for the digital age. Like a 300-horsepower bass boat blasting across the asphalt void, the Spaztyk pulls not a single punch. Roll with the whirlwind, come with the thunder.

HEADFORM: Long oval

VENTING: Recessed Twin Channel Supervent™

SHIELD: Icon Optics™ fog-free shield with Prolock™

LINER: Custom Hydradry™ moisture wicking liner

CERTIFICATION: World Standard DOT, ECE, SAI\*, SG\*

\*Does not ship with SAI or SG certification sticker unless purchased from an authorized dealer in Australia or Japan.

Available in Gold, Blue, Green, Red, & Purple // 2XS-3X \$270

Dark Smoke Shield Included





# HOOLOGAN SPAZTYK™ STREET JERSEY



## GO FAST, LOOK FLASH

Every season brings with it a new modification, a new tweak, a new touch to your ride—your apparel deserves the same treatment. The Hooligan Spaztyk jacket brings flash back to the streets on an improved Hooligan chassis. Full D30® impact protector package, internally reinforced elbows and shoulders, zip-off forearms, and streamlined FlexCuff™ to reduce bulk on your wrists. Fundamental design choices, made by riders for use by riders. Time to get your Spaztyk on.



**FIT:** Icon relaxed fit

**MATERIAL:** Fighter Mesh™ Chassis

**PROTECTORS:** Full compliment of D30®

impact protectors—shoulder, elbow, back

**LINER:** Insulated SatinCore™ Vest Liner

**DETAILS:** Integrated flex zones, zip-off sleeves, reinforced elbow & shoulder panels, internal zippered pocket with headphone cable management, FlexCuff™ – streamlined, athletic riding cuff

Available in Red, Black, Green, White, & Blue // s-4x \$160

Womens available in Purple and Black // xs-2x \$160





# RAVENOUS™

---

## AIRMADA HELMET



### FLY AS HELL

Birds of a feather flock together, and this is not a flock to be crossed. Preying eyes and aggressive in nature, ravens are birds that can bring good fortune or bad nights. They also like shiny things and popcorn, which is very evil in its own right.

Available In Black // xxs-3x \$250



HEADFORM: Long oval

VENTING: Recessed twin channel Supervent™

SHIELD: Icon Optics™ fog-free shield with Prolock™

LINER: Custom Hydradry™ moisture wicking liner

CERTIFICATION: World Standard DOT, ECE, SAI\*, SG\*

\*Does not ship with SAI or SG certification sticker unless purchased from an authorized dealer in Australia or Japan.



# BIOSKULL™

## AIRMADA HELMET



### ONE POSSIBLE FUTURE

Air-lock chambers whistle under pressure, diagnostic machines weep for reprieve. What started as innocent government research has dovetailed into the oft-hypothesized cybernetic future. Coated in a cylon-esque chrome and black, the Airmada Bioskull is a vision into one possible future.

Available In Chrome // XS-3X \$275

RST Silver Shield Included



**WORLD STANDARD**  
DOT USA • ECE EUR • SAI AUS • SG JPN  
MEETS OR EXCEEDS MULTI-NATIONAL SAFETY & TESTING STANDARDS



HEADFORM: Long oval

VENTING: Recessed twin channel Supervent™

SHIELD: Icon Optics™ fog-free shield with Prolock™

LINER: Custom Hydradry™ moisture wicking liner

CERTIFICATION: World Standard DOT, ECE, SAI\*, SG\*

\*Does not ship with SAI or SG certification sticker unless purchased from an authorized dealer in Australia or Japan.





# EVERYTHING IS PROCESS

Nothing is perfect. Nothing ever finished. Everything is process.



**WATCH THE VIDEO**

[www.rideicon.com/videos/icon-1000-everything-is-process/](http://www.rideicon.com/videos/icon-1000-everything-is-process/)



A photograph of two motorcycles and a car racing through a tunnel at night. The motorcycles are in the foreground, leaning into a turn, with their headlights on. The car is behind them. The tunnel walls are lined with lights, creating a sense of speed and motion.

# THE CHURCH OF INTERNAL COMBUSTION HAD COME TO ORDER

An organ of wretched excess churned out the processional as incense fumed from cast-iron chalices. These were the prophets of speed and they had brought their mechanized gospel to the people.





**THIS WAS  
THE NEW  
SACRAMENT.**

**A CONGREGATION  
RAISED ON THE  
BODY OF FIBERGLASS  
AND THE BLOOD  
OF HI-TEST.**





# OILDALE™ JACKET

## WAXED HERITAGE™ CANVAS CHASSIS

A Waxed Heritage™ coated canvas chassis has enough structure to hold its own in the fiercest conditions. Its unique vintage finish comes on strong and continues to evolve its look over the years. Stretch ballistic nylon panels, the same material used in high-end racewear, are incorporated throughout the jacket block to allow for ample mobility during aggressive riding. A full D30® impact protector package (elbow, shoulder, back) is included with the Oildale, as is the removable insulated SatinCore™ vest liner. YKK® tactical metal zippers, Clarino® trimmed collar, and custom cast-metal badging complete the Oildale's refined machismo.

Available in Brown and Black // S-2X \$250 3X-4X \$260

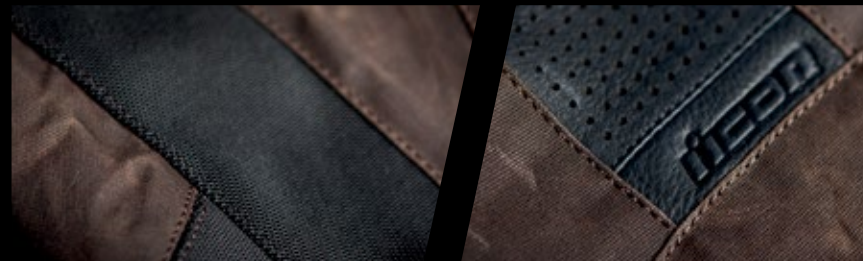

**D30®**  
IMPACT PROTECTION



**FIT:** Icon 1000 sport fit // **MATERIAL:** Waxed Heritage™ coated canvas chassis, stretch ballistic nylon panels  
**PROTECTORS:** Full compliment of D30® impact protectors – shoulder, elbow, back // **LINER:** Insulated SatinCore™ vest liner  
**DETAILS:** YKK® tactical oxide zippers, Clarino® lined collar, custom metal badging, internal zippered & cargo pockets, headphone cable management





# THE IRON LUNG

CUSTOM BUILT BY ICON 1000

She was an accident waiting to happen. 600 pounds of American coke-fired iron riding on weather-checked English rubber. Cracking femurs or rupturing internal organs were her specialties, and she had done both on more than one occasion. The Iron Lung, a 1991 Harley Sportster roadracer, was a vision of what never was, in response to a question that was never asked.



**WATCH THE VIDEO**

[rideicon.com/videos/the-iron-lung](http://rideicon.com/videos/the-iron-lung)



COMETIC

PEI

ACCEL

U/DRIVEN



WISCO

BALLISTIC

Motorcycle



PROGRESSIVE



SAVON





Wide band striping with a central lightning bolt. This mark is unique to ICON 1000 and is derived from the invasion stripes painted on the wings and fuselage of Allied aircraft during the Normandy invasion of WWII.

These stripes allowed rapid identification of Allied aircraft by ground troops in order to prevent friendly fire incidents.







RUBATONE BLACK

HEADFORM: Long oval // VENTING: Recessed twin channel Supervent™  
 SHIELD: Icon Optics™ fog-free shield with Prolock™ // LINER: Custom Hydradry™ moisture wicking liner  
 CERTIFICATION: World Standard DOT, ECE, SAI\*, SG\*

\*Does not ship with SAI or SG certification sticker unless purchased from an authorized dealer in Australia or Japan.



## CHANTILLY™ AIRMADA HELMET

LACE FOR YOUR FACE

Depending on which side of the Atlantic you reside, the word Chantilly can mean numerous things. None of these meanings are particularly masculine or thuggish. Which is precisely why we chose this name for our latest skull-based helmet. It's a dash of high-society class mixed with typical ICON low-brow predilections. Available in a glossy white or matte Rubatone™ black on black to suit your particular savoir-faire.

Available in Gloss White and Rubatone Black // XS-3X \$250







## ***CHANTILLY™ SCARF***

### **VEILED INTENTIONS**

The road can do wonders for one's mind. It can also do a number on one's face. The Chantilly Scarf will have none of it. It's a 30" square of satin luxury to keep your kerosene breath at bay. Other possible uses include the frontal Tupac tie, Hepburn neck wrap, or add a stick and you've got the ultimate hobo carryon. However you decide to use the Chantilly Scarf, always remember—go fast, look flash.

Available in White // \$35





**CORRUGATED  
ALUMINUM PEWS  
REVERBERATED  
AS THE WORD  
WAS DELIVERED.**



**TESTIFIED  
AND  
WITNESSED.**





**FIT:** Icon 1000 sport fit // **MATERIAL:** Herringbone nylon chassis, premium drum-dyed cowhide sleeves  
**PROTECTORS:** Full compliment of D30® impact protectors—shoulder, elbow, back // **LINER:** Insulated SatinCore™ vest liner  
**DETAILS:** Snap back collar, YKK® tactical oxide zippers, custom metal badging, internal zippered & cargo pockets, headphone cable management



## ***VIGILANTE™ JACKET***

### **TAKE MATTERS INTO YOUR OWN HANDS**

The Vigilante understands your prerogative and stands willing to assist by any means necessary. Drum-dyed leather sleeves & trim are combined with a unique herringbone textile chassis to provide the foundation for a formidable riding jacket. The full complement of D30® impact protectors [elbow, shoulder, back] ensure the Vigilante is more than just a ruggedly handsome face. An insulated SatinCore™ vest liner, YKK® zippers, & cast-metal badging complete this unique riding jacket.

Available Black or Dark Earth // S-2X \$285 3X-4X \$300







# ***VIGILANTE DROPOUT™ JACKET***

**ALWAYS CHEAT, ALWAYS WIN**

Rarely does a whispered voice carry over the sound of unbaffled exhausts. If you want to be heard at the track, we suggest you shout. The Dropout is just that voice. Chenille embroidered patches, the same style used on letterman jackets, emblazon the chest of the Dropout Jacket. Patched 1000 sleeve graphics are layered into the full-grain leather sleeves. Full D30® impact protectors (elbow, shoulder, back) are included with the jacket, as is the removable insulated SatinCore™ vest liner.

Available in Black // S-2X \$300 3X-4X \$320



**FIT:** Icon 1000 sport fit // **MATERIAL:** Herringbone nylon chassis, premium drum-dyed cowhide sleeves  
**PROTECTORS:** Full compliment of D30® impact protectors—shoulder, elbow, back // **LINER:** Insulated SatinCore™ vest liner  
**DETAILS:** Chenille embroidered patches, leather trims, snap back collar, YKK® tactical oxide zippers, custom metal badging, internal zippered & cargo pockets, headphone cable management





FIT: Icon 1000 relaxed fit // MATERIAL: 30/70 Kevlar® denim blend // PROTECTORS: D30® impact protectors—knee  
 DETAILS: Outseam protector zipper access, leather trims, YKK® zipper



## ***ROUSER™ DENIM***

### **BATTLE THE ASPHALT**

The ICON 1000 Rouser pant is the next generation in riding denim. It features the abrasion resistance of Kevlar® woven directly into the denim. This integrated Kevlar/denim blend means we can use a simplified construction without the usual riding denim pant drawbacks—no hung liner, no extra paneling, no discomfort—yet still provide 360° coverage.

D30® knee impact protectors, with hidden outseam access zippers, are included for additional riding coverage.

Available in Dark Indigo // 28-44 \$230





# ICON SPEEDMASTER

CUSTOM BUILT BY ICON 1000

The ICON 1000 Speedmaster is the second collaboration between ICON Motorsports and Triumph North America. Crafted in the ICON garage on the stout chassis of a 2013 Triumph Speedmaster, she was a vertical twin of known repute. While her finned cylinders spoke the refined language of an air-cooled era, the twin fork-mounted nitrous bottles shouted in the most egregious modern slang.

TRIUMPH X *icon*



WATCH THE VIDEO

[rideicon.com/videos/speedmaster](http://rideicon.com/videos/speedmaster)



TRIUMPH

PROGRESSIVE  
SUSPENSION

Castrol

Icon

GALPER

Castrol

Icon

Icon

Icon

Icon

Icon

Icon

Icon



The overall goal of any bike called 'Speedmaster' should be just that. We chose a straightline approach to prove the Speedmaster worthy of her name.

Tuned motor, ram-air intakes, bespoke exhaust and the wet nitrous system perform the lion's share of the go-fast requirements. Period-correct drag slick, swing-arm-mounted battery, and low-slung ergonomics make sure the CG and ETs stay low throughout the entirety of her quarter-mile territory.

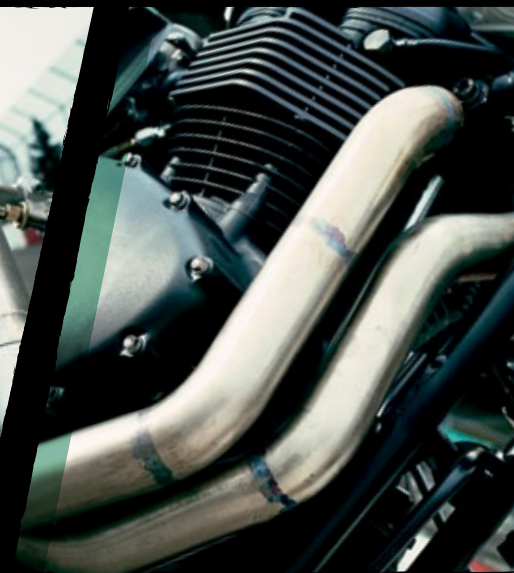





## **ODL™ JACKET**

**STAY WARM, LOOK COOL**

One can never be too rich or too handsome or have too many hoodies. If you're looking for something a bit different for this season, then the ODL may be right up your head-covering alley. The ODL, or Ole Dirty Leroy, is a nylon windbreaker shell wrapped over a 160 gram fleece lining, making it all kinds of warm...and cool.

The embroidered applied chest logo says ICON One Thousand the world over.

Now is the time to be rich, handsome, and hooded.

Available in Black // s-3x \$95



FIT: Icon 1000 sport fit // MATERIAL: Nylon shell, 160-gram fleece lining // DETAILS: Embroidered applied graphics, doubled pockets, custom zippers, leather toggles





FIT: Icon 1000 sport fit // MATERIAL: Softshell with a mesh lining // DETAILS: Water resistant shell, hidden side-entry zipper, custom buttons



## ***STAVANGER™ HOODIE***

### **LAYER UP, NORSKE STYLE**

Stavanger is a fishing community located on the southwestern coast of Norway. Cod, mackerel, and herring can all be found in great abundance in its North Sea fisheries. Along its harbor front are the cafes where the original ICON 1000 ideology and designs were first penned. In homage to our favorite Scandinavian city, we crafted the Stavanger Hoodie. It's a four-button Anorak block with a hidden side-entry zipper. The heathered-finished softshell chassis is perfect for tying up the snekke at the dock, or tying on an overnight drunk in town.

Available in Heather Grey // s-3x \$135



**FOR WHAT  
WE HAVE  
DONE.**

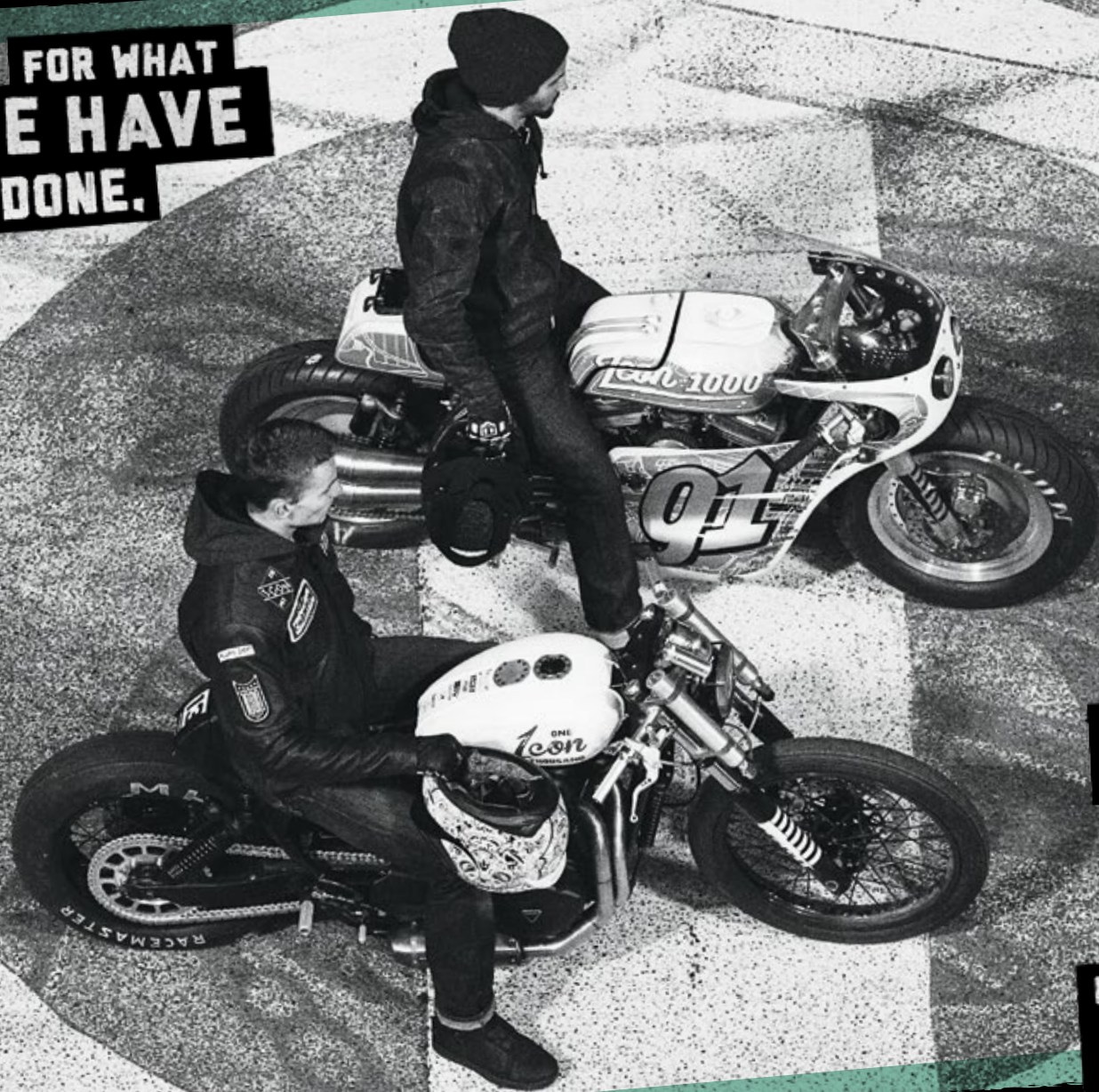

**FOR WHAT  
WE ARE  
ABOUT  
TO DO.**





# ***HARD LUCK™ VARIANT HELMET***

## **NEVER TELL ME THE ODDS**

Black ink sleeved across its raw construct shell speaks to the Hard Luck's felonious intent. 13's emblazoned across its flanks sneer politely at the society from which it was ostracized. The Hard Luck will never taste a silver spoon or know the loving embrace of a fat trust fund. It's the helmet for street cowboys looking for anything heavy.

Available In Black Construct // xs-3x \$390

Dark Smoke Shield Included



**WORLD STANDARD**  
DOT USA • ECE EUR • SAI AUS • SG JPN  
MEETS OR EXCEEDS MULTI-NATIONAL SAFETY & TESTING STANDARDS



HEADFORM: Intermediate oval // VENTING: Multiple oversized intake and exhaust ports  
SHIELD: Fog-Free™ Precision Optics Shield // LINER: Custom Hydradry™ moisture wicking liner  
CERTIFICATION: World Standard DOT, ECE, SAI\*, SG\*

\*Does not ship with SAI or SG certification sticker unless purchased from an authorized dealer in Australia or Japan.





# ***HARD LUCK™ AIRMADA HELMET***

**TEMPT FATE, CHEAT DEATH**

Leave luck for the unprepared—you've got bigger fish to fry. Namely the new fish on the block. The Airmada Hard Luck appreciates both your surly disposition and lack of superstition. You rock the thirteen because you give not one F. Go your own way, and we'll see you on the other side.

Available in Gloss Red and Rubatone Black // xs-3x \$265  
Dark Smoke Shield Included



**WORLD STANDARD**  
DOT USA • ECE EUR • SAI AUS • SG JPN  
MEETS OR EXCEEDS MULTI-NATIONAL SAFETY & TESTING STANDARDS



RUBATONE BLACK

HEADFORM: Long oval // VENTING: Recessed twin channel Supervent™  
SHIELD: Icon Optics™ fog-free shield with Prolock™ // LINER: Custom Hydradry™ moisture wicking liner  
CERTIFICATION: World Standard DOT, ECE, SAI,\* SG\*

\*Does not ship with SAI or SG certification sticker unless purchased from an authorized dealer in Australia or Japan.





## ***LUCKY TIME™ AIRMADA HELMET***

**ALWAYS CHEAT, ALWAYS WIN**

Rabbit's feet, three kisses to your lid, a special pair of socks—we all have a little piece of faith in our ride warm-up. But should your luck run thin, you might want a little extra. Enter the Airmada Lucky Time. There's nothing wrong with stacking the deck in your favor.

Available in Black Rubatone // XS-3X \$265

Dark Smoke Shield Included

HEADFORM: Long oval // VENTING: Recessed twin channel Supervent™  
SHIELD: Icon Optics™ fog-free shield with Prolock™ // LINER: Custom Hydradry™ moisture wicking liner  
CERTIFICATION: World Standard DOT, ECE, SAI,\* SG\*

\*Does not ship with SAI or SG certification sticker unless purchased from an authorized dealer in Australia or Japan.







## ***1000 BAD NEWS™ SHOP SHIRT***

Custom high density twill fabric  
65% Cotton / 35% Polyester  
Embroidered chest and sleeve graphic  
Custom buttons

Available in Heather Grey // s-3x \$65



## ***1000 AM SCREAMER™ HAT***

50% Cotton / 50% Polyester  
3D embroidered graphic  
Available in Black // SM/M-L/XL \$25





## ***1000 TWO TIMER™ TEE***

50% Cotton / 50% Polyester // Screen printed graphic

Available in Heather Blue and Heather Grey // M-2X \$25





# ICON 1000 WOMENS







FIT: Icon 1000 womens sport fit // MATERIAL: Waxed Heritage™ coated canvas chassis, stretch ballistic nylon panels  
 PROTECTORS: Full compliment of D30® impact protectors—shoulder, elbow, back // LINER: Insulated SatinCore™ vest liner  
 DETAILS: YKK® tactical oxide zippers, clarino lined collar, custom metal badging, internal zippered & cargo pockets, headphone cable management



# HELLA 1000™ WOMENS JACKET

## SPEEDWAY FABULOUS

True womens riding jackets that fit, flatter, and function are a rare commodity. The Hella 1000 performs in all these categories by offering women world-class performance and panache. The Hella 1000 jacket features a Waxed Heritage™ coated canvas chassis with supple drum-dyed leather trims. Stretch ballistic nylon panels, the same material used in high-end racewear, are incorporated throughout the jacket block to allow for ample mobility during riding. Custom black oxide snaps and YKK® tactical metal zippers are used for long-term durability. The interior of the Hella 1000 is just as impressive, with a full complement of D30® impact protectors [elbow, shoulder, back] and removable quilted SatinCore™ liner.

Available in Brown and Black // xs-2x \$275







FIT: Icon 1000 womens overpant fit // MATERIAL: Waxed Heritage™ coated canvas chassis, drum-dyed leather panels  
 DETAILS: YKK® tactical oxide zippers, custom metal badging, fully adjustable waist, adjustable length  
 for a custom fit



# ***HELLA 1000™ WOMENS CHAPS***

## **OUTFIT YOUR MODERN COWGIRL**

Built on ICON's proven chap pattern, the Hella 1000 Chaps are a perfect fit for the modern women rider. The Hella 1000 features a Waxed Heritage™ canvas chassis with large external panels of drum-dyed leather. The length is left extra long and is adjustable for a custom fit.

Available in Black // s-xl \$165





## ***CHANTILLY™ WOMENS HOODIE***

55% Cotton / 45% Polyester  
Soft hand screen printed graphic // Fitted

Available in White // s-2x \$40



## ***1000 VIRTUE™ WOMENS SHOP SHIRT***

Custom high density twill fabric  
65% Cotton / 35% Polyester  
Embroidered chest and sleeve graphic  
Hidden closure snaps

Available in Heather Grey // xs-2x \$60





## ***WOMENS STRIKE™ TANK***

100% Cotton // Screen print graphic // Fitted

Available in Black // s-2x \$25



## ***WOMENS AM SCREAMER™ TEE***

100% Ring spun cotton // Discharge printed

Available in Olive // s-2x \$25





# BUSTED & BROKEN™

The moment when your tires coefficient of friction fails to work in your favor. It is in that instant that good becomes bad, upright becomes laid-down, and factory shine is transformed into shattered and rashed.

Crashing does not discriminate between experienced or newbie. It doesn't care if you're sport, touring, v-twin, or commuter.

If you can accept the inevitability of this occurrence then you've passed the entrance exam into the cult of motorcycling. Dress for the crash is a damned fact. ICON has been promoting this decision since our inception. We build quality gear, with a truly unique flair, designed to take the hit we assure you is coming.

For those who have first hand knowledge of the harsh realities of asphalt, while wearing ICON gear, we have created the Busted & Broken club. A community of brothers and sisters who understand your pain because they've already been through it.



Send us your crash story and receive the Busted and Broken wrist band.

[www.rideicon.com/busted-and-broken](http://www.rideicon.com/busted-and-broken)





# STREET SUPERIORITY

The next-generation supersport jacket defined: lighter, cooler, more agile, while still maintaining the undeniable qualities of leather. The Sanctuary™ collection works with the rider providing a highly-defensible space, as well as the athleticism required for riding modern sport motorcycles.

**D3O**  
IMPACT-PROTECTION

SHOULDER  
ELBOW  
BACK







## COOLER

Multiple panels of unit-fused mesh, chest perforations, and unique cuff venting will keep you running cooler, longer.

## LIGHTER

1.2-1.4mm Brazilian leather is used in all the primary impact zones for excellent coverage while an engineered Dynax™ nylon is utilized in secondary tumblezones to provide coverage without unnecessary bulk.

## MORE AGILE

Articulated flex zones in the shoulders and elbows allow for the rider mobility necessary on modern sportbikes.

## PROTECTORS

The Sanctuary is equipped with a full complement of D30® Impact Protector—Shoulders, Elbows, Back.



# SANCTUARY<sup>™</sup> JACKET

Available in Hi-Vis Yellow, Grey, Green, Stealth, Red, White & Blue

SM-2X \$300 // 3X-5X \$330





# SANCTUARY™ GLOVE

Unit-fused construction decreases weight while the mesh backhand provides ventilation. The Battlehide™ goatskin palm provides necessary street legitimacy and a synthetic suede knuckle adds unique touch points of reinforced paneling.

Available in Stealth, Red, Green, & Blue

SM-4X \$70







## ***HEIRESS™ WOMENS POLO***

150 gm 100% polyester construction

Embroidered chest graphic

Available in Gunmetal // xs-2x \$40



## ***KINGSLY HERO™ WORK SHIRT***

35% Cotton / 65% Polyester chassis

Embroidered applique hero graphics package

Custom buttons // Shop shirt fit

Available in Black // s-3x \$65





## ***FUSED™ HAT***

83% Cotton / 15% Wool / 2% Spandex  
Welded rubber logo // Flat bill

Available in Black // S/M-L/XL \$20



## ***STAND UP™ TEE***

100% Ring spun cotton // Screen printed graphic

Mens available in Red & Charcoal // M-2X \$20

Womens available in Black // S-2X \$25







## ***BLOX™ TEE***

100% Ring spun cotton // Screen printed graphic

Available in Heather Grey // M-2X \$20



## ***CHARMER™ TEE***

100% Ring spun cotton // Screen printed graphic

Available in Grey // M-2X \$20







## ***ICON MOLDED HELMET CASE***

The world is unforgiving to a helmet left by its lonesome. Jealous, prying eyes, sticky fingers, and the unwashed masses can really smudge up your pride and joy. The ICON Molded Helmet Case is protection your ICON lid\* needs—nay—deserves.

Available in Heather Grey // \$90

\*Does not fit Variant Helmet



## ***ICON STASH BAG***

This is no ordinary poly stash bag, but fleece backed to keep your possessions from rattling around, and give them the care they deserve. Carry your knick knacks, your paddy whacks, even the bone for your dog. Carry it all, everywhere.

Available in Black // \$20





# THE CONTAINMENT CONFLICTS



[www.rideicon.com/videos/the-containment-conflicts/](http://www.rideicon.com/videos/the-containment-conflicts/)

The abandoned nuclear facility laid creaking before us. This is the nest. Here, humanity reached its moment where the wings started to melt and the cruel grip of reality dragged us down from flight. Here, nuclear disaster begat a new era of irradiated lurching hordes. Now, the location of our greatest defeat will now be home to our greatest victory.

The mission - contain the undead by any means necessary. Victory halts contamination to the rest of the world. Defeat is not an option. Equipped with the absolute latest armaments, apparel, and transportation, the hunters are the armored line between tranquility and chaos.

ICON 1000 PRESENTS  
NICK BROCHA AND ERNIE VIGIL IN "THE CONTAINMENT CONFLICTS"  
[WWW.ICON1000.COM](http://WWW.ICON1000.COM)



AN ICON 1000 JOINT





ICON 1000

## Navigator™ Collection

### PRODUCT INFORMATION

There was a time, in this fair land, when the railroad did not run. It was not until an international team of laborers, known as navigators, laid the steel rails across the whole of North America that the continent truly came to life.

The ICON 1000 Leather Navigator Collection was named after these 'navvies.' Hard working, hard living, and constantly on the move. They carried but a few precious items, kept close to their person, as they moved from station to station. The Navigator Portfolio, Wallet, and Keychain are worthy contemporaries to the needs of this mobile lifestyle.







#### PRODUCT NAME

# Leather Navigator™ Portfolio

#### PRICE

## \$65

#### PRODUCT INFORMATION

A life of constant travel, work, and hard living. The ICON 1000 team knows this life all too well—hours upon hours of overseas flights, weeks upon weeks on photo-shoot locations, or miles upon miles of road tests. Every member of the 1000 team runs a Navigator Portfolio equipped for their own personal mission. Load it with tools, mini-tablet, cables, passport, foreign currency, sketchbook, markers, etc. Make it personal, keep it close, and Godspeed on your next journey.

#### SIZE

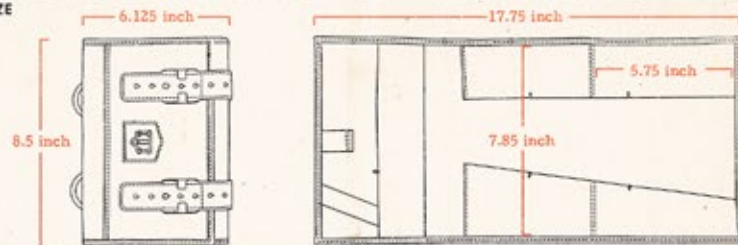

#### MATERIALS

Oiled Nissan Burnish Leather & Waxed Canvas Construction

#### FEATURES

- Trifold pattern with five internal pockets allows various storage configurations
- Large exterior pocket perfect for boarding passes
- Cast alloy post-clasps and reinforced leather straps
- Metal D-Rings allow for various mounting possibilities

#### EXAMPLE STORAGE CONFIGURATIONS

Tools



Electronics



Travel







PRODUCT NAME

## Leather Wallet

PRICE

\$50

### PRODUCT INFORMATION

You owe yourself a quality wallet and the Navigator™ delivers. Simple, effective, and low-profile the Navigator keeps all your monetary and identification needs securely at hand. Its burnished Nissan leather chassis grows richer with the age & experience you will show it on your journey. Treat it well, and it will return the favor in kind.

### SIZE

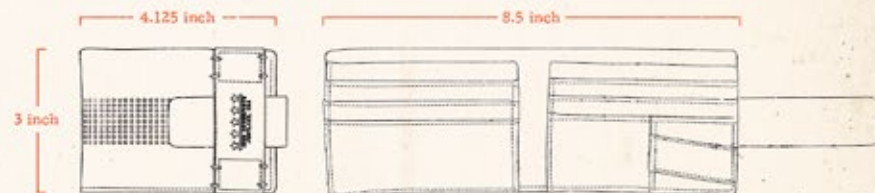

### MATERIALS

Oiled Nissan Burnish Leather & Waxed Canvas Construction

### FEATURES

- Bifold chassis with leather closure strap
- Six internal card pockets and one currency slot





---

**PRODUCT NAME****Leather Belt Loop Keychain****PRICE****\$35**

---

**PRODUCT INFORMATION**

Keep your keys at the ready with the Navigator™ Keychain. The burnished leather strap fits over most belts and secures with a custom cast post-clasp, while a quick-release trigger hook allows instant access to your keys.

---

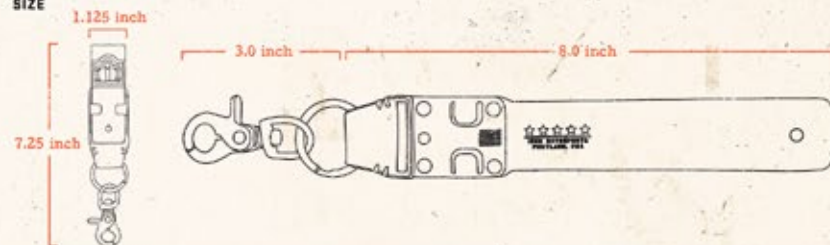
**SIZE**

---

**MATERIALS****Oiled Nissan Burnish Leather & Waxed Canvas Construction**

---

**FEATURES**

- Bifold leather strap with cast alloy post-clasp
- Swivel trigger snap hook