

## PACKAGE CONTENTS

Thermostat with Mounting Plate  
2 X Electrical Box Mounting Screws  
2 X Wood Mounting Screws  
2 X AAA Batteries  
Instruction Manual

## REQUIRED TOOLS (NOT INCLUDED)

Phillips and Small Flat-head Screwdriver  
Small Pliers (Needle-nose)  
May Need Drywall Inserts

## OPTIONAL TOOLS (NOT INCLUDED)

Wire Cutters/Stripper  
Small Level

flamew<sup>o</sup>rks

## INSTRUCTION MANUAL



fire-parts.com

## NON-PROGRAMMABLE FIREPLACE THERMOSTAT



**WARNING:** THIS THERMOSTAT IS DESIGNED AND TESTED FOR GAS FIREPLACES THAT FEATURE AN ELECTRONIC IGNITION SYSTEM WITH A MAXIMUM VOLTAGE OF 24 VOLTS/8 AMPS OR A STANDING PILOT/ MILLIVOLT IGNITION SYSTEM AND IS NOT INTENDED FOR USE WITH ELECTRIC FIREPLACES OR BASEBOARD HEATERS.

### BEFORE YOU START

**Please ensure that your fireplace is currently functional** and will work **with the existing switch or thermostat** or by crossing the two wires.

If this cannot be verified easily or you need some guidance, you can learn how to test the switch circuit on our website at:

<http://www.flameworxpro.com/how-to>

CLICK ON THE VIDEO TITLED:

“Testing the Switch Circuit in a Millivolt Fireplace”

More information about this product can be found at  
<http://www.flameworxpro.com/>

### SPECIFICATIONS

Thermostat operating voltage:	2 X AAA 1.5V Alkaline Batteries
Backup storage:	EEPROM
Maximum Voltage (ohmic) load:	8A.
Switch contacts:	NO and COM
Temperature settings:	40°F – 95°F, 1°F increments 4°C – 35°C, 0.5°C increments
Accuracy:	Plus or minus 1 degree
Dimensions: (including base)	5 5/8" X 3 3/8" X 1" 135mm X 87.5mm X 25.4mm
Color:	White
IP protection rating:	20.
Certification:	CE.

# THERMOSTAT OPERATION DETAILS

*NOTE: Fireplace will not work when thermostat display is turned off. Ensure that the thermostat is on when using the fireplace.*



Large display can be clearly read with white background lighting.



Click knob to activate back-lit screen and “set temperature” function



Turning knob clockwise raises temperature setting. Temperature changes will take a few seconds to activate.



Turning the knob counterclockwise lowers temperature setting. Temperature changes will take a few seconds to activate.

**SET/GOAL TEMPERATURE**

**MEASURED ROOM TEMPERATURE**

The display will show the set temperature as well as the measured room temperature. (See page 3 for instructions on how to change from Fahrenheit to Celsius)

**“FIREPLACE ON” INDICATOR**

“Fireplace On” indicator (represented by icon above) will appear in upper right of screen when fireplace is on.

When display is on, click knob again to turn display off. Fireplace will not function when display is off.

# MENU MODE

This thermostat is setup with default settings that are commonly used and does not require additional changes made in the menu. However, you may wish to make some adjustments which can be done in Menu Mode.



MENU OPTION

SETTING TO BE CHANGED

**ENTERING MENU MODE:** With display off, hold knob in for about **5 seconds** until display shows two numbers with a "1" towards the upper left. The lower right number may vary.

The number on the upper left signifies which menu option you are on. There are 4 menu options:

1 TEMPERATURE OFFSET

2 TEMPERATURE SCALE (°F TO °C, °C TO °F)

**Menu settings 3 and 4 are not currently used and cannot be adjusted**

## NAVIGATION



CLICK KNOB TO NAVIGATE BETWEEN MENU OPTIONS



TURN KNOB TO CHANGE SETTING VALUE



HOLD THE KNOB IN FOR 5 SECONDS TO SAVE SETTINGS AND RESTART THE THERMOSTAT

### 1 CHANGING TEMPERATURE OFFSET (+/- 1°F, +/- 0.5°C)

Temperature offset lets you adjust your thermostat reading if your thermostat is located in a slightly warmer or colder location than the rest of the room. It can also be used to adjust temperature reading to match your old thermostat.

MENU OPTION "1"

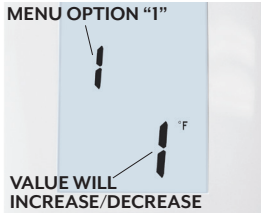

VALUE WILL INCREASE/DECREASE

INCREASE



DECREASE



With upper left number set at "1", turn the clockwise to increase the temperature offset, or counterclockwise to decrease it.

The number on the bottom right

### 2 SWITCHING TEMPERATURE SCALE (°F TO °C, °C TO °F)

This thermostat reads in Fahrenheit by default, but this can be changed in Menu Option 2. To access Menu Option 2, click the button knob while in Menu Mode until the upper left number reads "2"

MENU OPTION "2"

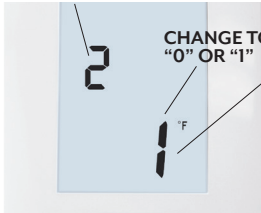

CHANGE TO "0" OR "1"

SWITCH BETWEEN "0" AND "1"



With upper left number set at "2", turn the knob to switch the number on the bottom right between 0 or 1.

0

"0" will change the display to Celsius (°C)

1

"1" will change the display to Fahrenheit (°F)

# REMOVING OLD THERMOSTAT OR WALL SWITCH

## BEFORE YOU BEGIN

### ELECTRONIC IGNITION FIREPLACES:

When working with an electronic ignition system fireplace, turn off the power to prevent electrical shock and/or equipment damage. Disconnect electrical power to the system at the control module or spark ignition module, junction box in fireplace or circuit breaker box. **Do not restore power until installation is complete.**



**WARNING:** FAILURE TO DISCONNECT POWER MAY CAUSE ELECTRICAL SHOCK AND OR DAMAGE TO THE CONTROL SYSTEM.

### STANDING PILOT SYSTEM:

When working with a standing pilot system, disable the main burners by turning the gas control off or to the pilot position to avoid fireplace turning on during installation process.

**This product does not contain mercury. However, this product may replace a product that contains mercury. Mercury and products containing mercury must not be discarded in household trash. See below:**



**CAUTION:** YOUR OLD THERMOSTAT MAY HAVE A SEALED GLASS TUBE CONTAINING MERCURY. BE CAREFUL NOT TO DAMAGE THE TUBE OR DISPOSE OF THE TUBE IN YOUR TRASH. FOR SAFE DISPOSAL INFORMATION, PLEASE SEE **MERCURY NOTICE** BELOW:

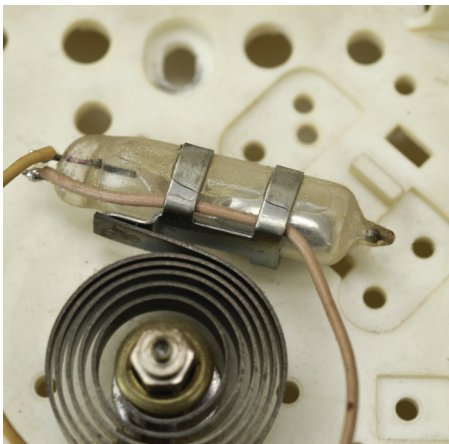

*Appearance, configuration, and placement may vary*

## MERCURY NOTICE

### USA:

The thermostat industry recognizes the need for proper disposal of mercury thermostats and has established a recycling program for such devices.

To locate your nearest thermostat recycling center, visit:

**<https://www.thermostat-recycle.org/>**

and enter your zip code in the upper right corner of the homepage to generate a list of approved collection centers in your area.

### CANADA:

**<https://www.hrai.ca/thermostat-recovery-program>**

**NOTE:** There is no standard color code for thermostat wires, so your wire colors may vary.

Some thermostat or fireplace switch setups may have multiple wires. Ensure that you use some method to keep track of which wires are used in the old setup, so that you can use the same wires on the Flameworks thermostat. Small pieces of tape or small labels work great for this purpose.

➡ **TIP:** Taking a picture with a camera or smartphone can help you not only remember how wires are connected to the terminals, but can also ensure that you label your wires correctly.

➡ **TIP:** To help prevent your wires from falling into the wall, keep them secure by wrapping them around a pencil or pen, or use a paperclip to secure the wire.

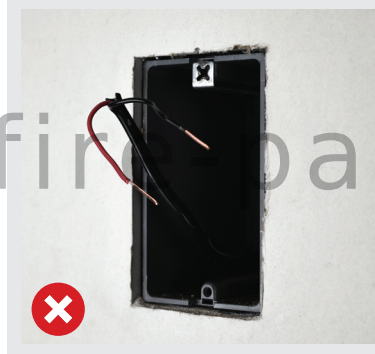

## REMOVING OLD THERMOSTAT (PART ONE)



Remove the front cover of the existing thermostat from the wall base. Some covers pull off easily, while others may need to be released by using a screwdriver.

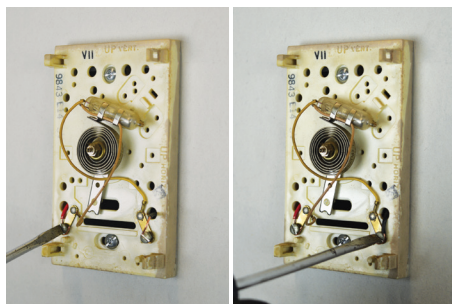

Using your screwdriver, carefully unscrew one wire at a time from the old terminal block (if there are more than two wires, attach some tape or label stickers to mark the two wires that were attached to your thermostat).

## REMOVING OLD THERMOSTAT (PART TWO)

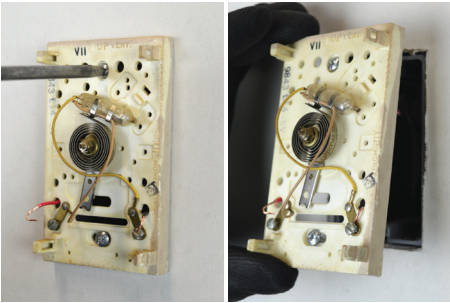

Unscrew the screws that attach your base plate to the wall. With your wires disconnected\* (and properly labeled if there are multiple wires), you may now safely remove the thermostat base from your wall.

*\*Take care to secure the wires so that they will not fall into your wall*

## REMOVING OLD FIRE PLACE WALL SWITCH

*NOTE: These instructions are intended for an existing fireplace ON/OFF wall switch and not a light switch.*



Remove the two flat head screws, then remove the switch cover plate.

Unscrew the switch and carefully pull it away from the wall. Be aware that the wires are still attached.

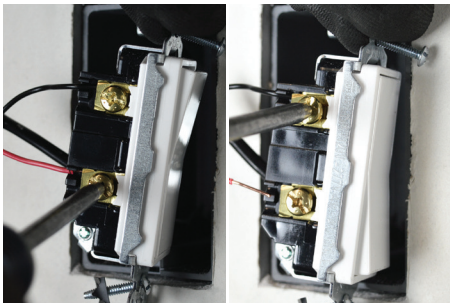

Using your screwdriver, carefully unscrew one wire\* at a time from the switch (if there are more than two wires, attach some tape or label stickers to mark the two wires that were attached to your switch).

*\*Take care to secure the wires so that they will not fall into your wall*

# INSTALLING NEW THERMOSTAT

Note: this new thermostat base has a footprint of 3" wide X 4" tall  
Your existing thermostat may not be the exact same size.



Bring the wires through the square opening on the base plate and install the new base plate using the supplied screws.



Use wood screws (have a pointed end) if there is no switch box, and machine screws (no point) if there is a switch box.

*If you are not using a switch box, you may need to use drywall inserts. You can use a level to determine position if desired.*



Make sure the "up" arrows are oriented correctly based on the style of thermostat (vertical mount).

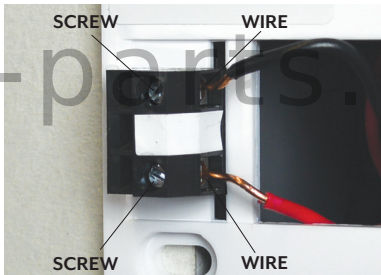

Insert wire into terminals and tighten screws to secure in place using a small flathead screwdriver.  
**In this case, the order and color of wires does not matter. Either wire can be inserted into either terminal.**

*Ensure that the wires are installed into the side of the terminal and NOT the top.*



Install the included 2 X AAA Alkaline batteries noting the polarity as indicated. Reattach the battery cover.



Align the cover to the base and push the front cover on to the thermostat base until it's secure.



Turn on the power or turn the gas valve back to the on position and your thermostat should be fully functional.

## FLAMEWORKS Limited Warranty

---

FLAMEWORKS warrants the FLAMEWORKS product for one year. This warranty is not transferable to another person and is for the original purchaser of the product. Should any part fail because of defective workmanship or material from the original date of purchase, FLAMEWORKS will repair or, at FLAMEWORKS option, replace the defective parts. A replacement will be available at no charge for the first year of this warranty. The Owner must provide a bill of sale, or payment record should be kept to verify purchase date and establish warranty period. Travel, diagnostic cost, service labor to repair the defective SYSTEM, will be the responsibility of the owner. FLAMEWORKS will not be responsible for labor charges and/or damage incurred in installation, repair, replacement, or for incidental or consequential damages. Batteries and any damage caused by them are not covered by this warranty. This warranty does not cover claims, which do not involve defective workmanship or materials. Damage to the SYSTEM caused by accident, misuse, abuse, or installation error, whether performed by a contractor, Service Company, or owner, is not covered by this warranty. Modification of the FLAMEWORKS product will void this warranty. IN NO EVENT SHALL FLAMEWORKS BE LIABLE FOR INCIDENTAL AND CONSEQUENTIAL DAMAGES INCLUDING THE IMPLIED WARRANTIES OF MERCHANTABILITY AND FITNESS, ARE LIMITED TO THE DURATION OF THIS WRITTEN WARRANTY. THIS WARRANTY SUPERSEDES ALL OTHER ORAL OR WRITTEN WARRANTIES. Some States do not allow the exclusion or limitation of incidental and consequential damages or limitation on how long an implied warranty lasts, so the above limitation may not apply to you. This warranty gives you specific rights and you may have other rights, which vary from state, province, and nation.

fire-parts.com

FOR MORE INFO, VISIT OUR WEBSITE AT

[flameworkspro.com](https://flameworkspro.com)