

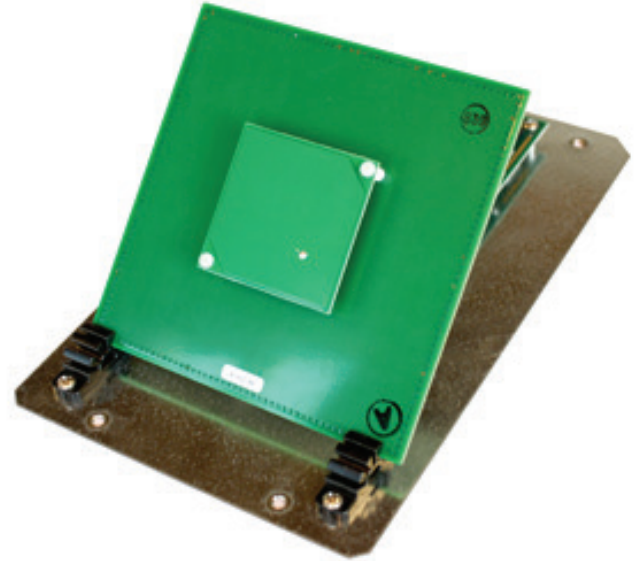

## 60003W | Location Device Node Wall Mount

The 60003W Location Device Node (LDN) monitors multiple 2.4 GHz RF channels from tag transmissions to determine accurate tag proximity. Locators maintain radio communication with the Crisis Controller Software via 900MHz. This device is intended for wall mount positions and provides antenna angle placements of 15, 30, 45, 75 and 90 degrees from the mounting surface.



### Features & Benefits

- Compatible with the PALS® 9K systems and Crisis Controller® Software
- Able to transmit in the harshest RF environments
- Long range transmission
- Allows use of two call cables
- Extended battery life  
*(up to 48 months depending on features and usage)*
- Full transmitter supervision includes alarms for low battery, tamper, and inactivity
- Returns accurate RF location
- Easy Installation  
*(consult installation manual for outdoor/high moisture applications)*
- Back tamper for tamper protection

### Specifications

#### DIMENSIONS

5" x 6" x 5" (HxWxD)

#### OPERATING TEMPERATURE

0 to 50 degrees Centigrade

#### WEIGHT

8 ounces

#### POWER REQUIREMENTS

9 to 24 VDC

#### POWER CONSUMPTION

180mA *(Refer to page 2 LDN Power Consumption graph for start up voltage)*

#### RF DETECTION RANGE

Up to 40 feet  
*(dependent on installation height and structure characteristics)*

#### WIRING REQUIREMENTS

2 conductors, 22 AWG minimum, 18 AWG maximum  
*(consult a qualified electrical engineer for wiring gauge appropriate for voltage/current consumption)*



Accurate Location



24/7 Support



Affordable System



Optimize Workflow



Improve Safety



Valuable Data



60003W | Location Device Node | Wall Mount



ATLAS | Locators

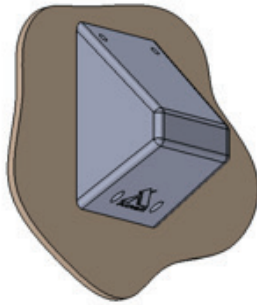

LDN Backplate

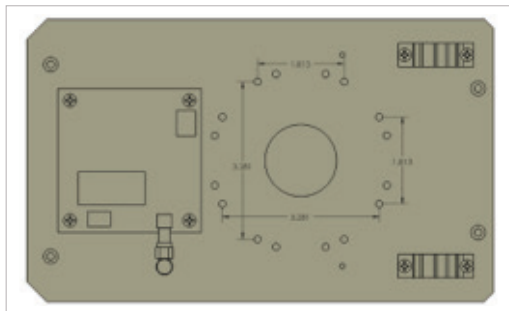

**LDN Power Consumption**  
*UNISV Scaling at 1000 samples/second*

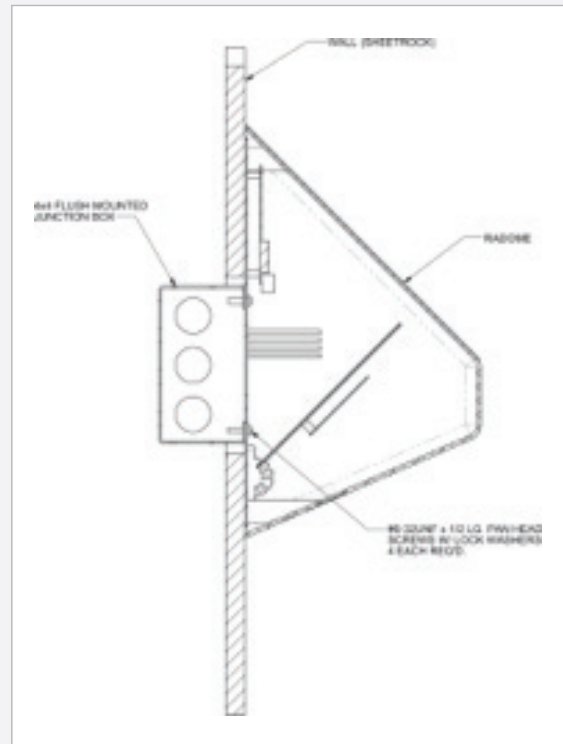
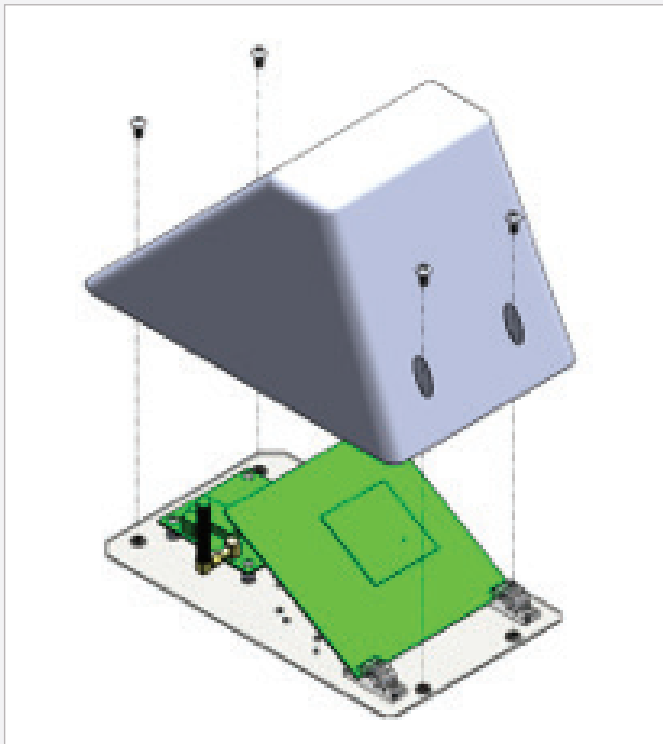
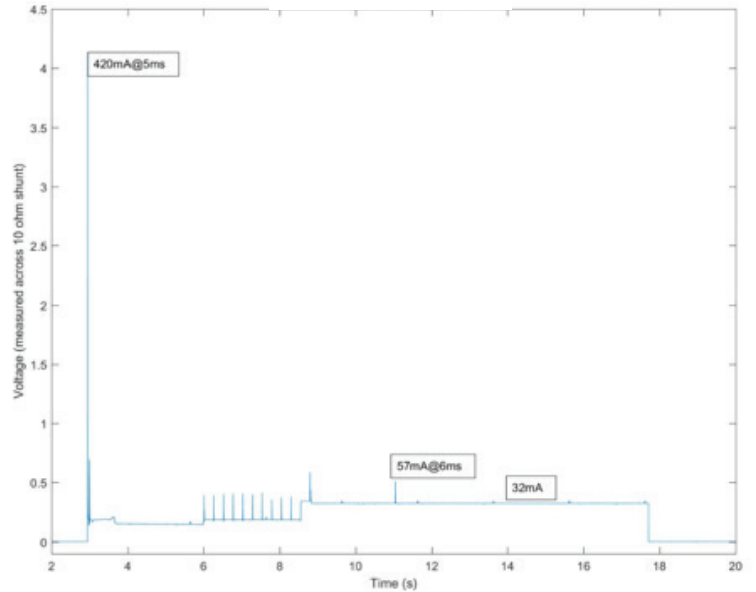

Accurate Location



24/7 Support



Affordable System



Optimize Workflow



Improves Safety



Valuable Data

