

Lines are approximate and not a legal survey. For accurate boundaries, consult a licensed surveyor

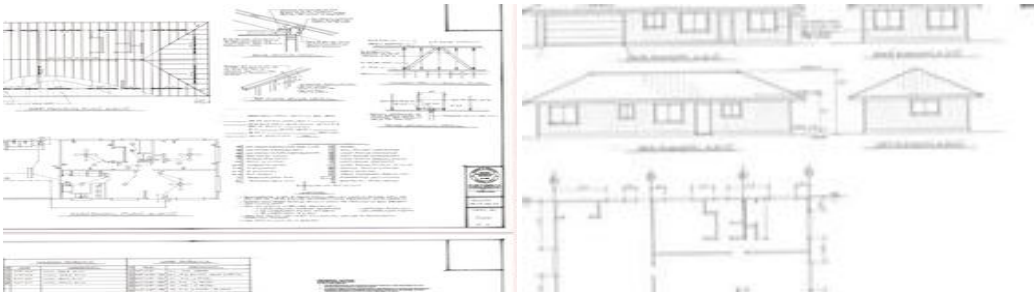

# 15-1452 10TH AVE

House for Sale in **Puna**, Big Island | MLS **717509**

**43,560** **\$140,000**  
sqft land listing price

Here is your opportunity to have your own slice of the Hawaiian Paradise right here on the Big Island! This STAKED parcel is located in the highly sought after Kaloli point area of Hawaiian Paradise Park! The best thing is that building plans are INCLUDED!! Located in the sun belt, this lot on the north side of the subdivision offers easy and quick access to the highway. The 1 acre parcel offers plenty of room for your design imagination. Don't overthink it, use the included building plans! This location is a good choice if you want to have a well instead of a rain

Listed by **Real Broker LLC**



**HAWAII LIFE**  
REAL ESTATE BROKERS

Statewide Customer Support  
Offices on All Islands

**HawaiiLife.com**

**(800)667-5028** call or text

**re@HawaiiLife.com** email support