

# What is a Collet Knob?



## How it works:

The collet knob is disassembled as shown below. The collet slides on top of the potentiometer and as the nut is tightened over the collet, the collet grips the pot 360 degrees to insure a secure fit.

## Advantages of Collet Knobs

1. Collet grips round shaft over the entire circumference insuring a secure fit
2. Brass is used for the metalwork which retains its original state
3. Fixing is from the top allowing access when knobs are close to each other
4. Can easily be moved to a precise, new position on shaft
5. Many accessories are available to make a variety of custom combinations  
(i.e. caps, nut covers, pointers, dials, etc)
6. Since there is no exposed set screw, the knob is electrically isolated from the pot
7. Available to suit many different shaft diameters in the same body size and design
8. Collet tools (spanner tool) is a fixing tool to tighten the round slotted nuts/collars on 10mm, 11mm, 13mm and 15mm collet knobs. This tool provides an easier grip to apply turning torque

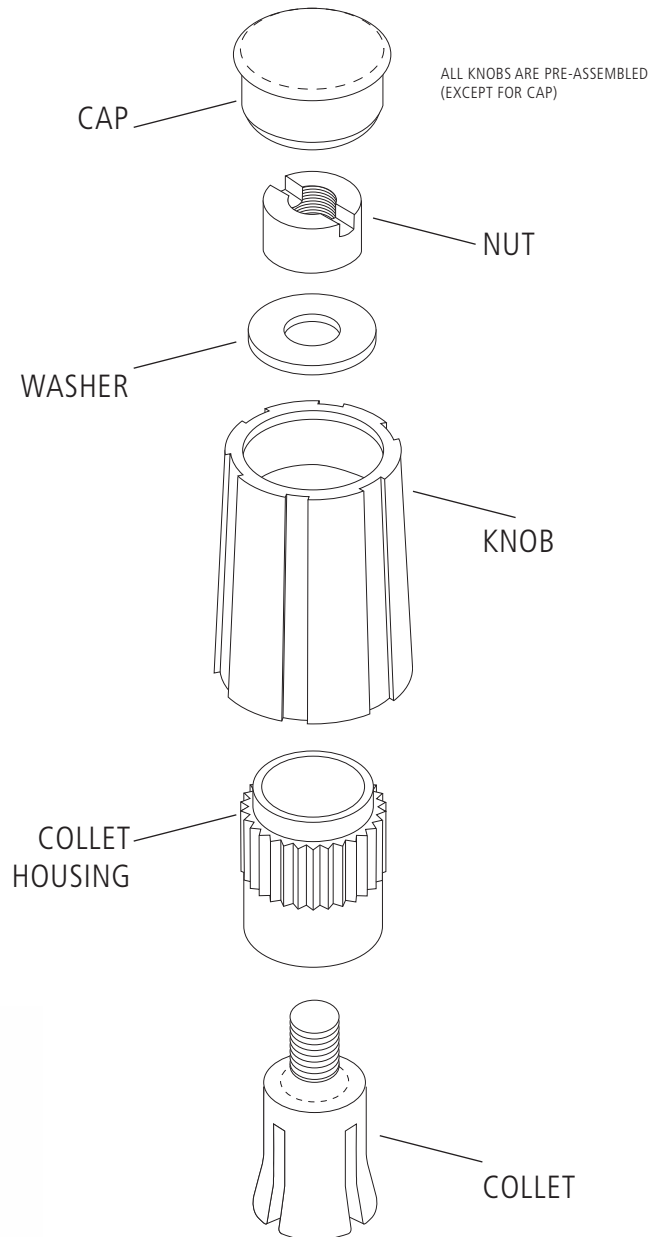
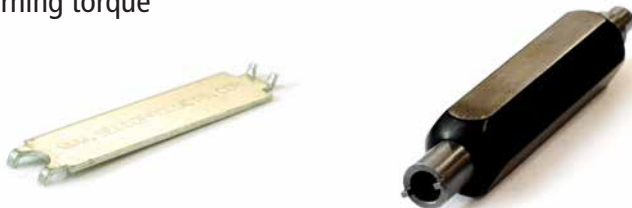

For more information on Selco Products please visit us at: [www.selcoproducts.com](http://www.selcoproducts.com)



Selco Products, Inc.  
8780 Technology Way  
Reno, Nevada 89521-5908

Tel +1.800.257.3526  
Fax +1.775.674.5111  
Email [sales@selcoproducts.com](mailto:sales@selcoproducts.com)

