



Alaska Cruises & Vacations by Tye Travel
President
Marjy Wood

907-205-4003
tyee@akcruises.com
<https://www.akcruises.com>



Alaska's Inside Passage Sojourn

Day 1



Alaskan Dream Inside Passage Sojourn - Baranof Dream

Alaska's Inside Passage Sojourn - Ketchikan to Sitka

DEPART KETCHIKAN THIS AFTERNOON



Day 2



METLAKATLA & MISTY FJORDS

Immerse yourself in the extraordinary history, art, and cultural traditions of the Metlakatla Indian Community on Annette Island. Visit a traditional Tsmishian longhouse, enjoy a ceremonial dance performance, and meet Native artists. Later, your ship will glide beneath the 3,000-foot glacier-sculpted cliffs of Misty Fjords. Discover the fjord's natural history, listen to the calls of a myriad of seabirds, feel the mist from glistening waterfalls, and see famous New Eddystone Rock, a stunning volcanic core.

Day 3



KASAAN

Walk an enchanted forest path laden with intricately carved totem poles to the Chief Son-i-Hat Whale-House,— the only remaining traditional Haida longhouse in the United States. Inside stand four original house posts, or “Gáats,” that were most likely carved at Old Kasaan in about 1880.

Day 4



WRANGELL

Home to a little over 2,000 permanent residents, Wrangell is the only town in Alaska to have been under the jurisdiction of three flags and ruled by four nations- the Tlingit, Russia, England, and the United States. Enjoy several options to explore this colorful history, including a guided tour and a trip to the Wrangell Museum. Visit the intriguing state historic park, Petroglyph Beach, which contains the highest concentration of petroglyphs in Southeast Alaska.

There is also an optional opportunity to board a high-speed jet boat and navigate through a maze of glistening icebergs en route to the LeConte Glacier. This excursion is available at an additional cost and is dependent on space/permits.

Day 5



Tracy/Endicott Arm Fjord/Frederick Sound

Journey through Tracy or Endicott Arm in the Tracy Arm–Fords Terror Wilderness, a place the famous naturalist John Muir called “a wild, unfinished Yosemite.” Renowned for its pristine waterfalls, towering icebergs, abundant harbor seals, and granite cliffs that rise from sea level to 4,000 feet, this wilderness is often referred to by locals as one of the most scenic areas in the state. Scout for humpback whales and other marine mammals in Frederick Sound. Humpbacks are famous for behavior that lends itself to incredible viewing and photography, such as tail lobbing, lunge feeding, pectoral slapping, breaching, and picturesque dives that showcase their massive flukes.

Day 6



Juneau & Orca Point Lodge

Spend the day visiting highlights of the scenic capital city of Juneau, including the world famous Mendenhall Glacier. In downtown Juneau, visit the recently-renovated Alaska State Museum. There will also be time to explore on your own. You may choose to visit the Juneau-Douglas City Museum, Alaska State Capitol, or take in the spectacular panoramic views of the Mount Roberts Tram. You can also delve deeper into local Native culture and history by exploring fascinating exhibits, art displays, and a clan house at the Walter Soboleff Center. End the day’s adventure with a relaxing evening at Orca Point Lodge, our own exclusive day-lodge on Colt Island. Enjoy the beautiful grounds, beach, and marine life touch-tank. Dine on Alaska salmon, Alaska crab*, or prime rib from the warmth of the lodge, or nestled next to a beachside bonfire.

*Subject to local processor availability

Day 7



Glacier Bay National Park

This remarkable national park fjord extends 65-miles, contains eight tidewater glaciers, and provides pristine habitat for a wide-array of wildlife, including both brown and black bears, wolves, mountain goats, Steller sea lions, and humpback whales. The highlight for many is the Margerie Glacier, known for its dramatic calving displays.

Day 8



WILDERNESS EXPLORATION

Savor the serenity of raw wilderness on an unscripted morning and afternoon of Southeast Alaska discovery. The countless options are dictated by the day’s unique circumstances. Opportunities may include a coastline kayak paddle, up-close whale encounters, or a hike through an alluring old-growth forest. We may do a beach landing on an unspoiled shoreline to explore a tidal flat or track along with a foraging bear from the safety of our expedition skiff. Regardless of the activity, you’ll experience the magic of the archipelago’s many remote coves, bays, and inlets.

Day 9



ARRIVE SITKA

After breakfast you will disembark at Sitka. You will be provided transfer to either the cruise line hospitality suite or the airport.

DATES AND PRICING

DATE	ROUTE	A	AA	AAA	DELUXE	DELUXE SUITE
May 27, 2024	Ketchikan to Sitka	\$5,395	\$5,495	\$6,195	\$7,595	\$8,095
June 4, 2024	Sitka to Ketchikan	\$5,395	\$5,495	\$6,195	\$7,595	\$8,095

June 12 2024	Ketchikan to Sitka	\$5,395	\$5,495	\$6,195	\$7,595	\$8,095
June 28, 2024	Ketchikan to Sitka	\$5,395	\$5,495	\$6,195	\$7,595	\$8,095
July 8, 2024	Sitka to Ketchikan	\$5,395	\$5,495	\$6,195	\$7,595	\$8,095
July 16 2024	Ketchikan to Sitka	\$5,395	\$5,495	\$6,195	\$7,595	\$8,095
Aug 01, 2024	Ketchikan to Sitka	\$5,395	\$5,495	\$6,195	\$7,595	\$8,095
Aug 9, 2024	Sitka to Ketchikan	\$5,395	\$5,495	\$6,195	\$7,595	\$8,095
Aug 17, 2024	Ketchikan to Sitka	\$5,395	\$5,495	\$6,195	\$7,595	\$8,095
Sep 02, 2024	Ketchikan to Sitka	\$5,395	\$5,495	\$6,195	\$7,595	\$8,095

BARANOF DREAM

SHIP SPECIFICATIONS

Passengers: 49**
 Length: 143 feet
 Staterooms: 25
 Cruising Speed: 9 knots

STATEROOMS/CATEGORIES

Deluxe Suite: One queen bed with two chairs; or replaced with one twin bed or one twin bunk bed. Large picture window, wardrobe, private bathroom with shower. Approx. 210 sq. ft.

+Select cabins can accommodate 3rd or 4th guests

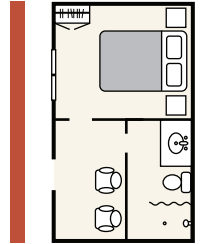

Deluxe: One queen bed, with either two chairs or an additional twin bed (or bunk bed) in the sitting room. Large picture window, wardrobe, private bathroom with shower. Approx. 110 sq. ft.

**Select cabins can accommodate a 3rd guest*

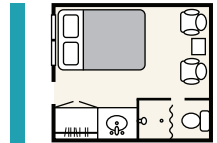

AAA: One queen bed, and either two chairs or one twin bed. Large picture window, wardrobe, private bathroom with shower. Approx. 116 sq. ft.

+Select cabins can accommodate 3rd or 4th guests

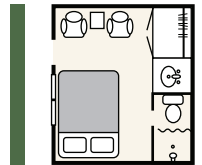

AA: Two twin beds, picture window, wardrobe, private bathroom with shower. Approx. 105 sq. ft.

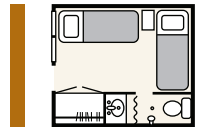

A: One queen and one single bed, picture window, private bathroom with shower. Approx. 109 sq. ft.

**Select cabins can accommodate a 3rd guest*

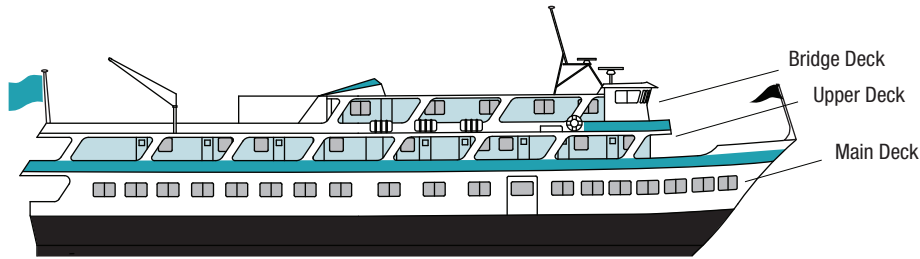
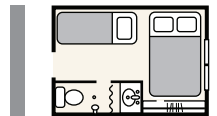

BRIDGE DECK

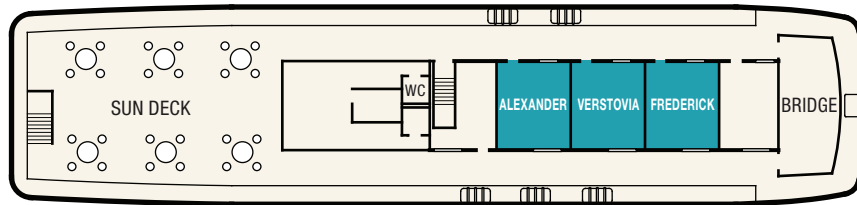

UPPER DECK

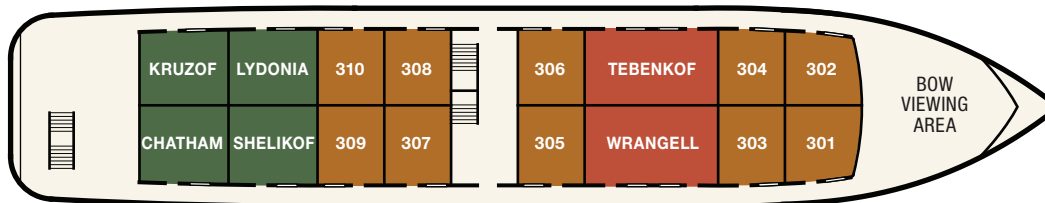

MAIN DECK

