



Alaska Cruises & Vacations by Tye Travel
President
Marjy Wood

907-205-4003
tyee@akcruises.com
<https://www.akcruises.com>



Ice of the Inside Passage

And incredible ICE intensive itinerary with Glacier Bay National Park at Dundas Bay, Glacier Bay NP proper, Juneau and the Mendenhall Glacier, Tracy Arm Fjord & glacier, Dawes Glacier and the LeConte Glacier by jet boat!

Day 1



Ice of the Inside Passage

DAY 1 – Sitka - Explore beautiful Sitka—the only community in Southeast Alaska that faces the open ocean waters of the Gulf of Alaska. Visit sites that highlight the community’s rich culture, history, and biodiversity. Embark for the winding narrows north of town while searching for bald eagles, sea otters, bears, whales, and other wildlife.

DAY 2 - Glacier Bay National Park - Dundas Bay - Venture into Dundas Bay (or another similar wilderness location) located near Cross Sound and within the boundaries of Glacier Bay National Park. In this secluded area, you'll experience remarkable solitude as you add a shallow water coastline inaccessible to larger craft.

DAY 3 - Glacier Bay National Park - This remarkable national park fjord extends 65-miles, contains tidewater glaciers, and provides pristine habitat for a wide-array of wildlife, including both brown and black bears, wolves, mountain goats, Steller sea lions, and humpback whales. The highlight for many is the Margerie Glacier, which has been known for its dramatic calving displays.

DAY 4- Juneau & Orca Point Lodge - Spend the day visiting highlights of the scenic capital city of Juneau, including the world-famous Mendenhall Glacier. In downtown Juneau, visit the recently renovated Alaska State Museum. There will also be time to explore on your own. You may choose to visit the Juneau-Douglas City Museum, Alaska State Capitol, or take in the spectacular panoramic views of the Mount Roberts Tram. You can also delve deeper into local Native culture and history by exploring fascinating exhibits, art displays, and a clan house at the Walter Soboleff Center. End the day’s adventure with a relaxing evening at Orca Point Lodge, our own exclusive day-lodge on Colt Island. Enjoy the beautiful grounds, beach, and marine life viewing-tank. Dine on Alaska salmon, Alaska crab*, or prime rib from the warmth of the lodge, or nestled next to a beachside bonfire.

*Subject to local processor availability

DAY 5 - Tracy Arm Fjord - Journey through Tracy Arm, a place the famous naturalist, John Muir, called, “a wild, unfinished Yosemite.” Renowned for its glaciers, pristine waterfalls, towering icebergs, abundant harbor seals, and granite cliffs that rise from sea level to 4,000 feet, this wilderness is often referred to by locals as one of the most scenic areas in the state.

DAY 6 - Endicott Arm Fjord - Enjoy an exciting kayak or skiff expedition in stunning Endicott Arm—a glacial fjord in the Tracy Arm Ford’s Terror Wilderness area. View the impressive Dawes Glacier at the head of the arm. Later, scout for humpback whales and other wildlife in Frederick Sound.

DAY 7 - Wrangell & Leconte Glacier - After exploring the charming and historical community of Wrangell, board a comfortable, high-speed jet boat and venture north through Dry Strait to LeConte Bay. En route to the spectacular LeConte Glacier—North America’s southernmost tidewater glacier—you’ll navigate through a maze of glistening icebergs in the shadows of towering, snow-capped mountains.

DAY 8 – Kasaan - Walk an enchanted forest path laden with intricately carved totem poles to the Chief Son-i-Hat Whale-House—the only remaining traditional Haida longhouse in the United States. Inside stand four original house posts, or “Gáats,” that were most likely carved at Old Kasaan in about 1880.

DAY 9 - Ketchikan - Disembark in Ketchikan, otherwise known as Alaska’s “First City’ and “Salmon Capital of the World.” Transfer to your hotel or the airport is complimentary.



Photo Legend

Photo 1 - Glacier Bay, Photo 2 - Dog on Petroglyph Beach Wrangell, Photo 3 - Heading in to Tracy Arm, Photo 4 - Orca Point Lodge, Photo 5,6,7 - LeConte Glacier near Wrangell, with permission James & Jim Leslie



BARANOF DREAM

SHIP SPECIFICATIONS

Passengers: 49**
 Length: 143 feet
 Staterooms: 25
 Cruising Speed: 9 knots

STATEROOMS/CATEGORIES

Deluxe Suite: One queen bed with two chairs; or replaced with one twin bed or one twin bunk bed. Large picture window, wardrobe, private bathroom with shower. Approx. 210 sq. ft.

+Select cabins can accommodate 3rd or 4th guests

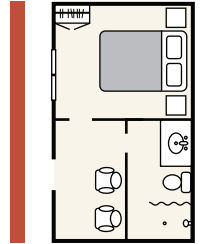

Deluxe: One queen bed, with either two chairs or an additional twin bed (or bunk bed) in the sitting room. Large picture window, wardrobe, private bathroom with shower. Approx. 110 sq. ft.

*Select cabins can accommodate a 3rd guest

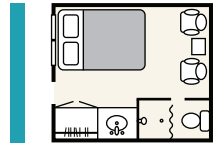

AAA: One queen bed, and either two chairs or one twin bed. Large picture window, wardrobe, private bathroom with shower. Approx. 116 sq. ft.

+Select cabins can accommodate 3rd or 4th guests

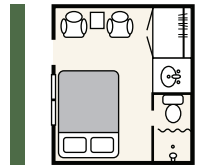

AA: Two twin beds, picture window, wardrobe, private bathroom with shower. Approx. 105 sq. ft.

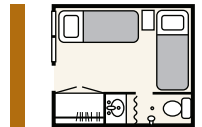

A: One queen and one single bed, picture window, private bathroom with shower. Approx. 109 sq. ft.

*Select cabins can accommodate a 3rd guest

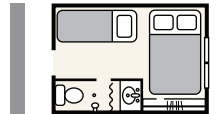

DELUXE SUITE



DELUXE



AAA



AA



A

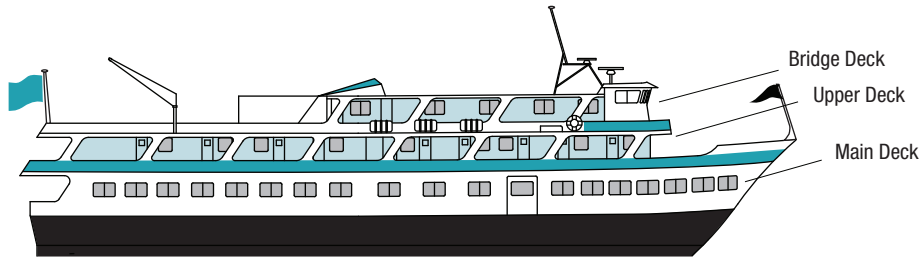

BRIDGE DECK

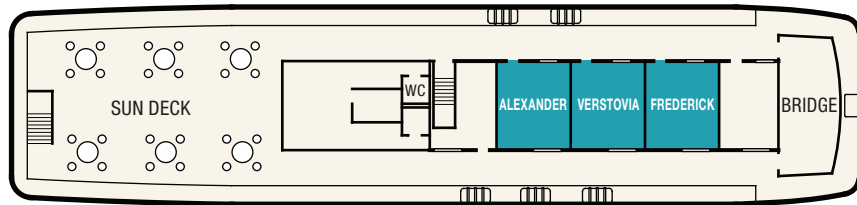

UPPER DECK

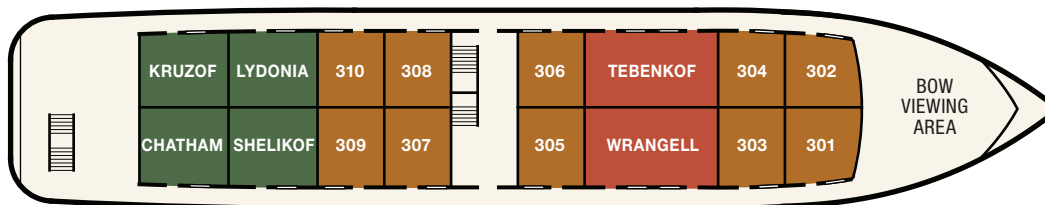

MAIN DECK

