

THE INTELLECTUAL HOUSE PHASE II



“With the next phase of the Intellectual House, we have the opportunity to reaffirm our commitment to our tribal students and communities and to start a new chapter in our successful work together.”

UW President Ana Mari Cauce

A HOME FOR STUDENTS

wəʔəbʔaltx^w – Intellectual House is built on tribal land and provides a multi-service learning and gathering space for American Indian and Alaska Native students, faculty and staff, as well as others from various cultures and communities to come together in a welcoming environment to share knowledge. A place to honor tribal sovereignty where students come together, where they feel comfortable, where they learn and celebrate. Where they are at home.

When it opened its doors for the first time in 2015, the Intellectual House made history. The building was the culmination of a decades-long dream to create a gathering place in honor of our region’s First Nations. An iconic structure on the University of Washington campus, the Intellectual House has been home to many tribal summits and events, and it has been the site of many other university and community events. Now, it is time to complete Phase II by adding spaces specifically for students. Phase II will require a collaboration among tribes, businesses, individuals and the University.

IMPACT OF THE INTELLECTUAL HOUSE

A **DEDICATED SPACE** FOR TRIBAL SUMMITS AND COMMUNITY GATHERINGS

SUCCESSFUL STUDENT PROGRAMMING HAS FOCUSED ON ACADEMICS, CULTURE AND PROFESSIONAL DEVELOPMENT

75,000 INDIVIDUALS HAVE ATTENDED MORE THAN **620** EVENTS

200+ AMERICAN INDIAN AND ALASKA NATIVE STUDENTS HAVE GRADUATED AND CELEBRATED THEIR ACHIEVEMENTS AT THE ANNUAL RAVEN’S FEAST

OVER **110,000** TOTAL INDIVIDUALS HAVE VISITED THE SPACE

5,000 CAMPUS PARTNERS HAVE HOSTED EVENTS IN THE GREAT GATHERING HALL

ESTABLISHMENT OF **UW CENTER FOR AMERICAN INDIAN AND INDIGENOUS STUDIES**

HOURLY JOBS TO AMERICAN INDIAN AND ALASKA NATIVE STUDENTS, AS WELL AS OTHER UNDERREPRESENTED STUDENTS

WHAT WILL PHASE II INCLUDE?

Phase II will be a 8,400-square-foot teaching and learning building with a design showcasing contemporary indigenous architecture. The space will focus on student success and include a student lounge. The funds raised will include the ability to increase student programming.

> MEETING SPACES

including an outdoor classroom, to bring more of our community into the space

> NATIVE ART LABS

for basket weaving, carving and other art, all part of our commitment to cultural artistic restoration on campus.

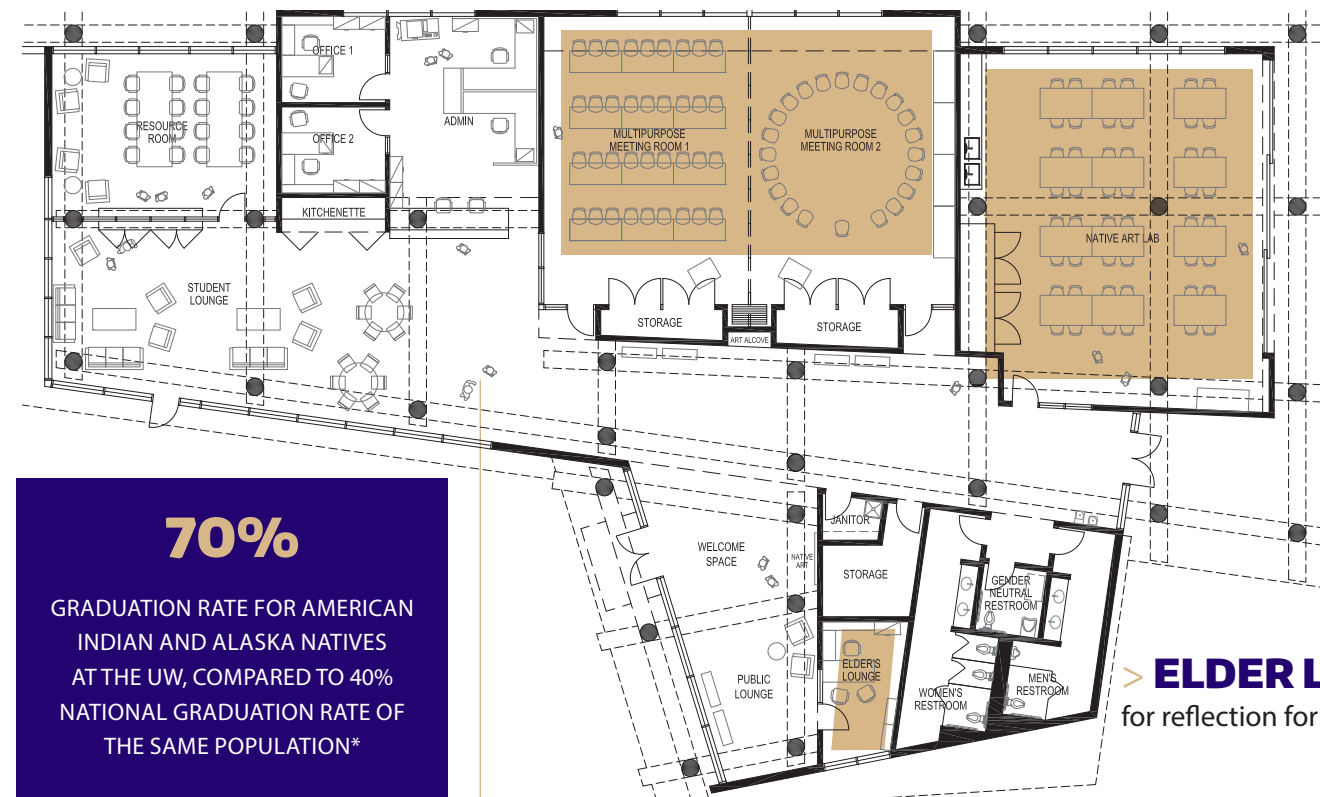

> **ELDER LOUNGE** for reflection for our students

70%

GRADUATION RATE FOR AMERICAN INDIAN AND ALASKA NATIVES AT THE UW, COMPARED TO 40% NATIONAL GRADUATION RATE OF THE SAME POPULATION*

3RD

MOST BACHELOR'S DEGREES FROM NATIONAL FLAGSHIP UNIVERSITIES AWARDED TO AMERICAN INDIAN AND ALASKA NATIVE STUDENTS

1ST

RANK AMONG PUBLIC AND PRIVATE UNIVERSITIES IN DEGREES AWARDED TO UNDERREPRESENTED MINORITY STUDENTS IN WASHINGTON STATE

4TH

MOST GRADUATE DEGREES FROM NATIONAL FLAGSHIP UNIVERSITIES AWARDED TO AMERICAN INDIANS

YOU CAN IMPACT STUDENTS' LIVES

Create a student-centric building with a welcoming space that shows value and respect for our communities

Increase evening and weekend use and current programming which includes speakers series, the Food Sovereignty Symposium, documentary film discussions, job-skills training, grant writing workshops, resume building, and professional networking and development

Provide a supportive environment so students thrive, graduate and work to employ more American Indian and Alaska Native students

Help students stay connected to and learn more about their cultural traditions

Support essential infrastructure for students to work and study together

Be part of respecting the past and addressing the racial dynamic in our community and facing some hard truths about the need to support AI/AN people in our community

American Indian and Alaska Native students, faculty and staff say they chose their particular college or university in part because of the longhouses on campus that welcomed them.

HELP US REACH OUR GOAL OF \$12 MILLION

MULTI-YEAR PLEDGES ARE WELCOMED

\$2.3 MILLION CURRENTLY RAISED *includes legacy giving

JOIN OUR CURRENT DONORS AND TRIBAL COMMUNITY PARTNERS WHO ARE SUPPORTING PHASE II.

RECOGNIZING YOUR COMMITMENT

Phase II offers several opportunities to name spaces which could include naming in honor or memory of an elder in the community. Our team is glad to work with you to ensure your gift is an investment in our students and the future of our American Indian and Alaska Native communities.



Phase II	Square footage	Gift amount
Native arts lab	1,500	\$1,000,000
Student lounge	1,300	\$750,000
Multi-purpose meeting room (2)	800	\$500,000
Computer/resource room	800	\$500,000
Public lounge	290	\$200,000
Elder's office	140	\$100,000
Staff office (2)	120	\$50,000
Total	5,870	\$3,650,000

Community gathering building – 8,645 square feet

Space	Square footage	Gift amount
Gathering hall	4,600	\$2,500,000
Welcome space/gathering Lobby	700	\$500,000
Conference room/green room	460	\$250,000
Kitchen	700	\$250,000
Total	6,460	\$3,500,000

Outdoor features

Space	Square footage	Gift amount
Gathering circle	1,500	\$500,000
Basket plants garden/Bioretenion Swale	1,500	\$100,000
Traditional use plants garden	600	Committed
Outdoor cooking plaza	400	\$35,000
Outdoor classroom (2)	350	Committed
Total	4,700	\$725,000

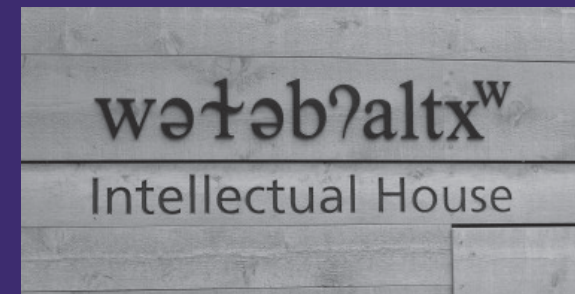

"It is our obligation to make higher education the best years of our students' lives and to be part of the reason that they thrive in college, in their communities, and in life."

Chairman, Ron Allen, UW Alum '83, Jamestown S'Klallam Tribe.

LEARN MORE

www.uw.edu/diversity/tribal-relations/intellectual-house/
www.washington.edu/omad/advancement/intellectual-house

CONTACT US

Katherine Day Hase | kdayhase@uw.edu | 206.616.4929
 lisaaksiichaa Ross Braine | dabraine@uw.edu | 206.616.6056
 Daya Terry | wnmterry@uw.edu | 206.616.2492

UNIVERSITY of WASHINGTON

The University of Washington acknowledges the Coast Salish peoples of this land, the land which touches the shared waters of all tribes and bands within the Suquamish, Tulalip and Muckleshoot nations.

wəłəbʔaltxʷ

THE INTELLECTUAL HOUSE PHASE II

"As you walk into wəłəbʔaltxʷ you can truly smell the cedar, and you can feel the spirit. This learning and gathering space reflects our Native heritage and cultures, while building community and respect. Now, it is time to create a student-centric building that will deliver on the UW's promise to respect the land on which we stand and truly support to our American Indian and Alaska Native students."

lisaaksiichaa Ross Braine (Apsaalooke Nation)
 UW Tribal Liaison and wəłəbʔaltxʷ Director

